

FunEase
Magnetic charging port

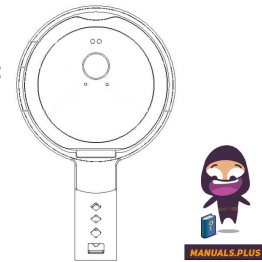

FunEase Magnetic charging port Instruction Manual

[Home](#) » [FunEase](#) » FunEase Magnetic charging port Instruction Manual 

Contents

- 1 FunEase Magnetic charging port
- 2 Product usage process
- 3 Set language
- 4 Description of custom options
- 5 Attachment list
- 6 FCC Statement
- 7 Documents / Resources
 - 7.1 References

FunEase

FunEase Magnetic charging port

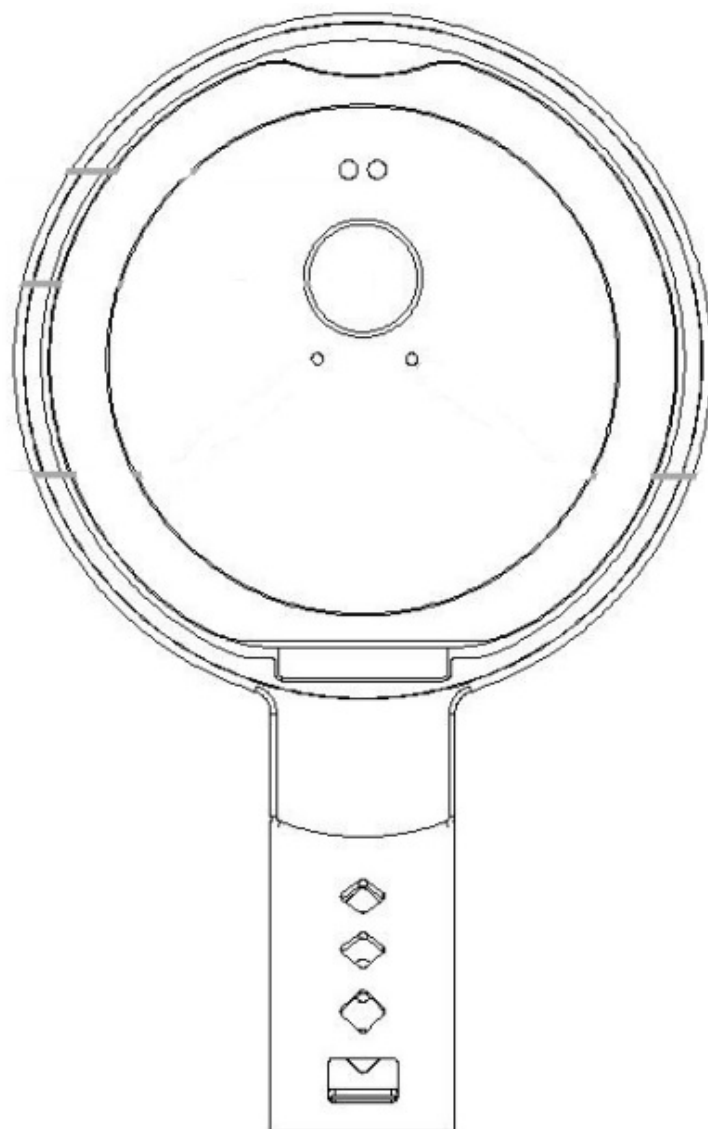

Appearance and function instructions of Bluetooth device.

Magnetic charging port

Provides a magnetic charging function. Using a conventional charger (5V1A), it can be fully charged in about 15 minutes. (It is not recommended to use high-power fast-charging chargers)

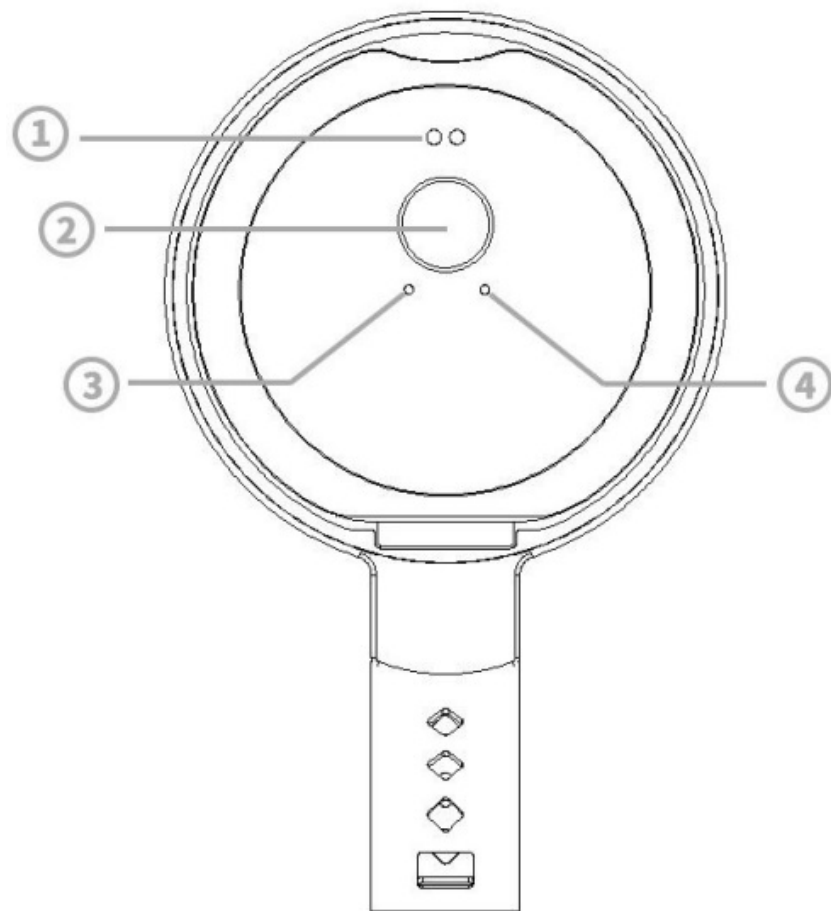

Voice control keys

When the device is connected, press and hold the control button to use the voice translation and speech-to-text functions. When the device is sleeping, press the control button to wake up the device.

Indicator light

- Hibernation/Standby: Lights off
- Bluetooth Not Connected: Flashing Blue Light
- Bluetooth connection successful: blue light flashes three times quickly
- While charging, the red light is always on; when fully charged, the red light turns off.

Reset key

Use the phone's card removal pin to press and hold for 2 seconds to restart the device.

Product usage process

- Download APP: The device needs to be used together with the APP.
- Method 1: Scan the QR code, download and install the "FunEase" APP
- Method 2: You can search for "FunEase" in major app stores to install it.



Connect Bluetooth device

1. Press the Voice control keys of the device to wake up the device. At this time, the device will flash a blue light;
2. Open “Settings” > “Bluetooth” on your phone, turn on Bluetooth search for devices, and select “FunEase” from the device list to pair and connect. After the Bluetooth connection is successful, the device will flash a blue light three times.
3. Return to the “FunEase” APP, and the device and the APP will be automatically connected successfully, the “Device not connected” prompt at the top will disappear, and you can start using it.



Important reminder: The device will enter sleep mode if it is not used for 10 minutes. You only need to press the Voice control keys again to wake up the device, and the device will automatically restore the connection with your phone.

Set language

1. Open the “FunEase” APP installed on your mobile phone and enter the homepage;
2. Click “Mandarin” on the left and set it as the source language for recognition;
3. Click “English” on the right and set it as the target language for translation.

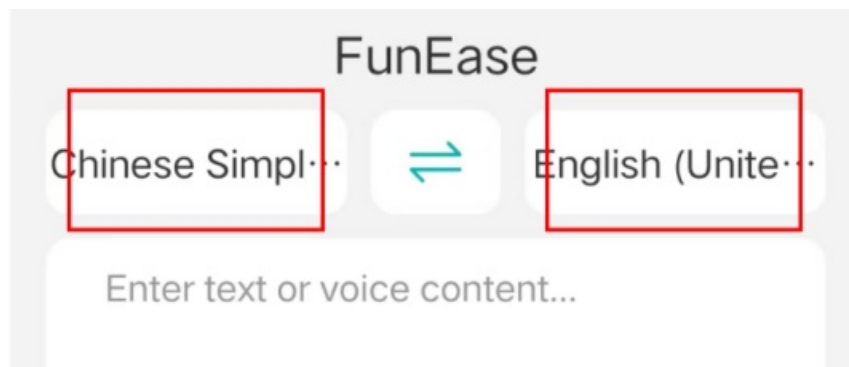

4. One-click cross-application translation and automatic pasting of translated content:

On the homepage of the "FunEase" APP, turn on {Translate}, {Read aloud}, and {Cross-application switch}; Important reminder: Apple mobile phone users must turn on the {cross-application switch} option. After turning it on, the "video small window" will pop up and slide to the edge of the screen to automatically paste text across applications! (Android phone users do not have this option and can simply ignore it because Android supports automatic pasting across applications by default.)

In the App, or switch to any third-party software (for example WeChat, QQ, WhatsApp, email, memo, etc.), click the text input box, then press and hold the voice control key of the device, speak a sentence into the phone, release the voice control key after speaking, and the text will immediately appear in the text box. The effect is as follows:



Description of custom options

Options	Turn On	Turn Off
Translate	Voice translation mode (long press the Voice control keys, speak a sentence into the phone, and the system will automatically translate it into a foreign language).	Voice-to-text mode (press and hold the Voice control keys, speak a sentence into the phone, and the system will automatically convert it into text).
Read aloud	Automatically read translations aloud.	Translations are not automatically read aloud.
Only show translations	The translation results only display the translation, not the original text.	The translation results display both the translation and the original text.
Cross-application switch (iPhone)	In any third-party APP, click on the text box and use the device's Voice control keys to automatically paste content into the text box.	Turn off automatic pasting of content into text boxes across apps.
Show floating window (Android phone)	When using one-click cross-application translation, the floating window can help you preview the translation results and quickly set custom options.	Turn off the floating window function.
Pronunciation	Switch male or female voice.	

App cross-application functions

Scenes	Steps
Required steps: Before using the function, open the APP {set language} + turn on {Translate, Read aloud, cross-application switch}	

Send text messages to foreign friends	Click on the chat input box, press and hold the Voice control keys without letting go. After speaking a sentence into the phone, release the Voice control keys. The system will automatically paste the content into the input box and send it with one click.
Send voice messages to foreign friends	(In the chat interface) Press and hold the Voice control keys, speak a sentence into the phone, then press and hold the “press and hold talk” button (of the chat software), and then release the Voice control keys. At this moment, the voice of reading the translation will appear. After the reading is completed, release the “press and hold to speak” button (in this way, the translated voice will be automatically sent to the other party).
Translate text messages from foreign friends	Copy the text sent by foreign friends, return to the “FunEase” App, and the system will automatically translate the content you copied into your language.
Translate voice messages from foreign friends	(In the chat interface) Press and hold the voice control key, then click to play the voice message of the foreign friend, (click the text input box), wait for the voice playback to finish, and then release the voice control key. The system will read the translation immediately (the translation result will also be automatically pasted into the text box)
Make voice & video calls to foreign friends	Open the “Video Call” function of the APP, set the language of both parties, and then click “Invite Friends to Call” to send the “Call Invitation Link” to the foreign friend, so that the other party can directly open the link to join the call. (The other party can talk to you without downloading the APP)

App's popular functions

Conversation translation, simultaneous interpretation, voice and video call translation, and camera translation.

Installation method

Please choose whether to stick the “magnetic ring” on the back of the phone case according to your own needs to achieve the function of adsorbing the device. Good looking and easy to carry!

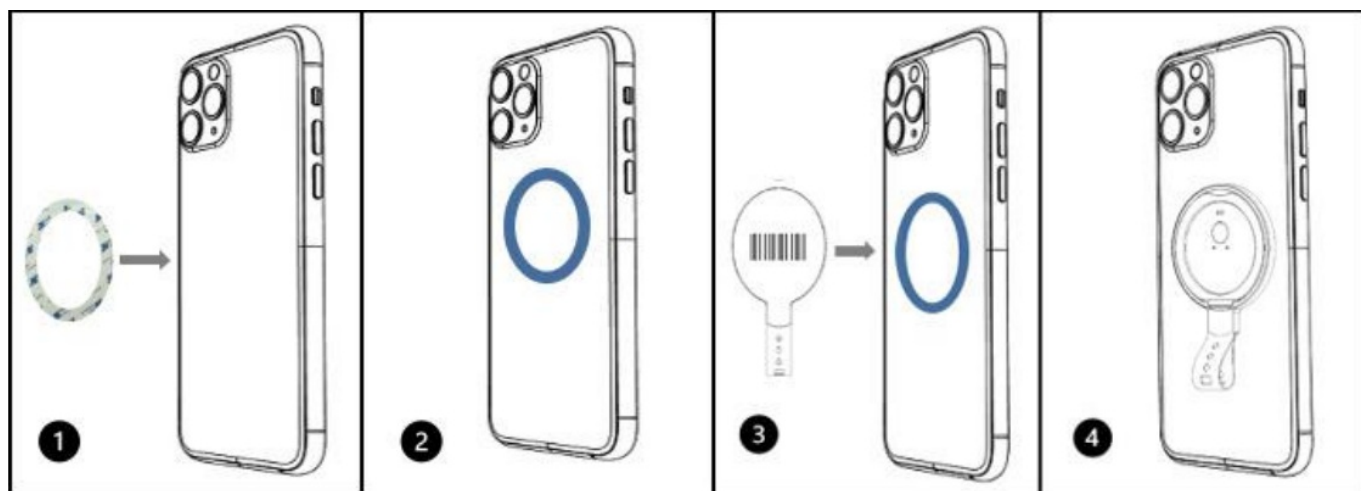

Attachment list

Device, charging cable, magnetic ring, instruction manual.

Safety information

Before using this product, please read the following safety information.

1. Do not charge with a damaged or untested charger to avoid fire, explosion, or other dangers;
2. Please keep the device and all accessories out of the reach of children to avoid being swallowed by them and causing suffocation or other risks;
3. The device is not waterproof, please keep away from any liquid;
4. Please avoid dropping, burning, or squeezing the product to avoid equipment damage;
5. Do not expose the product to high temperatures or around heating equipment such as ovens, microwave ovens, etc.;
6. Our company is not responsible for quality problems, equipment failures, and safety accidents caused by the use of unofficially approved accessories.

FCC Statement

This equipment has been tested and found to comply with the limits for a Class B digital device, under Part 15 of the FCC Rules. These limits are designed to provide reasonable protection against harmful interference in a residential installation. This equipment generates uses and can radiate radio frequency energy and, if not installed and used by the instructions, may cause harmful interference to radio communications. However, there is no guarantee that interference will not occur in a particular installation. If this equipment does cause harmful interference to radio or television reception, which can be determined by turning the equipment off and on, the user is encouraged to try to correct the interference by one or more of the following measures:

- Reorient or relocate the receiving antenna.
- Increase the separation between the equipment and the receiver.
- Connect the equipment to an outlet on a circuit different from that to which the receiver is connected.
- Consult the dealer or an experienced radio/TV technician for help.

This device complies with part 15 of the FCC Rules. Operation is subject to the following two conditions: (1) This device may not cause harmful interference, and (2) this device must accept any interference received, including interference that may cause undesired operation. Changes or modifications not expressly approved by the party responsible for compliance could void the user's authority to operate the equipment. The device has been evaluated to meet general RF exposure requirements. The device can be used in portable exposure conditions without restriction.

Product warranty card

Dear user:

Thank you for choosing our company's products to provide you with warranty service, please fill out this card carefully so that you can use this card for future repairs. This voucher is an important basis for the three guarantees of the product, please keep it properly.

- Name:
- Contact number:
- Product Name/Model:
- Purchase date:
- Purchase location:
- Device MAC:

Warranty instructions

1. Please keep this card properly. This card and proof of purchase are required for warranty purposes.
2. From the date of purchase, if the product is used normally by the product instructions, it will be repaired free of charge if it breaks down within one year.

The following situations are not within the scope of free services, but paid maintenance services are available:

1. Warranty cards and invoices cannot be produced.
2. Alteration of invoice.
3. Damage caused by accidental factors or improper use.
4. Damage caused by repairing by yourself without our permission.
5. If the three-pack validity period has expired, it can still be used after repair.

For products that have exceeded the warranty period, our company will continue to provide you with paid services.



Documents / Resources

	FunEase AiTok Smart Voice Input Device [pdf] Instruction Manual 2BMAZ-COINTOKBTC, 2BMAZCOINTOKBTC, AiTok Smart Voice Input Device, Smart Voice Input Device, Voice Input Device, Input Device, Device
-------------------------------------------------------------------------------------	--------------------------------------------------------------------------------------------------------------------------------------------------------------------------------------------------------------------------

References

- [User Manual](#)

[Manuals+](#). [Privacy Policy](#)

This website is an independent publication and is neither affiliated with nor endorsed by any of the trademark owners. The "Bluetooth®" word mark and logos are registered trademarks owned by Bluetooth SIG, Inc. The "Wi-Fi®" word mark and logos are registered trademarks owned by the Wi-Fi Alliance. Any use of these marks on this website does not imply any affiliation with or endorsement.