



FULLINK KB2901 Keyboard Case User Manual

[Home](#) » [FULLINK](#) » FULLINK KB2901 Keyboard Case User Manual 

Contents

- [1 FULLINK KB2901 Keyboard Case](#)
- [2 Power Light Overview](#)
- [3 Shortcut Keys](#)
- [4 Troubleshooting Guide](#)
- [5 FCC Statement](#)
- [6 Documents / Resources](#)
- [7 Related Posts](#)

FULLINK

FULLINK KB2901 Keyboard Case



Pairing Mode



Hold fn+ for 3 seconds to enter pairing mode while Bluetooth LED flash, turn on the tablet and enable the Bluetooth function, search for “Bluetooth keyboard” , and click it to pair.

Power Light Overview

- **Charging:** The red light is on
- **Fully Charged:** steady green light
- **Low battery:** The red light flashes every three seconds

Power Key

The keyboard is on at 90° and closed at 180°.

Standby Mode

The keyboard will enter into standby mode after 10 minutes of inactivity.

Backlight



Press to adjust the brightness(3 brightness level setting,start from the lowest level).

Shortcut Keys

FN+ shortcut key

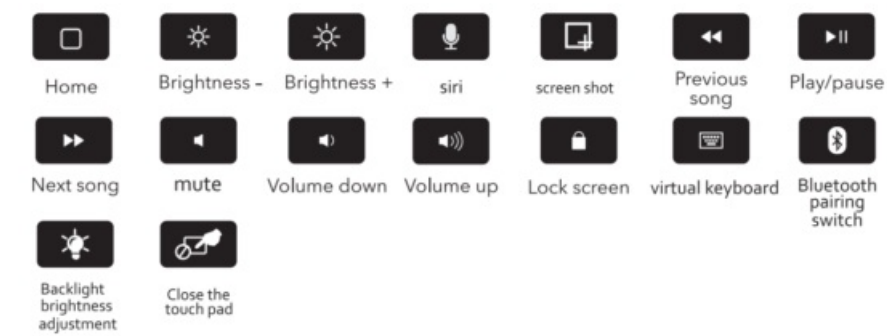

Troubleshooting Guide

If the keyboard stop working, please check the following:

1. Please flip the keyboard to 90° to open.
2. if the keyboard is out of battery, charge the keyboard.
3. if the connection is unstable, turn the keyboard and wait for 10 seconds before turning it back on. if the problem persists, disconnect the keyboard by going to Setting-Bluetooth- Device list-“Bluetooth keyboard” and “Select” or “Forget This Device”, then follow the Bluetooth pairing instruction to reconnect your keyboard.

If the keyboard remains unresponsive, repeat the above steps. If you are still experiencing problems, contact our Customer service.

Reminder

1. Built-in rechargeable battery can supply power for a few of weeks using-
2. In order to prolong battery life, suggest turning off the keyboard when not using the keyboard for an extended period of time.

FCC Statement

This device complies with part 15 of the FCC Rules. Operation is subject to the following two conditions:

1. This device may not cause harmful interference, and
2. this device must accept any interference received, including interference that may cause undesired operation

This equipment has been tested and found to comply with the limits for a Class B digital device, pursuant to part 15 of the FCC Rules. These limits are designed to provide reasonable protection against harmful interference in a residential installation. This equipment generates, uses and can radiate radio frequency energy and, if not installed and used in accordance with the instructions, may cause harmful interference to radio communications. However, there is no guarantee that interference will not occur in a particular installation. If this equipment does cause harmful interference to radio or television reception, which can be determined by turning the equipment off and on, the user is encouraged to try to correct the interference by one or more of the following measures:

- Reorient or relocate the receiving antenna.
- Increase the separation between the equipment and the receiver.
- Connect the equipment into an outlet on a circuit different from that to which the receiver is connected.
- Consult the dealer or an experienced radio/TV technician for help.

Caution: Any changes or modifications not expressly approved by the party responsible for compliance could void the user’s authority to operate the equipment.
This equipment complies with FCC radiation exposure limits set forth for an uncontrolled environment. This transmitter must not be co-located or operating in conjunction with any other antenna or transmitter

Documents / Resources

	FULLINK KB2901 Keyboard Case [pdf] User Manual KB2901, 2A9P3-KB2901, 2A9P3KB2901, KB2901 Keyboard Case, KB2901, Keyboard Case, Case
---	--