



Fujitsu Air Conditioner Remote Buttons and Functions Guide

[Home](#) » [FUJITSU](#) » Fujitsu Air Conditioner Remote Buttons and Functions Guide 

Contents

- [1 Fujitsu Air Conditioner Remote Buttons and Functions Guide](#)
- [2 Introduction](#)
- [3 SAFETY PRECAUTIONS](#)
- [4 FEATURES AND FUNCTIONS](#)
- [5 WIRED REMOTE CONTROLLER \(OPTION\)](#)
- [6 NAME OF PARTS](#)
- [7 PREPARATION](#)
- [8 OPERATION](#)
- [9 SUPER QUIET Operation](#)
- [10 ADJUSTING THE DIRECTION OF AIR CIRCULATION](#)
- [11 SWING OPERATION](#)
- [12 CLEANING AND CARE](#)
- [13 TROUBLESHOOTING](#)
- [14 OPERATING TIPS](#)
- [15 Temperature and Humidity Range](#)
- [16 SPECIFICATIONS](#)
- [17 FAQs](#)
- [18 Related Posts](#)



Fujitsu Air Conditioner Remote Buttons and Functions Guide



Introduction

The Fujitsu Air Conditioner Remote is a crucial component of Fujitsu's innovative cooling solutions, providing users with convenient control over their air conditioning systems. Packed with an array of buttons and functions, this remote empowers users to customize and optimize their indoor climate according to their preferences. In this blog post, we will explore the various buttons and functions found on the Fujitsu Air Conditioner Remote, shedding light on their purpose and explaining how they contribute to creating a comfortable environment. Whether you're a new user or simply looking to maximize your air conditioning experience, understanding these features will help you harness the full potential of your Fujitsu air conditioner. So, let's dive in and discover the key buttons and functions at your fingertips!

SAFETY PRECAUTIONS

DANGER!

- Do not attempt to install this air conditioner by yourself.
- This unit contains no user-serviceable parts. Always consult authorized service personnel for repairs.
- When moving, consult authorized service personnel for disconnection and installation of the unit.
- Do not become excessively chilled by staying for lengthy periods in the direct cooling airflow.
- Do not insert fingers or objects into the outlet port or intake grilles.
- Do not start and stop the air conditioner operation by disconnecting the power supply cord and so on.
- Take care not to damage the power supply cord.
- In the event of a malfunction (burning smell, etc.), immediately stop operation, disconnect the power supply plug, and consult authorized service personnel

CAUTION!

- Provide occasional ventilation during use.
- Do not direct airflow at fireplaces or heating apparatus.
- Do not climb on, or place objects on, the air conditioner.
- Do not hang objects from the indoor unit.
- Do not set flower vases or water containers on top of air conditioners.
- Do not expose the air conditioner directly to water.
- Do not operate the air conditioner with wet hands.
- Do not pull the power supply cord.
- Turn off the power source when not using the unit for extended periods.
- Check the condition of the installation stands for damage.
- Do not place animals or plants in the direct path of the airflow.
- Do not drink the water drained from the air conditioner.
- Do not use it in applications involving the storage of foods, plants or animals, precision equipment, or artworks.
- Connection valves become hot during Heating; handle them with care.
- Do not apply any heavy pressure to the radiator fins.
- Operate only with air filters installed.
- Do not block or cover the intake grille and outlet port.
- Ensure that any electronic equipment is at least one meter away from either the indoor or outdoor units.
- Avoid installing the air conditioner near a fireplace or other heating apparatus.
- When installing indoor and outdoor units, take precautions to prevent access to infants.
- Do not use inflammable gases near the air conditioner.
- This appliance is not intended for use by persons (including children) with reduced physical, sensory, or mental capabilities, or lack of experience and knowledge unless they have been given supervision or instruction concerning use of the appliance by a person responsible for their safety. Children should be supervised to ensure that they do not play with the appliance.

FEATURES AND FUNCTIONS

INVERTER

At the start of the operation, a large power is used to bring the room quickly to the desired temperature. Afterward, the unit automatically switches to a low power setting for economic and comfortable operation.

COIL DRY OPERATION

The Indoor unit can be dried by pressing the COIL DRY button on the Remote Controller so as to avoid going moldy and restrain the breed of the bacterium.

AUTO CHANGEOVER

The operation mode (cooling, drying, heating) is switched automatically to maintain the set temperature, and the temperature is kept constant at all times.

PROGRAM TIMER

The program timer allows you to integrate OFF timer and ON timer operations in a single sequence. The sequence can involve one transition from OFF timer to ON timer, or from ON timer to OFF timer, within a twenty-four-hour period.

SLEEP TIMER

When the SLEEP button is pressed during the Heating mode, the air conditioner's thermostat setting is gradually

lowered during the period of operation; during the cooling mode, the thermostat setting is gradually raised during the period of operation. When the set time is reached, the unit automatically turns off.

WIRELESS REMOTE CONTROLLER

The Wireless Remote Controller allows convenient control of the air conditioner operation.

HORIZONTAL AIRFLOW: COOLING/ DOWNWARD AIRFLOW: HEATING

For cooling, use horizontal airflow so the cool air does not blow directly on the occupants in the room. For heating, use downward airflow to send powerful, warm air to the floor and create a comfortable environment.

WIRED REMOTE CONTROLLER (OPTION)

The optional wired remote controller (model No. : UTB-YUD) can be used. When you use a remote controller, there are following different points as compared with using a wireless remote controller.

[The additional functions for wired remote controller]

- Weekly timer
- Temperature setback timer
- [The restricted functions for wired remote controller]
- ECONOMY
- MAINTENANCE
- THERMO SENSOR

And you can't use both wired remote controller and wireless remote controller simultaneously. (Only one kind can be selected)

OMNI-DIRECTIONAL AIR FLOW (SWING OPERATION)

Three-dimensional control over air direction swing is possible through the dual use of both a UP/DOWN air direction swing and a RIGHT/LEFT air direction swing. Since UP/DOWN air direction flaps operate automatically according to the operating mode of the unit, it is possible to set air direction based on the operating mode.

REMOVABLE OPEN PANEL

The indoor unit's Open Panel can be removed for easy cleaning and maintenance.

MILDEW-RESISTANT FILTER

The AIR FILTER has been treated to resist mildew growth, thus allowing cleaner use and easier care.

SUPER QUIET OPERATION

When the FAN CONTROL button is used to select QUIET, the unit begins super-quiet operation; the indoor unit's airflow is reduced to produce quieter operations.

POLYPHENOL CATECHIN AIR CLEANING FILTER

The polyphenol catechin air cleaning filter uses static electricity to clean the air of fine particles and dust such as tobacco smoke and plant pollen that are too small to see. The filter contains catechin, which is highly effective against various bacteria by suppressing the growth of the bacteria adsorbed by the filter. Note that when the air cleaning filter is installed, the amount of air produced decreases, causing a slight decrease in the air conditioner's performance.

NEGATIVE AIR IONS DEODORIZING FILTER

It comprises pottery super microparticles, which can produce negative air ions having the effect of deodorizing and can absorb and remit the peculiar smell at home

NAME OF PARTS

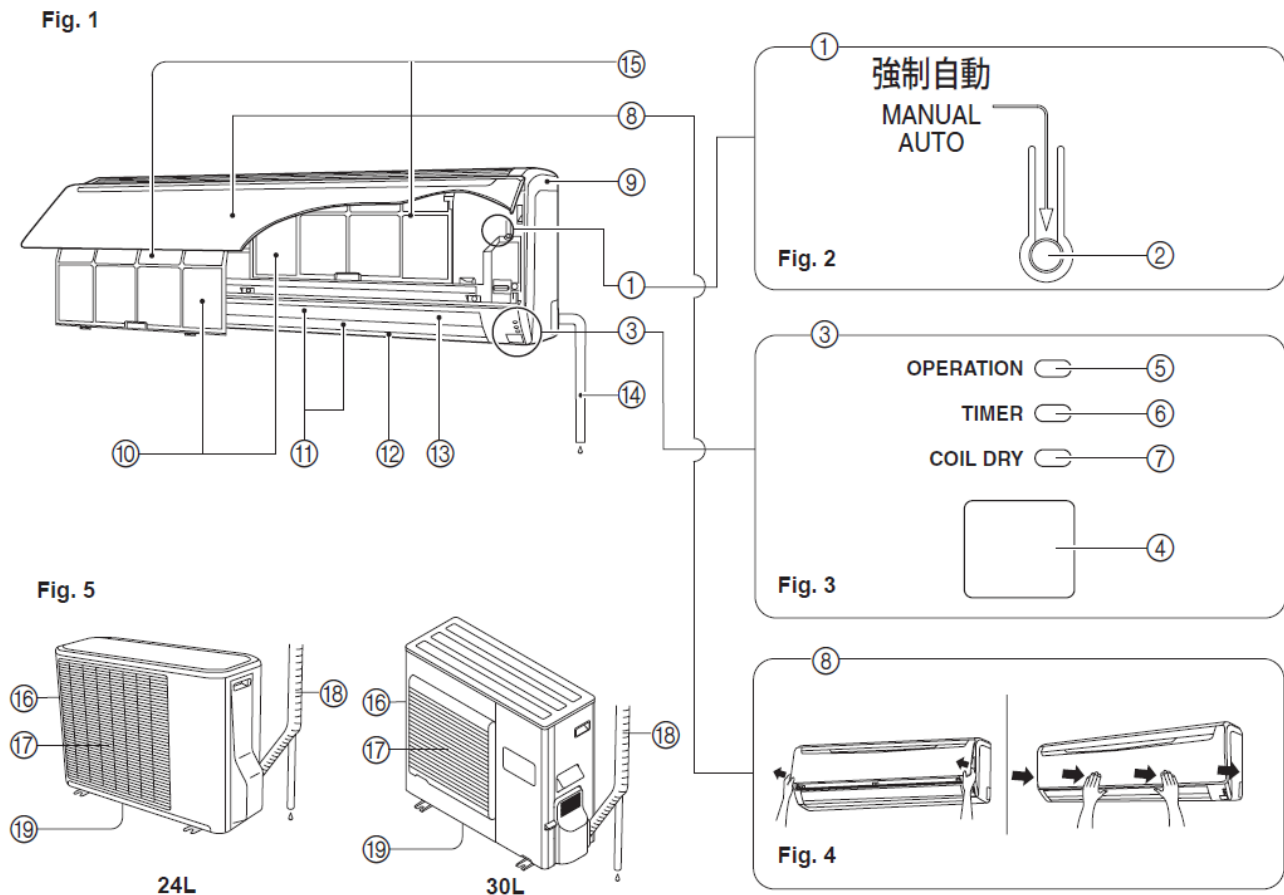

Fig. 7

To facilitate explanation, the accompanying illustration has been drawn to show all possible indicators; in actual operation, however, the display will only show those indicators appropriate to the current operation.

Fig. 1 Indoor Unit

1. Operating Control Panel (Fig. 2)

2. MANUAL AUTO button

- When kept on pressing the MANUAL AUTO button for more than 10 seconds, the forced cooling operation will start.
- The forced cooling operation is used at the time of installation.
- Only for authorized service personnel's use.
- When the forced cooling operation starts by any chance, press the START/STOP button to stop the operation.

3. Indicator (Fig. 3)

4. Remote Control Signal Receiver

5. OPERATION Indicator Lamp (red)





6. TIMER Indicator Lamp (green)

- If the TIMER indicator lamp flashes when the timer is operating, it indicates that a fault has occurred with the timer setting (See Page 15 Auto Restart).

7. COIL DRY Indicator Lamp (orange)

8. Intake Grille (Fig. 4)

9. Front Panel

- Air Filter
- An Air Flow Direction Louver
- Power Diffuser
- Right-Left Louver (behind Air Flow Direction Louver)
- Drain Hose
- Air Cleaning Filter
- Flg. 5 Outdoor Unit
- Intake Port
- Outlet Port
- Pipe Unit
- Drain port (bottom)
- Fig. 6 Remote Controller
- SLEEP button
- MASTER CONTROL button
- SET TEMP. button ( / )
- COIL DRY button
- Signal Transmitter
- TIMER MODE button
- TIMER SET ( / ) button
- FAN CONTROL button
- START/STOP button
- SET button (Vertical)
- SET button (Horizontal)
- SWING button
- RESET button
- TEST RUN button

This button is used when installing the conditioner, and should not be used under normal conditions, as it will cause the air conditioner's thermostat function to operate incorrectly. If this button is pressed during normal operation, the unit will switch to test operation mode, and the Indoor Unit's OPERATION Indicator lamp and TIMER Indicator Lamp will begin to flash simultaneously. To stop the test operation mode, press the START/STOP button to stop the air conditioner.

- CLOCK ADJUST button
- Remote Controller Display (Fig. 7)

Fig. 6

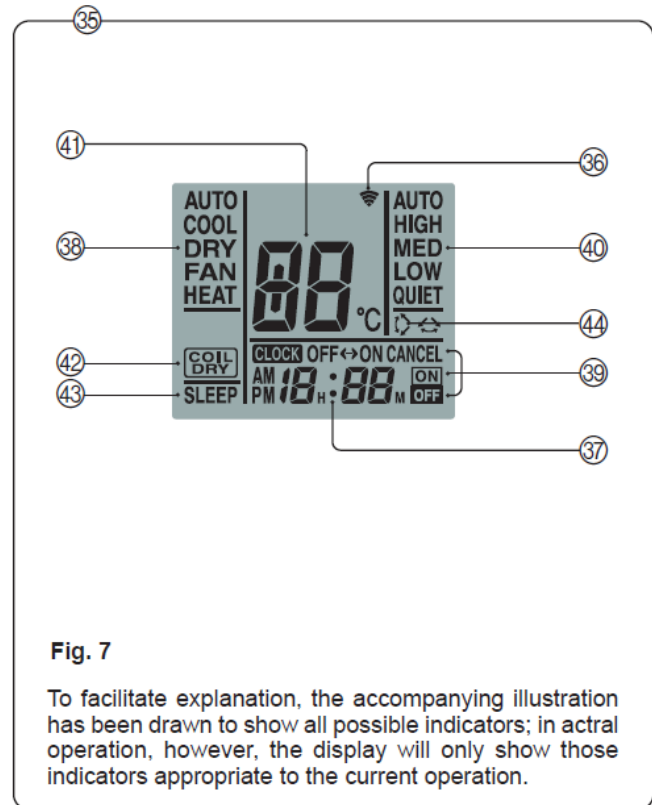
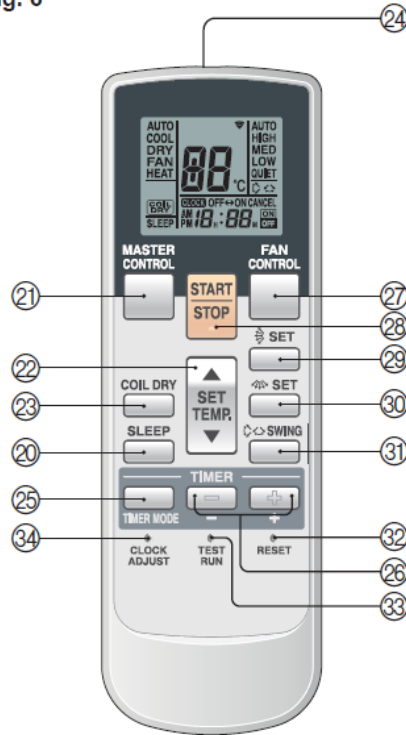

Fig. 7

To facilitate explanation, the accompanying illustration has been drawn to show all possible indicators; in actual operation, however, the display will only show those indicators appropriate to the current operation.

- Transmit Indicator
- Clock Display
- Operating Mode Display
- Timer Mode Display
- Fan Speed Display
- Temperature SET Display
- COIL DRY Display
- SLEEP Display
- SWING Display

PREPARATION



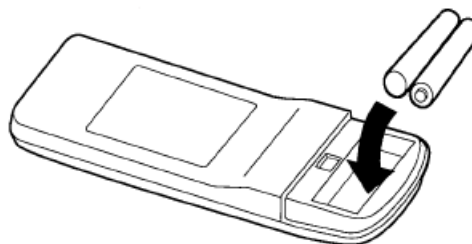

Load Batteries (Size AAA R03/LR03 × 2)

1. Press and slide the battery compartment lid on the reverse side to open it. Slide in the direction of the arrow while pressing the mark. Batteries are not included in this product.



2. Insert batteries. Be sure to align the battery \oplus/\ominus polarities () correctly.
3. Close the battery compartment lid.

Set the Current time

1. Press the CLOCK ADJUST button (Fig. 6 X). Use the tip of a ballpoint pen or other small object to press the button.
2. Use the TIMER SET ( / ) buttons (Fig. 6 P) to adjust the clock to the current time.  button: Press to advance the time.  button: Press to reverse the time. (Each time the buttons are pressed, the time will be advanced/reversed in one-minute increments; hold the buttons depressed to change the time quickly in ten-minute increments.)
3. Press the CLOCK ADJUST button (Fig. 6 X) again. This completes the time setting and starts the clock.

To Use the Remote Controller

- The Remote Controller must be pointed at the signal receiver (Fig. 1 4) to operate correctly.
- Operating Range: About 7 meters.
- When a signal is properly received by the air conditioner, a beeping sound will be heard.
- If no beep is heard, press the Remote Controller button again.

Remote Controller Holder

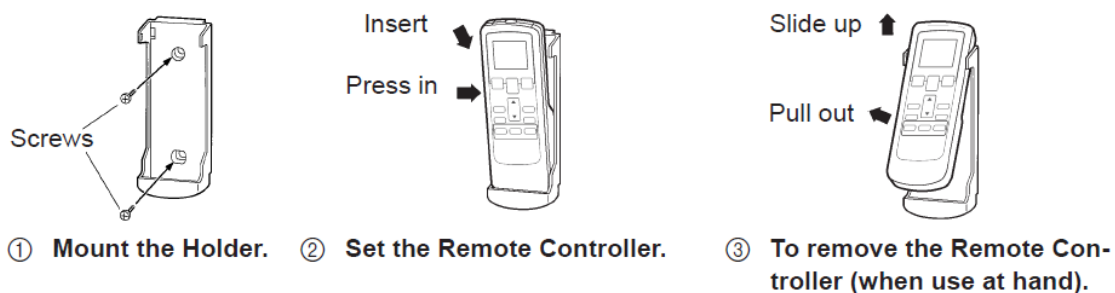

CAUTION!

- Take care to prevent infants from accidentally swallowing batteries.
- When not using the Remote Controller for an extended period, remove the batteries to avoid possible leakage and damage to the unit.
- If leaking battery fluid comes in contact with your skin, eyes, or mouth, immediately wash with copious amounts of water, and consult your physician.
- Dead batteries should be removed immediately and disposed of properly, either in a battery collection receptacle or to the appropriate authority.
- Do not attempt to recharge dry batteries. Never mix new and used batteries or batteries of different types.
- Batteries should last about one year under normal use. If the Remote Controller's operating range becomes appreciably reduced, replace the batteries, and press the RESET button with the tip of a ballpoint pen or another small object.

OPERATION

To Select Mode Operation

1. Press the START/STOP button (Fig.6 R).

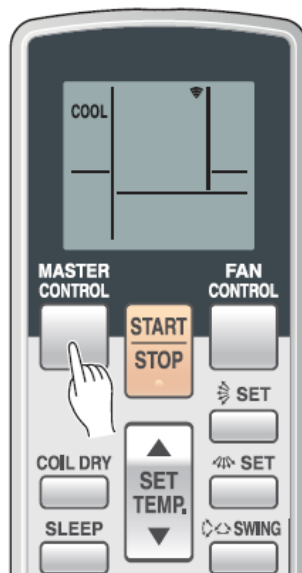

2. The indoor unit's OPERATION Indicator Lamp (red) (Fig. 3 5) will light. The air conditioner will start operating.



3. Press the MASTER CONTROL button (Fig.6 K) to select the desired mode. Each time the button is pressed, the mode will change in the following order.

About three seconds later, the entire display will reappear.

To Set the Thermostat

Press the SET TEMP. button (Fig. 6 L). button: Press to raise the thermostat setting. button: Press to lower the thermostat setting.

Thermostat setting range



- AUTO18-30 °C
- Heating16-30 °C
- Cooling/Dry18-30 °C

The thermostat cannot be used to set room temperature during the FAN mode (the temperature will not appear on the Remote Controller's Display). About three seconds later, the entire display will reappear. The thermostat setting should be considered a standard value and may differ somewhat from the actual room temperature

To Set the Fan Speed

Press the FAN CONTROL button (Fig. 6 Q). Each time the button is pressed, the fan speed changes in the following order: About three seconds later, the entire display will reappear.

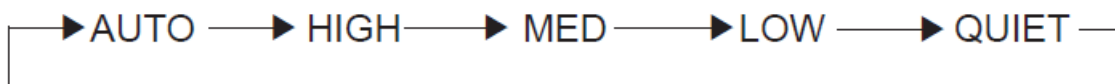

When set to AUTO

- Heating: The fan operates so as to optimally circulate warmed air.

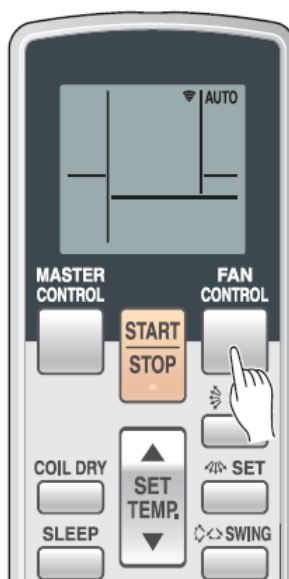

Example: When set to AUTO.

- However, the fan will operate at a very low speed when the temperature of the air issued from the indoor unit is low.

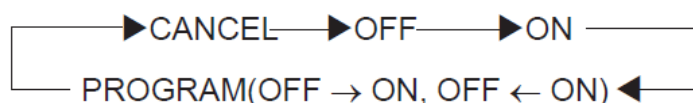

- Cooling: As the room temperature approaches that of the thermostat setting, the fan speed becomes slower.
- Fan: The fan runs at a low fan speed.
- The fan will operate at a very low setting during Monitor operation and at the start of the Heating mode.

SUPER QUIET Operation

When set to Quiet

SUPER QUIET operation begins. The indoor unit's airflow will be reduced for quieter operation.

- The SUPER QUIET operation cannot be used during Dry mode. (The same is true when the dry mode is selected during AUTO mode operation.)
- During Super Quiet operation, Heating and Cooling performance will be reduced somewhat.
- If the room does not warm up/ cool down when using SUPER QUIET Operation, please adjust the air

conditioner's Fan Speed.

To Stop Operation

Press the START/STOP button (Fig. 6 R). The OPERATION Indicator Lamp (red) (Fig. 3 5) will go out.

About AUTO CHANGEOVER Operation

AUTO: When AUTO CHANGEOVER operation is first selected, the fan will operate at a very low speed for about one minute, during which time the unit detects the room conditions and selects the proper operating mode. If the difference between the thermostat setting and the actual room temperature is more than $+2\text{ }^{\circ}\text{C}$ → Cooling or dry operation If the difference between the thermostat setting and the actual room temperature is within $\pm 2\text{ }^{\circ}\text{C}$ → Monitor operation If the difference between the thermostat setting and the actual room temperature is more than $-2\text{ }^{\circ}\text{C}$ → Heating operation

- When the air conditioner has adjusted your room's temperature to near the thermostat setting, it will begin monitor operation. In the monitor operation mode, the fan will operate at a low speed. If the room temperature subsequently changes, the air conditioner will once again select the appropriate operation (Heating, Cooling) to adjust the temperature to the value set in the thermostat. (The monitor operation range is $\pm 2\text{ }^{\circ}\text{C}$ relative to the thermostat setting.)
- If the mode automatically selected by the unit is not what you wish, select one of the mode operations (HEAT, COOL, DRY, FAN).

About Mode Operation

Heating: Use to warm your room.

- When the Heating mode is selected, the air conditioner will operate at a very low fan speed for about 3 to 5 minutes, after which it will switch to the selected fan setting. This period of time is provided to allow the indoor unit to warm up before beginning full operation.
- When the room temperature is very low, frost may form on the outside unit, and its performance may be reduced. In order to remove such frost, the unit will automatically enter the defrost cycle from time to time. During Automatic
- During the defrosting operation, the OPERATION Indicator Lamp (Fig. 3 5) will flash, and the heat operation will be interrupted.
- After the start of the heating operation, it takes some time before the room gets warmer.

Cooling: Use to cool your room.

Dry: Use for gentle cooling while dehumidifying your room.

- You cannot heat the room during Dry mode.
- During Dry mode, the unit will operate at low speed; in order to adjust room humidity, the indoor unit's fan may stop from time to time. Also, the fan may operate at a very low speed when adjusting room humidity.
- The fan speed cannot be changed manually when Dry mode has been selected.
- Fan: Use to circulate the air throughout your room

During Heating mode

Set the thermostat to a temperature setting that is higher than the current room temperature. The Heating mode will not operate if the thermostat is set lower than the actual room temperature.

During Cooling/Dry mode

Set the thermostat to a temperature setting that is lower than the current room temperature. The Cooling and Dry modes will not operate if the thermostat is set higher than the actual room temperature (in Cooling mode, the fan alone will operate).

During Fan mode

You can not use the unit to heat and cool your room

TIMER OPERATION



Before using the timer function, be sure that the Remote Controller is set to the correct current time (P. 5).

To Use the ON timer or OFF timer

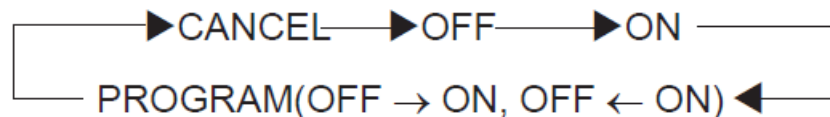
1. Press the START/STOP button (Fig. 6 R) (if the unit is already operating, proceed to step 2). The indoor unit's OPERATION Indicator Lamp (red) (Fig. 3 5) will light.
2. Press the TIMER MODE button (Fig. 6 O) to select the OFF timer or ON timer operation. Each time the button is pressed the timer function changes in the following order

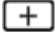

Use the TIMER SET buttons (Fig. 6 P) to adjust the desired OFF time or ON time. Set the time while the time display is flashing (the flashing will continue for about five seconds).

-  button: Press to advance the time.
-  button: Press to reverse the time.

About five seconds later, the entire display will reappear

To Use the Program timer

1. Press the START/STOP button (Fig. 6 R). (if the unit is already operating, proceed to step 2). The indoor unit's OPERATION Indicator Lamp (red) (Fig. 3 5) will light.
2. Set the desired times for the OFF timer and ON timer. See the section "To Use the ON timer or OFF timer" to set the desired mode and times. About three seconds later, the entire display will reappear. The indoor unit's TIMER Indicator Lamp (green) (Fig. 3 6) will light.
3. Press the TIMER MODE button (Fig. 6 O) to select the PROGRAM timer operation (OFF ON or OFF ON will display).

The display will alternately show "OFF timer" and "ON timer", then change to show the time set for the operation to occur first.

- The program timer will begin operation. (If the ON timer has been selected to operate first, the unit will stop operating at this point.)
- About five seconds later, the entire display will reappear.

About the Program timer

- The program timer allows you to integrate OFF timer and ON timer operations in a single sequence. The sequence can involve one transition from OFF timer to ON timer, or from ON timer to OFF timer, within a twenty-four hour period.
- The first timer function to operate will be the one set nearest to the current time. The order of operation is indicated by the arrow in the Remote Controller's Display (OFF → ON, or OFF ← ON).
- One example of Program timer use might be to have the air conditioner automatically stop (OFF timer) after you go to sleep, then start (ON timer) automatically in the morning before you arise

To Cancel the Timer

Use the TIMER button to select "CANCEL". The air conditioner will return to normal operation. To Change the Timer Settings Perform steps 2 and 3. To Stop Air Conditioner Operation while the Timer is Operating Press the START/STOP button. To Change Operating Conditions If you wish to change operating conditions (Mode, Fan Speed, Thermostat Setting, SUPER QUIET mode), after making the timer setting wait until the entire display reappears, then press the appropriate buttons to change the operating condition desired.

To Use the Program timer

1. Press the START/STOP button (Fig. 6 R). (if the unit is already operating, proceed to step 2). The indoor unit's OPERATION Indicator Lamp (red) (Fig. 3 5) will light.
2. Set the desired times for the OFF timer and ON timer. See the section "To Use the ON timer or OFF timer" to set the desired mode and times. About three seconds later, the entire display will reappear. The indoor unit's TIMER Indicator Lamp (green) (Fig. 3 6) will light.
3. Press the TIMER MODE button (Fig. 6 O) to select the PROGRAM timer operation (OFF ON or OFF ON will display).

The display will alternately show "OFF timer" and "ON timer", then change to show the time set for the operation to occur first.

- The program timer will begin operation. (If the ON timer has been selected to operate first, the unit will stop operating at this point.) About five seconds later, the entire display will reappear. About the Program timer
- The program timer allows you to integrate OFF timer and ON timer operations in a single sequence. The sequence can involve one transition from OFF timer to ON timer, or from ON timer to OFF timer, within a twenty-four hour period.
- The first timer function to operate will be the one set nearest to the current time. The order of operation is indicated by the arrow in the Remote Controller's Display (OFF → ON, or OFF ← ON).
- One example of Program timer use might be to have the air conditioner automatically top (OFF timer) after you go to sleep, then start (ON timer) automatically in the morning before you arise

To Cancel the Timer

Use the TIMER MODE button to select "CANCEL". The air conditioner will return to normal operation.
To Change the Timer Settings

1. Follow the instructions given in the section "To Use the ON Timer or OFF Timer" to select the timer setting you wish to change.
2. Press the TIMER MODE button to select either OFF ON or OFF ON. To Stop Air Conditioner Operation while the Timer is Operating Press the START/STOP button. To Change Operating Conditions

- If you wish to change operating conditions (Mode, Fan Speed, Thermostat Setting, SUPER QUIET mode), after making the timer setting wait until the entire display reappears, then Press the appropriate buttons to change the operating condition desired.



SLEEP TIMER OPERATION

Unlike other timer functions, the SLEEP timer is used to set the length of time until the air conditioner operation is stopped.

To Use the SLEEP Timer

While the air conditioner is operating or stopped, press the SLEEP button (Fig. 6 J). The indoor unit's OPERATION Indicator Lamp (red) (Fig. 3 5) lights and the TIMER Indicator Lamp (green) (Fig. 3 6) light.

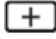
To Change the Timer Settings

Press the SLEEP button (Fig. 6 J) once again and set the time using the TIMER SET ( / ) buttons (Fig. 6 P). Set the time while the Timer Mode Display is flashing (the flashing will continue about

To Cancel the Timer

Use the TIMER MODE button to select "CANCEL". The air conditioner will return to normal operation.

To Stop the Air Conditioner During

Timer Operation: Press the START/STOP button.

About the SLEEP Timer

To prevent excessive warming or cooling during sleep, the SLEEP timer function automatically modifies the thermostat setting in accordance with the set setting. When the set time has elapsed, the air conditioner completely stops.

During Heating operation

When the SLEEP timer is set, the thermostat setting is automatically lowered 1 °C every thirty minutes. When the thermostat has been lowered a total of 4 °C, the thermostat setting at that time is maintained until the set time has elapsed, at which time the air conditioner automatically turns off

During Cooling/Dry operation

When the SLEEP timer is set, the thermostat setting is automatically raised 1 °C every sixty minutes. When the thermostat has been raised a total of 2 °C, the thermostat setting at that time is maintained until the set time has elapsed, at which time the air conditioner automatically turns off.

m

SLEEP timer setting

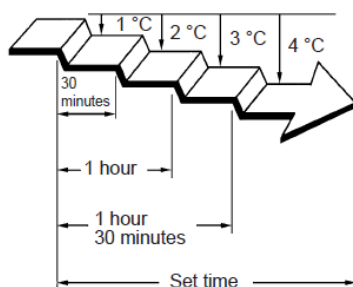

SLEEP timer setting

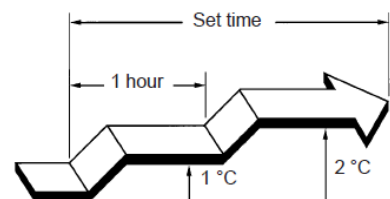

MANUAL AUTO OPERATION

Use the MANUAL AUTO operation in the event the Remote Controller is lost or otherwise unavailable.

How To Use the Main Unit Controls

Press the MANUAL AUTO button (Fig. 2 2) on the main unit control panel. To stop the operation, press the MANUAL AUTO button (Fig. 2 2) once again. (Controls are located inside the Open Panel)

- When the air conditioner is operated with the controls on the Main Unit, it will operate under the same mode as the AUTO the mode selected on the Remote Controller (see page 7).
- The fan speed selected will be "AUTO" and the thermostat setting will be standard.(24°C)

ADJUSTING THE DIRECTION OF AIR CIRCULATION

- Adjust the up, down, left, and right AIR directions with the AIR DIRECTION buttons on the Remote Controller.
- Use the AIR DIRECTION buttons after the Indoor Unit has started operating and the airflow-direction louvers have stopped moving.

Vertical Air Direction Adjustment

Press the SET button (Vertical) (Fig. 6 S). Each time the button is pressed, the air direction range will change as follows:

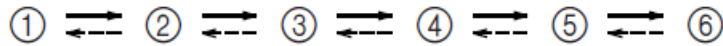

Types of Air Flow Direction Setting:

1,2,3: During Cooling/Dry modes 4,5,6: During Heating mode The Remote Controller's display does not change Use the air direction adjustments within the ranges shown above.

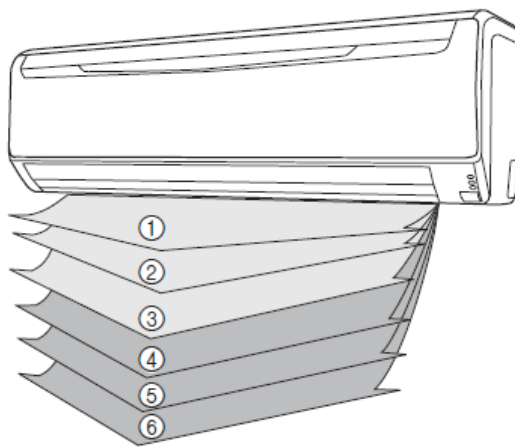

- The vertical airflow direction is set automatically as shown, in accordance with the type of operation selected.
- During Cooling/Dry mode: Horizontal flow 1
- During Heating mode: Downward flow 5
- During AUTO mode operation, for the first minute after beginning operation, airflow will be horizontal 1; the air direction cannot be adjusted during this period.
- Direction 1 2
- Only the direction of the Air Flow Direction Louver changes; the direction of the Power Diffuser does not change.

DANGER!

- Never place fingers or foreign objects inside the outlet ports, since the internal fan operates at high speed and

could cause personal injury.

- Always use the Remote Controller's SET button to adjust the vertical airflow louvers. Attempting to move them manually could result in improper operation; in this case, stop the operation and restart. The louvers should begin to operate properly again.
- During the use of the Cooling and Dry modes, do not set the Air Flow Direction Louvers in the Heating range (4 – 6) for long periods of time, since water vapor may condense near the outlet louvers and drops of water may drip from the air conditioner. During the Cooling and Dry modes, if the Air Flow Direction Louvers are left in the heating range for more than 30 minutes, they will automatically return to position 3.
- When used in a room with infants, children, elderly or sick persons, the air direction and room temperature should be considered carefully when making settings

Horizontal Air Direction Adjustment

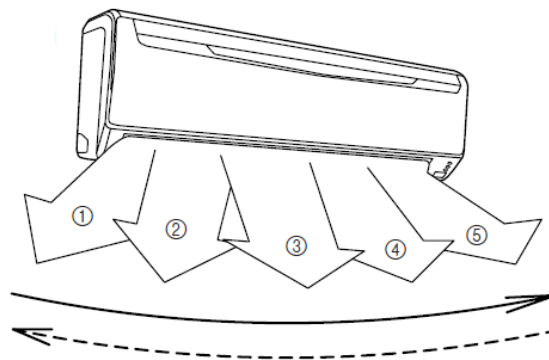

Press the SET button (Horizontal)(Fig. 6 T). Each time the button is pressed, the air direction range will change as follows: The remote controller's display does not change.



SWING OPERATION

Begin air conditioner operation before performing this procedure

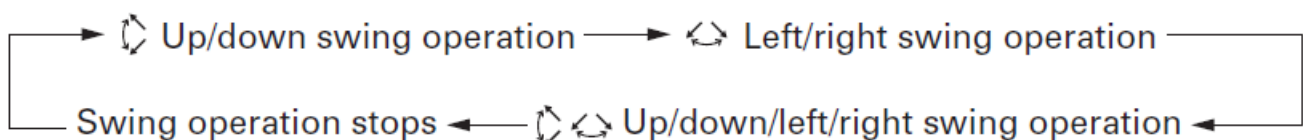

To select SWING Operation

Press the SWING button (Fig. 6 U). The SWING Display (Fig. 7 d) will light. Each time the SWING button is pressed, the swing operation will change in the following order.

To stop SWING Operation

Press the SWING button and select STOP. Airflow direction will return to the setting before the swing was begun

About Swing Operation

- Up/down swing: Swing operation begins using the following range according to the current airflow direction.
- Airflow direction is 1–4 (for cooling, and drying). With the upper airflow direction louver in the horizontal position, the lower airflow direction louver moves (swings) to direct airflow to a wide area.
- Airflow direction is 3–6 (for heating).
- With the airflow direction louvers set for downward or straight-down airflow, airflow is directed mainly at the floor. Left/right swing: The airflow direction louvers move (swing) in the left/right airflow direction.
- Up/down/left/right swing: The airflow direction louvers move (swing) in both the up/down and left/right airflow directions.
- The SWING operation may stop temporarily when the air conditioner's fan is not operating, or when operating at very low speeds.
- If the SET button(Vertical) is pressed during the up/down swing operation, the up/down swing operation will stop and if the SET button(Horizontal) is pressed during the left/right swing operation, the left/right swing operation will stop.

COIL DRY OPERATION

The Indoor unit can be dried by pressing the COIL DRY button on the Remote Controller so as to avoid going moldy and restrain the breed of the bacterium. The COIL DRY Operation will operate for 20 minutes after pressing the COIL DRY button and it will stop automatically. To select COIL DRY Operation Press the COIL DRY button (Fig. 6 M) during operation or when it stops. The COIL DRY Display (Fig. 7 b) will light. Then it will disappear after 20 minutes. To cancel COIL DRY Operation Press the START/STOP button (Fig. 6 R) during COIL DRY Operation. The COIL DRY Display (Fig. 7 b) will go out. Then the operation stops.

About COIL DRY Operation

Press the COIL DRY button again during COIL DRY Operation, and COIL DRY Operation can be reset. The COIL DRY Operation cannot get rid of the existing mold or bacterium, and it has no sterilization effect either.

CLEANING AND CARE

- Before cleaning the air conditioner, be sure to turn it off and disconnect the Power Supply Cord.
- Be sure the Intake Grille (Fig. 1 8) is installed securely.
- When removing and replacing the air filters, be sure not to touch the heat exchanger, as personal injury may result. To avoid excessive wear of the part and components or malfunctioning of the air conditioning, the user/consumer shall perform preventive maintenance through an accredited technical assistance, periodically. To know the preventive maintenance periodicity, the consumer shall check with the accredited installer or an accredited technical assistant.
- When used for extended periods, the unit may accumulate dirt inside, reducing its performance. We recommend that the unit be inspected regularly, in addition to your own cleaning and care. For more information, consult authorized service personnel.
- It is recommended for the user/consumer to demand a copy of the Work Order every time there is a visit of a technical assistant for verification, maintenance, testing or repair of the product.
- When cleaning the unit's body, do not use water hotter than 40 °C, harsh abrasive cleansers, or volatile agents like benzene or thinner.
- Do not expose the unit's body to liquid insecticides or hairsprays.
- When shutting down the unit for one month or more, first allows the fan mode to operate continuously for about one-half day to allow internal parts to dry thoroughly

Cleaning the Intake Grille

1. Remove the Intake Grille.
2. Place your fingers at both lower ends of the grille panel, and lift forward; if the grille seems to catch partway through its movement, continue lifting upward to remove.
3. Pull past the intermediate catch and open the Intake Grille wide so that it becomes horizontal.

Clean with water.

Remove dust with a vacuum cleaner; wipe the unit with warm water, then dry with a clean, soft cloth.

Replace the Intake Grille.

1. Pull the knobs all the way.
2. Hold the grille horizontally and set the left and right mounting shafts into the bearings at the top of the panel.
3. Press the place where the arrow on the diagram indicates and close the Intake Grille

Cleaning the Air Filter

1. Open the Intake Grille, and remove the air filter.
2. Lift up the air filter's handle, disconnect the two lower tabs, and pull out.
3. Air filter handle

Remove dust with a vacuum cleaner or by washing

After washing, allow to dry thoroughly in a shaded place. Replace the Air Filter and close the Intake Grille.

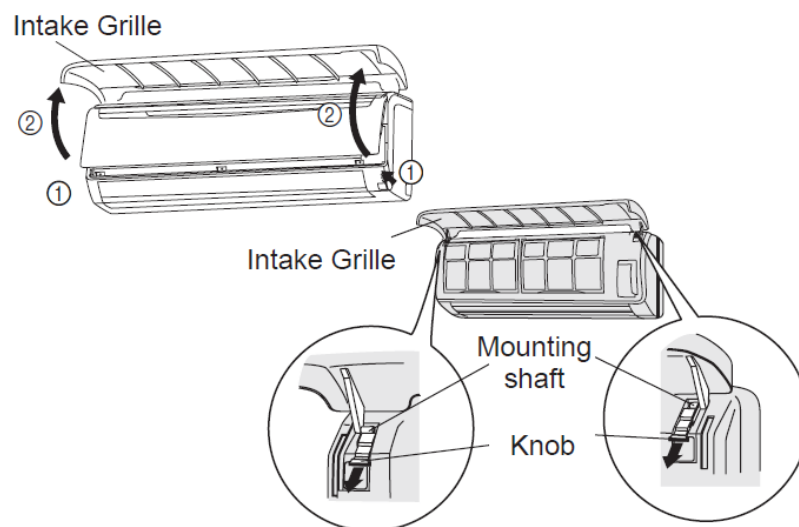

1. Align the sides of the air filter with the panel, and push in fully, making sure the two lower tabs are returned properly to their holes in the panel. Hooks (two places)
2. Close the Intake Grille.

(For purposes of example, the illustration shows the unit without Intake Grille installed.)

- Dust can be cleaned from the air filter either with a vacuum cleaner or by washing the filter in a solution of mild

detergent and warm water. If you wash the filter, be sure to allow it to dry thoroughly in a shady place before reinstalling it.

- If dirt is allowed to accumulate on the air filter, air flow will be reduced, lowering operating efficiency and increasing noise.
- During periods of normal use, the Air Filters should be cleaned every two weeks.

Air Cleaning Filter Installation

1. Open the Intake Grille and remove the Air filters.
2. Install the Air cleaning filter set (set of 2).
3. Set the air cleaning filter into the air cleaning filter frame.
4. Engage the latch at both ends of the filter with the two hooks at the rear of the air cleaning filter frame. Take care that the air cleaning filter does not project beyond the frame. Engage the four fixing locations at the top and bottom of the air cleaning filter frame with the hooks of the air filter.
5. Install the two Air filters and close the Intake Grille.

When air cleaning filters are used, the effect will be increased by setting the fan speed to “High”.

Replacing dirty Air cleaning filters

Replace filters with the following components (purchased separately).

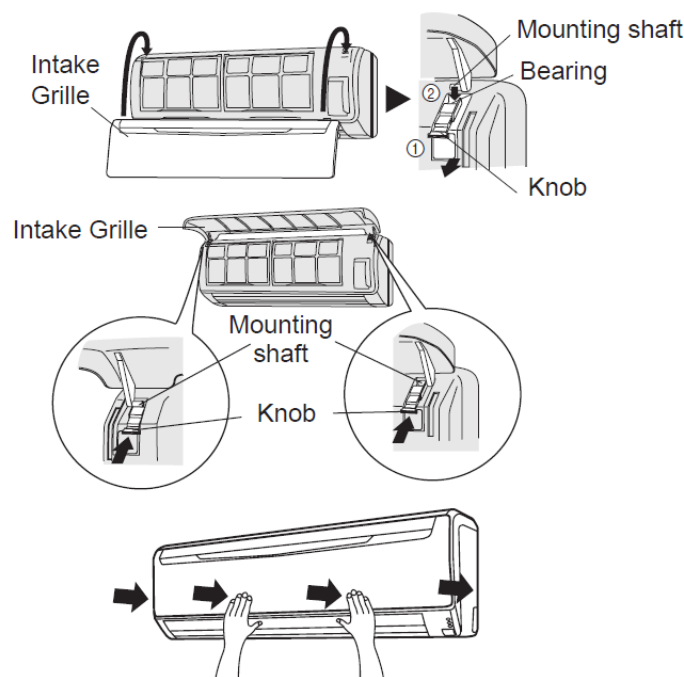

POLYPHENOL CATECHIN AIR CLEANING FILTER: UTR-FA13-1

Negative air ions deodorizing filter: UTR-FA13-2 Open the Intake Grille and remove the Air filters

Air filter handle

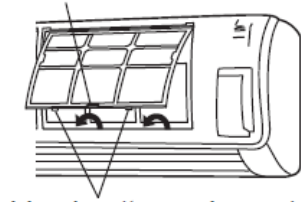

Hooks (two places)

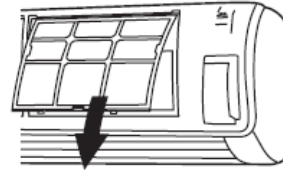

Replace them with two new Air cleaning filters.

1. Remove the old air cleaning filters in reverse order of their installation.

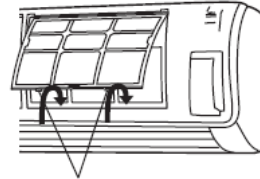
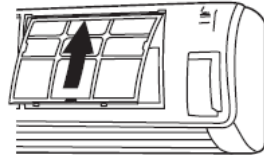

Hooks (two places)

2. install in the same way as for installation of the air cleaning filter set.
3. Install the two Air filters and close the Intake Grille

In regard to the Air Cleaning Filters

POLYPHENOL CATECHIN AIR CLEANING FILTER (one sheet)

- The Air Cleaning Filters are disposable filters. (They can not be washed and reused.)

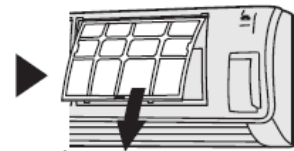
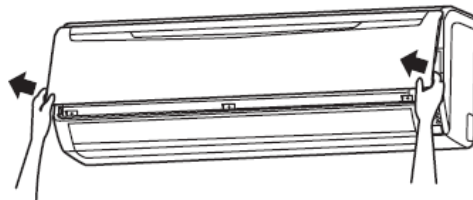

Air Filter
(Right & Left)

- For storage of the Air Cleaning Filters, use the filters as soon as possible after the package has been opened. (The air-cleaning effect decreases when the filters are left in the opened package)
- Generally, the filters should be exchanged about every three months.
- Please buy delicate air cleaning filters (UTR-FA13-1) (Sold separately) to exchange the used dirty air cleaning filters. [Negative air ions deodorizing filter (one sheet) — light blue]
- The filters should be exchanged about every three years so as to maintain the deodorizing effect.

Air cleaning filter set

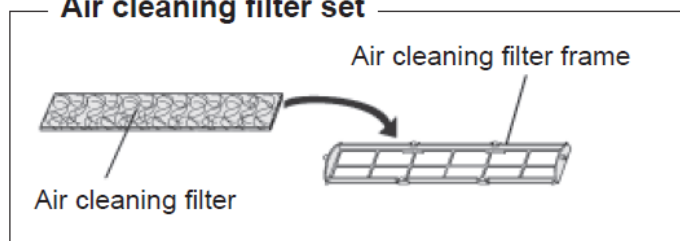

- The filter frame is not a one-off product.

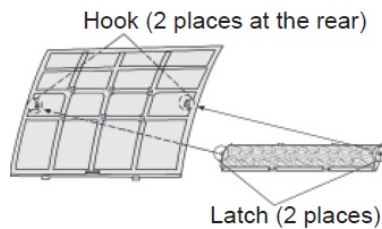

- Please buy a delicate deodorizing filter (UTR-FA13-2) (Sold separately) when exchanging the filters.

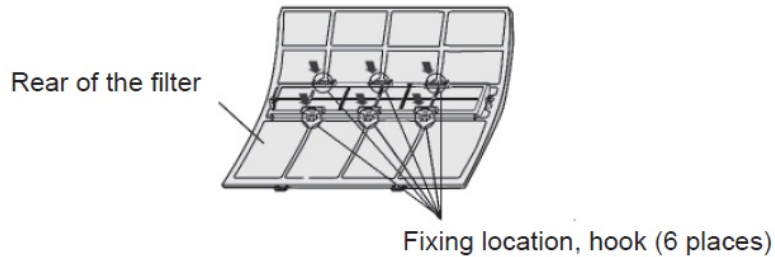

Maintenance of Deodorizing Filters

In order to maintain the deodorizing effect, please clean the filter in the following way once three months.

1. Remove the deodorizing filter.

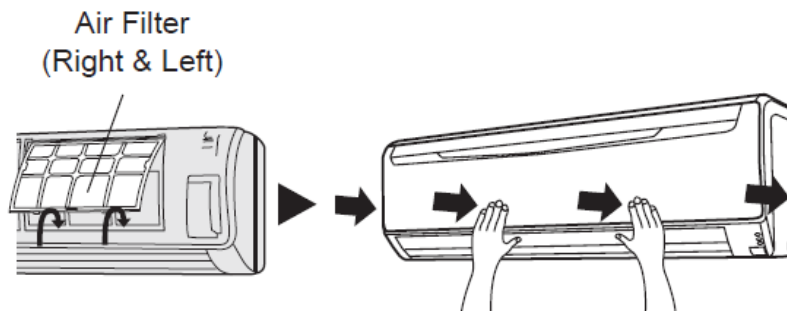

2. Clean with water and dry in the air.
3. Flush the filters with high-pressure hot water until the surface of the filters is covered with water.

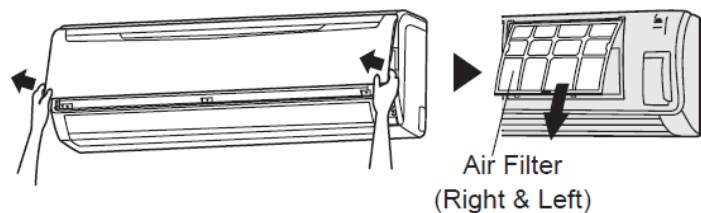

4. Please flush with a diluent neutral detergent. Never wash by reaming or rubbing, otherwise, it will damage the deodorizing effect.
5. Rinse with water flow.

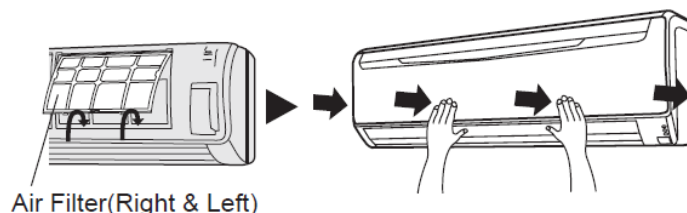

6. Dry in the shade.
7. Reinstall the deodorizing filter.

TROUBLESHOOTING

In the event of a malfunction (burning smell, etc.), immediately stop operation, turn off the electrical breaker or

disconnect the power supply plug, and consult authorized service personnel. Merely turning off the unit's power switch will not completely disconnect the unit from the power source. Always be sure to turn off the electrical breaker or disconnect the power supply plug to ensure that the power is completely off. Before requesting service, perform the following checks: the problem persists after performing these checks, or if you notice burning smells, or both the OPERATION Indicator Lamp (Fig. 3 and the TIMER Indicator Lamp (Fig. 3 6) fl ashes, or only the TIMER Indicator Lamp (Fig. 3 6) fl ashes, immediately stop operation, disconnect the Power Supply, and consult authorized service personnel

	Symptom	Problem	See Page
NORMAL FUNCTION	Doesn't operate immediately:	<ul style="list-style-type: none"> ● If the unit is stopped and then immediately started again, the compressor will not operate for about 3 minutes, in order to prevent fuse blowouts. ● Whenever the Power Supply Plug is disconnected and then reconnected to a power outlet, the protection circuit will operate for about 3 minutes, preventing unit operation during that period. 	—
	Noise is heard:	<ul style="list-style-type: none"> ● During operation and immediately after stopping the unit, the sound of water flowing in the air conditioner's piping may be heard. Also, noise may be particularly noticeable for about 2 to 3 minutes after starting operation (sound of coolant flowing). ● During operation, a slight squeaking sound may be heard. This is the result of minute expansion and contraction of the front cover due to temperature changes. 	—
		<ul style="list-style-type: none"> ● During Heating operation, a sizzling sound may be heard occasionally. This sound is produced by the Automatic Defrosting operation. 	15
	Smells:	<ul style="list-style-type: none"> ● Some smell may be emitted from the indoor unit. This smell is the result of room smells (furniture, tobacco, etc.) which have been taken into the air conditioner. 	—
	Mist or steam are emitted:	<ul style="list-style-type: none"> ● During Cooling or Dry operation, a thin mist may be seen emitted from the indoor unit. This results from the sudden Cooling of room air by the air emitted from the air conditioner, resulting in condensation and misting. 	—
		<ul style="list-style-type: none"> ● During Heating operation, the outdoor unit's fan may stop, and steam may be seen rising from the unit. This is due to Automatic Defrosting operation. 	15

	Symptom	Problem	See Page
NORMAL FUNCTION	Airflow is weak or stops:	<ul style="list-style-type: none"> ● When Heating operation is started, fan speed is temporarily very low, to allow internal parts to warm up. ● During Heating operation, if the room temperature rises above the thermostat setting, the outdoor unit will stop, and the indoor unit will operate at very low fan speed. If you wish to warm the room further, set the thermostat for a higher setting. 	—
		<ul style="list-style-type: none"> ● During Heating operation, the unit will temporarily stop operation (between 7 and 15 minutes) as the Automatic Defrosting mode operates. During Automatic Defrosting operation, the OPERATION Indicator Lamp will flash. 	15
		<ul style="list-style-type: none"> ● The fan may operate at very low speed during Dry operation or when the unit is monitoring the room's temperature. 	6
		<ul style="list-style-type: none"> ● During SUPER QUIET operation, the fan will operate at very low speed. 	6
		<ul style="list-style-type: none"> ● In the monitor AUTO operation, the fan will operate at very low speed. 	6
	Water is produced from the outdoor unit:	<ul style="list-style-type: none"> ● During Heating operation, water may be produced from the outdoor unit due to Automatic Defrosting operation. 	15

	Symptom	Items to check	See Page
CHECK ON CE MORE	Doesn't operate at all:	<ul style="list-style-type: none"> ● Is the Power Supply Plug disconnected its outlet? ● Has there been a power failure? ● Has a fuse blown out, or a circuit breaker been tripped? 	—
		<ul style="list-style-type: none"> ● Is the timer operating? 	8 – 9
	Poor Cooling performance:	<ul style="list-style-type: none"> ● Is the Air Filter dirty? ● Air the air conditioner's intake grille or outlet port blocked? ● Did you adjust the room temperature settings (thermostat) correctly? ● Is there a window or door open? ● In the case of Cooling operation, is a window allowing bright sunlight to enter? (Close the curtains.) ● In the case of Cooling operation, are there heating apparatus and computers inside the room, or are there too many people in the room? 	—
		<ul style="list-style-type: none"> ● Is the unit set for SUPER QUIET operation? 	6
	The unit operates differently from the Remote Controller's setting:	<ul style="list-style-type: none"> ● Are the Remote Controller's batteries dead? ● Are the Remote Controller's batteries loaded properly? 	5

OPERATING TIPS

Operation and Performance

Heating Performance

This air conditioner operates on the heat-pump principle, absorbing heat from outdoor air and transferring that heat indoors. As a result, the operating performance is reduced as outdoor air temperature drops. If you feel that insufficient

heating performance is being produced, we recommend you use this air conditioner in conjunction with another kind of heating appliance. Heat-pump air conditioners heat your entire room by recirculating air throughout the room, with the result that some time may be required after first starting the air conditioner until the room is heated

Microcomputer-controlled Automatic Defrosting

When using the Heating mode under conditions of low outdoor temperature and high humidity, frost may form on the outdoor unit, resulting in reduced operating performance. In order to prevent this kind of reduced performance, this unit is equipped with a Microcomputer-controlled Automatic Defrosting function. If frost forms, the air conditioner will temporarily stop, and the defrosting circuit will operate briefly (for about 7-15 minutes). During Automatic Defrosting operation, the OPERATION Indicator Lamp (red) will flash

AUTO Restart

In the Event of Power Interruption

The air conditioner's power has been interrupted by a power failure. The air conditioner will then restart automatically in its previous mode when the power is restored. Operated by setting before the power failure If a power failure occurs during TIMER operation, the timer will be reset and the unit will begin (or stop) operation at the new time setting. In the event that this kind of timer fault occurs the TIMER Indicator Lamp will flash (see

Page. 4). Use of other electrical appliances (electric shaver, etc.) or nearby use of a wireless radio transmitter may cause the air conditioner to malfunction. In this event, temporarily disconnect the Power Supply Plug, reconnect it, and then use the Remote Controller to resume operation.

Temperature and Humidity Range

	Cooling Mode	Dry Mode	Heating Mode
Outdoor temperature	About -10 to 46 °C	About -10 to 46 °C	About -15 to 24 °C
Indoor temperature	About 18 to 32 °C	About 18 to 32 °C	About 30 °C or less

- If the air conditioner is used under a higher temperature conditioner than those listed, the built-in protection circuit may operate to prevent internal circuit damage. Also, during Cooling and Dry modes, if the unit is used under conditions of lower temperature than those listed above, the heat exchanger may freeze, leading to water leakage and other damage.
- Do not use this unit for any purposes other than the Cooling, Dehumidifying, and air-circulation of rooms in ordinary dwellings.
- If the unit is used for long periods under high-humidity conditions, condensation may form on the surface of the indoor unit, and drip onto the floor or other objects underneath. (About 80% or more).
- If the outdoor temperature is lower than the temperature scope in the list above, in order to keep safety operation of the device, the outdoor unit may stop operation for a certain period of time.

SPECIFICATIONS

MODEL				
	INDOOR UNIT		ASBA24LFC	ASBA30LFC
	OUTDOOR UNIT		AOBR24LFL	AOBR30LFT
TYPE			HEAT & COOL SPLIT TYPE (REVERSE CYCLE)	
POWER			220 V ~ 60 Hz	
COOLING				
	CAPACITY	[k W]	7.03	7.91
		[B T U/ h]	24,000	27,000
	POWER INPUT	[k W]	2.16	2.44
	CURRENT (MAX.)	[A]	9.9 (13.5)	11.2 (17.0)
	ENERGY EFFICIENCY RATIO	[k W/ k W]	3.26	3.24

AIRFLOW	INDOOR UNIT	[m 3/ h]	1,100	1,100
	OUTDOOR UNIT	[m 3/ h]	2,470	3,600
HEATING				
CAPACITY		[kW]	7.91	9.08
		[BTU/h]	27,000	31,000
POWER INPUT		[kW]	2.31	2.77
CURRENT (MAX.)		[A]	10.6 (18.5)	12.7 (19.0)
ENERGY EFFICIENCY RATIO		[kW/kW]	3.42	3.28
AIRFLOW	INDOOR UNIT	[m 3/ h]	1,120	1,150
	OUTDOOR UNIT	[m 3/ h]	2,570	3,600
MAX. PRESSURE		[MPa]	4.12	4.12
REFRIGERANT (R410A)		[kg]	1.65	2.10
DIMENSIONS & WEIGHT (NET)				
INDOOR UNIT				
HEIGHT		[mm]	320	
WIDTH		[mm]	998	
DEPTH		[mm]	228	
WEIGHT		[kg]	14	
OUTDOOR UNIT				

HEIGHT	[m m]	578	830
WIDTH	[m m]	790	900
DEPTH	[m m]	315	330
WEIGHT	[k g]	43	61

FAQS

Q: What are the basic buttons on a Fujitsu air conditioner remote?

A: The basic buttons typically found on a Fujitsu air conditioner remote include Power On/Off, Mode (to switch between cooling, heating, dehumidification, etc.), Temperature Up/Down, Fan Speed, and Timer.

Q: How do I turn on/off the Fujitsu air conditioner using the remote?

A: To turn on the air conditioner, press the Power On button. To turn it off, press the Power Off button. The specific button names may vary depending on the remote model.

Q: How do I adjust the temperature with the Fujitsu remote?

A: Use the Temperature Up and Temperature Down buttons to adjust the desired temperature. Press the Up button to increase the temperature and the Down button to decrease it.

Q: What does the Mode button do on a Fujitsu air conditioner remote?

A: The Mode button allows you to switch between different operating modes of the air conditioner, such as Cool, Heat, Dry, Fan, and Auto. Press the Mode button repeatedly until you reach the desired mode.

Q: How do I change the fan speed using the Fujitsu remote?

A: The Fan Speed button on the remote allows you to adjust the fan speed settings. Pressing the button multiple times will cycle through the available speed options, such as Low, Medium, High, and Auto.

Q: What is the Timer function on a Fujitsu air conditioner remote?

A: The Timer function allows you to set a specific time for the air conditioner to turn on or off automatically. You can program the remote to start or stop the air conditioner after a certain duration or at a particular time.

Q: Are there any additional buttons or features on Fujitsu air conditioner remotes?

A: Some remotes may have additional buttons or features based on the specific model and features of the air conditioner. These can include options like Sleep Mode, Turbo Mode, Swing (to control the direction of airflow), and more. Refer to the user manual for your specific remote model to understand its full capabilities.

Q: How does auto setting work on Fujitsu?

A: When your air conditioner is running in auto mode, it will sense the temperature in the room and then determine if it should operate in cooling or in heating to best achieve the set point you have chosen for the unit.

Q: What is min heat on Fujitsu remote?

A: Starts MIN. HEAT operation that maintains the room temperature at **50 °F (10 °C)** so as to prevent the room temperature to drop too low. When you press the button to start the MIN. HEAT operation, the indoor unit emits 2 short beeps and the ECONOMY indicator (green) turns on.

Q: What is the dry mode on the Fujitsu air conditioner remote?

A: Dry: Use for gentle cooling while dehumidifying your room. You cannot heat the room during Dry mode. During Dry mode, the unit will operate at low speed; in order to adjust room humidity, the indoor unit's fan may stop from time to time.

Download PDF: [Fujitsu Air Conditioner Remote Buttons and Functions Guide](#)

Manuals+