



Fuji Onkyo iA600 WiFi Camera Instruction Manual

[Home](#) » [Fuji Onkyo](#) » Fuji Onkyo iA600 WiFi Camera Instruction Manual 



Instruction Manual



Installation rapide
no-QS-498600-2111

Quick installation guide

You can download the complete operating instructions on <https://www.fujionkyo.com/camera-autonome-498600>

Contents

- [1 Installation](#)
- [2 Technical data](#)
- [3 Documents / Resources](#)
- [4 Related Posts](#)

Installation

This autonomous WiFi camera is designed with a waterproof housing (IP 64 index) allowing you to install it both indoors and outdoors. Before installing it, make sure that your WiFi signal is accessible at the desired location. If the camera is installed outdoors, it is advisable to place it under a shelter in order to improve the quality of the image (raindrops can sometimes impair visibility).

Step 1 : Activating the batteries

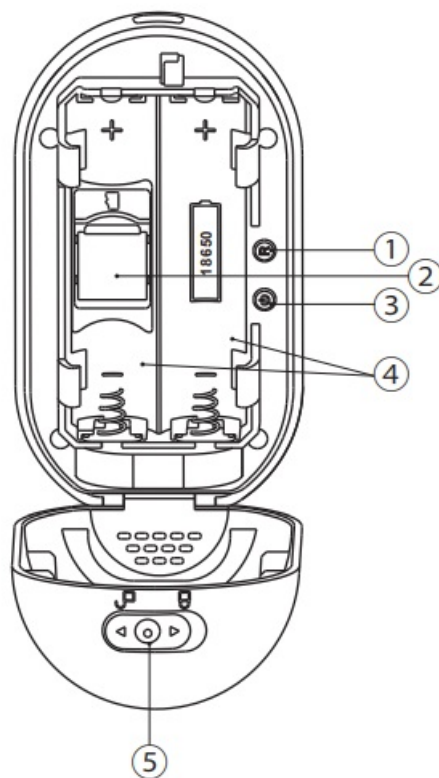

1. Reset button
2. Micro-SD card
3. ON / OFF button
4. Batteries : 2 x 3,7 V / 2600 mAh
5. Lock button/case unlock waterproof

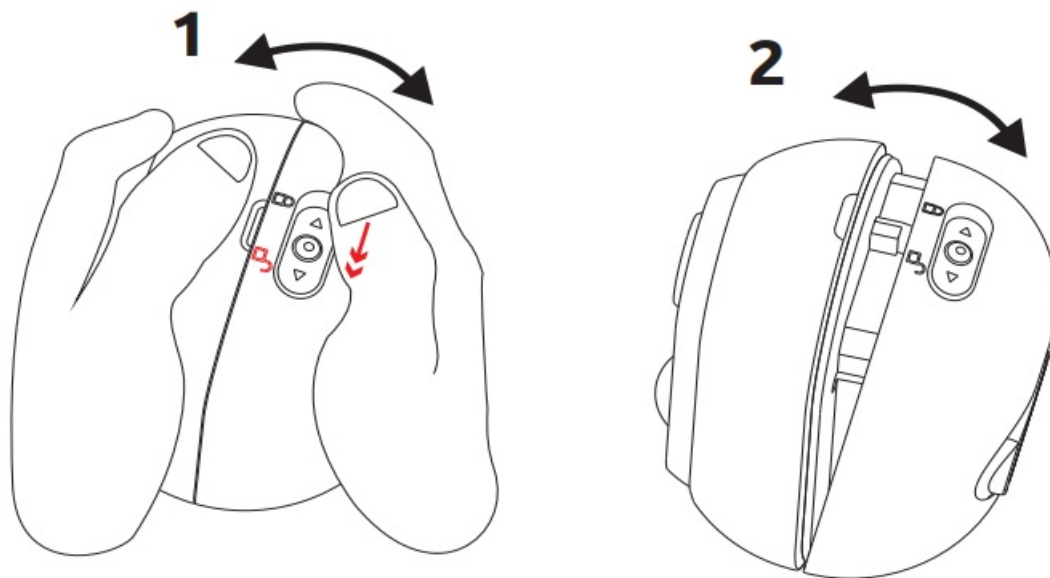

Open the housing and pull the protective tabs to activate the camera batteries.

Step 2 : Recharging the batteries

Please fully charge the camera batteries before installing/using the camera.

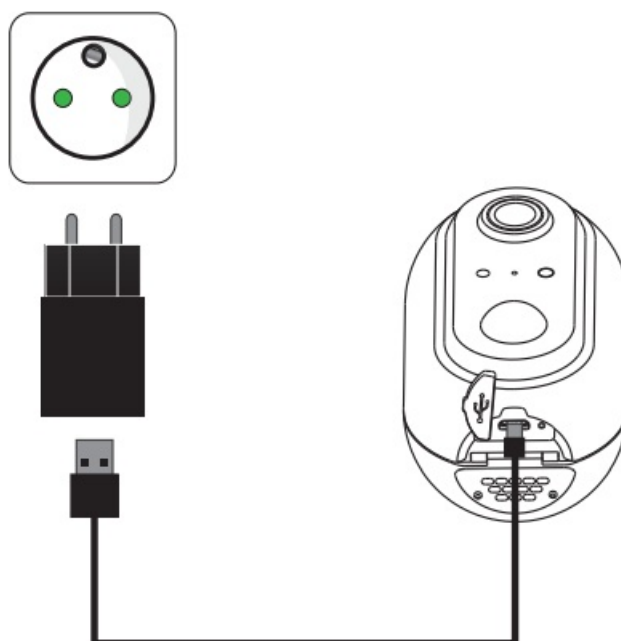

Use the supplied Micro USB cable to connect the camera to a USB power supply (not included). To obtain the correct charging time, it is recommended to use a USB charger of 1A or more. Once plugged in, the camera indicator lights red, and the batteries are fully charged when the indicator turns green.

Step 3 : Installing a Micro SD card

Note : If you do not wish to use a Micro SD card for recording, you can go directly to step 4.

The Micro SD card reader (2), is located underneath the batteries.

Remove the batteries and insert your Micro SD card :

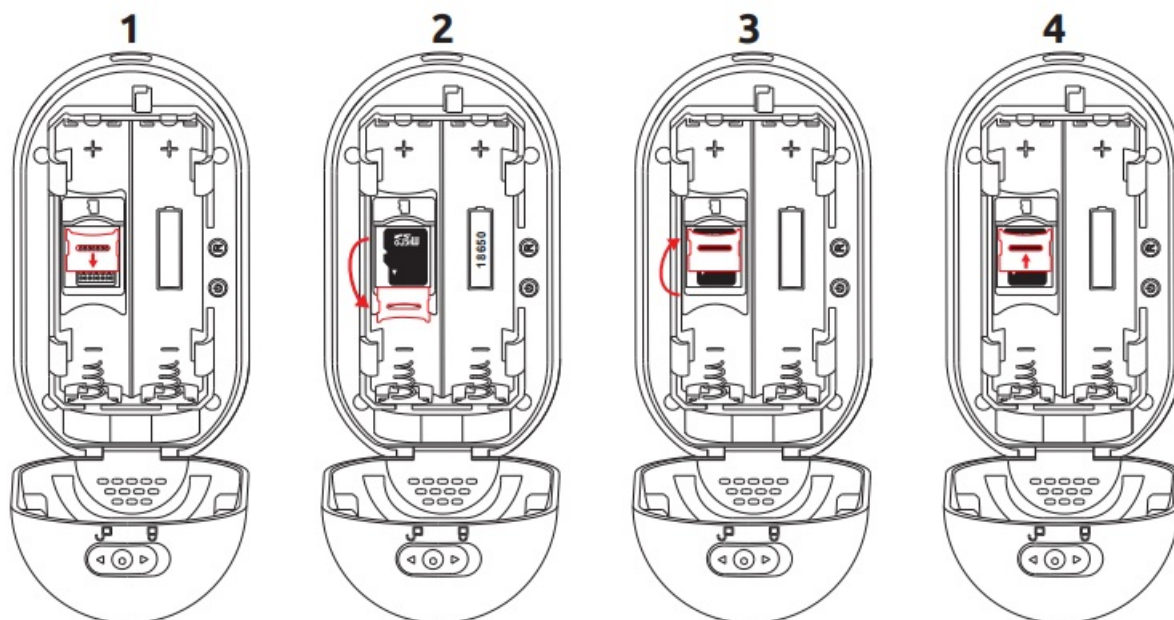

- Push the latch downwards to unlock and open it
- Place the Micro SD card in its slot
- Close the latch again and push it upwards to lock it

ATTENTION : Do not force, the latch must close and lock easily. If the lock is broken, remove the Micro SD card and replace it correctly.

Step 4 : Switching on the camera

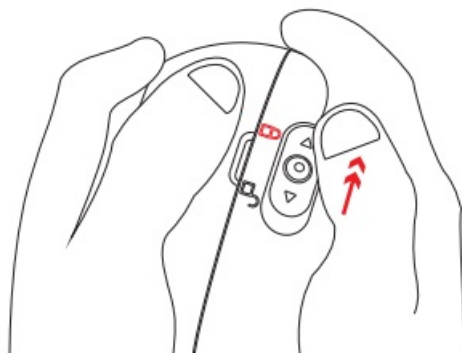

Press the ON/OFF button : an audible signal sounds and then a voice confirms that the camera is ready to be paired (the camera is ready to pair).

You can now close the camera's waterproof housing and then reposition the locking button to the «closed» position :



Step 5 :

Download the SEDEA Home application available on Google Play and on the App store.

If you do not have access to the Playstore, please scan the QR Code below to download the application

installation file to your phone.

Attention, when launching this one, you may be asked to allow installation from unknown sources, if this is the case, please configure your phone accordingly.

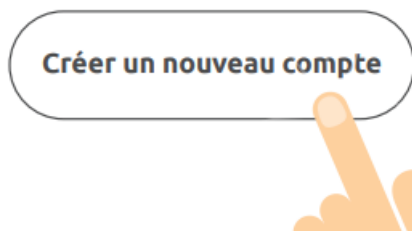

c. Click on the SEDEA Home application and then follow the instructions on your screen.

First create your account! You have the possibility to use your e-mail address or mobile phone number.

To verify your email address or phone number, a code will be sent to you and you will need to create a password to complete the creation of your account.

Now click on the + symbol at the top right of the screen :

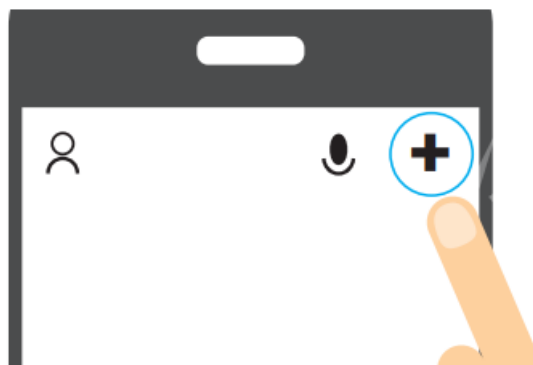

Then choose your product from the proposed list.

The application will then guide you to check the status of your camera and connect it to your WiFi network.

Enter the password for your WiFi network as soon as you are asked for it.

(WiFi network on which your smartphone is connected)

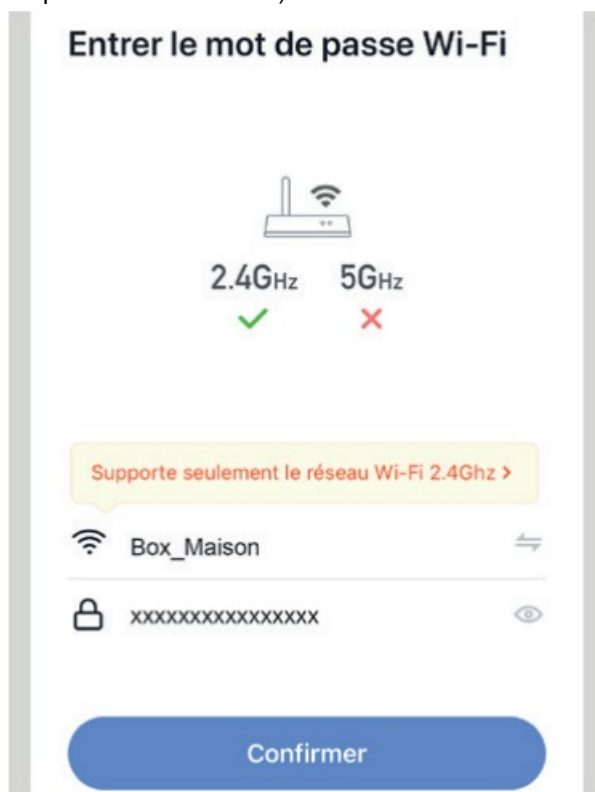

The SEDEA Home application will then display a QR Code to be directed to your camera :

Place your smartphone or tablet in front of the camera (at a distance of 15 to 20 cm) so that the camera can scan the QR Code displayed on the screen.

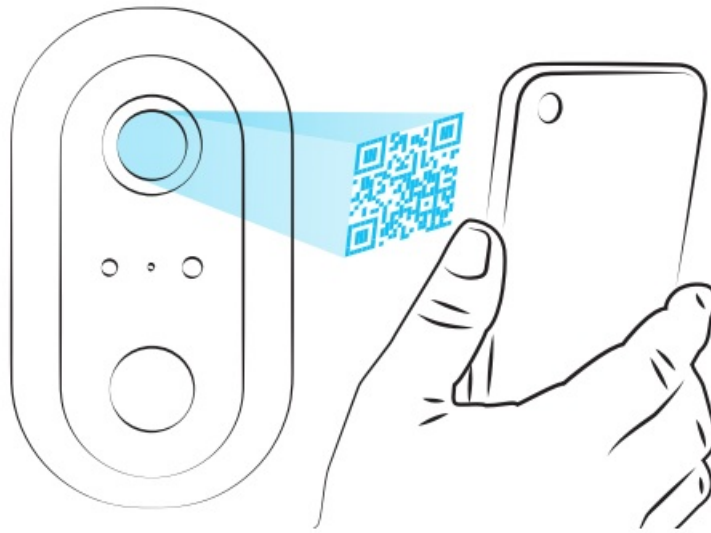

Once the code is recognised, the camera emits a confirmation beep: it is then connected to the Wi-Fi network and associated with your account.

You can therefore view the images and enjoy all the smart features of this device !

Installation help (in case of problems reading the QR Code)

Make sure that the phone is not placed in front of a light source, which may cause a reflection on the phone window and thus make the QR code unreadable.

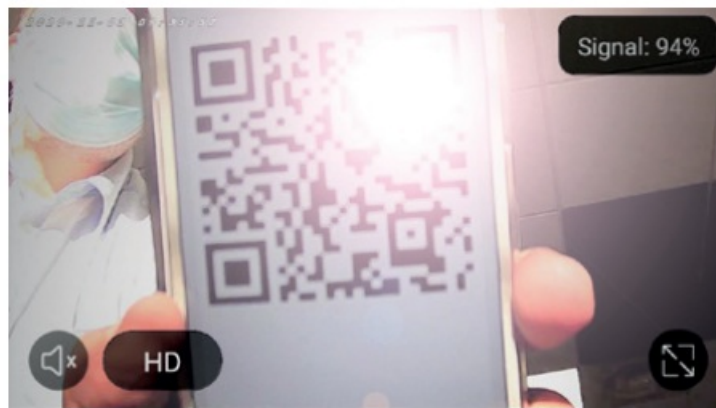

The focus is sometimes on the background and can therefore make the reading of the QR code «blurred» for the camera :



In this case, put your hand in front of the camera or clean the lens so that it can focus on the phone again.

Technical data

Camera

- Viewing angle : 130 °
- Night vision : 8 – 12 metres
- Supports micro SD card : up to 128 GB (Max) (not included)

- Power supply : Rechargeable batteries 2 x 3.7 V / 2600 mAh
- WiFi frequency band IEEE 802.11b/g/n : 2412MHz-2472MHz
- Maximum emitted power : 43.15 mW e.i.r.p.

Pre-installed batteries

- Brand : DONGGUAN CHAM BATTERY TECHNOLOGY CO. LTD
- Type : Rechargeable Lithium-Ion cylindrical cell
- Model : CMICR18650F8
- Voltage : 3.7V
- Capacity : 2600 mAh

Recycling



This symbol on the product, its accessories or documentation indicates that the product complies with European Directive 2012/19/ EU. This means that neither the product nor its used electronic accessories may be disposed of with other household waste. Please separate your used products and accessories from other waste. The citizen disposal of your old product helps to protect the environment and your health, you will thus promote the recycling of the material they are made of within the framework of sustainable development. Private individuals are invited to contact the local authorities to find out about the procedures and collection points for recycling these products.

Warranty

The warranty for your appliance and its accessories complies with the legal provisions at the date of purchase. Spare parts for this appliance are at least available for the duration of the warranty.

Declaration of conformity

The undersigned, SEDEA, declares that the radio equipment of the WiFi camera type complies with Directive 2014/53/EU. The full text of the EU Declaration of Conformity is available at the following internet address :

<https://www.fujionkyo.com/camera-autonome-498600>



Precautions for use

- Do not use an obviously defective product.
- Never open the appliance. This will expose you to the risk of fatal electric shocks and will result in loss of warranty coverage.
- Keep the product, accessories and packaging parts out of the reach of children and pets to prevent accidents and choking hazards.
- Do not submerge the product and do not expose it to extremely low or extremely high temperatures to avoid corrosion or deformation.
- The camera should not be installed in a place where the lens filter is exposed to scratches and dirt.
- Do not expose the lens to direct sunlight or any reflected light source.
- Do not multiply power strips or extension cables when charging the batteries.
- Do not install near acid chemicals, ammonia or a source of toxic gas emissions.
- The installation and use of the camera must be in accordance with local legislation.
- Clean the product only with a soft, dry cloth.
- Never touch the appliance with wet hands or feet.



Find out more: www.quefairedemesdechets.fr



HOTLINE

TEL : +(33)3 20 96 59 91

P.A.M. – CS 80458 – 5981 4 LESQUIN cedex – FRANCE

Documents / Resources

	<p>Fuji Onkyo iA600 WiFi Camera [pdf] Instruction Manual iA600 WiFi Camera, iA600, WiFi Camera, Camera</p>
---	--

Manuals+.