




[Home](#) » [Front Runner](#) » **FRONT RUNNER TBRA057 Load Bed Cargo Slide Drop Down Table Bracket Instruction Manual** 

# FRONT RUNNER TBRA057 Load Bed Cargo Slide Drop Down Table Bracket Instruction Manual

May 12,  
2025

## Contents [ [hide](#) ]

### 1 FRONT RUNNER

#### 1.1 Load Bed Cargo Slide Drop Down Table Bracket

##### 1.1.1 TBRA057

##### 1.1.2 1 GET ORGANIZED

###### 1.1.2.1 IN THE BOX

###### 1.1.2.2 TOOLS NEEDED

##### 1.1.3 2 FIT AND SECURE

##### 1.1.4 3 FINISH

##### 1.1.5 4 INSTALL OTHER VEHICLE AND RACK ACCESSORIES

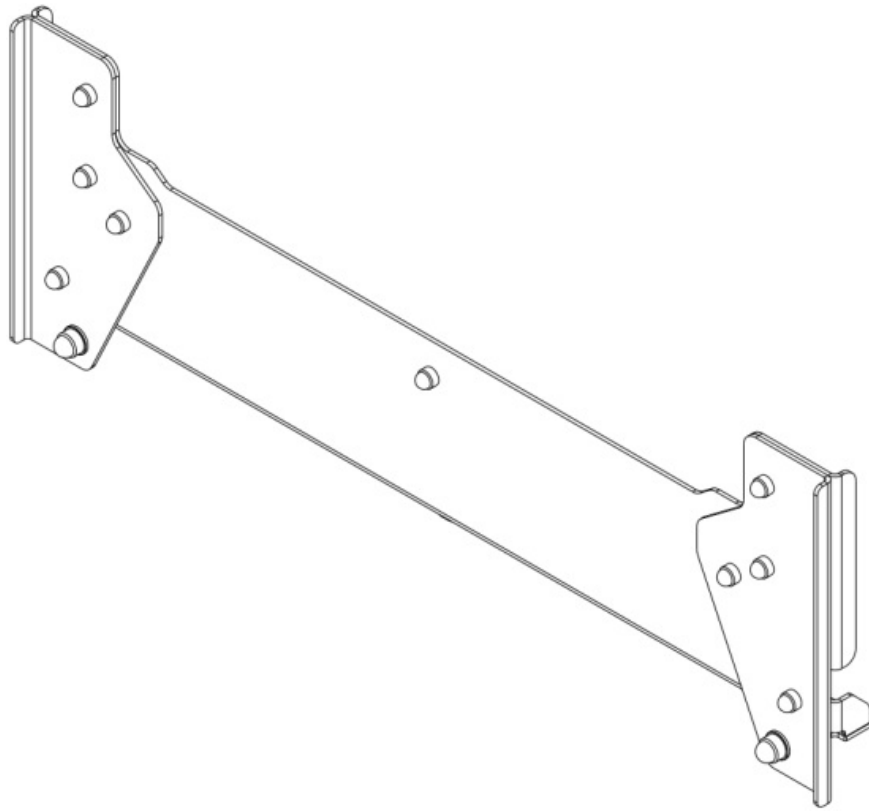
### 2 Documents / Resources

#### 2.1 References

## FRONT RUNNER

### Load Bed Cargo Slide Drop Down Table Bracket

TBRA057



## **READ ME !**

**Thank you for purchasing a Load Bed Cargo Slide Drop Down Table Bracket**  
**Before you start, take a moment to familiarize yourself with the Fitting Instructions**  
**and the included components.**

**Refer to Page 2 for a list of all the components, quantities and tools required.**

## **IMPORTANT WARNING! ⚠**

IT IS CRITICAL THAT ALL FRONT RUNNER PRODUCTS BE PROPERLY AND SECURELY ASSEMBLED AND ATTACHED TO YOUR VEHICLE. IMPROPER ATTACHMENT COULD RESULT IN AN AUTOMOBILE ACCIDENT, AND COULD CAUSE SERIOUS BODILY INJURY OR DEATH. YOU ARE RESPONSIBLE FOR ASSEMBLING AND SECURING ALL FRONT RUNNER PRODUCTS TO YOUR VEHICLE, CHECKING THE ATTACHMENTS PRIOR TO USE, AND PERIODICALLY INSPECTING THE PRODUCTS FOR ADJUSTMENT, WEAR AND DAMAGE. THEREFORE, YOU MUST READ AND UNDERSTAND ALL OF THE INSTRUCTIONS AND PRECAUTIONS SUPPLIED WITH YOUR FRONT RUNNER PRODUCT PRIOR TO INSTALLATION OR USE. IF YOU DO NOT UNDERSTAND ALL OF THE INSTRUCTIONS AND CAUTIONS, OR IF YOU HAVE NO MECHANICAL EXPERIENCE

AND ARE NOT THOROUGHLY FAMILIAR WITH THE INSTALLATION PROCEDURES, YOU SHOULD HAVE THE PRODUCT INSTALLED BY A PROFESSIONAL INSTALLER OR OTHER QUALIFIED PERSONNEL.

**NOTE: Front Runner will not be responsible for any damage caused by the failure to install the product according to these instructions.**

**Please call us if you have any questions about the installation of this product.**

## **1 GET ORGANIZED**

### **IN THE BOX**

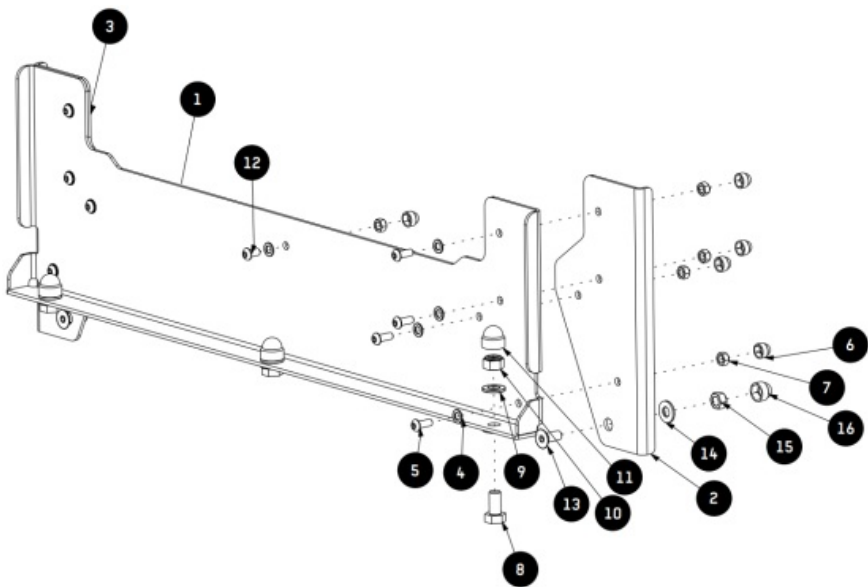
1	1 X	Top Bracket
2	1 X	Stiffener Bracket LH
3	1 X	Stiffener Bracket RH
4	9 X	M6 x 12 x 1 Flat Washer
5	8 X	M6 x 16 Button Head Screw
6	9 X	M6 Nut Cap
7	9 X	M6 Nyloc Nut
8	3 X	M10 x 25 Hex Bolt
9	6 X	M10 Flat Washer
10	3 X	M10 Nyloc Nut
11	3 X	M10 Nut Cap
12	1 X	M6 x 12 Button Head Screw
13	2 X	M8 x 20 Countersink Screw
14	2 X	M8 x 19 x 2 Flat Washer

15	2 X	M8 Nyloc Nut
16	2 X	M8 Nut Cap

TOOLS NEEDED

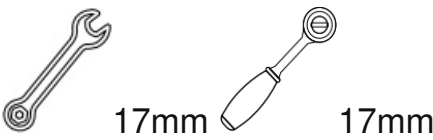


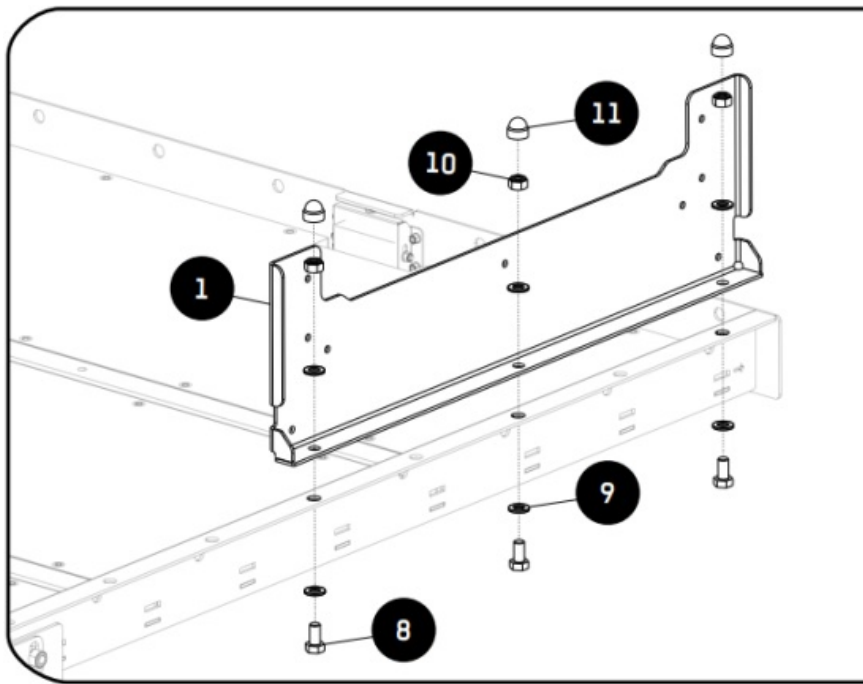
FIGURE 1.1



2 FIT AND SECURE

2.1





↻ With the Slide in the open position, decide on which side you would like to mount the Drop down Table Bracket.

Place the Top Bracket (Item 1) onto the side of the bakkie slide lining up the bottom mounting holes with the slide.

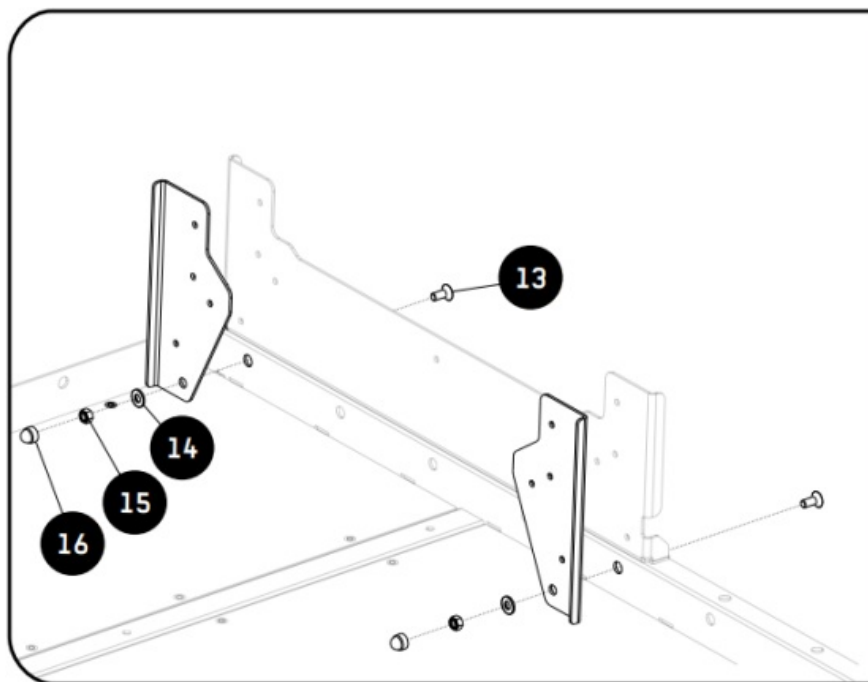
Using the M10 x 25 Hex Bolt, M10 Flat Washer and M10 Nyloc Nut (Item 8 ,9 &10) and assemble the Top bracket to the slide as shown.

Fully Tighten.

**⚠ Tightening Torque:**

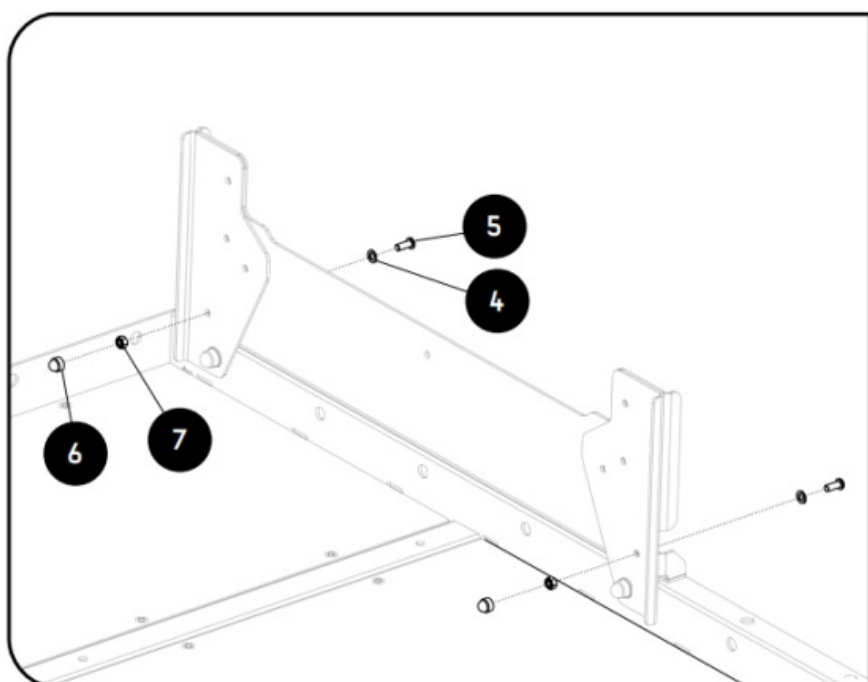
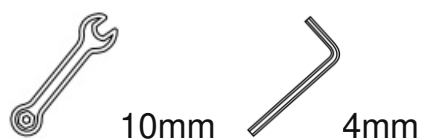
**M10 : 45-50Nm/ 33.19 ft lb – 36.87 ft lb**

**2.2**



↻ Assemble the stiffener brackets the the Top bracket fitted in 2.1, using M8 x 20 Countersink screw, M8 x 19 x 2 Flat washer and M8 Nyloc nut (Iten 13,14 & 15) as shown do not fully tighten at this point.

## 2.3



↻ Assemble two M6 x 16 Button Head screws (Item 5) as shown together with two M6 x 12 x 1 Flat Washers and two M6 Nyloc Nuts (Item 4 & 7).

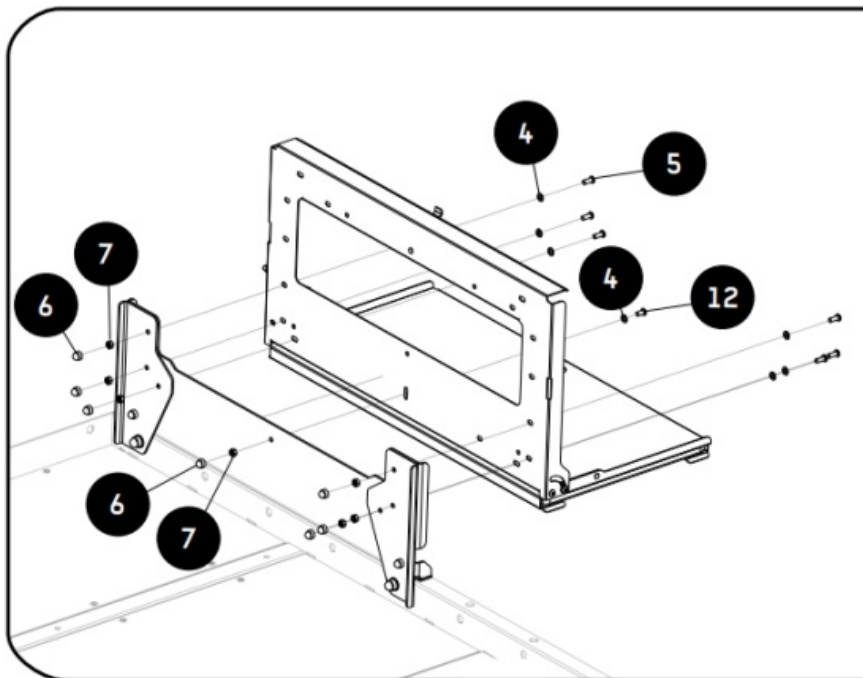
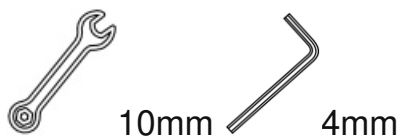
Fully Tighten and place the M6 Nut caps (Item 6) over the M6 Nyloc Nuts.

Place the M10 Nut caps (Item 11) over the M10 Nyloc Nuts fitted in 2.2

**⚠ Tightening Torque:**

**M6 : 8-10Nm / 5.9 ft lb – 7.38 ft lb**

**2.4**



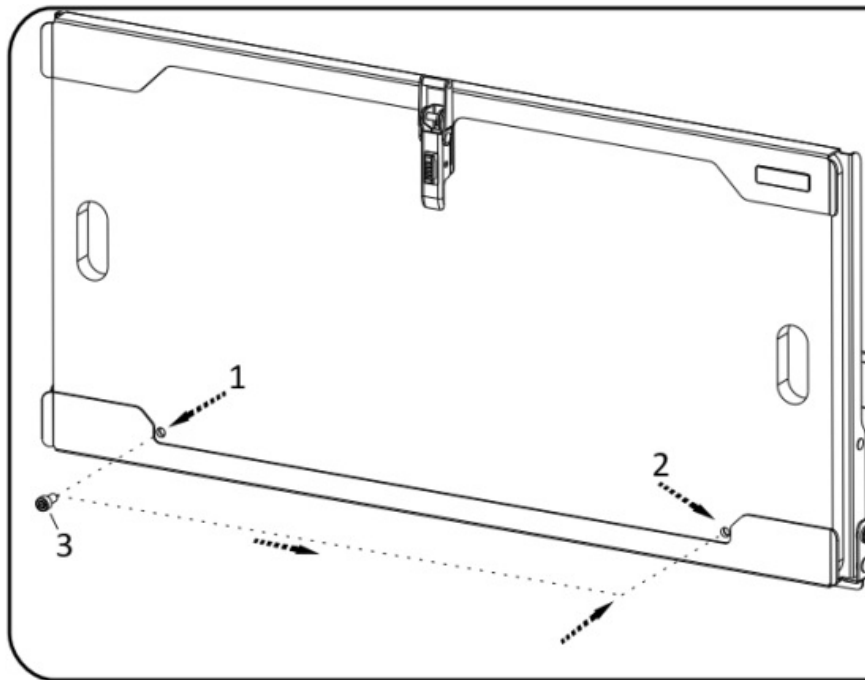
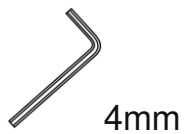
↻ Align TBRA034 (not included) mounting holes with backing plate mounting holes and secure using M6 x 16 Button Head screws, M6 x 12 x 1 Flat washers and M6 Nyloc Nuts (Item 4,5 & 7) as shown.

Assemble M6 x 12 Button Head screw, M6 x 12 x 1 Flat washer and M6 Nyloc Nut (Item 12,4 & 7) to the middle of the mounting bracket as shown.

**⚠ Tightening Torque:**

**M6 : 8-10Nm / 5.9 ft lb – 7.38 ft lb**

**2.5**



1. Slide out Right
2. Slide out Left
3. Stopper Screw

↻ If you would like the Board to slide out left or right you will need to reposition the Stopper Screw. Do this by removing it from the Right side of the Sliding Board and refitting it on the Left side as shown. Retighten the stopper screw.

**3 FINISH**

Congratulations! You did it. Take a step back and admire your work!

**4 INSTALL OTHER VEHICLE AND RACK ACCESSORIES**

Now's the time to visit your favorite Front Runner Dealer in person or online.

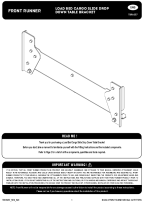


Be sure to tag us. We love to see our gear in action! #FrontRunnerOutfitters  
#BornToRoam

Share your adventures on:    

TBRA057\_REV\_A00      © 2024 FRONT RUNNER VEHICLE OUTFITTERS

## Documents / Resources

	<p><a href="#">FRONT RUNNER TBRA057 Load Bed Cargo Slide Drop Down Table Bracket [pdf]</a> Instruction Manual</p> <p>TBRA057 Load Bed Cargo Slide Drop Down Table Bracket, TBRA057, Load Bed Cargo Slide Drop Down Table Bracket, Slide Drop Down Table Bracket, Drop Down Table Bracket, Table Bracket</p>
---	---

## References

- [User Manual](#)

Front  
Runner

Drop Down Table Bracket, Front Runner, Load Bed Cargo Slide Drop Down Table Bracket, Slide Drop Down Table Bracket, Table Bracket, TBRA057, TBRA057 Load Bed Cargo Slide Drop Down Table Bracket

—Previous Post

[FRONT RUNNER TBMK046 Cross Bar Tent Mount Kit Instruction Manual](#)

## Leave a comment

Your email address will not be published. Required fields are marked \*

Comment \*

Name

Email

Website

☐ Save my name, email, and website in this browser for the next time I comment.

**Post Comment**

**Search:**

e.g. whirlpool wrf535swhz

**Search**

[Manuals+](#) | [Upload](#) | [Deep Search](#) | [Privacy Policy](#) | [@manuals.plus](#) | [YouTube](#)

This website is an independent publication and is neither affiliated with nor endorsed by any of the trademark owners. The "Bluetooth®" word mark and logos are registered trademarks owned by Bluetooth SIG, Inc. The "Wi-Fi®" word mark and logos are registered trademarks owned by the Wi-Fi Alliance. Any use of these marks on this website does not imply any affiliation with or endorsement.