



Fronius Smart Meter IP User Guide

[Home](#) » [Fronius](#) » Fronius Smart Meter IP User Guide 

Contents

- [1 Fronius Smart Meter IP](#)
- [2 Product Information](#)
- [3 Product Usage Instructions](#)
- [4 Technical Data](#)
- [5 Communication](#)
- [6 LEDs](#)
- [7 Mounting](#)
- [8 Power wiring](#)
- [9 Data wiring](#)
- [10 Modbus RTU BIAS](#)
- [11 Modbus RTU Terminating Resistor](#)
- [12 Setup](#)
- [13 Warranty](#)
- [14 Documents / Resources](#)
 - [14.1 References](#)
- [15 Related Posts](#)



Fronius Smart Meter IP



Product Information

The Fronius Smart Meter IP is a radio equipment type device that is compliant with Directive 2014/53/EU. It is manufactured by Fronius International GmbH. The product allows for communication through WLAN and LAN, and operates at a frequency band of 2.4 GHz. It has an IP20/IP30 rating for housing and connections and has a footprint of 3 TE (3 Modules DIN 43880). The Smart Meter has LEDs to indicate connection status and a boot process. It is compatible with Fronius GEN24, Tauro, Datamanager 2.0 (SnapInverter), and Symo Hybrid.

Technical Data

- **Permitted ambient temperature:** 100 – 240 V
- **Nominal frequency:** 208 – 480 V
- **Voltage phase/neutral:** max. 5 W
- **Voltage phase/phase:** 5 kA
- **Self-consumption:** IP20/IP30
- **Primary current:** 3 TE (3 Modules DIN 43880)

Product Usage Instructions

1. **Mounting:** Install the Fronius Smart Meter IP in the desired location.
2. **Power wiring:** Connect the appropriate voltage phase/neutral and voltage phase/phase to the Smart Meter.
3. **Data wiring:**
 - For LAN (GEN24 & Tauro), connect the LAN cable to the Smart Meter.
 - For WLAN (GEN24 & Tauro), connect to the access point using the provided SSID and password.
 - For Modbus RTU (SnapInverter, GEN24 & Tauro), connect the Modbus RTU cable to the Smart Meter.
4. **Load/Source:** Depending on your setup, connect the load/source wires to the appropriate terminals on the Smart Meter.
5. **CT (Current Transformer) Wiring:**

- **For 1 Phase, 2 Wires – CT:** Connect CT1 to the appropriate terminals on the Smart Meter.
 - **For 3 Phases, 4 Wires – CT:** Connect CT1, CT2, and CT3 to the appropriate terminals on the Smart Meter.
 - **For 2 Phases, 3 Wires – CT:** Connect CT1 and CT2 to the appropriate terminals on the Smart Meter.
6. **Modbus RTU BIAS:** Set the Modbus RTU BIAS to ON or OFF depending on your requirements.
 7. **Battery:** Set the Battery switch to ON or OFF depending on your setup.
 8. **Modbus RTU Terminating Resistor:** Set the Modbus RTU Terminating Resistor to ON or OFF depending on your requirements.
 9. **Outside Setup:**
 - Using a mobile phone, scan the QR-Code on the Smart Meter.
 - Follow the instructions provided.
 - The initial password for UI is 123.
 10. **Inside Setup:**
 - On a PC, connect to the access point using the provided SN and PW.
 - The SSID is FroniusMeter_xxxxx (xxx = Seriennummer) and the password can be found on the Smart Meter.

Fronius International GmbH declares that the radio equipment type Fronius Smart Meter IP is in compliance with Directive 2014/53/EU. The full text of the EU declaration of conformity is available at the following internet address: www.fronius.com.

Technical Data

Technical Data	
Permitted ambient temperature	from -25° to +55°C
Nominal frequency	50- 60 Hz
Voltage phase / neutral	100 – 240 V
Voltage phase / phase	208 – 480 V
Self-consumption	max. 5 W
Primary current	5 kA
IP range	IP20 / IP30 (Housing / Connections)
Footprint	3 TE (3 Modules DIN 43880)

Communication

Communication	
WLAN / LAN	Modbus TCP
WLAN frequency band	2,4 GHz
RS 485	Modbus RTU
Terminating resistor for RS 485	Configurable 0-1
BIAS Network for RS 485	Configurable 0-1
Multimetering	Yes – up to 2 Smart meters (RTU) Modbusinterface
Addressing (Modbus RTU)	In UI
Update possibility	Yes
CTs can be sourced by Fronius	100 A, 250 A, 400 A

LEDs

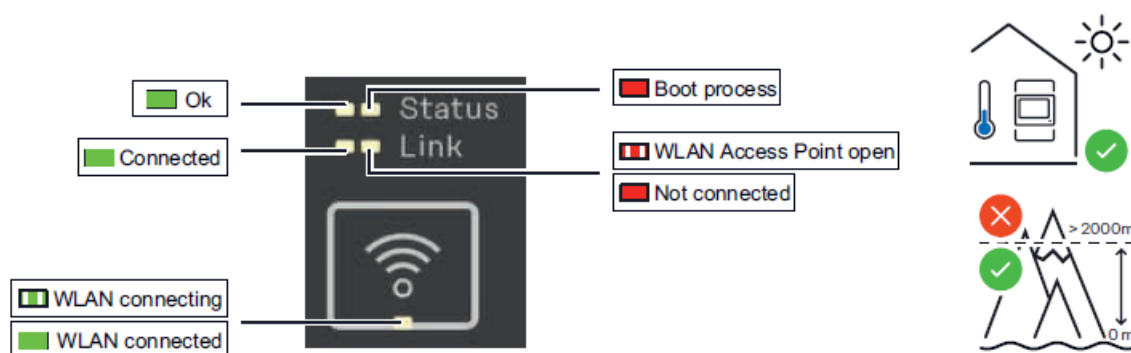

Software-Version:

- Fronius GEN24 & Tauro
- Full Compatibility (Version $\geq 1.24.1$)
- Fronius Datamanager 2.0 (SnapInverter)
- Modbus RTU (Version $\geq 3.25.1$)
- Fronius Symo Hybrid
- Modbus RTU (Version $\geq 1.25.1$)

AC~

1

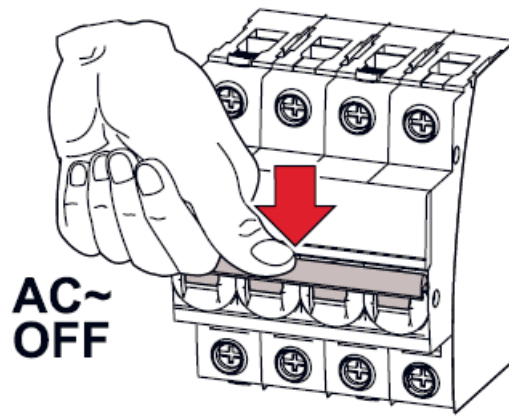

Mounting

2

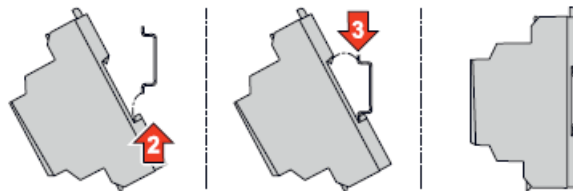
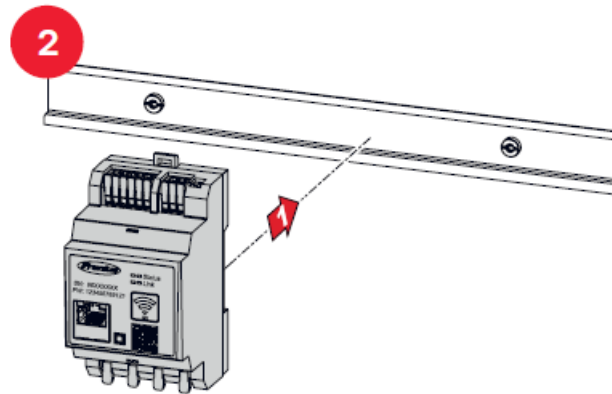

Power wiring

3

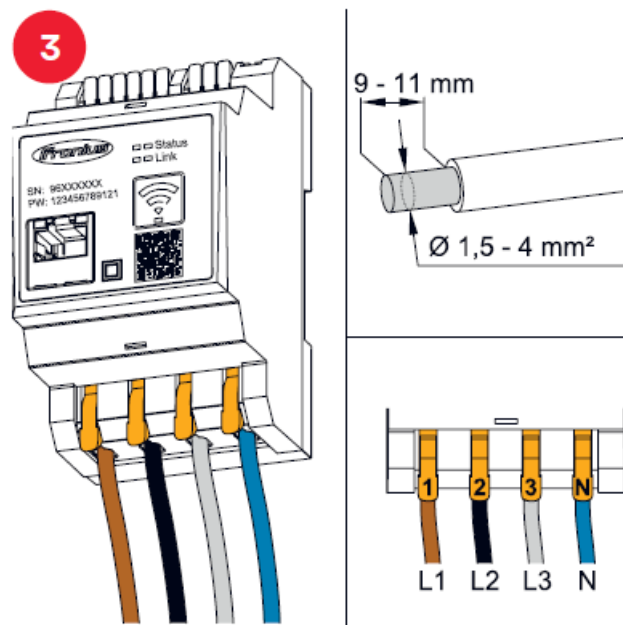

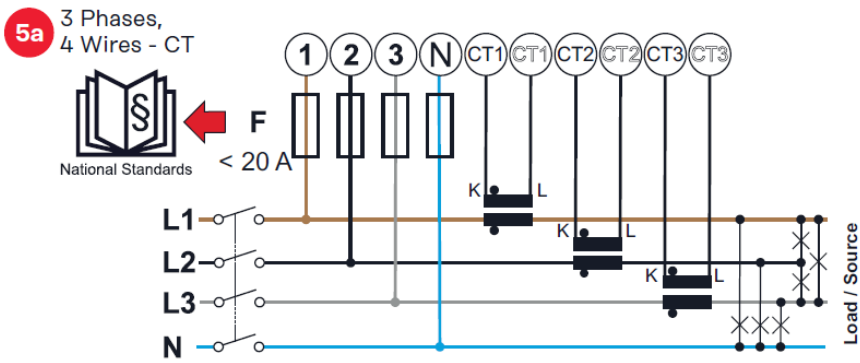
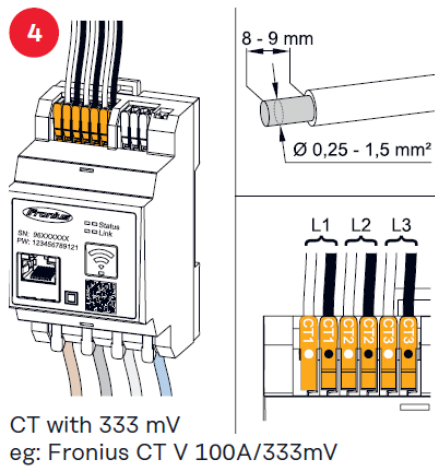

5b 1 Phase, 2 Wires - CT

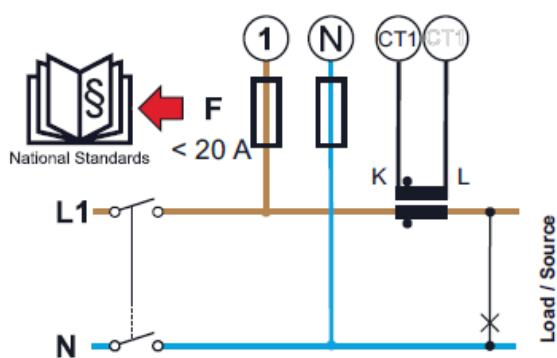

5c 2 Phases, 3 Wires - CT

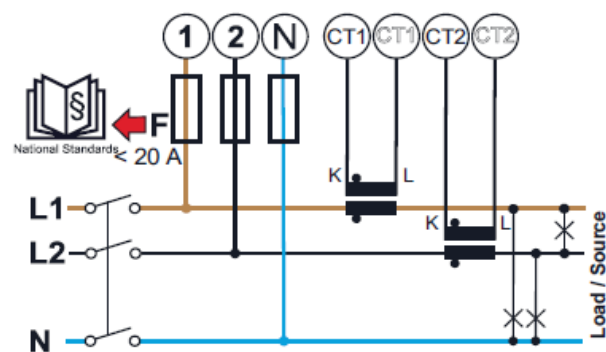

Data wiring

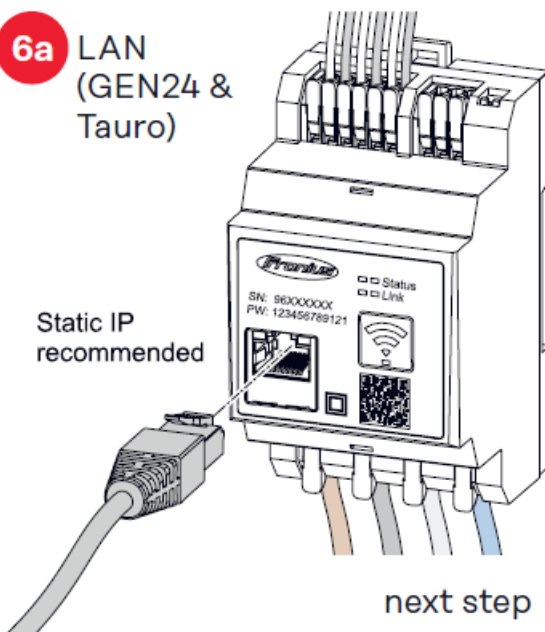

6b WLAN (GEN24 & Tauro)

Static IP recommended

Check signal strength

Technical Data (WLAN)
 Frequency band: channel 1-14 (2412-2472 MHz)
 Radio-frequency power: <100 mW (<20 dBm)

next step **9**

6c Modbus RTU (SnapInverter, GEN24 & Tauro)

CU Wire (min CAT 5)

8 - 9 mm

Ø 0,25 - 1,5 mm²

SnapInverter		
	Smart Meter	Modbus
	M+	D+
	M-	D-
	GND	-

GEN24		
	Smart Meter	Modbus
	M+	M0+
	M-	M0-
	GND	GND

Modbus TCP Port: 502

Modbus RTU BIAS

7

Battery

Term Bias ON OFF

1 = ON

0 = OFF

Battery

Term Bias ON OFF

1 = ON

0 = OFF

Modbus RTU Terminating Resistor

8a

Term Bias ON OFF

8b

Manufacturer manual

e. g. Ohmpilot, Battery

Manufacturer manual

Inverter

Manufacturer manual

Smart Meter

max. 300 m

Outside Inside Outside

AC~

9

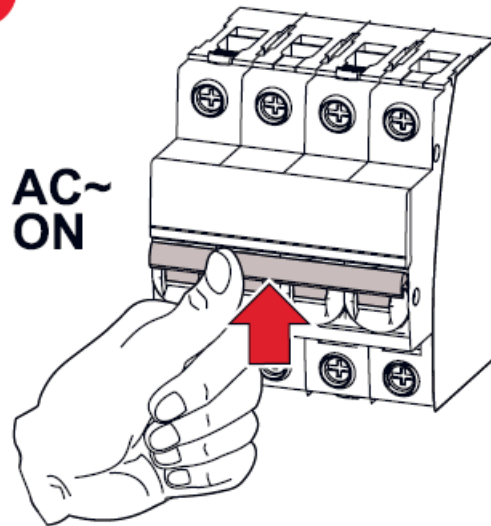

Setup

Mobile phone

10a Mobile phone



10b PC

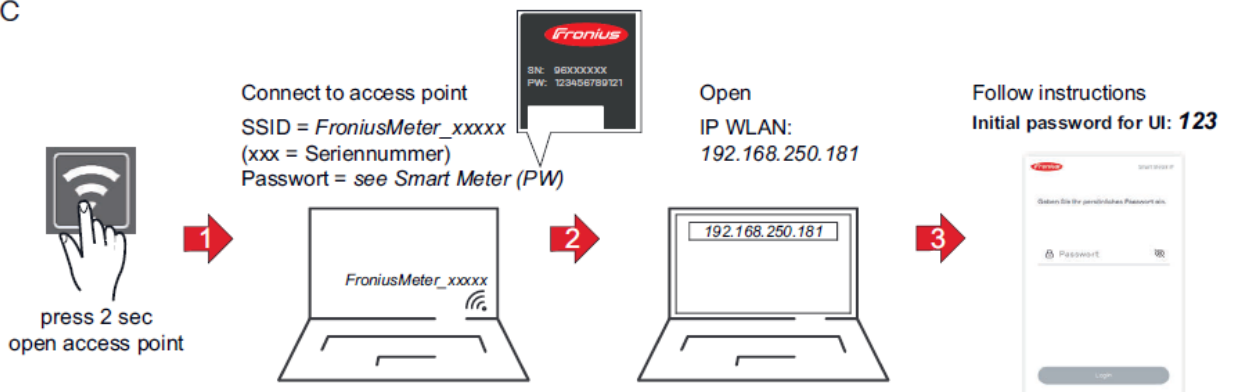



Warranty

Detailed, country-specific warranty terms are available on: www.fronius.com/solar/warranty.

Documents / Resources

	<p>Fronius Smart Meter IP [pdf] User Guide MAXSEL, 3400200421, Smart Meter IP, Smart IP, Meter IP, IP</p>
--	---

References

-  [Download Search - Fronius](#)
-  [Fronius International](#)
-  [Our warranty models for your Fronius products](#)