



PV-4050.221
Backup Switch



Fronius PV-4050.221 Backup Switch Instruction Manual

[Home](#) » [Fronius](#) » Fronius PV-4050.221 Backup Switch Instruction Manual 

Contents

- [1 Fronius PV-4050.221 Backup Switch](#)
- [2 OPERATING INSTRUCTION](#)
- [3 Switching OFF](#)
- [4 Mounting](#)
- [5 Documents / Resources](#)
 - [5.1 References](#)



Fronius PV-4050.221 Backup Switch



Fronius Backup Switch 1P/3P-63A

OPERATING INSTRUCTION

- <https://manuals.fronius.com/html/4204260536>





EN: WARNING!

Incorrect operation or poorly executed work can cause serious injury or damage. Installation and commissioning must be carried out by trained personnel according to the nationally applicable standards and guidelines. Before working with the device, ensure that you have read and understood all the documents printed and provided in hard

copy and online. When PV modules are exposed to light, they supply voltage to the inverter. This document does not describe all possible system configurations.

- Detailed, country-specific warranty terms are available at: www.fronius.com/solar/warranty

Warning signs explanation

-  General warning sign
-  Electricity hazard

Switching OFF

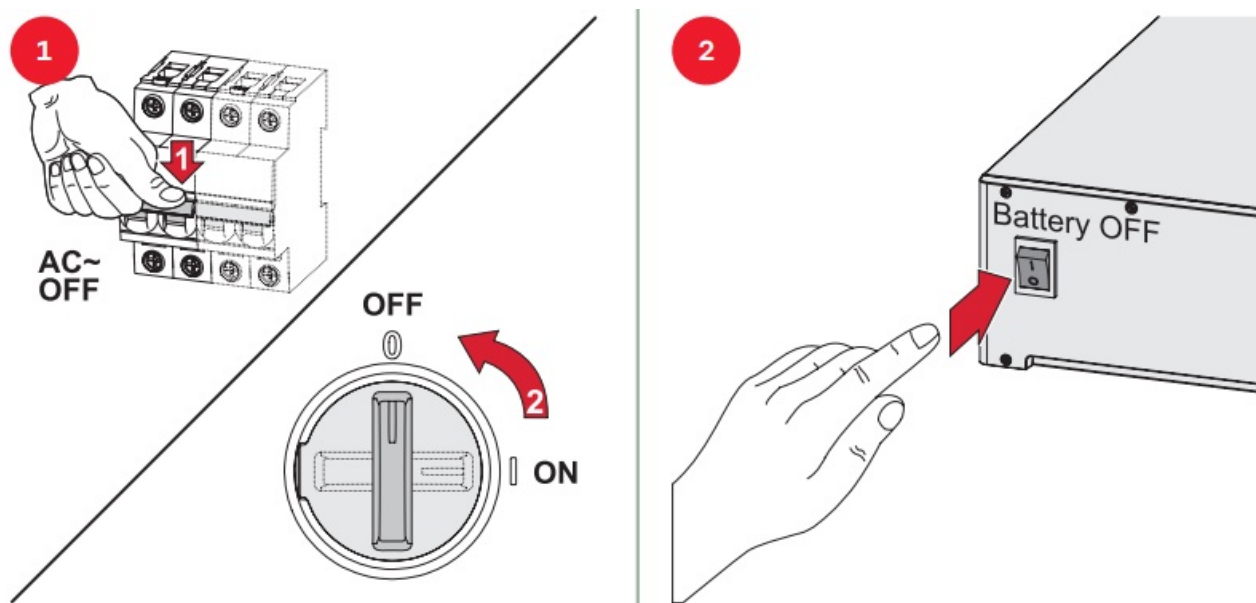

Mounting

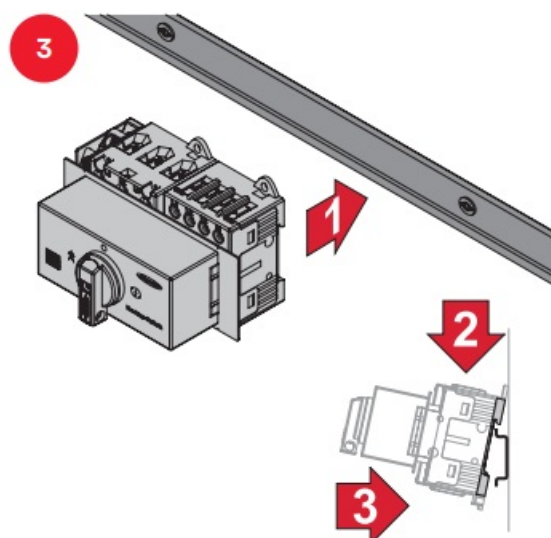

Preparing for installation

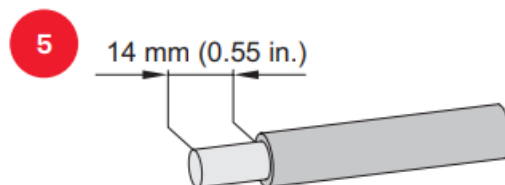
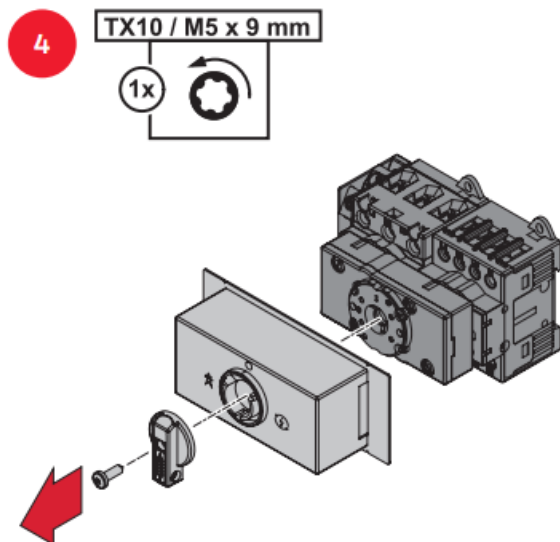

conductor per terminal	CU wire	
	1 - 25 mm ²	4 - 16 mm ²
	max. 2 x 10 mm ²	

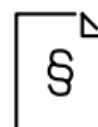

Option: 1P separation

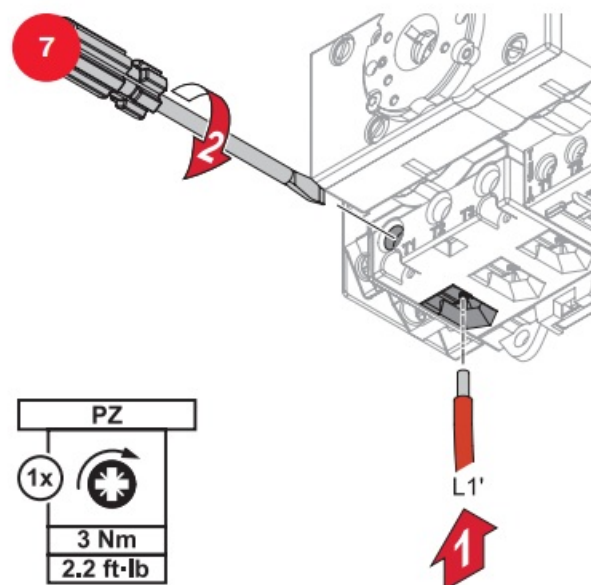
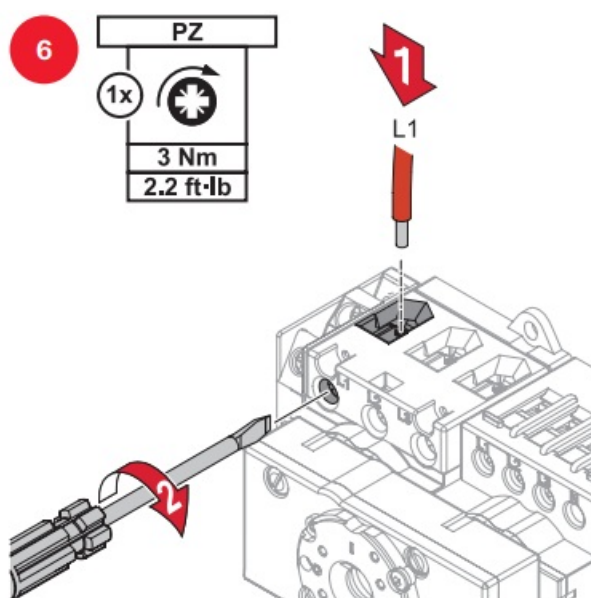

Option: 3P separation

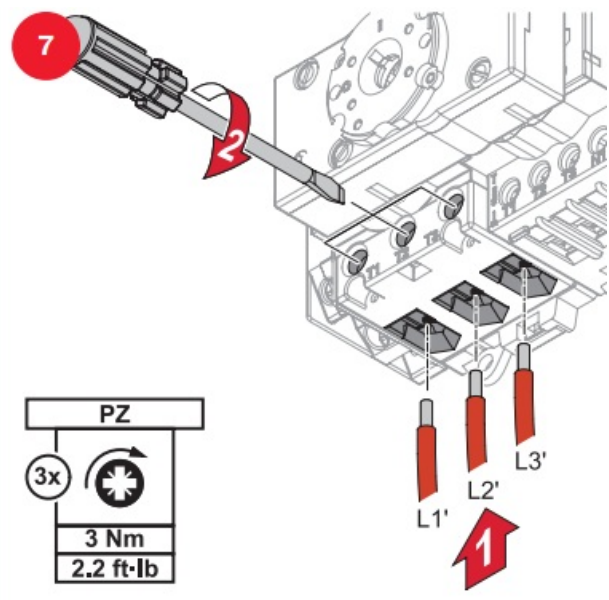
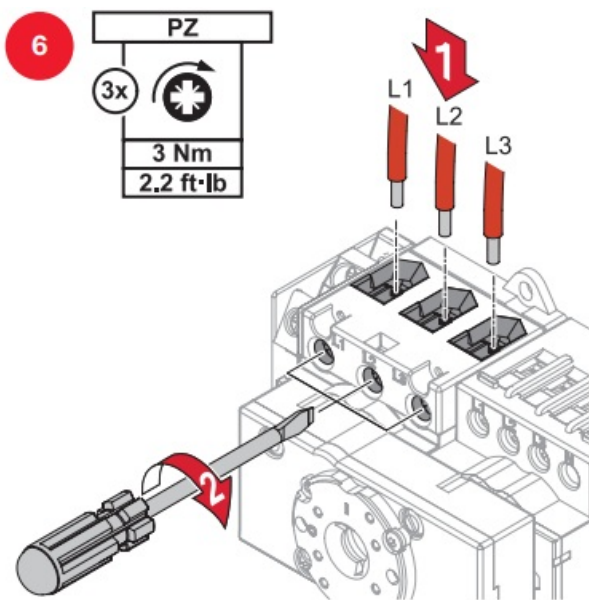

Connecting the data communication

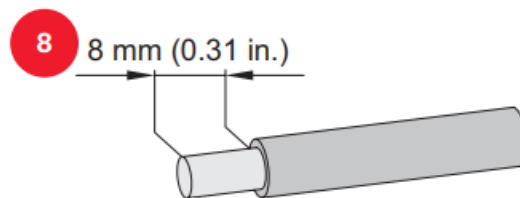

conductor per terminal	CU wire	
	0,13 - 2,5 mm ²	0,75 - 2,5 mm ²

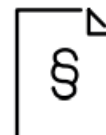
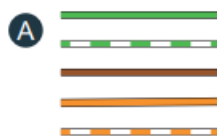

9

Smart Meter	Pin		
	M-	GND	M+
IP	B	C	A
50k A-3	34	35	33
63A-1	B	C	A
TS 5kA-2	12	13	11
TS 5kA-3	9	10	8
TS 100A-1	5	6	4

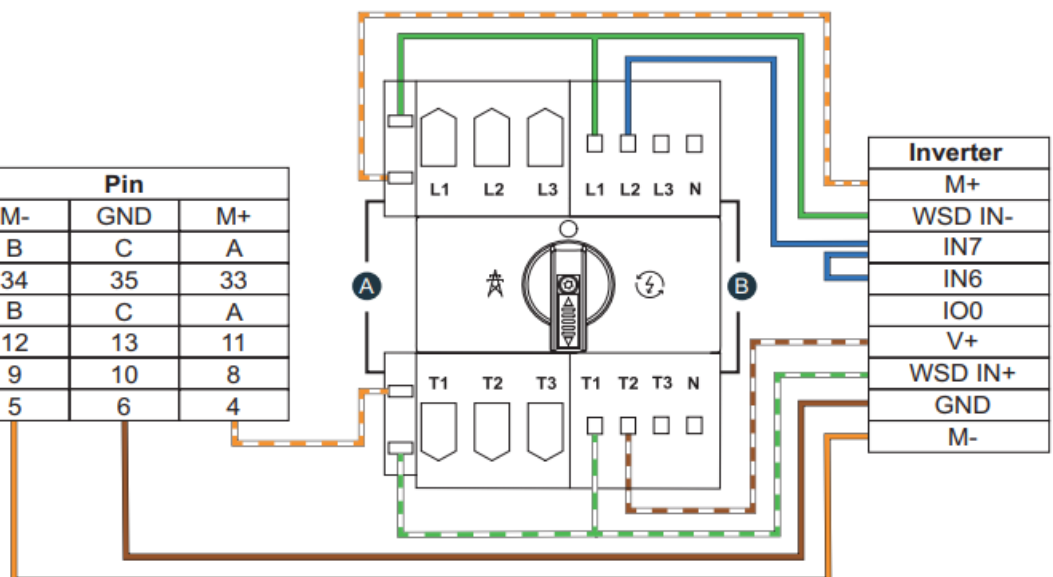

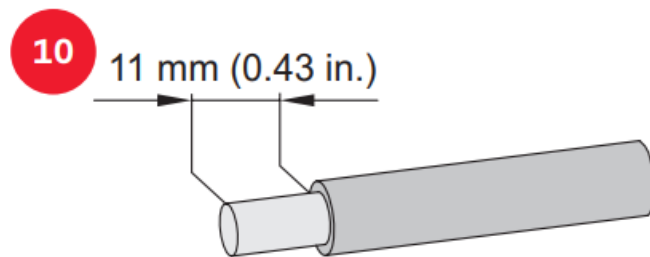

conductor per terminal	CU wire	
	0,13 - 10 mm ²	0,5 - 6 mm ²

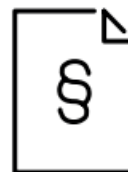
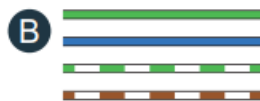

Mounting the protective cover

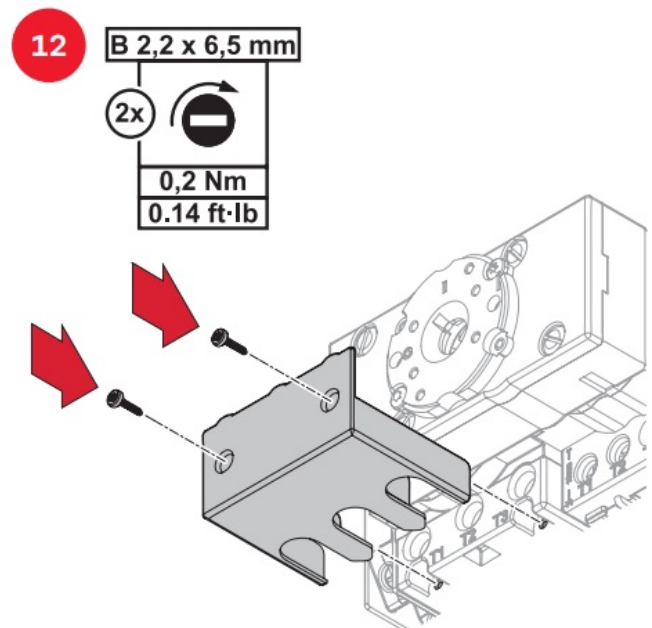
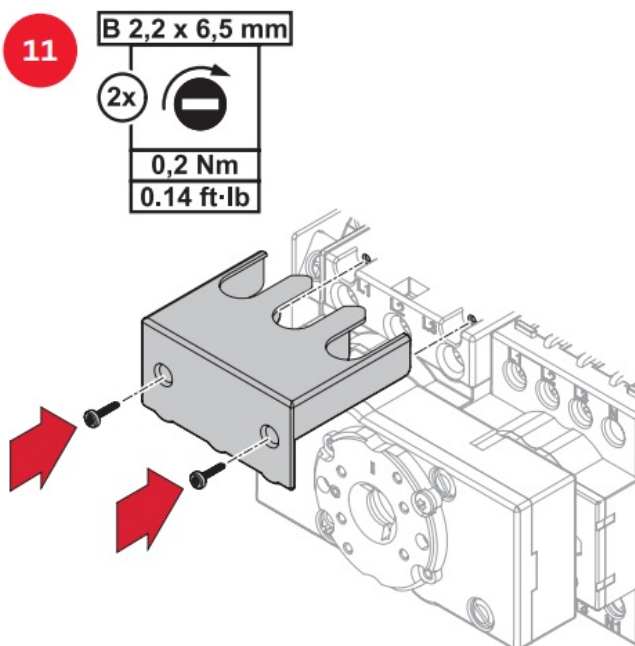

Commissioning

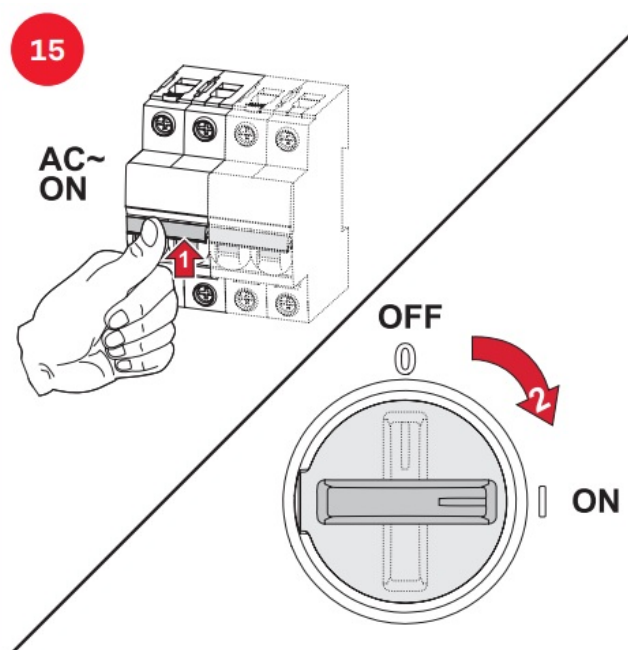
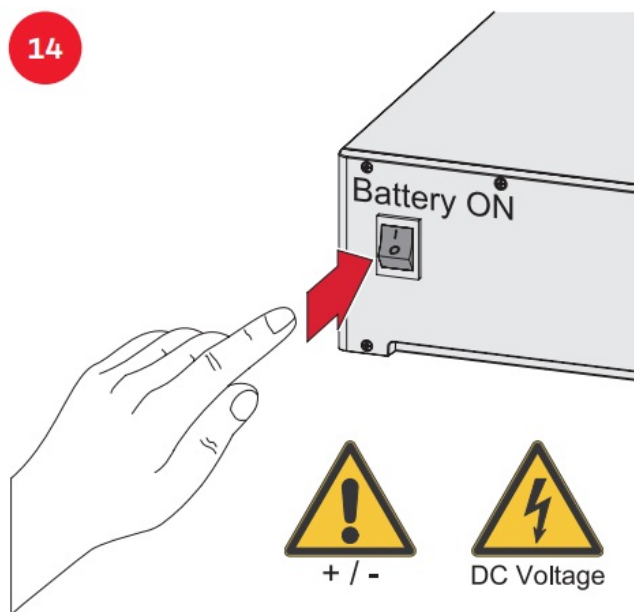
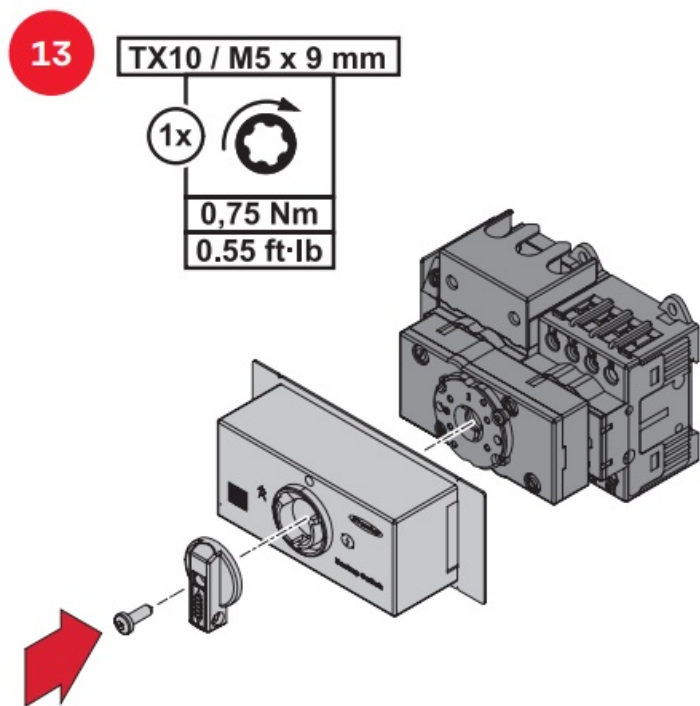

User interface configuration

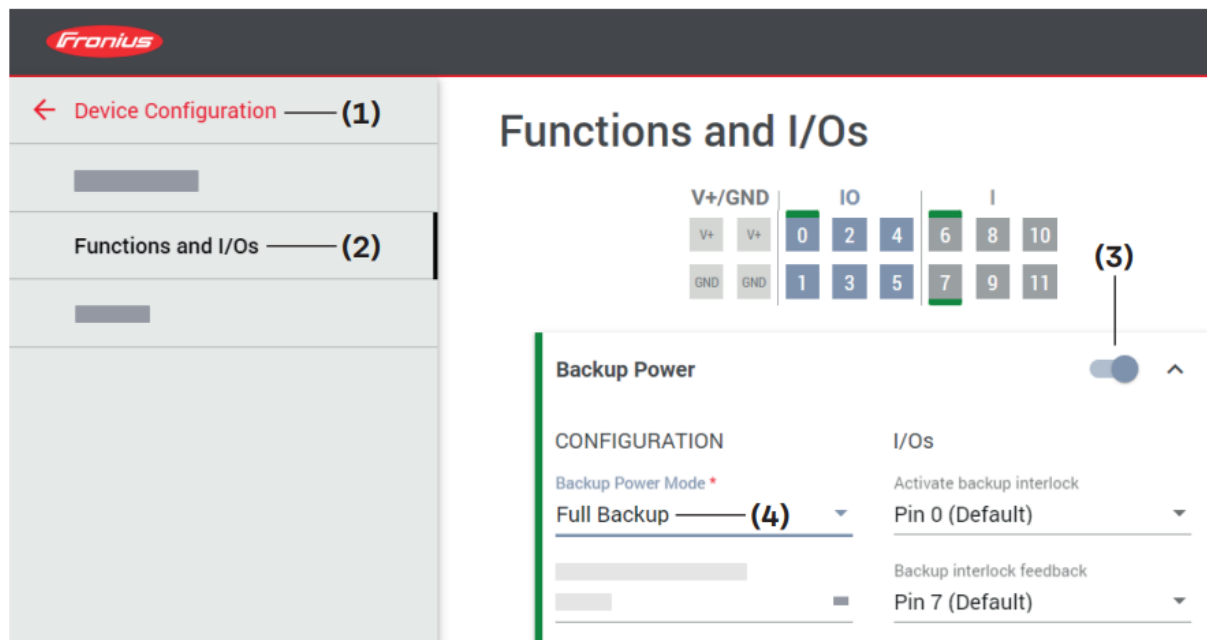

1. Open user interface of the inverter
2. Navigate to Device Configuration > Fun- functions and I/Os
3. Activate Backup Power
4. Select Full Backup under Backup PoPowerode

Testing the backup power function

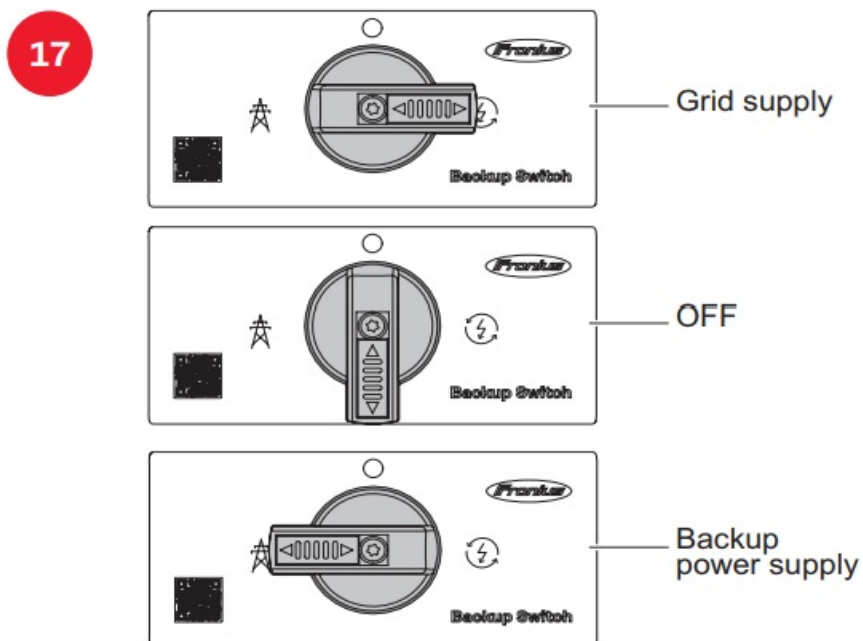



<https://www.fronius.com/en/solar-energy/installers-partners/downloads>

search for: „42,0426,0365“



- <https://www.fronius.com/en/solar-energy/installers-partners/downloads>
- Search for: „42,0426,0365“

Circuit diagrams



1-pin separation



3-pin separation

- 1-pin separation
- 3-pin separation

Documents / Resources

	<p>Fronius PV-4050.221 Backup Switch [pdf] Instruction Manual PV-4050.221, 42, 0410, 2974, PV-4050.221 Backup Switch, PV-4050.221, Backup Switch, Switch</p>
--	--

References

- [User Manual](#)

Manuals+. Privacy Policy

This website is an independent publication and is neither affiliated with nor endorsed by any of the trademark owners. The "Bluetooth®" word mark and logos are registered trademarks owned by Bluetooth SIG, Inc. The "Wi-Fi®" word mark and logos are registered trademarks owned by the Wi-Fi Alliance. Any use of these marks on this website does not imply any affiliation with or endorsement.