

Frizzlife FK99 Series Undersink Water Filter System



Frizzlife FK99 Series Undersink Water Filter System Installation Guide

[Home](#) » [Frizzlife](#) » Frizzlife FK99 Series Undersink Water Filter System Installation Guide 

Contents

- [1 Frizzlife FK99 Series Undersink Water Filter System](#)
- [2 Product Usage Instructions](#)
- [3 INSTALLATION INSTRUCTION](#)
- [4 PRODUCT INTRODUCTION](#)
- [5 SAMPLE CONNECTION](#)
- [6 FILTER REPLACEMENT INSTRUCTIONS](#)
- [7 PERFORMANCE DATA](#)
- [8 Documents / Resources](#)
 - [8.1 References](#)
- [9 Related Posts](#)

Frizzlife

Frizzlife FK99 Series Undersink Water Filter System



Specifications:

- **Model Name:** FK99, FK99M, FK99L
- **Dimension:** FK99 – 4.9 x 6.1 x 15 in, FK99M – 4.9 x 6.1 x 18.9 in, FK99L – 4.9 x 6.1 x 21.1 in
- **Replacement Filter:** PLC10, PLC15, PLC20
- **Replacement Period:** 12 m/10000 Gal., 24 m/20000 Gal., 36 m/30000 Gal.
- **Flow Rate:** 2 Gallons/min.@60 psi
- **Applicable Water Source:** Municipal Water
- **Operating Temp.:** Min.39 F, Max.100 F
- **Working Pressure:** Min. 20 psi, Max. 80 psi

Product Usage Instructions

Before Installation:

Inspect the box contents to ensure no damage during shipping. Contact Frizzlife if any parts are cracked or broken.

Product Introduction Part List:

- System Cap
- Water Filter Cartridge with filter loaded
- Housing Wrench
- 3/8 -1/2 converter
- Mount-up Screws
- Teflon Tape

- Drilling Hole Sticker
- Inlet hose
- Cold angle valve

Installation Tips:

Detailed instructions on connecting the system based on the valve type.

Installation Steps:

Precautions:

- Do not use with water that is microbiologically unsafe or of unknown quality without adequate disinfection.
- This filter must be protected from freezing to avoid cracking and water leakage.
- Ensure compliance with all applicable state and local regulations.

Step 1: Connect the Filter System with the Hoses

Connect the inlet water hose to the supply end of the water filter system.

Step 2: Install the System onto a Wooden Plate

1. Set the sticker provided in the package on the plate to mark the spots for two screws.
2. Use an electric screwdriver to fasten the screws and mount the system.

Note: Mount the water filter at least 4 inches lower than the bottom of the basin for easier installation.

FAQ

- **Q: Can this water filter system be used with hot water?**
 - **A:** No, this filter is designed for cold water use only to ensure optimal performance and longevity.
- **Q: How often should I replace the filter cartridge?**
 - **A:** The replacement period varies based on the model and usage. Refer to the specifications for details on replacement periods.
- **Q: What should I do if I encounter water leakage during installation?**
 - **A:** Check all connections for tightness and ensure proper installation following the provided instructions. If issues persist, contact Frizzlife for assistance.

Model: FK99 Series

Thank you for purchasing the Frizzlife FK99 Series undersink water filter system with 0.5 micron composite carbon block filter. If you have any questions or need any assistance, please contact: support@frizzlife.com

INSTALLATION INSTRUCTION

Before Installation

Inspect Box

Open the box and take out the system and all the components. Inspect them carefully according to “Product Introduction” and make sure nothing is missing or damaged during shipping. If any parts are cracked or broken, please do not proceed with the installation and contact Frizzlife for an exchange or diagnosis.

Technical Parameters

Model Name	FK99	FK99M	FK99L
Dimension	4.9 x 6.1 x 15 in	4.9 x 6.1 x 18.9 in	4.9 x 6.1 x 21.1 in
Replacement Filter	PLC10	PLC15	PLC20
Replacement Period	12 m/10000 Gal.	24 m/20000 Gal.	36 m/30000 Gal.
Flow Rate	2 Gallons/min.@60 psi		
Applicable Water Source	Municipal Water		
Operating Temp.	Min.39°F , Max.100°F		
Working pressure	Min. 20 psi, Max. 80 psi		

Rated flow 2 gallons/m @25 C (77 F). Low water temperature will slow down water flow. Please contact us for reference at: support@frizzlife.com

PRODUCT INTRODUCTION

Part List

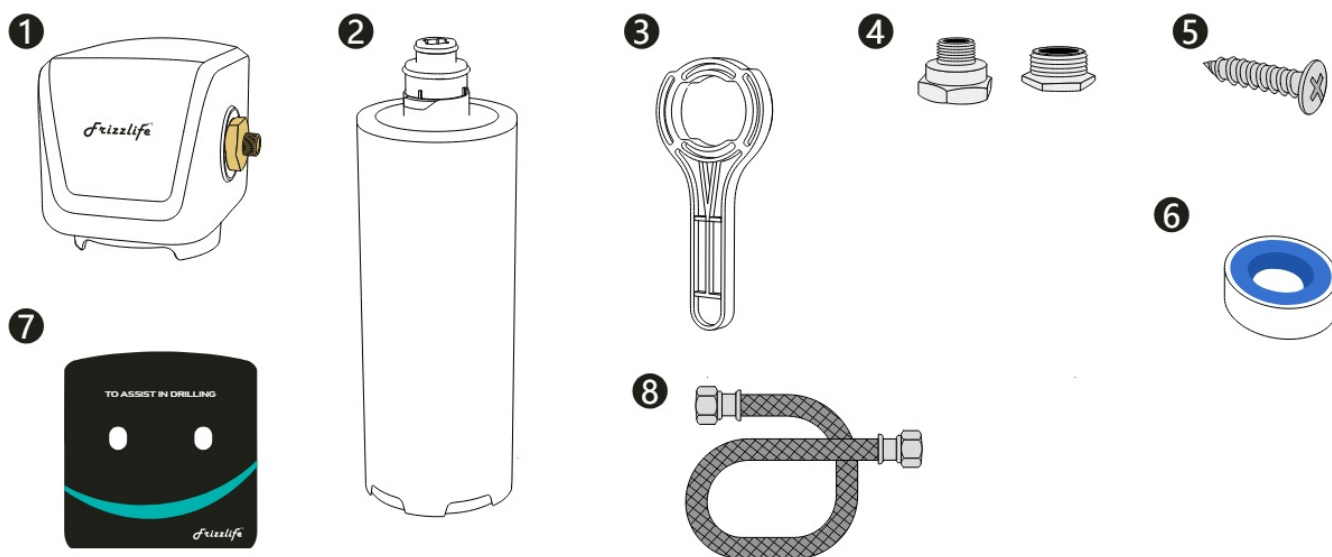

1. System Cap
2. Water Filter Cartridge with filter loaded
3. Housing Wrench
4. 3/8" -1/2" converter

5. Mount-up Screws
6. Teflon Tape
7. Drilling Hole Sticker
8. Inlet hose

SAMPLE CONNECTION

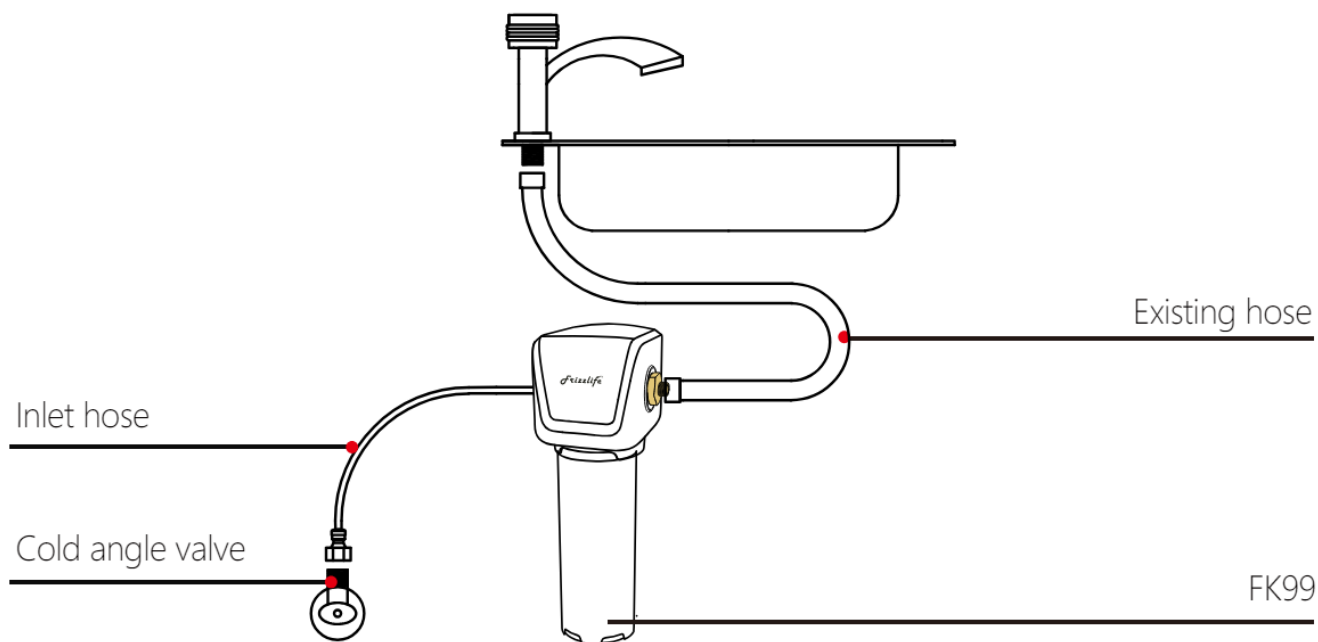

INSTALLATION TIPS

IF YOUR VALVE IS 1/2"

IF ANGLE VALVE OUTLET IS 3/8"



3/8" Comp (9/16" thread)

IF ANGLE VALVE OUTLET IS 1/2"



1/2" thread

CONNECT ONE PART OF THE CONVERTER TO THE ANGLE VALVE

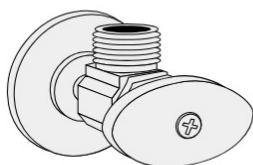

1/2" thread

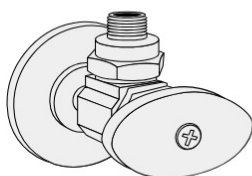

1/2" to 3/8"

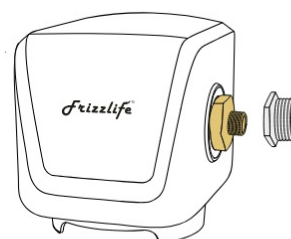

Outlet Port ► 3/8" to 1/2"

INSTALLATION STEPS

Precautions:

- Do not use with water that is microbiologically unsafe or of unknown quality without adequate disinfection.
- Testing was performed under standard laboratory conditions, actual performance may vary. For cold water use only.
- This filter must be protected from freezing, which can cause cracking of the filter and water leakage.
- Do not allow children under 3 years of age to have access to small parts during installation.
- The installation must comply with all applicable state and local regulations.

STEP 1: CONNECT THE FILTER SYSTEM WITH THE HOSES

1. Connect the inlet water hose to the supply end of the water filter system.

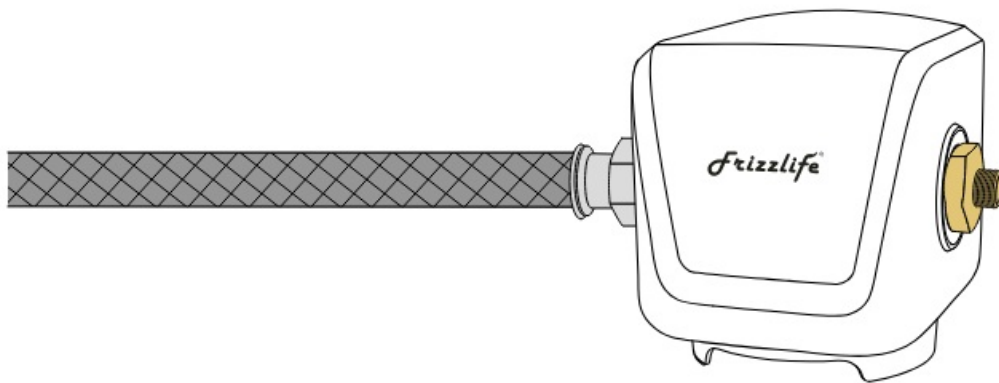

STEP 2 INSTALL THE SYSTEM ONTO A WOODEN PLATE

1. Set the sticker provided in the package on the plate to mark the spots for two screws.
2. Use an electric screwdriver to fasten the screws. Mount the system.

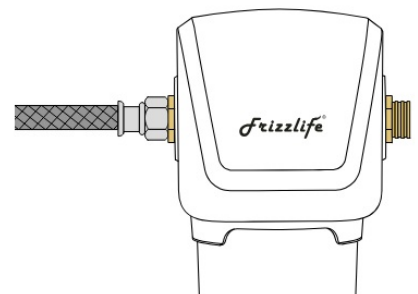

NOTE



Mount the water filter at least 4 inches lower than the bottom of the basin for easier installation

STEP 3: CONNECT THE WATER SUPPLY (COLD WATER ONLY)

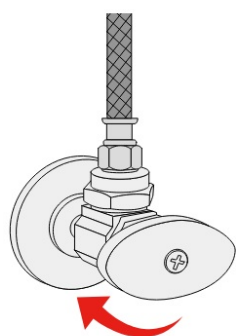

Shut off water supply

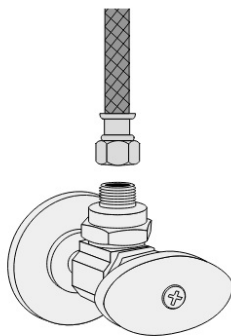

Remove original hose

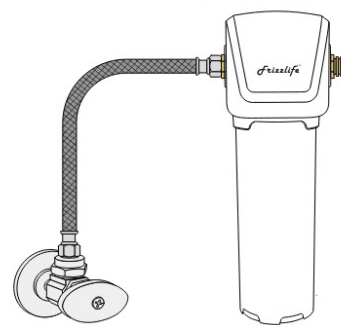

Connect inlet hose

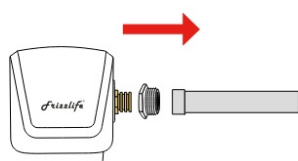

Connect the original faucet hose

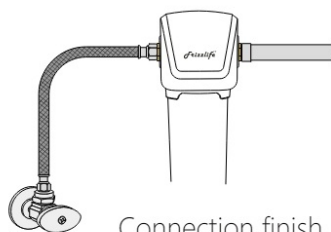

Connection finish

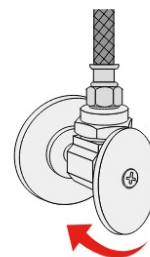

Turn on the valve

STEP 4: CHECK FOR LEAKS AND FLUSH THE FILTER

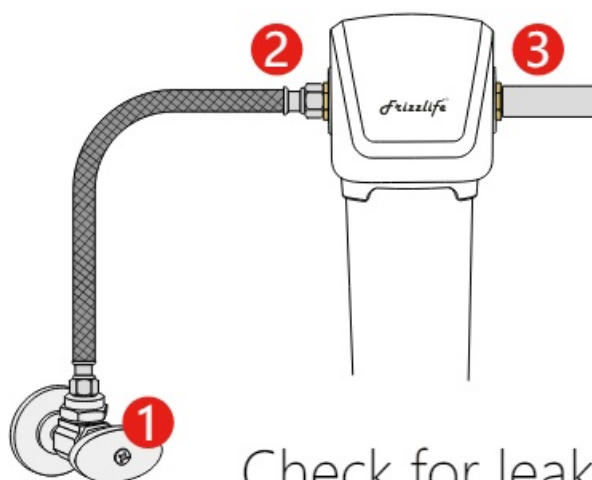

Check for leaks

1. Turn on the water supply to check for leaks
2. Flush the filter for 10 minutes before use

FILTER REPLACEMENT INSTRUCTIONS

- **STEP 1:** Twist the housing anti-clockwise;
- **STEP 2:** Using a wrench to unscrew the housing body;
- **STEP 3:** Take out the old cartridge and load it with new one, then install back in the same way.

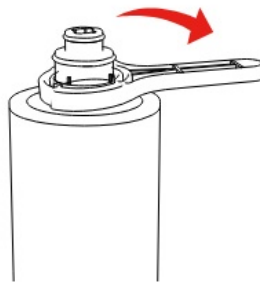
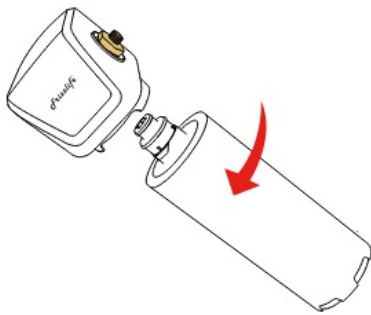

NOTE



With the AUTO Shut off design of the system, you don't need to shut off the water supply when doing the replacement.

WARNING

Please keep the wrench always

HOOK UP TO YOUR REFRIGERATOR

The FK99 Series under sink water filter system can be connected with your refrigerator/Ice-maker by utilizing an extra IMC-2 ice maker connection kit (not included).



Simply search "Frizzlife IMC-2" or Asin# "B07RBMLR26" on Amazon, or scan the QR code to purchase.

Model: FK99 Series

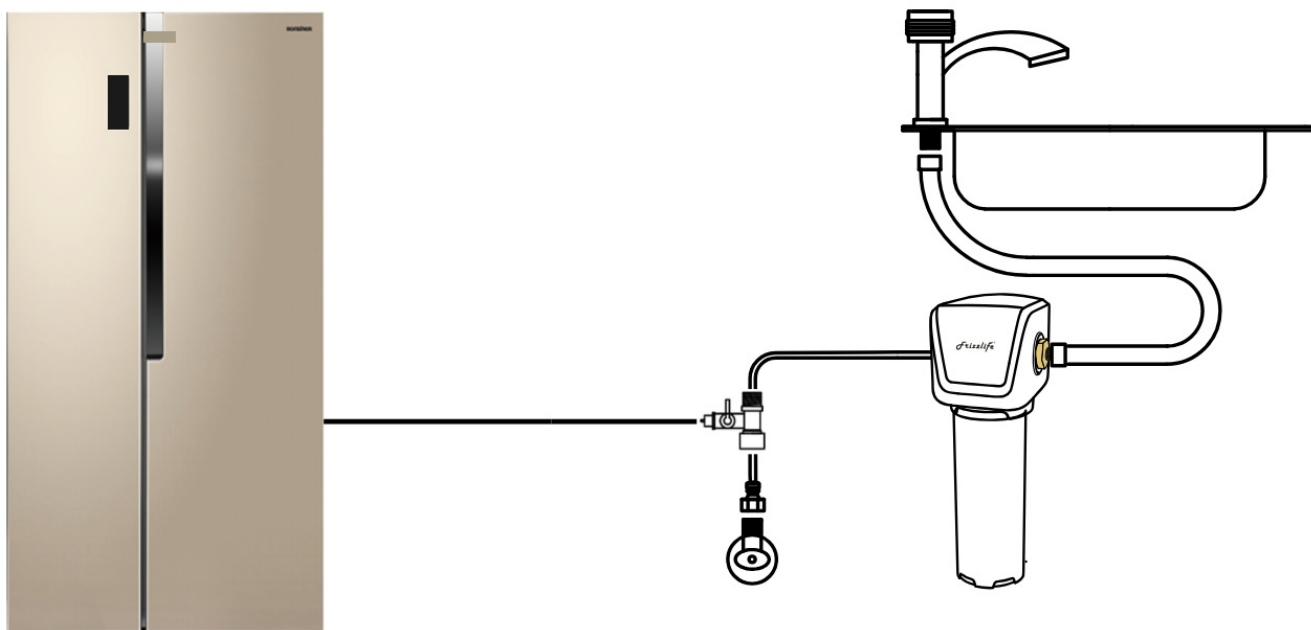

PERFORMANCE DATA

Substance	Influent challenge concentration (mg/L)	Maximum permissible product water concentration (mg/L)
Chlorine	2.0 mg/L \pm 10%	\geq 50%
Particulate, Class I Particles 0.5 to $<1\mu\text{m}$	At least 10,000 particles/mL	\geq 85%
Lead	0.15 \pm 10%	0.010
Cyst	Min. 50,000/L	99.95%

TROUBLESHOOTING

1. Leaks at the threaded connection: if once the system leaks after installation, please use plumber tapes properly on the threaded fitting to prevent leakage.
2. PPM is not dropping while tested by TDS meter: Frizzlife FK99 has a unique technology that removes 99.99% of contaminants while leaving all the essential minerals in water such as Calcium, Potassium, Sodium, Magnesium ect. All healthy water has a certain level of total dissolved solids. they are essential minerals. The TDS meters are not an effective way to measure the water quality, The water without TDS is normally produced by a reverse osmosis system.

LIMITED WARRANTY

Model: FK99 Series Undersink Water Filter System / Warrantor: FRIZZLIFE INC

ONE-YEAR LIMITED FRIZZLIFE WARRANTY

The Frizzlife FK99 Series under sink water filter are warranted to the original purchaser. To be free of defects in material and workmanship by Frizzlife INC, Frizzlife will replace or repair components of the unit that Frizzlife has deemed to be broken within the limits of the warranty without charge. The customer is not responsible for any freight involved with shipping the item back for inspection and shipment of replacement items. Frizzlife is not liable for cost of removal, installation, transportation or any other charges in connection with a warranty claim.

1. Frizzlife is not liable for anything that we deem as abuse of the units, including but not limited to, misuse of product outside of intended use, equipment modifications, unauthorized repairs, improper installation, damage from freezing, hot water, fire or other acts of God outside of Frizzlife control.

This warranty will be void if defects occur due to failure to observe the following conditions:

- Incoming water to the the system cannot exceed 100°F.
- Do not use outdoors or in a location that is subjected to direct sunlight or freezing
- This warranty will not be effective unless and until the Frizzlife is shown to have been used in accordance with the installation and maintenance instructions accompanying the product.
- The filter cartridges should be replaced in time according to the recommended replacement period.

The plastic housings should be replaced every 18 months.

2. Filter Cartridges are considered as disposable items and, thus are not covered by warranty.
3. The customer is responsible for proper operation, which includes complete and continual leak inspection.
 - Most of the unit components are made of plastic and eventually can break or crack from stress.
 - Three eive watery services ease centers Lizzie at supports frize come.

Owner s Warranty Responsibility:

As a condition of this Limited Warranty, the owner must ensure that periodic maintenance of the system is performed as described in the literature enclosed with the system. Should your unit develop a defect or otherwise fail to perform in accordance with this warranty, you should contact the retailer from whom the product was originally purchased.



NOTE

IN CASE SOME STATES DO NOT ALLOW LIMITATIONS ON HOW LONG AND IMPLIED WARRANTY LASTS, YOU MAY CHOOSE TO RETURN THE SYSTEM. IF YOU CHOOSE

TO KEEP IT, YOU AGREE THAT THE ABOVE LIMITATIONS STILL APPLY TO YOU.

150% Extended Warranty

1. Email us your order ID and full name at support@frizzlife.com
2. Scan the QR code below to register



- www.frizzlife.com

Find the installation video

Search “Frizzlife FK99 installation” on www.youtube.com

Register to get 150% warranty

1. Email us your order ID and full name at support@frizzlife.com.
2. Scan the QR code to register.



Documents / Resources



[Frizzlife FK99 Series Undersink Water Filter System](#) [pdf] Installation Guide
FK99 Series Undersink Water Filter System, FK99 Series, Undersink Water Filter System, Water Filter System, Filter System, System

References

- [Water As It Should Be | Frizzlife Home Water Solution](#)

- [User Manual](#)

[Manuals+](#), [Privacy Policy](#)

This website is an independent publication and is neither affiliated with nor endorsed by any of the trademark owners. The "Bluetooth®" word mark and logos are registered trademarks owned by Bluetooth SIG, Inc. The "Wi-Fi®" word mark and logos are registered trademarks owned by the Wi-Fi Alliance. Any use of these marks on this website does not imply any affiliation with or endorsement.