



Frizzlife FK99 Series Direct Connect Under Sink Water Filter System Installation Guide

[Home](#) » [Frizzlife](#) » Frizzlife FK99 Series Direct Connect Under Sink Water Filter System Installation Guide 

Contents

- [1 Frizzlife FK99 Series Direct Connect Under Sink Water Filter System](#)
- [2 INSTALLATION INSTRUCTION](#)
- [3 Technical Parameters](#)
- [4 PRODUCT INTRODUCTION](#)
- [5 SAMPLE CONNECTION](#)
- [6 INSTALLATION TIPS](#)
- [7 INSTALLATION STEPS](#)
- [8 FILTER REPLACEMENT INSTRUCTIONS](#)
- [9 HOOK UP TO YOUR REFRIGERATOR](#)
- [10 TROUBLESHOOTING](#)
- [11 LIMITED WARRANTY](#)
- [12 Documents / Resources](#)
 - [12.1 References](#)
- [13 Related Posts](#)



Frizzlife FK99 Series Direct Connect Under Sink Water Filter System



Model: FK99 Series

Thank you for purchasing Frizzlife FK99 Series under sink water filter system with 0.5-micron composite carbon block filter. If you have any questions or need any assistance, please contact: support@frizzlife.com

Find the installation video

Search "Frizzlife FK99 installation" on www.youtube.com

Register to get 150% warranty

1. Email us your order ID and full name at support@frizzlife.com.
2. Scan the QR code to register.



INSTALLATION INSTRUCTION

Before Installation

Inspect Box

Open the box and take out the system and all the components. Inspect them carefully according to “Product Introduction” and make sure nothing is missing or damaged during shipping. If any parts are cracked or broken, please do not proceed with the installation and contact Frizzlife for an exchange or diagnosis

Technical Parameters

Model Name	FK99	FK99M	FK99L
Dimension	4.9 x 6.1 x 15 in	4.9 x 6.1 x 18.9 in	4.9 x 6.1 x 21.1 in
Replacement Filter	PLC10	PLC15	PLC20
Replacement Period	12 m/10000 Gal.	24 m/20000 Gal.	36 m/30000 Gal.
Flow Rate	2 Gallons/min.@60 psi		
Applicable Water Source	Municipal Water		
Operating Temp.	Min.39 F , Max.100 F		
Working pressure	Min. 20 psi, Max. 80 psi		

Rated flow 2 gallons/m @25 C (77 F). Low water temperature will slow down water flow. Please contact us for reference at: support@frizzlife.com

PRODUCT INTRODUCTION

Part List

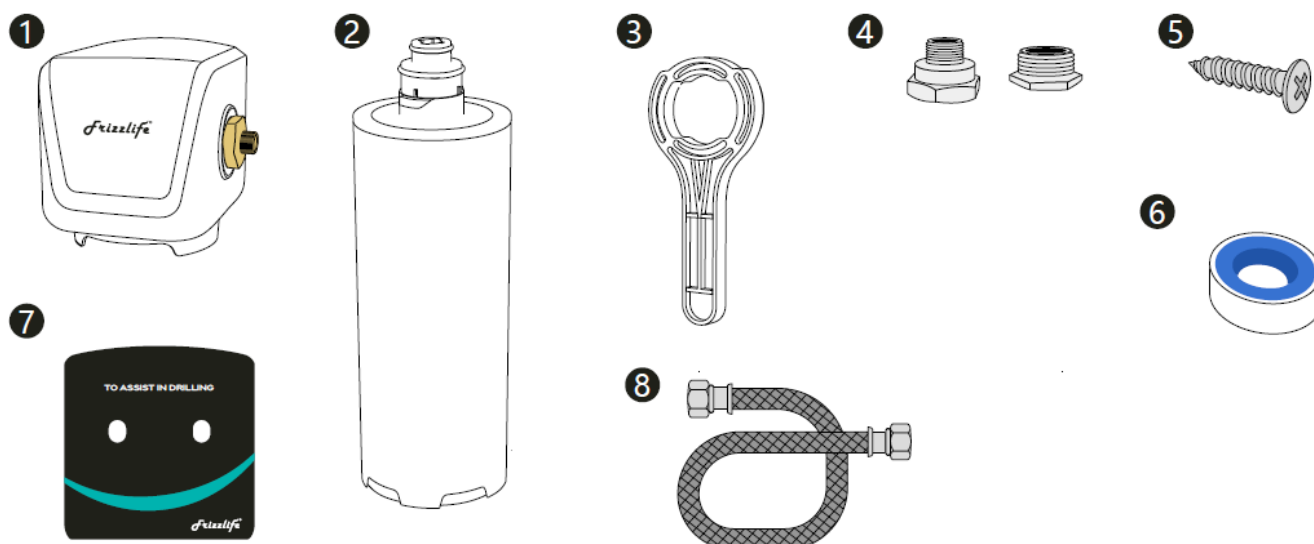

1. System Cap
2. Water Filter Cartridge with filter loaded
3. Housing Wrench
4. 3/8" -1/2" converter
5. Mount-up Screws

6. Teflon Tape
7. Drilling Hole Sticker
8. Inlet hose

SAMPLE CONNECTION

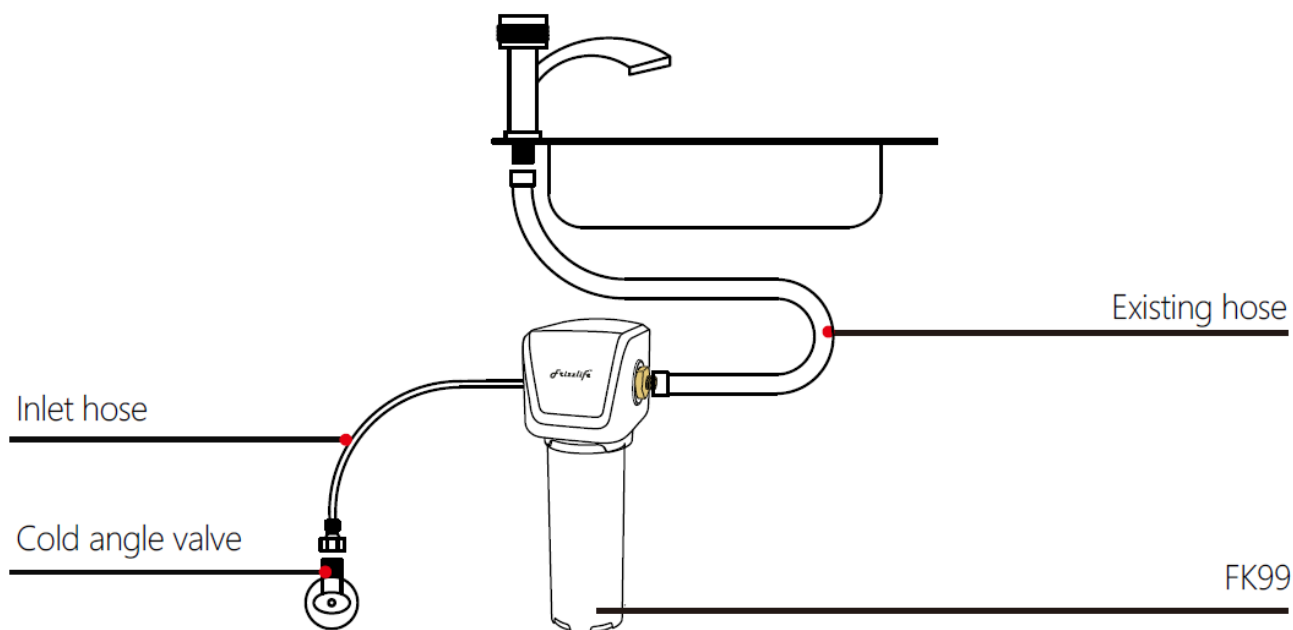

INSTALLATION TIPS

IF YOUR VALVE IS 1/2"

IF ANGLE VALVE OUTLET IS 3/8"



3/8" Comp (9/16" thread)

IF ANGLE VALVE OUTLET IS 1/2"



+



1/2" thread

CONNECT ONE PART OF THE CONVERTER TO THE ANGLE VALVE

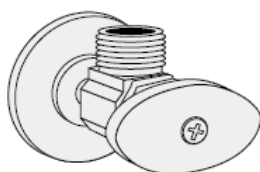

1/2" thread

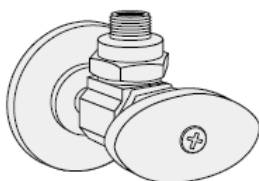

1/2" to 3/8"

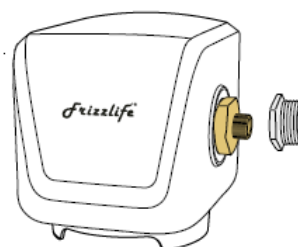

Outlet Port ► 3/8" to 1/2"

INSTALLATION STEPS

Precautions:

- Do not use with water that is microbiologically unsafe or of unknown quality without adequate disinfection.
- Testing was performed under standard laboratory conditions, actual performance may vary.
- For cold water use only.
- This filter must be protected from freezing, which can cause cracking of the filter and water leakage.
- Do not allow children under 3 years of age to have access to small parts during installation.
- The installation must comply with all applicable state and local regulations.

STEP 1: CONNECT THE FILTER SYSTEM WITH THE HOSES

Connect the inlet water hose to the supply end of the water filter system.

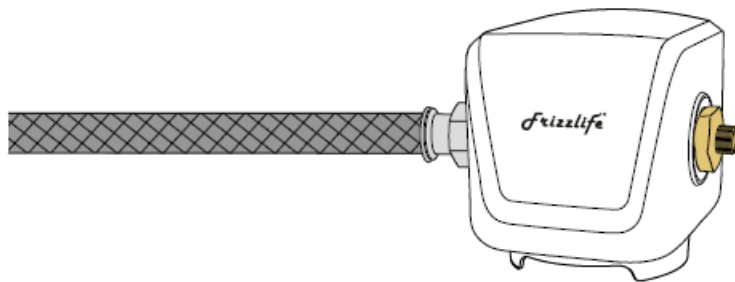

STEP 2 INSTALL THE SYSTEM ONTO A WOODEN PLATE

1. Set the sticker provided in the package on the plate to mark the spots for two screws.
2. Use an electric screwdriver to fasten the screws. Mount the system

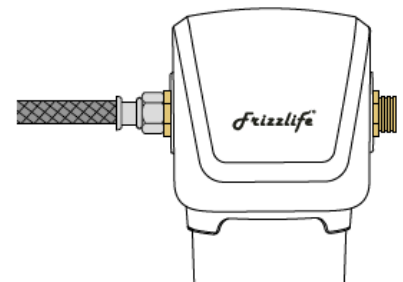
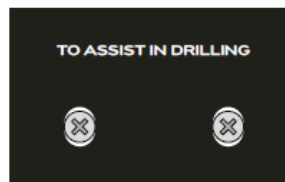
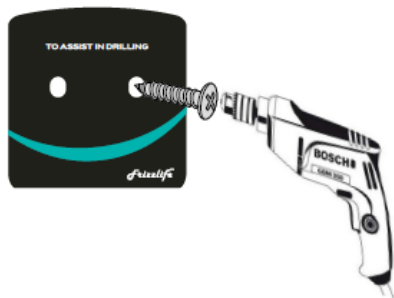

STEP 3: CONNECT THE WATER SUPPLY (COLD WATER ONLY)

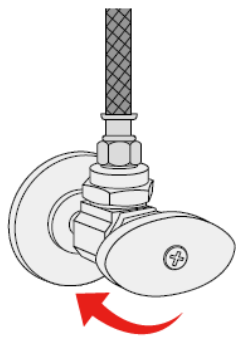

Shut off water supply

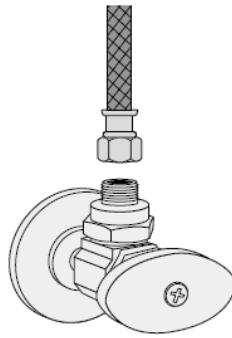

Remove original hose

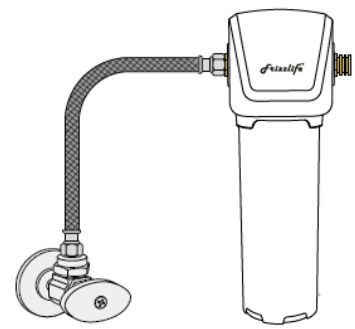

Connect inlet hose

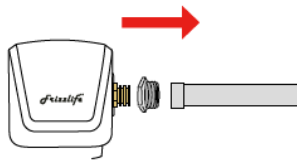

Connect the original faucet hose

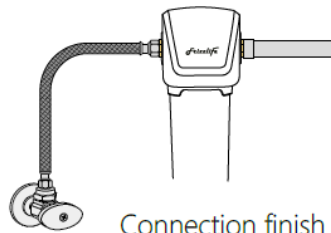

Connection finish

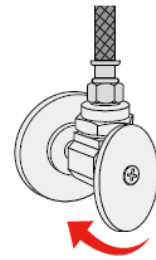

Turn on the valve

STEP 4: CHECK FOR LEAKS AND FLUSH THE FILTER

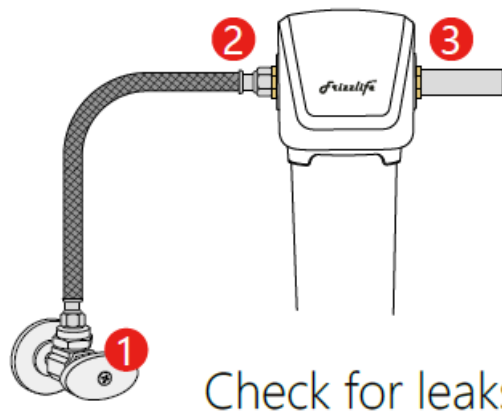

Check for leaks

1. Turn on the water supply to check for leaks
2. Flush the filter for 10 minutes before use

FILTER REPLACEMENT INSTRUCTIONS

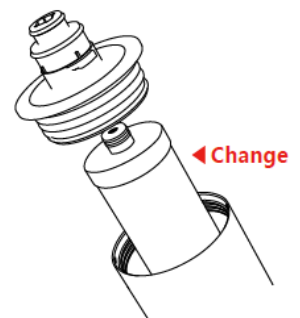
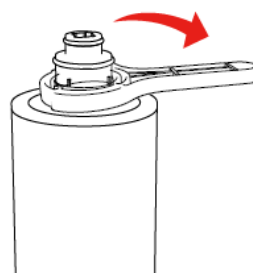
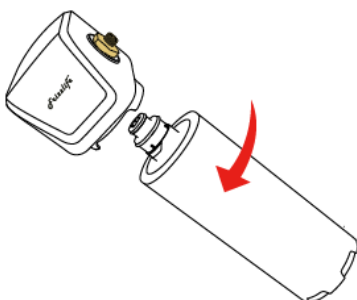

- **STEP 1:** Twist the housing anti-clockwise;

- **STEP 2:** Using wrench to unscrew the housing body;
- **STEP 3:** Take out the old cartridge and load with new one, then install back in the same way.

NOTE

With the AUTO Shut off design of the system, you don't need to shut off the water supply when doing the replacement

WARNING

Please keep the wrench always

HOOK UP TO YOUR REFRIGERATOR



The FK99 Series under sink water filter system can be connected with your refrigerator/Ice-maker by utilizing an extra IMC-2 ice maker connection kit (not included).

Simply search "Frizzlife IMC-2" or Asin# "B07RBMLR26" on Amazon, or scan the QR code to purchase.

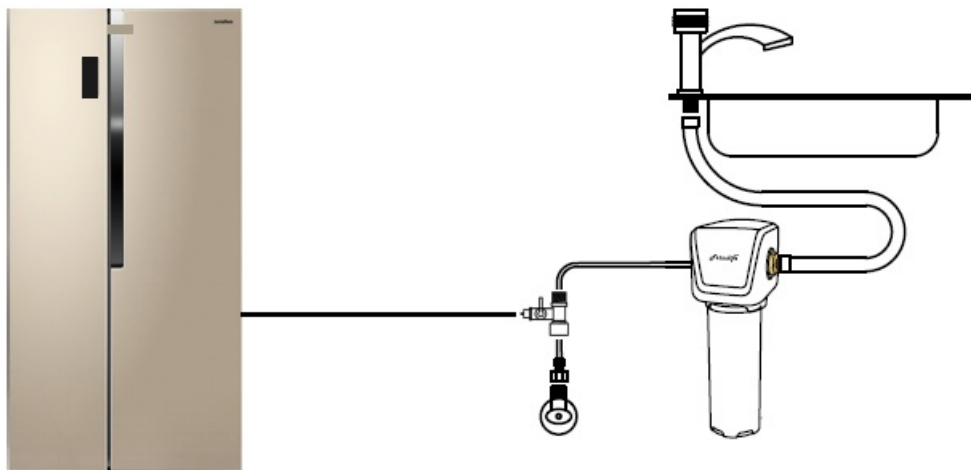

PERFORMANCE DATA

Substance	Influent challenge concentration (mg/L)	Maximum permissible product water concentration (mg/L)
Chlorine	2.0 mg/L \pm 10%	\geq 50%
Particulate, Class I Particles 0.5 to <1 μ m	At least 10,000 particles/mL	\geq 85%
Lead	0.15 \pm 10%	0.010
Cyst	Min. 50,000/L	99.95%

TROUBLESHOOTING

1. Leaks at the threaded connection: If the system leaks after installation, please use plumber tapes properly on the threaded fitting to prevent leakage.
2. PPM is not dropping while tested by TDS meter: Frizzlife FK99 has a unique technology that removes 99.99% of contaminants while leaving all the essential minerals in water such as Calcium, Potassium, Sodium, Magnesium etc. All healthy water has a certain level of total dissolved solids. they are essential minerals. The TDS meters are not an effective way to measure the water quality, The water without TDS is normally produced by a reverse osmosis system.

LIMITED WARRANTY

Model: FK99 Series Undersink Water Filter System

Warrantor: FRIZZLIFE INC

ONE-YEAR LIMITED FRIZZLIFE WARRANTY

The Frizzlife FK99 Series under sink reverse osmosis units are warranted to the original purchaser. To be free of defects in material and workmanship by Frizzlife INC, Frizzlife will replace or repair components of the unit that Frizzlife has deemed to be broken within the limits of the warranty without charge. The customer is not responsible for any freight involved with shipping the item back for inspection and shipment of replacement items. Frizzlife is not liable for cost of removal, installation, transportation or any other charges in connection with a warranty claim

1. Frizzlife is not liable for anything that we deem as abuse of the units, including but not limited to, misuse of product outside of intended use, equipment modifications, unauthorized repairs, improper installation, damage from freezing, hot water, fire or other acts of God outside of Frizzlife control

This warranty will be void if defects occur due to failure to observe the following conditions:

1. Incoming water to the system cannot exceed 100°F.
2. Do not use outdoors or in a location that is subjected to direct sunlight or freezing. This warranty will not be effective unless and until the Frizzlife is shown to have been used in accordance with the installation and maintenance instructions accompanying the product.
2. Filter Cartridges are considered as disposable items, thus are not covered by warranty.
3. The customer is responsible for proper operation, which includes complete and continual leak inspection.
 1. Most of the unit components are made of plastic and eventually can break or crack from stress.
 2. There are no other warranties that extend beyond what is described above.
 3. To receive warranty service, please contact Frizzlife at support@frizzlife.com

Owner™ s Warranty Responsibility:

As a condition of this Limited Warranty, the owner must ensure that periodic maintenance of the system is performed as described in the literature enclosed with the system. Should your unit develop a defect or otherwise fail to perform in accordance with this warranty, you should contact the retailer from whom the product was originally purchased.

NOTE

IN CASE SOME STATES DO NOT ALLOW LIMITATIONS ON HOW LONG AND IMPLIED WARRANTY LASTS, YOU MAY CHOOSE TO RETURN THE SYSTEM. IF YOU CHOOSE TO KEEP IT, YOU AGREE THAT THE ABOVE LIMITATIONS STILL APPLY TO YOU.

150% Extended Warranty

1. Email us your order ID and full name at support@frizzlife.com
2. Scan the QR code below to register



www.frizzlife.com

Documents / Resources

The image shows the front cover of a technical manual. At the top, it says "INSTALLATION GUIDE" in white capital letters on a black background. Below that, it says "For FK99 Series" in smaller white text. The central part of the cover features a photograph of the water filter unit, which is a black cylindrical device with a white top and bottom. The background of the cover is dark with some light-colored, abstract, wavy lines at the bottom.	<p>Frizzlife FK99 Series Direct Connect Under Sink Water Filter System [pdf] Installation Guide</p> <p>FK99 Series Direct Connect Under Sink Water Filter System, FK99 Series, FK99 Series Water Filter System, Direct Connect Under Sink Water Filter System, Under Sink Water Filter System, Direct Connect Water Filter System, Water Filter System, Water Filter, Filter System, Filter</p>
--	---

References

- [Water Filters | Water Purification Systems | Frizzlife Water Solutions](#)