

FRIGIDAIRE  
EFIC220-  
BLACK-6COM  
Touchscreen  
Nugget Ice  
Maker



## Contents

- [1 FRIGIDAIRE EFIC220-BLACK-6COM Touchscreen Nugget Ice Maker](#)
- [2 Specifications](#)
- [3 INTRODUCTION](#)
- [4 IMPORTANT SAFETY INFORMATION](#)
- [5 SAFETY INSTRUCTIONS](#)
- [6 GETTING TO KNOW YOUR UNIT](#)
- [7 OPERATING PROCEDURES & MAINTENANCE](#)
- [8 CONNECTING YOUR ICE MAKER](#)
- [9 USING YOUR ICE MAKER](#)
- [10 FAQs](#)
- [11 Documents / Resources](#)
  - [11.1 References](#)
- [12 Related Posts](#)

## FRIGIDAIRE EFIC220-BLACK-6COM Touchscreen Nugget Ice Maker

### Specifications

- **Model Variants:** EFIC220-BLACK-6COM, EFIC220-GREY-6COM, EFIC220-NAVY-6COM
- **Type:** Ice Maker
- **Country of Manufacture:** USA, Canada
- **Power Requirement:** 15 AMP, 110-115 VOLT, 60 Hz GROUNDED OUTLET

### INTRODUCTION

**Welcome to our family:** Thank you for bringing Frigidaire into your home! We see your purchase as the beginning of a long relationship together. This manual is your resource for the use and care of your product. Please read it before using your appliance. Keep it handy for quick reference. If something doesn't seem right, the troubleshooting section will help you with common issues. FAQs, helpful tips and videos, cleaning products, and kitchen and home accessories are available at [www.frigidaire.com](http://www.frigidaire.com).

- When you unpack your ice maker, you may find a small amount of water inside.
- Your unit is brand new.
- Any water you may find is from the standard quality control testing that all of our ice makers undergo as part of the manufacturing process.
- Please follow the initial preparation and cleaning instructions as detailed in the User Guide prior to using your new icemaker.
- When using, please avoid direct sunlight.

## Installation Checklist

- **Leveling**
  - Cabinet is setting solid on all corners
- **Electrical Power**
  - House power turned on
- **Ice Maker**
  - Ice maker is turned ON
- **Final Checks**
  - Shipping material removed

## IMPORTANT SAFETY INFORMATION



**WARNING** Please read all instructions before using this appliance.

### • Safety Definitions



This is the safety alert symbol. It is used to alert of potential personal injury hazards. Obey all safety messages that follow this symbol to avoid possible injury or death.



- **DANGER** DANGER indicates an imminently hazardous situation which, if not avoided, will result in death or serious injury.



- **WARNING** indicates a potentially hazardous situation which, if not avoided, could result in death or serious injury.



- **CAUTION** indicates a potentially hazardous situation which, if not avoided, may result in minor or moderate injury.
- **IMPORTANT** indicates installation, operation or maintenance information which is important but not hazard-related.

## Child Safety

- Destroy or recycle the carton, plastic bags, and any exterior wrapping material immediately after the Ice Maker is unpacked. Children should NEVER use these items to play. Cartons covered with rugs, bedspreads, plastic sheets or stretch wrap may become airtight chambers, and can quickly cause suffocation.

## Safety Instructions

- DO NOT store or use gasoline, or other flammable liquids in the vicinity of this or any other appliance. Read product labels for warnings regarding flammability and other hazards.
- Avoid contact with any moving parts of automatic ice maker.
- Remove all staples from the carton. Staples can cause severe cuts, and also destroy finishes if they come in contact with other appliances or furniture.

## SAFETY INSTRUCTIONS

This appliance must be plugged into at least a 15 AMP 110-115 VOLT 60 Hz GROUNDED OUTLET. This appliance must be grounded. It is equipped with a 3-wire cord having a grounding plug. The plug must be plugged into an outlet that is properly installed and grounded.

**WARNING!** Improper use of grounded wire can result in the risk of electric shock. Consult a physician if necessary. Do not attempt to defeat this safety feature by modifying the plug.

Avoid the use of an extension cord because it may overheat and cause a risk of fire. However, if it is necessary to use an extension cord:

- **A.** Use only 3-wire extension cords with 3-blade grounding plug.
- **B.** The marked rating of an extension cord must be equal to or greater than the rating of this appliance.
- **C.** It should be positioned such that it does not drape over the counter or tabletop where it can be pulled on by children intentionally.

### Attempting any maintenance or cleaning:

To minimize the possibility of electric shock, unplug this appliance from the power supply or disconnect at the household distribution panel by removing the fuse or switching off the circuit breaker before attempting any maintenance or cleaning.

**NOTE:** Pressing the Power Ice/Clean button to an off position does not disconnect the appliance from the power supply.

### Warning:\*\*

#### **\*\*IMPORTANT NOTICE: Use Only Water\*\***

We want to ensure the safe and efficient operation of your ice maker. Please be aware that this appliance is designed for one specific purpose – to make ice from water. Do not use any beverages, liquids, or substances other than water in this ice maker. Using anything other than water may lead to damage, malfunctions, and potentially hazardous situations therefore voiding your warranty.

#### **\*\*Why Use Only Water:\*\***

1. **\*\*Safety:\*\*** Introducing beverages or non-water substances can result in chemical reactions or build-up that could pose safety risks.
2. **\*\*Performance:\*\*** Using water ensures that your ice maker functions as intended, producing clean and odorless ice cubes.
3. **\*\*Durability:\*\*** Water is the only liquid that will not corrode or damage the internal components of your ice maker, preserving its lifespan.

#### **\*\*Consequences of Using Beverages:\*\***

- **\*\*Damage:\*\*** Non-water substances can corrode, clog, or damage the internal components, resulting in costly repairs or replacement.
- **\*\*Health Concerns:\*\*** Using beverages may introduce contaminants into the ice-making process, potentially impacting the safety of the ice produced.

- **\*\*Voided Warranty:\*\*** Using beverages or non-water substances may void your appliance's warranty, leaving you responsible for any repair or replacement costs.
- To ensure the longevity and reliability of your ice maker, always follow these guidelines strictly. Only use clean, potable water in your ice maker to guarantee safe and refreshing ice for all your beverage needs.
- If you have any questions or concerns regarding the proper usage of your ice maker, please refer to the user manual or contact our customer support for assistance.

## GETTING TO KNOW YOUR UNIT

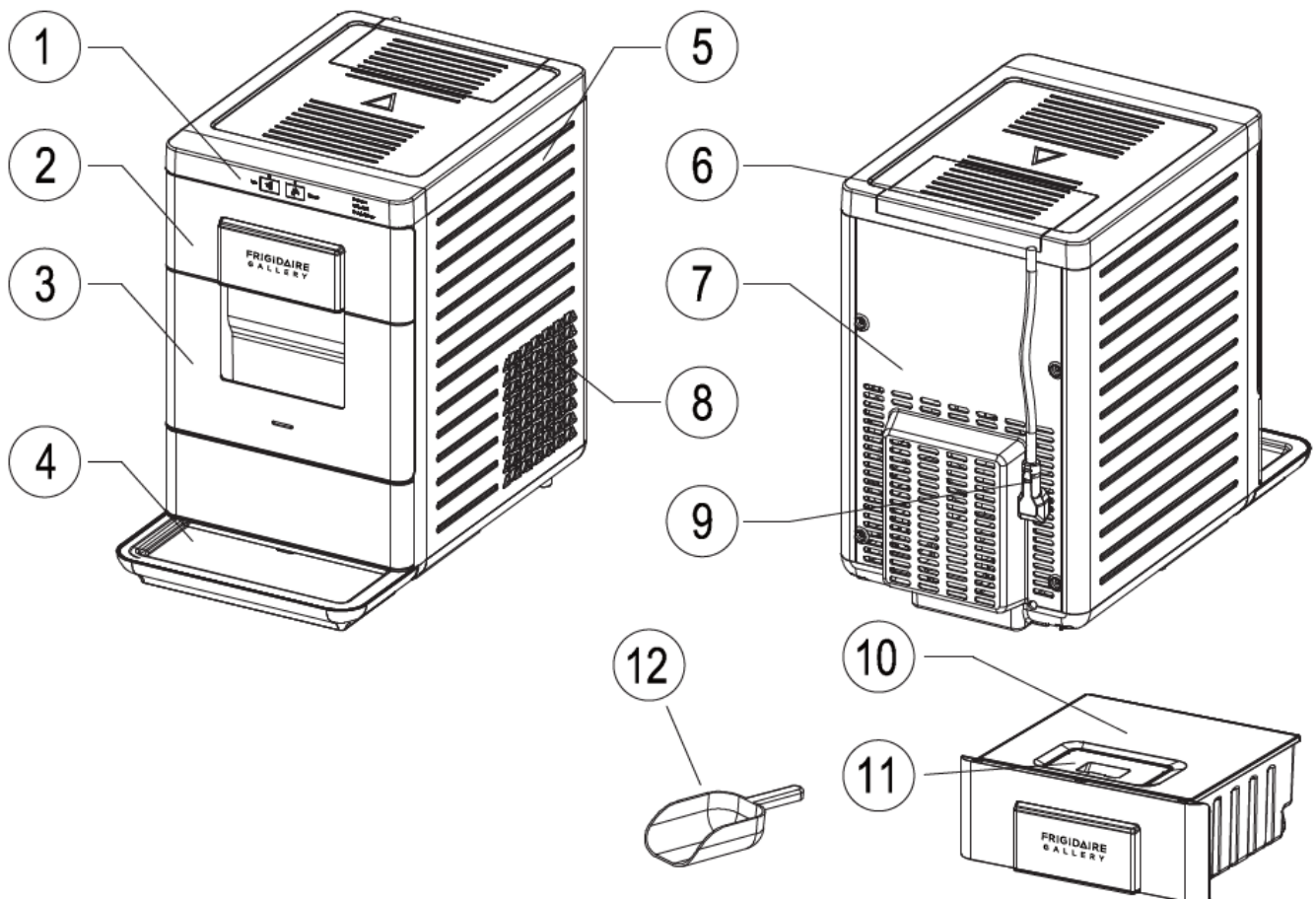

1. Control panel
2. Drawer water tank: drawer for water
3. Drawer ice basket: drawer for ice
4. Drip tray
5. Unit shell
6. Tip-up door: After opening this door, you can directly clean the internal water tank
7. Rear Panel
8. Hot air outlet
9. Power cord
10. Cover: cover for drawer water tank
11. Ice scoop
12. Lid: you can open the lid and pour the water into the tank

Come equipped with a premium stainless steel ice scoop, allowing for easy and hygienic handling of ice.

## OPERATING PROCEDURES & MAINTENANCE

### UNPACKING YOUR ICE MAKER

1. Remove the exterior and interior packaging, and then check all the accessories are included. If any parts are missing, please contact our customer service.
2. Remove all the tapes on the unit; take out the accessory parts inside.
3. Clean the interior with lukewarm water and a soft cloth.
4. Locating your ice maker on a level counter table far from direct sunlight and other sources of heat (i.e.: stove, furnace, and radiator). Make sure that there is at least 6 inches between the back and sides of your ice maker with the wall.
5. Allow one hour for the refrigerant fluid to settle down before plugging your ice maker in.
6. The power plug must be accessible directly.
  - **WARNING:** Fill with drinking water (potable water) only.

### CONNECTING YOUR ICE MAKER

**DANGER** \*Improper use of the grounded plug can result in the risk of electrical shock. If the power cord is damaged please call our customer service.

1. This unit should be properly grounded for your safety. The power cord of this appliance is equipped with a grounding plug which mates with standard grounding wall outlets to minimize the possibility of electric shock.
2. Plug your appliance into an exclusive, properly installed, grounding wall outlet. Do not be under any circumstances; damage the grounding means of the plug. Any questions concerning power and or grounding should be directed toward a certified electrician.
3. This appliance requires a standard 110-120Volt, 60Hz electrical outlet with good grounding means.

### CLEANING AND MAINTAINING YOUR ICE MAKER

Before using your ice maker, it is strongly recommended to clean it thoroughly. Unplug the unit before cleaning or making any maintenance.

1. Take out the drawer water tank and drawer ice basket.
2. Clean the interior with commercial descaling solution specifically designed for ice makers, warm water and a soft cloth. First pour the warm water with diluted descaling solution into the internal water reservoir, and then use the soft cloth to wipe the surface.
3. Again use the water to rinse the inside parts, and drain out the water by unplugging the drain cap on the back.
4. The outside of the ice maker should be cleaned regularly with a mild commercial descaling solution specifically designed for ice makers and warm water.
5. Dry the interior and exterior with a soft cloth.
6. When the appliance is not in use for a long time, open water drain cap to drain out water completely from water reservoir.

### USING YOUR ICE MAKER

## How to start the unit

1. Pull out the drawer water tank, Open the lid of the drawer water tank, pour potable water into drawer water tank, until the drawer water tank is filled with water, then push it back to the original place.
2. Before you put back the drawer ice basket, please make sure the water tank under the drawer ice basket is empty if is not, unplug water drain plug to drain out water completely.
3. Put the drip tray in position

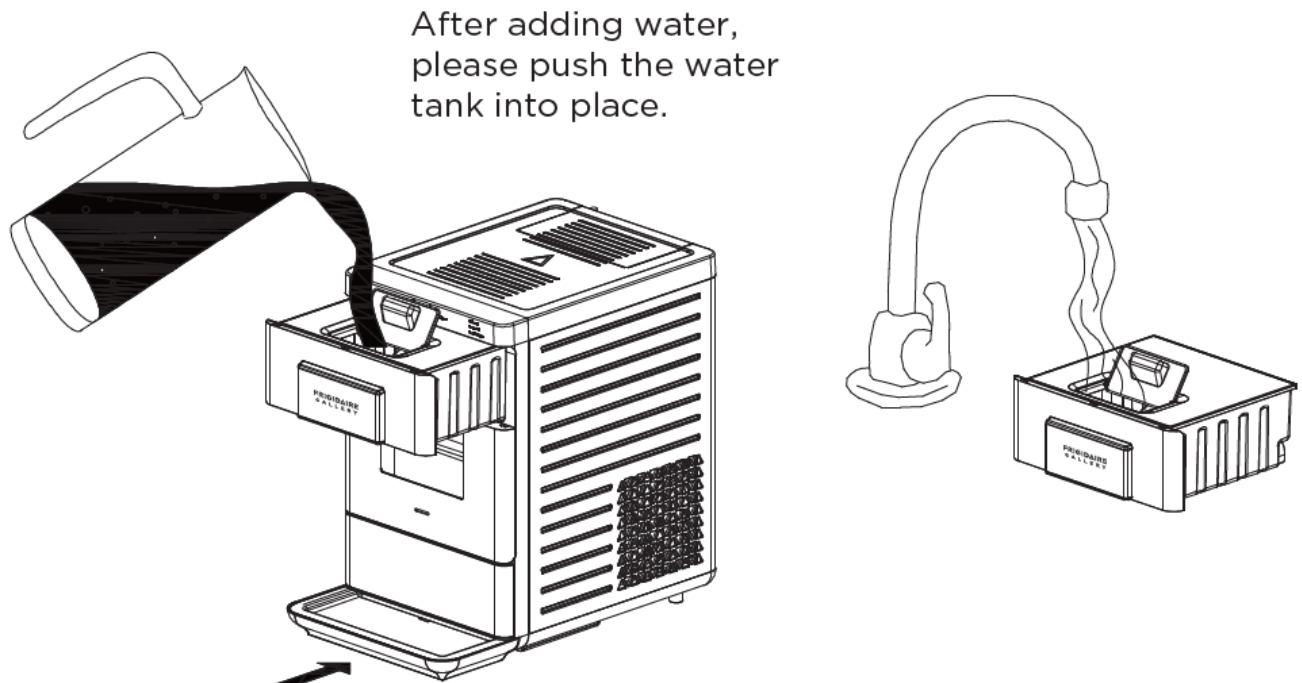

### • Operation and display areas

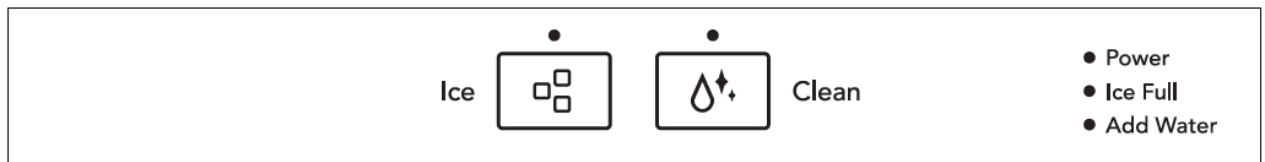

4. Plug in the power cord, the power indicator is on: you can operate this appliance by touch the button on panel as shown above, the main function includes: ice and clean
  - **Clean** For the first time, or the clean procedure has not been running for a long time, it is highly recommended to run this procedure at first.
5. Before clean procedure, please fill the drawer tank with water and check the drainpipe under the appliance, make sure the water drain cap has been inserted into the unit; otherwise the appliance will not work properly.
6. Press "CLEAN" button "", the icon lights up, it will run cleaning procedure for at least 20 minutes, then the icon goes out. Press this button again, it will stop cleaning.
7. After cleaning procedure, move the appliance to the edge of the desktop, make sure that the appliance is placed steady, place a water container under the appliance, remove drain plug from the bottom, water in the tank under the drawer and the evaporator will drain into the water container, then reinsert the plug.

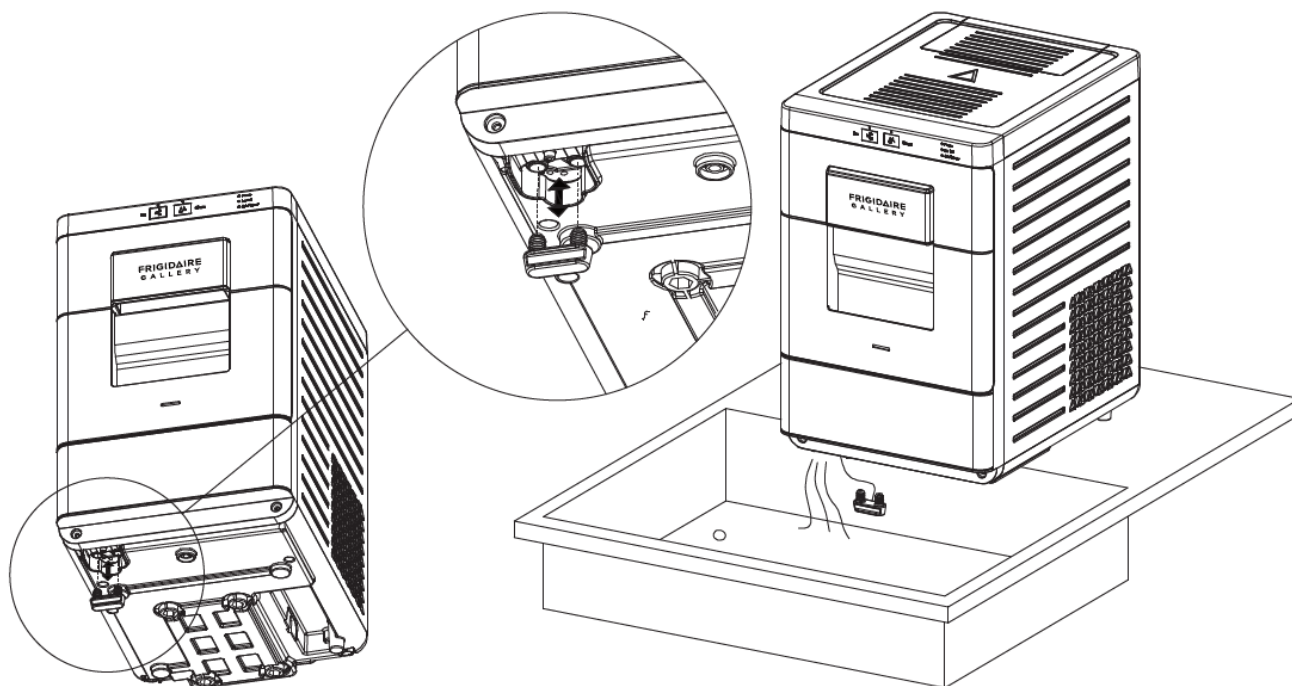

- Change water in the water reservoir every 24 hours to ensure a reasonable hygiene level. If the unit isn't to be used, drain all water & dry the water reservoir.

- **How to obtain the ice-cube**

- Before we start making ice, first please fill the drawer water tank with water and check the drainpipe behind the appliance, make sure the water drain cap has been inserted into the drainpipe; otherwise the appliance will not work properly.



- Press the "ICE" button "  ", the icon lights up, it begins to work. Press this button again, it will stop making ice.
- For the first time, or if the appliance has not been used for a long time, it is recommended to clean this appliance before you start to make ice.
- While the ice-maker is on, verify water level periodically. If water pump can't pump out water, the ice maker will stop automatically, and the "Add water" indicator will on. Need to pour water into the drawer water tank, then press the "ICE" button twice to restart ice-making.

**When Ice Full indicator is on**

- The ice maker automatically stops working when the ice-cube is full inside and the "ice full" Indicator is on.

**Open the Drawer Ice Basket**

- Hold the drawer handle gently and pull it out along the horizontal direction, until the back of the drawer contacts the front panel and then gently put it down, the drawer will have a certain angle hanging in the front panel. Instead, when you need to close the drawer, hold the drawer handle and place the drawer horizontally, then gently push it into full closure.



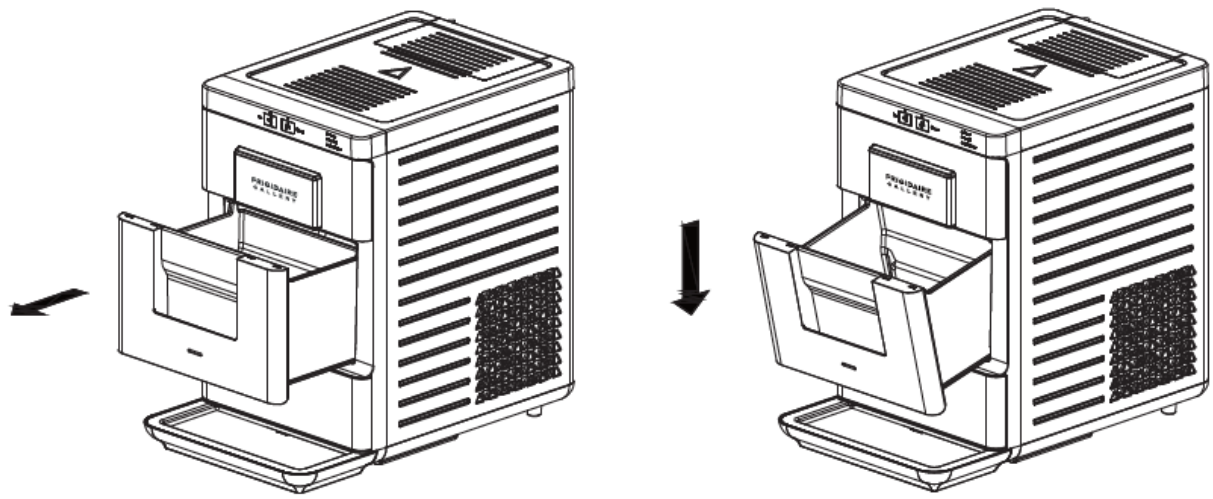

#### **Take Out the Drawer Ice Basket**

14. Hold the drawer handle gently and pull it out along the horizontal direction, until the back of the drawer contacts the front panel and then gently put it down, the drawer will have a certain angle hanging in the front panel. Instead, when you need to close the drawer, hold the drawer handle and place the drawer horizontally, then gently push it into full closure.

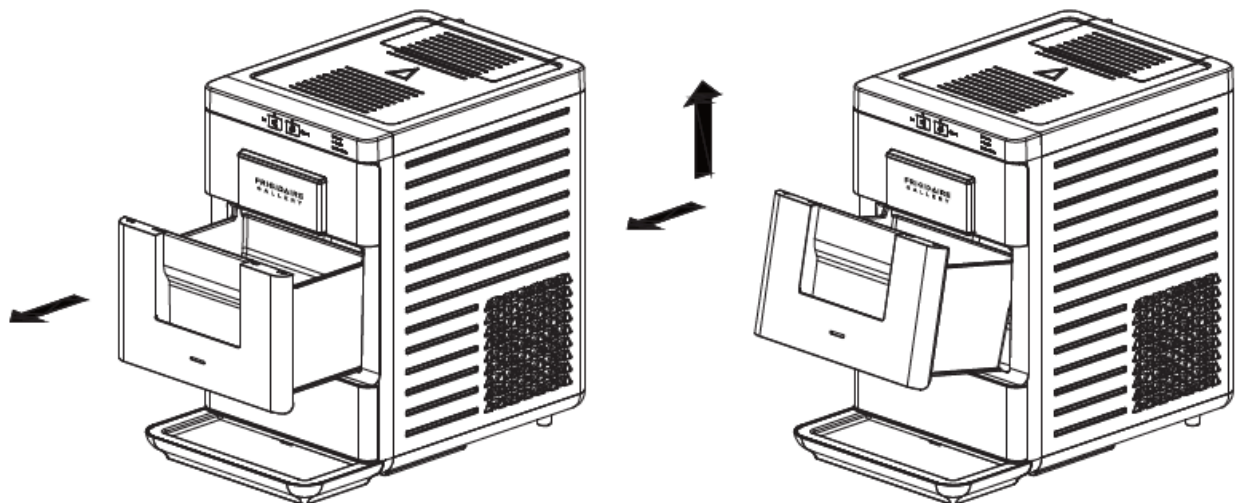

#### **Open the Drawer Water Tank and Add Water**

15. Hold the handle of the drawer and gently pull it out in a horizontal direction until the bottom of the drawer hooks the mouth frame and then gently lower it. At this time, you can open the lid of the water filler and start adding water. Conversely, when it needs to be closed, hold the drawer handle and gently push it in until it is fully closed.



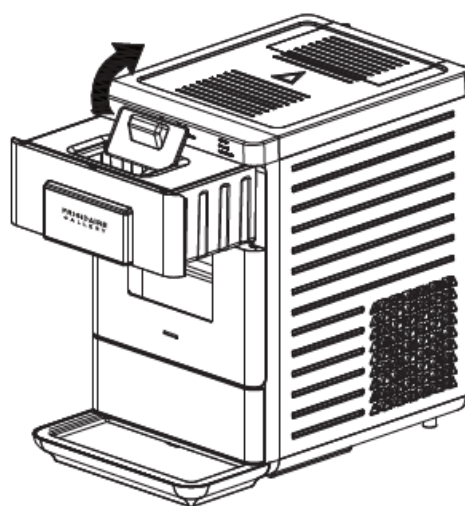
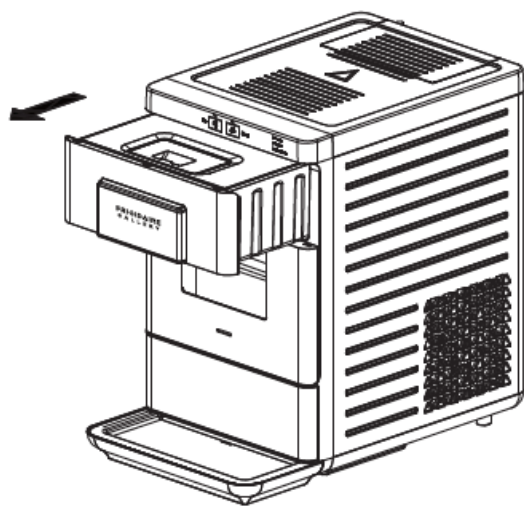

### Take Out the Drawer Water Tank

16. Pull the water tank outward in a horizontal direction, and when the panel frame is about to be pulled out, hold the water tank with the other hand to prevent it from falling. When placing the water tank back, first use your hands to support the tank and align it with the panel frame, then push it horizontally. Note that the water tank must be completely pushed to the bottom, otherwise the waterway may not be connected.

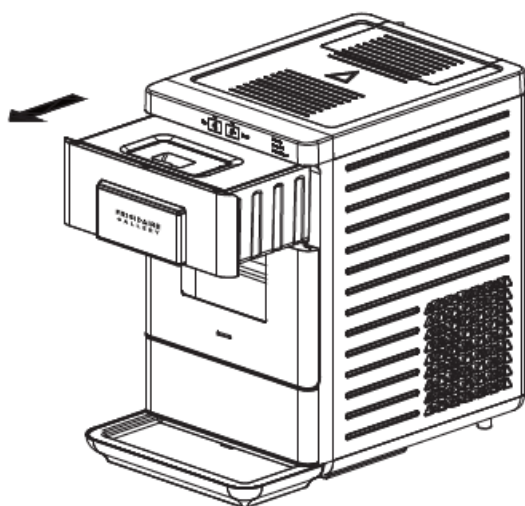

### FAQs

- **Q: Can children use the ice maker?**
  - **A:** Children should not use the ice maker unsupervised, and they should never play with the packaging materials.
- **Q: What should I do if any parts are missing upon unpacking?**
  - **A:** Please contact our customer service immediately for assistance in case of missing parts.
- **Q: Can I modify the plug of the appliance?**
  - **A:** Do not attempt to modify the plug as it can pose a risk of electric shock. Consult a professional if needed.

### Documents / Resources

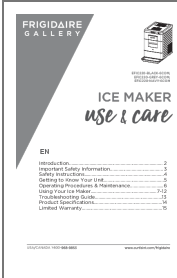

[FRIGIDAIRE EFIC220-BLACK-6COM Touchscreen Nugget Ice Maker \[pdf\]](#) Instruction Manual  
EFIC220-BLACK-6COM, EFIC220-GREY-6COM, EFIC220-NAVY-6COM, EFIC220-BLACK-6COM Touchscreen Nugget Ice Maker, EFIC220-BLACK-6COM, Touchscreen Nugget Ice Maker, Nugget Ice Maker, Ice Maker

References

- [Curtis International - Affordable TVs, electronics and appliances](#)
- [User Manual](#)

[Manuals+](#), [Privacy Policy](#) | [@manuals.plus](#) | [YouTube](#)

This website is an independent publication and is neither affiliated with nor endorsed by any of the trademark owners. The "Bluetooth®" word mark and logos are registered trademarks owned by Bluetooth SIG, Inc. The "Wi-Fi®" word mark and logos are registered trademarks owned by the Wi-Fi Alliance. Any use of these marks on this website does not imply any affiliation with or endorsement.