



FRICO PF Smart App User Manual

[Home](#) » [FRICO](#) » FRICO PF Smart App User Manual 

FRICO

PF Smart App
Original instructions



Our Address

Prevent, Adremit Limited, Unit 5a, Commercial Yard,
Settle, North Yorkshire, BD24 9RH

Contents

- 1 PF Smart App
- 2 Wall installation
- 3 Default settings
- 4 General symbols
- 5 Documents / Resources
 - 5.1 References
- 6 Related Posts

PF Smart App

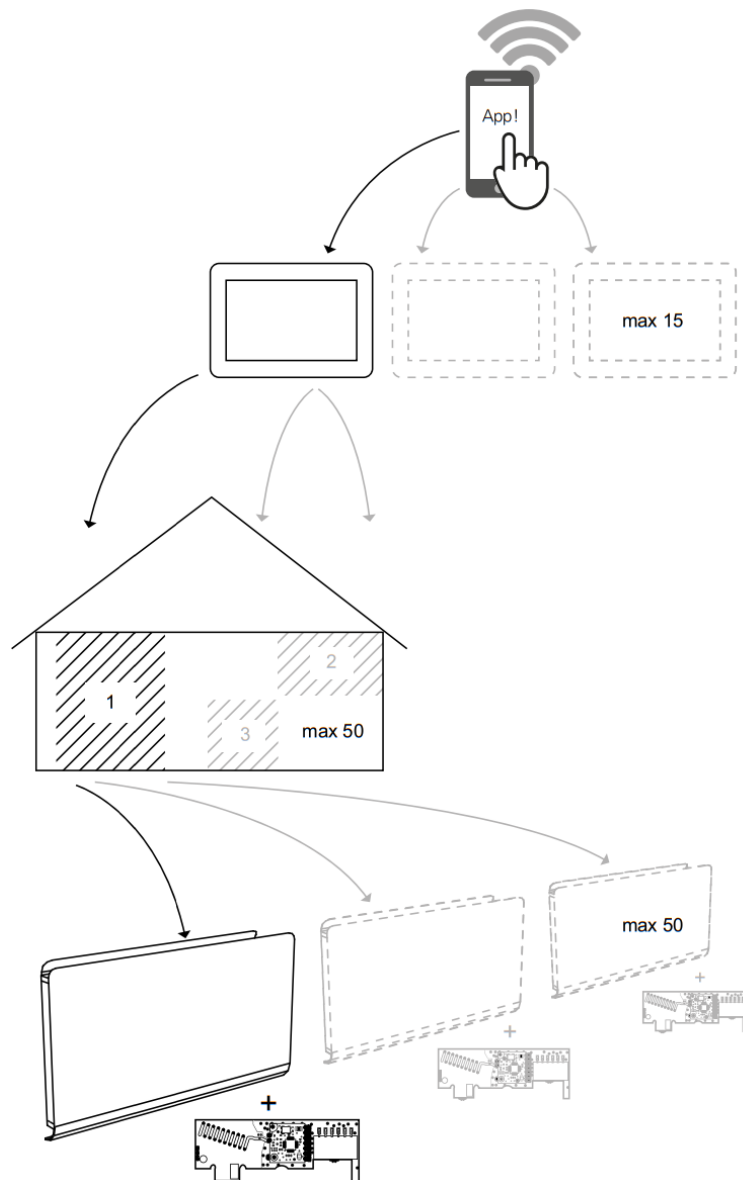

PFSRF

1

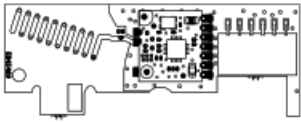

2



A

2

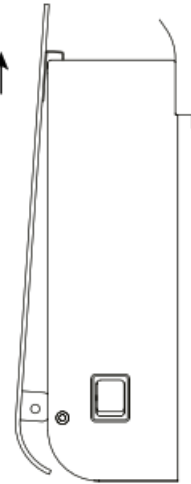

B

1

3

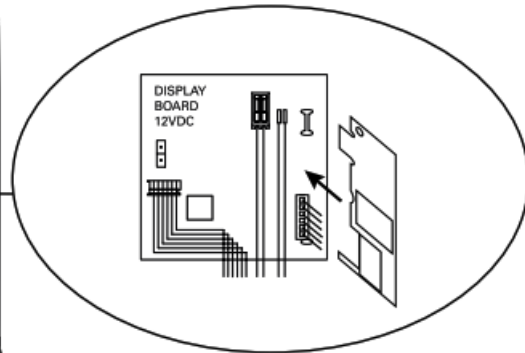
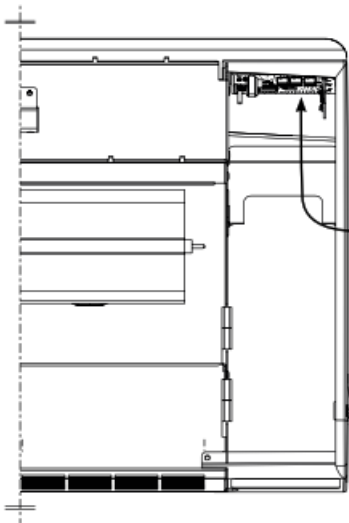

Wall installation

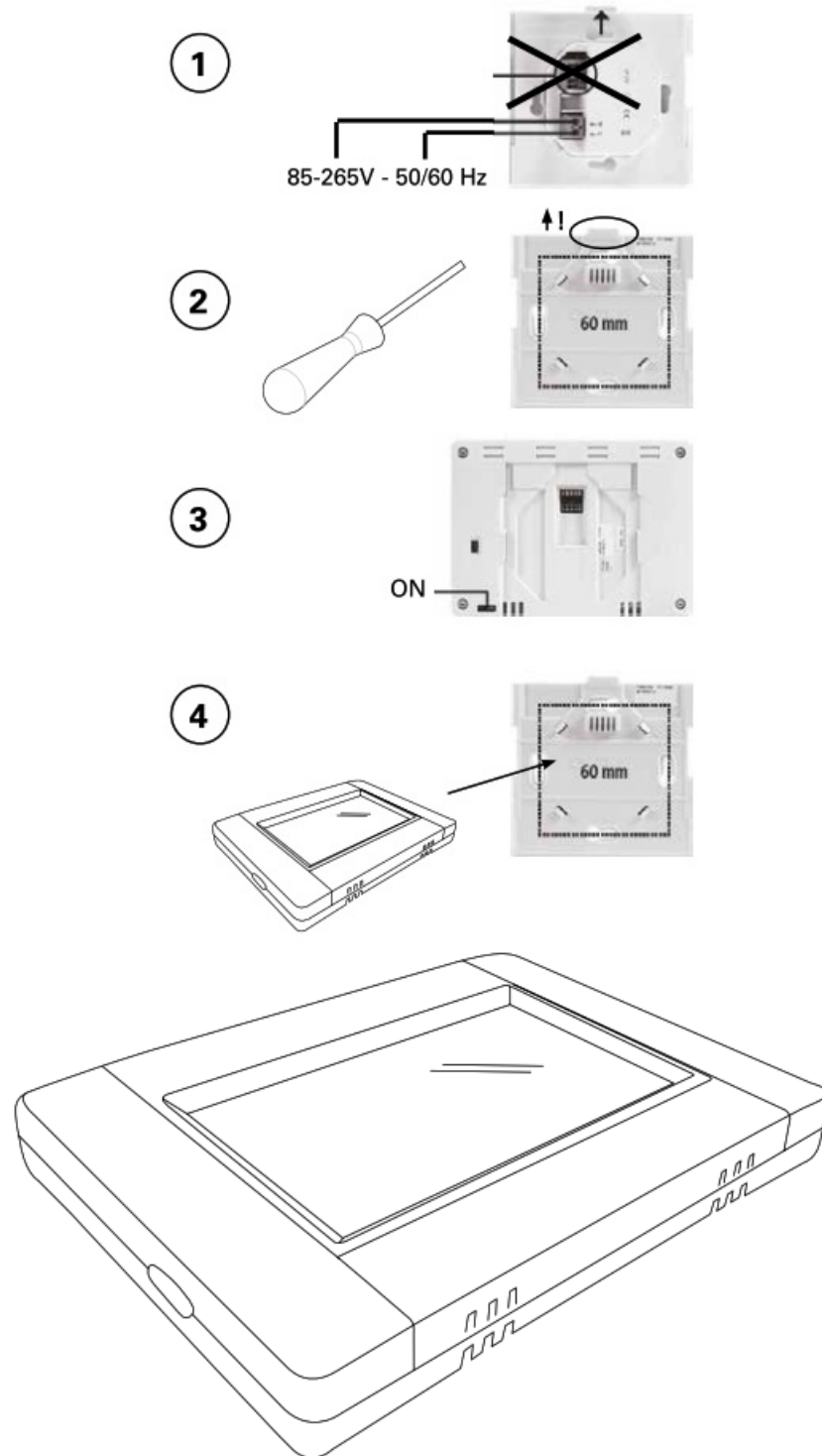
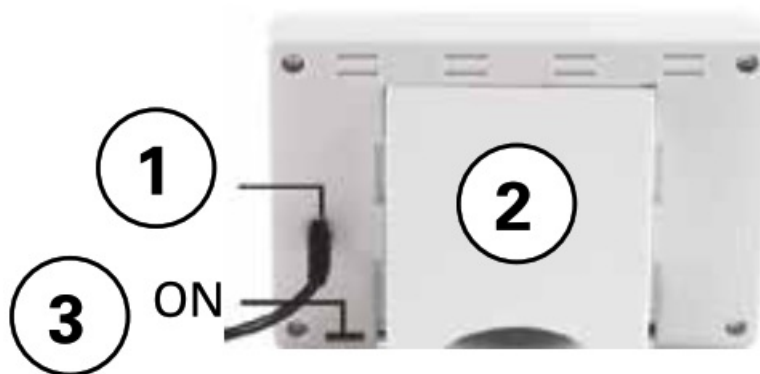
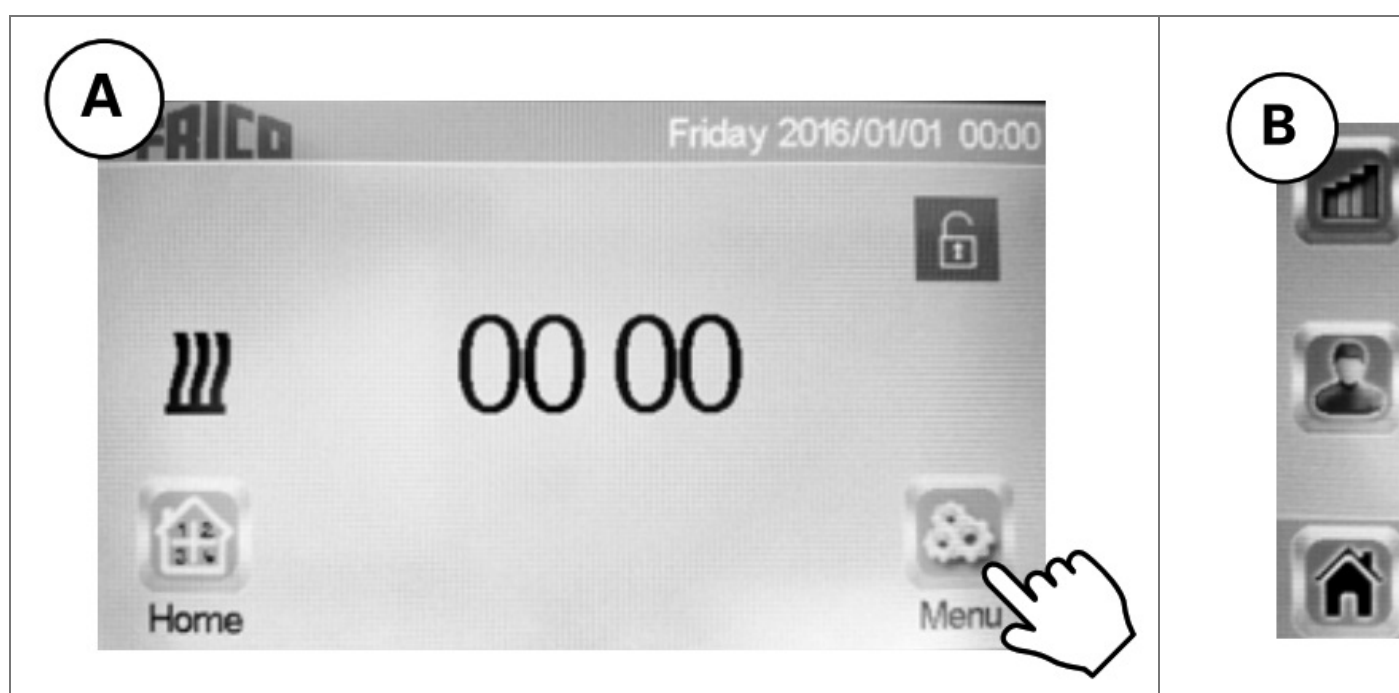

Table installation



Mini-USB 5V, 1 A (ingår ej) / Mini USB 5V, 1 A (not included) / Mini USB 5V, 1 A (ikke inkludert) / Mini USB 5V, 1 A (nicht im Lieferumfang enthalten) / Mini USB 5V, 1 A (non inclus) / Mini USB 5V, 1 A (niet inbegrepen)

1: Connect hub PFSRH to WIFI



C

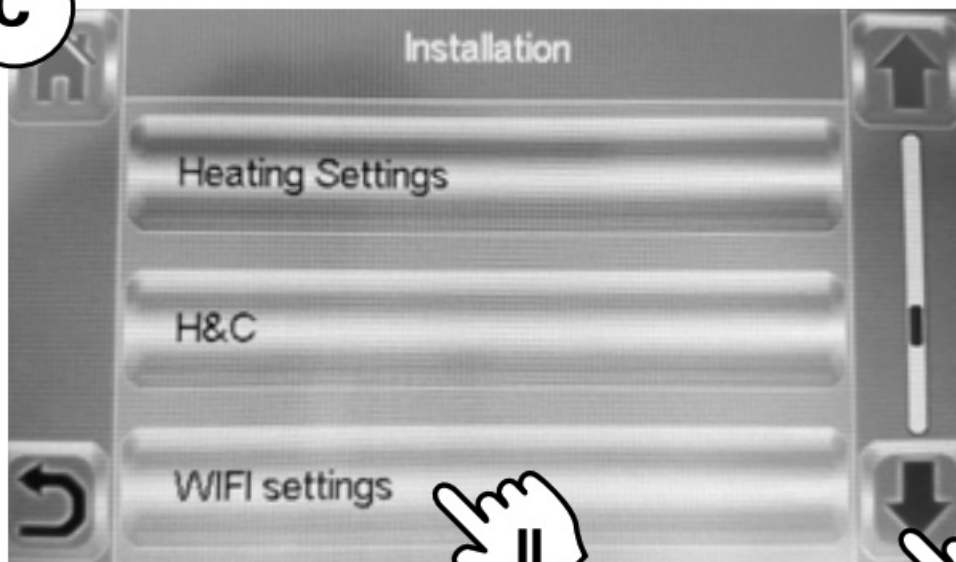

WIFI settings



State 0/2:

Internet connection No

Pairing hub PFSH with App No

State 1/2:

Internet connection OK

Pairing hub PFSH with App No

State 2/2:

Internetanslutning OK

Pairing hub PFSH with App OK

(see Section 4)

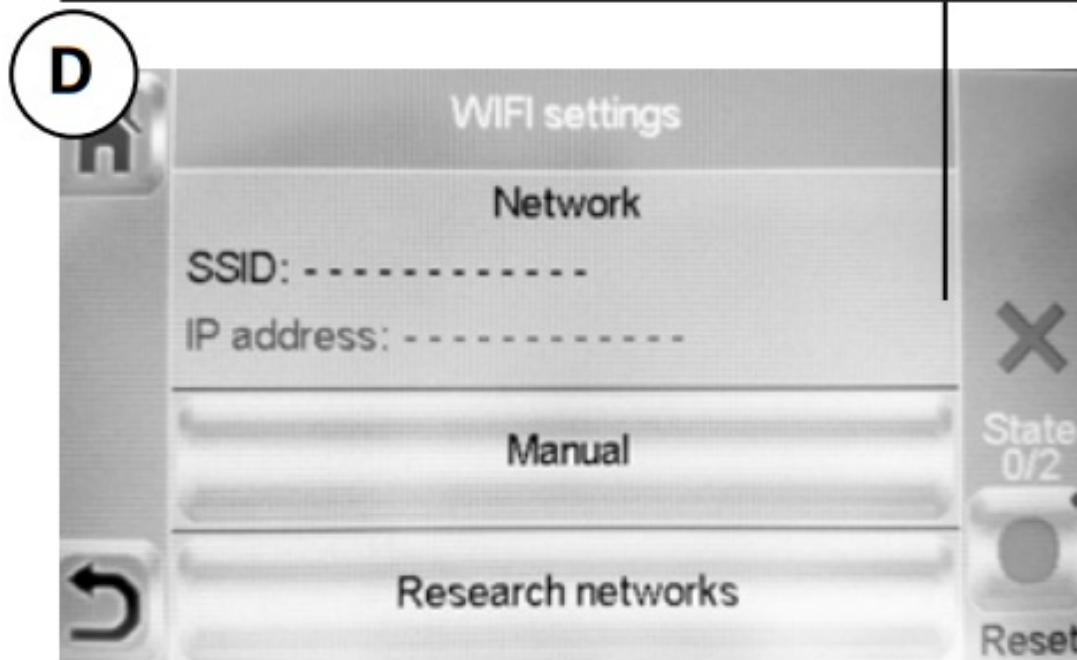

WIFI configuration can be set manually or scan the active networks. Automatic pairing time to WiFi router with WEP key: 3-4 min, with WPA2 key: 1 min.

2: House creation

A

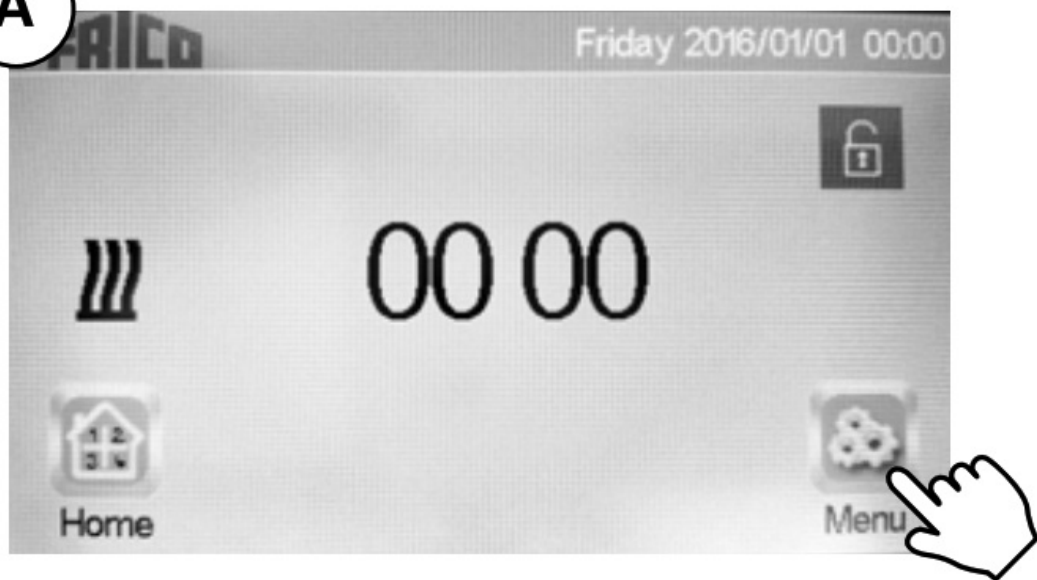

B



House creation.

C

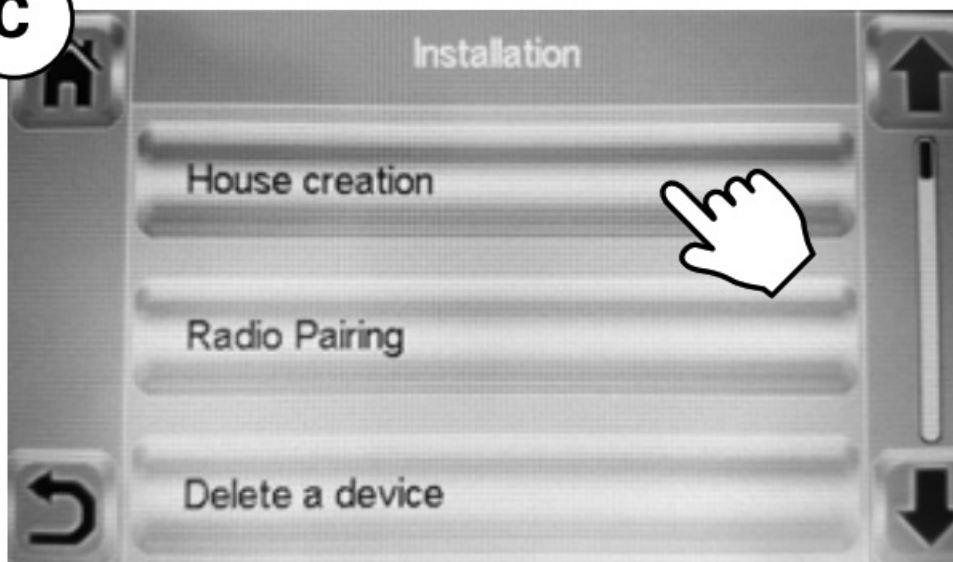

D





I. Name the room.

II. Confirm.

Create more rooms (up to 50)

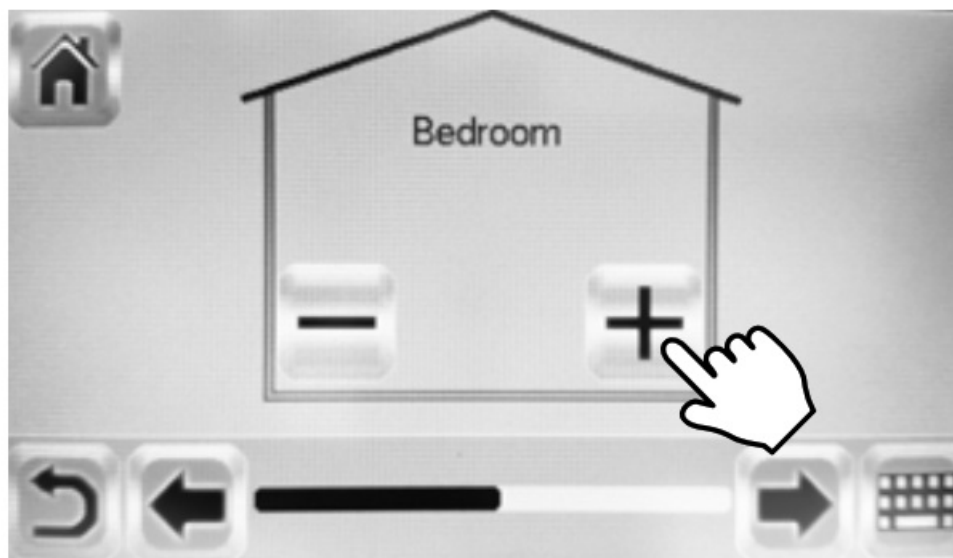

Repeat steps D and E until your house is ready.

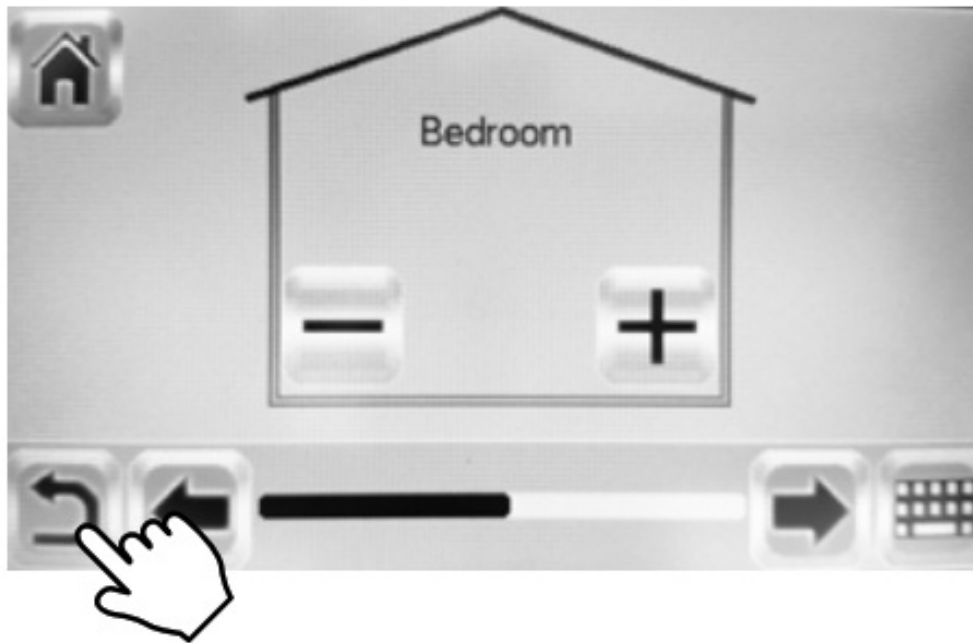

Finished.

3: Pairing PFS and hub PFSRH

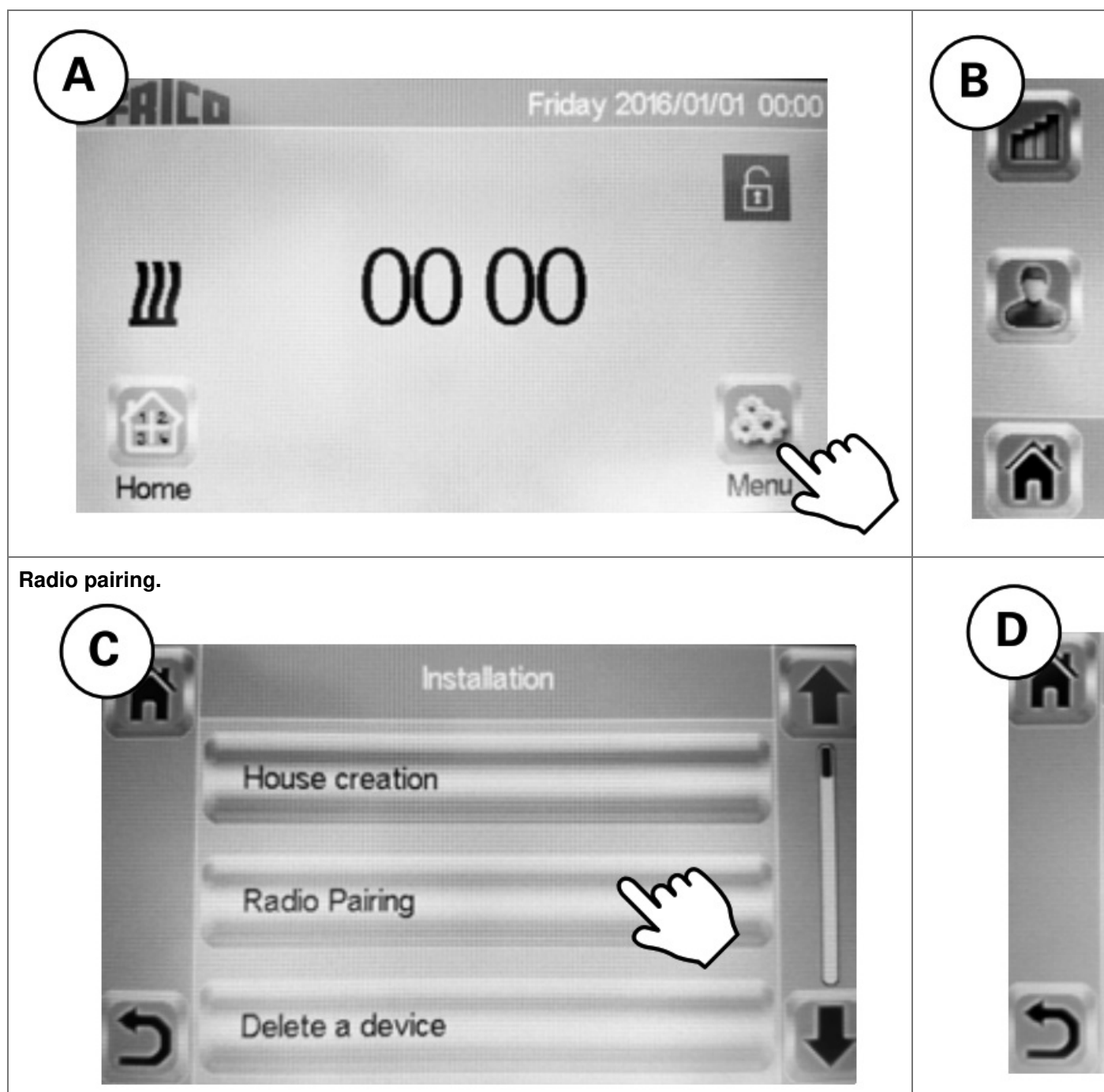

Heating.

Choose Room

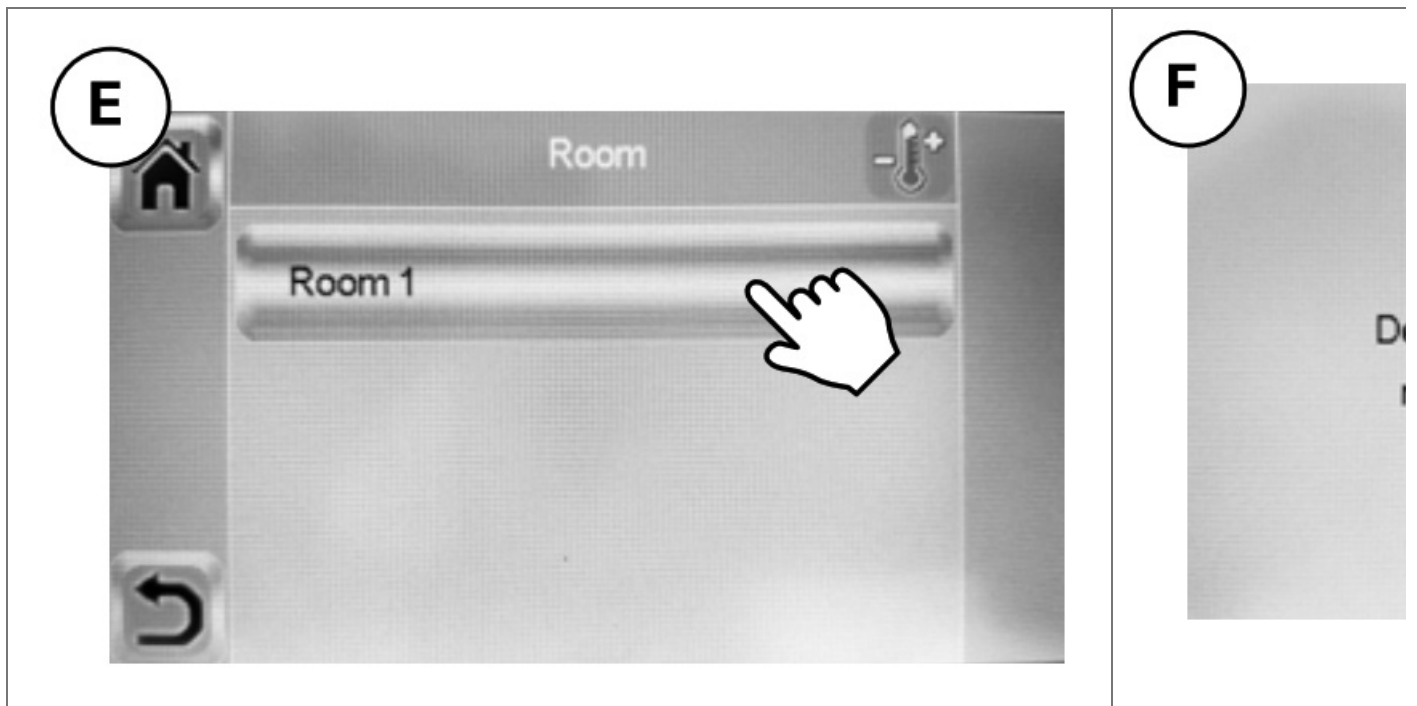

The fan convector to measure the temperature must be paired first in each room/zone.

PF Smart App





User menu

Select 



Confirm.

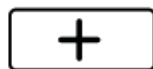

Select rF (06).

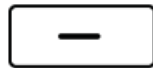

Confirm.

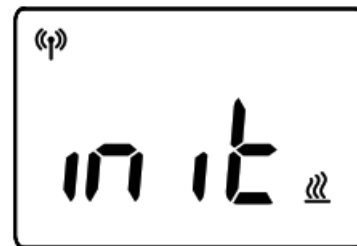

H



I



I. Select with how big steps you want to set the power +1/+10/+100/+1000/+10000.

II. Set the power that your PFS has, according to the type plate – 400/1000/1750W.

III. Confirm.



I. Name the fan convector.

II. Confirm.

Each room/zone can have up to 50 fan convectors.

4: Pairing hub PFSH with App

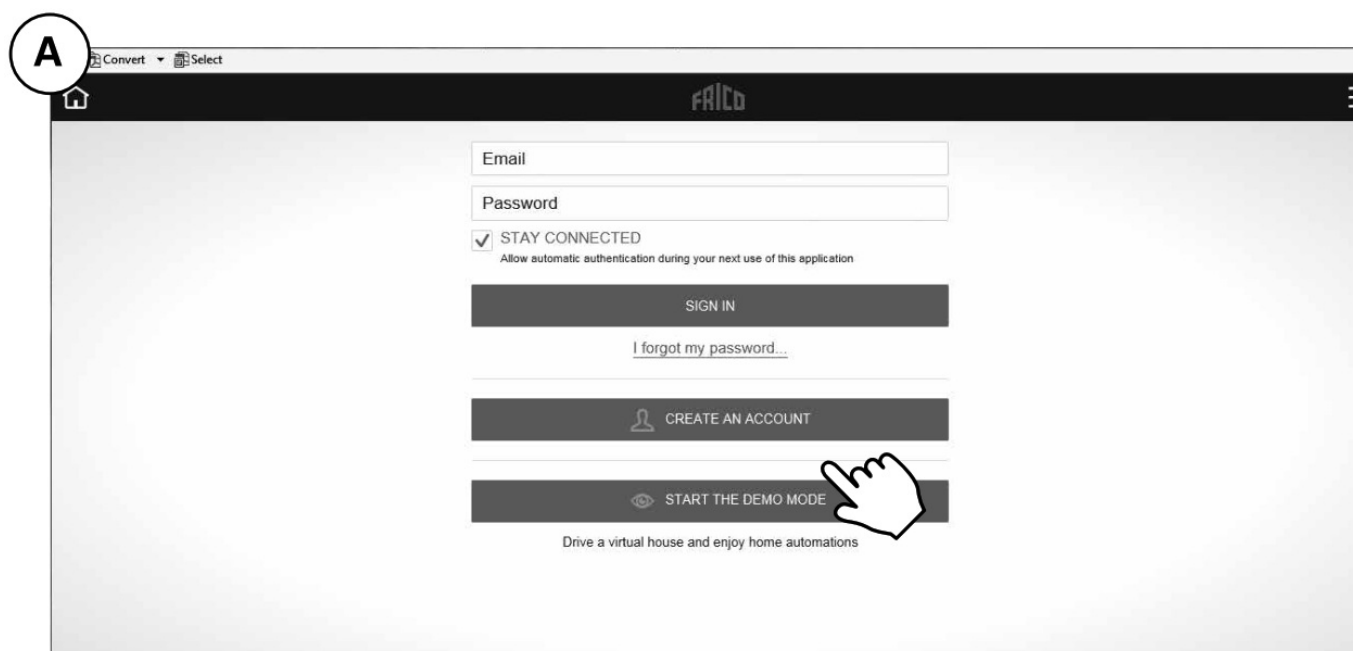

Download the app Frico PFS (Android, iOS) or visit the website fricopfsmart.frico.se -> Create an account.



Add hub PFSH.

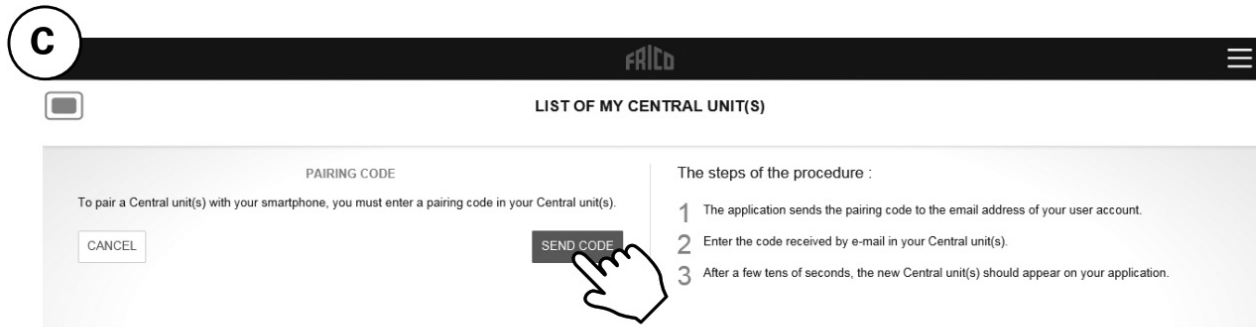

Send code to the email address added in the account

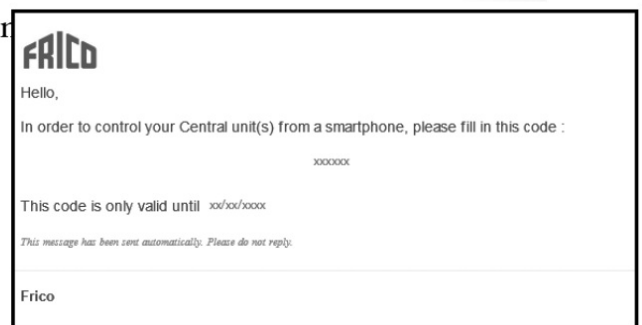

See next page >>

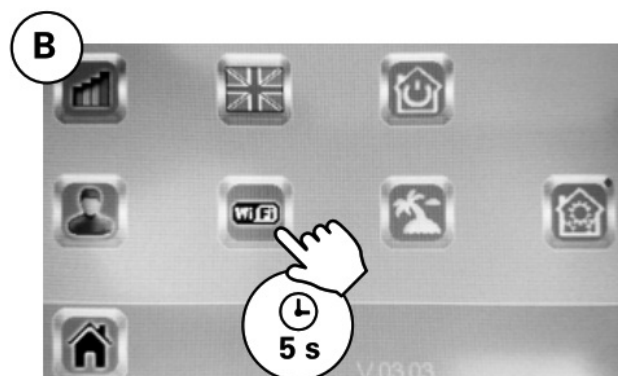
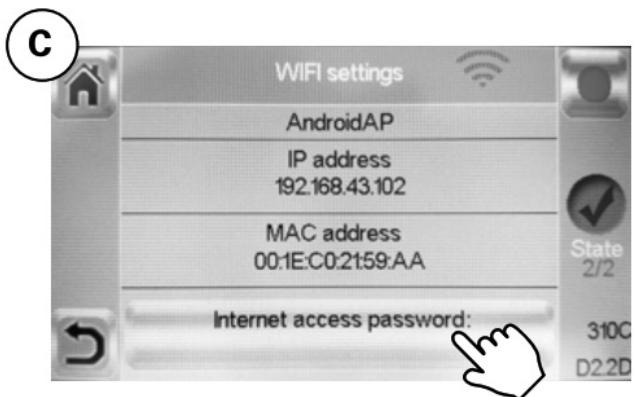
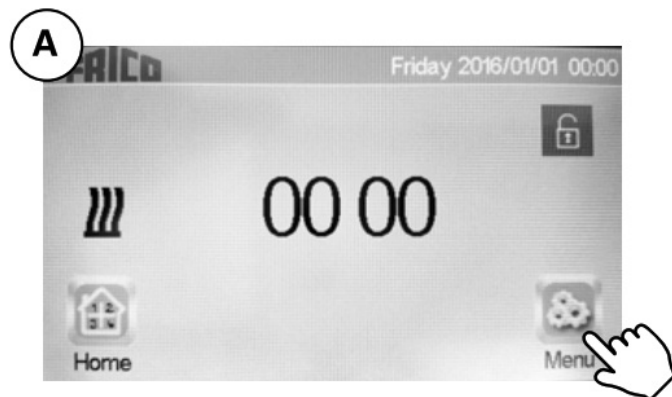

- I. Enter the pairing code.
- II. Confirm.

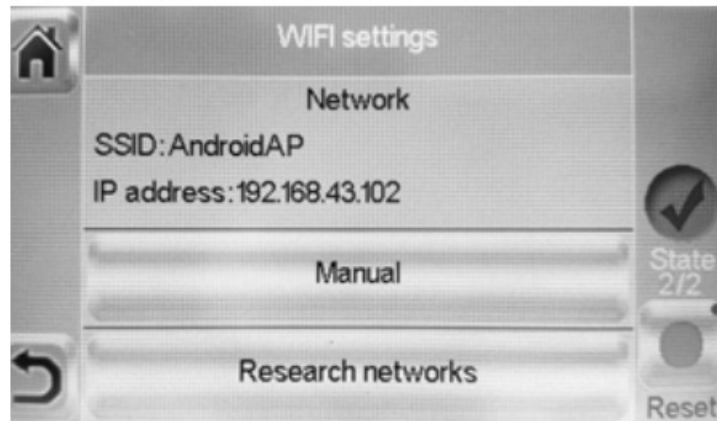

State 2/2 = OK!

5: Control with App

Download the app Frico PFS (Android, iOS) or visit the website fricopfsmart.frico.se.



Home screen

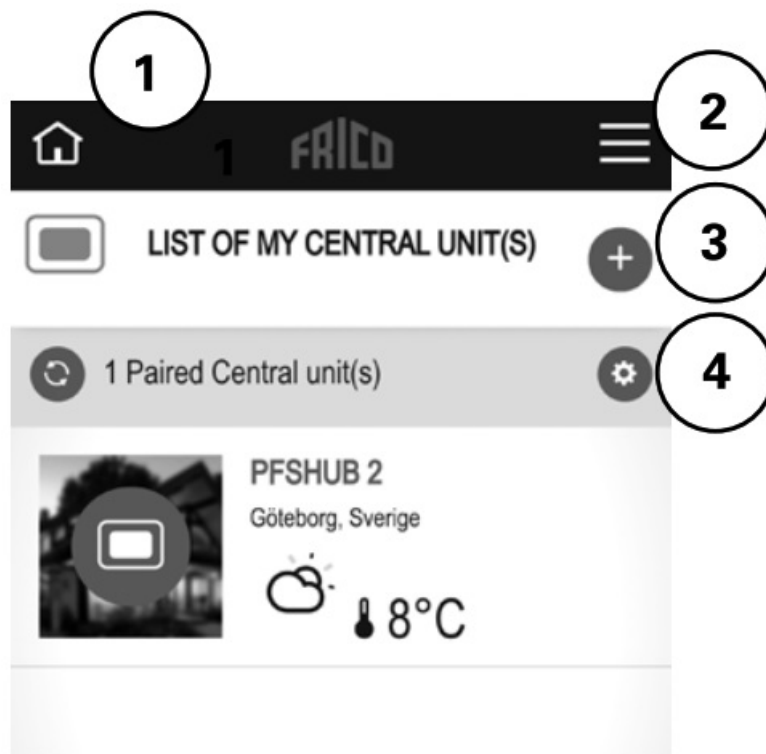

1. Home screen
2. Settings, see separate heating.
3. Add more units/hubs.
4. Hub settings: Personalize / Delete

Settings

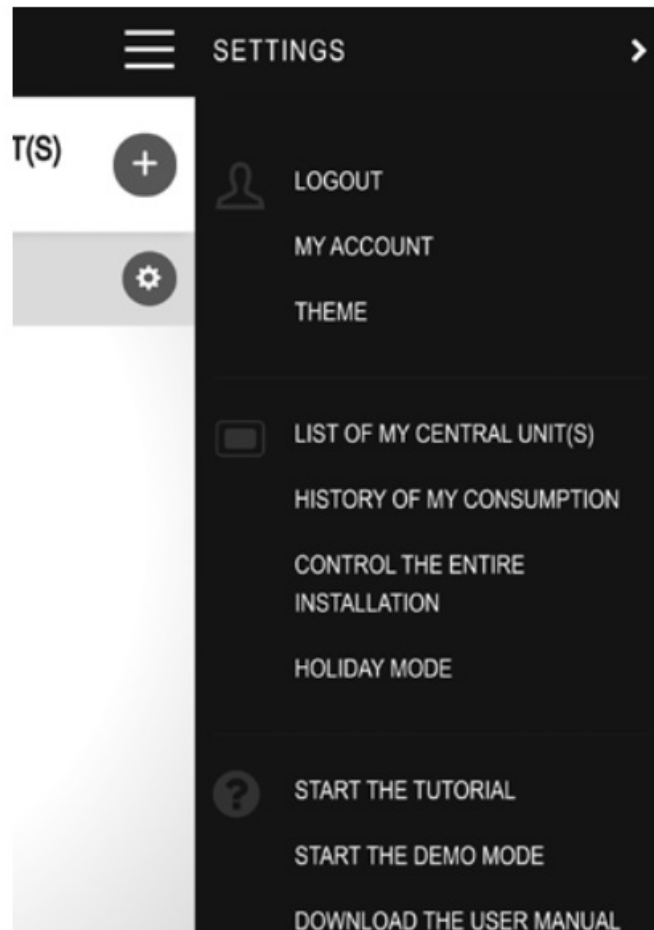

- Logout
- My account: ID, password, language, time format
- Theme: Appearance
- List of my central unit(s)
- History of my consumption
- Control the entire installation (Used to set all devices in the same mode.)
- Holiday mode: Set the departure time, return time, and desired mode.
- Start the tutorial
- Start the demo mode
- Download the user manual
- Website of Frisco
- Terms of use

Showroom

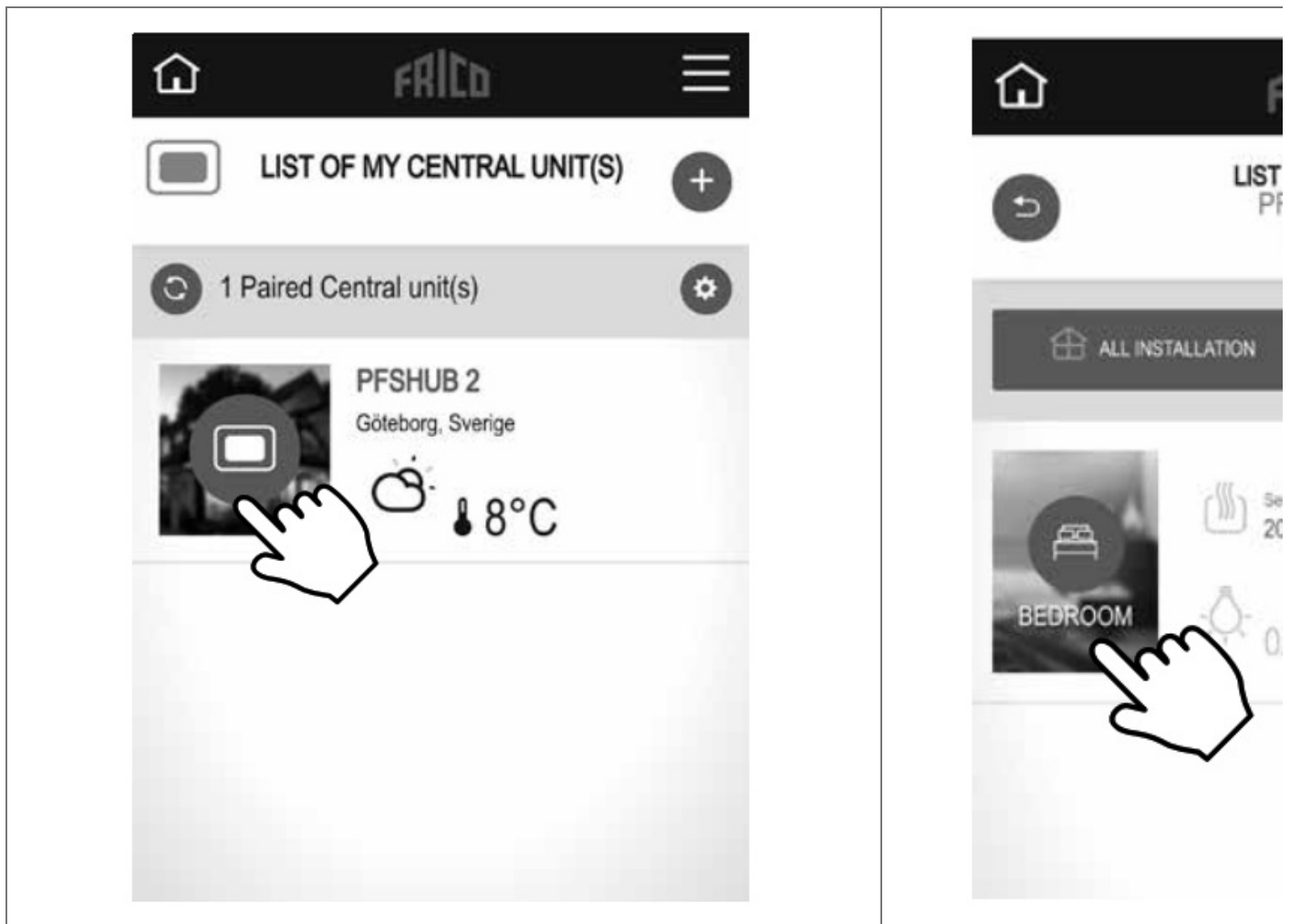

Showroom

Settings that also can be done here:

- Control the entire installation (Used to set all devices in the same mode.)
- Holiday mode: Set the departure time, return time, and desired mode.



Change the settings for the room.

Fan mode

Auto/Low/High/Off.

Temperature mode

It is possible to choose between three modes comfort, reduced mode (night mode), or frost protection. Settings for Comfort mode and Reduced mode are also applied in the week program when used.

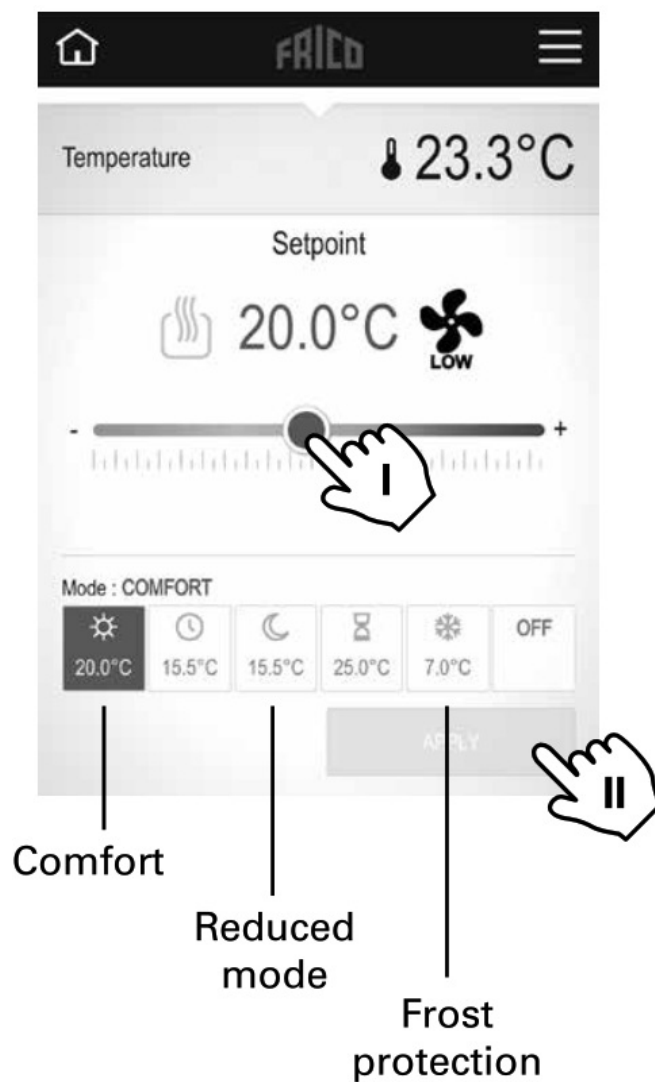

- I Set the desired temperature (Setpoint temperature).
 II Apply.

Default settings

Temperature mode	Setpoint	Fan mode
Comfort mode	21 °C	
Reduced (night mode)	15,5 °C	
Frost protection	7 °C	High (locked)

If OFF is selected frost protection is activated.

Timer

The set temperature can be changed for a limited time with the timer (0 min to 44 days). The fan runs on the set value.



I Set a temporary desired temperature (Setpoint temperature).

II Set time.

III Apply.

Week program

Five preset week programs (Model 1-5) and the possibility to add one custom-made for each room/zone.

The function ITCS (default) makes the control learn when it needs to start in order to reach a certain desired temperature at a specific time in the environment it is used. It can be disabled, on the hub or on PFS.



Week program

- I Set the week program, see separate heading.
- II Apply.

Set week program

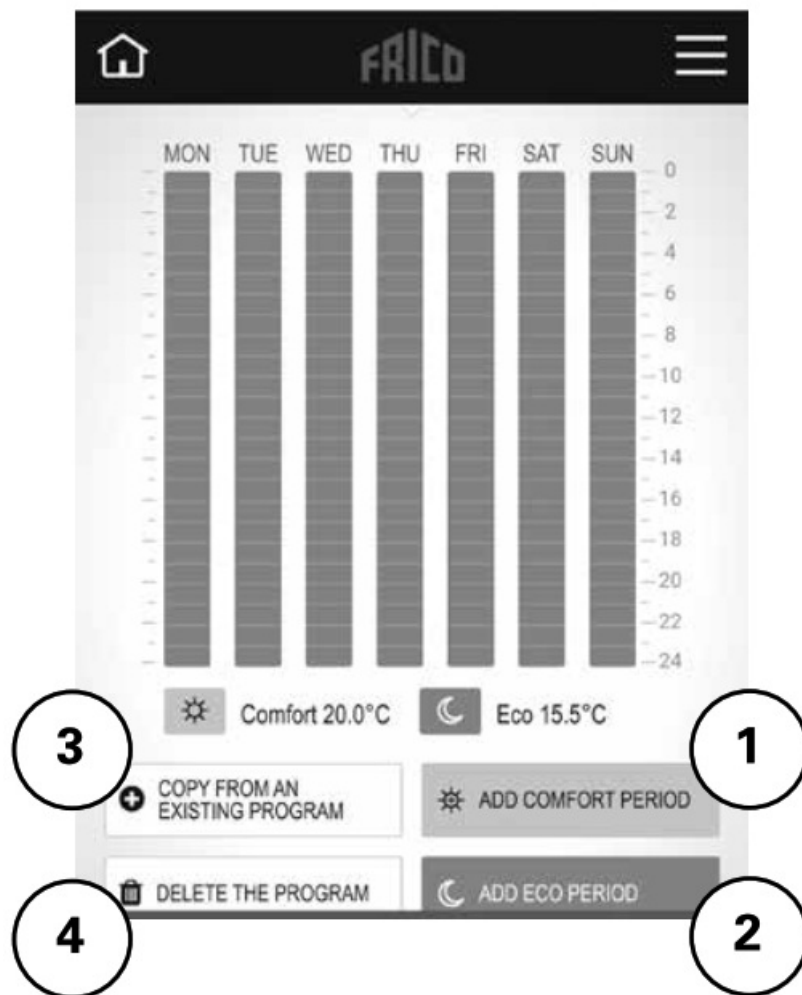

1. Add comfort period.
2. Add eco period (reduced mode).
3. Copy from an existing program: from a previously created or from a preset (model 1-5).
4. Delete the program

6: Control with hub PFSH

Main screen

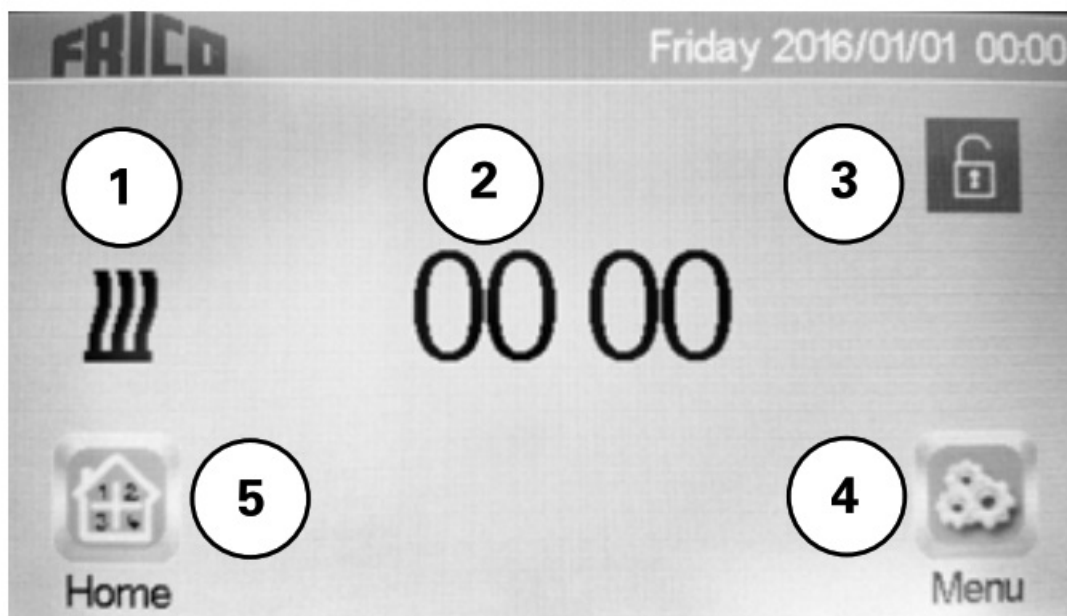

1. Red: Heat on, black: heat off
2. Display the time or the temperature of the chosen room. Make your choice by pressing on the central part of the screen.
3. Screen lock. A long press toggles between locking and unlocking.
4. Main menu
5. Show room. (Active even if the hub is locked, only viewing possible.)

Main menu

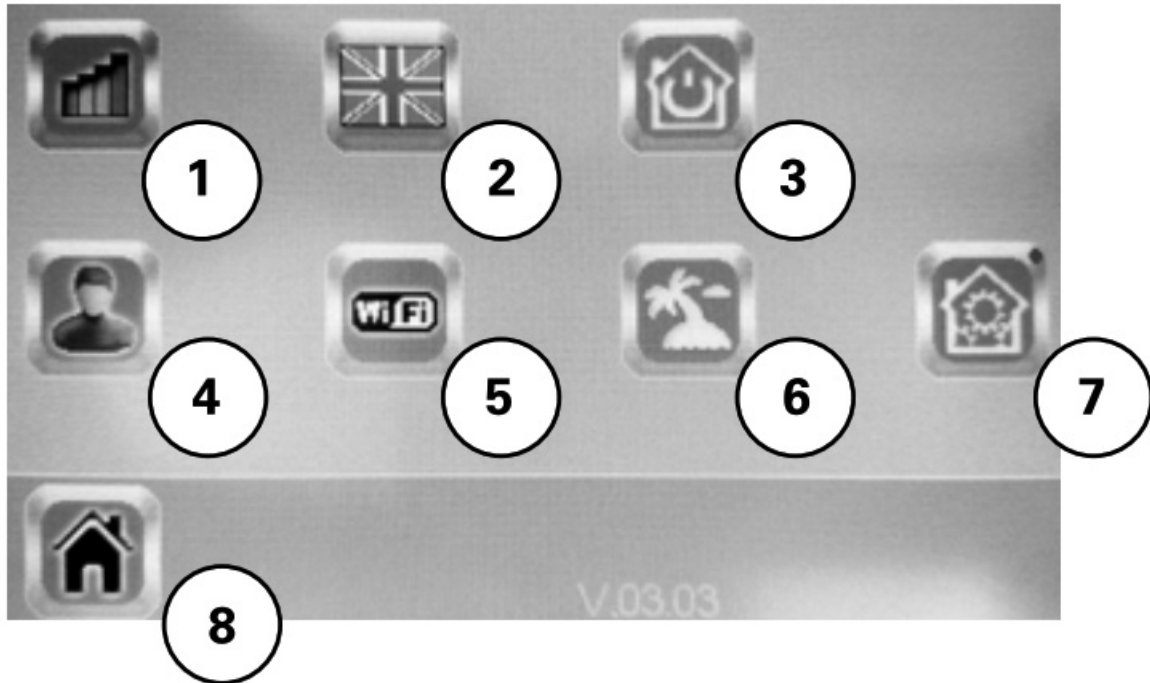

1. History of my consumption
2. Language (the flag of the current language is displayed).
3. Control the entire installation. Used to set all devices in the same mode.
4. User settings: Hour, Date, Summer-Winter (Manual/Auto), Temperature unit, Color (background), Buttons color, Backlight, Screen saver, Screen cleaner, the Factory default user
5. WIFI settings
6. Holiday mode: Set the departure time, return time, and desired mode.
7. Installation menu (push and hold for 5 s): House creation, Radio pairing, Delete a device, Delete all devices, Identify the device, Anti freeze setpoint, Heating settings, &C, WIFI settings, General factory default, Update Firmware, Parameters)
8. Main screen

General symbols



Return to the previous menu.



Return to the main screen.

Showroom

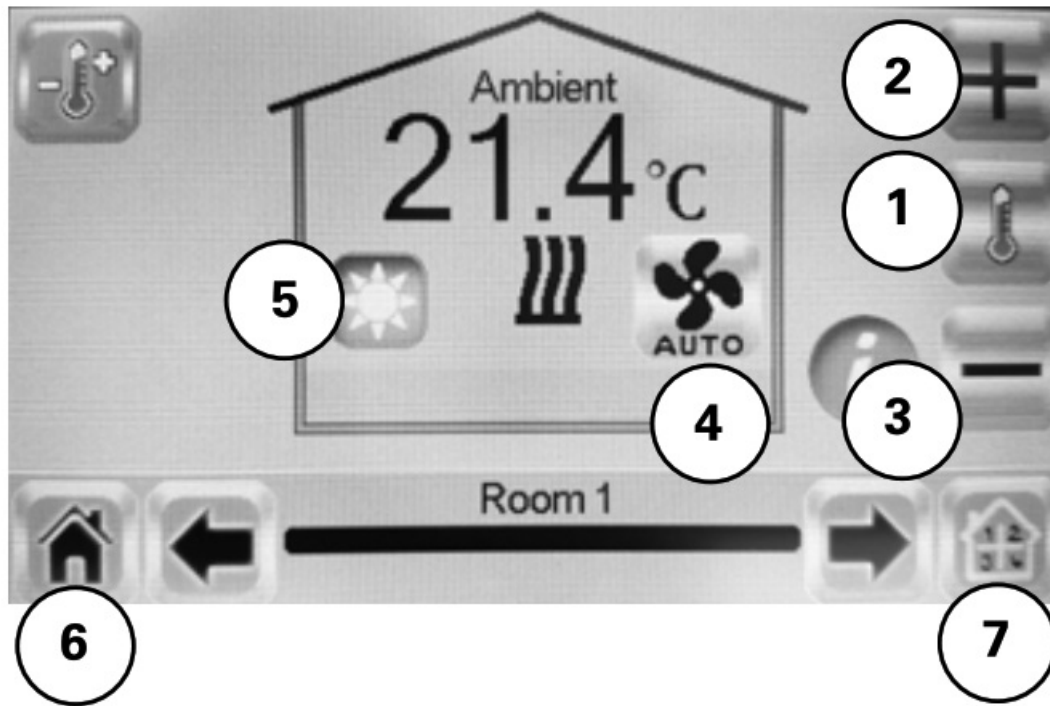

1. Show ambient temperature or desired temperature (setpoint temperature).
2. +/- Set the current setpoint (deactivated if the screen is locked).
3. General settings for the heating devices installed in the room. When the setting button (gear wheel) which can be found here is held in (5 s), the following can be changed: Device Name, Power, ITCS (Yes / No)
4. Fan mode, see separate heading.
5. Modes, see separate headings – Temperature mode, Timer, Week program.
6. Main screen
7. Choose room.

Fan mode Auto/Low/High/Off.

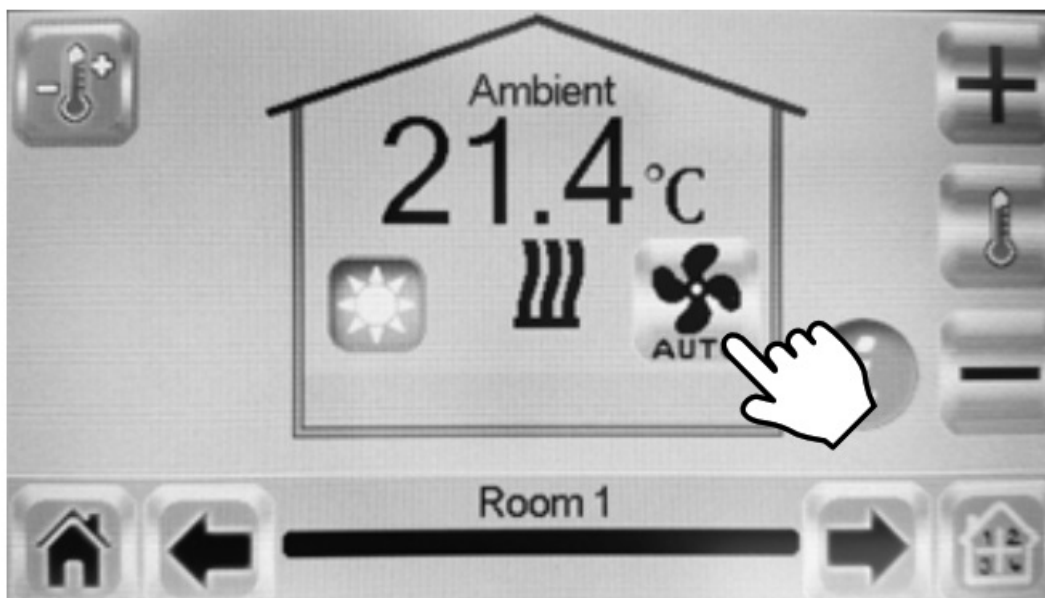

Temperature mode

It is possible to choose between three modes comfort, reduced mode (night mode), or frost protection. Settings for Comfort mode and Reduced mode are also applied in the week program when used.

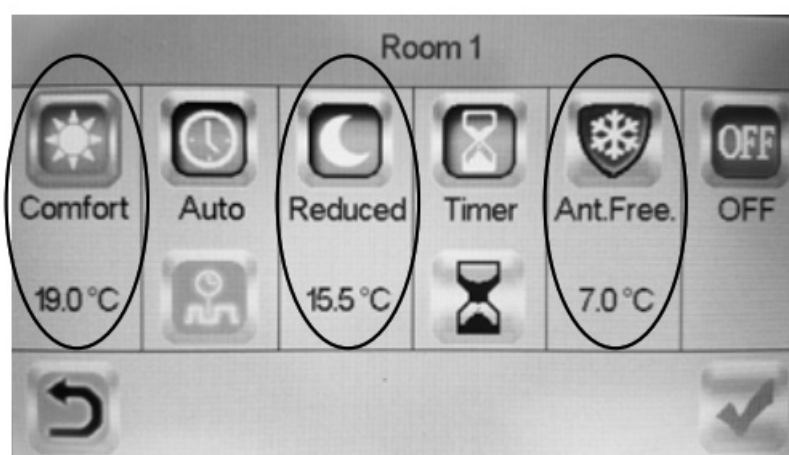

Default settings

Temperature mode	Setpoint	Fan mode
Comfort mode	21 °C	
Reduced (night mode)	15,5 °C	
Frost protection	7 °C	High (locked)

If OFF is selected frost protection is activated.

Timer

The set temperature can be changed for a limited time with the timer (3 min to 44 days). The fan runs on the set value.

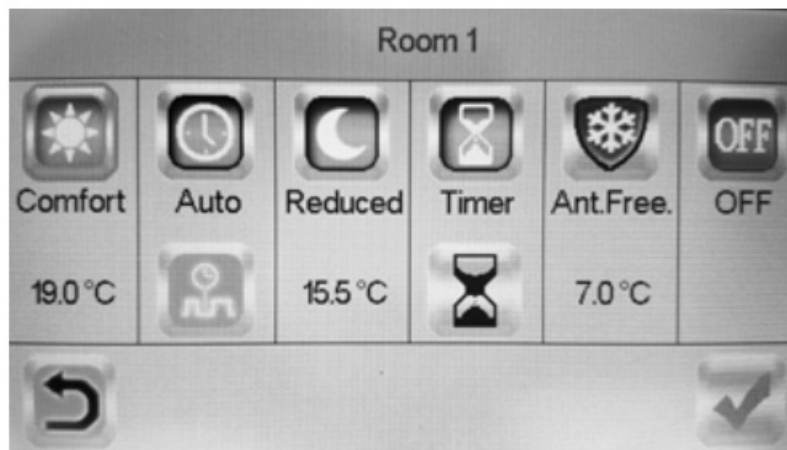

Activate.



Change the set time.



Confirm.

Week program

Five preset week programs (Program 1-5) and the possibility to add one custom-made for each room/zone.

The function ITCS (default) makes the control learn when it needs to start in order to reach a certain desired temperature at a specific time in the environment it is used. It can be disabled, see section 6, heading Showroom, 3.

Week programs are most easily done in the App.

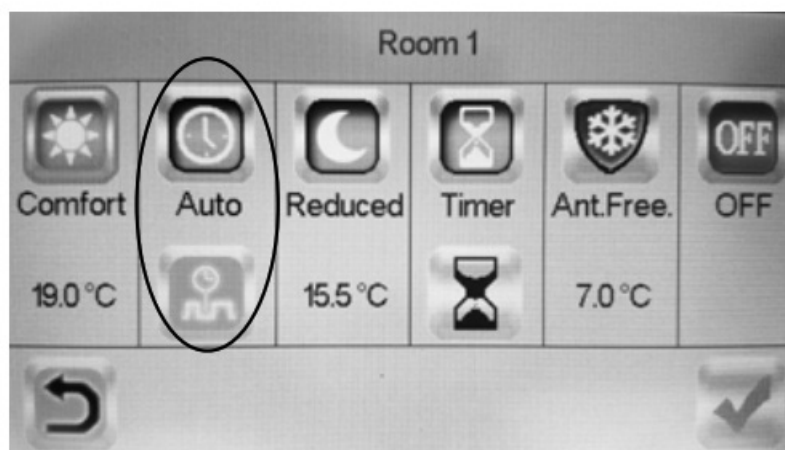

Main office

Frico AB
Box 102
SE-433 22 Partille
Sweden

Tel: +46 31 336 86 00
mailbox@frico.se
www.frico.se

For the latest updated information and information about your local contact: www.frico.se

Get In Touch

Call: 0845 6880112

Email: info@adremit.co.uk

Our Address

Prevent, Adremit Limited, Unit 5a, Commercial Yard,
Settle, North Yorkshire, BD24 9RH

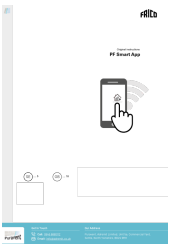

Documents / Resources

	<p>FRICO PF Smart App [pdf] User Manual PF Smart App, PF APP, App</p>
--	---

References

- [FRICO PF SMART](#)
- [Energieeffektiva värmesystem för en bättre värmekomfort | Frico | Frico](#)