

freshwater IQ Smart Monitoring System User Guide

[Home](#) » [freshwater](#) » freshwater IQ Smart Monitoring System User Guide 



Smart Monitoring System Replacement Sensor uick Start Guide

Contents

- [1 OVERVIEW OF FRESHWATER® IQ](#)
- [2 COMPONENTS OF THE FRESHWATER® IQ SYSTEM](#)
- [3 HOW TO REPLACE THE SENSOR](#)
- [4 IMPORTANT ADDITIONAL INFORMATION](#)
- [5 Documents / Resources](#)
 - [5.1 References](#)

OVERVIEW OF FRESHWATER® IQ

FreshWater IQ is designed to simplify your water care management. It is a water testing system that measures pH, chlorine, and salt levels in spa water. The system lets you know when action is required to balance your water and provides feedback on the health of your spa water. Working together with the FreshWater Salt System, FreshWater IQ delivers a smarter, cleaner, simpler way to hot tub.

Please see your FreshWater IQ Owner's Manual for detailed instructions and other best practices, located on your spa brand's website.

COMPONENTS OF THE FRESHWATER® IQ SYSTEM

Controller and Sensor

The FreshWater IQ System contains one controller and one replaceable sensor. The sensor has a life span of up to 12 months.*

Replacement sensors are sold separately.

*Many factors affect the life of spa water, such as bather load and water chemistry.

When these factors are accounted for and the spa is properly maintained, FreshWater IQ will automatically test

water and provide recommendations for up to a full year.

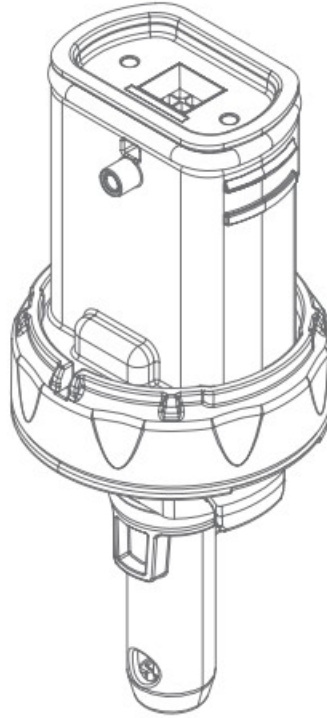

Housing and Cap

The bartop-accessible housing holds the FreshWater IQ controller and sensor and allows for easy replacement.

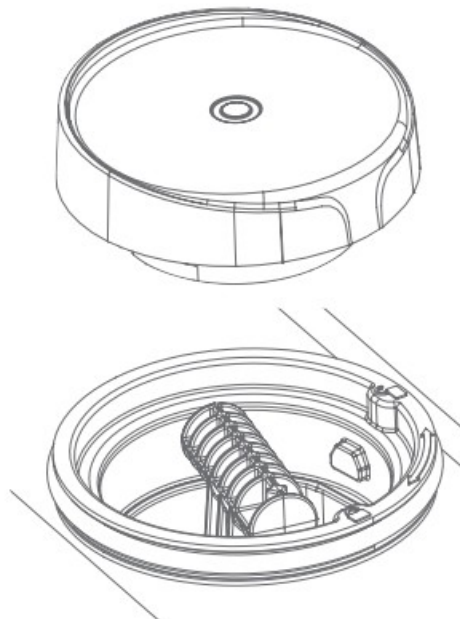

Handle and Cable

The factory-installed handle has a cable that connects internally to the spa.

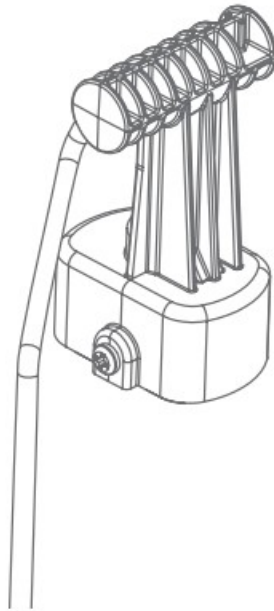

HOW TO REPLACE THE SENSOR

1. Turn the power to your spa off (reference Spa Owner's Manual for instructions).
Rotate the cap counterclockwise and lift up to remove.

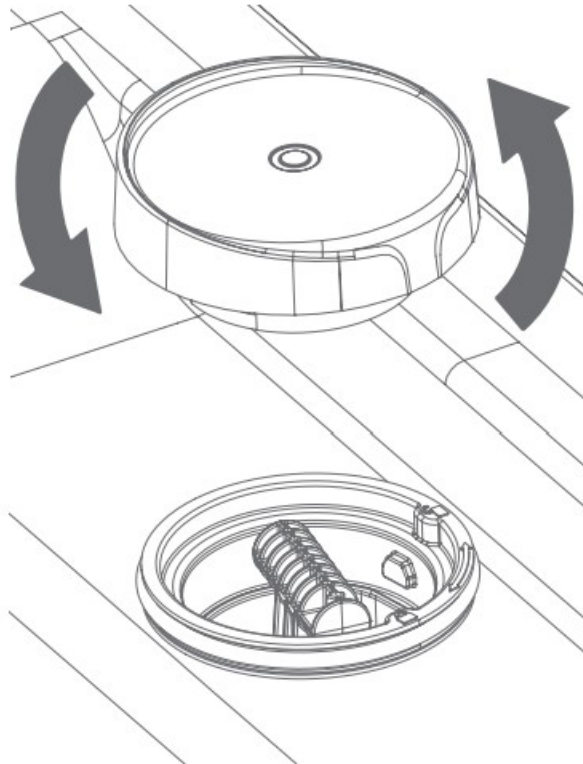

2. Rotate the handle counterclockwise to unlock and lift out.

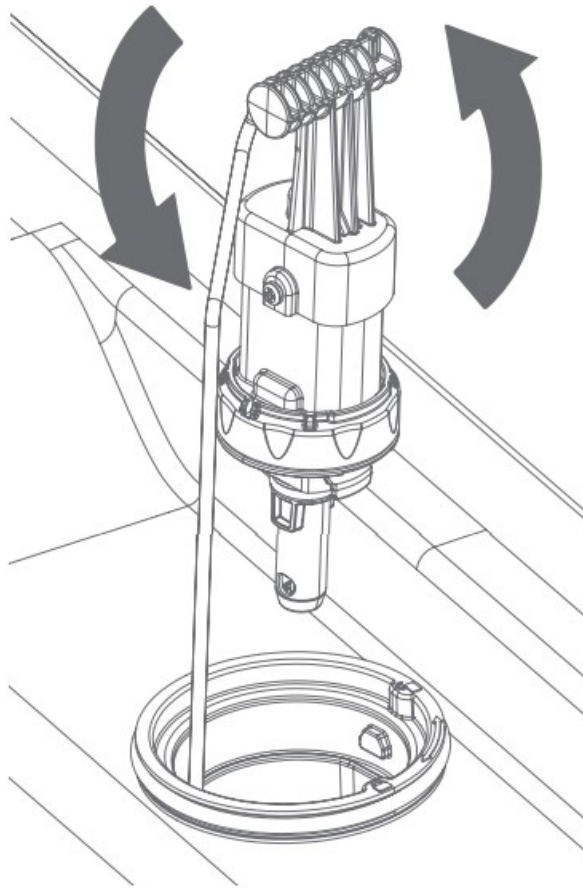

3. With the sensor pointing up, rotate the locking ring clockwise to release the sensor. Then remove the sensor.

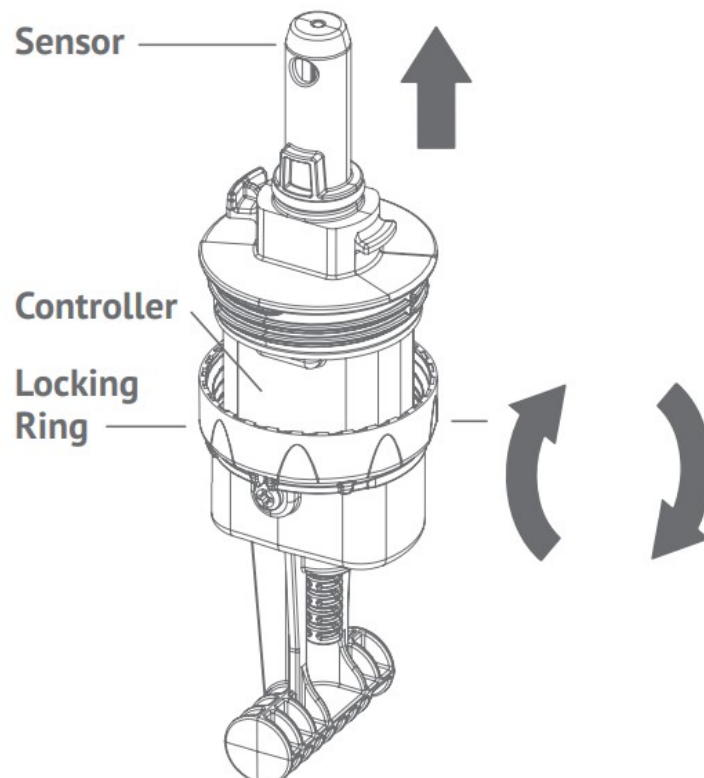

4. Attach the replacement sensor to the controller and rotate the locking ring counterclockwise to lock.

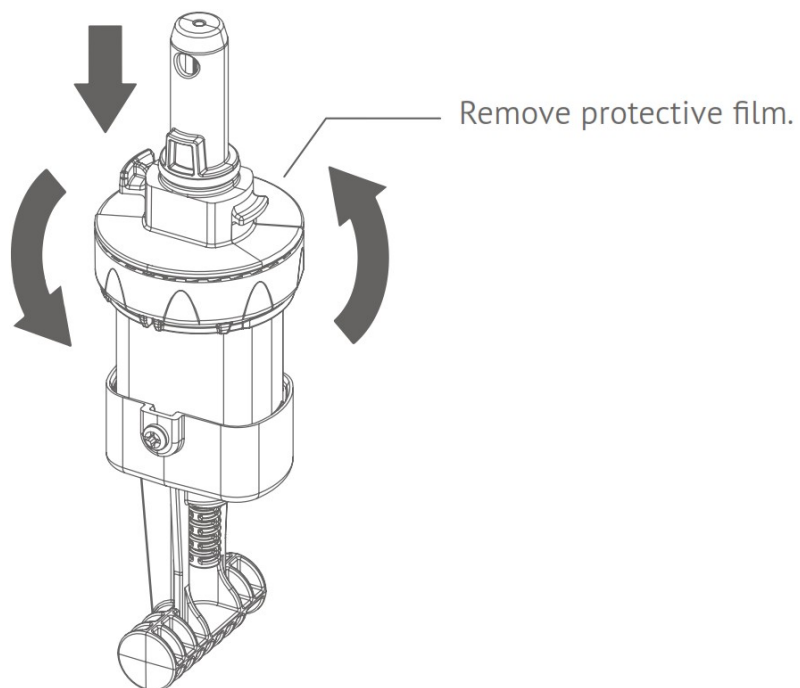

5. Align the handle arrow to the unlock position, fully insert into the housing, push down, and rotate clockwise to the lock position.

IMPORTANT: The system will not work unless the FreshWater IQ handle is fully rotated to the locked position.

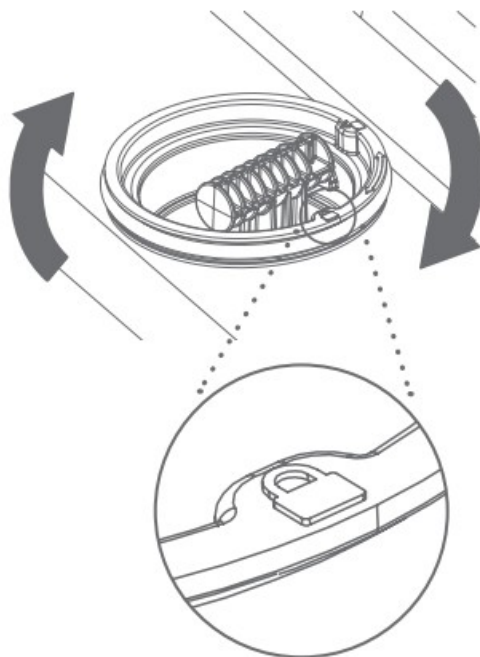

6. Replace the cap and turn clockwise to tighten.

Turn the power to your spa back on (reference Spa Owner's Manual for instructions).

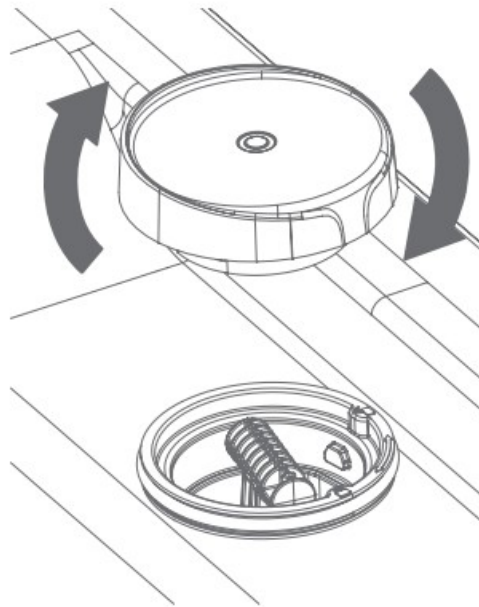

IMPORTANT ADDITIONAL INFORMATION

WARNING: The spa user is ultimately responsible for maintaining safe and sanitary water in the spa regardless of what water quality system is installed on the spa.

WARNING: Please make sure the FreshWater® Salt System is operational before using/starting FreshWater IQ.

WARNING: Operating FreshWater IQ in the unlocked position can damage the sensor cartridge.

WARNING: To reduce the risk of injury, do not permit children to operate this device.

WARNING: Maintaining high salt and chlorine levels above recommended range can contribute to corrosion of spa equipment.

IMPORTANT: FreshWater IQ will not function accurately when the spa water is below 60° F (15° C).

IMPORTANT: When using test strips, check the expiration date of test strips as test results may be inaccurate if used after that date.

IMPORTANT: Use genuine FreshWater parts when replacing the FreshWater IQ sensor.

IMPORTANT: FreshWater IQ is not compatible with Monopersulfate (MPS), Ozone, Bromine, FreshWater Mineral Spa Sanitizer, or other silver nitrate products.

© 2024 Watkins Wellness®
1280 Park Center Drive Vista, CA 92081
PN 63695 Rev A



Documents / Resources

	freshwater IQ Smart Monitoring System [pdf] User Guide IQ Smart Monitoring System, Smart Monitoring System, Monitoring System, System
---	--

References

- [User Manual](#)

[Manuals+](#), [Privacy Policy](#)

This website is an independent publication and is neither affiliated with nor endorsed by any of the trademark owners. The "Bluetooth®" word mark and logos are registered trademarks owned by Bluetooth SIG, Inc. The "Wi-Fi®" word mark and logos are registered trademarks owned by the Wi-Fi Alliance. Any use of these marks on this website does not imply any affiliation with or endorsement.