



# Freshin DL-Sensor-AU Motion Sensor LED Down Light Instruction Manual

[Home](#) » [Freshin](#) » Freshin DL-Sensor-AU Motion Sensor LED Down Light Instruction Manual 

## freshin

MOTION SENSOR LED DOWN LIGHT  
INSTALLATION INSTRUCTIONS

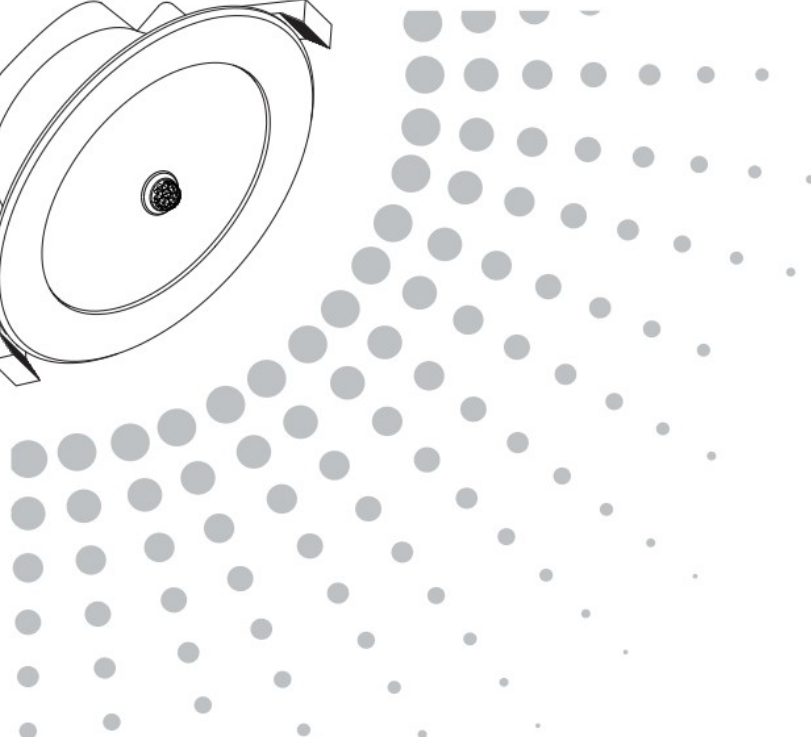
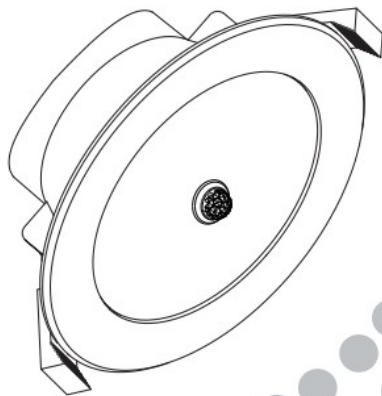
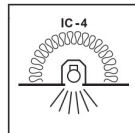

## Model: DL-Sensor-AU

The Downlight offers 3 color temperatures in one fitting

**WARNING:** THIS FITTING MUST BE INSTALLED BY A LICENSED ELECTRICIAN !

### Contents

- [1 Specifications](#)
- [2 Safety Tips](#)
- [3 Installation](#)
- [4 Sensor Specification](#)
- [5 Sensor Information:](#)
- [6 Documents / Resources](#)
- [6.1 References](#)
- [7 Related Posts](#)

## Specifications

**Rated Voltage:** AC240V~50Hz

Model	Wattage	CCT	Cut-out Size	Lumen	Induction Distance	IP Rating
DL-Sensor-AU	9W	3000K 4000K 5700K	90mm	750lm 850lm 810lm	Max. 8m	IP40 (IP44 for front)

## Safety Tips

- Always ensure the power is OFF and the LED downlight has cooled down before performing any maintenance, cleaning or making any adjustment to the recessed luminaire.
- The external flexible cable or cord of this luminaire cannot be replaced; if the cable or cord is damaged, the luminaire shall be destroyed.
- The luminaire must not be used if the protective shield has been cracked.
- Replace any cracked protective shield before using the luminaire.
- The light source of this luminaire is not replaceable; when the light source reaches its end of life the whole luminaire shall be replaced. There are no serviceable parts, do not attempt to dismantle or open the product.
- To avoid injury or damage to the luminaire, ensure that power leads and screws are secure before connecting the power.
- Ensure that the fitting does not come in contact with corrosive chemicals/solvents or abrasive cleaners etc.
- To clean, wipe with a soft damp clean cloth.  
Do NOT soak or immerse the product in water or other liquids.

## Installation

**Before installation, please make sure the power is off**

1. Before installation, plug the downlight into a socket outlet to ensure it is working correctly.
2. Select the colour temperature via the switch on the back of the downlight. (Fig. 2)  
**Note:** The downlight must be turned off before using the switch to change the color temperature.
3. Cut an installation hole of 90mm into the ceiling. (Fig. 1)
4. Insert the plug into the socket outlet and ensure it is fully plugged in. (Fig. 2)
5. Push the springs up and put the downlight up through the cut out hole and into the ceiling. (Fig. 3)
6. After the installation, switch on the LED downlight and test all the lighting functions.

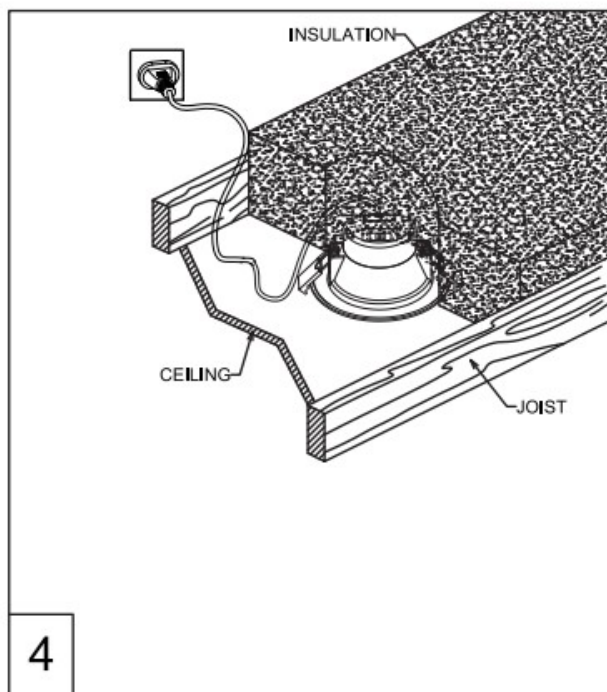
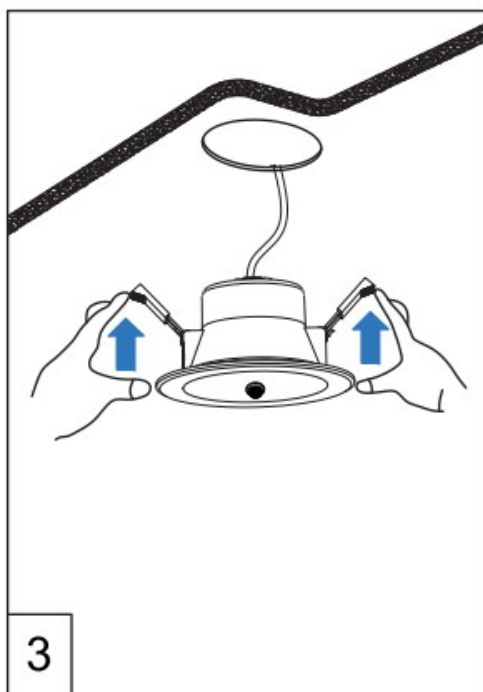
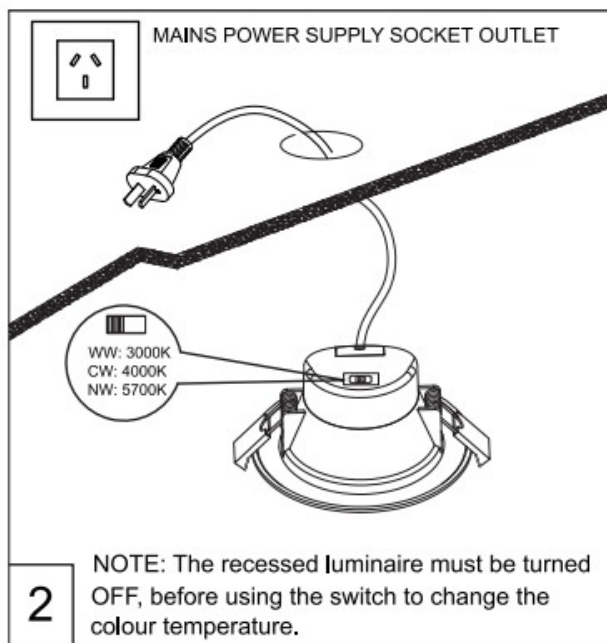
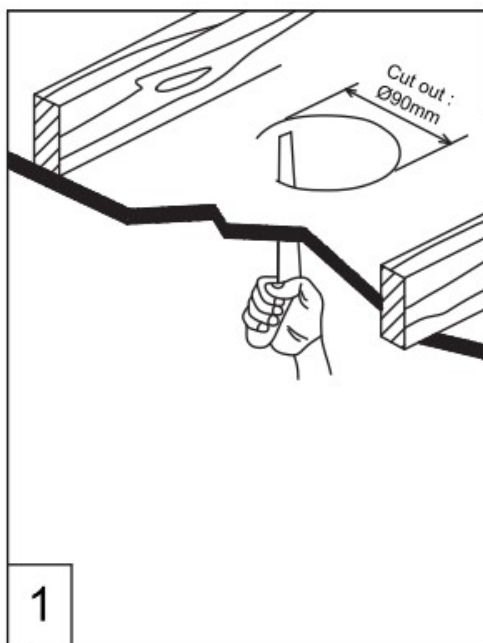

1. Aclosed luminaire that allows building insulation to come into contact with s sides and to cover it.
2. Type IC-4 recessed luminaire can be used together with building insulation that can safely be exposed continuously to temperatures up to 90°C may abut and cover the luminaire;

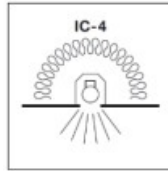

RISK OF FIRE – Required clearance from structural members and building elements

SCB =50 mm

HCB =50 mm

## Sensor Specification

Item	Parameter
Standby Power	<0.5W
Block Time	0.2s
Detection Angle	1000
Time Delay	70±10s
Detection Distance	Max. 8m
installation Height	1.8m – 2.5m
No Manual Override	
Sensor Operates Day and Night	

## Sensor Information:

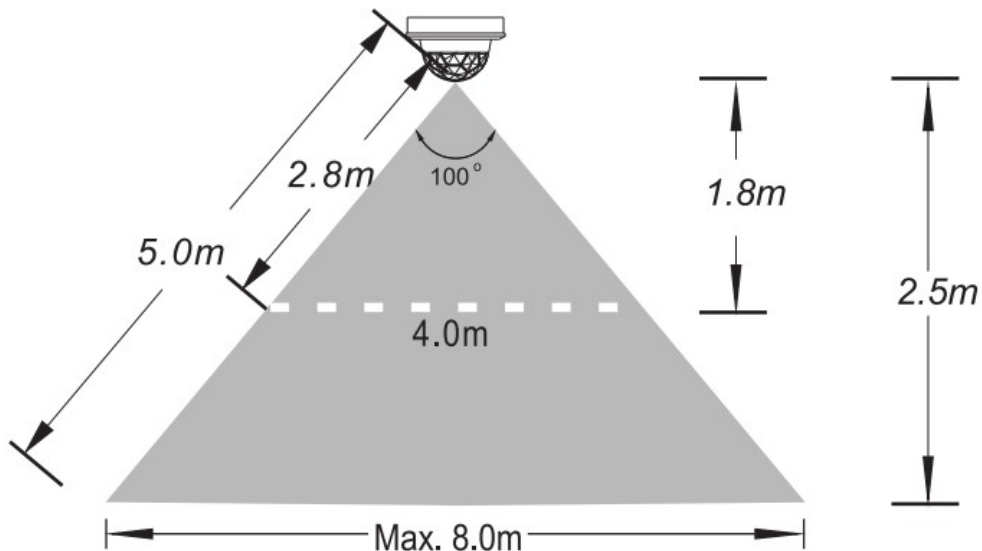

Recommended Height of Installation: 1.8~2.5m

Detection Distance: Max. 8m

**Height:** 1.8M = 4 meter detection range

**Height:** 2.5M = 8 meter detection range

**\*Note:** The detection distance will vary with change of installation height

**Any questions or suggestions are welcomed**

freshin



Phone: +61 478169288



Email: [customerservice@freshin.com](mailto:customerservice@freshin.com)

---

## Documents / Resources

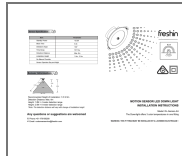

**[Freshin DL-Sensor-AU Motion Sensor LED Down Light](#)** [pdf] Instruction Manual  
DL-Sensor-AU Motion Sensor LED Down Light, DL-Sensor-AU, Motion Sensor LED Down Light,  
Sensor LED Down Light, LED Down Light, Down Light, Light

## References

- [User Manual](#)