



freqport FT-1 Hub User Manual

[Home](#) » [freqport](#) » freqport FT-1 Hub User Manual 

freqport FT-1 Hub User Manual



Contents

- [1 Welcome](#)
- [2 Hardware](#)
- [3 Software](#)
- [4 Installation](#)
- [5 DAW and Plugin](#)
- [6 Hub](#)
- [7 Firmware Updater](#)
- [8 Hardware Specifications](#)
- [9 Block Schematic](#)
- [10 Notices](#)
- [11 Notices](#)
- [12 Documents / Resources](#)

Welcome

Fregport products have been developed for audio producers, engineers and song writers to enable them to craft better sound through pure analog processing – with all of the benefits of digital integration, control and recall.

Real analog inside your computer” The current product lineup is just the beginning and we would like to sincerely thank you for becoming part of our family.

THANKYOU

Hardware

The FT-1 freqtube hardware is designed for achieving maximum analog performance with professional 32bit converters, all metal enclosure, and minimal aesthetic with full colour high resolution display to show assignments and status. DC power is converted to low noise high voltage within the unit. USB C connectivity to a host computer is provided via rear connector,

top

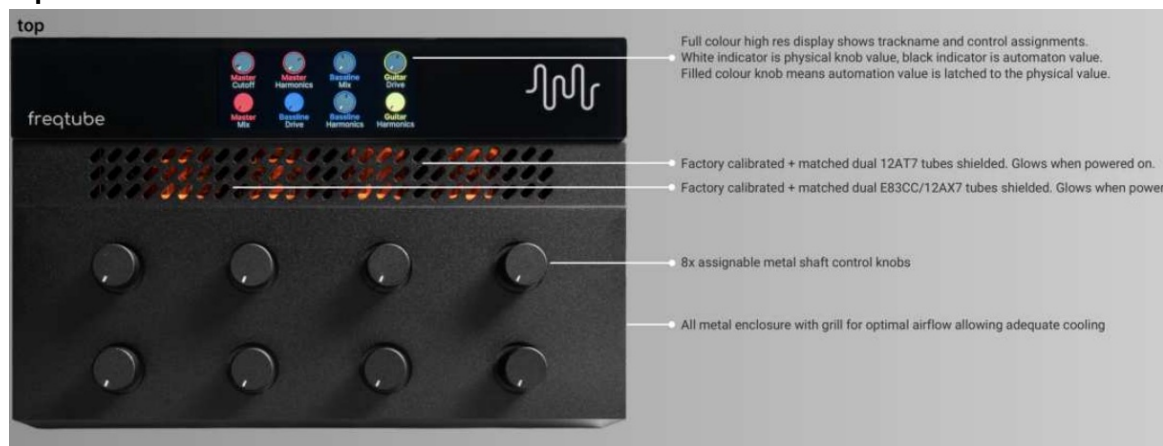

Rear



Software

Fregtube is available as an installer for MAC and PC. The installed software consists of multiple plug-in formats along with a hub application and in the case of windows also a driver. Fregport is continuously working on

updates and platform validation testing. Please refer to the freqport website for latest up-to-date compatibility and software releases.

Installation

1. First check supported systems here: support.freqport.com/portal/en/kb/articles/supported-systems
2. Download the appropriate installer from mac or pc from here:
support.freqport.com/portal/en/kb/freqport/downloads
3. For windows please run Add or remove software and Uninstall existing installation of freqtube before installing and update.
4. Extract the installer from the zip file then run the installer (pkg, or exe).
5. Accept all licences and prompts to allow installation. Please only install to the default locations (do not install to a different location).
6. Reboot computer.
7. Ensure FT-1 is firmly plugged directly into a spare USB port on the host computer.
8. Turn-on power to the FT-1.

DAW and Plugin

All FT-1 audio processing is done in hardware. The plugin UI shows all audio processing options and paths within the hardware. All controls are automatable and can be stored and recalled via presets.

- Before using your DAW check articles on optimizing your DAW for freqtube here:
support.freqport.com/portal/en/kb/freqport
- To use the plugin simply open your DAW, find freqtube from the plugin list then add to an audio track.
- The maximum number of instances of the plugin you can open is the number of hardware tube circuits used.
For example; a maximum of two stereo instances can be opened in a project.
- To render (bounce) the final track then ensure real-time rendering is used in your DAW.

Hub

A companion app called the hub is opened automatically in the background when any freqtube plugin is used. The hub is not required to be opened manually by the user at any time, other than to set some configuration settings during use, or showing status of the freqport system. Further details shown on the hub page.

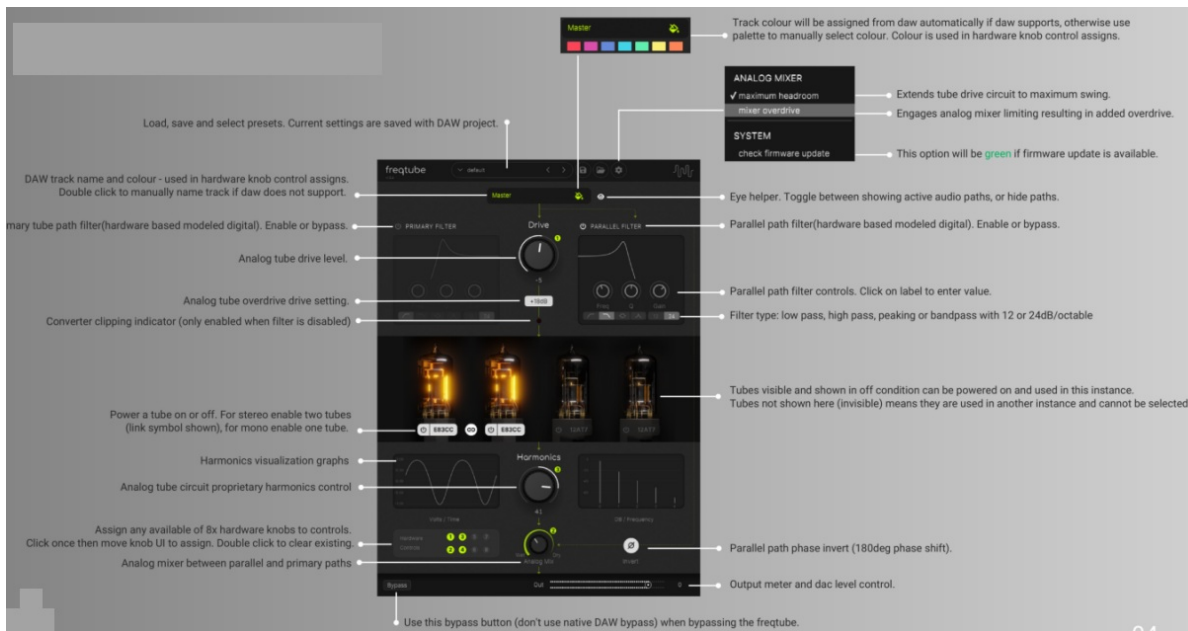

The hub runs automatically in the background when plugins are used in the DAW. Generally the user does not need to access the hub other than to optimize latency or for informative reasons.

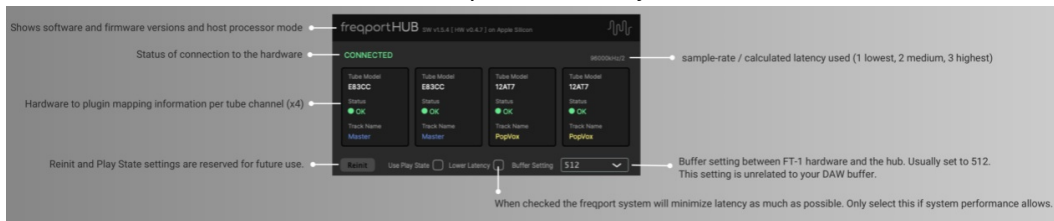

Firmware Updater

Occasionally a hardware device firmware update will be part of the installed software. Firmware updates are done using the freqport updater app.

The updater app can be run from one of three methods:

- from plugin by selecting the “run firmware updater” setting (shown here), or
- from the hub when an update is available, or
- when daw is closed by manually opening freqtube_hub.app (osx) or freqtube_hub.exe (windows)

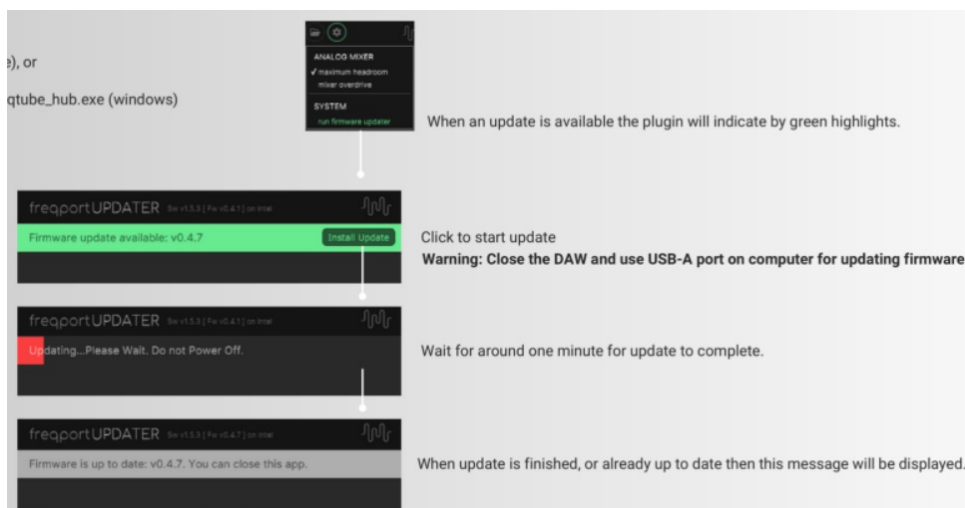

Hardware Specifications

- **Power Input**

24W DC power adaptor

Use only freqport adaptor

- **Adaptor Mains**

100Vac – 240Vac. 50/60Hz.

- **Ambient Temperature Range**

0to 50C

- **USB Connector**

Type-C 480Mbps.

- **ADC/DAC Converters**

Professional specification ESS Converters

120dB DNR 32bit DAC

116dB DNR 32bit ADC

- **Dimensions**

Unit: 205mm x 130mm x 50mm (W x H x D)

Boxed: 350mm x 120mm x 80mm (W x H x D)

- **Weight**

Unit: 810g

Boxed: 1.43kg

- **Control and Indication**

Full Color Display 8 assignable knobs Power switch

Block Schematic

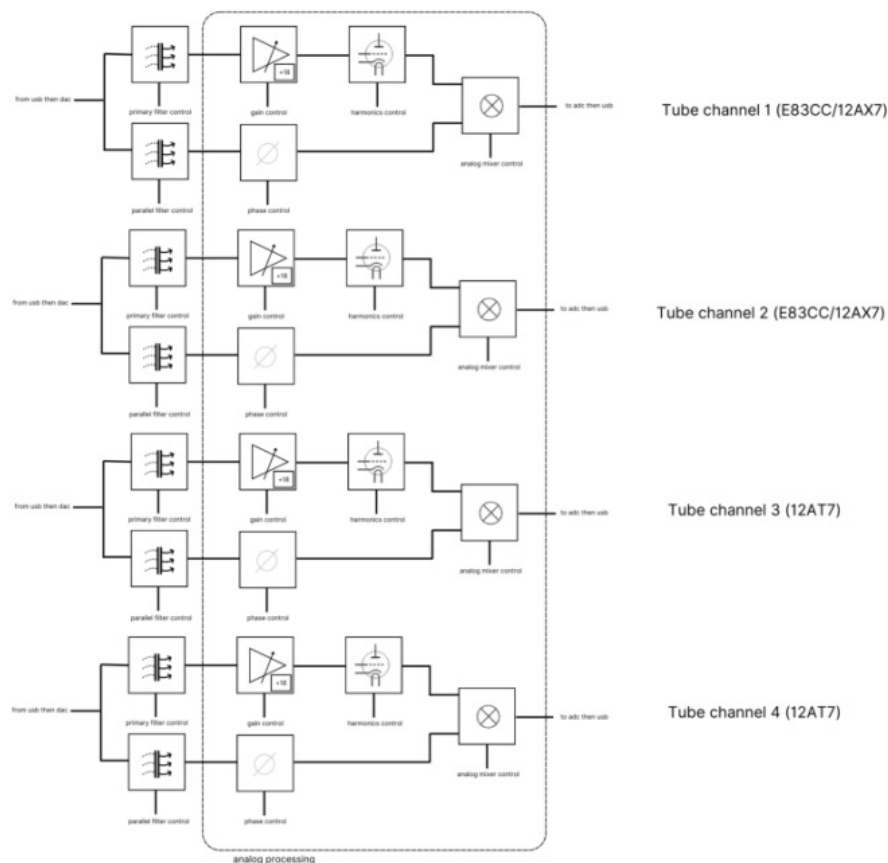

Notices

Important Safety Information

Before using this unit, be sure to carefully read the applicable items of these operating instructions and the safety suggestions. Afterwards, keep them handy for future reference. Take special care to follow the warnings indicated on the unit, as well as in the operating instructions.

- Read and keep these instructions.
- Heed all warnings.
- Follow all instructions.
- Do not use this apparatus near water.
- Clean only with dry cloth.
- Do not block any ventilation openings. Install in accordance with the manufacturer's instructions.
- Do not install near any heat source such as radiators, heat registers, stoves, or other apparatus (including amplifiers) that produce heat.
- Use only a power supply sourced from freqport. Attach the power adapter blade that is suitable for your country. Do not force or modify any part of the product connectors.
- Protect the power cord from being walked on or pinched particularly at plugs, convenience receptacles, and the point where they exit from the apparatus.
- Only use with attachments/accessories specified by the manufacturer.
- Unplug this apparatus during lightning storms or when unused for long periods of time.
- Refer all servicing to qualified service personnel. Servicing is required when the apparatus has been damaged in any way, such as power-supply cord or plug is damaged, liquid has been spilled or objects have fallen into the apparatus, the apparatus has been exposed to rain or moisture, does not operate normally, or has been dropped.

United States FCC Manual Statement

This equipment has been tested and found to comply with the limits for a Class B digital device pursuant to Part 15 of the FCC Rules. These limits are designed to provide reasonable protection against harmful interference in a residential installation. This equipment generates, uses, and can radiate radio frequency energy and, if not installed and used in accordance with the instructions, may cause harmful interference to radio communications. However, there is no guarantee that interference will not occur in a particular installation. If this equipment does cause harmful interference to radio or television reception, which can be determined by turning the equipment off and on, the user is encouraged to try and correct the interference by one or more of the following measures:

- Reorient or relocate the receiving antenna.
- Increase the separation between the equipment and the receiver.
- Connect the equipment into an outlet on a circuit different from that to which the receiver is connected.
- Consult the dealer or an experienced radio/TV technician for help.



European Union CE regulation compliance statement

This product has been tested to comply with the Low Voltage Directive 2014/35/EU and the Electromagnetic Compatibility Directive 2014/30/EU. The product meets the requirements of RoHS 2 Directive 2011/65/EU.

This symbol indicates that your product must be disposed of properly according to local laws and regulations.

Notices

Warranty

Fregport provides a limited warranty on all hardware products. To learn more, please visit www.fregport.com/terms-and-conditions. The limited warranty gives you specific legal rights. You may also have other rights which vary by state or country.

Trademarks

fregport and fregtube are trademarks or registered trademarks of fregport PTY, LTD. Other company and product names mentioned herein are trademarks of their respective owners. ASIO is a trademark and software of Steinberg Media Technologies GmbH.

Patent

fregport and fregtube products have patent pending, or afford patent protection. The associated technology and products are protected and owned by fregport PTY LTD.

Copyright

Copyright ©2022 fregport PTY, LTD. All rights reserved.

This manual and any associated software, artwork, product designs, and design concepts are subject to copyright protection. No part of this document may be reproduced, in any form, without prior written permission of fregport PTY, LTD.

Technical Support

fregport knowledge Base, online technical resource for configuring, operating, troubleshooting, fregport products. You can watch helpful support videos, search the Knowledge Base for answers, get updated technical information, submit support tickets and more.

Please visit: support.fregport.com

The information in this document is subject to change without notice and does not represent a commitment on the part of fregport PTY LTD. The software described by this document is subject to a License Agreement and may not be copied to other media. No part of this publication may be copied, reproduced or otherwise transmitted or recorded, in whole or in part, for any purpose, without prior written permission by fregport PTY LTD, hereinafter referred to as fregport.

CONTACT US

support@fregport.com

sales@fregport.com

www.fregport.com

Documents / Resources



[fregport FT-1 Hub](#) [pdf] User Manual
FT-1 Hub, FT-1, Hub