



Freeman Technology FRMKB68D 68 Key RGB Gaming Keyboard User Guide

[Home](#) » [Freeman Technology](#) » Freeman Technology FRMKB68D 68 Key RGB Gaming Keyboard User Guide



Contents

- 1 [Freeman Technology FRMKB68D 68 Key RGB Gaming Keyboard](#)
- 2 [DISPLAY](#)
- 3 [WIRED INSTALLATION INSTRUCTIONS](#)
- 4 [WIRELESS \(RF\) INSTALLATION INSTRUCTIONS](#)
- 5 [How to re sync the keyboard to the RF dongle](#)
- 6 [SWITCHING BETWEEN WIRED AND WIRELESS MODE](#)
- 7 [CHARGING THE BATTERY](#)
- 8 [FN SHORTCUTS](#)
- 9 [USING THE KEYCAP AND SWITCH PULLER](#)
- 10 [Removing the switches](#)
- 11 [DEVICE SOFTWARE](#)
- 12 [SPECIFICATIONS](#)
- 13 [FCC](#)
- 14 [Documents / Resources](#)
- 15 [Related Posts](#)

Freeman

Freeman Technology FRMKB68D 68 Key RGB Gaming Keyboard



DISPLAY

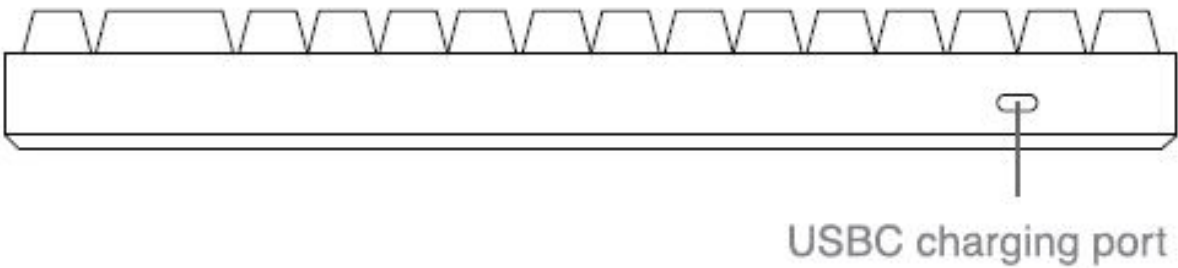

(BACK SIDE OF THE KEYBOARD)

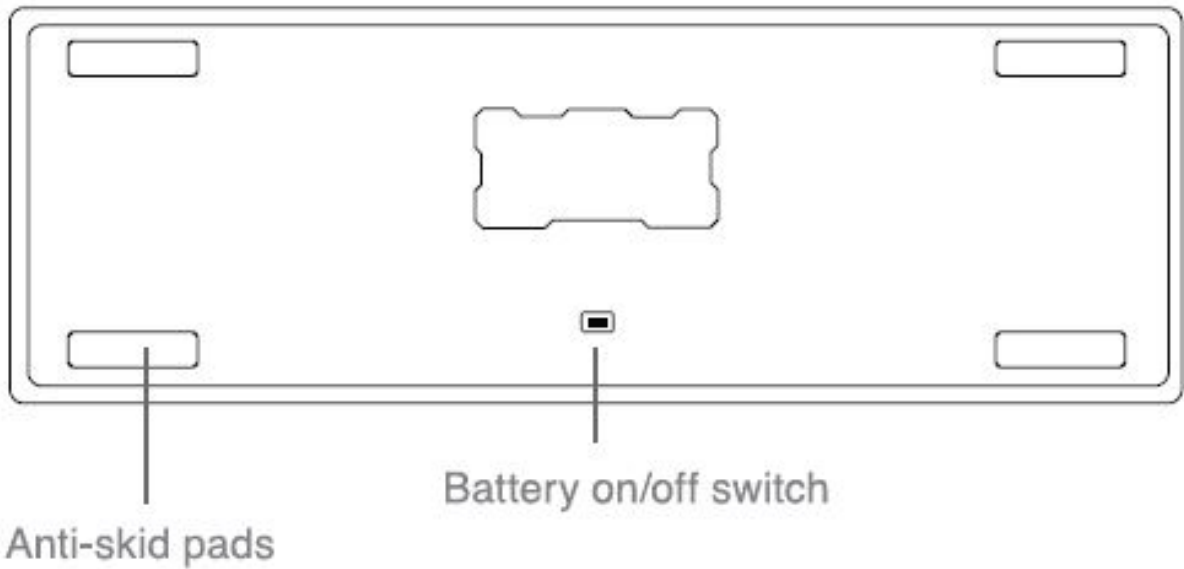

WIRED INSTALLATION INSTRUCTIONS

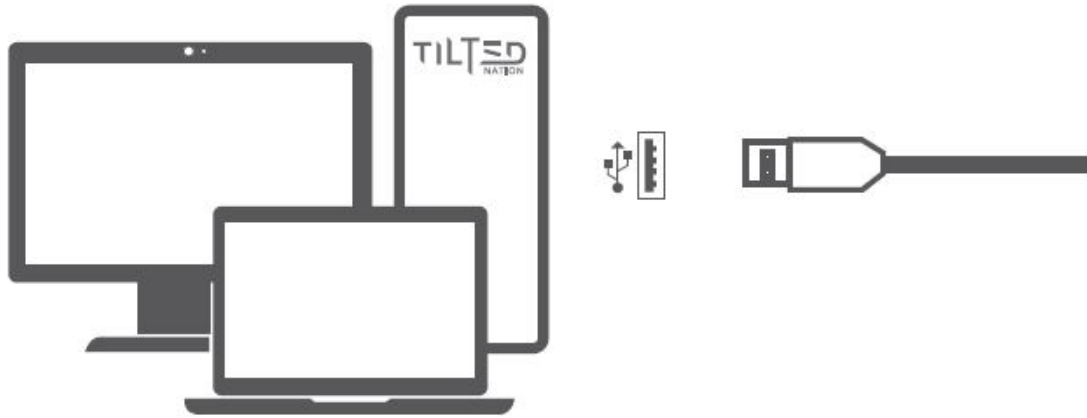

Connect the USB-C end of the USB cable into the USB-C slot located on top end of the keyboard and the USB-A end into any available USB port on your computer or laptop. The device is Plug-N-Play and will be ready to use after the driver is automatically installed by Windows.

Note: While plugged into the computer you will be charging the internal battery which will allow you to use the keyboard wirelessly when needed. Please refer to the wireless installation instruction for wireless usage.

WIRELESS (RF) INSTALLATION INSTRUCTIONS



Please follow the steps below to start using the keyboard wirelessly using the RF dongle.

1. Connect the RF dongle that came with your keyboard into any available USB port on your computer or laptop. The RF dongle is Plug-N-Play and will be ready to use after the driver is automatically installed by Windows.
2. Turn on the internal battery by switching the on/off switch (located on the back of the keyboard) to the on position.
Note: Please keep the switch in the off position when wireless gameplay is not needed.
3. On the keyboard press and hold the FN key then press and release the Q key. This will set the keyboard to RF mode as printed on the key.

Note: You can switch back to wired mode by pressing the letter T while holding the FN key.

Once set to RF mode you can plug the keyboard into any USB charger to charge the keyboard while using the keyboard wirelessly.

How to re sync the keyboard to the RF dongle

The following steps will help you re-sync the keyboard to the RF dongle.

1. Remove the dongle from your computer/laptop.
2. Press and release FN+Q (RF mode). Since the dongle is out the Q LED will flash constantly.
3. Press and hold FN+P for 5 seconds until the Q and P keys start to flash.
4. Plug the RF dongle into any USB port on your computer/laptop and the keyboard will automatically sync with the dongle.

SWITCHING BETWEEN WIRED AND WIRELESS MODE



You can switch between wired and wireless mode at any time by simply holding down the FN key followed by any of the following keys:

- Q/RF: Wireless
- T/Wired: Wired

CHARGING THE BATTERY

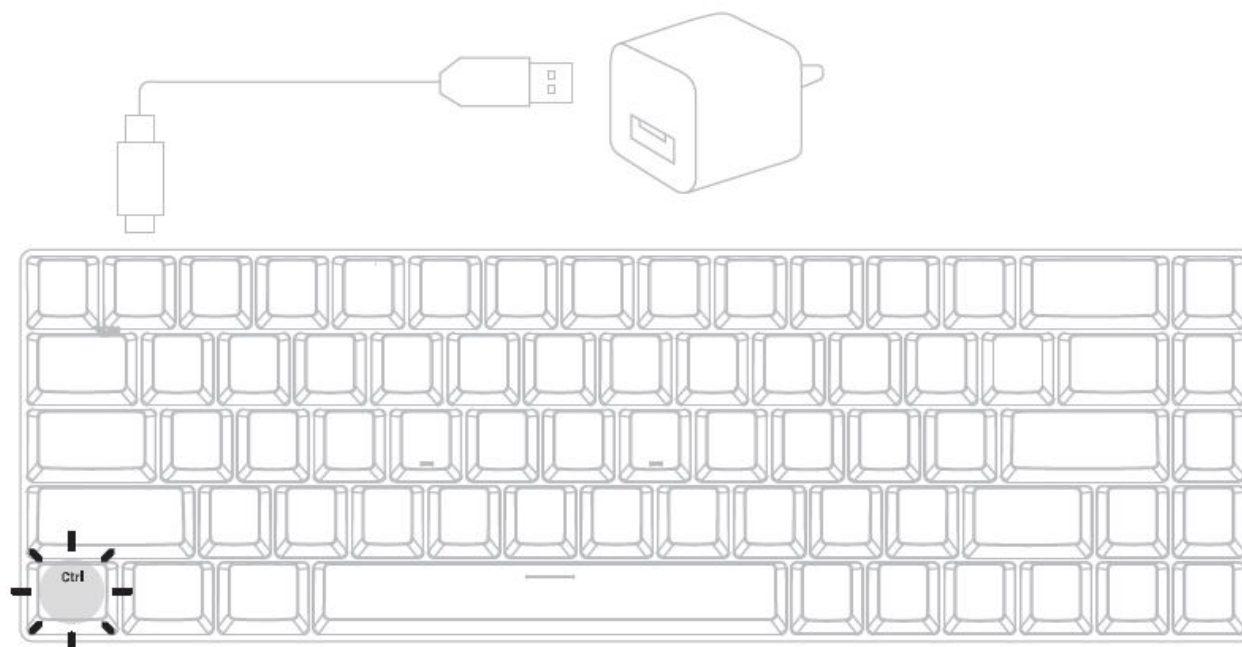

When using the keyboard wirelessly, the CTRL key located on the left side of the keyboard will start to flash indicating that the battery is low and needs to be charged. To charge the keyboard simply connect the USBC end of the charging cable into the USBC port located at the top of the keyboard and the USBA end into any USBA charger.

FN SHORTCUTS

The keyboard is preprogrammed with 34 predefined productivity and RGB shortcuts. To utilize these shortcuts simply “press and hold” the FN key followed by the shortcut you would like to perform. Below is a table of what each shortcut does.

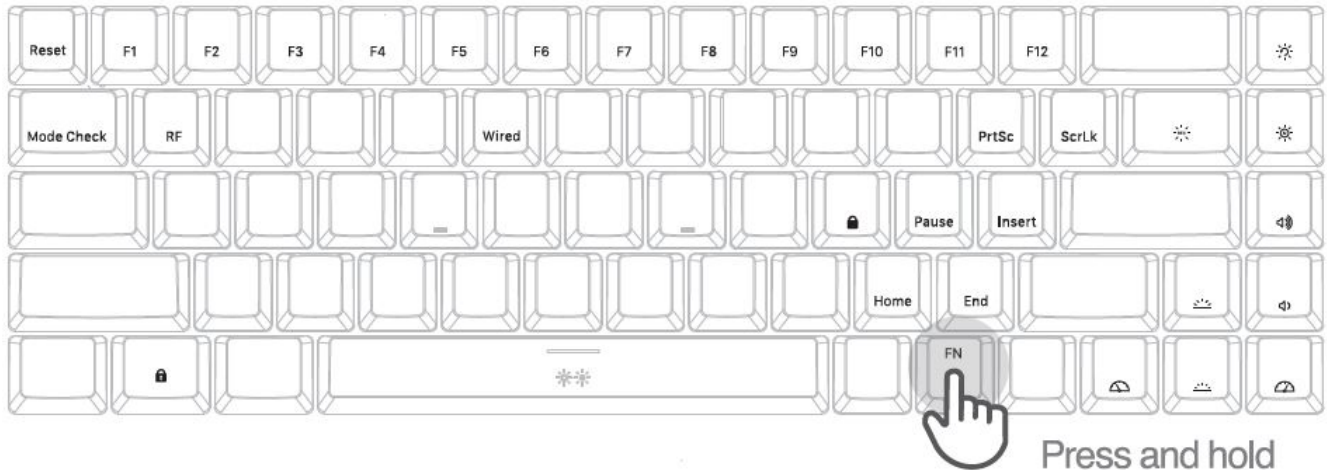

Productivity Shortcuts

FN+	Shortcut description
ESC	Resets the keyboard to its factory default settings. To perform this action simply press & hold the FN Key and ESC key simultaneously until the keyboard's RGB flashes on/off.
L	Lock/unlock all keys on the keyboard (all keys will be disabled when locked). When locked the L key will stay solid white.
WIN	Locks the Win key
	F1
2	F2
3	F3

4	F4
5	F5
6	F6
7	F7
8	F8
9	F9
0	F10
–	F11
=	F12
[Print screen / System Request
]	Scroll lock
;	Pause
,	Insert
.>	Home
/	End

T	Switches the keyboard to wired mode
Q	Switches the keyboard to wireless RF mode
Tab	<p>Used to identify the current keyboard connection mode being used. Once pressed the Tab key will flash for 10 seconds (green or pink) to help you identify the connection type being used.</p> <ul style="list-style-type: none"> • Green flash: RF • Pink flash: Wired

RGB Control Shortcuts

FN+	Shortcut description
Del	Switches between the 19 predefined RGB modes
~	Change the static RGB color (8 colors to choose from)
/	Start/Stop RGB recording
Space	RGBon/off
up button	Increase the RGB brightness
down button	Decrease the RGB brightness
left button	Decrease the RGB speed
right button	Increase the RGB speed
PgUp	Volume+
PgDn	Volume –

Recording a static layout

To record your own personalized “static RGB” layout please do the following:

1. Press and release FN+\ to put the keyboard in custom RGB mode.
2. Press and release FN+\ again to initiate recording. In record mode the Win & Caps LEDs will flash rapidly indicating that it is in record mode.
3. Press each key to cycle through the different color options. Each key is controlled independently so you will need to repeat the color option for each key.
4. Once you are done, press FN+\ one more time to save and apply the current pattern.

Note: Keyboard typing will be disabled while it is in record mode and you can only record 1 static layout.

USING THE KEYCAP AND SWITCH PULLER

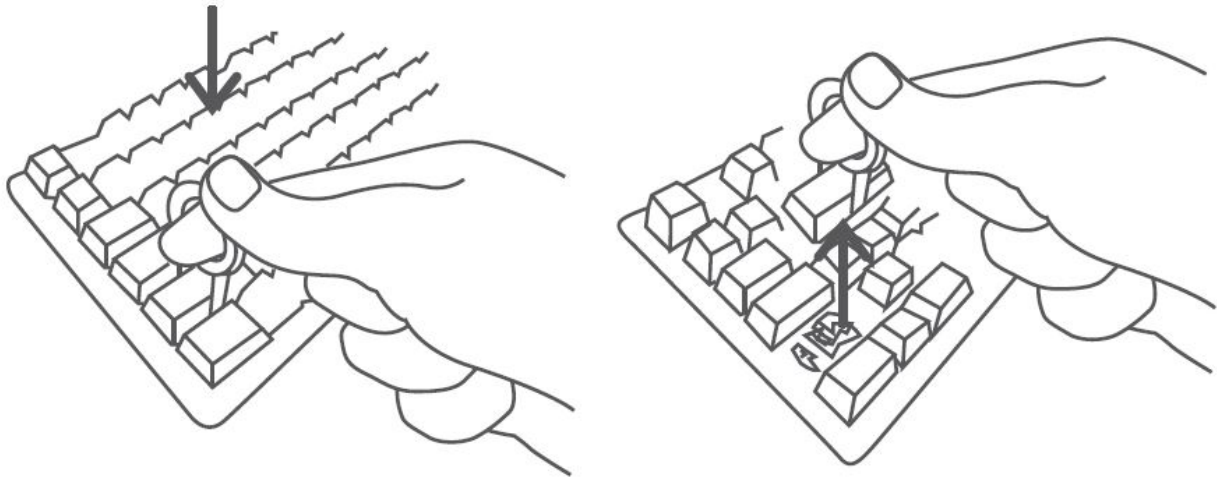

Should you need to remove the keycaps and switches on your mechanical keyboard to brush away any crumbs, dust, lint, or to simply swap out the caps/switches to add a personal touch, you'll need to use the included keycap and switch pullers.

Removing the keycaps

- Unplug the keyboard from your computer.
- Attach the keycap puller over the keycap you wish to remove by pushing the puller down over the keycap until the puller grasps the cap fully.
- Pull up on the keycap to remove it from the switch.

To reattach the keycap simply align the crosshairs located under the keycap over the switch and push it down into place.

Removing the switches

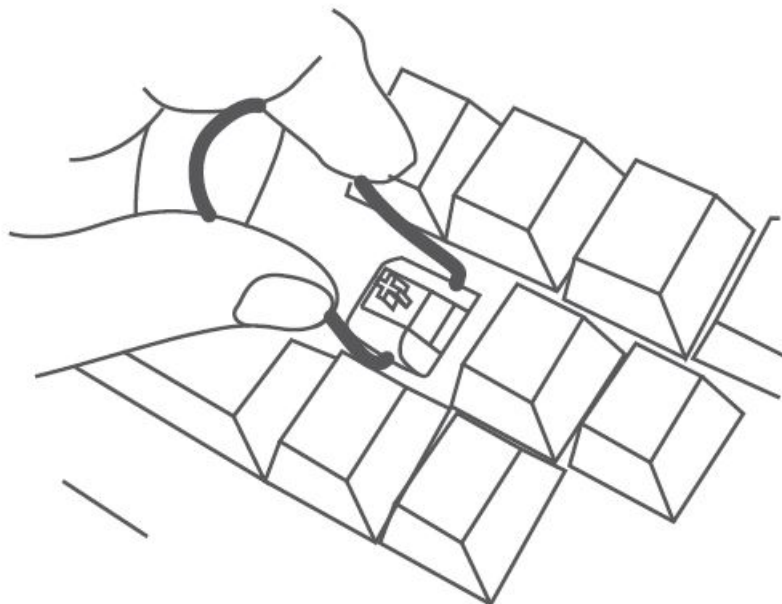

With the keycap already removed, place the switch puller over the top and bottom part of the switch and clamp it tightly while lifting it upwards.

Important: When reattaching the switches please make sure you align the switch pins correctly before pushing

them into place. Pushing them in incorrectly will cause the pins to bend making them unusable.

DEVICE SOFTWARE

The Tilted Nation software* will give you full control of your gaming device. Once installed you will be able to customize the RGB settings, create custom profiles so that you can tailor the devices performance and keys to specific games, create custom macros (combination keys) to help you gain advantage over your opponents and much more. The software can be downloaded for free at www.tiltednation.com

Not all items come with software. Please visit the download section of our website to see if there is software available for your item.

SAFETY INSTRUCTIONS

Please read the following carefully. Incorrect use of this product may result in reduced performance, permanent damage and void your warranty.

- Keep this device away from liquid, humidity and moisture.
- Operate this device only within the specific temperature range of 0c (32° F) to 5c to 40°c (104° F)
- Please refrain from taking the device apart. Doing so will void your warranty.
- Do not dispose this product in the garbage. Take it to your local recycling center.

SPECIFICATIONS

Keys	68
Switches	Otemu brown (hot swappable)
Hot swap connector	Gateron
Battery	1800 mAh (up to 40 hrs on a single charge)
Charge time	3hrs
Wireless type	RF2.4G
Battery type	Polymer Lithium Ion
Keyboard charge port	USBC
Key caps	Double shot ABS
Polling rate	1000Hz

FCC

This device complies with part 15 of the FCC Rules. Operation is subject to the following two conditions:

1. This device may not cause harmful interference.
2. This device must accept any interference received, including interference that may cause undesired operation.

Any Changes or modifications not expressly approved by the party responsible for compliance could void the user’s authority to operate the equipment.

Note: This equipment has been tested and found to comply with the limits for a Class B digital device, pursuant to part 15 of the FCC Rules. These limits are designed to provide reasonable protection against harmful interference in a residential installation. This equipment generates uses and can radiate radio frequency energy and, if not installed and used in accordance with the instruction, may cause harmful interference to radio communications. However, there is no guarantee that interference will not occur in a particular installation. If this equipment does cause harmful interference to radio or television reception, which can be determined by turning the equipment off and on, the user is encouraged to try to correct the interference by one or more of the following measures:

- Reorient or relocate the receiving antenna.
- Increase the separation between the equipment and receiver.
- connect the equipment into an outlet on a circuit different from that to which the receiver is connected.
- Consult the dealer or an experienced radio/TV technician for help.

Documents / Resources

	Freenman Technology FRMKB68D 68 Key RGB Gaming Keyboard [pdf] User Guide FRMKB68D, 2A3X4FRMKB68D, FRMKB68D 68 Key RGB Gaming Keyboard, 68 Key RGB Gaming Keyboard, Gaming Keyboard, Keyboard
---	---