



FREE THE TONE PA-1Q Programmable Analog 10 Band EQ Graphic Equalizer User Guide

[Home](#) » [FREE THE TONE](#) » FREE THE TONE PA-1Q Programmable Analog 10 Band EQ Graphic Equalizer User Guide 

Contents

- [1 FREE THE TONE PA-1Q Programmable Analog 10 Band EQ Graphic Equalizer](#)
- [2 Product Information](#)
- [3 Specifications](#)
- [4 Controls and indicators](#)
- [5 Adjusting Equalizer](#)
- [6 Recalling a Preset](#)
- [7 Changing/writing preset contents](#)
- [8 Configuring MIDI settings](#)
- [9 Receivable MIDI Messages](#)
- [10 Initializing](#)
- [11 Documents / Resources](#)
 - [11.1 References](#)



FREE THE TONE

FREE THE TONE PA-1Q Programmable Analog 10 Band EQ Graphic Equalizer



Product Information

The Programmable Analog 10 Band EQ Graphic Equalizer is a device that allows you to adjust the boost amount of selected frequencies or volume for a preset. It comes with a PRESET display that shows the number of the currently recalled preset, a PRESET tact switch that is pressed when recalling a preset, and an equalizer display that shows the currently recalled preset's equalizer status or volume. Additionally, it has an EFFECT ON/OFF switch that is pressed to turn on/off the equalizer effects.

The device also features a PARAMETER encoder that is turned when adjusting the boost amount of the selected frequency or volume for the preset. It is pressed when confirming the operation to save parameters in a preset. Furthermore, it has a cursor key switch that selects the frequency or volume to be adjusted and a SAVE switch that is pressed when saving parameters in a preset.

On the rear panel, it has an INPUT LEVEL select switch that is used to select PA-1Q series input level according to the output level of the device connected to the INPUT terminal. It also has an INPUT terminal used to connect a guitar/bass, another instrument, effects unit, etc. Additionally, it has an OUTPUT terminal used to connect to your amplifier/mixer, etc. Finally, it has MIDI IN & OUT/THRU terminals used to send/receive MIDI signals to/from a connected external MIDI device. ◀ ▶

Specifications

- **Number of presets:** 99
- **Input impedance:** INST min. 1 M Ω / LINE min. 300 k Ω
- **Output load impedance:** min. 10 k Ω
- **Max. input level:** INST +4 Bu / LINE +14 Bu (EQ setting = flat)
- **Controls:** ◀ ▶ cursor keys, PARAMETER encoder, INST (-10dB)/LINE(+4dB) level selector switch
- **Frequencies PA-1QG:** 50 Hz, 100 Hz, 200 Hz, 400 Hz, 800 Hz, 1500 Hz, 2500 Hz, 3500 Hz, 7 kHz, 10 kHz (± 12 dB)
PA-1QB: 40 Hz, 80 Hz, 125 Hz, 250 Hz, 500 Hz, 800 Hz, 1200 Hz, 2400 Hz, 4500 Hz, 8 kHz (± 12 dB)
PA-1QA: 31 Hz, 62 Hz, 125 Hz, 250 Hz, 500 Hz, 1 kHz, 2 kHz, 4 kHz, 8 kHz, 16 kHz (± 12 dB)
- **Terminals:** 1/4" standard phone jack x 2 (input and output) 9V DC input jack (for AC adapter), DIN 5-pin

connector × 2 (MIDI IN and OUT /THRU)

- **Power supply:** 9V DC center negative polarity
- **Current consumption:** 200 mA
- **Dimensions (W x D x H):** 120 x 102.3 x 58.5 mm (incl. protuberances such as footswitch, jacks, etc.)
- **Weight (excl. accessories):** approx. 350 g or 0.77 lbs
- **Accessories:** Warranty card, Quick Start Guide, Safety Precautions, rubber feet x 4

Please download detailed instruction manuals from the SUPPORT page on our website.

www.freethetone.com/en/support/download/

Controls and indicators

Front panel

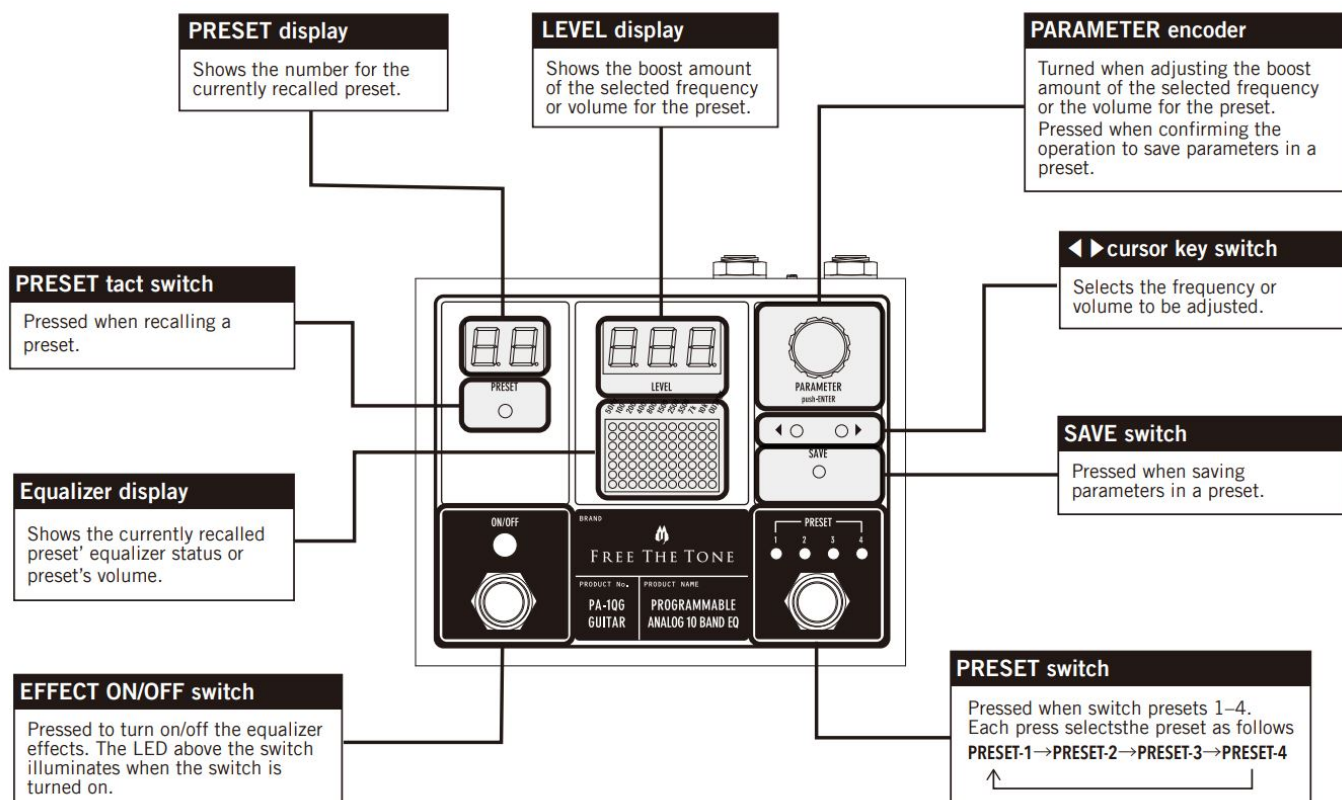

Rear panel

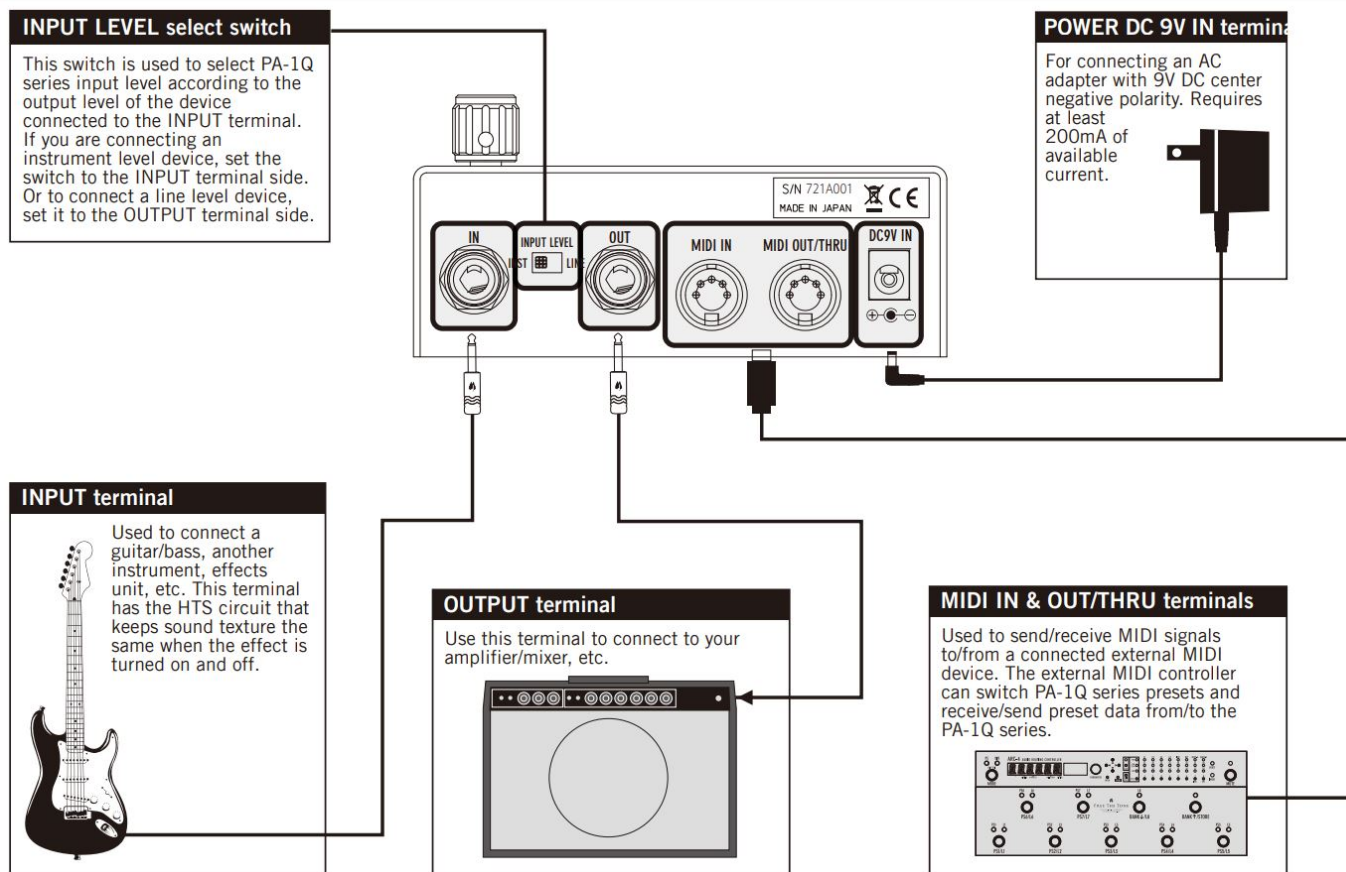

Adjusting Equalizer

You can create your favorite tone by adjusting various parameters.

Adjusting the equalizer

1. Press the ON/OFF switch to turn on the LED above it.
2. Press the ◀▶ cursor key switch to select the frequency to be adjusted (blue dot) in the equalizer display.
3. Turn the PARAMETER encoder to adjust the boost amount of the selected frequency.

NOTE The boost amount of the selected frequency is adjustable in the range of +12 dB. The selected frequency is shown in the equalizer display. The boost amount for the selected frequency is shown in the LEVEL display. Double-clicking the PARAMETER encoder resets the boost amount of the selected frequency to zero. The previous value returns by double-clicking the encoder again.

Adjusting a preset's volume

1. Press the ON/OFF switch to turn on the LED above it.
2. Press the ◀▶ cursor key switch to select the OUTPUT (green dot) in the equalizer display.
3. Turn the PARAMETER encoder to adjust the volume for the preset.

NOTE

The preset's volume is adjustable from 0 to 127. The preset's volume is shown in the LEVEL display. When all of the frequencies of the equalizer are set to boost amount 0, unity level is obtained with the LEVEL value 100, and when the value is 127, the volume can be increased up to +12 dB. Double-clicking the PARAMETER encoder resets the volume back to 100. The previous value returns by double-clicking the encoder again.

Recalling a Preset

The PA-1Q series can use up to 99 presets that can be recalled in various ways.

Switching between presets 1-4

1. Press the ON/OFF switch to turn on the LED above it.
2. Press the PRESET switch to switch the presets.

NOTE Each press of the PRESET switch changes the presets as follows: PRESET 1-> PRESET 2 -> PRESET 3 -> PRESET 4 -> PRESET 1, ...

Switching between presets 1-99

1. Press the ON/OFF switch to turn on the LED above it.
2. Press the PRESET tact switch to flash the PRESET display.
3. Turn the PARAMETER encoder to show the preset to be recalled.
4. Press the PARAMETER encoder to recall the selected preset.

Switching presets via MIDI

1. Connect an external MIDI controller to the MIDI IN terminal on the PA-1Q series rear panel.
2. Press the PA-1Q series ON/OFF switch to illuminate the LED above it.
3. From the external MIDI controller, send the MIDI program change number corresponding to the preset to be recalled.

NOTE Be sure to set the same MIDI program change number on the sending device's MIDI channel and the PA-1Q series MIDI channel.

Changing/writing preset contents

1. Press the ON/OFF switch to turn on the LED above it.
2. Press the ◀▶ cursor key switch to select the parameter to be adjusted.
3. Turn the PARAMETER encoder to adjust the selected parameter.
4. Press the SAVE switch.
5. The LEVEL display shows the destination preset number.
6. Turn the PARAMETER encoder to select the desired preset number.
7. Press the PARAMETER encoder to store the preset to the selected numbered location

NOTE When a preset's parameter is changed, the dot at the PRESET display's lower right corner illuminates. This dot turns off when the save operation is confirmed by pressing the PARAMETER encoder and the parameters are written to the preset. If the SAVE switch is pressed again after pressing it, then the write operation is canceled.

Configuring MIDI settings

The PA-1Q series can receive MIDI signals sent from an external controller to switch presets and edit parameters.

Setting a MIDI receiving channels

1. Turn on the power to the PA-1Q series while holding down the PRESET switch.
2. The PRESET display shows “ch”.
3. The LEVEL display shows the number of the MIDI receiving channel.
4. Turn the PARAMETER encoder to show the desired MIDI receiving channel.
5. Press the PARAMETER encoder to confirm the selected MIDI receiving channel.

NOTE User editable parameters: ALL (Omni mode), 1-16 (MIDI receiving channel), OFF [PRESET] switch means the footswitch on the lower right of the front panel.

Receivable MIDI Messages

The PA-1Q series can switch presets or change all of the parameters via MIDI signals sent from an external device. MIDI signals assigned to controllable functions are listed below. Correspondence between presets and MIDI program change numbers

PRESET Number	Program Change Number
PRESET-1	001
PRESET-2	002
PRESET-3	003
PRESET-4	004

When the PA-1Q series receives a MIDI program change number 001-004, the corresponding LED 1-4 above the PRESET switch illuminates and the PRESET display shows the corresponding preset number. If a MIDI program change number 005 or later is received, then the LEDs 1-4 above the PRESET switch will not illuminate but the PRESET display shows the corresponding preset number.

Initializing

1. Turn on the power to the unit while holding down the cursor key switch and PRESET switch.
2. The LEVEL display shows ‘Int’.
3. Press the PARAMETER encoder to execute the initialization.
4. The PRESET display counts up from 01 to 99.
5. The LEVEL display shows the firmware version number.
6. All of the presets are returned to their factory default settings and usual operation resumes.

NOTE This operation clears all of the presets and resets all of the settings to the default status as shipped from the factory.

Correspondence between parameters and MIDI control change numbers

Controls			MIDI CC Numbers	Value Range
PA-1QG	PA-1QB	PA-1QA	Common to PA-1Q series	Common to PA-1Q series
50Hz	40Hz	31Hz	97	0-127
100	80	62	98	0-127
200	125	125	99	0-127
400	250	250	100	0-127
800	500	500	101	0-127
1500	800	1K	102	0-127
2500	1200	2K	103	0-127
3500	2400	4K	104	0-127
7K	4500	8K	105	0-127
10K	8K	16K	106	0-127
OUTPUT LEVEL			107	0-127
EFFECT ON/OFF			66	Off=0, On=127

EQ LEVEL	Value Range	EQ LEVEL	Value Range
+12	122 ~ 127	-1	56 ~ 60
+11	117 ~ 121	-2	51 ~ 55
+10	112 ~ 116	-3	46 ~ 50
+9	107 ~ 111	-4	41 ~ 45
+8	102 ~ 106	-5	36 ~ 40
+7	97 ~ 101	-6	31 ~ 35
+6	92 ~ 96	-7	26 ~ 30
+5	87 ~ 91	-8	21 ~ 25
+4	82 ~ 86	-9	16 ~ 20
+3	77 ~ 81	-10	11 ~ 15
+2	72 ~ 76	-11	6 ~ 10
+1	67 ~ 71	-12	0 ~ 5
0	61 ~ 66		

Documents / Resources

	FREE THE TONE PA-1Q Programmable Analog 10 Band EQ Graphic Equalizer [pdf] User Guide PA-1Q Programmable Analog 10 Band EQ Graphic Equalizer, PA-1Q, Programmable Analog 10 Band EQ Graphic Equalizer, 10 Band EQ Graphic Equalizer, Graphic Equalizer
---	---

References

-  [DOWNLOAD SUPPORT Free The Tone](#)

Manuals+.