



Free The Tone LB-2 Loop Box User Manual

[Home](#) » [FREE THE TONE](#) » Free The Tone LB-2 Loop Box User Manual 

Free The Tone LB-2 Loop Box User Manual



Contents

- [1 Specifications](#)
- [2 INPUT/OUTPUT JACK PANEL](#)
- [3 HOW TO USE LOOPS](#)
- [4 Documents / Resources](#)
- [5 Related Posts](#)

Specifications

- Number of Loops : 2 (two separated loops)
- Control: ON, RMT (remote)
- Terminals : 9 x 1/4" standard phone jack (input, output, control)
 - 1 x 1/4" standard TRS phone jack (control)
 - 1 x 9V DC input jack (for connecting AC adapter)
- Power supply : 9V DC center negative polarity
- Consumption current : 75 mA (max.)
- Dimensions (W x D x H, incl. protuberances such as jacks): 145 x 59 x 49 mm
- Weight : 230 g (0.51 lbs)
- Accessories : Warranty card, Owner's manual, Safety Precautions, 4 x rubber foot (No connecting cable included)

Specifications and appearance subject to change without notice.

INPUT/OUTPUT JACK PANEL

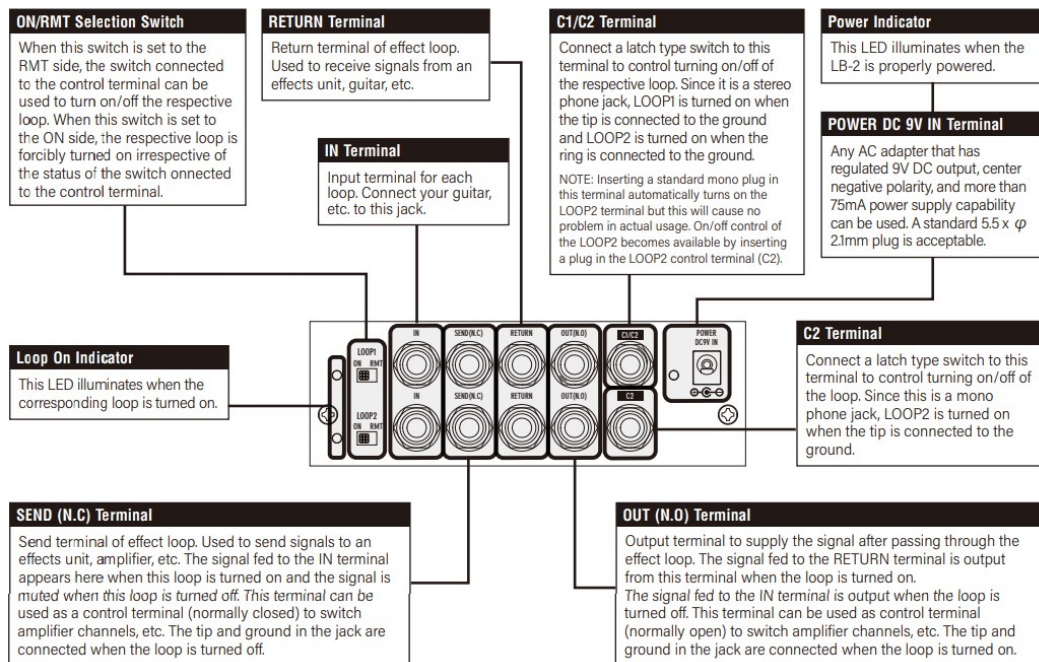

HOW TO USE LOOPS

The loop of the LB-2 can be used in a various ways. The signal path when the loop is ON/OFF is shown as a solid line and a dotted line in each setting.



As Effect Loop

Feed signals to the IN terminal and connect from the SEND terminal to effects unit's input. Connect from the effects unit's output to the RETURN terminal, then from the OUT terminal to a device that is placed downstream.

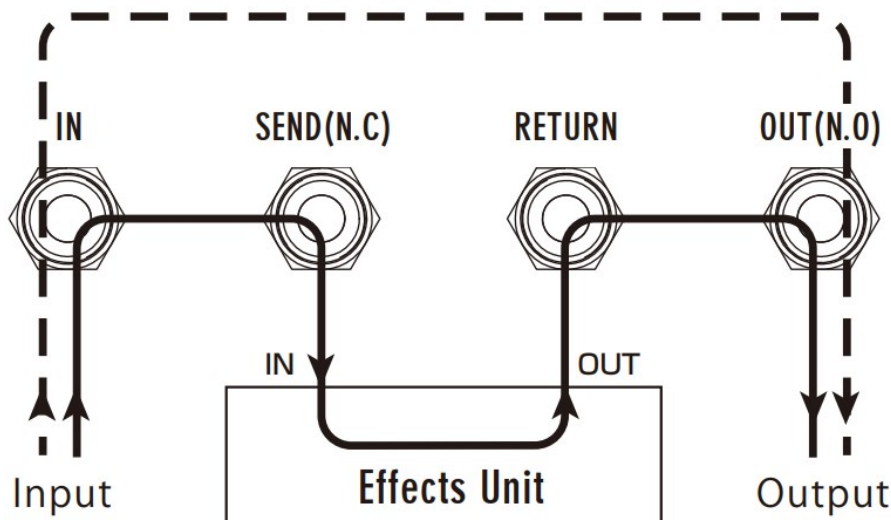

As Output Selector

The LB-2 can be used as an output selector to choose one of two outputs. Feed signals to the IN terminal and connect from the SEND terminal to the input of an amplifier, etc. The RETURN terminal should be left unplugged. Connect from the OUT terminal to the input of another amplifier, etc. When the loop is turned on and the output 1 is selected, the output 2 is muted to prevent crosstalk or noise. Conversely, by turning off the loop and selecting the output 2, the output 1 is muted.

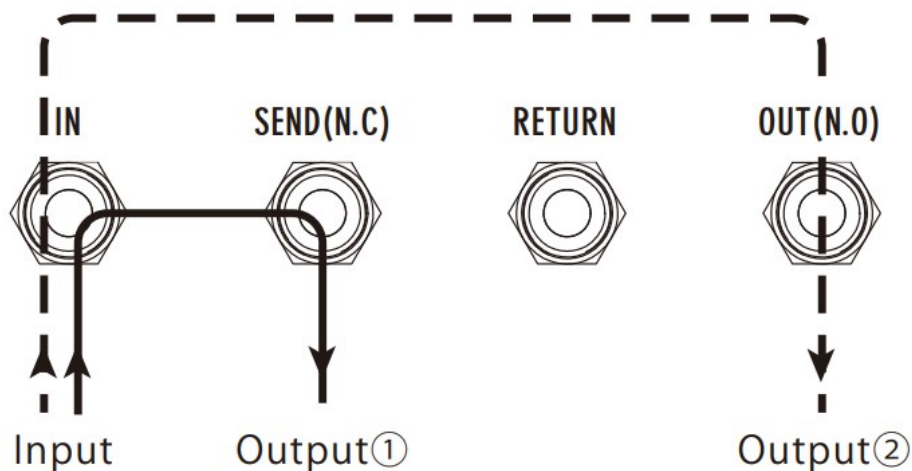

As Input Selector

The LB-2 can be used as an input selector to choose one of two inputs. Input 2 signal fed to the RETURN terminal is supplied from the OUT terminal when the loop is turned on. By turning off the loop, input 1 signal fed to the IN terminal is supplied from the OUT terminal. The SEND terminal should be left unplugged.

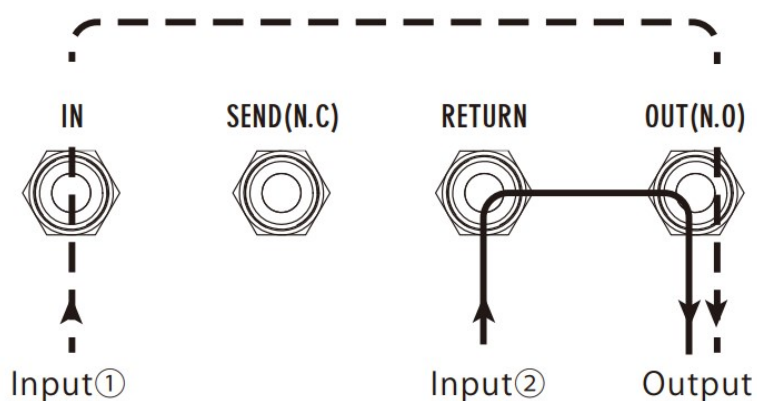

As Amplifier's Send/Return Effect Loop

Connect from an amplifier's send to the LB-2's IN terminal and then from the LB-2's SEND terminal to an effects unit's input. Connect from the effects unit's output to the LB-2's RETURN terminal and from the LB-2's OUT terminal to the amplifier's return input. Since the grounds of LOOP1 and LOOP2 are isolated, LOOP1 can be used as an effect loop between your guitar and amplifier, and LOOP2 as an amplifier's send/return effect loop.

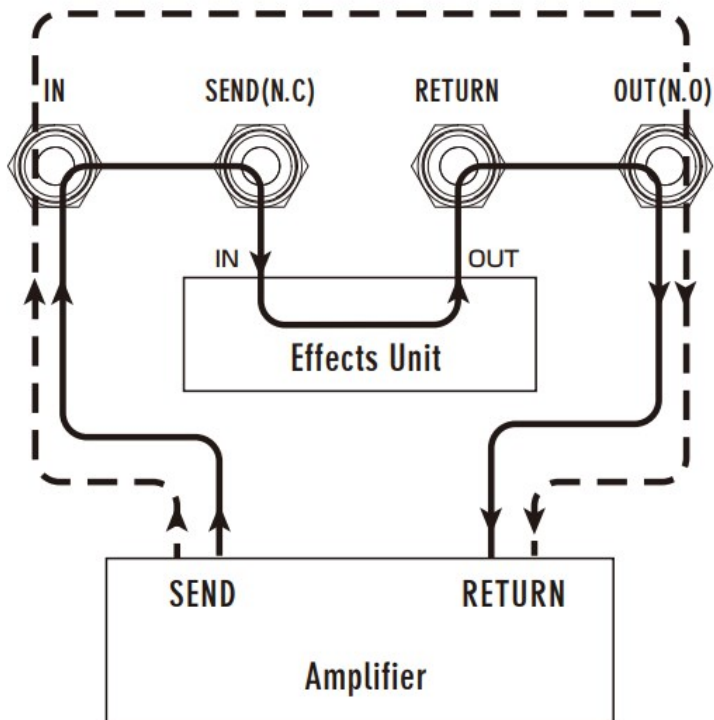

As Stereo Effect Loop

The LB-2 can be used as a single loop box for a device supporting stereo operation, assuming LOOP1 is for Left channel and LOOP2 for Right channel. Note that the IN/OUT terminal of each loop does not support a standard TRS plug, you need to use a standard mono plug.

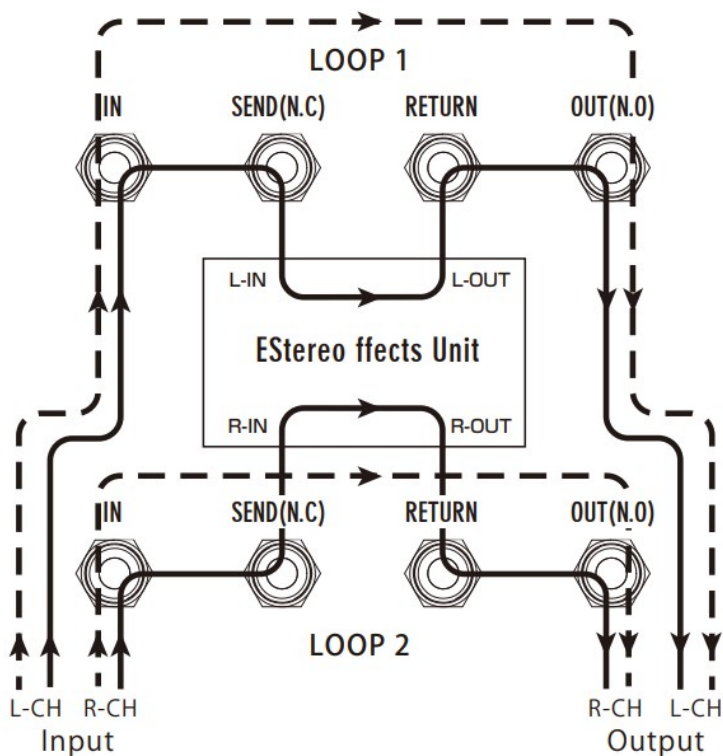

As Mute Box

The LB-2 can be used as a mute box that cut the signal fed to the IN terminal from the OUT terminal, The output from the OUT terminal is muted when the loop is turned on. The SEND and RETURN terminals should be left unplugged.

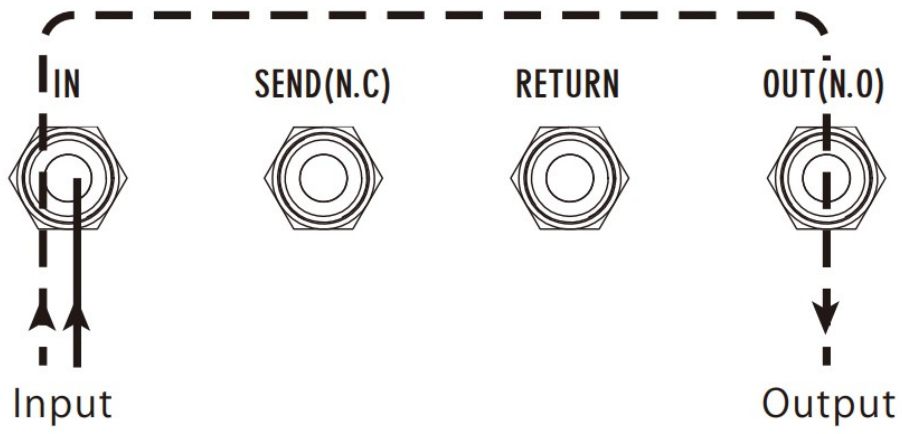

Documents / Resources

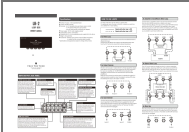

[Free The Tone LB-2 Loop Box](#) [pdf] User Manual
LB-2 Loop Box, LB-2, Loop Box, Box