



**INLINE 3000 Series
In-Counter Curved
Heated Display**



FPG INLINE 3000 Series In-Counter Curved Heated Display Owner's Manual

[Home](#) » [FPG](#) » FPG INLINE 3000 Series In-Counter Curved Heated Display Owner's Manual 

Contents

- [1 FPG INLINE 3000 Series In-Counter Curved Heated Display](#)
- [2 Product Using Instructions](#)
- [3 FAQ](#)
- [4 FEATURES](#)
- [5 OPTIONS & ACCESSORIES](#)
- [6 Specifications](#)
- [7 Installation](#)
- [8 CONTACT](#)
- [9 Documents / Resources](#)
 - [9.1 References](#)



FPG INLINE 3000 Series In-Counter Curved Heated Display



Product Using Instructions

- The Inline 3000 Series heated 1200mm curved in-counter display comes with the following features:
- Fixed Front or Sliding Doors Heated Display
- Operational Excellence
- Sliding doors (staff side) and fixed front or sliding doors options (customer side)
- Constructed from stainless and mild steel with toughened safety glass and double-glazed end panels for maximum energy efficiency, climate control, and durability
- Low wattage density element provides even temperature distribution
- Model cutout dimensions: IN-3H12-CU-XX-IC models require an 1180 x 645mm benchtop cutout. Refer to the product manual for the installation guide.

FAQ

- **Q: Where can I find more information about technical data and installation guidelines?**
 - **A:** More information, including technical data and installation guidelines, is available from the Product Manual published on our website.
- **Q: Can specifications and design change without notice?**
 - **A:** Yes, in line with our policy to continually develop, improve, and support our products, Future Products Group Ltd reserves the right to change specifications and design without notice.

3000 SERIES 1200 IN-COUNTER/CURVED HEATED

RANGE	INLINE 3000 SERIES	
TEMPERATURE	HEATED	
MODEL	IN-3H12-CU-FF-IC	IN-3H12-CU-SD-IC
FRONT	CURVED/ FIXED FRONT	CURVED/ SLIDING DOORS
INSTALLATION	IN-COUNTER	
HEIGHT	761mm	
WIDTH	1203mm	
DEPTH	663mm	

TEMPERATURE RANGE	+30°C – +90°C
RECOMMENDED CORE PRODUCT TEMPERATURE	+65°C – +80°C
ENVIRONMENTAL TEST CONDITIONS	22°C / 65% RH

FEATURES

- High energy efficiency: 1.1 kWh per hour (average)
- Cabinet operating temperature range +30°C – +90°C
- Recommended core product temperature +65°C – +80°C
- Smart display with toughened safety glass encased in brushed stainless steel frame

Fixed Front or Sliding Doors Heated Display

- Three tiltable, height-adjustable stainless steel wire rack shelves are full cabinet width to support maximum display capacity
- 25,000-hour LED lighting system at 2758 lumens per meter in cabinet top
- Unique shelf-mounted ticket strip front and rear: 30mm
- Extrusion at the top of the cabinet – front only – is fitted with a stainless steel panel that can be replaced with a branded insert

Showing: Inline 3000 Series heated 1200mm curved in-counter fixed front

Operational Excellence

- Sliding doors (staff side) and fixed front or sliding door options (customer side)
- Constructed from stainless and mild steel with toughened safety glass and double-glazed end panels for maximum energy efficiency, climate control, and durability
- Low wattage density element provides even temperature distribution
- Designed to be installed into joinery

OPTIONS & ACCESSORIES

Contact a [FPG Sales Representative](#) for our full range, including:

- Shelf trays: Toughened safety glass or mild steel.
- Colour and wood print options available for steel shelf trays
- Stainless steel product trays with sides
- Stainless steel pie chutes
- Additional shelf
- Ticket strip to the base: 30mm

- 25,000-hour LED lighting on shelves
- Branded decals/insert
- Rear door or end glass mirror application
- Forward-facing controls
- Custom joinery solution

Please contact FPG to discuss your requirements for meeting country-specific standards.



Specifications

HEATED DATA

MODEL	TEMPERATURE RANGE	RECOMMENDED CO RE PRODUCT TEMPER ATURE	ENVIRONMENTAL T EST CONDITIONS	HEATING
IN-3H12-CU- XX-IC	+30°C – +90°C	+65°C – +80°C	22°C / 65% RH	Low wattage density element

ELECTRICAL DATA

MODEL	VOLT AGE	PH AS E	CUR REN T	E24 H (kW h)	kWh pe r hour (average)	IP RA TIN G	MAINS		LED LIGHTING		
							CONNECTI ON	CONNECTI ON PLUG1	HOU RS	LUME NS	COL OUR
IN-3H12-CU- XX-IC	220-2 40 V	Sin gle	7.2 A	26. 4	1.1	IP 2 0	3 meter, 3 c ore cable	10 amp, 3 p in plug	25,0 00	2758 per m etre	Natu ral

1. Please advise the country to change the plug specification.

CAPACITY, ACCESS & CONSTRUCTION

MODEL	DISPLAY AREA	LEVELS	ACCESS FRONT	ACCESS REAR	CHASSIS CONSTRUCTION
IN-3H12-CU-FF-IC	1.0 m2	3 Shelves	Fixed front	Sliding doors	Stainless 304 and mild steel
IN-3H12-CU-SD-IC	1.0 m2	3 Shelves	Sliding doors	Sliding doors	Stainless 304 and mild steel

DIMENSIONS

MODEL	H x W x D mm (Uncrated)	MASS (Uncrated)
IN-3H12-CU-XX-IC	761 x 1203 x 663	92 kg

- Crated weights and dimensions vary. Please contact us for information on your shipment.

Installation

Installation note

- **Model cutout dimensions:** IN-3H12-CU-XX-IC models require an 1180 x 645mm benchtop cutout (see product manual for installation guide).

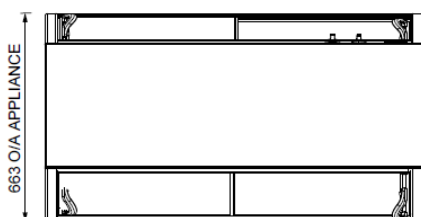

PLAN VIEW

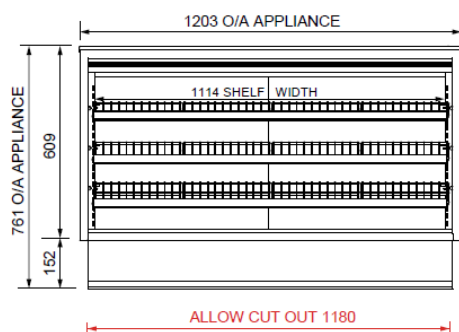

FRONT ELEVATION

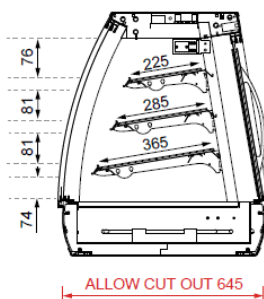

SECTION VIEW

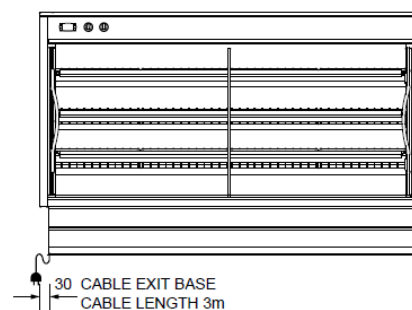

REAR ELEVATION

CONTACT

- More information including technical data and installation guidelines is available from the Product Manual published on our website.
- In line with our policy to continually develop, improve, and support our products, Future Products Group Ltd

reserves the right

- to change specifications and design without notice.
- Have a question? Please email us at sales@fpgworld.com or visit www.fpgworld.com for full contact details for your region.
- © 2024 Future Products Group Limited
- Worldwide contact details: FPGWORLD.COM



Documents / Resources

	FPG INLINE 3000 Series In-Counter Curved Heated Display [pdf] Owner's Manual INLINE 3000 Series, INLINE 3000 Series In-Counter Curved Heated Display, In-Counter Curved Heated Display, Curved Heated Display, Heated Display, Display
---	---

References

-  [Home - FPG | Food Display Solutions](#)
- [User Manual](#)

[Manuals+](#), [Privacy Policy](#)

This website is an independent publication and is neither affiliated with nor endorsed by any of the trademark owners. The "Bluetooth®" word mark and logos are registered trademarks owned by Bluetooth SIG, Inc. The "Wi-Fi®" word mark and logos are registered trademarks owned by the Wi-Fi Alliance. Any use of these marks on this website does not imply any affiliation with or endorsement.