



**INLINE 3000 Series
1200 On-Counter
Square Ambient
Display**



FPG INLINE 3000 Series 1200 On-Counter Square Ambient Display Owner's Manual

[Home](#) » [FPG](#) » FPG INLINE 3000 Series 1200 On-Counter Square Ambient Display Owner's Manual 

Contents

- [1 FPG INLINE 3000 Series 1200 On-Counter Square Ambient Display](#)
- [2 Product Usage Instructions](#)
- [3 Maintenance](#)
- [4 FEATURES](#)
- [5 OPTIONS & ACCESSORIES](#)
- [6 Specifications](#)
- [7 Installation](#)
- [8 FAQ](#)
- [9 CONTACT](#)
- [10 Documents / Resources](#)
 - [10.1 References](#)
- [11 Related Posts](#)



FPG INLINE 3000 Series 1200 On-Counter Square Ambient Display



Product Usage Instructions

Installation

- Refer to the installation manual for detailed instructions on setting up the product.

Operation

- Ensure the product is plugged into a suitable power source meeting the specified voltage and current requirements.
- Adjust the height of the shelves as needed to optimize display capacity.
- If using sliding doors, ensure they operate smoothly and securely close after use.

Maintenance

- Regularly clean the display area, shelves, and glass surfaces with a mild detergent and soft cloth.
- Ensure the product is unplugged before cleaning.

3000 SERIES 1200 ON-COUNTER/SQUARE AMBIENT

RANGE	INLINE 3000 SERIES	
TEMPERATURE	AMBIENT	
MODEL	IN-3A12-SQ-FF-OC	IN-3A12-SQ-SD-OC
FRONT	SQUARE/ FIXED FRONT	SQUARE/ SLIDING DOORS
INSTALLATION	ON-COUNTER	
HEIGHT	777mm	
WIDTH	1200mm	
DEPTH	662mm	

- CORE PRODUCT TEMPERATURE AMBIENT

FEATURES

- High energy efficiency: 0.039 kWh per hour (average)
- Cabinet operating at ambient temperature
- Smart display with double-glazed glass finished with a black trim

Operational Excellence

- Sliding doors (staff side) and fixed front or sliding door options (customer side)
- Constructed from stainless and mild steel for durability with fully double-glazed, toughened safety glass
- Fan-assisted air circulation to mitigate heat build-up
- Positioned on a counter top

Showing: Inline 3000 Series ambient 1200mm square on-counter fixed front.

OPTIONS & ACCESSORIES

Contact a [FPG Sales Representative](#) for our full range, including:

- Shelf trays: Toughened safety glass or mild steel.
- Color and woodprint options available for steel shelf trays
- 50,000-hour LED lighting on shelves
- Angled base insert
- Branded decals/inserts
- Rear door or end glass mirror application
- Forward-facing controls
- Thermal divider panels
- Custom joinery solution

Please contact FPG to discuss your requirements for meeting country-specific standards.



Specifications

AMBIENT DATA

MODEL	CORE PRODUCT TEMPERATURE
IN-3A12-SQ-XX-OC	Ambient

ELECTRICAL DATA

MODEL	VOLTAGE	PHASE	CURRENT	E24 H (kW h)	kWh per hour (average)	IP RATING	MAINS		LED LIGHTING		
							CONNECTION	CONNECTION PLUG1	HOURS	LUMENS	COLOR
IN-3A12-SQ-XX-OC	220-240 V	Single	0.17 A	0.94	0.039	IP 20	3 meter, 3 core cable	10 amp, 3 pin plug	50,000	2758 per metre	Natural

- Please advise the country to change the plug specification.

CAPACITY, ACCESS & CONSTRUCTION

MODEL	DISPLAY AREA	LEVELS	ACCESS FRONT	ACCESS REAR	CHASSIS CONSTRUCTION
IN-3A12-SQ-FF-OC	1..3 m2	2 Shelves + Base	Fixed front	Sliding doors	Stainless 304 and mild steel
IN-3A12-SQ-SD-OC	1.3 m2	2 Shelves + Base	Sliding doors	Sliding doors	Stainless 304 and mild steel

DIMENSIONS

MODEL	H x W x D mm (Uncrated)	MASS (Uncrated)
IN-3A12-SQ-XX-OC	777 x 1200 x 662	– kg

- Crated weights and dimensions vary. Please contact us for information on your shipment.

Installation

Installation note

- When installing this cabinet next to an adjacent Inline 3000 Series refrigerated cabinet, please install an Inline 3000 Series thermal divider panel (accessory) between them.

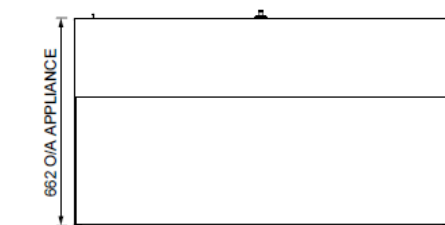

PLAN VIEW

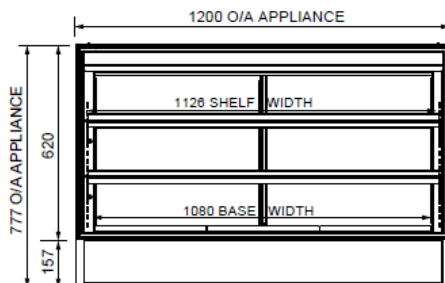

FRONT ELEVATION

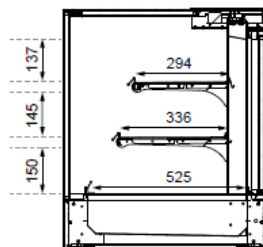

SECTION VIEW

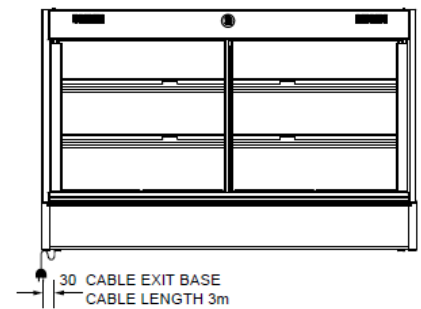

REAR ELEVATION

FAQ

- **Q: Can I change the plug specification for different countries?**
 - **A:** Yes, please contact FPG to discuss your requirements for changing the plug specification based on the country's standards.
- **Q: How do I install the product next to another Inline 3000 Series refrigerated cabinet?**
 - **A:** When installing this cabinet next to an adjacent Inline 3000 Series refrigerated cabinet, make sure to install an Inline 3000 Series thermal divider panel between them. Refer to the installation manual for detailed instructions.

CONTACT

- More information including technical data and installation guidelines is available from the Product Manual published on our website.
- In line with our policy to continually develop, improve, and support our products, Future Products Group Ltd reserves the right to change specifications and designs without notice.
- Have a question? Please email us at sales@fpgworld.com or visit www.fpgworld.com for full contact details for your region.
- © 2022 Future Products Group Limited
- Worldwide contact details: FPGWORLD.COM



Documents / Resources



[FPG INLINE 3000 Series 1200 On-Counter Square Ambient Display](#) [pdf] Owner's Manual
INLINE 3000 Series, INLINE 3000 Series 1200 On-Counter Square Ambient Display, 1200 On-Counter Square Ambient Display, Square Ambient Display, Ambient Display, Display

References

-  [Home - FPG | Food Display Solutions](#)
- [User Manual](#)

[Manuals+](#), [Privacy Policy](#)

This website is an independent publication and is neither affiliated with nor endorsed by any of the trademark owners. The "Bluetooth®" word mark and logos are registered trademarks owned by Bluetooth SIG, Inc. The "Wi-Fi®" word mark and logos are registered trademarks owned by the Wi-Fi Alliance. Any use of these marks on this website does not imply any affiliation with or endorsement.