



IN-3H09-SQ-FF-OC Inline 3000 Series Food Display Solutions



FPG IN-3H09-SQ-FF-OC Inline 3000 Series Food Display Solutions Owner's Manual

[Home](#) » [FPG](#) » FPG IN-3H09-SQ-FF-OC Inline 3000 Series Food Display Solutions Owner's Manual 

Contents

- [1 FPG IN-3H09-SQ-FF-OC Inline 3000 Series Food Display Solutions](#)
- [2 Specification](#)
- [3 FEATURES](#)
- [4 OPTIONS & ACCESSORIES](#)
- [5 HEATED DATA](#)
- [6 DIMENSIONS](#)
- [7 FAQ](#)
- [8 Documents / Resources](#)
 - [8.1 References](#)
- [9 Related Posts](#)



FPG IN-3H09-SQ-FF-OC Inline 3000 Series Food Display Solutions



Specification

RANGE	INLINE 3000 SERIES	
TEMPERATURE	HEATED	
MODEL	IN-3H09-SQ-FF-OC	IN-3H09-SQ-SD-OC
FRONT	SQUARE/ FIXED FRONT	SQUARE/ SLIDING DOORS
INSTALLATION	ON-COUNTER	
HEIGHT	777mm	
WIDTH	900mm	
DEPTH	662mm	

TEMPERATURE RANGE	+30°C – +90°C
RECOMMENDED CORE PRODUCT TEMPERATURE	+65°C – +80°C
ENVIRONMENTAL TEST CONDITIONS	22°C / 65% RH

FEATURES

- High energy efficiency: 0.6 kWh per hour (average)
- Cabinet operating temperature range +30°C – +90°C
- Recommended core product temperature +65°C – +80°C
- Smart display with double-glazed glass finished with a black trim

Fixed Front or Sliding Doors Heated Display

- Two tiltable, height-adjustable stainless steel wire rack shelves are full cabinet width to support maximum display capacity
- 25,000 hour LED lighting system at 2758 lumens per metre in cabinet top
- Unique shelf-mounted ticket strip front and rear: 30mm
- Extrusions at the bottom of the cabinet – both front and rear – are fitted with stainless steel panels that can be replaced with branded inserts

Operational Excellence

- Sliding doors (staff side) and fixed front or sliding doors options (customer side)
- Constructed from stainless and mild steel with fully double-glazed, toughened safety glass for maximum energy efficiency, climate control and durability
- Low wattage density element provides even temperature distribution
- Positioned on counter top

Showing : Inline 3000 Series heated 900mm square on-counter fixed front

OPTIONS & ACCESSORIES

Contact a [FPG Sales Representative](#) for our full range, including:

- Shelf trays: Toughened safety glass or mild steel.
- Colour and woodprint options available for steel shelf trays
- Stainless steel product trays with three sides
- Stainless steel pie chutes
- Additional shelf
- Ticket strip to base: 30mm
- 25,000-hour LED lighting to shelves
- Branded decals/inserts
- Rear door or end glass mirror application
- Forward-facing controls
- Custom joinery solution

HEATED DATA

MODEL	TEMPERATURE RANGE	RECOMMENDED CORE PRODUCT TEMPERATURE	ENVIRONMENTAL TEST CONDITIONS	HEATING
IN-3H09-SQ-XX-OC	+30°C – +90°C	+65°C – +80°C	22°C / 65% RH	Low wattage density element

ELECTRICAL DATA

MODEL	VOLTAGE	PHASE	CURRENT	E24 H (kW h)	kWh per hour (average)	IP RATING	MAINS		LED LIGHTING		
							CONNECTI ON	CONNECTI ON PLUG1	HOU RS	LUME NS	COL OUR
IN-3H09-SQ-XX-OC	220-240 V	Single	3.8 A	14.4	0.6	IP 20	3 metre, 3 core cable	10 amp, 3 pin plug	25,000	2758 per metre	Natural

1 Please advise the country to change the plug specification

CAPACITY, ACCESS & CONSTRUCTION

MODEL	DISPLAY AREA	LEVELS	ACCESS FRONT	ACCESS REAR	CHASSIS CONSTRUCTION
IN-3H09-SQ-FF-OC	0.5 m2	2 Shelves	Fixed front	Sliding doors	Stainless 304 and mild steel
IN-3H09-SQ-SD-OC	0.5 m2	2 Shelves	Sliding doors	Sliding doors	Stainless 304 and mild steel

DIMENSIONS

MODEL	H x W x D mm (Uncrated)	MASS (Uncrated)
IN-3H09-SQ-XX-OC	777 x 900 x 662	– kg

Crated weights and dimensions vary. Please contact us for information on your shipment.

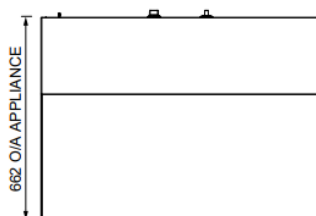

PLAN VIEW

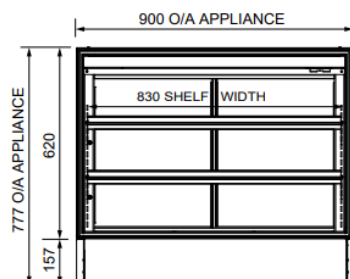

FRONT ELEVATION

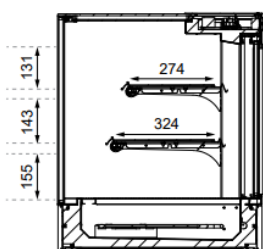

SECTION VIEW

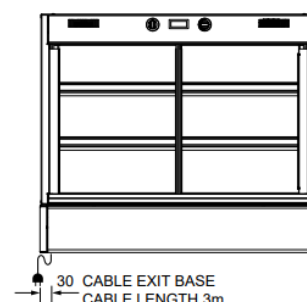

REAR ELEVATION

More information including technical data and installation guidelines is available from the Product Manual published on our website. In line with our policy to continually develop, improve and support our products, Future Products Group Ltd reserves the right to change specifications and design without notice. Have a question? Please email us at sales@fpgworld.com or visit www.fpgworld.com for full contact details for your region

Worldwide contact details:

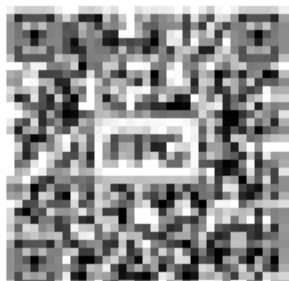

- FPGWORLD.COM

FAQ

- **Q: Can I adjust the shelves in the unit?**
 - A: Yes, the two stainless steel wire rack shelves are tiltable and height-adjustable to accommodate different display items.
- **Q: How do I change the plug specification for different countries?**
 - A: Please contact FPG for guidance on changing the plug specification to meet country-specific standards.

Documents / Resources

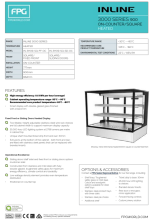

[FPG IN-3H09-SQ-FF-OC Inline 3000 Series Food Display Solutions](#) [pdf] Owner's Manual
IN-3H09-SQ-FF-OC, IN-3H09-SQ-SD-OC, IN-3H09-SQ-XX-OC, IN-3H09-SQ-FF-OC Inline 3000 Series Food Display Solutions, IN-3H09-SQ-FF-OC, Inline 3000 Series Food Display Solutions, Food Display Solutions, Display Solutions, Solutions

References

-  [Home - FPG | Food Display Solutions](#)
- [User Manual](#)

[Manuals+](#), [Privacy Policy](#)

This website is an independent publication and is neither affiliated with nor endorsed by any of the trademark owners. The "Bluetooth®" word mark and logos are registered trademarks owned by Bluetooth SIG, Inc. The "Wi-Fi®" word mark and logos are registered trademarks owned by the Wi-Fi Alliance. Any use of these marks on this website does not imply any affiliation with or endorsement.