



[Home](#) » [FoxInsights](#) » **FoxInsights FoxPressure Level Meter for Tanks Radar or Ultrasonic Sensor User Manual** 

Contents [[hide](#)]

- [1 FoxInsights FoxPressure Level Meter for Tanks Radar or Ultrasonic Sensor](#)
- [2 Overview](#)
- [3 Functionality](#)
- [4 Safety instructions](#)
- [5 App setup](#)
- [6 Notes on installation](#)
- [7 Technical data](#)
- [8 FCC Statement](#)
- [9 FAQ](#)
- [10 Documents / Resources](#)
 - [10.1 References](#)

FoxInsights

FoxInsights FoxPressure Level Meter for Tanks Radar or Ultrasonic Sensor



Dear FoxPressure user,

- Thank you for choosing our innovative level meter. Please take the time to read this user manual carefully before setting up and using the device.
- For optimal performance and guaranteed operational safety, the FoxPressure must be installed carefully and operated correctly.
- Please ensure that all persons who assemble and operate the device have read and understood this user manual and the assembly instructions in the FoxMobile app (see page 15).

Your FoxInsights team

Overview

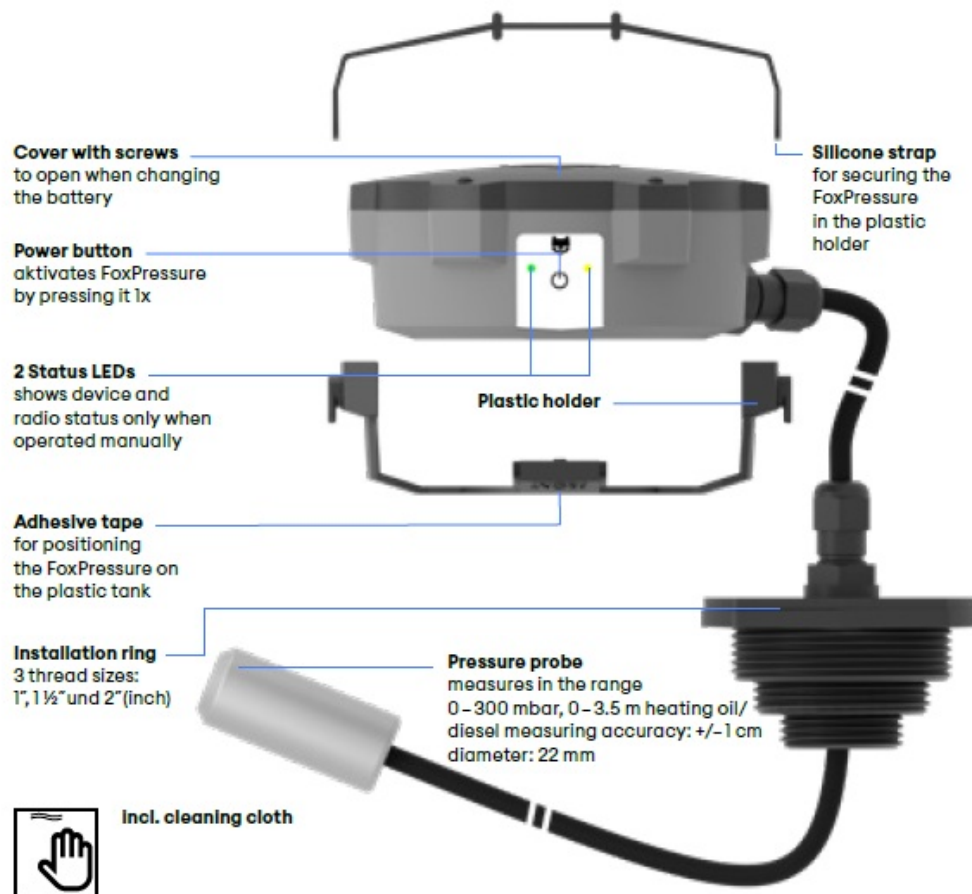

Functionality

- The FoxPressure is used for simple measurement of the tank levels.
- This is done by detecting the hydrostatic pressure of the level column.
- The level is then calculated using the measured pressure and density.
- The FoxPressure is not a calibrated measuring device. The max pressure FoxPressure can detect is 300mBar. For a standard oil with a product density of 0.84 kg/liter the maximum detectable fill level the FoxPressure can take is 3.50 m. For products with higher density the max level decreases. Formula: $300\text{mBar} / \text{density (kg/L)} = \text{max level in cm}$.
- The accuracy of the content indication is based on the consistency of the data specified in the configuration of the app, the actual conditions of the tank, and the configured density.
- To calculate the fill level, you can select the manufacturer and model of your tank in the app. The required dimensions for the fill level calculation are then automatically filled in for you. If your tank model is not available in the app or you do not know your tank model, please enter the tank configuration (total capacity, tank height and tank shape) manually in the app.
- For battery tanks, enter the total volume of all tanks during the app configuration step,

e.g., 6,000 l total volume with 3 x 2,000 l per tank. For pre-configured tanks, enter the number of connected tanks.

Safety instructions

- The FoxPressure is battery-powered. Please only use high quality batteries designed for a long service life only.
- FoxInsights cannot be held liable for any damage to the unit caused by replaced batteries.

The FoxPressure must not:

- be used in tanks with moving parts
- remain in the tank when taking a dipstick measurement, provided it is mounted on the dipstick tube. It must be removed entirely from the tank, otherwise its pressure probe could be damaged.
- be used in potentially explosive atmospheres (according to 2014/34/EU)

The FoxPressure cannot:

- be used as an overfill prevention device
- protect against unnoticed emptying of the tank as well as against theft or unauthorized removal of the tank contents by third parties

The threads of the tank adapter are not self-sealing and do not prevent water from entering the tank. To prevent water from entering the tank, please ensure that the FoxPressure is properly sealed when mounted.

- No liability is accepted for damage caused by improper use or incorrect operation.
- Any modifications to the device are not permitted.

App setup

- The FoxPressure is easily set up using your smartphone. To do this, download the cost free FoxMobile app from the iOS App Store (for iPhones) or the Google PlayStore (for Android devices).

- Start the download by visiting www.foxmobile.app or simply scan the
- QR code below with your smartphone camera.
- After entering your email address for verification, the FoxMobile app will guide you through the individual steps for installing the level meter.
- You can also access the User manual at any time through the FoxMobile app.



Notes on installation

- First modify the cable length to fit your tank. In general, we recommend adjusting the length so that it is equivalent to the tank height + offset + 5 cm.
- Then lower the pressure probe of the FoxPressure slowly (!) into the tank until it rests on the bottom of the tank. Dropping the probe in a sudden manner should be avoided, as the FoxPressure could be damaged. Please also note that the connection of the upper end of the pressure probe with the cable may be stressed with max. 25N on tension.
- In addition, the part of the cable that is in the tank should be enclosed in a tube. This prevents the probe from being thrown around in the tank during filling and possibly being damaged. Alternatively, the measuring probe should be removed from the tank during the filling process.

Max. Measured
value: 350cm
(heating oil)
Cable length:
3 m or 5 m

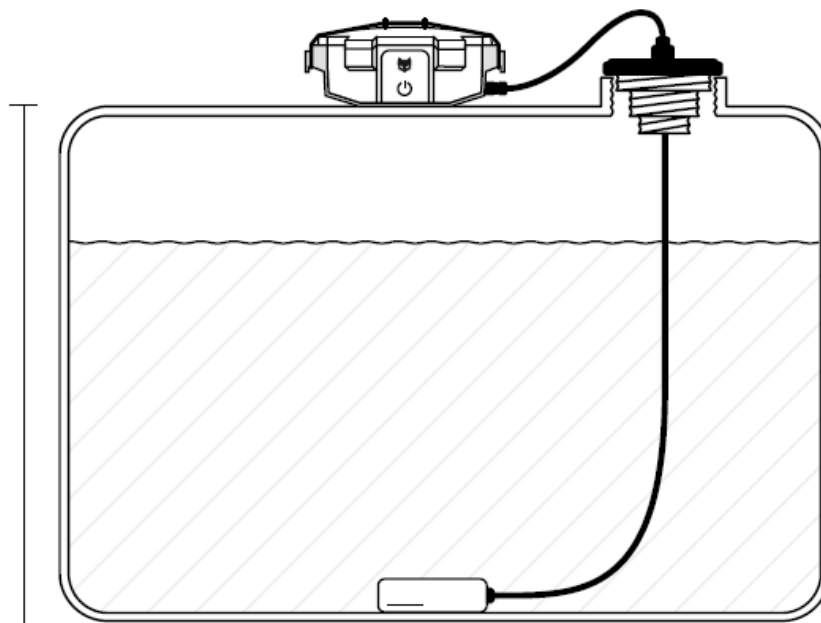

You can find detailed instructions for installation in the FoxMobile app.

Technical data

Category	Explanation
Measuring principle	Hydrostatic pressure measurement
Max. measured value	300mbar = 350cm for heating oil / diesel
Measurement accuracy	+/- 1cm
Display	2 LED status lights (device and radio status)
Housing material	ABS
Hose material	PUR measuring hose with d = 5,7 mm
Probe material	Stainless steel
Operating temperature	-20°C to +45°C
rel. humidity	5 – 95%, non-condensing
Protection class	IP68

Dimensions and weight	Casing Ø 112 x 48 mm // 3 m and 5 m cable length // approx. 442 grams (without battery)
Battery life	10 years with one measurement per day*
Material compatibility	Tank storage of diesel, KAT A2, C1, C2 and D oil according to BS2869
Wi-Fi standard	supports 802.11 b/g/n
Frequencies WIFI LTE Cat NB1 (NB-IoT) 2G, Cat-M	WiFi: 2.412 GHz to 2.462 GHz / Bluetooth: 2.402GHz to 2.480 GHz / GSM850/1900; CAT-M: Band 2/4/5/12/13/25/26/66/85; NB-IoT: Band 2/4/5/12/13/25/66/85
scope of delivery	FoxPressure, adapter with adhesive surface, silicone band, tank adapter, 1" adapter for external thread, 3 batteries (type AA) inserted, cleaning cloth, user manual

- poor signal strength may reduce battery-lifetime
- The FoxPressure is registered with FoxInsights GmbH under the WEEE number 87528297.

FCC Statement

FCC ID: 2BKML-FOXPRESSURE

This device complies with part 15 of the FCC Rules. Operation is subject to the following two conditions:

1. This device may not cause harmful interference, and
2. This device must accept any interference received, including interference that may cause undesired operation.

Any changes or modifications not expressly approved by the party responsible for compliance could void the user's authority to operate the equipment or similar

description

Note: This equipment has been tested and found to comply with the limits for a Class B digital device, pursuant to part 15 of the FCC Rules. These limits are designed to provide reasonable protection against harmful interference in a residential installation. This equipment generates, uses and can radiate radio frequency energy and, if not installed and used in accordance with the instructions, may cause harmful interference to radio communications. However, there is no guarantee that interference will not occur in a particular installation. If this equipment does cause harmful interference to radio or television reception, which can be determined by turning the equipment off and on, the user is encouraged to try to correct the interference by one or more of the following measures:

- Reorient or relocate the receiving antenna.
- Increase the separation between the equipment and receiver.
- Connect the equipment into an outlet on a circuit different from that to which the receiver is connected.
- Consult the dealer or an experienced radio/TV technician for help.

This equipment complies with radio frequency (RF) exposure limits adopted by the Federal Communications Commission for an uncontrolled environment. This equipment should be installed and operated with minimum distance 20 cm between the radiator & your body. This Transmitter must not be co-located or operating in conjunction with any other antenna or transmitter.

IC Statement

- **PMN:** FoxPressure
- **HVIN:** FoxPressure-V1
- **IC:** 32961-FOXPRESSURE
- CAN ICES(B)/NMB(B)

This device contains licence-exempt transmitter(s)/receiver(s) that comply with Innovation, Science and Economic Development Canada's licence-exempt RSS(s). Operation is subject to the following two conditions:

Radiation Exposure Statement:

This equipment complies with IC radiation exposure limits set forth for an uncontrolled environment. This equipment should be installed and operated with minimum distance 20cm between the radiator & your body.

FAQ

- **Q: What batteries should I use for the FoxPressure?**
 - A: Use high-quality batteries designed for long service life to ensure proper operation of the device.
- **Q: Can the FoxPressure be used in tanks with moving parts?**
 - A: No, it is not recommended to use the device in tanks with moving parts to avoid damage to the pressure probe.

Documents / Resources

	FoxInsights FoxPressure Level Meter for Tanks Radar or Ultrasonic Sensor or [pdf] User Manual FoxPressure Level Meter for Tanks Radar or Ultrasonic Sensor, Level Meter for Tanks Radar or Ultrasonic Sensor, Meter for Tanks Radar or Ultrasonic Sensor, Radar or Ultrasonic Sensor
---	---

References

- [User Manual](#)

■ FoxInsights

📎 FoxInsights, FoxPressure Level Meter for Tanks Radar or Ultrasonic Sensor, Level Meter for Tanks Radar or Ultrasonic Sensor, Meter for Tanks Radar or Ultrasonic Sensor, Radar or Ultrasonic Sensor

Leave a comment

Your email address will not be published. Required fields are marked *

Comment *

Name

Email

Website

☐ Save my name, email, and website in this browser for the next time I comment.

Post Comment

Search:

e.g. whirlpool wrf535swhz

Search

[Manuals+](#) | [Upload](#) | [Deep Search](#) | [Privacy Policy](#) | [@manuals.plus](#) | [YouTube](#)

This website is an independent publication and is neither affiliated with nor endorsed by any of the trademark owners. The "Bluetooth®" word mark and logos are registered trademarks owned by Bluetooth SIG, Inc. The "Wi-Fi®" word mark and logos are registered trademarks owned by the Wi-Fi Alliance. Any use of these marks on this website does not imply any affiliation with or endorsement.