

FOXESS APP 2.0 Access App



FOXESS APP 2.0 Access App User Guide

[Home](#) » [FoxESS](#) » FOXESS APP 2.0 Access App User Guide 

Contents

- 1 [FOXESS APP 2.0 Access App](#)
- 2 [Product Usage Instructions](#)
- 3 [FAQ](#)
- 4 [How to set up](#)
- 5 [What to expect](#)
- 6 [More details System Dashboard](#)
- 7 [Getting technical Statistical Analysis](#)
- 8 [Documents / Resources](#)
 - 8.1 [References](#)
- 9 [Related Posts](#)



FOXESS APP 2.0 Access App



Specifications

- Product Name: APP 2.0
- Version: 2.0.5
- System Requirements: FOXESS User

Product Usage Instructions

Step 1: Create Your Plant

Installer assistance may be required. Click the right top corner of the plant page to create your plant.

Step 2: Add Your Device

Scan the QR code located on the right top corner of the Device page to add your device.

Step 3: Connect Your Device to the Network

Connect your device to the network by following the instructions\ on the 'Me' page.

Note: It is recommended to seek help from your installer to complete these steps.

FAQ

Q: What is the purpose of creating a plant?

A: Creating a plant is essential for organizing and managing your devices within the system.

Q: How can I add a device to the system?

A: You can add a device by scanning the QR code on the Device page.

Q: What are the different working modes available for the system?

A: The system offers various working modes such as Self-Use mode, Feed In Priority mode, Back Up mode, and Peak Shaving mode to optimize energy consumption and efficiency.

Q: Can I customize the charging time for my battery?

A: Yes, you can customize the charging time and battery discharging state of charge (SOC) in the Battery Setting section.

How to set up

System Configuration

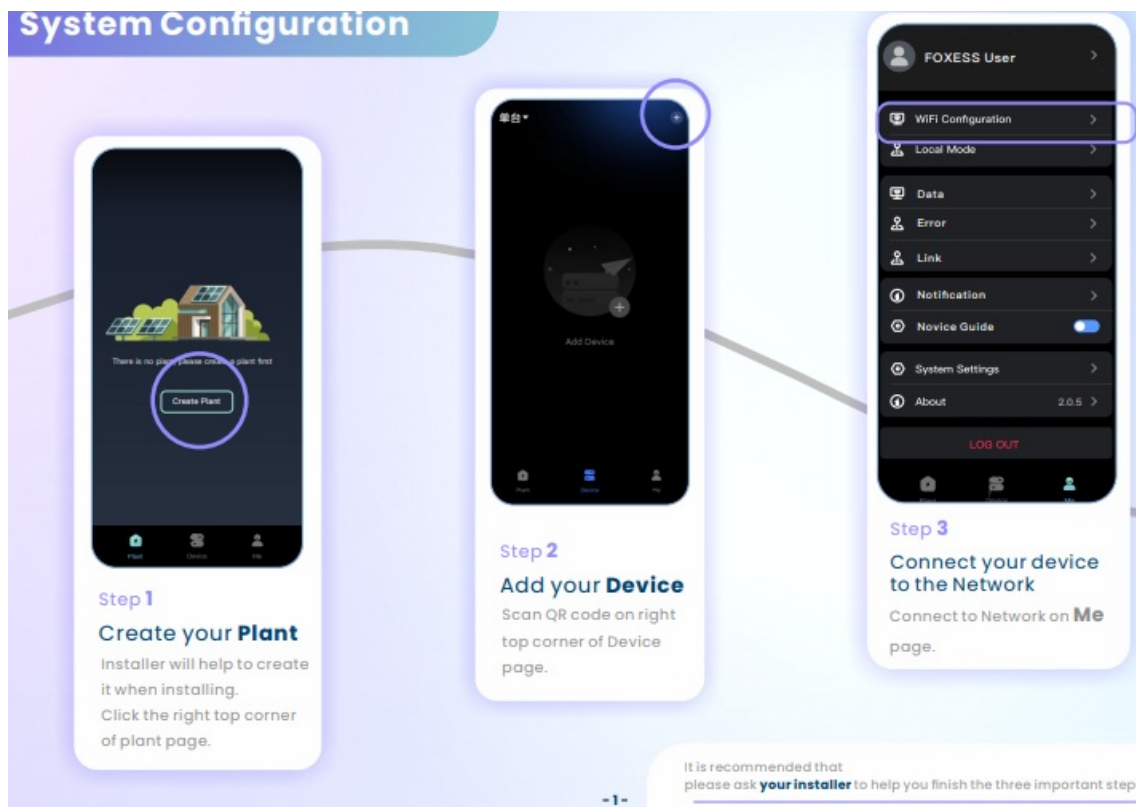

What to expect

Basic Framework

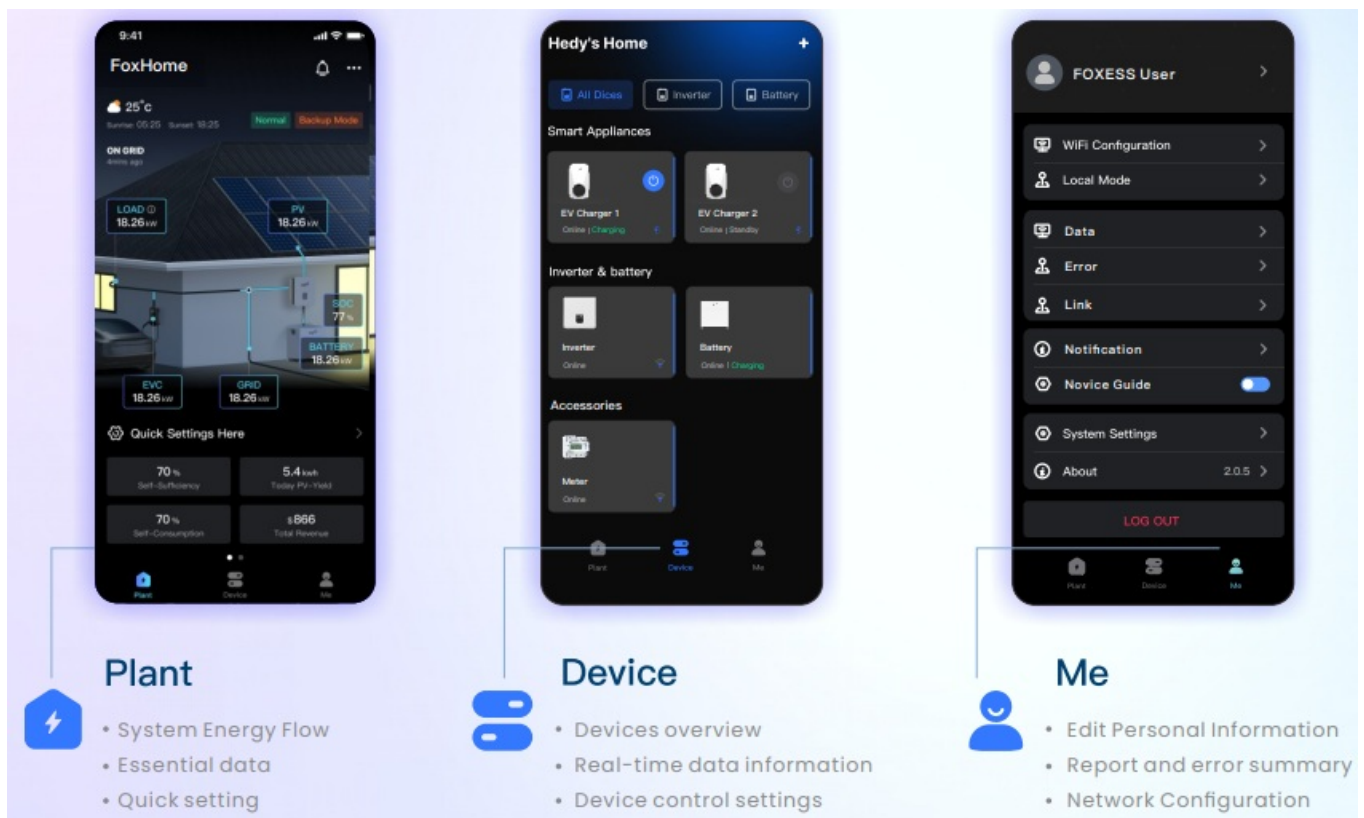

More details System Dashboard

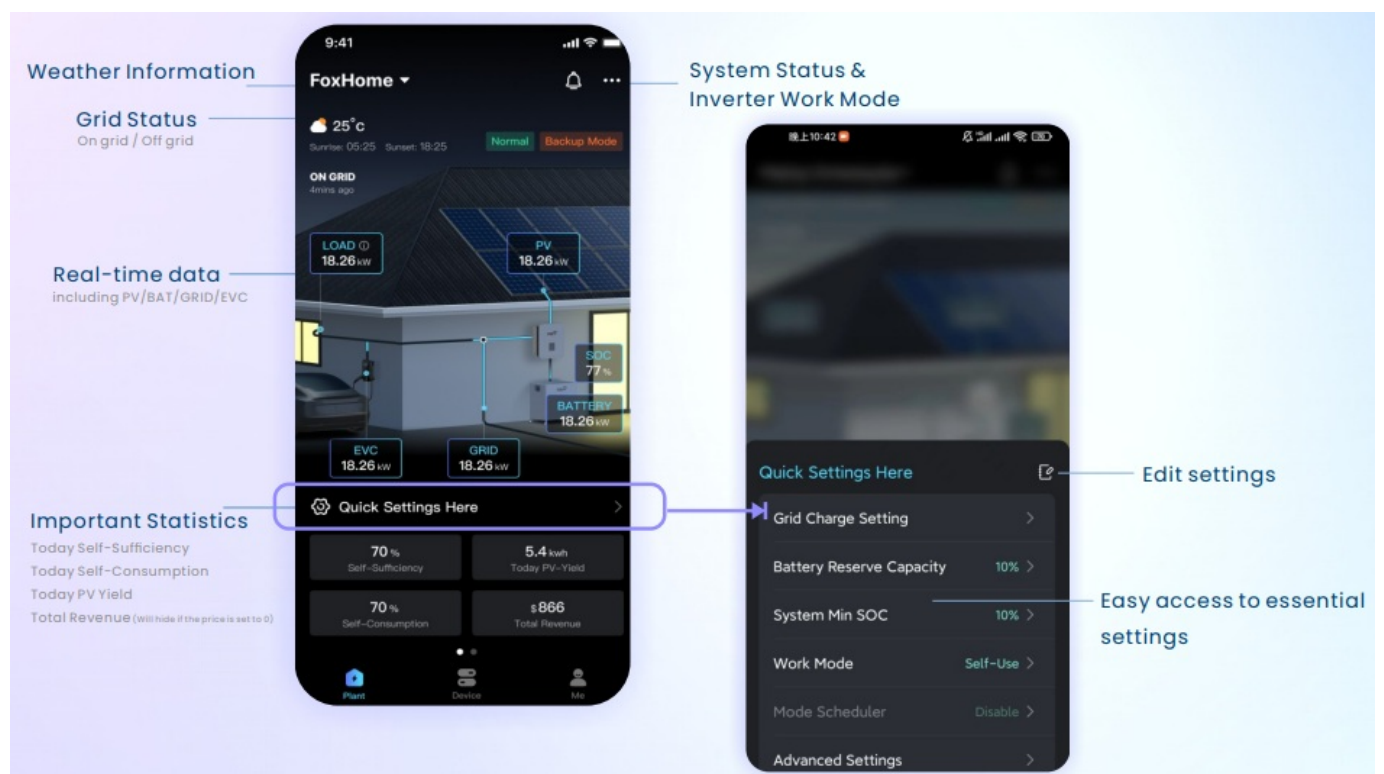

What you need to know Essential Operation Setting

What you need to know

Essential Operation Setting

2 Battery Reserve Capacity

When grid is on, battery will stop discharging when reaching this set value.

3 System Min SOC

No matter when grid is on or off, battery will stop discharging immediately when reaching this set value.
This value should be lower than Battery Reserve Capacity

4

Self-Use mode

Optimize self-sufficiency, reduce reliance on grid energy

Feed In Priority mode

Prioritize feed-in (export) to benefit from export tariffs

Back Up mode

Suitable for areas with unstable power grid
Reserve battery SOC

Peak Shaving mode

Suitable for avoiding peak demand charges for grid consumed energy.

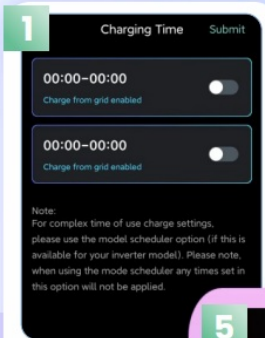
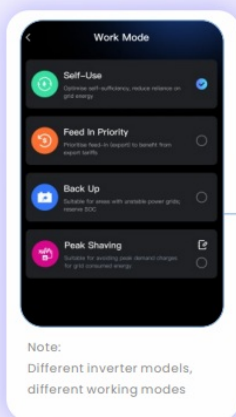

Here are 2 charging periods can be set. User can choose charging from Grid enabled or disabled.

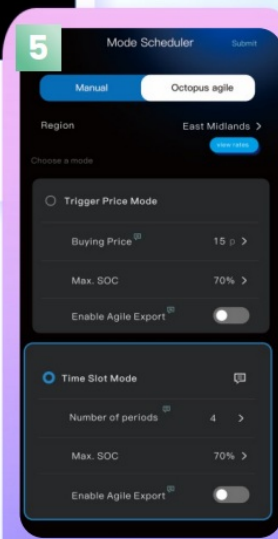

Mode Scheduler allows more advanced controls on charging/discharging settings.

Getting technical Statistical Analysis

Getting technical Statistical Analysis

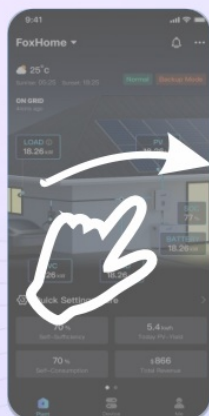

Swipe to right



Graphical Data Display

Energy data can be displayed daily, weekly, monthly, yearly or over a lifetime

Production Analysis

Production=Energy produced by solar
Self-Consumption=Load powered by solar +battery charging
Export=Exported to the grid

Consumption Analysis

Consumption=Load consumption energy
Self-Sufficiency=Load powered by solar+ battery discharging
Grid Purchase=Imported from the grid



transverse zygomorphy

Produced=Solar+battery discharged+Grid imported
Consumed=load+battery charged+Grid exported
Produced=Consumed

FoxHome

All Devices Inverter Battery Accessories

Normal

Nickname
0081078A032270857

4mins ago

1267 W
PV Power

Today PV Yield
3.3 kWh

Total PV Yield
65 kWh

Detail Parameters

Analysis Graph

Plant Device Me

Inverter Details

PV Information

	Voltage(V)	Current(A)	Power(kW)
PV	15.1	0	0
PV1	10.5	0	0
PV2	4.6	0	0

AC Information

Load Information

Grid Information

Battery Information

Analysis Graph

Day Month Year Lifetime

2024-01

Solar Produced Load Consumed Grid Export Grid Import Battery Charge Battery Discharge

PV/AC/LOAD/GRID/BATTERY data from inverter.

The image displays three mobile application screens for a battery management system, with callout boxes providing additional context.

Battery Setting
You can customize the charging time and Battery discharging SOC here.
Note: Setting here is the same as the Quick Settings.

Battery Information
Real-time information
Charging and discharging analysis

Device Info
Including Status /Model/Version ...

Battery Details

Parameter	Value
SOC	53%
SOH	100%
Capacity	9830wh
Current	-11.1A
Voltage	215.5V
Daily Discharging Energy	1.40kWh
Total Discharging Energy	92.30kWh
Daily Charging Energy	1.50kWh
Total Charging Energy	93.50kWh

2024-02-02 10:36:21

More details EV Charger Dashboard

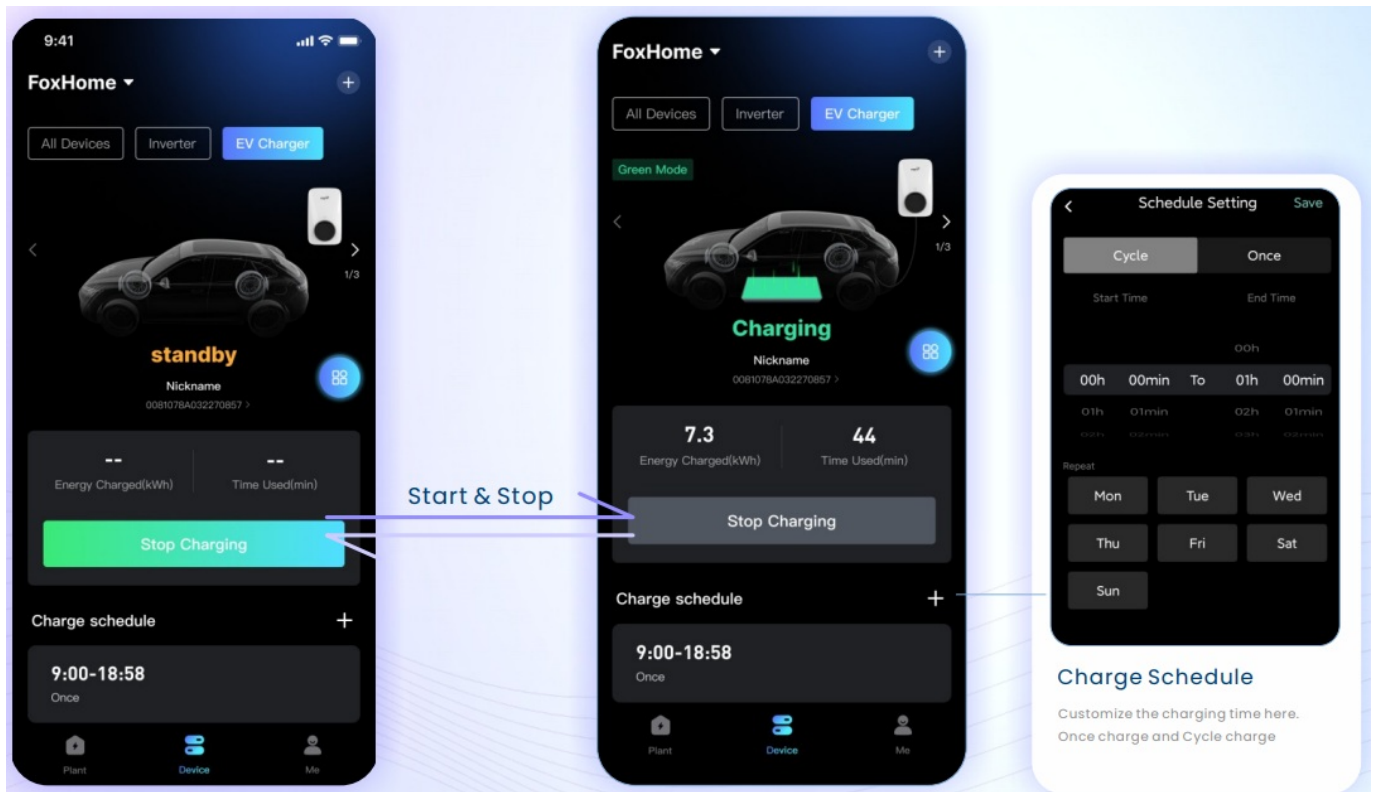

More details EV Charger Dashboard

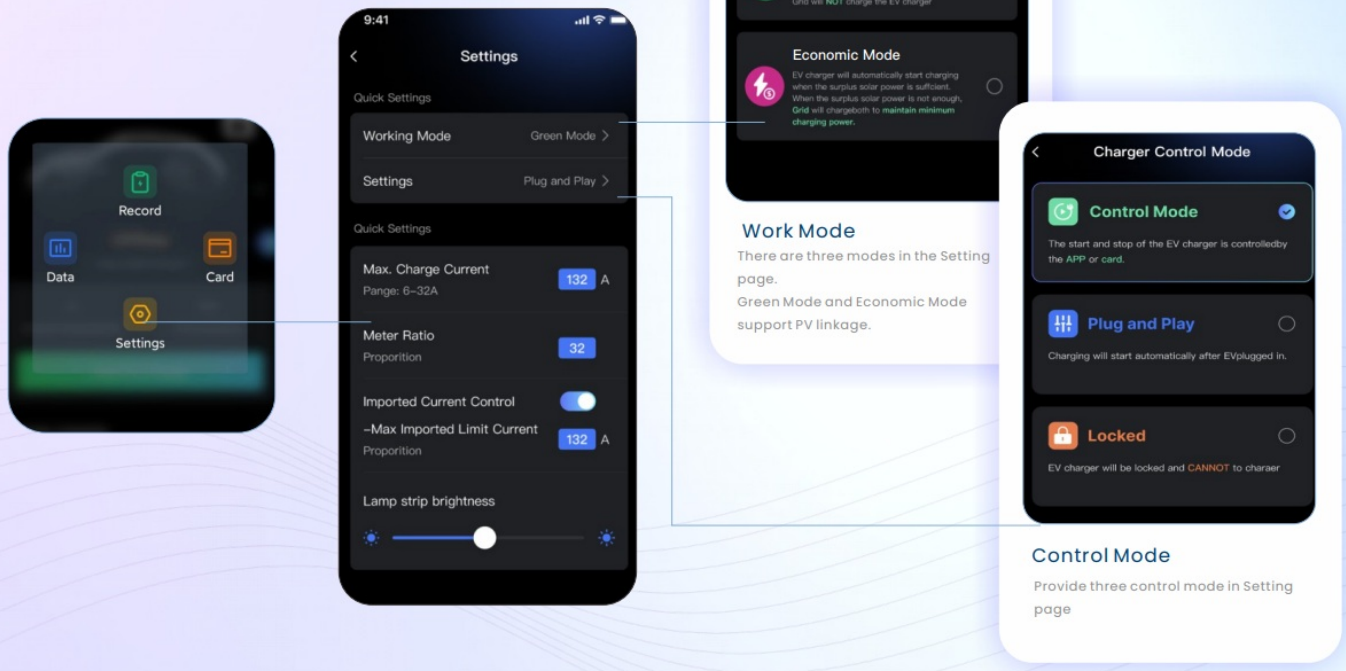

Personal Settings Me Dashboard

Personal Settings Me Dashboard

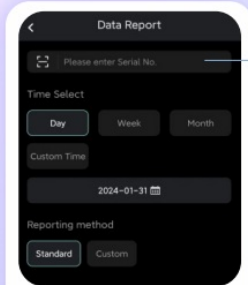

You can download data reports here

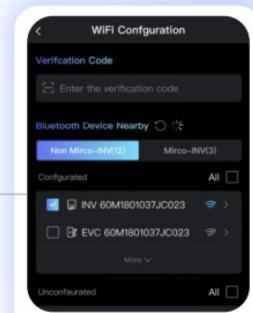
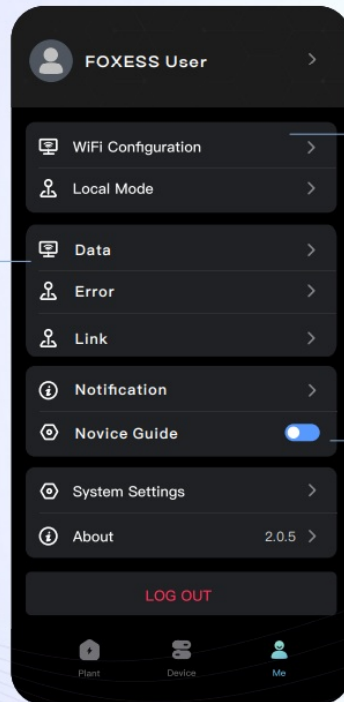

Network Configuration

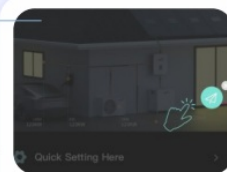

Here is a Novice guide to help you operate the APP.



Download on the
App Store



GET IT ON
Google Play

<https://www.fox-ess.com>

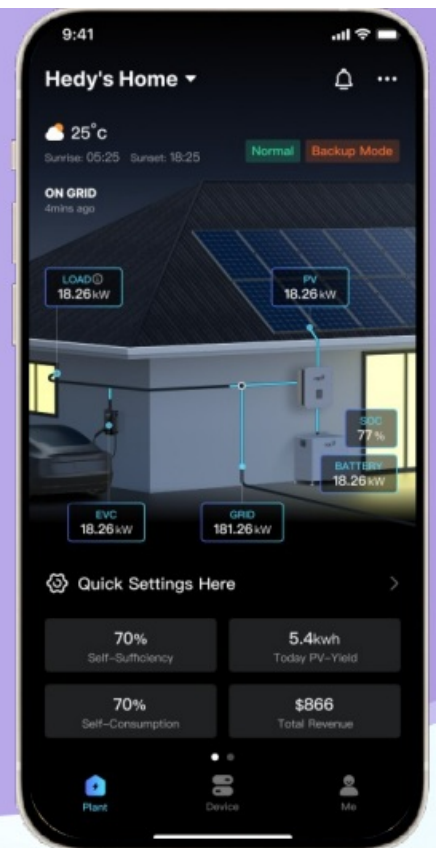

<https://www.fox-ess.com>

Documents / Resources



[FOXESS APP 2.0 Access App](#) [pdf] User Guide
APP 2.0 Access App, APP 2.0, Access App, App

References

- [User Manual](#)

[Manuals+](#), [Privacy Policy](#)

This website is an independent publication and is neither affiliated with nor endorsed by any of the trademark owners. The "Bluetooth®" word mark and logos are registered trademarks owned by Bluetooth SIG, Inc. The "Wi-Fi®" word mark and logos are registered trademarks owned by the Wi-Fi Alliance. Any use of these marks on this website does not imply any affiliation with or endorsement.