

Foundations
BAYDSCF322
Packaged Rooftop
Units



Foundations BAYDSCF322 Packaged Rooftop Units Installation Guide

[Home](#) » [Foundations](#) » Foundations BAYDSCF322 Packaged Rooftop Units Installation Guide 

Contents

- [1 Foundations BAYDSCF322 Packaged Rooftop Units](#)
- [2 SAFETY WARNING](#)
- [3 Warnings, Cautions, and Notices](#)
- [4 Inspection](#)
- [5 Parts List](#)
- [6 Installation](#)
- [7 Documents / Resources](#)
 - [7.1 References](#)

Foundations

Foundations BAYDSCF322 Packaged Rooftop Units

**Model Number: Used With:**

- BAYDSCF322* E/GB*036-060****B*
- E/GD*036-060****B*, Cooling Only/Gas Heat
- BAYDSCF323* EB*036-060****B*
- ED*036-060****B*, 5 to 25 kW Electric Heat

SAFETY WARNING

Only qualified personnel should install and service the equipment. The installation, starting up, and servicing of heating, ventilating, and air-conditioning equipment can be hazardous and require specific knowledge and training. Improperly installed, adjusted, or altered equipment by an unqualified person could result in death or serious injury. When working on the equipment, observe all precautions in the literature and on the tags, stickers, and labels that are attached to the equipment.

Warnings, Cautions, and Notices

Read this manual thoroughly before operating or servicing this unit. Safety advisories appear throughout this manual as required. Your safety and the proper operation of this machine depend upon the strict observance of these precautions.

The three types of advisories are defined as follows:

Warning

Indicates a potentially hazardous situation which, if not avoided, could result in death or serious injury.

CAUTION

Indicates a potentially hazardous situation which, if not avoided, could result in minor or moderate injury. It could also be used to alert against unsafe practices.

NOTICE

Indicates a situation that could result in equipment or property damage only accidents.

Important Environmental Concerns

Scientific research has shown that certain man-made chemicals can affect the earth's naturally occurring stratospheric ozone layer when released into the atmosphere. In particular, several of the identified chemicals that may affect the ozone layer are refrigerants that contain Chlorine, Fluorine, and Carbon (CFCs) and those containing Hydrogen, Chlorine, Fluorine, and Carbon (HCFCs). Not all refrigerants containing these compounds have the same potential impact on the environment. Trane advocates the responsible handling of all refrigerants.

Important Responsible Refrigerant Practices

Trane believes that responsible refrigerant practices are important to the environment, our customers, and the air conditioning industry. All technicians who handle refrigerants must be certified according to local rules. For the USA, the Federal Clean Air Act (Section 608) sets forth the requirements for handling, reclaiming, recovering, and recycling certain refrigerants and the equipment that is used in these service procedures. In addition, some states or municipalities may have additional requirements that must also be adhered to for responsible management of refrigerants. Know the applicable laws and follow them.

WARNING

Proper Field Wiring and Grounding Required!

Failure to follow the code could result in death or serious injury. All field wiring **MUST** be performed by qualified personnel. Improperly installed and grounded field wiring poses **FIRE** and **ELECTROCUTION** hazards. To avoid these hazards, you **MUST** follow requirements for field wiring installation and grounding as described in NEC and your local/state/national electrical codes.

WARNING

Personal Protective Equipment (PPE) Required!

Failure to wear proper PPE for the job being undertaken could result in death or serious injury. Technicians, to protect themselves from potential electrical, mechanical, and chemical hazards, **MUST** follow precautions in this manual and on the tags, stickers, and labels, as well as the instructions below:

- Before installing/servicing this unit, technicians **MUST** put on all PPE required for the work being undertaken (Examples; cut-resistant gloves/sleeves, butyl gloves, safety glasses, hard hat/bump cap, fall protection, electrical PPE, and arc flash clothing). **ALWAYS** refer to appropriate Safety Data Sheets (SDS) and OSHA guidelines for proper PPE.
- When working with or around hazardous chemicals, **ALWAYS** refer to the appropriate SDS and OSHA/GHS (Global Harmonized System of Classification and Labeling of Chemicals) guidelines for information on allowable personal exposure levels, proper respiratory protection, and handling instructions.
- If there is a risk of energized electrical contact, arc, or flash, technicians **MUST** put on all PPE by OSHA, NFPA 70E, or other country-specific requirements for arc flash protection, before servicing the unit. **NEVER** PERFORM ANY SWITCHING, DISCONNECTING, OR VOLTAGE TESTING WITHOUT PROPER ELECTRICAL PPE AND ARC FLASH CLOTHING. ENSURE ELECTRICAL METERS AND EQUIPMENT ARE PROPERLY RATED FOR THE INTENDED VOLTAGE.

WARNING

Follow EHS Policies! Failure to follow the instructions below could result in death or serious injury.

- All Trane personnel must follow the company's Environmental, Health, and Safety (EHS) policies when performing work such as hot work, electrical, fall protection, lockout/tagout, refrigerant handling, etc. Where

local regulations are more stringent than these policies, those regulations supersede these policies.

- Non-race personnel should always follow local regulations.

WARNING

R-454B Flammable A2L Refrigerant! Failure to use proper equipment or components as described below could result in equipment failure, and possibly fire, which could result in death, serious injury, or equipment damage. The equipment described in this manual uses R-454B refrigerant which is flammable (A2L). Use ONLY R-454 B-rated service equipment and components. For specific handling concerns with R-454B, contact your local representative.

Copyright

This document and the information in it are the property of Trane, and may not be used or reproduced in whole or in part without written permission. Trane reserves the right to revise this publication at any time, and to make changes to its content without obligation to notify any person of such revision or change.

Trademarks

All trademarks referenced in this document are the trademarks of their respective owners.

Inspection

1. Check carefully for shipping damage. If any damage is found, report it immediately, and file a claim against the transportation company. Replace damaged parts with authorized parts only.
2. Compare the order number on the shipping label with the accessory identification information on the ordering and shipping documents to verify that the correct accessory has been received.

Parts List

Table 1. Parts list

Qty	Description
1	Disconnect Switch Assembly with Mounting Bracket
1	Installation Instructions
1	Disconnect Switch Flip Cover
2	Screws 6-32*
10	Screws 10-16
1	Label Unit Disconnect Switch
2	Straight Wire Ties
1	Harness, Control Box to Switch
3	Bushings 2.0-inch
1	Label LOAD LINE

Installation

WARNING

Hazardous Voltage w/Capacitors! Failure to disconnect power and discharge capacitors before servicing could result in death or serious injury. Disconnect all electric power, including remote disconnects and discharge all motor start/run capacitors before servicing. Follow proper lockout/tagout procedures to ensure the power cannot be inadvertently energized. Verify with an appropriate voltmeter that all capacitors have discharged.

Figure 1. Remove front access panel and blower panel

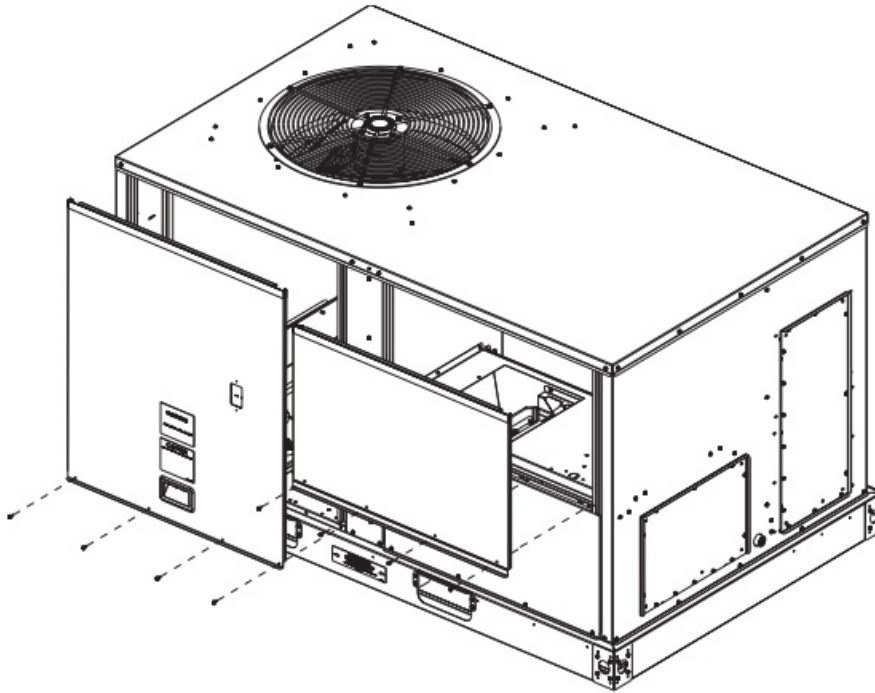
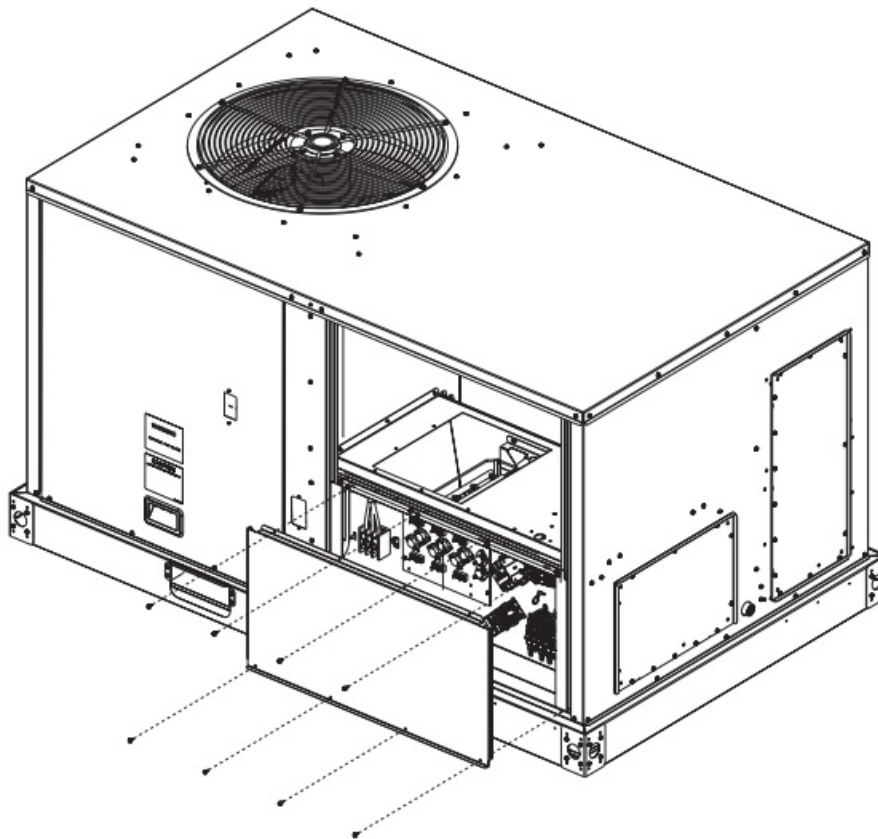
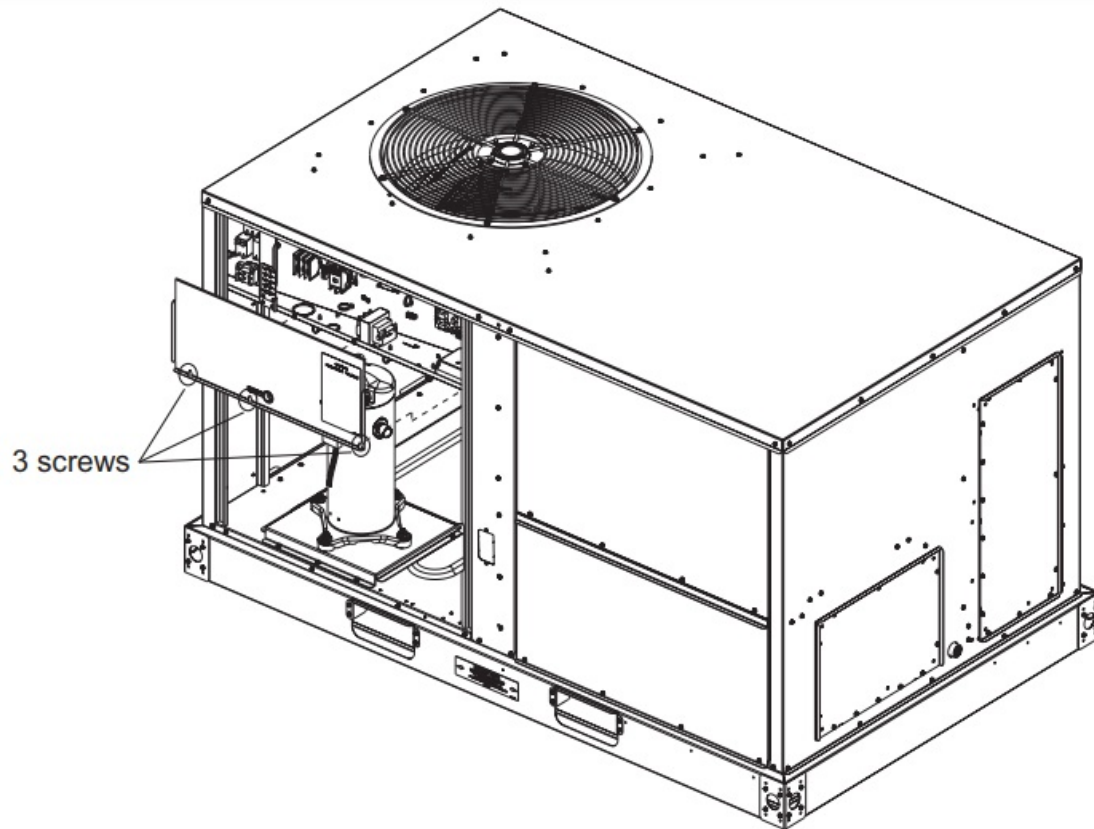

Figure 2. Remove the electric heater access panel



1. Remove the control box access panel (see Figure 3).

Figure 3. Remove control box access panel



Replace/Install the disconnect switch assembly in the unit (refer to Figure 4):

- To remove the old kit, remove two, 10-16 screws and push the bottom of the kit to release the tabs from the control box.
- To install the new kit, insert the three tabs of the new kit into the slots in the control box.
- Using two, 10-16 screws, secure the disconnect switch to the unit as shown in Figure 4.

Figure 4. Install disconnect switch

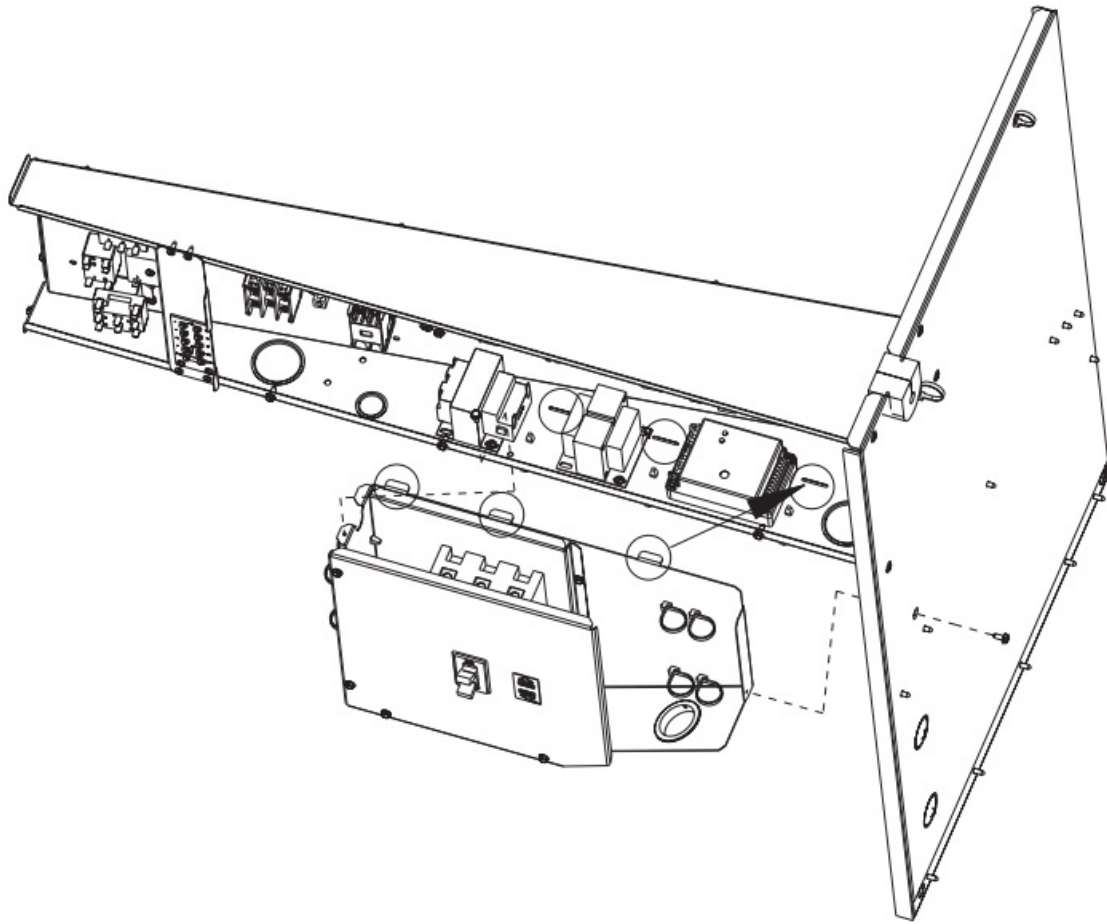

For cooling only and gas heat units, route power wiring to terminal block in control box. For electric heat units, route power wiring to terminal block in electric heat box. Refer to Figure 5.

Figure 5. Route power wiring

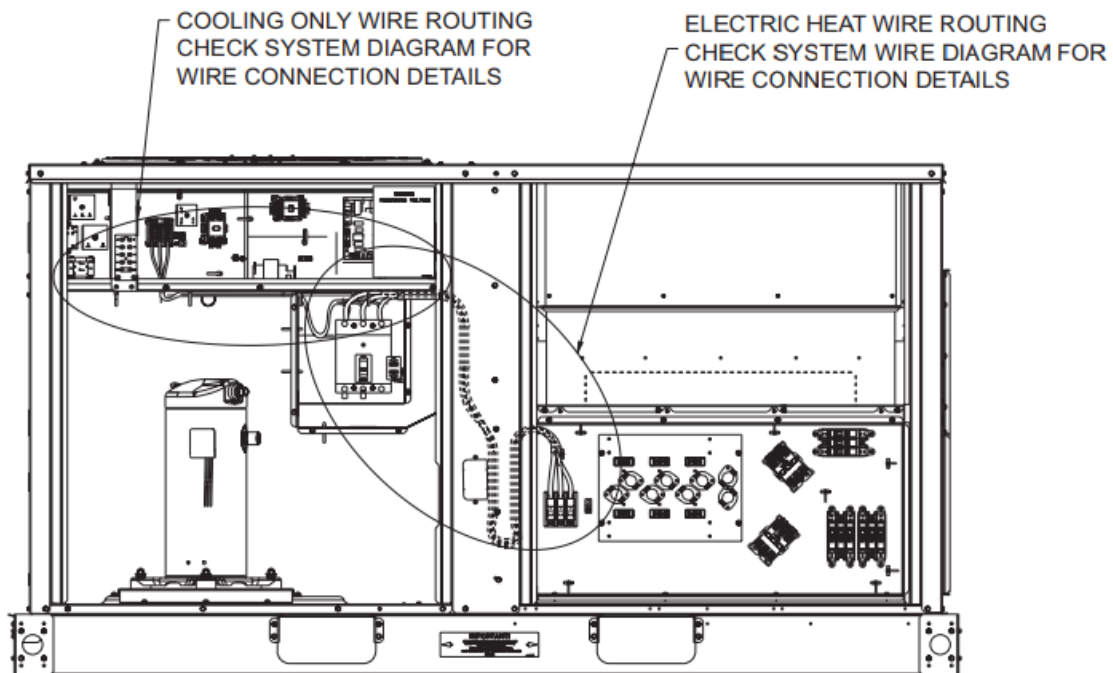

Install disconnect switch cover (refer to Figure 6 for substeps below):

- Using a flathead screwdriver, remove the knockout plate from the compressor access panel.
- Remove the flip switch cover from packaging.

- Using the two, 6-32 screws provided in the kit, secure the switch cover to the front access panel.

Figure 6. Install disconnect switch cover

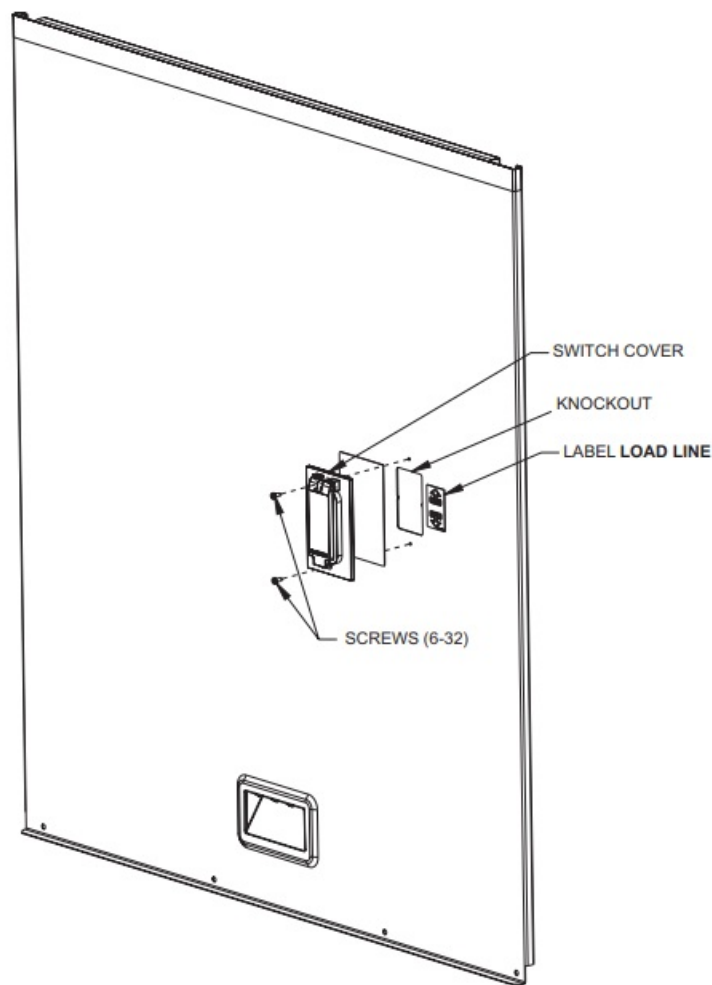

1. Place the label load line beside the switch cover on the unit access panel as shown in Figure 6.
2. Reinstall the control box access panel, compressor access panel, blower access panel, and electric heat access panel.

Trane and American Standard create comfortable, energy-efficient indoor environments for commercial and residential applications. For more information, please visit trane.com or americanstandardair.com.



Trane and American Standard have a policy of continuous product and product data improvement and reserve the right to change design and specifications without notice. We are committed to using environmentally conscious print practices. ACC-SVN195E-EN 23 Aug 2024 Supersedes ACC-SVN195D-EN (Jul 2024)

Documents / Resources



[Foundations BAYDSCF322 Packaged Rooftop Units](#) [pdf] Installation Guide
BAYDSCF322, BAYDSCF323, BAYDSCF322 Packaged Rooftop Units, BAYDSCF322, Package
d Rooftop Units, Rooftop Units, Units

References

-  [American Standard® | Air Conditioning and Heating | HVAC Systems](#)
-  [Trane Heating & Air Conditioning](#)
- [User Manual](#)

[Manuals+](#), [Privacy Policy](#)

This website is an independent publication and is neither affiliated with nor endorsed by any of the trademark owners. The "Bluetooth®" word mark and logos are registered trademarks owned by Bluetooth SIG, Inc. The "Wi-Fi®" word mark and logos are registered trademarks owned by the Wi-Fi Alliance. Any use of these marks on this website does not imply any affiliation with or endorsement.