



FOSVISION FS-C8F-5MP Smart Mini PTZ WIFI/IP Camera User Guide

[Home](#) » [FOSVISION](#) » FOSVISION FS-C8F-5MP Smart Mini PTZ WIFI/IP Camera User Guide 

FOSVISION
FS-C8F-5MP Smart Mini PTZ WIFI/IP Camera
User Guide



-Wireless camera



<http://www.dvr163.com/download/indexm.php>

Before operating this unit please read these instructions carefully and save them for future use.

Contents

- 1 Interface description
- 2 Description
- 3 Software Installation
- 4 Camera adding process description
- 5 Wired add configuration process
- 6 Documents / Resources

Interface description

This manual is suitable for various types of cameras.

(The appearance may be different due to different batches. The detail are subject to the receipt. This manual is only for the installation instructions of this series of equipment)

1. Wireless Pan-tilt IP Camera



2. WiFi Bullet Camera

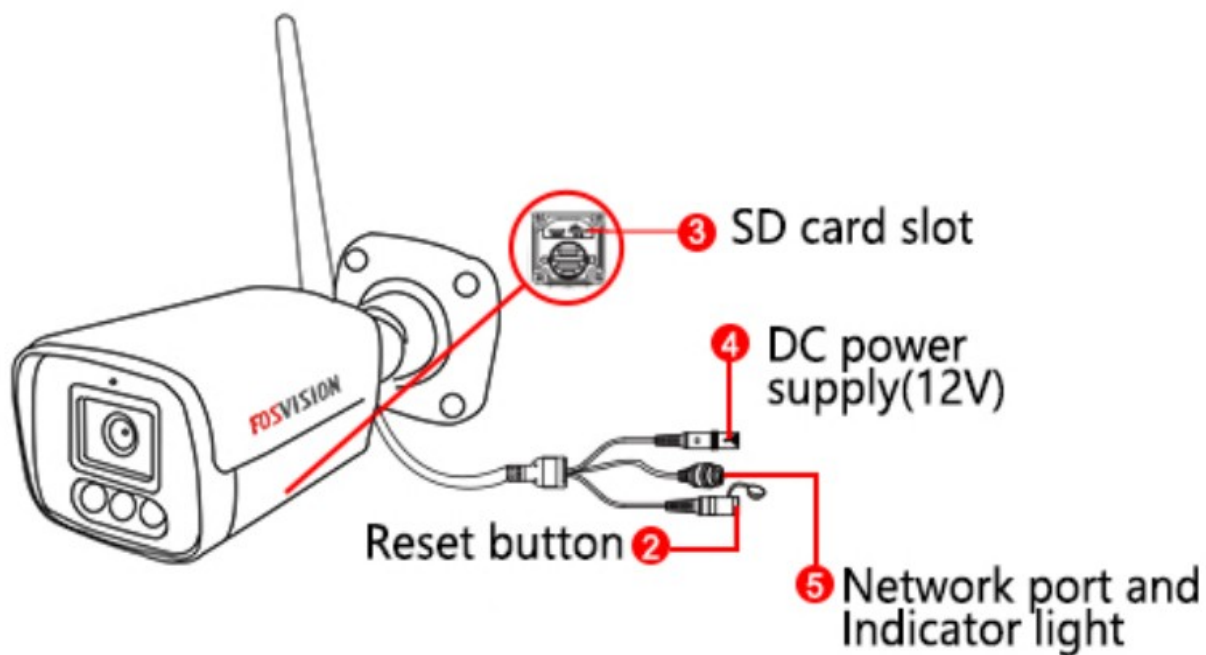

3. WiFi MINI PTZ Camera

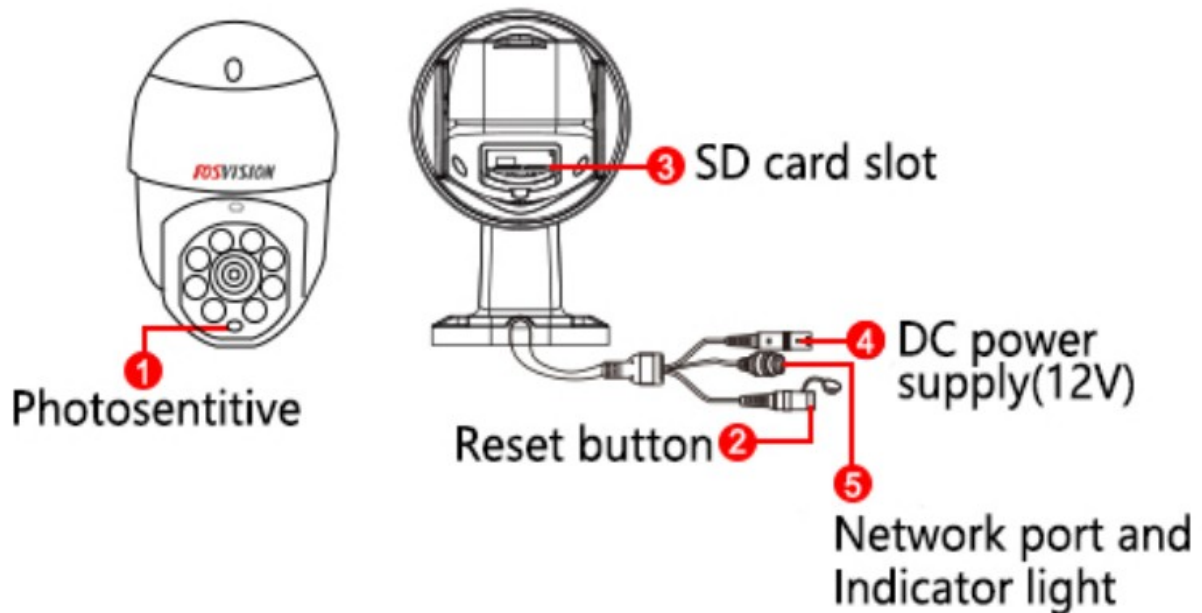

Description

1. Photosensitive

Collect ambient luminosity value, turn on the infrared light when the current illuminance is less than 3 Lux

2. Reset button

The working state of the device, long press 3-5 seconds to restore the factory, the camera will have a voice prompt. broadcast

3. SD card slot

TF card, storage video and playback video,

4. DC power supply

Power input

5. Network port and indicator light

Connect the Lan cable and check the current device status indicator light (flashes once /1s on hotspot mode)

Software Installation

APP Download and Installation

Users can search "EseeCloud(IP Pro, VR Cam)" on APP store or Google Play, or scan the QR code below to install the APP.



EseeCloud APP



APP download

<http://www.dvr163.com/download/indexm.php>

Note: For iOS system, it requires iOS 9.0 version or above. For Android, Android 5.1 or above.

Account login

Account login: On the login interface, enter the account/ phone number/ email, and the corresponding password, and click the “OK” button to log in.

Third-party login: APP supports third-party login. Click the third-party social software icon, jump to the APP to complete the authorization and log in.

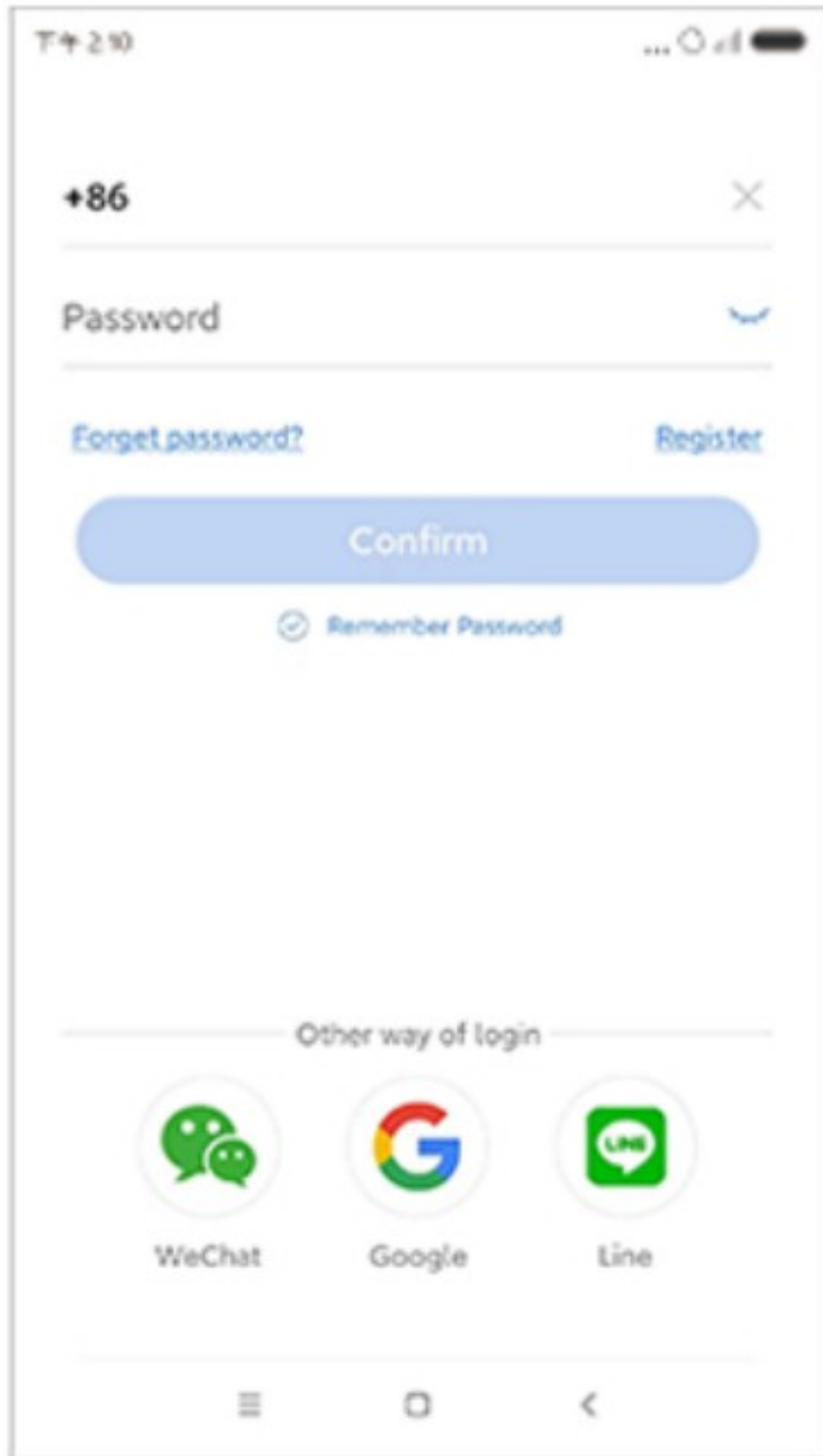

Camera adding process description

1. Open the “EseeCloud” APP and click the “+” icon in the middle of the interface to enter the scan QR code interface;

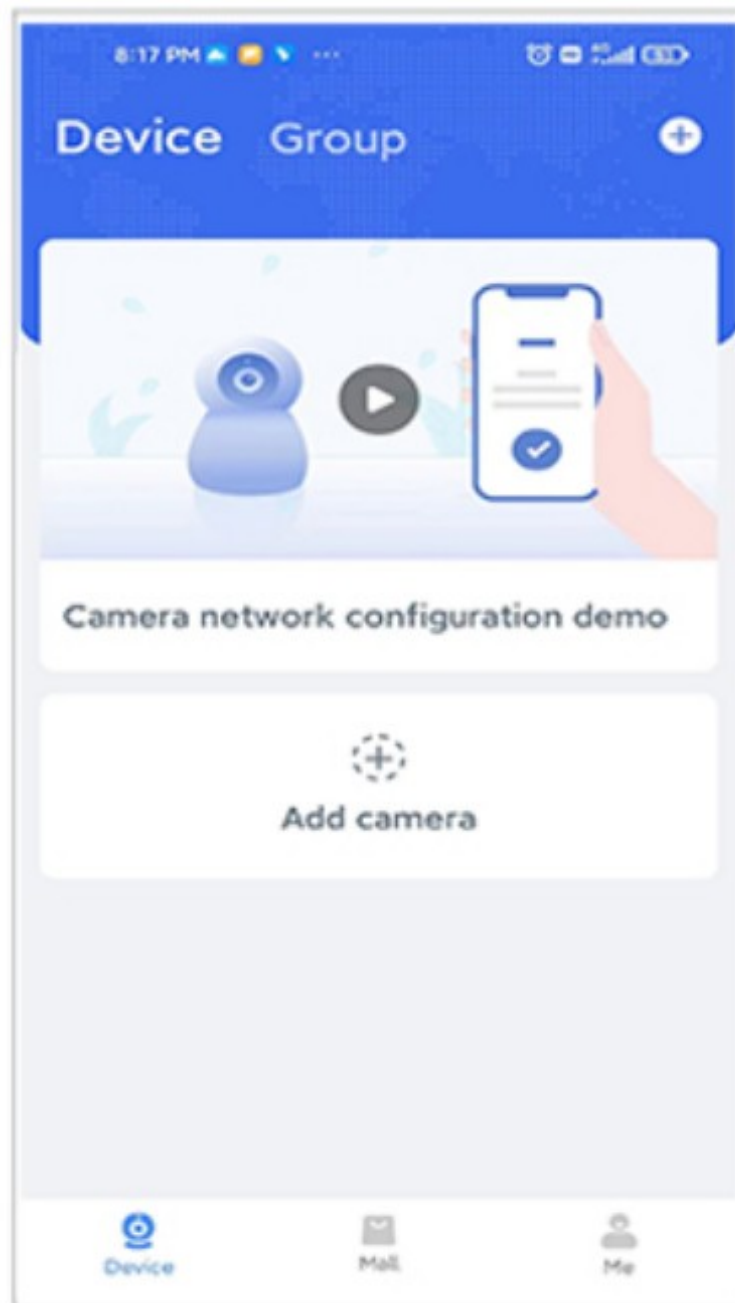

2. Scan the QR code on the device ;



3. On the Add device interface, click "Add";



4. Reset the device and wait for the device indicator to flash and proceed to the next step;



5. To view and use via WiFi or other networks, please select Remote Viewf there is no network, if you connect to the camera at close range, please select local Direct Connection;

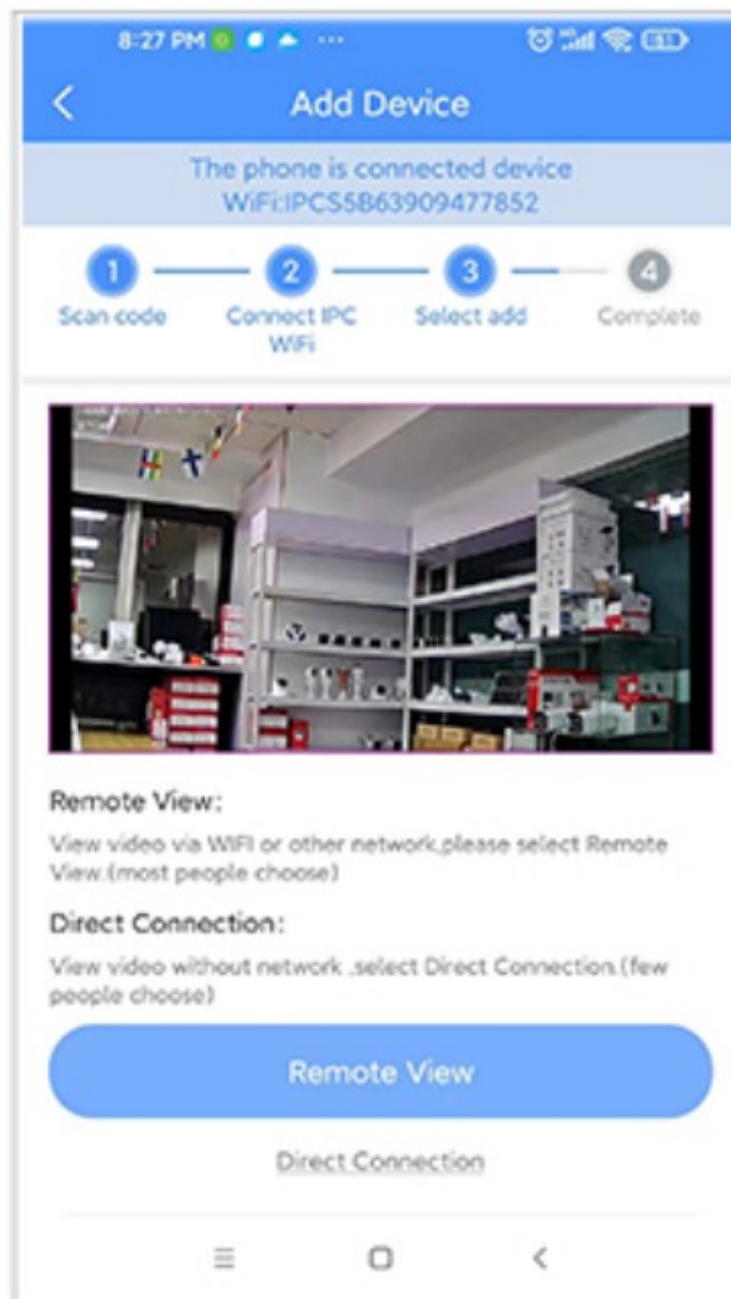

Remote View adding process

1. Select "Remote View" to add, connect the device to WiFi, select the working WiFi that the device needs to connect to, enter the password, and click Next;

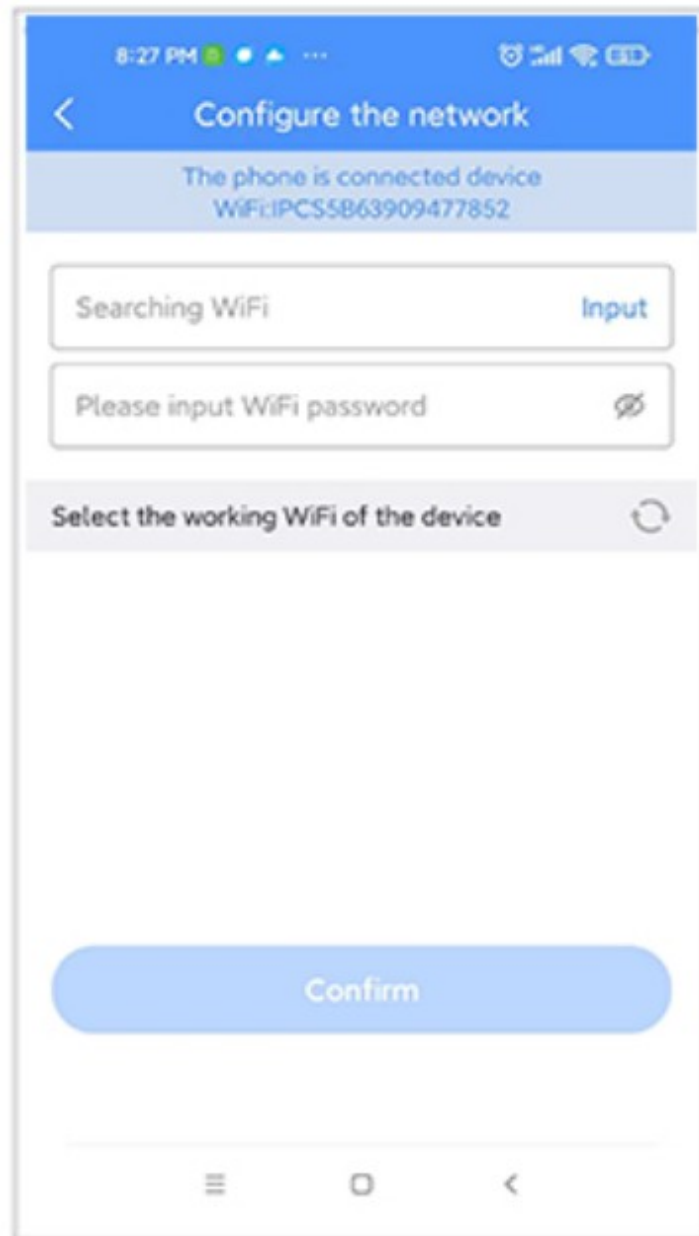

2. Use the device to scan the QR code of the mobile phone according to the operation shown in the figure, and proceed to the next step after hearing the prompt tone or the device indicator light no longer flashes;



3. After the network configuration is successful, the device name can be added successfully.

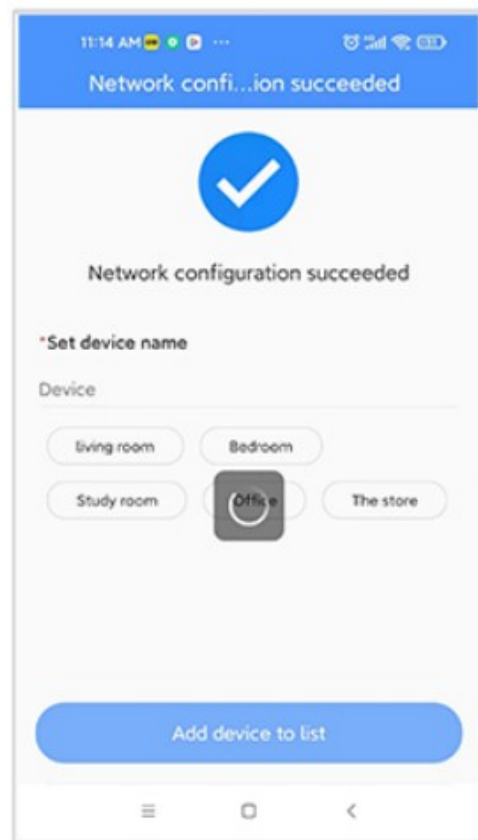
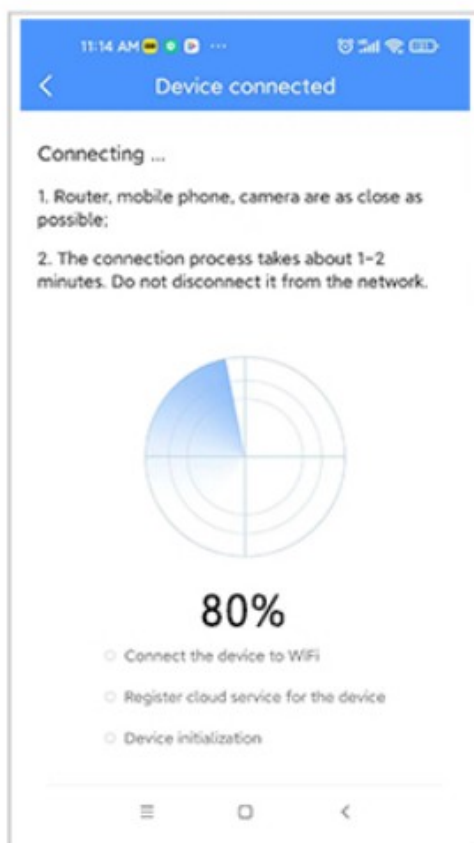

Local direct connection add

1. Click * Direct Connection”, set a password for the WiFi of the device, and enter the next step; (Direct connection can only be connected to the camera for viewing locally)

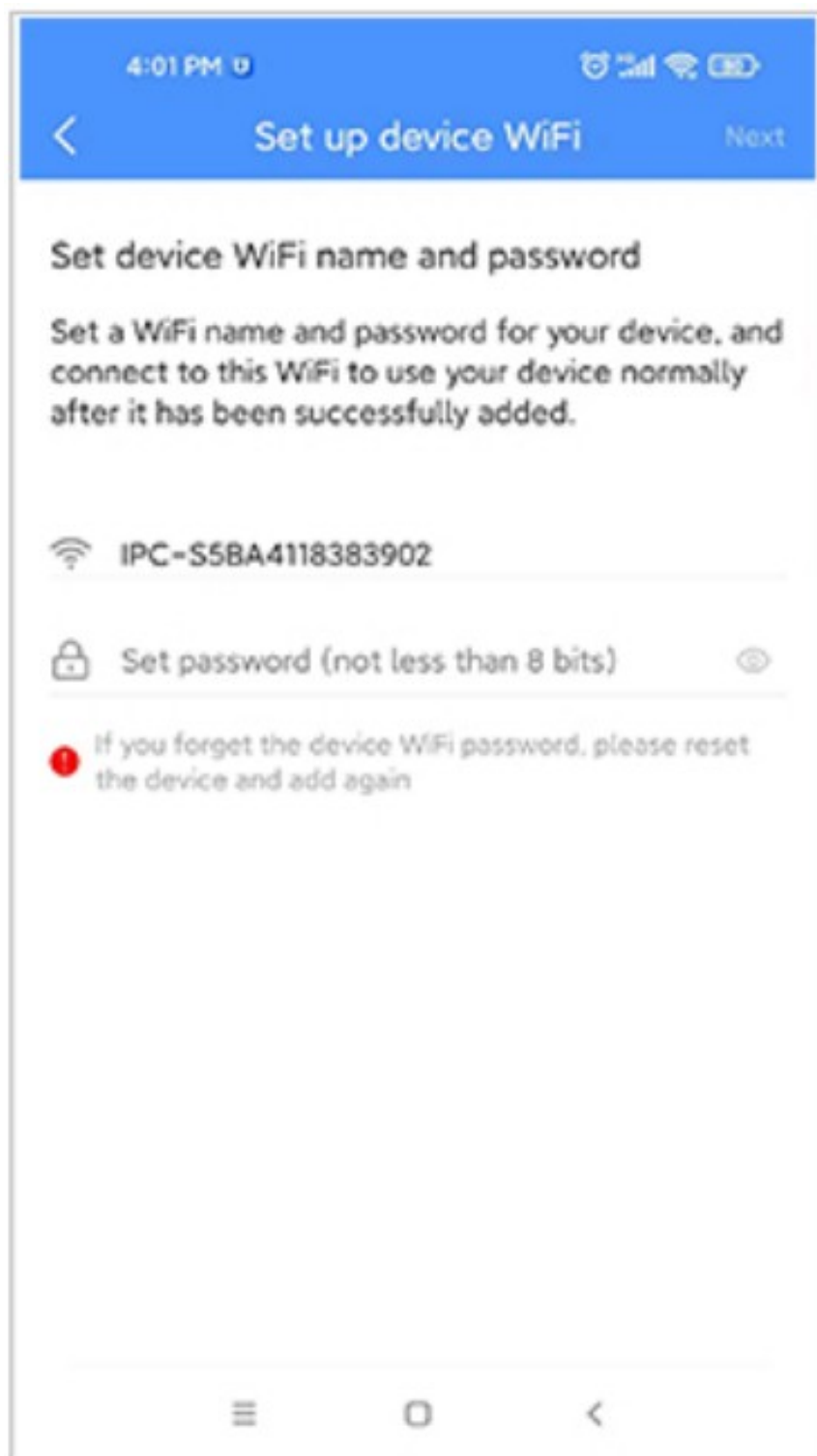

2. Use the device to scan the QR code of the mobile phone according to the operation shown in the figure and go to the next step after hearing the prompt tone or the device indicator light no longer flashes;



3. According to the interface guide, after connecting the device with its own WiFi, return to the APP;

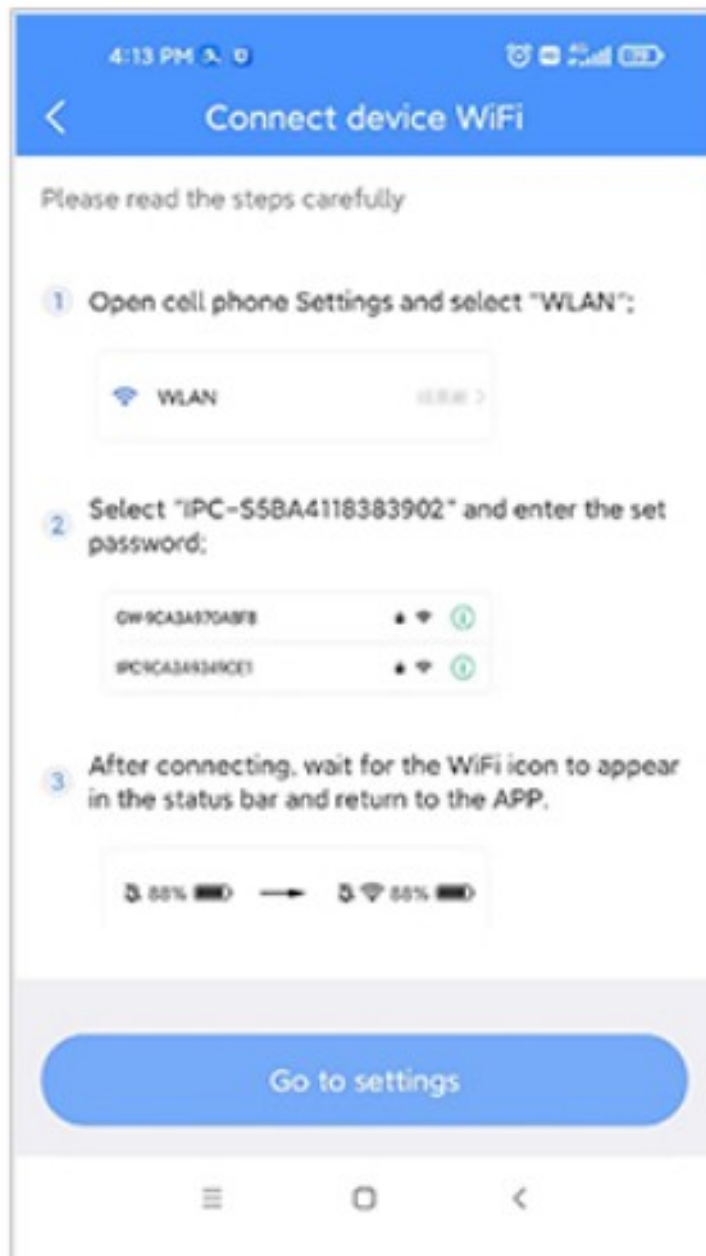

4. The device is successfully connected to the device.

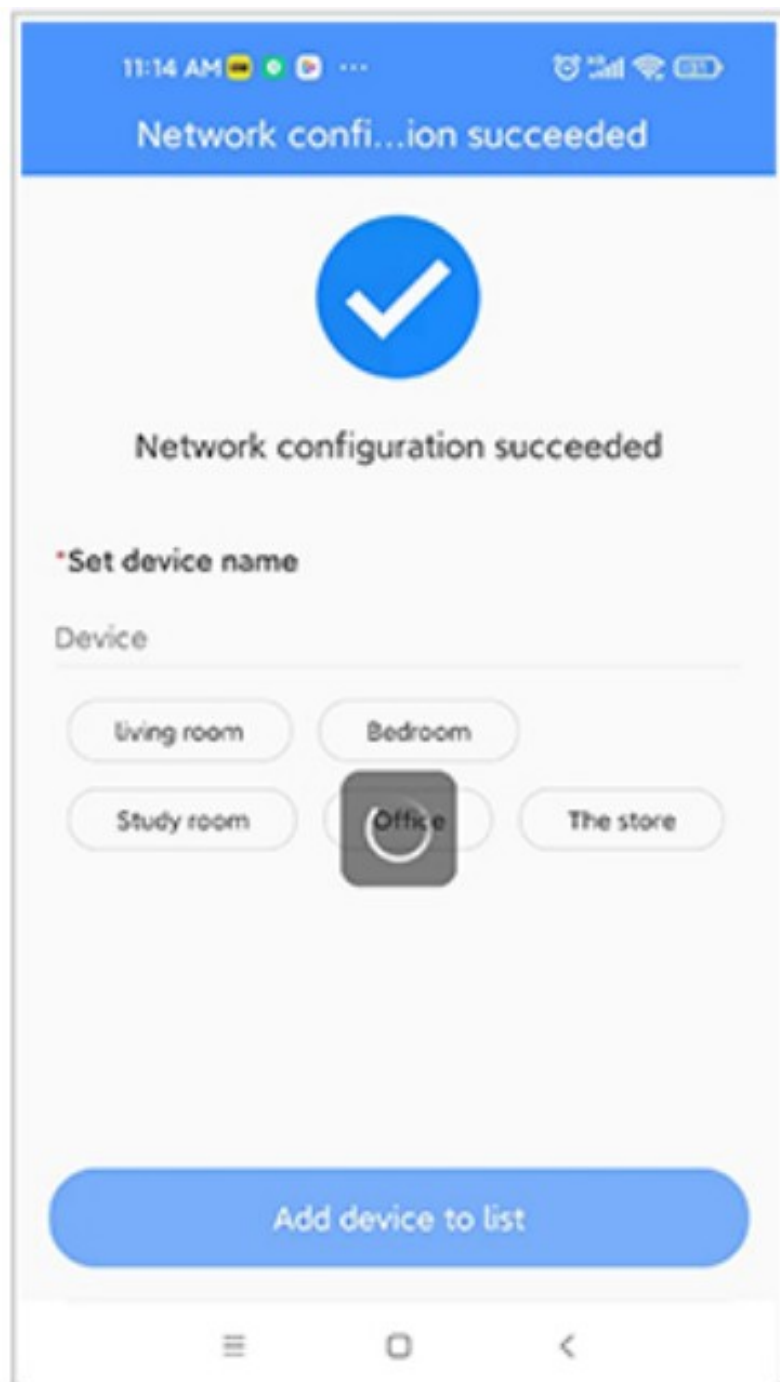

When the QR code of the device cannot be found (or the scan code is unsuccessful)

1. Connect to the IPCXXX hotspot in the phone settings, the password is 11111111;

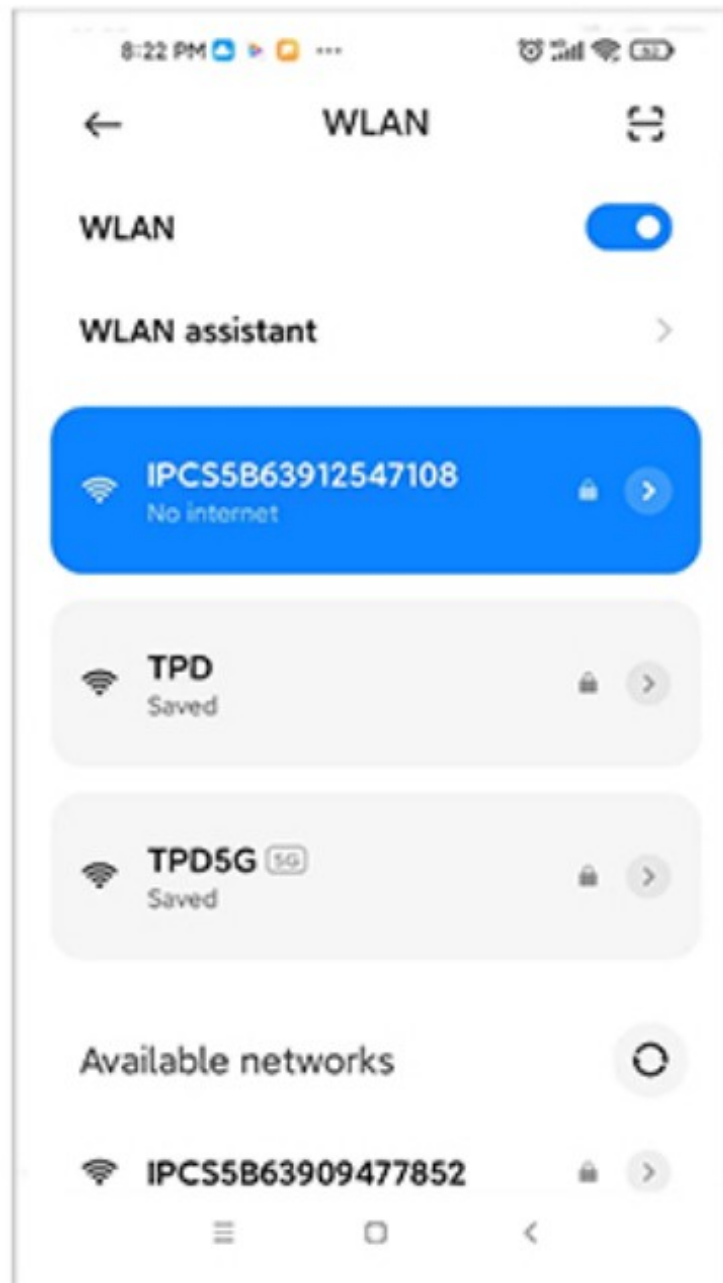

2. Click "Other ways to add" in the code scan interface, and select the "Standalone camera"

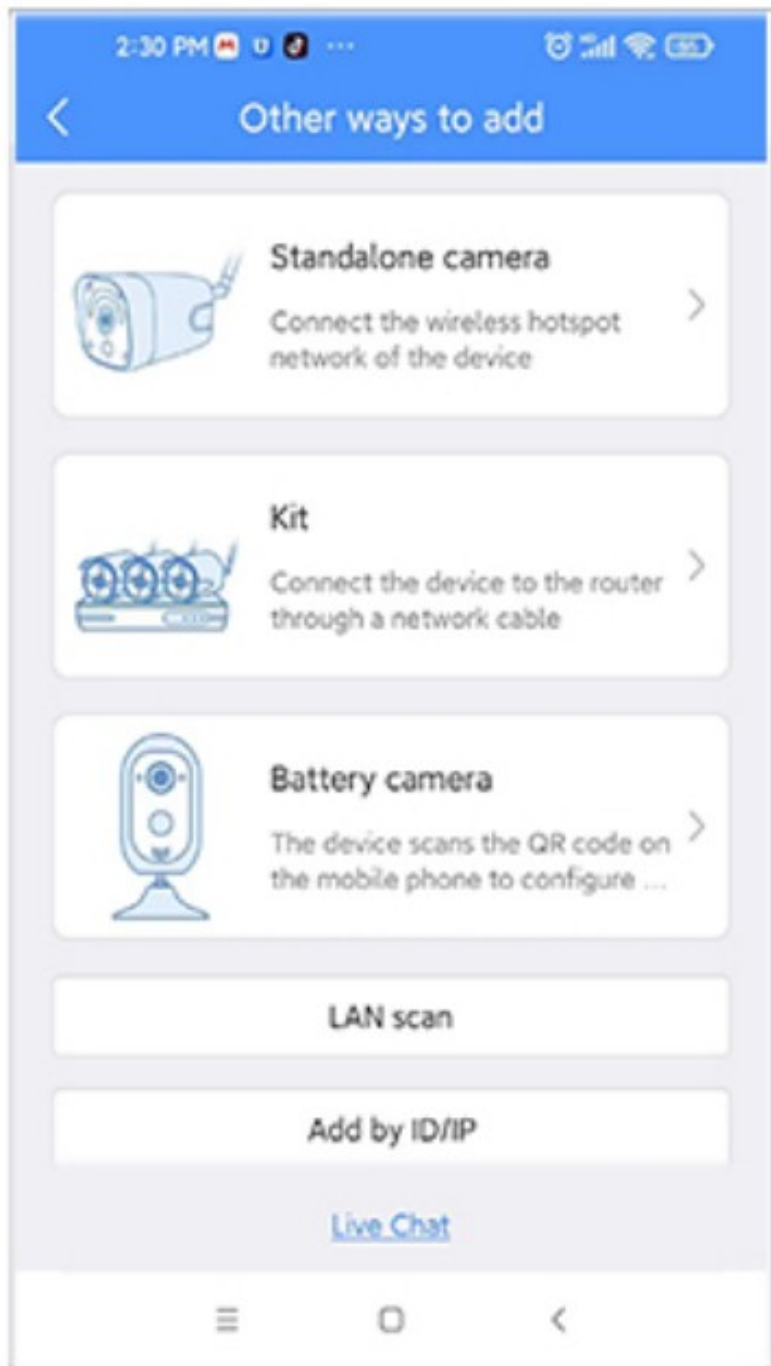

3. To view and use via WiFi or other networks, please select "Remote View * if there is no network, to view the camera at close range, please select "Direct Connection";

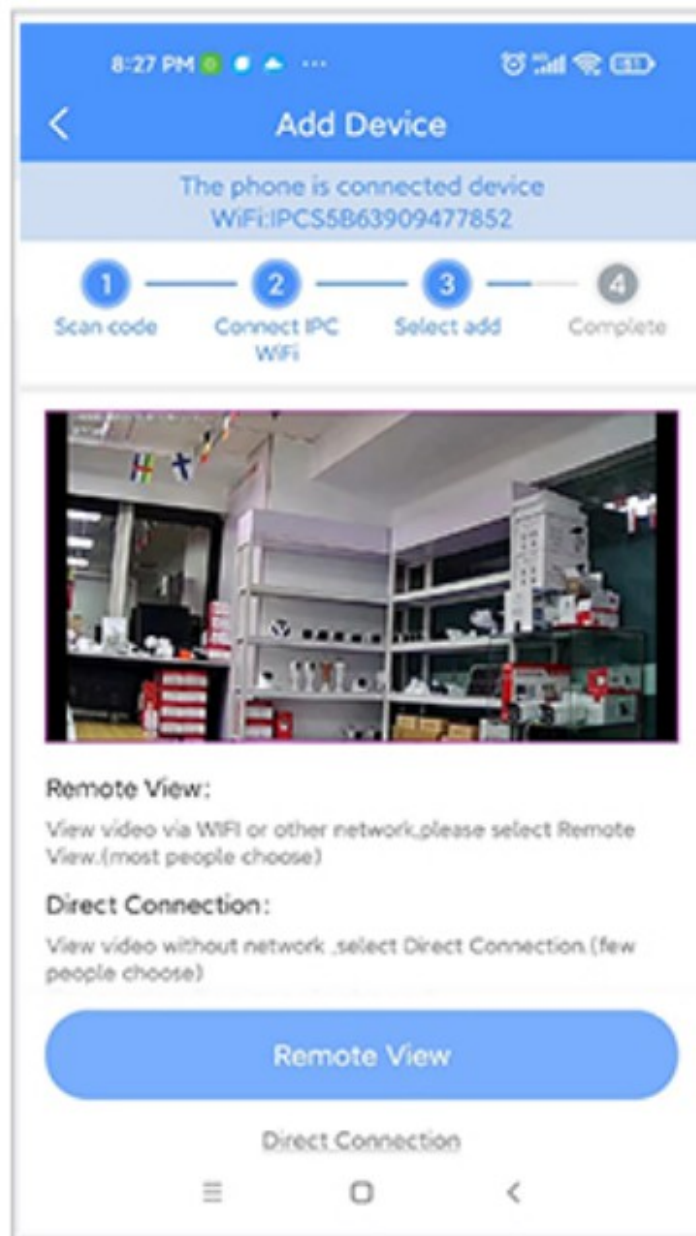

Remote View adding process

1. Select Remote View' to add, connect the device to WiFi, select the working WiFi that the device needs to connect to, enter the password, and click Next;

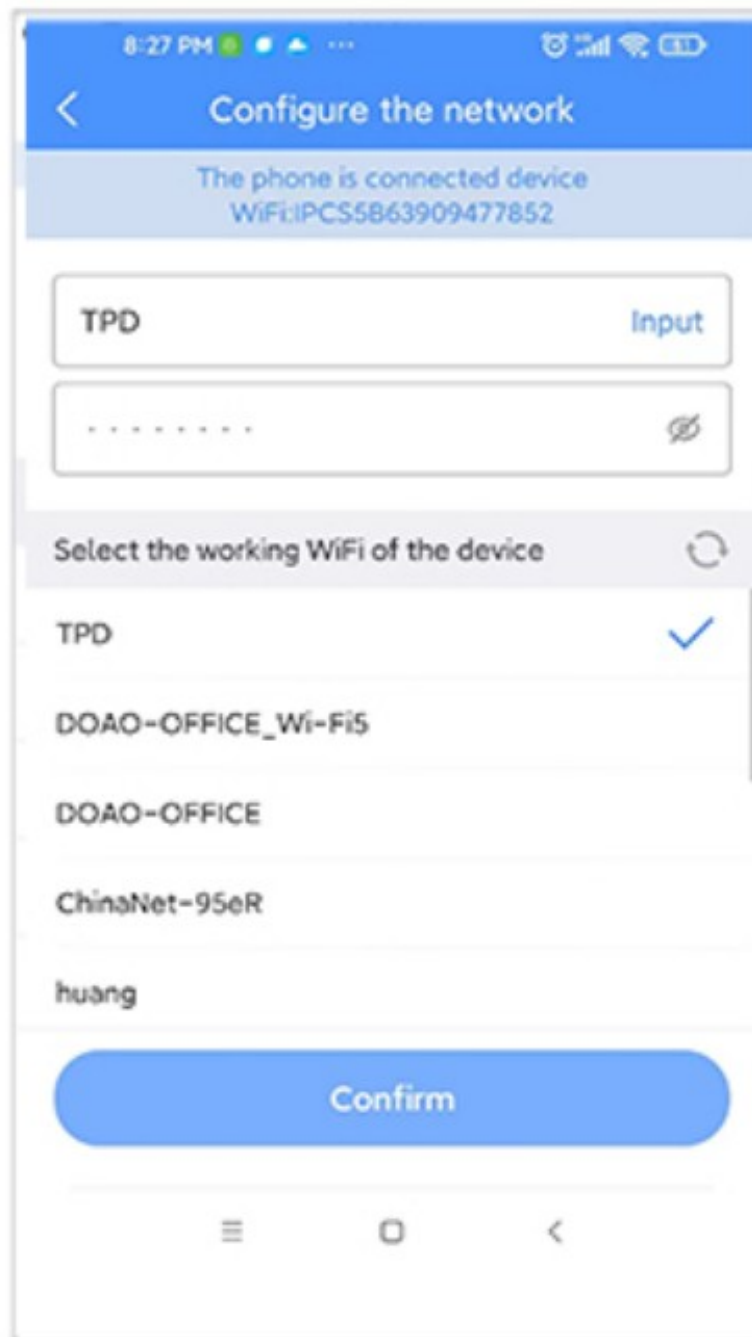

2. Please wait patiently during the device configuration network;

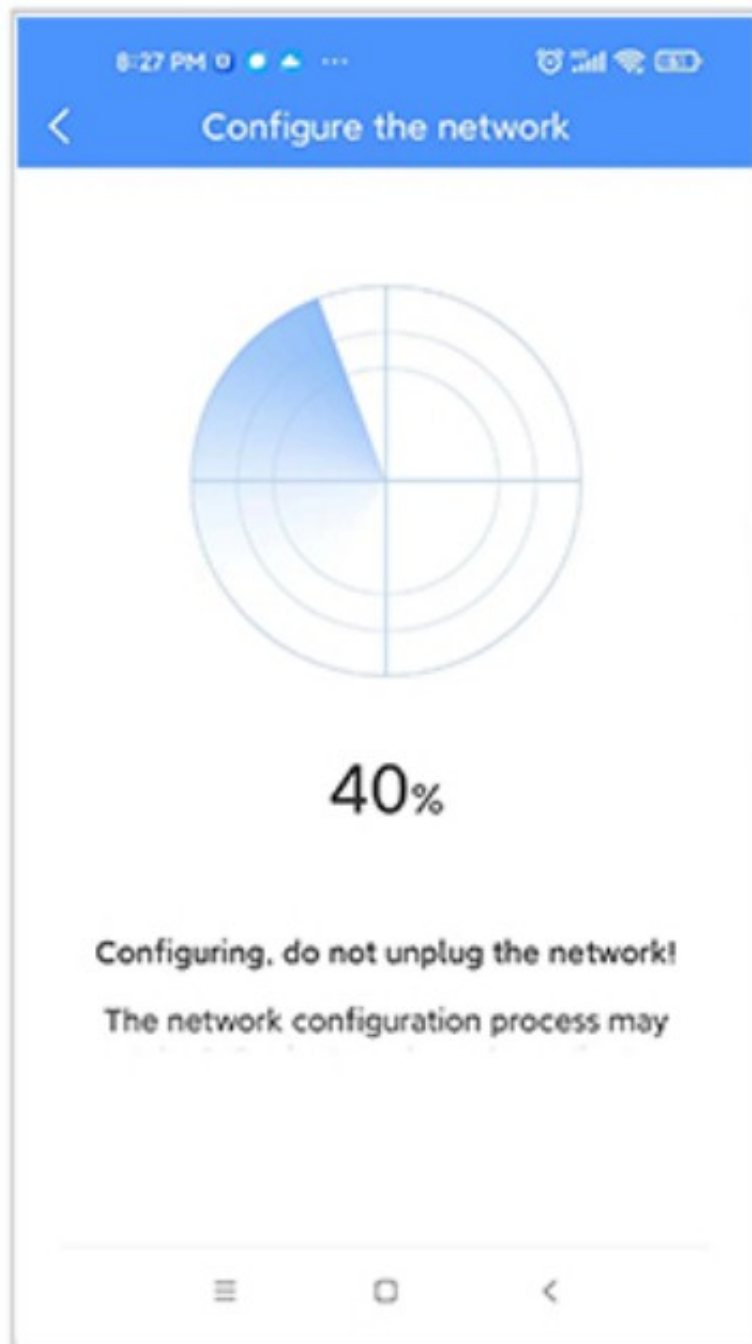

3. The device is successfully added, please set a name for the device

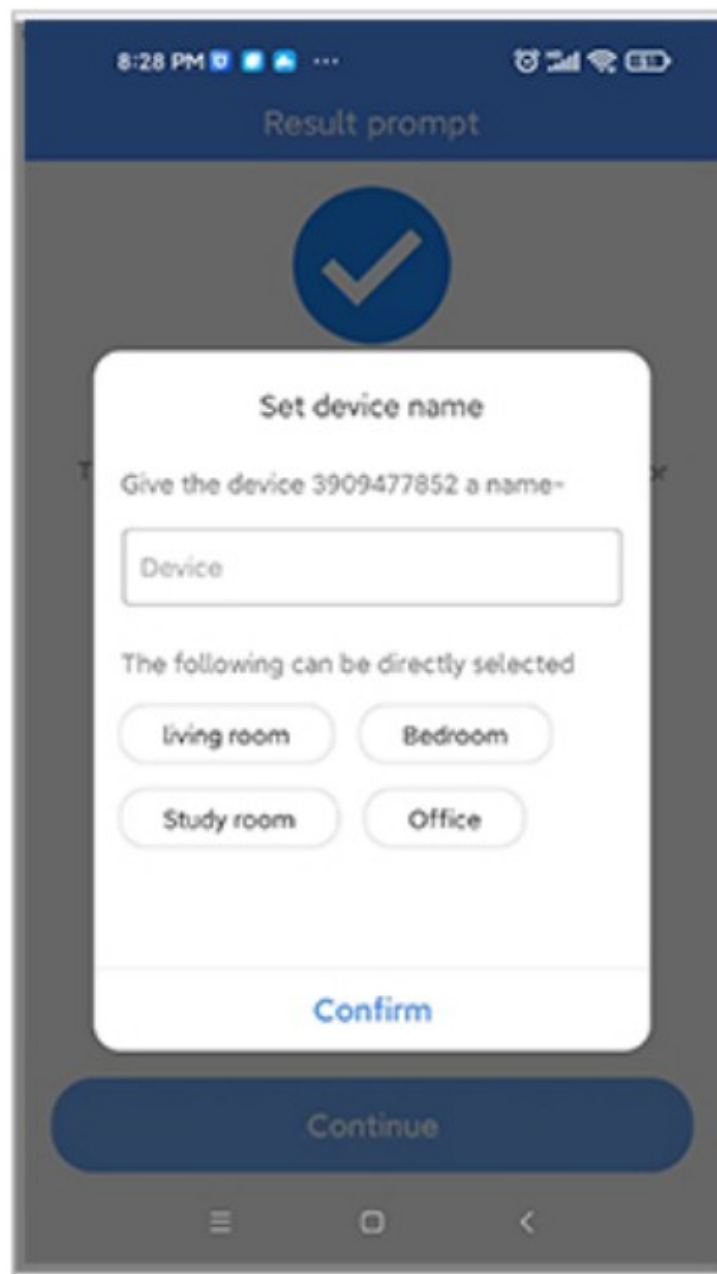

Direct Connection adding process

Select "Direct Connection" to add, and set the name and password for the device to add successfully;

Note: The Direct Connection needs to be connected to the device hotspot to preview the device screen normally.

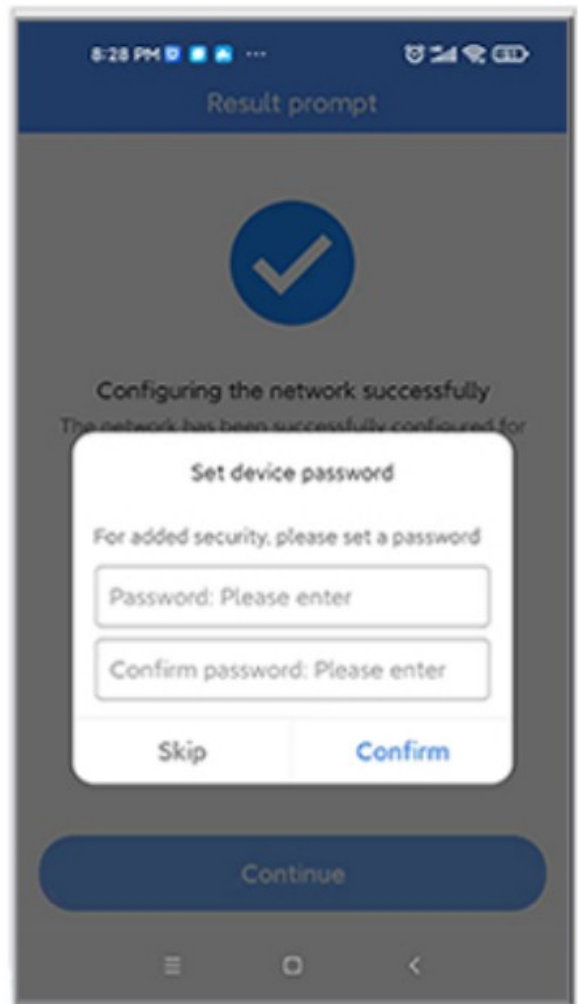
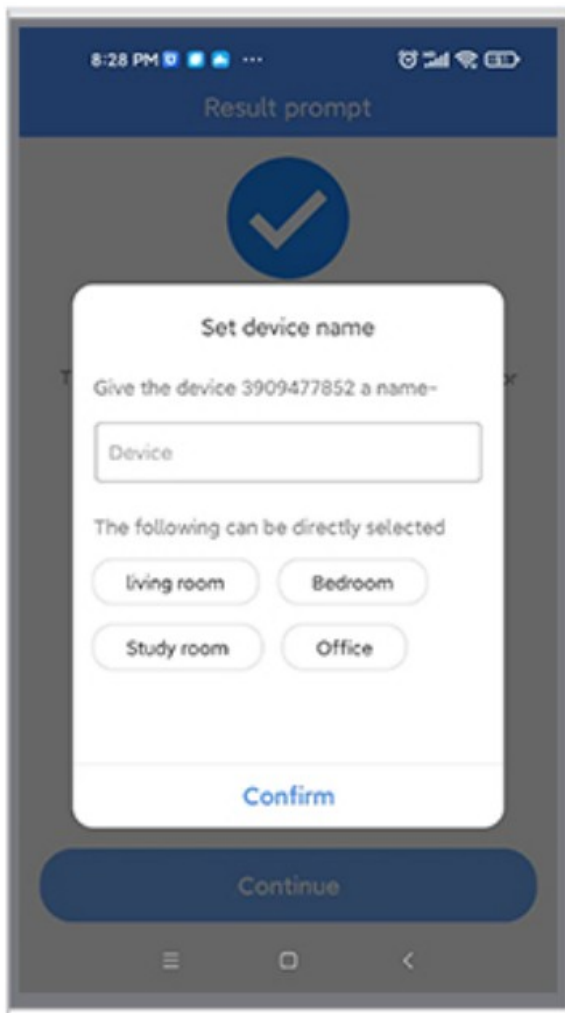

Wired add configuration process

Power on the device, connectit to a router with internet access with a network cable.

1. Scan the QR code of the device, and click "Add";



2. After setting the name for the device, it can be added successfully

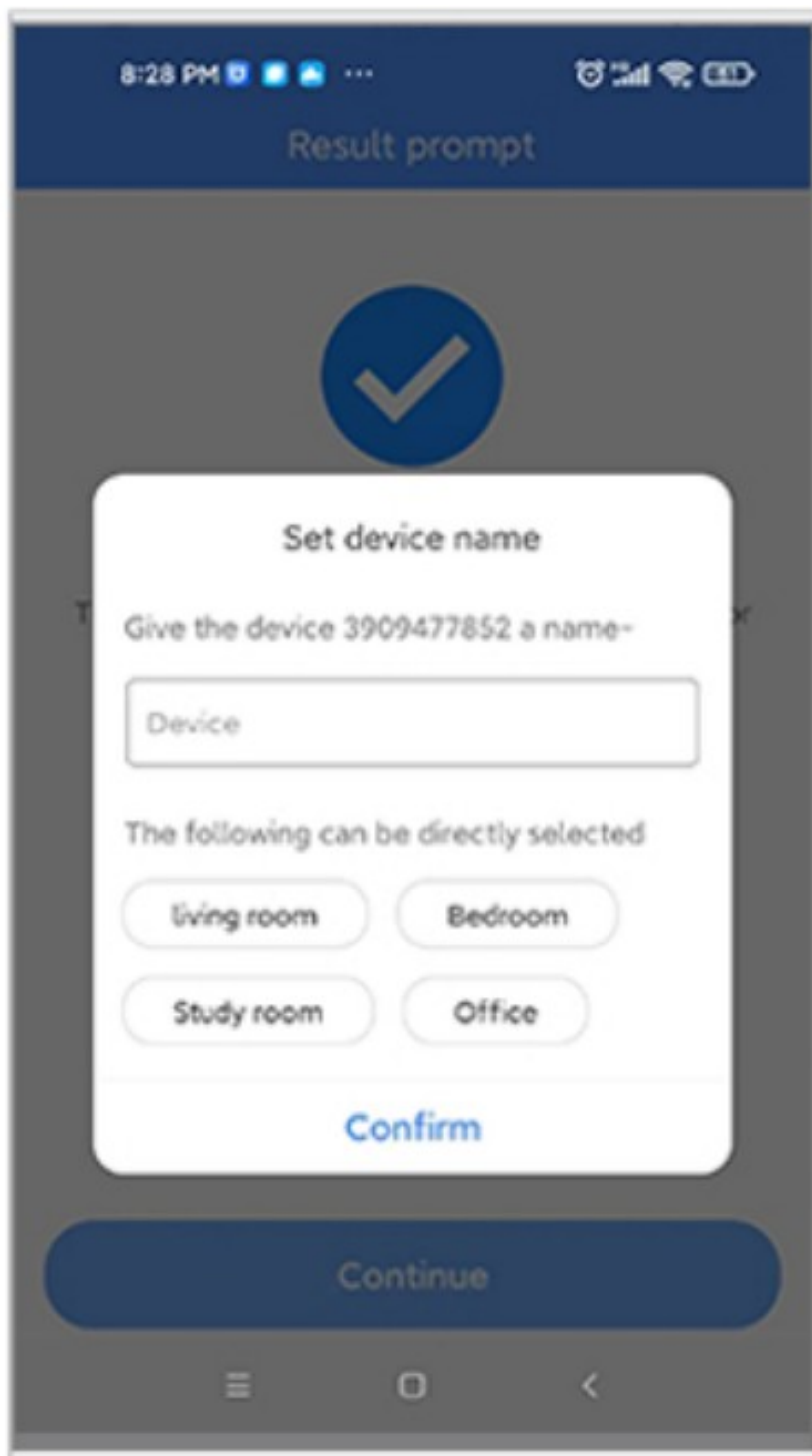

Warning



In case of fire or lightning, pls don't put product in damp and raining place, operate to maintain according to the user manual.



Be careful when you see attachment with a Dangerous Voltage which might cause serious electric accident.



Warning

To reduce electric shock, unprofessional people please don't open product front panel or rear panel

Warning

In case of electric shock and fire, pls don't use power supply beyond power list in user manual

Notice:

1. Ensure your equity,pls read the user manual carefully before you use the product
2. Pls contact professional people if you need install and maintain the product
3. Working Environment:temperature of -20% relative humidity under 85% ~+60°C,
4. Pls don't exceed the user manual" is standard range of temperature humidity and voltage.



Documents / Resources



[FOSVISION FS-C8F-5MP Smart Mini PTZ WIFI/IP Camera](#) [pdf] User Guide
FS-C8F-5MP Smart Mini PTZ WIFI IP Camera, FS-C8F-5MP, Smart Mini PTZ WIFI IP Camera,
PTZ WIFI IP Camera, WIFI IP Camera, IP Camera, Camera

Manuals+.