



FOSTER FD2-10 Controller and LCD5S Display User Manual

[Home](#) » [FOSTER](#) » FOSTER FD2-10 Controller and LCD5S Display User Manual 



FlexDrawer
FFC2-1, 4-2, 3-1 & 6-2
FD2-10 Controller & LCD5S Display



Original Operation Manual

Contents

- 1 FD2-10 Controller and LCD5S Display
- 2 Electrical Safety
- 3 General Safety
- 4 Disposal Requirements
- 5 Start-Up and Test Sequence
- 6 User Adjustments
- 7 Alarms and Warnings
- 8 Keypad Security Settings
- 9 Cleaning and Maintenance
- 10 Documents / Resources
 - 10.1 References
- 11 Related Posts

FD2-10 Controller and LCD5S Display

Models Applicable to This Manual

FFC2-1
FFC4-2
FFC3-1
FFC6-2

Climate Class

Climate class is indicated on the serial plate, shows the temperature & humidity at which this appliance has been tested, for the purposes of establishing values in line with European standards.

Important Note to the Installer:

Please ensure that this document is passed to the user as it contains important guidelines on operation, loading, cleaning and general maintenance and should be kept for reference.

Electrical Safety

This equipment shall be connected to an electrical supply protected by a Residual Current Device (RCD). This may include a residual current circuit breaker (RCCB) type socket, or through a Residual Current Circuit Breaker with overload protection (RCBO) supplied circuit.

Should it be necessary to replace the fuse, the replacement fuse must be of the value stated on the serial label for the appliance.

General Safety



Do not store explosive substances such as aerosol cans with a flammable propellant in this appliance.



Keep all ventilation openings in the appliance or in the structure of a built in unit clear of any obstructions.



Do not use electrical appliances inside the storage compartment.



The appliance is air tight when the door is closed therefore under no circumstances should any living body be stored or 'locked in' the appliance.



The moving of the appliance should be carried out by competent personnel, ensure that two or more people are used to guide and support the appliance, the appliance should not be moved over uneven surfaces.



The emitted sound level of this appliance is below 70db(A).



To ensure stability the appliance should be located on a flat, level surface, correctly loaded with the castors locked.



If the supply cord is damaged, it must be replaced by the manufacturer, it's service agent or similarly qualified persons in order to avoid hazards.



Care should be taken to avoid prolonged contact with cold surfaces with unprotected body parts, Correct PPE to be used at all time.



When moving the appliance appropriate gloves should be worn, and a relevant risk assessment carried out.

Disposal Requirements

If not disposed of properly all refrigerators have components that can be harmful to the environment. All old refrigerators must be disposed of by appropriately registered and licensed waste contractors, and in accordance with national laws and regulations.

Start-Up and Test Sequence



After unpacking, clean and allow the counter to stand for 2 hours before turning on (cleaning directions supplied within this manual). Ensure, where possible that the counter is situated away from both hot and cold air sources, as this will affect its performance. Make sure effective ventilation around the unit is available for optimum operation.

Connect the unit to a suitable mains power outlet and turn the supply on. Do not plug or unplug the unit with wet hands.

Counters are supplied ready for operation.

After connecting the unit to the mains the displays will briefly show a dash in the centre of the screen. This will then show.

Activate the controller Per drawer display:

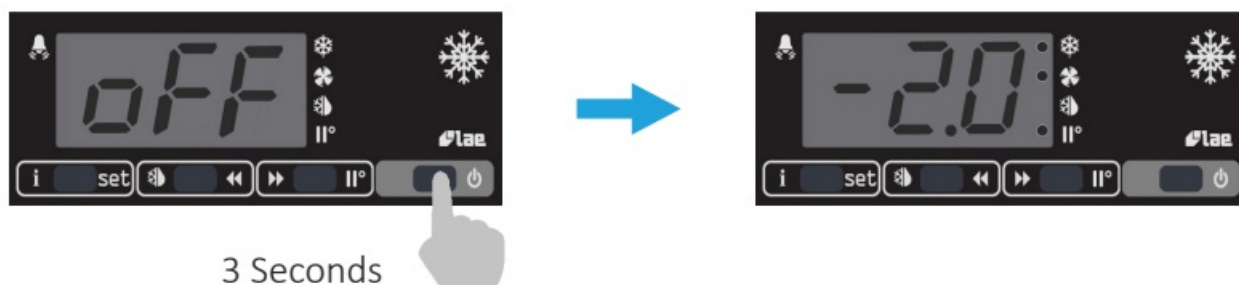

Cancel Test Sequence Per drawer display:



Note: If not pressed the test will continue and when complete the controller will show 'End' wait 1 minute, then resume normal operation.



User Adjustments

Check Storage Temperature Set Point Per drawer display:



Temperature Settings

The factory default temperature is -18°C/-21°C (freezer). To amend the drawer temperature from the factory default to a +1°C/+4°C (fridge) follow the instructions below.

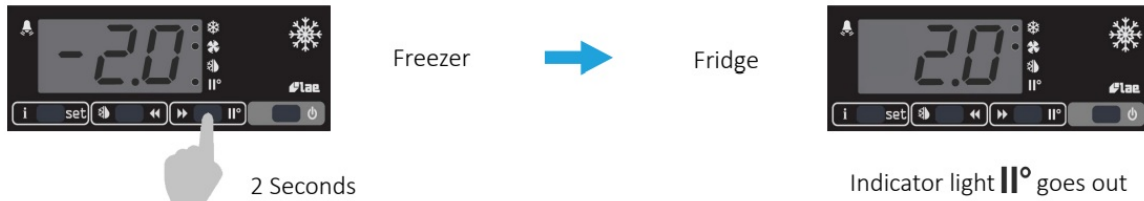

Repeat above instruction to reset from fridge to freezer.

When changing drawer temperatures please ensure that all product has been unloaded and that the counter is left for a minimum period of 1 hour to acclimatise to the new temperature.

For freezer temperatures only place already frozen product inside. This unit is not designed to freeze down product.

Standby

Per drawer display:

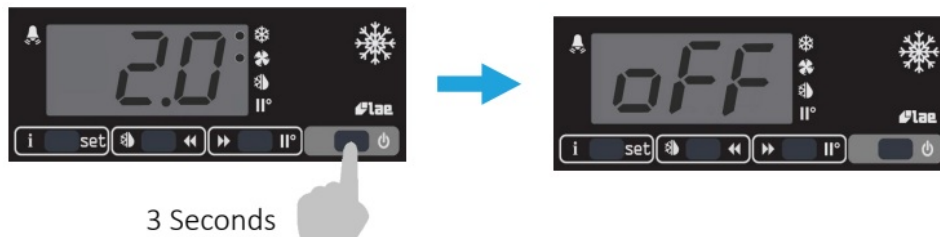

This will show while the unit is not operating but still has mains power applied to it. This mode may be used for interval cleaning regimes and short periods when the unit is not required. For extended periods of inactivity the mains supply should be isolated.

Defrost

Automatic -When set to freezer temperature the drawer has a totally automatic defrost system that ensures the evaporator coil is clear from ice.

Manual Defrost – If required on either fridge or freezer temperatures a manual defrost can be initiated on each drawer display.

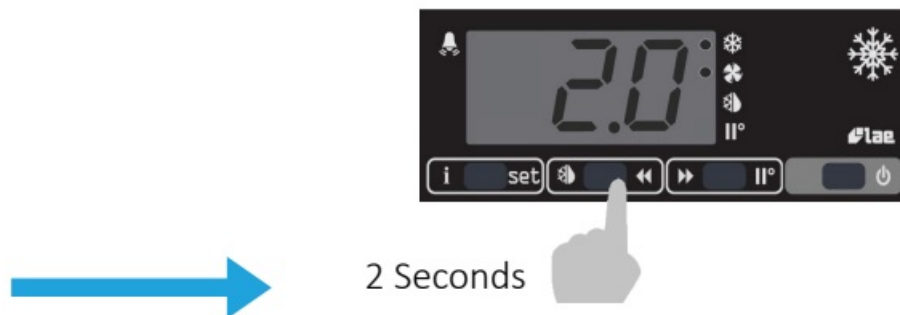

Alarms and Warnings

During normal operation the displays will show either the temperature or one of the following indicators:

<i>hi</i>	Counter High Temperature Alarm
<i>Lo</i>	Counter Low Temperature Alarm
<i>do</i>	Drawer Open Alarm
<i>E 1</i>	Air Temperature Probe T1 Failure
<i>E 2</i>	Evaporator Temperature Probe T2 Failure (Freezer Counters Only)

Drawers

Loading

Product should be placed in a way that ensures air can circulate around/through it and only when the bin is in situ.

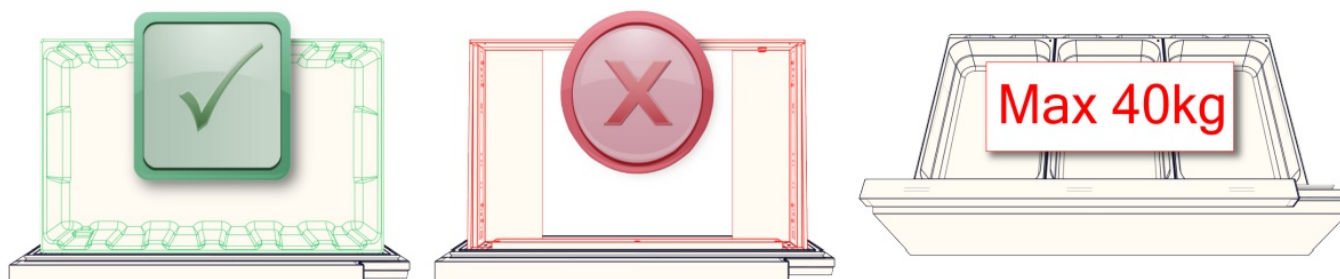

Evaporator Fan Protection

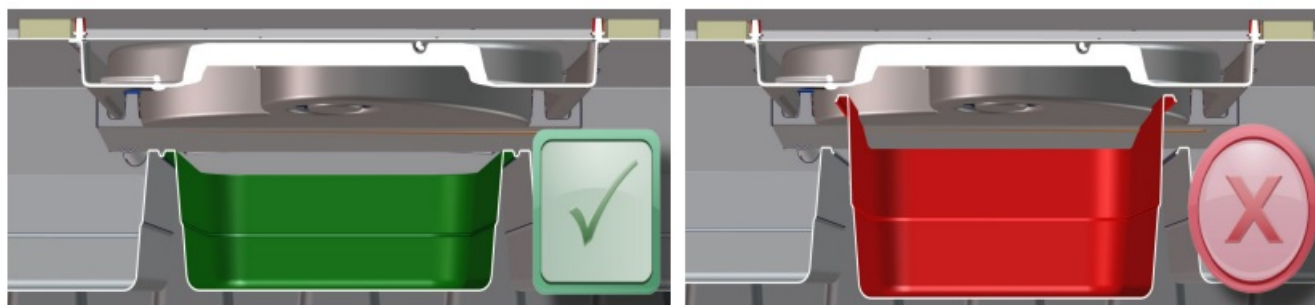

Do **NOT** block the fan airflow

Locking

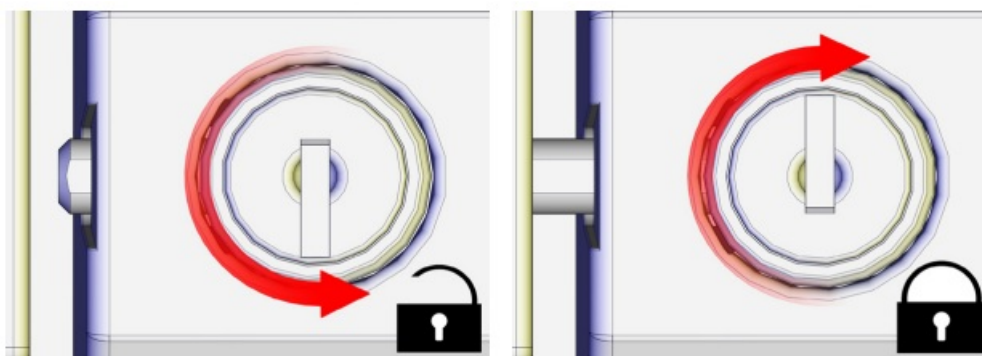

Overshelf and Can Opener (Optional)

Both the overshelf & can opener options are only supplied fitted to models from factory. The overshelf should hold no more than 80kg evenly distributed.

Keypad Security Settings

The keypad lock avoids undesired, potentially dangerous operations, which might be attempted when the controller is operating in a public place. It can also prevent unauthorised adjustment of the cabinet temperature.

Press briefly 'i set', then use either '🌞 ⏪' or '⏩ 🌞' to select 'Loc'. While holding 'i set', use either '🌞 ⏪' or '⏩ 🌞' to change from a '45', to 'no'.
Leave for 10 seconds or briefly press '🔌' to resume.

Cleaning and Maintenance

Important: Before cleaning, the unit should be put into standby and then the power supply should be turned off at the mains. Please do not plug or unplug the unit with wet hands. Only when cleaning has been completed and the unit is dry should the counter be turned back on at the mains.

Suitable P.P.E (Personnel Protective Equipment) should be worn at all times.

Regular Maintenance:

> As and when required remove all product from the unit. Clean exterior and interior surfaces with mild liquid detergent, following the directions on the pack at all times. Rinse surfaces with a damp cloth containing clean water. Never use wire wool, scouring pads/powders or high alkaline cleaning agents i.e bleaches, acids and chlorines as these may cause damage.

> Bin Removal

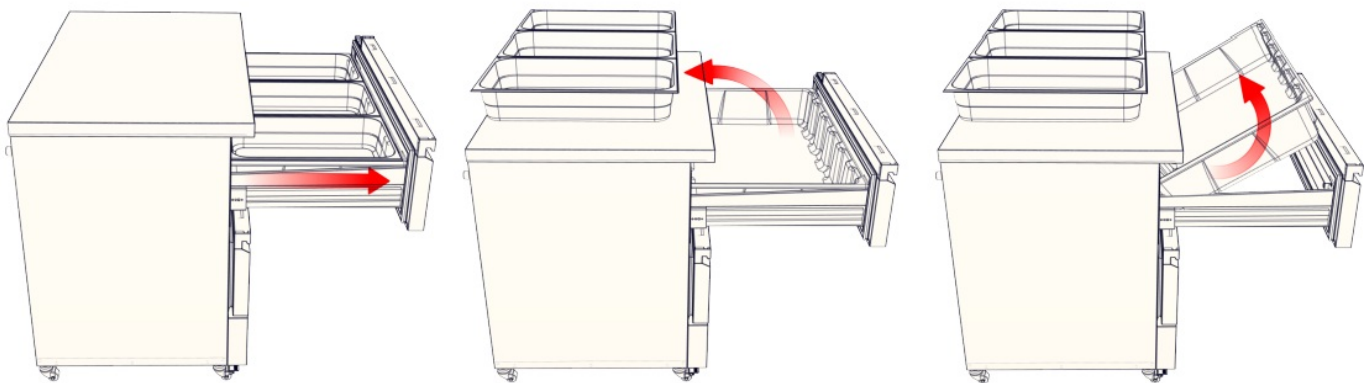

> Condenser Cleaning:

This should take place on a regular basis (4 to 6 weeks) or as and when required only by your supplier (this is normally chargeable). Failure to maintain the condenser may invalidate the warranty of the condensing unit and cause premature failure of the motor/compressor.

> All gaskets should be inspected on a regular basis and replaced if damaged. To clean, wipe with a warm damp soapy cloth followed by a clean damp cloth. Finally thoroughly dry.

> Drawers and their bins should be removed to clean. All should be cleaned with warm soapy water then rinsed and dried before refitting to the counter.

> If fitted, the overshelf should be wiped down regularly with warm soapy water, rinsed and then dried as a worktop would be.

> If fitted, the can opener should be maintained as any other kitchen utensil, be aware of possible sharp parts when carrying out maintenance on this part.

Before calling your supplier please make sure that:

- None of the plugs have come out of the socket and the mains power supply is on i.e. are the controller displays illuminated?
- The unit is not in standby
- The fuse has not blown
- The counter is positioned correctly – controllable cold or warm air sources are not affecting the performance
- The condenser is not blocked or dirty
- The products are placed in the unit correctly
- Defrost is not in progress or required
- The temperature is set to the desired set point for either fridge or freezer temperatures.

If the reason for the malfunction cannot be identified, disconnect the electrical supply to the unit and contact your supplier. When requesting a service call, please quote the model and serial number which can be found on the silver label located on the outside right hand side of the unit (starts E.....).



By Appointment to
Her Majesty Queen Elizabeth II
Suppliers of Commercial Refrigeration
Foster Refrigerator, King's Lynn
00-570148 November 2019 Issue 4
A Division of ITW Ltd
UK Head Office
Foster Refrigerator
Oldmedow Road
Kings Lynn
Norfolk
PE30 4JU
a Division of ITW (UK) Ltd
Tel: +44 (0)1553 691 122
Email: support@foster-gamko.com
Website: www.fosterrefrigerator.co.uk

Documents / Resources



[FOSTER FD2-10 Controller and LCD5S Display](#) [pdf] User Manual
FD2-10 Controller and LCD5S Display, FD2-10, Controller and LCD5S Display, LCD5S Display, Display

References

- [Gamko Are The Experts in Professional Drinks Cooling](#)