



Fosco Connect F1-8525, F1-8520 D Shape Threaded Adapter Owner's Manual

[Home](#) » [Fosco Connect](#) » Fosco Connect F1-8525, F1-8520 D Shape Threaded Adapter Owner's Manual 

Contents

- [1 Fosco Connect F1-8525, F1-8520 D Shape Threaded Adapter](#)
- [2 Product Information](#)
- [3 Product Usage Instructions](#)
- [4 D-Shape threaded Adapter](#)
- [5 Features](#)
- [6 SPECIFICATIONS](#)
- [7 RECOMMENDED PANEL HOLE](#)
- [8 Documents / Resources](#)
 - [8.1 References](#)
- [9 Related Posts](#)



Fosco Connect F1-8525, F1-8520 D Shape Threaded Adapter



Product Information

Specifications

- **Key Width:** D-Shape Threaded Adapter
- **Features:**
 - Optical Characteristics (Typical Insertion Loss at 1310nm):
 - Singlemode: PC – 0.10 dB, APC – 0.10 dB
 - Multimode: 0.25 dB
 - Materials:
 - Body: Nickel plated brass
 - Dust Cap: Vinyl
 - Sleeve: Zirconia or Phosphor Bronze
 - Hexagonal Nut: Nickel plated brass
 - Washer: Nickel plated brass
 - Part Numbers:
 - F1-8525 – APC
 - F1-8520 – PC

Product Usage Instructions

Installation

1. Ensure the panel hole matches the recommended panel hole size.
2. Insert the D-Shape Threaded Adapter into the panel hole securely.
3. Verify that the adapter is properly seated and secured in place.

Maintenance

To maintain optimal performance, periodically clean the adapter components using a lint-free cloth and appropriate cleaning solution recommended for optical components.

Storage

When not in use, store the adapter in a dry and dust-free environment to prevent contamination and damage to the optical surfaces.

FAQ (Frequently Asked Questions)

- **Q: Can this adapter be used for both singlemode and multimode applications?**

A: Yes, this adapter can be used for both singlemode and multimode applications. Ensure proper alignment and compatibility with your fiber optic components.
- **Q: What is the recommended cleaning procedure for this adapter?**

A: Use a lint-free cloth and an appropriate optical cleaning solution to gently wipe the adapter components. Avoid using harsh chemicals or abrasive materials that may damage the optical surfaces.

D-Shape threaded adapter

Key Width:

- PC: 2.18 ± 0.02
- APC: 2.05 ± 0.02

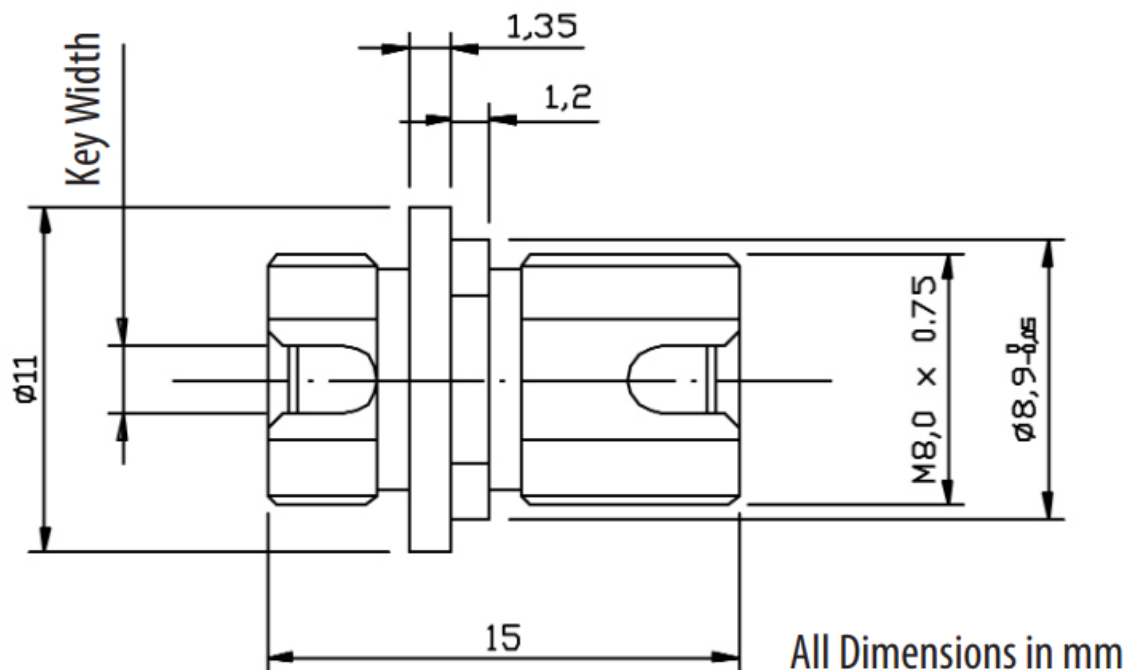

Features

- Compliant with NTT, EIA / TIA specifications
- Low insertion loss
- Compact and lightweight
- Easy installation on panels
- Perfect durability
- Precision alignment straight split sleeves

APPLICATION

- Telecommunications
- Local area network
- Fiber optic instruments
- Testing optical devices

SPECIFICATIONS

Optical Characteristics

- (Typical Insertion Loss at 1310nm) Singlemode Multimode
- PC 0.10 dB 0.25 dB
- APC 0.10 dB

Mechanical Characteristics

- Materials 303 Stainless Steel
- Operating Temperature (°C) .Min -20° Typ. + 25° Max +60

Materials

- Body Nickel plated brass
- Dust Cap Vinyl
- Sleeve Zirconia or Phosphor Bronze
- Hexagonal Nut Nickel plated brass
- Washer Nickel plated brass

Part Number

- F1-8525 – APC
- F1-8520 – PC

RECOMMENDED PANEL HOLE

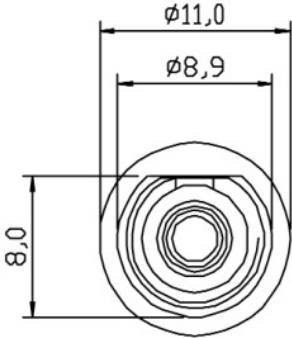
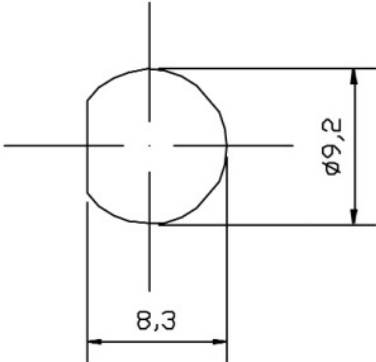
Model	Flange	Recommended Panel Hole
FC D-Shape		

Documents / Resources

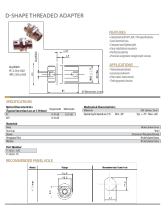
	<p>Fosco Connect F1-8525, F1-8520 D Shape Threaded Adapter [pdf] Owner's Manual F1-8525, F1-8520, F1-8525 F1-8520 D Shape Threaded Adapter, F1-8525 F1-8520, D Shape T hreaded Adapter, Threaded Adapter, Adapter</p>
-------------------------------------------------------------------------------------	-----------------------------------------------------------------------------------------------------------------------------------------------------------------------------------------------------------------------------------------------

References

- [User Manual](#)

This website is an independent publication and is neither affiliated with nor endorsed by any of the trademark owners. The "Bluetooth®" word mark and logos are registered trademarks owned by Bluetooth SIG, Inc. The "Wi-Fi®" word mark and logos are registered trademarks owned by the Wi-Fi Alliance. Any use of these marks on this website does not imply any affiliation with or endorsement.