

FOSCAM[®]

PD5

Wireless

IP

Camera

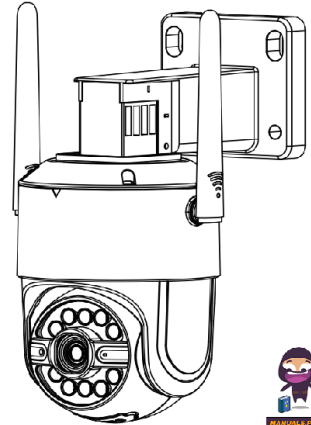

FOSCAM PD5 Wireless IP Camera User Guide

[Home](#) » [FOSCAM](#) » FOSCAM PD5 Wireless IP Camera User Guide 

Contents

- [1 FOSCAM PD5 Wireless IP Camera](#)
- [2 Product Usage Instructions](#)
- [3 FAQ](#)
- [4 Getting Started](#)
- [5 Physical Description](#)
- [6 Setting Up Your Camera](#)
- [7 PC Access Your Camera](#)
- [8 Hardware Installation](#)
- [9 Important Notice](#)
- [10 Product Performance](#)
- [11 FCC Statement](#)
- [12 Documents / Resources](#)
 - [12.1 References](#)

FOSCAM[®]

FOSCAM PD5 Wireless IP Camera

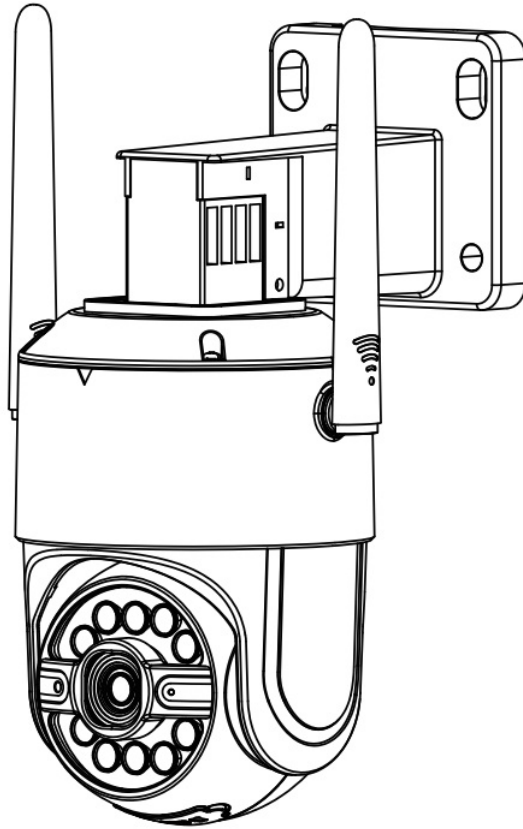

Specifications:

- Model: XXX FHD Wireless IP Camera
- FCC ID: XXXXX IC: 12558A-XX
- S/N: FIAI1403000001
- UID: XXXXXXXXXXXX
- System Requirements:
 - iOS: version 11 or higher
 - Android: 5.0 or higher, using a device with a Graphics Processing Unit (GPU)

Product Usage Instructions

Getting Started

Package Contents:

- IP Camera
- Waterproof Lid Power Adapter
- Mounting Template
- Network Cable
- Expansion Screws

Physical Description

The product features:

- Antenna
- Microphone
- LED Indicator
- Spotlight & Infrared LED Light Sensor
- Reset button
- LAN Port
- Power Port
- Micro SD Card Slot
- Speaker

Note: Ensure cords are kept out of reach of children to prevent strangulation hazards.

Setting Up Your Camera:

Connection via the Foscam App (Recommended)

Before You Get Started:

1. Scan the QR code to download and install the Foscam APP.
2. If you didn't hear the voice prompt, press and hold reset for about 3~5 seconds to reset the camera.
3. Ensure your smartphone is connected to your WiFi router and Bluetooth is turned on.

WiFi Connection:

1. Plug the power adapter into the camera and wait for the "Ready for WiFi configuration" prompt.
2. Open the Foscam APP, register or sign in to your account.
3. Scan the QR code on the device to add the camera.
4. Follow on-screen instructions for WiFi configuration, keeping the device close to the router.
5. Name your device for easy identification.

PC Access Your Camera

Foscam VMS:

Foscam VMS is a tool for PCs compatible with Windows & Mac, supporting all Foscam HD cameras and up to 36 cameras simultaneously. Download the Windows version from foscam.com/vms or the Mac version from the APP store: <https://apps.apple.com/cn/app/foscamvms/id1521202507?mt=12>

FAQ

- **Q: How do I reset the camera?**
 - **A:** Press and hold the reset button for about 3~5 seconds to reset the camera.
- **Q: What are the system requirements for the Foscam APP?**
 - **A:** For iOS, version 11 or higher is required. For Android, version 5.0 or higher with a GPU is recommended.

To view this guide in other languages (e.g. Nederlands, Deutsch, Français, Español), and for detailed manuals, tools, etc., please visit foscam.com/downloads

Getting Started

Package Contents

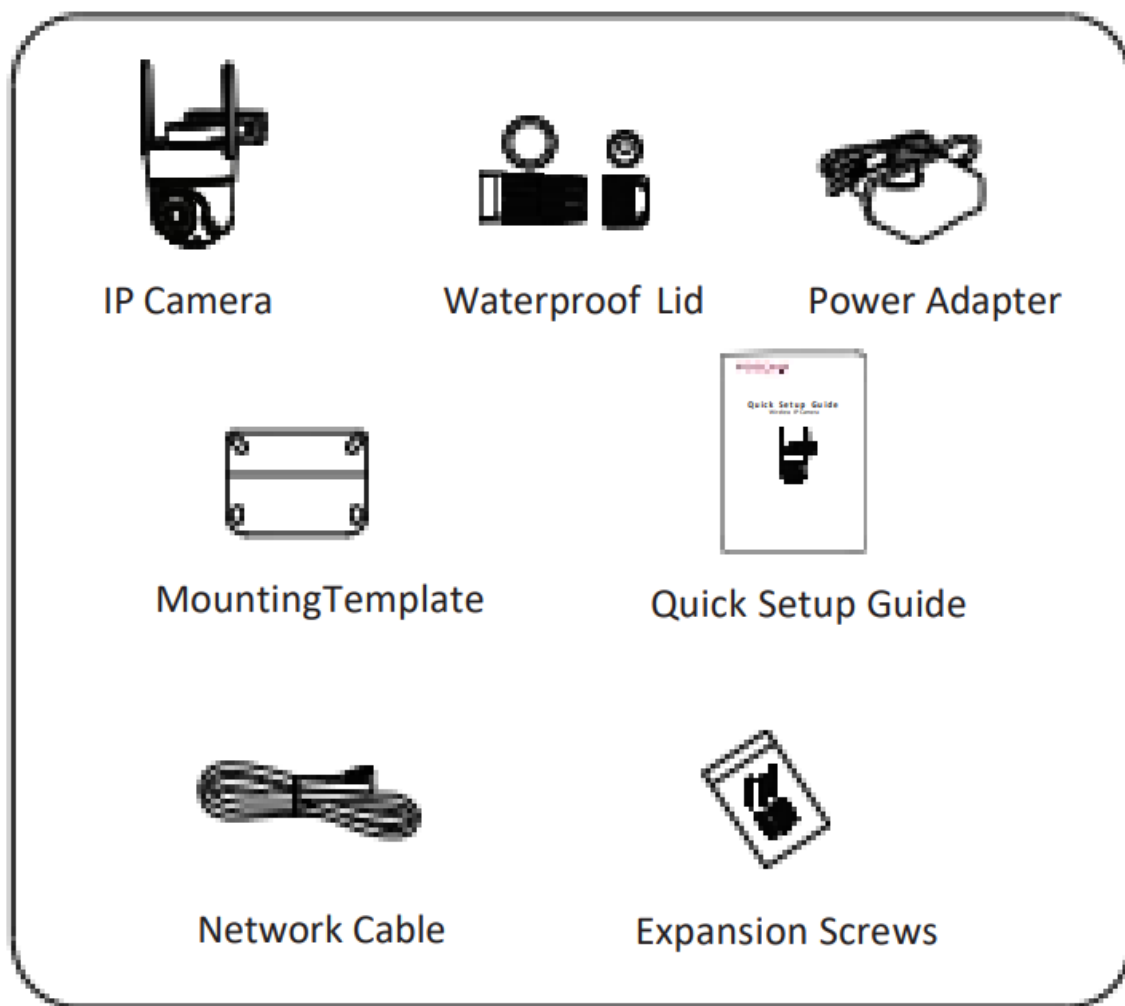

Security Tips

- Please change the camera's password regularly, using a combination of numbers, letters and special characters.
- We recommend that you regularly update your camera with the latest available software and firmware to ensure the best experience with your camera.
- Please ensure that the proper power supply is used before using the camera.
- Do not use the device where wireless devices are not allowed.
- Do not disassemble, repair or modify the product.
- Do not use the product if the casing has been broken. The danger of electric shock.
- Please install the camera securely using the screws provided.
- Change your default port to a greater range to help ensure the safety of your connection.
- To avoid the risk of fire or electric shock, please keep your camera connectors in a cool, dry place
- Please keep the camera out of reach of small children.
- Operating Temperature: 0°C ~40°C (-4°F ~113°F).

Physical Description

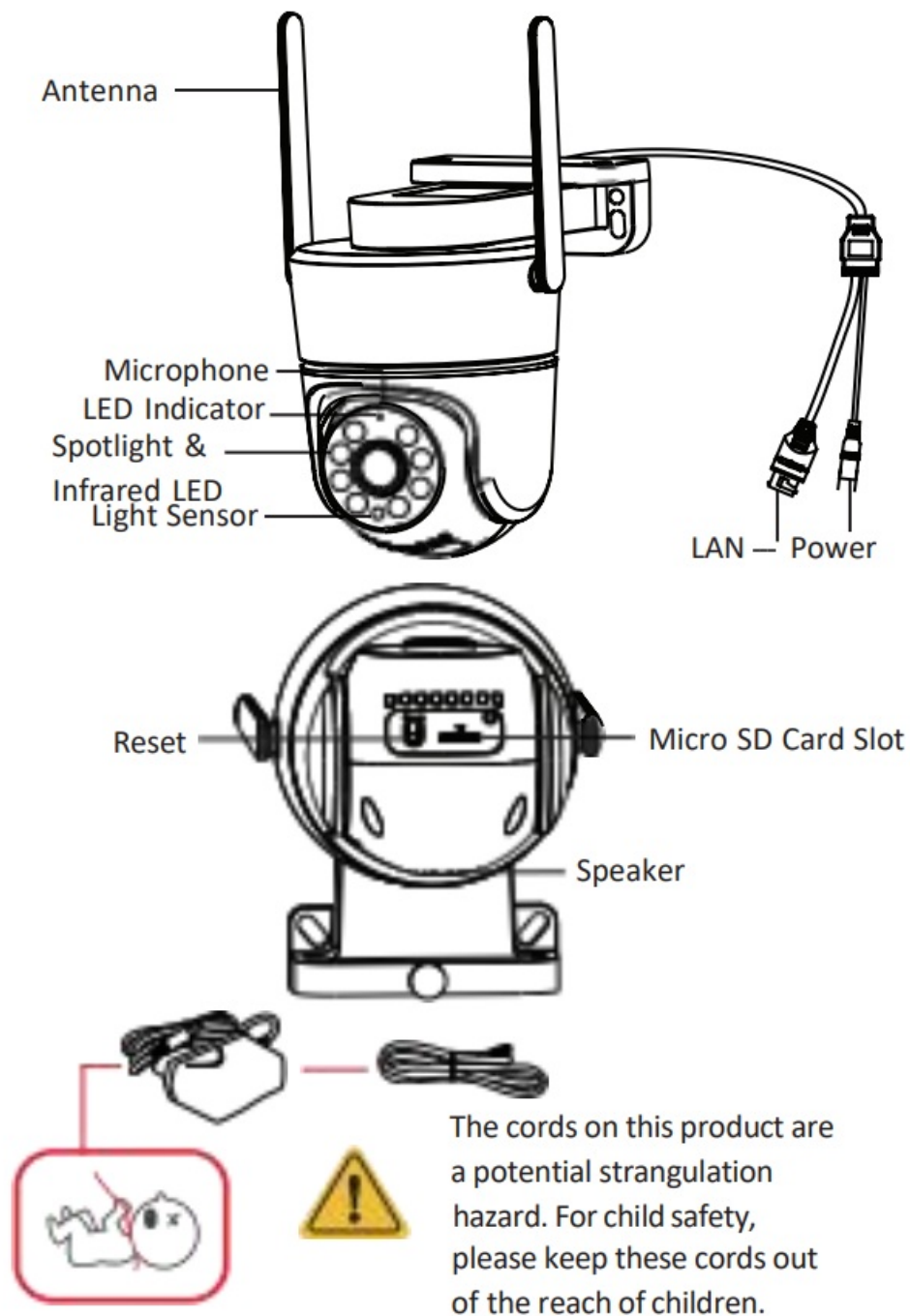

Setting Up Your Camera

Connection via the Foscam App (Recommended)

Before You Get Started

Scan the QR code below to download and install the Foscam APP.



To ensure a smoother video experience on your smartphone, it is recommended that your smartphone meet the following specifications:

- iOS: version 11 or higher.
- Android: 5.0 or higher, using a device with a Graphics Processing Unit (GPU).

Note: For the best experience, please update the APP to the latest version!

WiFi Connection

1. Plug the power adapter into the camera, and please wait for a few seconds until hearing the “Ready for WiFi configuration”



Tips: If you didn't hear the voice prompt, press and hold reset for about 3~5 seconds to reset the camera.

2. Make sure that your smartphone is connected to your WiFi router and turn on the system Bluetooth

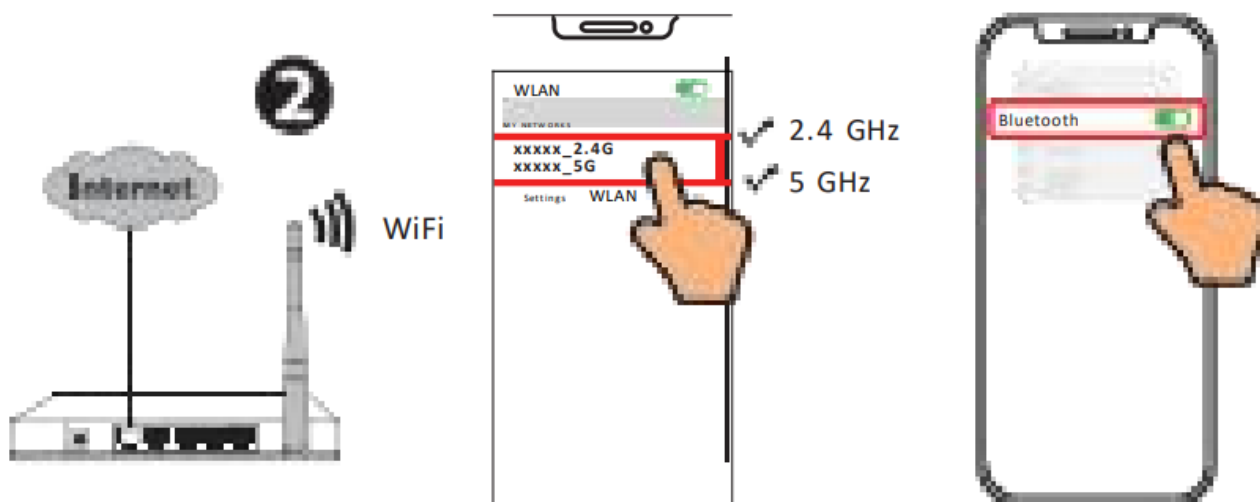

Note: Before connecting the camera via Bluetooth, ensure that the system's Bluetooth is turned on.

3. Open the Foscam APP and please register a Foscam account, or sign in if you have one already

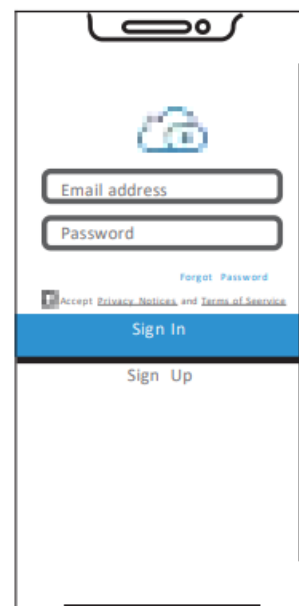

4. Follow the steps below:

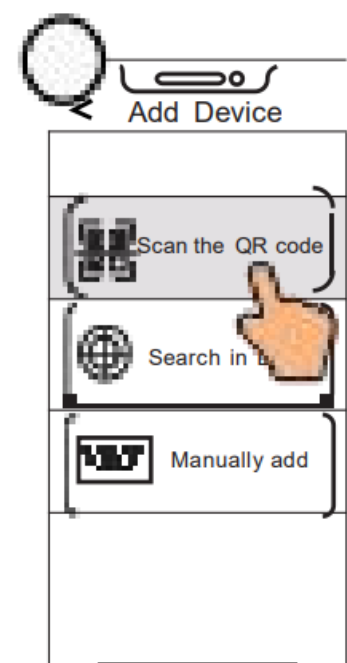
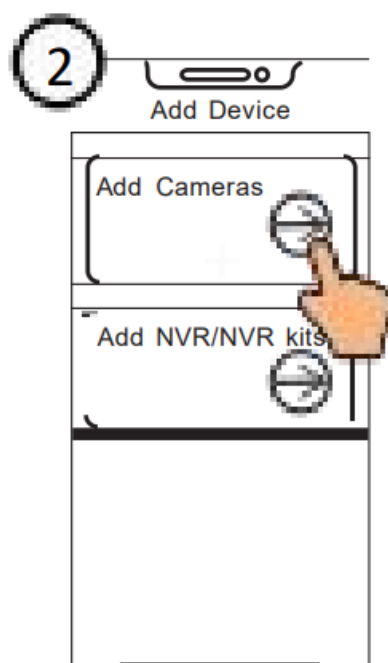
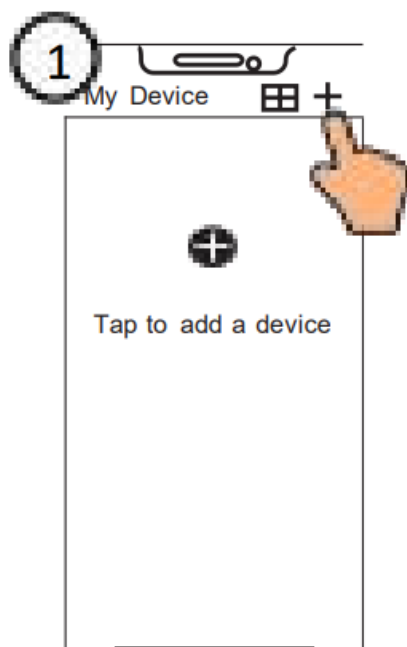

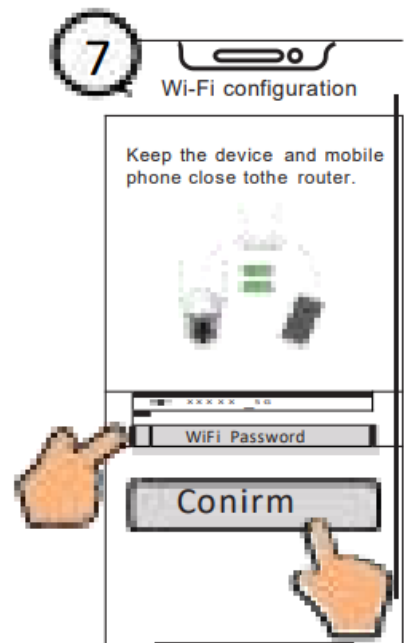
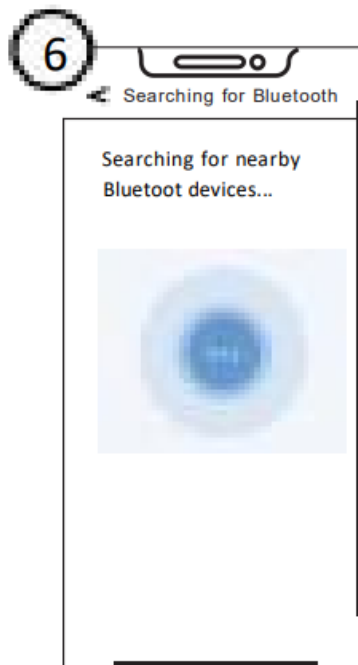
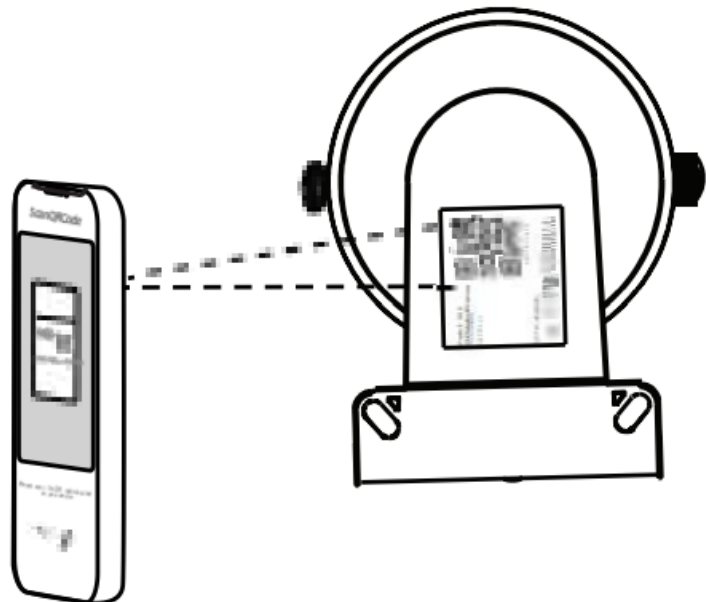

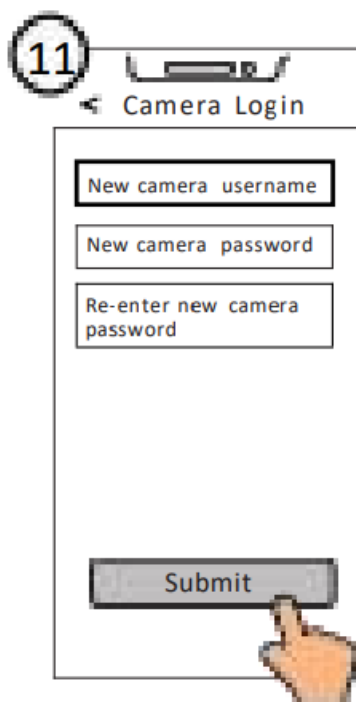
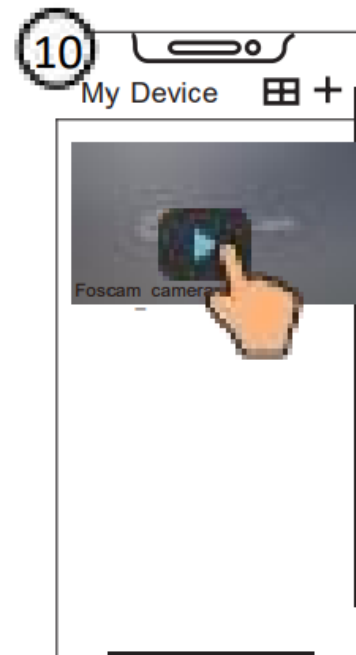
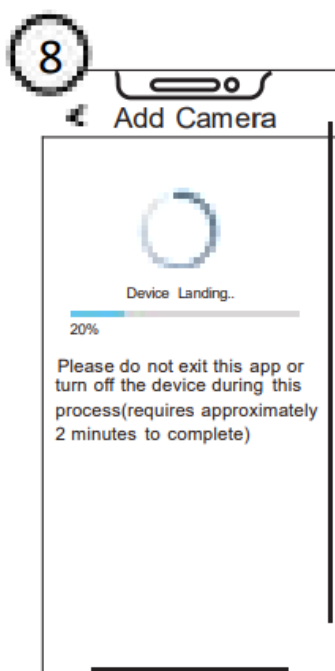

Note: If the adding process fails, please reset your camera and try adding again according to the above method.

PC Access Your Camera



Foscam VMS

Foscam VMS is a new tool for PCs. It does not require plug-ins and is compatible with Windows & Mac, supporting all Foscam HD cameras and up to 36 cameras at the same time. If you would like to manage multiple cameras, we suggest you install Foscam VMS. You can download the “Foscam VMS” Windows version from foscam.com/vms, and can download the “Foscam VMS” Mac version from the APP store:

<https://apps.apple.com/cn/app/foscamvms/id1521202507?mt=12>

Note: For the best experience, please update Foscam VMS to the latest version!

Add the IP Camera

1. Run Foscam VMS, then create a local administrator account or a Foscam account and login.
2. Tap the “+” icon on the Foscam VMS and follow the setup wizard to add your camera.

Please visit foscam.com/downloads to view the user manual and for additional detailed steps.



Hardware Installation

Method A: Wall mounted

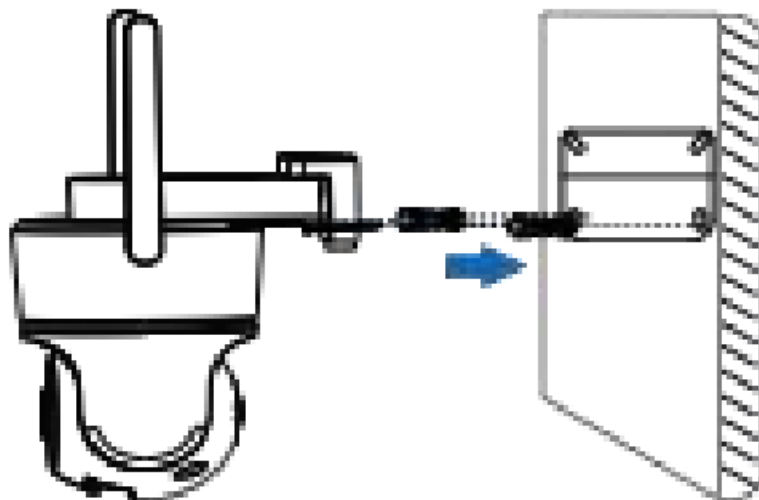

Method B: Ceiling mounted

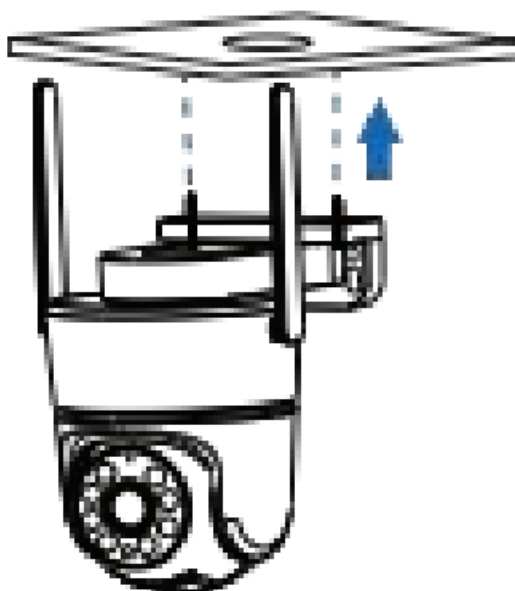

Point the camera at the desired location and use the screws provided to mount it.

Please Note:

Ensure that the rain or water will not reach the connector ports at the end of the pigtail wiring. These connectors are not weather-resistant.

Important Notice

Camera Username & Password

The camera username & password are used to access and manage your camera. Having a strong password can significantly improve the security of your camera. If you have forgotten either of them, please press the “Reset” button

- Press and hold the “Reset” button for 3-5 seconds until hearing “reset succeed”.



Storage Media

Your camera supports cloud, NVR (Network Video Recorder), and Micro SD card (supports FAT32 and exFAT format) storage formats



cloud Storage



NVR



Micro SD card
(FAT32 & exFAT)

How to format MicroSD card, please follow the steps below:

1



2



3



4 Scan the QR code below to download the "FoscamFormat "Tool



- foscam.com/downloads/app-software.html

5 Open the "FoscamFormat" Tool

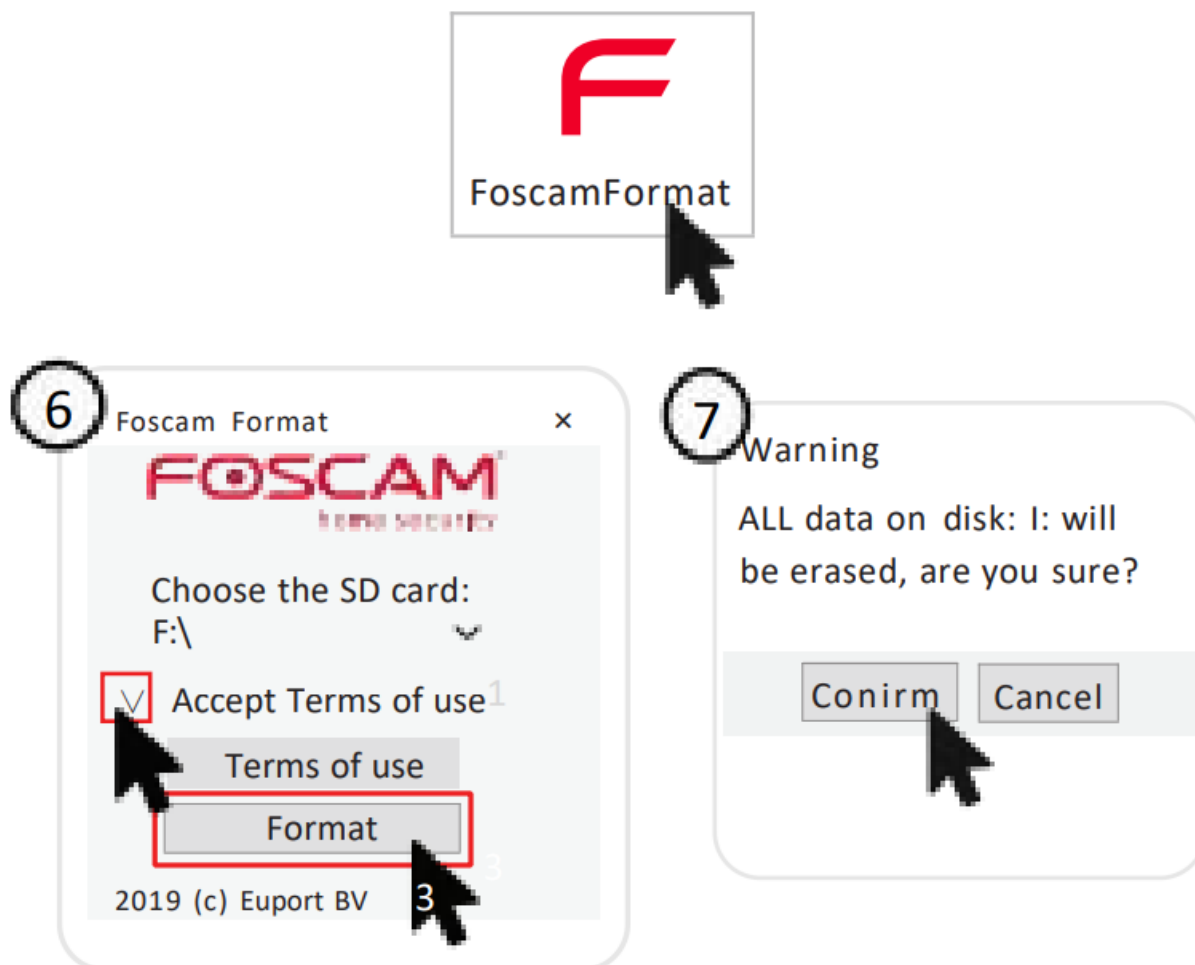

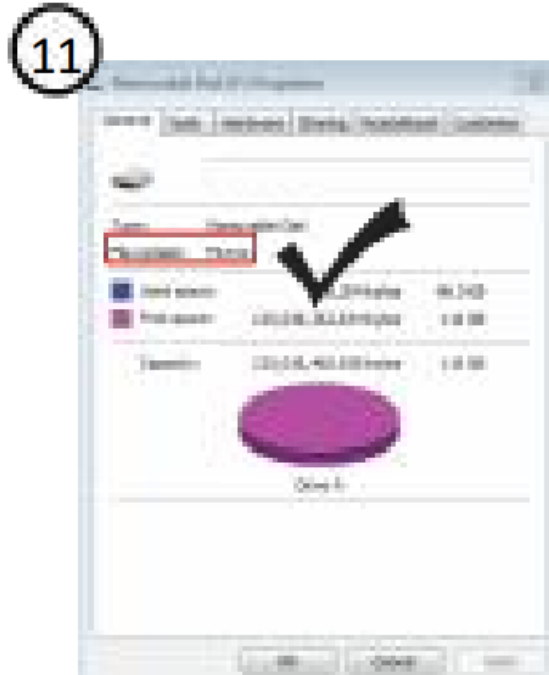
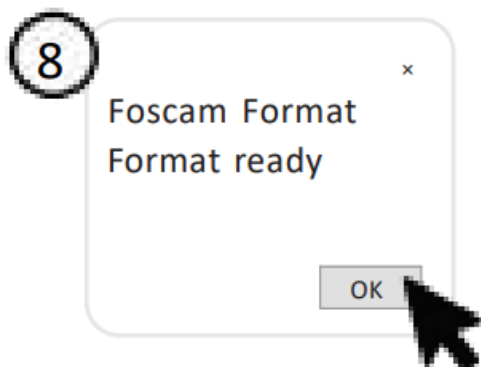

Product Performance

- WLAN frequency range: 2400MHz – 2483.5MHz and 5725MHz – 5850MHz
- Maximum transmission power: < 18dBm
- Wireless Standard: IEEE802.11b/g/n/ax (2.4GHz) IEEE802.11a/n/ac/ax (5GHz)
- Power Supply: DC 12V 1.0A 12W

FCC Statement

To assure continued compliance, any changes or modifications not expressly approved by the party. Responsible for compliance could void the user's authority to operate this equipment.

This equipment complies with Part 15 of the FCC Rules. Operation is subject to the following two conditions:

1. This device may not cause harmful interference, and
2. This device must accept any interference received, including interference that may cause undesired operation.

NOTE: This equipment has been tested and found to comply with the limits for a Class B digital device, pursuant to part 15 of the FCC rules.

These limits are designed to provide reasonable protection against harmful interference in a residential installation. This equipment generates, uses and can radiate radio frequency energy and, if not installed and used in

accordance with the instructions, may cause harmful interference to radio communications. However, there is no guarantee that interference will not occur in a particular installation. If this equipment does cause harmful interference to radio or television reception, which can be determined by turning the equipment off and on, the user is encouraged to try to correct the interference by one or more of the following measures:

- Reorient or relocate the receiving antenna.
- Increase the separation between the equipment and the receiver.
- Connect the equipment into an outlet on a circuit different from that to which the receiver is connected.
- Consult the dealer or an experienced radio/TV technician for help.

FCC Radiation Exposure Statement:

The equipment complies with FCC Radiation exposure limits set forth for uncontrolled environments. This equipment should be installed and operated with minimum distance 20cm between the radiator and your body.

- CE Certificate statement Website:
- <https://www.foscam.com/company/ce-certificate.html>
- Exporter and Importer Information Opened to Public:
- <https://www.foscam.com/company/open-information.html>
- Manufacturer: Shenzhen Foscam Intelligent Technology Co., Ltd
- Addr: Room 902, Building 1B, Shenzhen International Innovation Valley, Xingke 1st Street, Nanshan District, Shenzhen, Guangdong, China, 518055



FAQS



Foscam APP



Facebook

www.foscam.com

Due to product upgrades and other reasons, this guide may be slow to update, resulting in slight inconsistencies with the official website information. Please take the official website (www.foscam.com) information as the current standard.

Documents / Resources

	FOSCAM PD5 Wireless IP Camera [pdf] User Guide PD5, PD5 Wireless IP Camera, Wireless IP Camera, IP Camera, Camera
---	--

References

- [Foscam Support - FAQs](#)
- [Foscam Official Website - Security Cameras, NVRs, Baby Monitors, IP Cameras, NVR Kits, Security](#)

[Kit, Pet Monitors, Cloud Storage Service](#)

- [!\[\]\(cd3e54d951a9fb854f48e4697cf550f9_img.jpg\) Foscam Support - FAQs](#)
- [!\[\]\(cc729e263f29c0a76fbdc4cfe67fceb0_img.jpg\) Foscam Official Website - Security Cameras, NVRs, Baby Monitors, IP Cameras, NVR Kits, Security Kit, Pet Monitors, Cloud Storage Service](#)
- [!\[\]\(90d36d418f8f7ab67431ba2525e00a5e_img.jpg\) Foscam Open-Information System](#)
- [User Manual](#)

[Manuals+, Privacy Policy](#)

This website is an independent publication and is neither affiliated with nor endorsed by any of the trademark owners. The "Bluetooth®" word mark and logos are registered trademarks owned by Bluetooth SIG, Inc. The "Wi-Fi®" word mark and logos are registered trademarks owned by the Wi-Fi Alliance. Any use of these marks on this website does not imply any affiliation with or endorsement.