



FORTIN Universal All In One CAN Bus Data Interface And Transponder Immobilizer Bypass Module Installation Guide

[Home](#) » [FORTIN](#) » FORTIN Universal All In One CAN Bus Data Interface And Transponder Immobilizer Bypass Module Installation Guide 



REV.: 20211101

Guide # 63971

STAND ALONE & THAR-CHR5 INSTALLATION

ADDENDUM – SUGGESTED WIRING CONFIGURATION

Contents

- [1 Universal All In One CAN Bus Data Interface And Transponder Immobilizer Bypass Module](#)
- [2 PARTS REQUIRED \(NOT INCLUDED\)](#)
- [3 STAND ALONE CONFIGURATION](#)
- [4 REMOTE STARTER FUNCTIONALITY](#)
- [5 AUTOMATIC TRANSMISSION WIRING CONNECTION](#)
- [6 PROGRAMMING PROCEDURE](#)
- [7 KEY BYPASS PROGRAMMING PROCEDURE 2/2](#)
- [8 REMOTE STARTER FUNCTIONALITY](#)
- [9 Documents / Resources](#)
 - [9.1 References](#)

Universal All In One CAN Bus Data Interface And Transponder Immobilizer Bypass Module



ONLY COMPATIBLE WITH AUTOMATIC TRANSMISSION VEHICLES.

Vehicle functions supported in this diagram (functional if equipped)

YEAR S	Immo bilizer bypas s	Lock	Unloc k	Arm	Disar m	Parkin g Ligh ts	Tacho meter	Door Status	Trunk Status	Hand- Brake Status	Foot- Brake Status	OEM Remot e monito ring
2007	•	•	•	•	•	•	•	•	•	•	•	•



FIRMWARE VERSION
VERSION LOGICIELLE
74.[39] MINIMUM

To add the firmware version and the options, use the FLASH LINK UPDATER or FLASH LINK MOBILE tool, sold separately.



Program bypass option IF THE VEHICLE IS NOT EQUIPPED WITH FUNCTIONAL HOOD PIN:

UNIT OPTION	DESCRIPTION
A11 	Hood trigger (Output Status).
C1	OEM Remote status (Lock/Unlock) monitoring
D2	Unlock before / Lock after (Disarm OEM alarm)

Parts required (Not included)

WIRE TO WIRE DIAGRAM

1x 7.5 Amp. use

1x Relay (Parking Lights)

THARNESSE DIAGRAM

1x THAR-CHR5

1x Relay (Parking Lights)

MANDATORY INSTALL

* HOOD PIN



HOOD STATUS: THE HOOD PIN SWITCH MUST BE INSTALLED IF THE VEHICLE CAN BE REMOTE STARTED WITH THE HOOD OPEN, SET FUNCTION A11 TO OFF.

A11

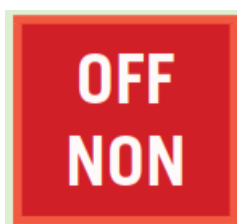

Notice: the installation of safety elements are mandatory. The hood pin is an essential security element and must be installed.

THIS MODULE MUST BE INSTALLED BY A QUALIFIED TECHNICIAN. A WRONG CONNECTION CAN CAUSE PERMANENT DAMAGE TO THE VEHICLE.

This guide may change without notice. See www.fortin.ca for latest version.

PARTS REQUIRED (NOT INCLUDED)

1x  FLASH LINK UPDATER,

1x  FLASH LINK MANAGER
SOFTWARE | PROGRAMME

MANDATORY

HOOD PIN

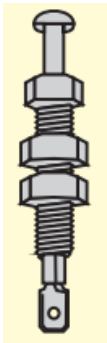

REMOTE START SAFETY OVERRIDE SWITCH

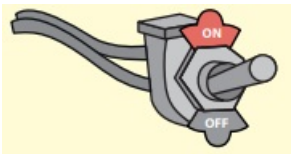

VALET SWITCH COMMUTATEUR VALET

Part #: RSPB available, Sold separately.

Notice: the installation of safety elements are mandatory.
The hood pin and the valet switch are essential security elements and must be installed.

STAND ALONE CONFIGURATION



Program bypass option

OEM Remote Stand Alone Remote Starter:

UNIT OPTION

D1.10	By default, LOCK, LOCK, LOCK
D1.1	LOCK, UNLOCK, LOCK



Program bypass option with oem remote:



UNIT OPTION	DESCRIPTION
C1	OEM Remote Monitoring



Program bypass option with RF KIT antenna:

UNIT OPTION	DESCRIPTION
H1 to H6	Supported RF Kits and select RF Kit

REMOTE STARTER FUNCTIONALITY

		
All doors must be closed.	Press the OEM remote's Lock button 3x to remote-start (or remote-stop) the vehicle.	The vehicle will START.

REMOTE STARTER DIAGNOSTICS

x2 flash :	Brake ON
x3 flash :	No tach
x4 flash :	Ignition before start
x5 flash :	Hood Open

REMOTE STARTER WARNING CARD



CUT THIS WARNING CARD AND STICK IT ON A VISIBLE PLACE: or use the package RSPB, Sold separately.

WARNING



THE VEHICLE CAN BE STARTED BY EITHER: PRESSING THE LOCK BUTTON ON THE OEM REMOTE 3 TIMES CONSECUTIVELY OR BY A SMARTPHONE. TURN ON THE SAFETY SWITCH LOCATED UNDER THE DASHBOARD BEFORE WORKING ON THE VEHICLE.

AUTOMATIC TRANSMISSION WIRING CONNECTION

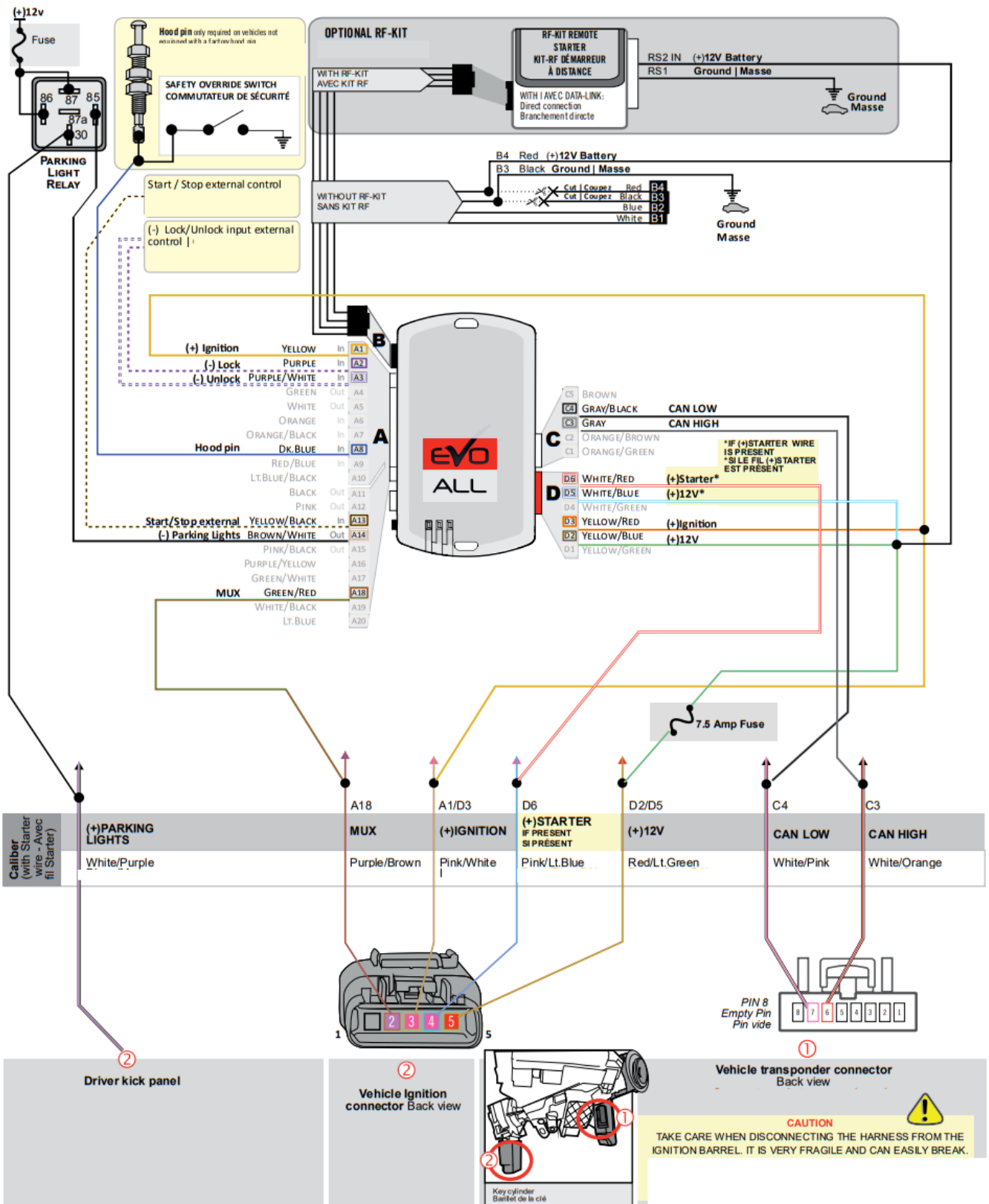

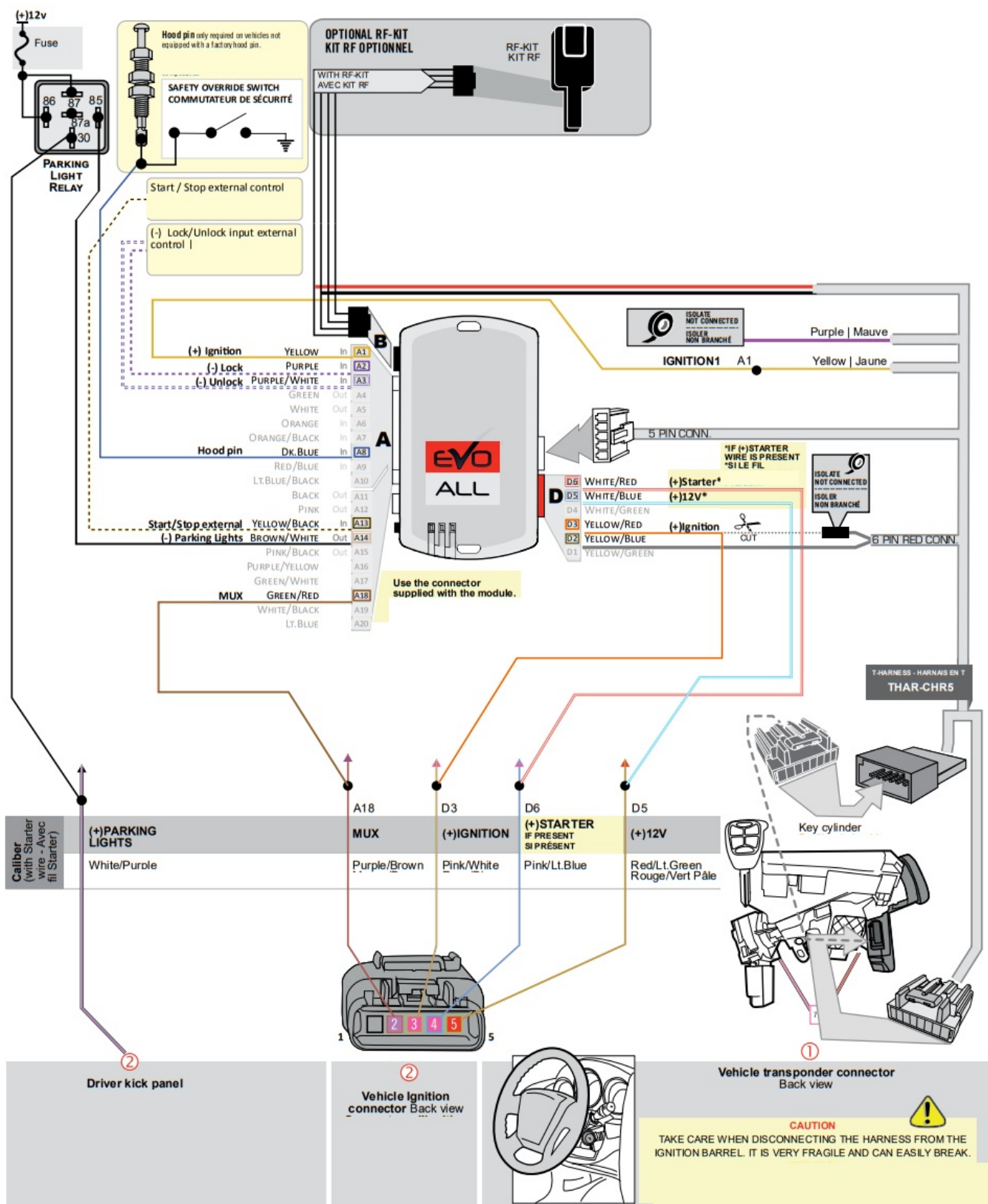

PROGRAMMING PROCEDURE

BEFORE PROGRAMMING SET THE UNIT OPTIONS AND SAVE.

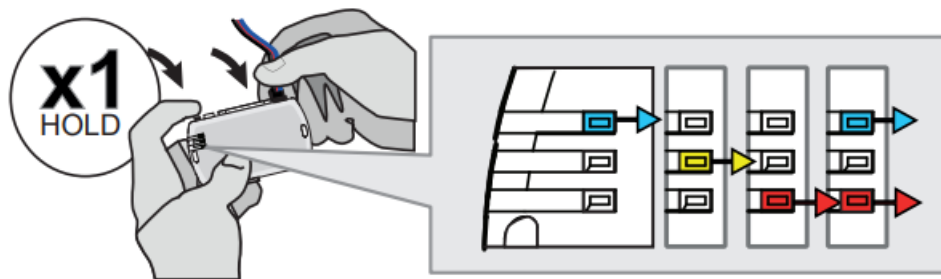

Press and hold the programming button:
Connect the 4-PIN Data-link connector.
The BLUE, RED, YELLOW and BLUE & RED LEDs will alternatively illuminate.

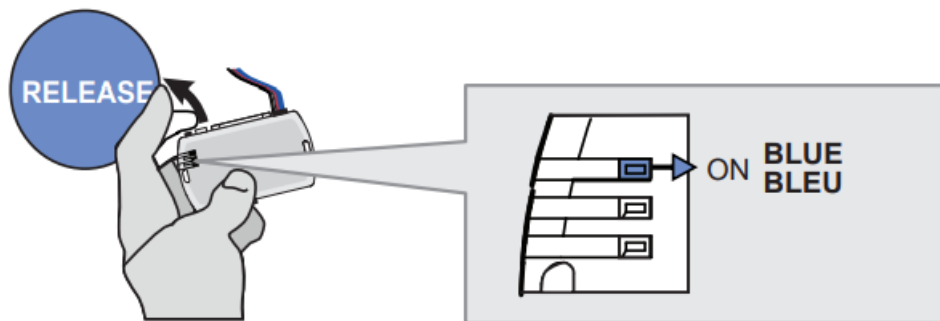

Release the programming button when the LED is BLUE.
If the LED is not solid BLUE disconnect the 4-Pin connector (Data-Link) and go back to step 1.

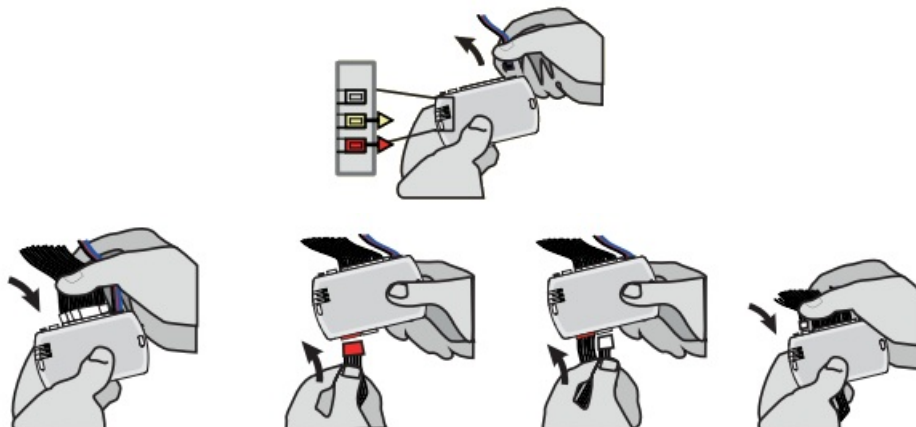

Insert the required remaining connectors.

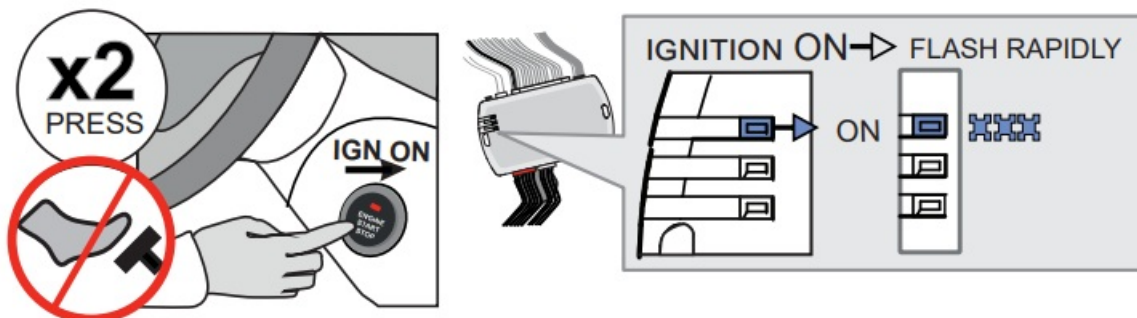

Do not press the brake pedal.
Press the Push-to-Start button twice to turn on the ignition.
Wait for the BLUE LED to flash rapidly and constantly.

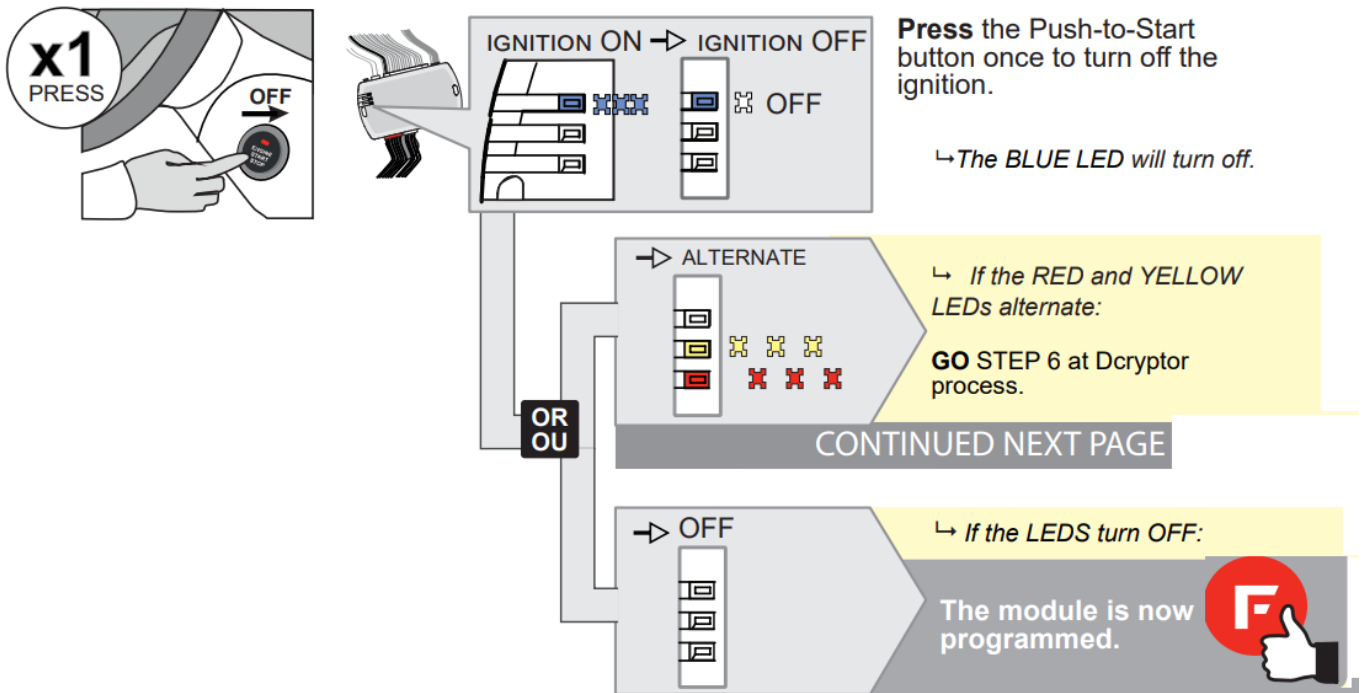

KEY BYPASS PROGRAMMING PROCEDURE 2/2

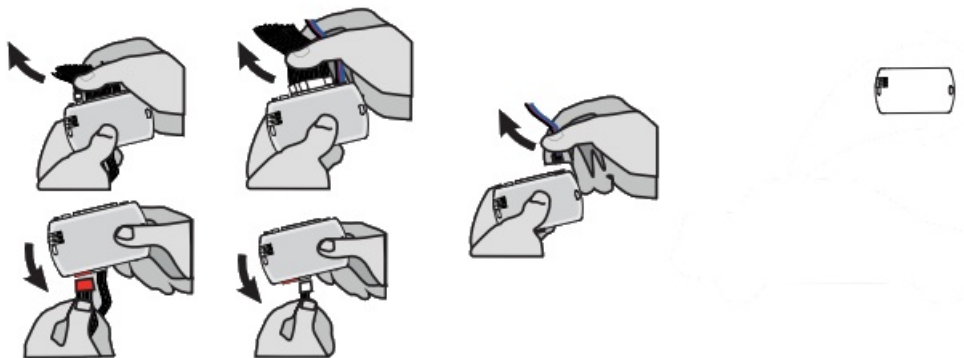

Disconnect all the connectors and after the Data-Link (4-pins) connector.



Microsoft Windows Computer with Internet connection*

Use the tool:

FLASH LINK UPDATER or FLASH LINK MOBILE to visit the DCryptor menu.

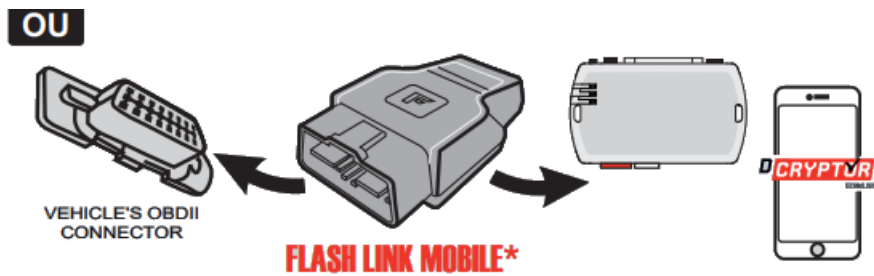

Smartphone*
(Internet provider charges may apply)

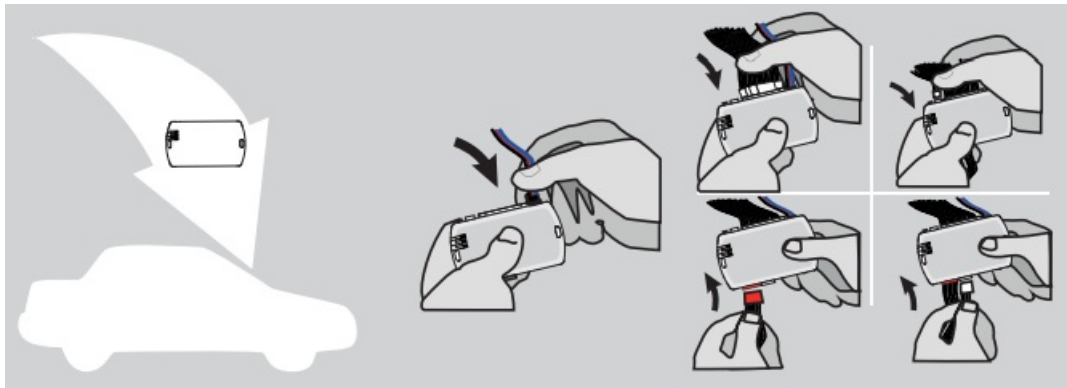

AFTER DCRYPTOR PROGRAMMING COMPLETED

Go back to the vehicle and reconnect the 4-Pin (Data-Link) connector and after, all the remaining connector.



The module is now programmed.



REMOTE STARTER

PROCEDURE

Test the remote starter. Remote start the vehicle.

OPTIONAL RF-KIT PROGRAMMING

PROGRAM BYPASS OPTION



Program bypass option:

H2

- ☒ Supported RF-KITS enable
- ☒ H2 Fortin 2

OPTIONAL FORTIN RF KIT SERIES 4 OR SERIES 9 PROGRAMMING



The module must be programmed on the vehicle.

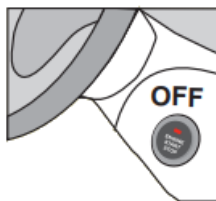

MAKE SURE THE IGNITION KEY HAS BEEN IN THE OFF POSITION FOR AT LEAST 5SECONDS.



Do not press the brake pedal.
Press twice the to turn on the ignition.



Press the Push-to-Start button once to turn off the ignition.



Do not press the brake pedal.
Press twice the to turn on the ignition.

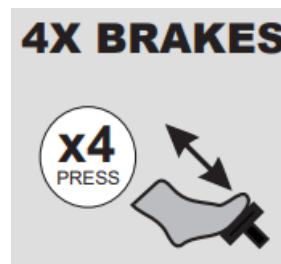

Press and release the brake pedal four times.

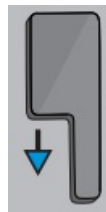

The LED will turn ON solide.

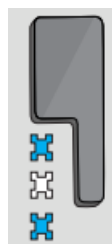

The LED will turn off each time.

ON EACH TRANSMITTER

 PRESS AND RELEASE



 PRESS AND RELEASE

1 BUTTON



PRESS APPROX.

12 SEC. AND WAIT FOR THE BLUE LED TO TURN OFF THEN BACK ON SOLID THEN RELEASE.



The LED will turn off each time.



The YELLOW LED will turn ON solid.

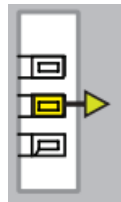

The YELLOW LED will turn Off.



The YELLOW LED will turn ON solid.

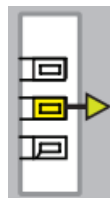

The 3 LED will turn ON solid.



The 3 LED will turn off each time.

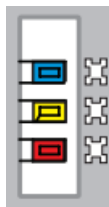

The 3 LED will turn off.

REMOTE STARTER FUNCTIONALITY

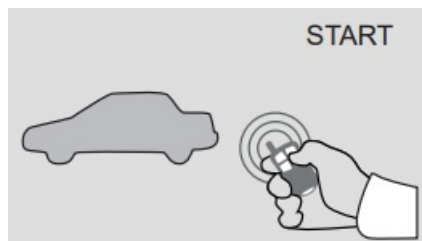

All doors must be closed.
Remote start the vehicle.



Unlock the doors with either:

- The OEM remote
- The remote-starter remote
- Or the proximity remote

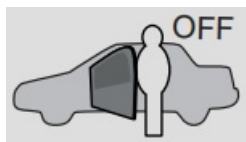

The module will shut down the vehicle as soon as the drivers door is opened.

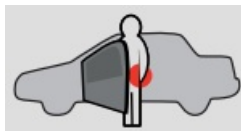

Enter the vehicle with the Smart-Key.



Press the brake pedal.



Press the Push-to-Start button to start the vehicle.



The vehicle can now be put in to gear and driven.

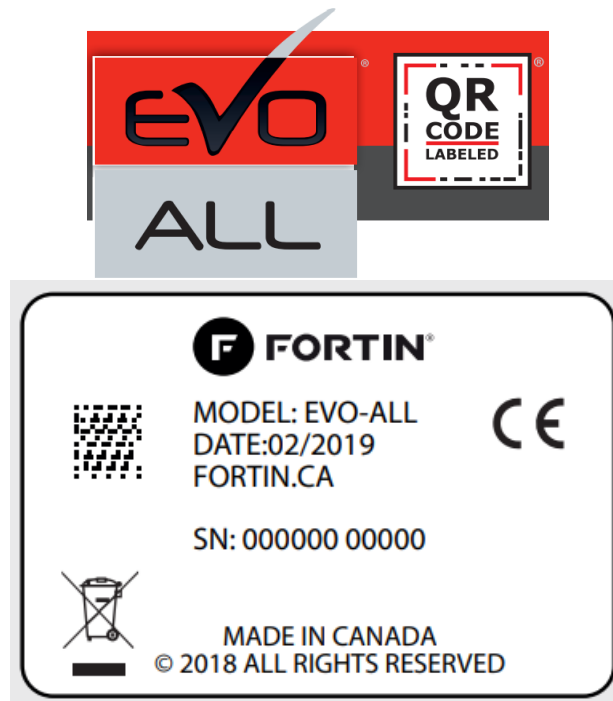

Notice: Updated Firmware and Installation Guides

Updated firmware and installation guides are posted on our web site on a regular basis. We recommend that you update this module to the latest firmware and download the latest installation guide(s) prior to the installation of this product.

WARNING

The information on this sheet is provided on an (as is) basis with no representation or warranty of accuracy whatsoever.

It is the sole responsibility of the installer to check and verify any circuit before connecting to it. Only a computer safe logic probe or digital multimeter should be used. FORTIN ELECTRONIC SYSTEMS assumes absolutely no liability or responsibility whatsoever pertaining to the accuracy or currency of the information supplied. The installation in every case is the sole responsibility of the installer performing the work and FORTIN ELECTRONIC SYSTEMS assumes no liability or responsibility whatsoever resulting from any type of installation, whether performed properly, improperly or any other way. Neither the manufacturer or distributor of this module is responsible of damages of any kind indirectly or directly caused by this module, except for the replacement of this module in case of manufacturing defects. This module must be installed by qualified technician. The information supplied is a guide only. This instruction guide may change without notice. Visit www.fortinbypass.com to get the latest version.



TECH SUPPORT

Tél: 514-255-HELP (4357)

1-877-336-7797



ADDENDUM GUIDE

WEB UPDATE

www.fortinbypass.com

Documents / Resources

	<p>FORTIN Universal All In One CAN Bus Data Interface And Transponder Immobilizer Bypass Module [pdf] Installation Guide</p> <p>Universal All In One CAN Bus Data Interface And Transponder Immobilizer Bypass Module, Universal All In One CAN, Bus Data Interface And Transponder Immobilizer Bypass Module, Transponder Immobilizer Bypass Module, Immobilizer Bypass Module, Bypass Module, Module</p>
---	---

References

- [Fortin Remote Car Starters, Car Alarms, Immobilizer Bypass and Connected Vehicle Solutions | Fortin Electronic Systems](#)
- [Fortin Remote Car Starters, Car Alarms, Immobilizer Bypass and Connected Vehicle Solutions | Fortin Electronic Systems](#)