



FORTIN EVO 107851 High Encrypted Key Immobilizer Bypass Module Installation Guide

[Home](#) » [FORTIN](#) » FORTIN EVO 107851 High Encrypted Key Immobilizer Bypass Module Installation Guide 

Contents

- [1 FORTIN EVO 107851 High Encrypted Key Immobilizer Bypass Module](#)
- [2 Product Information](#)
- [3 Product Usage Instructions](#)
- [4 REGULAR INSTALLATION](#)
- [5 DESCRIPTION](#)
- [6 AUTOMATIC TRANSMISSION WIRING CONNECTION](#)
- [7 MANUAL TRANSMISSION WIRING CONNECTION](#)
- [8 DCRYPTOR PROGRAMMING PROCEDURE](#)
- [9 REMOTE STARTER PROGRAMMING PROCEDURE](#)
- [10 REMOTE STARTER FUNCTIONALITY](#)
- [11 Documents / Resources](#)
 - [11.1 References](#)



FORTIN EVO 107851 High Encrypted Key Immobilizer Bypass Module



Product Information

- **Product Name:** Immobilizer bypass
- **Compatibility:** VEHICLES NISSAN Versa 2022-2023
- **Model:** EVO-ONE
- **Manufactured after:** 2019
- **Firmware Version:** 72.[54] (minimum required)
- **Manufacturer:** FORTIN.CA
- **Serial Number:** 000000 00000



Product Usage Instructions

1. To add firmware version and options, use the FLASH LINK UPDATER or FLASH LINK MOBILE tool (sold separately).
2. Program the bypass option: – If the vehicle is not equipped with a functional hood pin, set A11 to OFF. – If the vehicle can be remote started with the hood open, install the hood pin switch (included) and set A11 to OFF.
3. Program remote starter options: – For automatic transmission mode, cut the loop. – For heated seats, program option 39.
4. Parts required for installation (not included): – 1x Manual transmission: Relay (Trunk release) – HOOD PIN CONTACT (if applicable) – SECURITY STICKER (included)
5. Ensure that this module is installed by a qualified technician to avoid permanent damage to the vehicle.
6. The OEM remote of the vehicle will not be operable during remote start. Note: The provided text extract contains additional technical details and wiring information that may require further consultation with the full user manual for proper installation and usage guidance.

REGULAR INSTALLATION

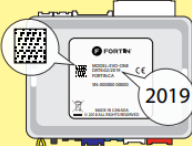
		Vehicle functions supported in this diagram (functional if equipped) Fonctions du véhicule supportées dans ce diagramme (fonctionnelles si équipé)											
VEHICLE VEHICULES	YEARS ANNÉES	Immobilizer bypass	Lock	Unlock	Trunk (open)	RAP shutdown	Rear Defrost (AUX.1)	Tachometer	Door Status	Trunk Status	Hand-Brake Status	Foot-Brake Status	OEM Remote monitoring**
NISSAN													
Versa	2022-2023	•	•	•	•	•	•	•	•	•	•	•	•

	COMPATIBLE MODULE REQUIRED:	QR CODE ON THE LABEL MANUFACTURED AFTER: 2019	FIRMWARE VERSION VERSION LOGICIELLE 72.[54] MINIMUM	To add the firmware version and the options, use the FLASH LINK UPDATER or FLASH LINK MOBILE tool, sold separately. Pour ajouter la version logicielle et les options, utilisez l'outil FLASH LINK UPDATER ou FLASH LINK MOBILE , vendu séparément.
	MODULE COMPATIBLE REQUIS:	CODE QR SUR L'ÉTIQUETTE FABRIQUÉ APRÈS: 2019		

	Program bypass option: Programmez l'option du contournement:	UNIT OPTION OPTION UNITÉ		DESCRIPTION
		C1		OEM Remote status (Lock/Unlock) monitoring Suivi des status (Verrouillage/Déverrouillage) de la télécommande d'origine
	IF THE VEHICLE IS NOT EQUIPPED WITH FUNCTIONAL HOOD PIN: SI LE VÉHICULE N'EST PAS ÉQUIPÉ D'UN CONTACT DE CAPOT FONCTIONNEL:	A11	<div>OFF NON</div>	Hood trigger (Output Status).
				Contact de capot (état de sortie).

	Program remote starter option for AUTOMATIC TRANSMISSION: Programmez l'option démarreur à distance pour TRANSMISSION AUTOMATIQUE:	FUNCTION FONCTION	MODE	DESCRIPTION
		31	3	White wire (E1) : Trunk output Fil blanc (E1) : Sortie de la valise
	Program remote starter option for HEATED SEATS: Programmez l'option démarreur à distance pour L'ACTIVATION SIÈGES CHAUFFANTS:	39	2	Temperature option : AUX.1 activated at 5°C, 5 seconds after remote started Option de température: AUX.1 s'active à 5°C, 5 secondes après le démarrage à distance

NOTES

	The vehicles OEM remote will not be operable during remote start.	La télécommande d'origine du véhicule ne sera pas fonctionnelle durant le démarrage à distance.
---	---	---

	Parts required (Not included)	Pièce(s) requise(s) (Non incluse(s))
	1x Manual transmission : Relay (Trunk release)	1x Transmission manuelle : Relai (Ouverture de la valise)

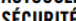
MANDATORY INSTALL INSTALLATION OBLIGATOIRE					
<div>* HOOD PIN</div> <div></div> <div>CONTACT DE CAPOT</div>	<div>HOOD STATUS : THE HOOD PIN SWITCH (INCLUDED) MUST BE INSTALLED IF THE VEHICLE CAN BE REMOTE STARTED WITH THE HOOD OPEN, SET FUNCTION A11 TO OFF.</div> <div>STATUT DE CAPOT : LE CONTACT DE CAPOT (INCLUS), DOIT ÊTRE INSTALLÉ SI LE VÉHICULE PEUT DÉMARRER À DISTANCE, LORSQUE LE CAPOT EST OUVERT, PROGRAMMEZ LA FONCTION A11 À NON.</div>	<div>A11</div>	<div>OFF NON</div>	<div>SECURITY STICKER AUTOCOLLANT DE SÉCURITÉ</div> <div></div> <div>Included Inclus</div>	<div>Notice: the installation of safety elements are mandatory. The hood pin and the sticker are essential security elements and must be installed.</div> <div>Notice: l'installation des éléments de sécurité est obligatoire. Le contact de capot et l'autocollant de sécurité sont des éléments de sécurité essentiels et doivent absolument être installés.</div>
	<div>THIS MODULE MUST BE INSTALLED BY A QUALIFIED TECHNICIAN. A WRONG CONNECTION CAN CAUSE PERMANENT DAMAGE TO THE VEHICLE.</div> <div>CE MODULE DOIT ÊTRE INSTALLÉ PAR UN TECHNICIEN QUALIFIÉ, TOUTE ERREUR DANS LES BRANCHEMENTS PEUT OCCASIONNER DES DOMMAGES PERMANENTS AU VÉHICULE.</div>				

DESCRIPTION

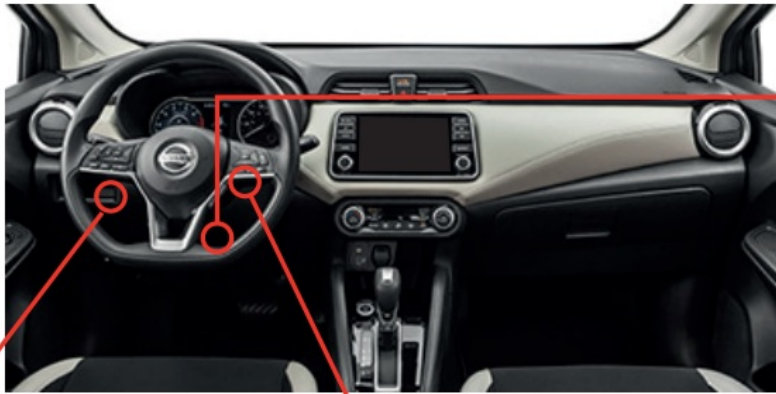

③ Clutch switch
Commutateur d'embrayage

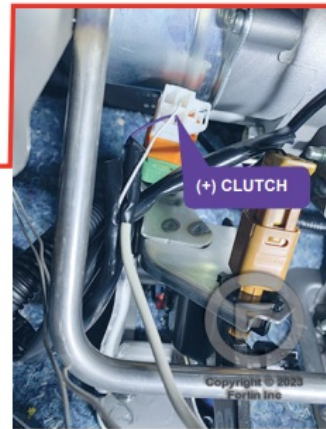

① BCM



② Ignition switch
Commutateur d'ignition

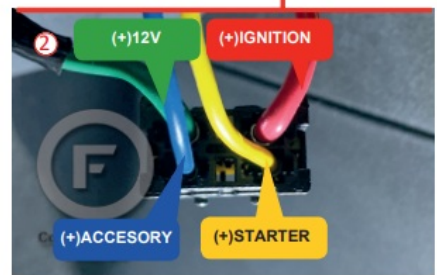
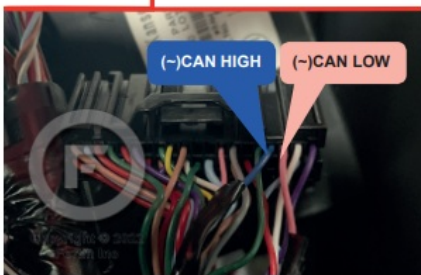
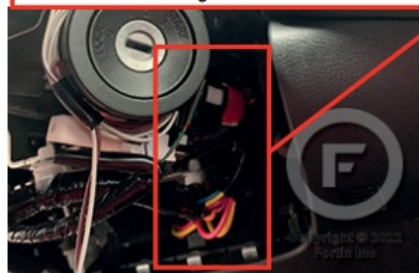

AUTOMATIC TRANSMISSION WIRING CONNECTION

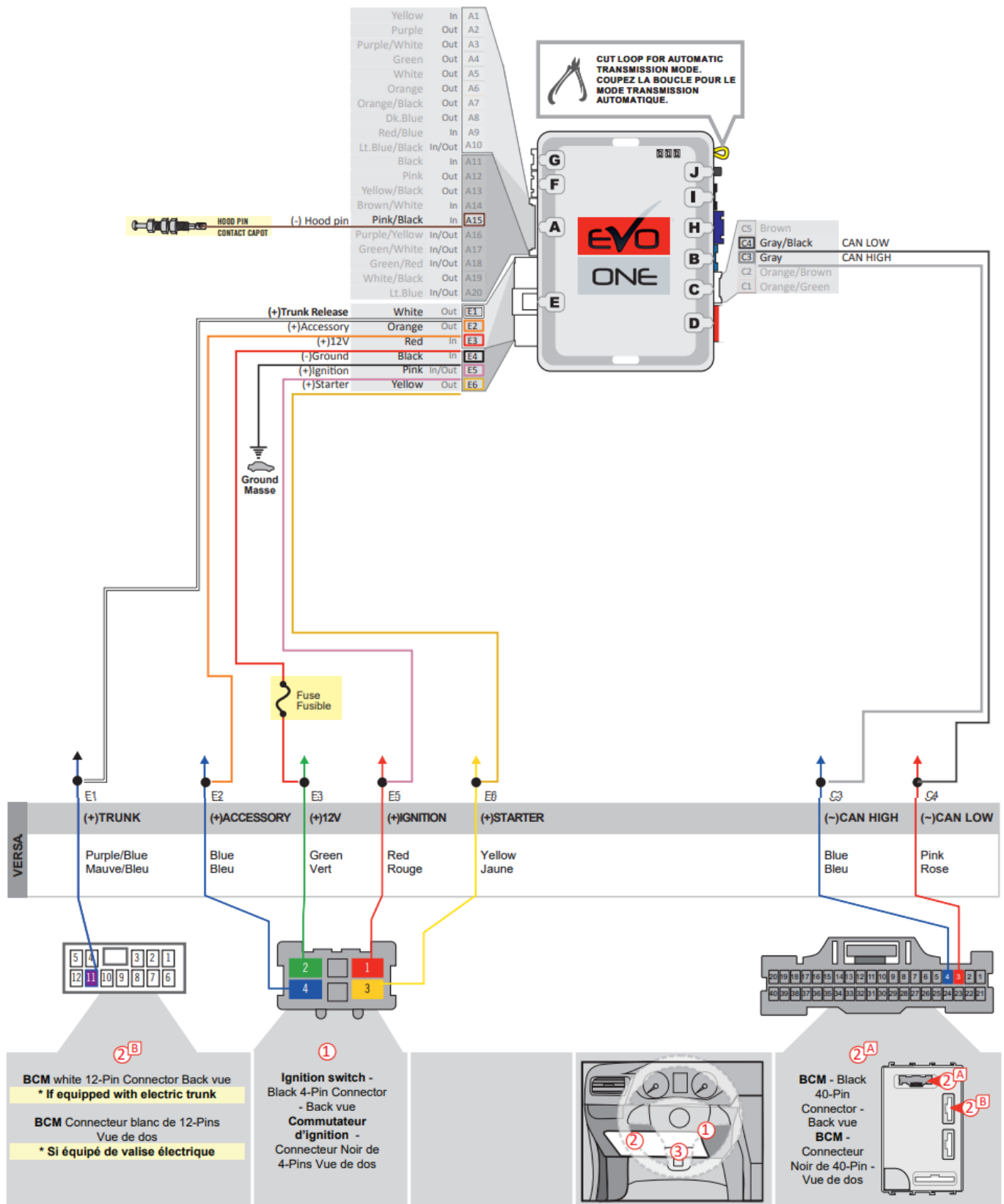

MANUAL TRANSMISSION WIRING CONNECTION

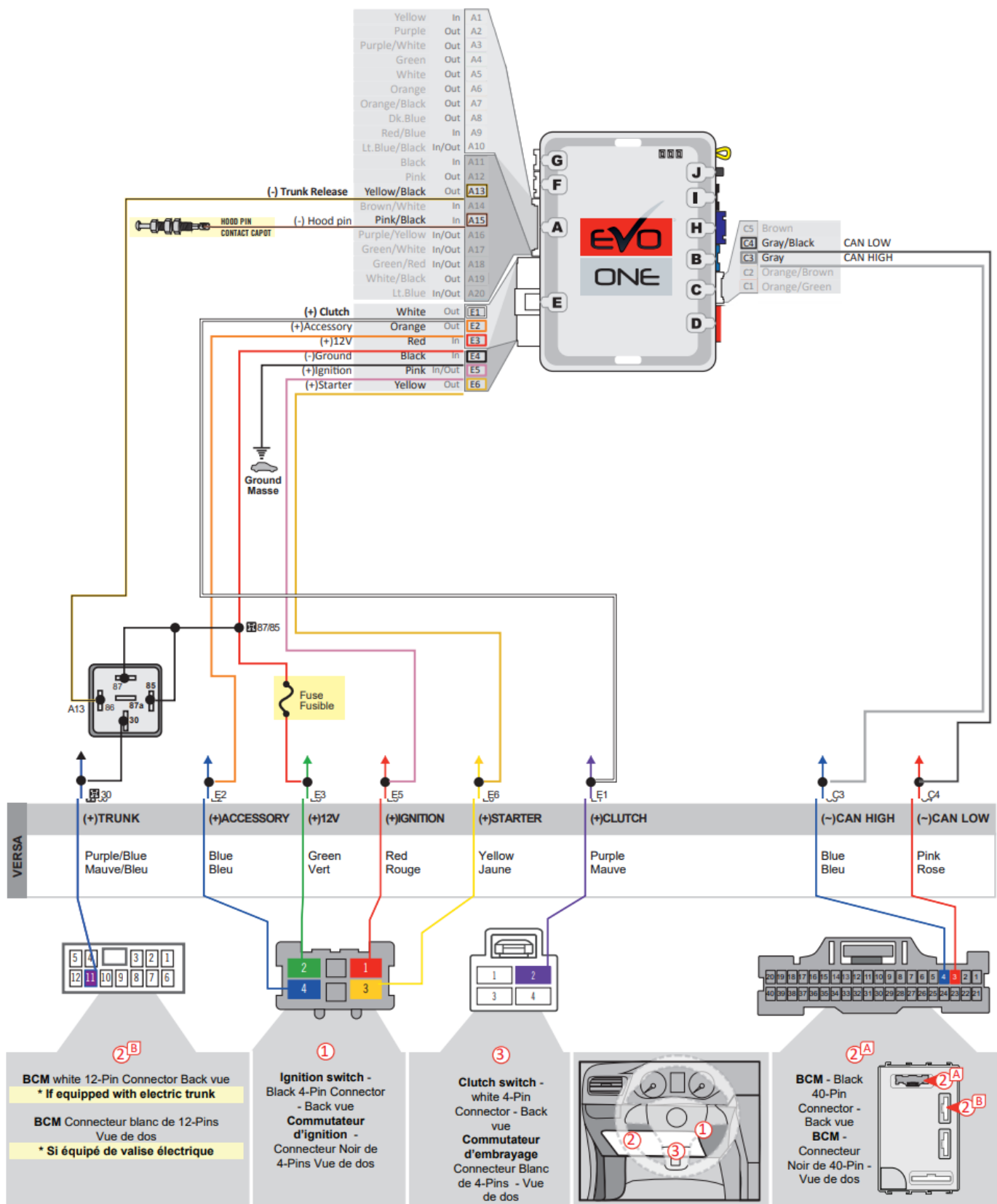

DCRYPTOR PROGRAMMING PROCEDURE

Parts required (not included)

- 1x **FLASH LINK UPDATER, FLASH LINK MANAGER** SOFTWARE | PROGRAMME
- 1x Microsoft Windows Computer with Internet connection

Pièces requises (non incluses)

- 1x **FLASH LINK MOBILE, FLASH LINK MOBILE APP**
- 1x Smartphone Android or iOS with Internet connection (Internet provider charges may apply)

OR OU

BEFORE PROGRAMMING SET THE UNIT OPTIONS AND SAVE. | AVANT LA PROGRAMMATION CONFIGURER LES OPTIONS DE L'UNITÉ ET SAUVEGARDER.

1. Press and hold the programming button:

Connect the 6-PIN Main harness (White connector).

The LEDs will alternate between BLUE, RED, YELLOW & BLUE/RED flashes.

2. Release the programming button when the LED is BLUE.

If the BLUE LED is not ON solid disconnect the 6-Pin Main connector and go back to step 1.

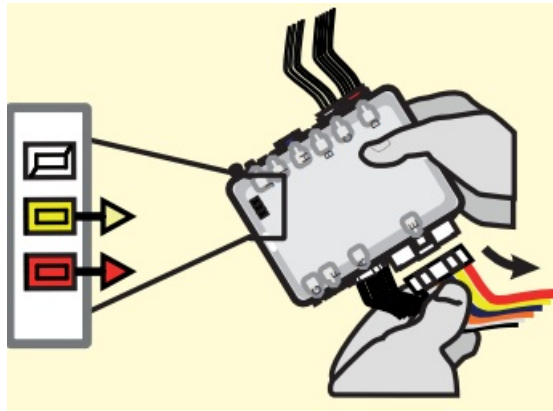

3. Insert the required remaining connectors.

4. Turn the key to the ON/RUN position.

The BLUE LED will turn OFF.

Wait,

The BLUE LED will flash rapidly.

1

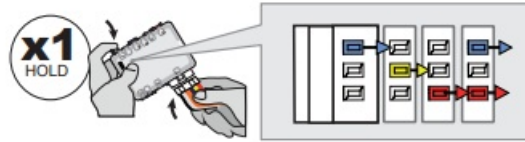

2



3



4

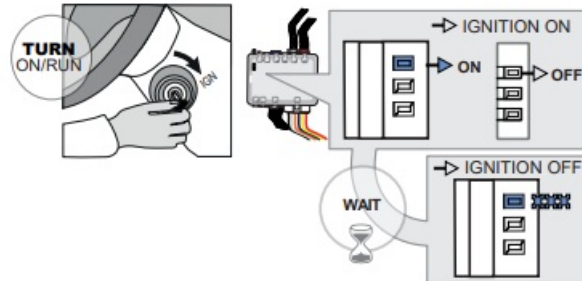

5. Turn the ignition to the OFF position.
The RED LED will turn ON.
6. Turn the key to the ON/RUN position.
The YELLOW LED will turn ON.
The RED LED will flash once.
7. Turn the ignition to the OFF position.
The YELLOW LED will turn OFF.
8. Turn the key to the ON/RUN position.
The YELLOW LED will turn ON
The RED LED will flash once.
The Red and Yellow LEDs will start flashing alternatively.
9. Turn the ignition to the OFF position.

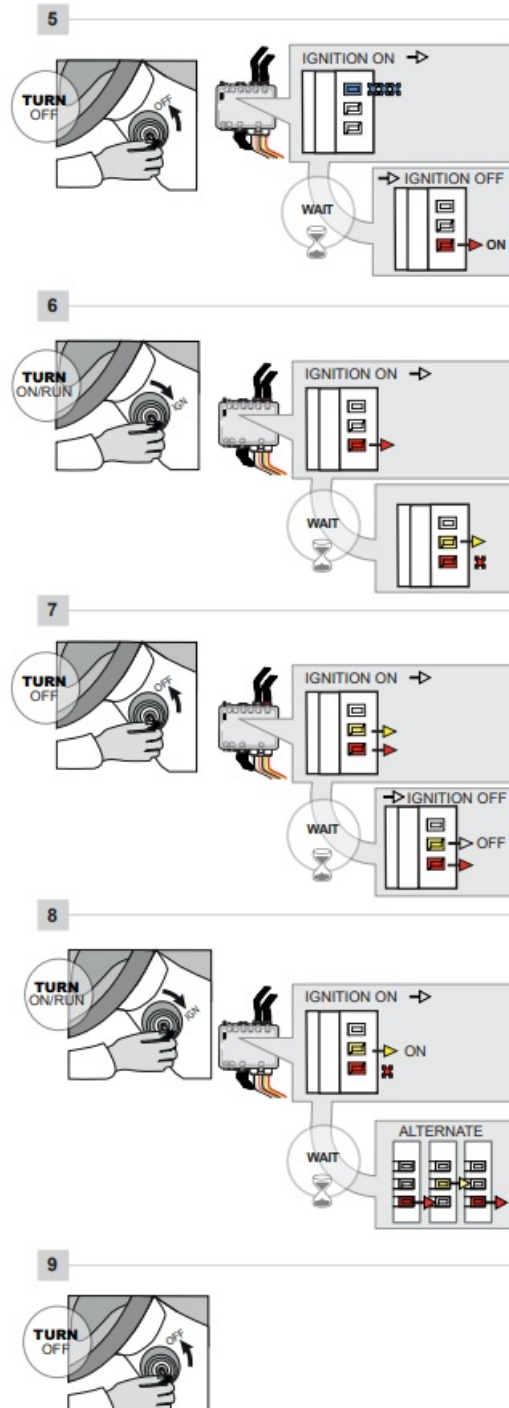

10. Disconnect all connectors and after the 6-Pin (Main-Harness) or the 4-Pin Data-link connector.

11. Use the tool:

FLASH LINK UPDATER or FLASH LINK MOBILE to visit the DCryptor menu.

*Parts required (not included)

The DCryptor process can take up to 15 minutes.

12. AFTER DCRYPTOR PROGRAMMING COMPLETED Go back to the vehicle and reconnect the 6-Pin (Main-Harness) or the 4-pins (Data-Link) connector and after all the remaining connector.

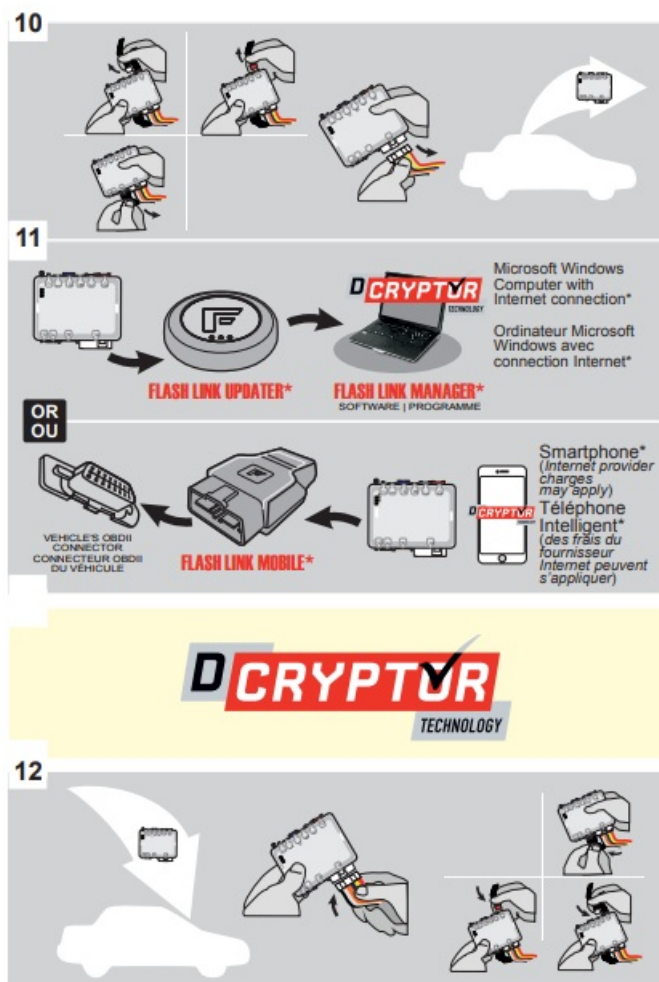

The module is now programmed.

REMOTE STARTER

Test the remote starter.

REMOTE STARTER PROGRAMMING PROCEDURE

REFER TO THE QUICK INSTALL GUIDE INCLUDED WITH THE MODULE FOR THE REMOTE STARTER PROGRAMMING.



REFER TO THE **QUICK INSTALL GUIDE** INCLUDED WITH THE MODULE FOR THE REMOTE STARTER PROGRAMMING.



RÉFÉREZ-VOUS AU **GUIDE D'INSTALLATION RAPIDE** INCLUS AVEC LE MODULE POUR LA PROGRAMMATION DU DÉMARREUR À DISTANCE.

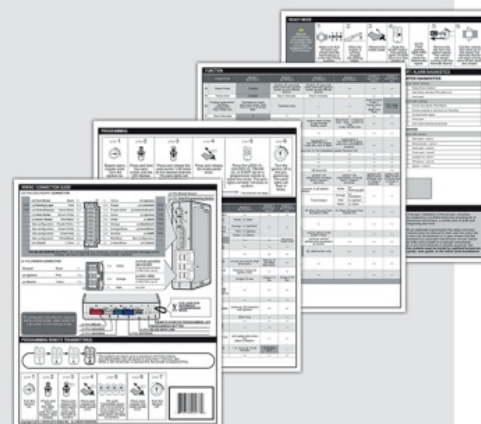

REMOTE STARTER FUNCTIONALITY

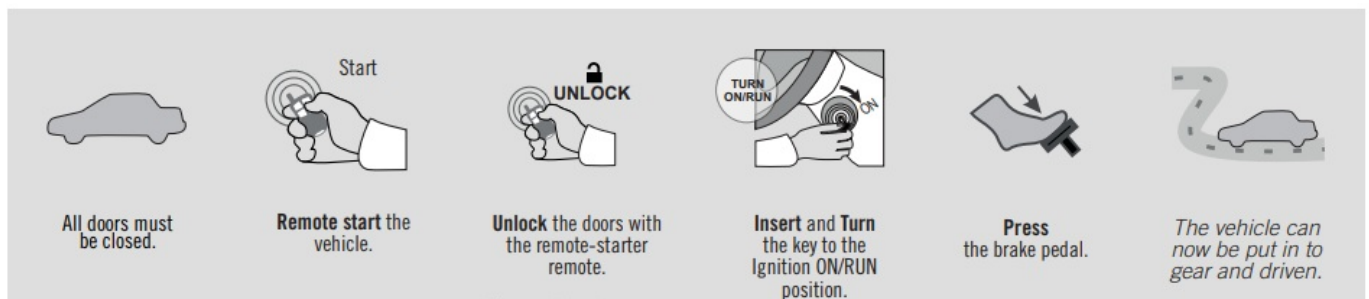

Notice: Updated Firmware and Installation Guides Updated firmware and installation guides are posted on our web site on a regular basis. We recommend that you update this module to the latest firmware and download the latest installation guide(s) prior to the installation of this product.

WARNING

The information on this sheet is provided on an (as is) basis with no representation or warranty of accuracy whatsoever. It is the sole responsibility of the installer to check and verify any circuit before connecting to it. Only a computer safe logic probe or digital multimeter should be used. FORTIN ELECTRONIC SYSTEMS assumes absolutely no liability or responsibility whatsoever pertaining to the accuracy or currency of the information supplied. The installation in every case is the sole responsibility of the installer performing the work and FORTIN ELECTRONIC SYSTEMS assumes no liability or responsibility whatsoever resulting from any type of installation, whether performed properly, improperly or any other way. Neither the manufacturer or distributor of this module is responsible of damages of any kind indirectly or directly caused by this module, except for the replacement of this module in case of manufacturing defects. This module must be installed by qualified technician. The information supplied is a guide only. This instruction guide may change without notice. Visit www.fortinbypass.com to get the latest version.

Copyright © 2006-2019, FORTIN AUTO RADIO INC ALL RIGHTS RESERVED PATENT PENDING

TECH SUPPORT

Tél: 514-255-HELP (4357)
1-877-336-7797
ADDENDUM GUIDE

www.fortinbypass.com

WEB UPDATE

Documents / Resources

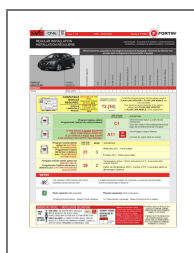

[FORTIN EVO 107851 High Encrypted Key Immobilizer Bypass Module](#) [pdf] Installation Guide

EVO-ONE, EVO 107851, EVO 107851 High Encrypted Key Immobilizer Bypass Module, High Encrypted Key Immobilizer Bypass Module, Key Immobilizer Bypass Module, Immobilizer Bypass Module, Bypass Module

References

- [!\[\]\(effbd7993c63c039a58fd3395789cf3f_img.jpg\) Remote Car Starters, Car Alarms, Immobilizer Bypass and Connected Vehicle Solutions | Fortin Electronic Systems](#)
- [!\[\]\(144980d038f2541d7b588a8a9132bd70_img.jpg\) Remote Car Starters, Car Alarms, Immobilizer Bypass and Connected Vehicle Solutions | Fortin Electronic Systems](#)
- [!\[\]\(c4ce2d477989700c971cf3d240ad9283_img.jpg\) Remote Car Starters, Car Alarms, Immobilizer Bypass and Connected Vehicle Solutions | Fortin Electronic Systems](#)

Manuals+.