



FORTIN 95021 EVO-ALL Universal All In One Data Bypass And Interface Module Installation Guide

[Home](#) » [FORTIN](#) » FORTIN 95021 EVO-ALL Universal All In One Data Bypass And Interface Module Installation Guide 

Contents

- [1 FORTIN 95021 EVO-ALL Universal All In One Data Bypass And Interface Module](#)
- [2 Vehicle functions](#)
- [3 MANDATORY INSTALL](#)
- [4 PARTS REQUIRED](#)
- [5 STAND ALONE CONFIGURATION](#)
- [6 REMOTE STARTER FUNCTIONALITY](#)
- [7 AUTOMATIC TRANSMISSION](#)
- [8 PROGRAMMING PROCEDURE](#)
- [9 TECH SUPPORT](#)
- [10 Documents / Resources](#)
 - [10.1 References](#)



FORTIN 95021 EVO-ALL Universal All In One Data Bypass And Interface Module



Vehicle functions

		Vehicle functions supported in this diagram (functional if equipped) Fonctions du véhicule supportées dans ce diagramme (fonctionnelles si équipé)												
	YEARS ANNÉES	Immobilizer bypass	Lock	Unlock	Arm	Disarm	Parking Lights	Hatch (open)	Tachometer	Door Status	Trunk Status	Hand-Brake Status	Foot-Brake Status	OEM Remote monitoring
JEEP														
Commander	2006-2007	•	•	•	•	•	•	•	•	•	•	•	•	

FIRMWARE VERSION VERSION LOGICIELLE 74.[39] MINIMUM



To add the firmware version and the options, use the FLASH LINK UPDATER or FLASH LINK MOBILE tool, sold separately.

Program bypass option

IF THE VEHICLE IS NOT EQUIPPED WITH FUNCTIONAL HOOD PIN:



UNIT OPTION OPTION UNITE/DESCRIPTION

- **A11/OFF NON/**
Hood trigger (Output Status).
- **C1**
OEM Remote status (Lock/Unlock) monitoring
- **D2**

Unlock before / Lock after (Disarm OEM alarm)

Parts required (Not included)

WIRE TO WIRE DIAGRAM

- 1x 7.5 Amp. fuse
- 1x Fusible 7.5 Amp.

THARNESSE DIAGRAM

- THARNESSE THAR-CHR5
- 1x THAR-CHR5
- 1x THAR-CHR5

MANDATORY INSTALL

HOOD PIN

- **HOOD STATUS:** THE HOOD PIN SWITCH MUST BE INSTALLED IF THE VEHICLE CAN BE REMOTE STARTED WITH THE HOOD OPEN, SET FUNCTION A11 TO OFF.



- **A11 OFF NON**

Notice: the installation of safety elements are mandatory. The hood pin is an essential security element and must be installed. THIS MODULE MUST BE INSTALLED BY A QUALIFIED TECHNICIAN. A WRONG CONNECTION CAN CAUSE PERMANENT DAMAGE TO THE VEHICLE.

PARTS REQUIRED

PARTS REQUIRED (NOT INCLUDED)

-  FLASH LINK UPDATER,

-  FLASH LINK MANAGER
 - SOFTWARE/PROGRAMME

-  Microsoft Windows Computer with Internet connection Ordinateur Microsoft Windows avec

connection Internet

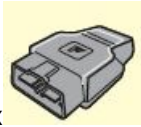

- 1x FLASH LINK MOBILE

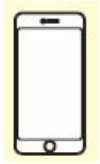

- 1x FLASH LINK MOBILE APP



- Smartphone Android or iOS with Internet connection (provider charges may apply).

MANDATORY

- HOOD PIN





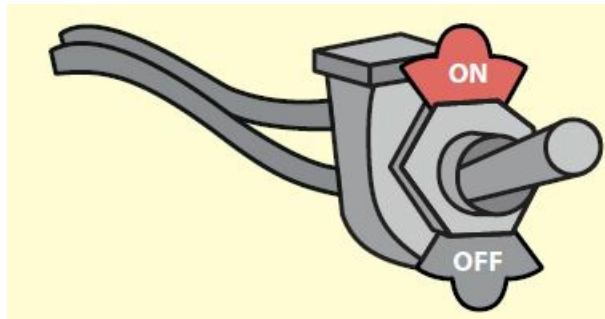

- REMOTE START SAFETY OVERRIDE SWITCH



- **Part:** RSPB available, Sold separately.

Notice: the installation of safety elements are mandatory. The hood pin and the valet switch are essential security elements and must be installed.

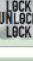
STAND ALONE CONFIGURATION

	Program bypass option OEM Remote Stand Alone Remote Starter: Programmez l'option du contournement Démarrreur à distance Autonome avec télécommande d'origine :	UNIT OPTION OPTION UNITE	DESCRIPTION
		OR D1.10  D1.1 	By default, LOCK, LOCK, LOCK Par défaut, VERROUILLE,VERROUILLE,VERROUILLE LOCK, UNLOCK, LOCK VERROUILLE,DÉVERROUILLE,VERROUILLE
	Program bypass option with oem remote: Programmez l'option du contournement avec télécommande d'origine:	UNIT OPTION OPTION UNITE	DESCRIPTION
		C1	OEM Remote Monitoring Supervision de la télécommande d'origine
	Program bypass option with RF KIT antenna: Programmez l'option du contournement avec antenne RF:	UNIT OPTION OPTION UNITE	DESCRIPTION
		H1 to H6 H1 à H6	Supported RF Kits and select RF Kit Kit RF supportés et sélectionnez le KIT RF

REMOTE STARTER FUNCTIONALITY

- All doors must be closed.

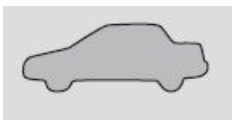

- Press the OEM remote's Lock button 3x to remote-start (or remote-stop) the vehicle.



- The vehicle will START.



REMOTE STARTER DIAGNOSTICS

- **MODULE RED LED**
 - x2 Flash : Brake ON
 - x3 Flash : No tach
 - x4 Flash : Ignition before start
 - x5 Flash: Hood Open

REMOTE STARTER WARNING CARD

CUT THIS WARNING CARD AND STICK IT ON A VISIBLE PLACE: or use the package RSPB, Sold separately.

WARNING REMOTE STARTER

- THE VEHICLE CAN BE STARTED BY
- **EITHER:** PRESSING THE LOCK BUTTON ON THE OEM REMOTE 3 TIMES CONSECUTIVELY OR BY A SMARTPHONE. TURN ON THE SAFETY
- SWITCH LOCATED UNDER THE
- DASHBOARD BEFORE WORKING ON THE VEHICLE.

AUTOMATIC TRANSMISSION

AUTOMATIC TRANSMISSION WIRING CONNECTION

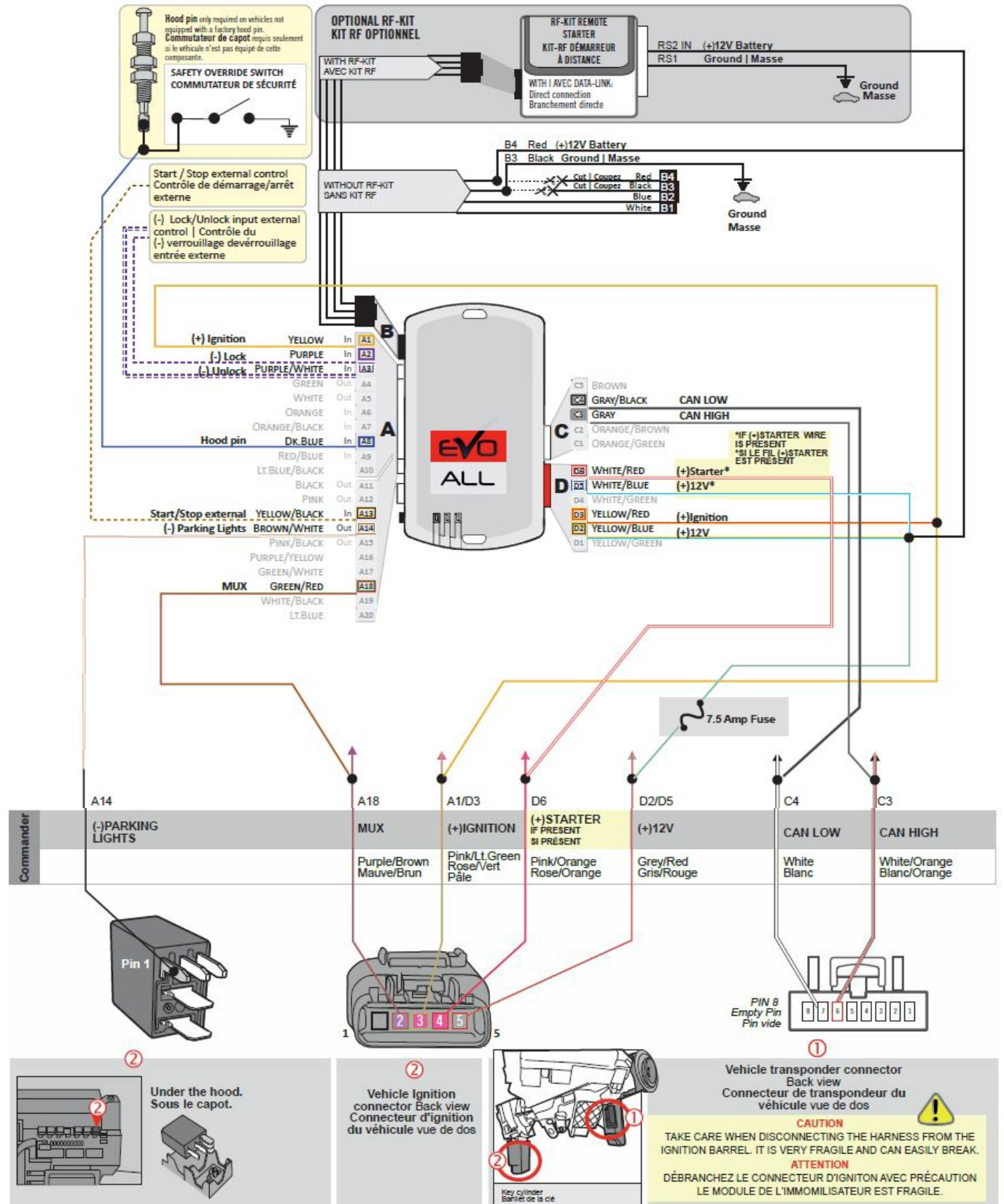

THAR-CHR5 | AUTOMATIC TRANSMISSION CONNECTION

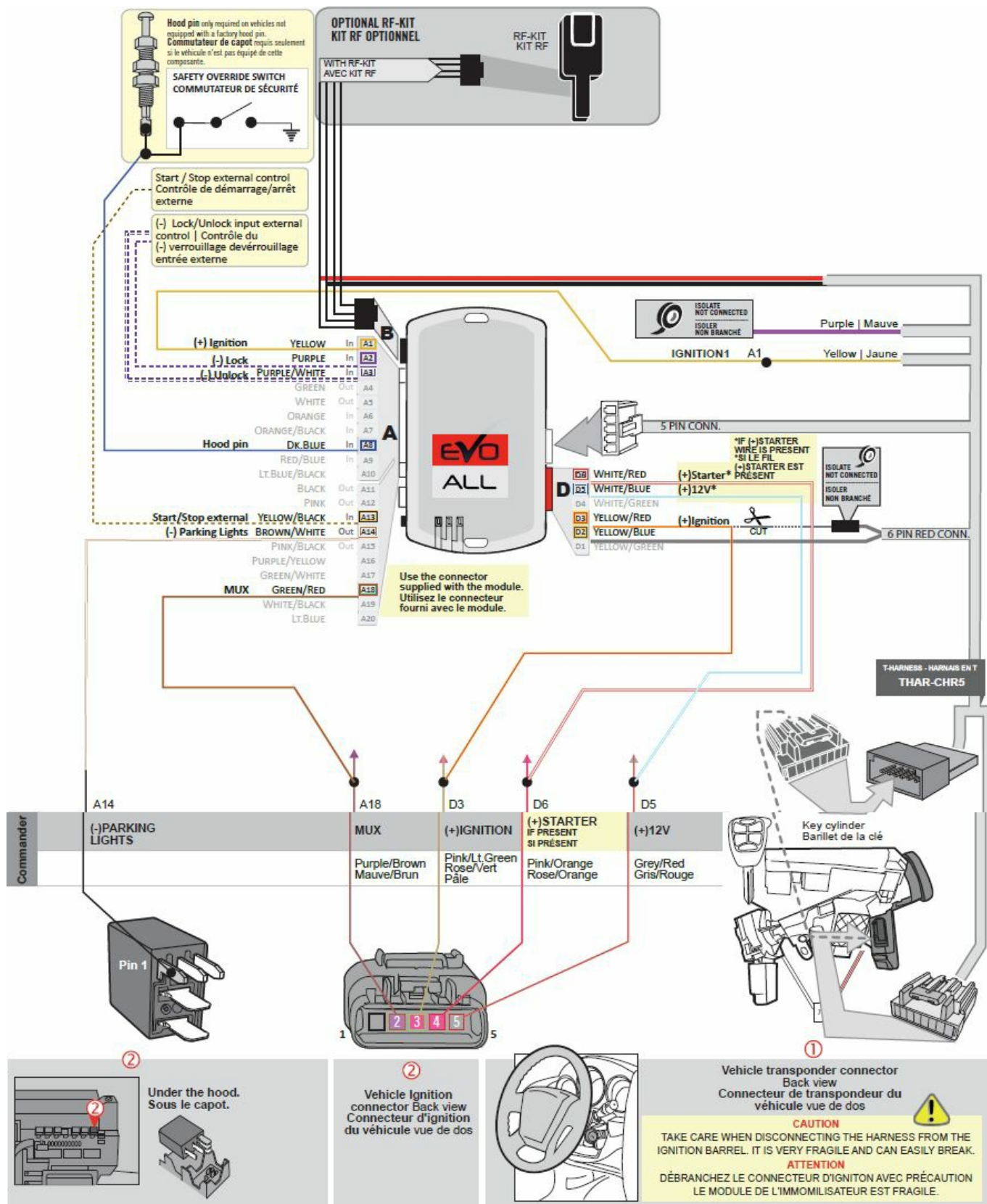

PROGRAMMING PROCEDURE

1

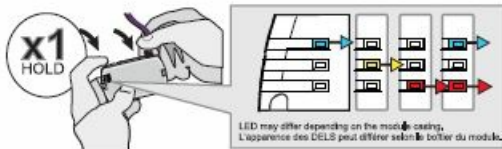

Press and hold the programming button:
Connect the 4-PIN Data-link harness (Black connector).

↳ The Blue, Red, Yellow and Blue & Red LEDs will alternatively illuminate.

Appuyez et maintenez enfoncé le bouton de programmation: **Branchez** le harnais Data-Link à 4-Broches (connecteur Noir)

↳ Les DELs Bleue, Rouge, Jaune et Bleue & Rouge s'allumeront alternativement.

2

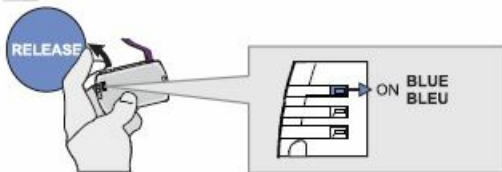

Release the programming button when the LED is BLUE.

If the LED is not solid BLUE disconnect the 4-Pin connector (Data-Link) and go back to step 1.

Relâchez le bouton de programmation quand la DEL est BLEU.

Si le DEL n'est pas BLEU débranchez le connecteur 4 pins (Data-Link) et allez au début de l'étape 1.

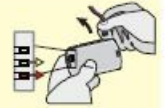

3



Insert the required remaining connectors,

Insérez les connecteurs requis restants,

4

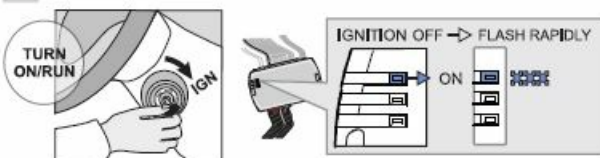

Turn the key to the Ignition ON/RUN position.

↳ The BLUE LED will flash rapidly.

Tournez la clé à Ignition.

↳ La DEL BLEU clignotera rapidement.

5

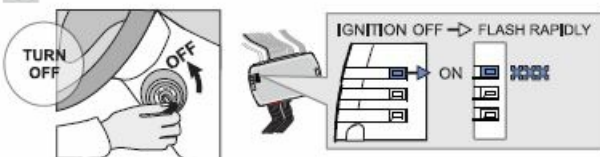

Turn the key to the OFF position.

↳ The BLUE LED will flash rapidly.

Tournez la clé à la position Arrêt (OFF).

↳ La DEL BLEU clignotera rapidement.

6

With OEM remote
Avec Télécommande d'origine



Press the LOCK button on the vehicles OEM remote.

Appuyez sur le bouton Verrouillage de la télécommande d'origine du véhicule.

Or | Ou

Without OEM remote
Sans Télécommande d'origine



Press and release the programming button on the module once.

Appuyez sur le bouton de programmation du module.

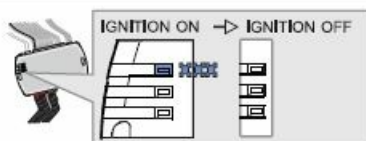

↳ The BLUE LED will turn off.

↳ La DEL BLEU s'éteint.



The module is now programmed.

Use the remote of the remote starter or security system to test all of the supported features to ensure proper programming.

Le module est programmé.

Testez toutes les fonctions supportées sur le véhicule avec la télécommande du démarreur à distance ou du système de sécurité.

REMOTE STARTER FUNCTIONALITY

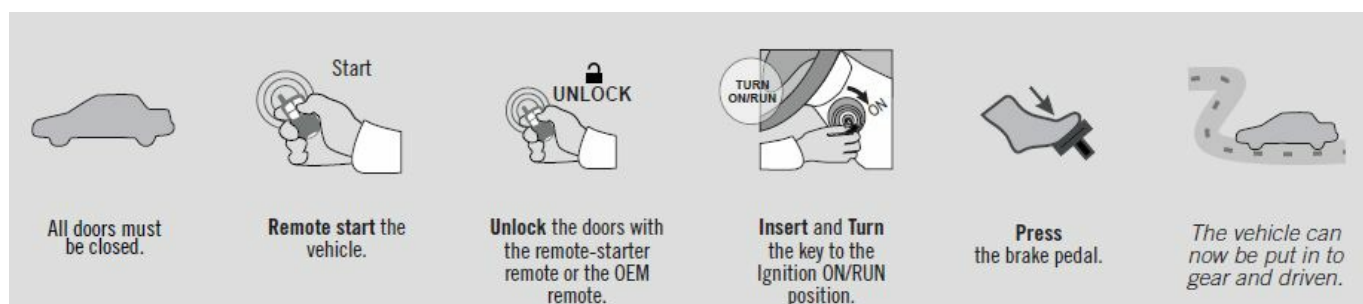

Notice: Updated Firmware and Installation Guides Updated firmware and installation guides are posted on our web site on a regular basis. We recommend that you update this module to the latest fi rmware and download the latest installation guide(s) prior to the installation of this product.

WARNING

The information on this sheet is provided on an (as is) basis with no representation or warranty of accuracy whatsoever. It is the sole responsibility of the installer to check and verify any circuit before connecting to it. Only a computer safe logic probe or digital multimeter should be used. FORTIN ELECTRONIC SYSTEMS assumes absolutely no liability or responsibility whatsoever pertaining to the accuracy or currency of the information supplied. The installation in every case is the sole responsibility of the installer performing the work and FORTIN ELECTRONIC SYSTEMS assumes no liability or responsibility whatsoever resulting from any type of installation, whether performed properly, improperly or any other way. Neither the manufacturer or distributor of this module is responsible of damages of any kind indirectly or directly caused by this module, except for the replacement of this module in case of manufacturing defects. This module must be installed by qualifi ed technician. The information supplied is a guide only. This instruction guide may change without notice. Visit www.fortinbypass.com. to get the latest version.

TECH SUPPORT

- www.fortinbypass.com.
- Tél: 514-255-HELP (4357) 1-877-336-7797

Copyright © 2006-2018, FORTIN AUTO RADIO INC ALL RIGHTS RESERVED PATENT PENDING ADDENDUM – SUGGESTED WIRING CONFIGURATION ONLY COMPATIBLE WITH AUTOMATIC TRANSMISSION VEHICLES.

Documents / Resources

	<p>FORTIN 95021 EVO-ALL Universal All In One Data Bypass And Interface Module [pdf] Inst allation Guide</p> <p>95021 EVO-ALL Universal All In One Data Bypass And Interface Module, 95021, EVO-ALL Uni versal All In One Data Bypass And Interface Module, Universal All In One Data Bypass And Int erface Module, All In One Data Bypass And Interface Module, One Data Bypass And Interface Module, Bypass And Interface Module, And Interface Module, Interface Module</p>
---	--

References

- [Fortin Remote Car Starters, Car Alarms, Immobilizer Bypass and Connected Vehicle Solutions | Fortin Electronic Systems](#)
- [Fortin Remote Car Starters, Car Alarms, Immobilizer Bypass and Connected Vehicle Solutions | Fortin Electronic Systems](#)

