

FORTIN 2024 Immobilizer Bypass Module



# FORTIN 2024 Immobilizer Bypass Module Installation Guide

[Home](#) » [FORTIN](#) » FORTIN 2024 Immobilizer Bypass Module Installation Guide 

## Contents

- [1 FORTIN 2024 Immobilizer Bypass Module](#)
- [2 Product Information](#)
- [3 Product Usage Instructions](#)
- [4 Vehicle functions supported in this diagram](#)
- [5 DESCRIPTION](#)
- [6 AUTOMATIC TRANSMISSION WIRING CONNECTION](#)
- [7 MANUAL TRANSMISSION WIRING CONNECTION](#)
- [8 PROGRAMMING PROCEDURE](#)
- [9 PROGRAM.: 2 VEHICLE WITHOUT EMS COM WIRE](#)
- [10 REMOTE STARTER FUNCTIONALITY](#)
- [11 Documents / Resources](#)
  - [11.1 References](#)
- [12 Related Posts](#)



**FORTIN 2024 Immobilizer Bypass Module**



## Product Information

### Specifications:

- Product: Immobilizer Bypass for Hyundai Elantra 2024
- Firmware Version: 76.[60]
- Manufacturer: Hyundai/Kia

## Product Usage Instructions

### Installation Requirements:

- Parts Required (Not included): 1x Fuse, 1x Relay
- Mandatory Install: Hood Pin Contact De Capot

### Installation Steps:

1. Ensure the vehicle is not equipped with a functional hood pin.
2. Install the hood pin switch to enable hood status monitoring.
3. Program the bypass option as per the provided instructions.

### Connection Instructions:

- Connect various inputs and outputs as per the provided wiring diagram.
- Always connect with Data-Link for proper functionality.

### Safety Notice:

- This module must be installed by a qualified technician to avoid damage to the vehicle.
- Incorrect connections can lead to permanent damage, so follow the installation guidelines carefully.

## FAQ (Frequently Asked Questions)

**1. Q: Can I install the Immobilizer Bypass myself?**

A: It is recommended to have the unit installed by a qualified technician to avoid any potential damage to the vehicle.

**2. Q: What do I do if my vehicle has a functional hood pin already installed?**

A: Follow the provided instructions to program the bypass option accordingly and set the function as required.

**Vehicle functions supported in this diagram**

**Immobilizer bypass**

- Lock
- Unlock
- Arm
- Disarm
- Trunk (open)
- Tachometer
- Door Status
- Parking Lights
- Trunk Status
- Hood Status\*
- Hand-Brake Status
- Foot-Brake Status
- OEM Monitoring



**FIRMWARE VERSION**

**76.[60]**

**HYUNDAI/KIA MINIMUM**

To add the firmware version and the options, use the FLASH LINK UPDATER or FLASH LINK MOBILE tool, sold separately.

	<b>Program bypass option:</b>	UNIT OPTION	DESCRIPTION
		<b>C1</b>	OEM Remote status (Lock/Unlock) monitoring

IF THE VEHICLE IS NOT EQUIPPED WITH FUNCTIONAL HOOD PIN:

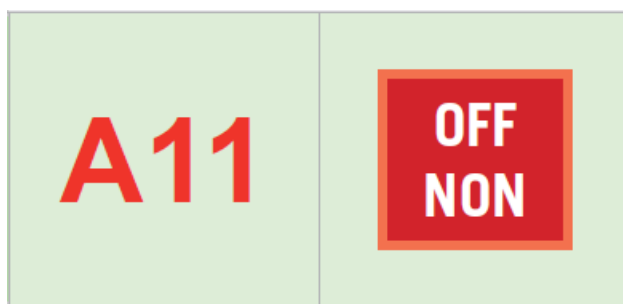

Hood trigger (Output Status).



**Parts required (Not included)**

- 1x Fuse
- 1X relay

**MANDATORY INSTALL**

**\* HOOD PIN**



**HOOD STATUS :** THE HOOD PIN SWITCH MUST BE INSTALLED  
IF THE VEHICLE CAN BE REMOTE STARTED WITH THE HOOD OPEN, SET FUNCTION A11 TO OFF.

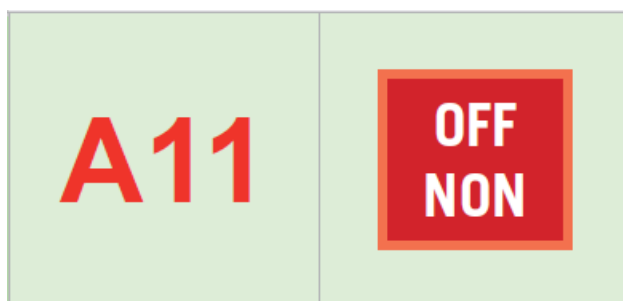

**Notice:** the installation of safety elements are mandatory. The hood pin is an essential security element and must be installed.

THIS MODULE MUST BE INSTALLED BY A QUALIFIED TECHNICIAN. A WRONG CONNECTION CAN CAUSE PERMANENT DAMAGE TO THE VEHICLE.

This guide may change without notice. See [www.fortin.ca](http://www.fortin.ca) for latest version.

## DESCRIPTION

- ③ At Parking light harness, above key barrel  
Au Harnais des feux de stationnement, au dessus du barillet d'ignition



Under steering column  
Sous la colonne de direction

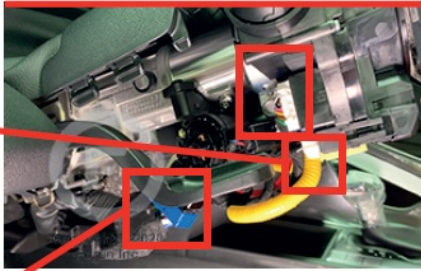

- ① Ignition switch  
Commutateur d'ignition

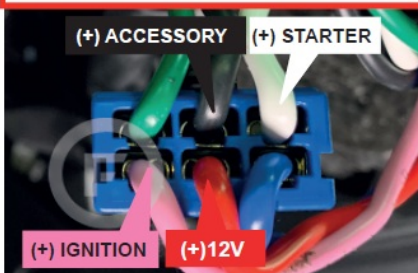

- ④ At clutch switch  
Au commutateur d'embrayage

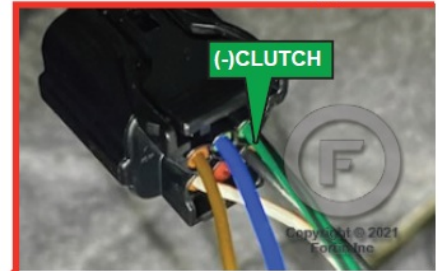

- ② Right of the fuse box  
À droite de la Boîte à fusibles



- Behind the fuse box  
Au dos de la Boîte à fusibles

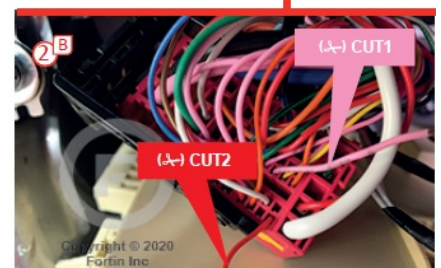
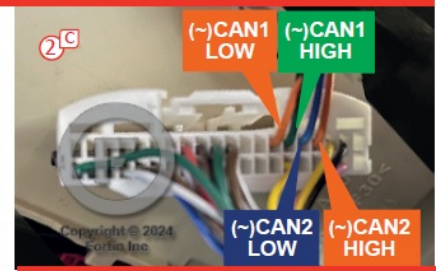

## AUTOMATIC TRANSMISSION WIRING CONNECTION

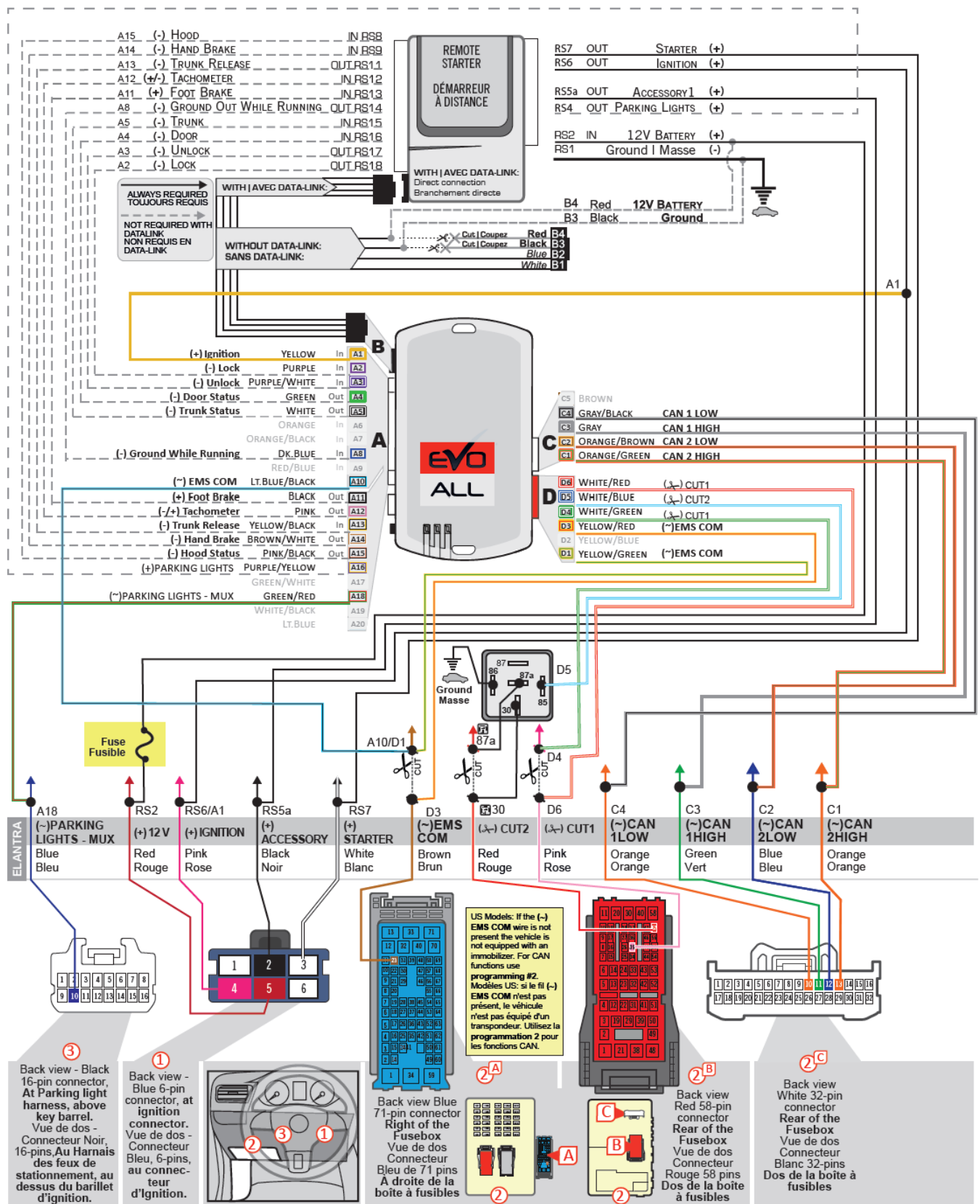

## MANUAL TRANSMISSION WIRING CONNECTION



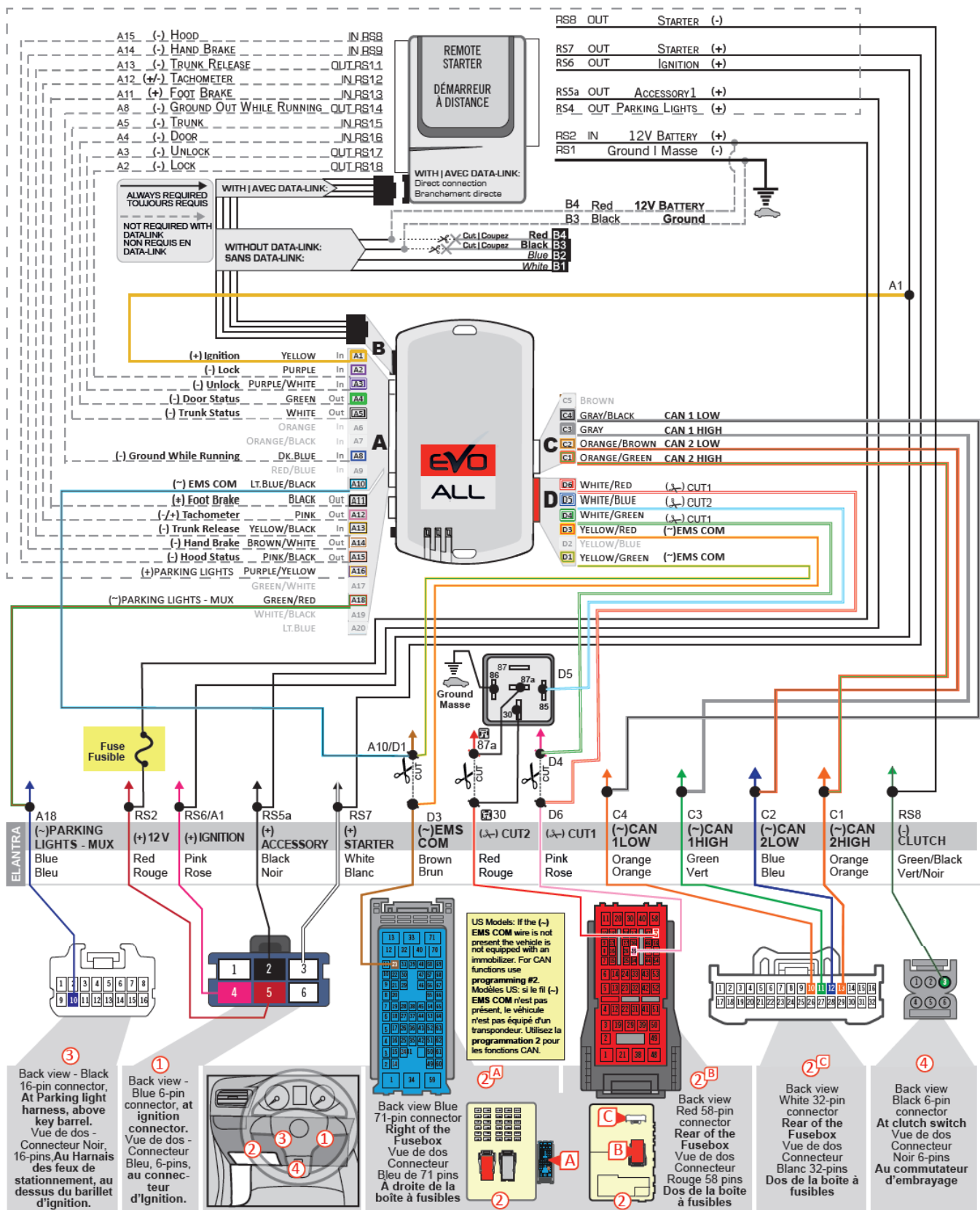

## PROGRAMMING PROCEDURE

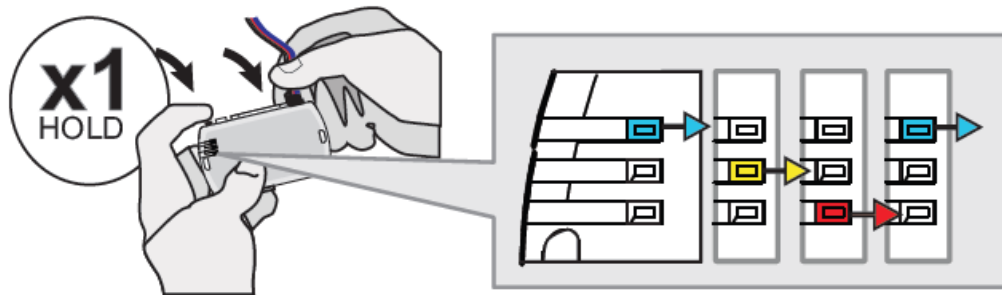

Press and hold the programming button: Insert the 4-Pin (Data-Lin connector).  
The Blue, Red, Yellow and Blue & Red LEDs will alternatively illuminate.

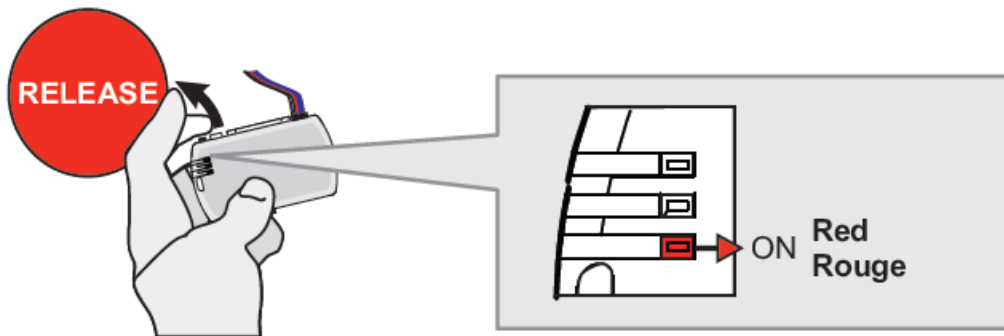

Release the programming button when the Red LED is ON.  
If the Red LED is not ON solid, disconnect the 4-PIN Data-Link harness (Black connector) and go back to step 1.

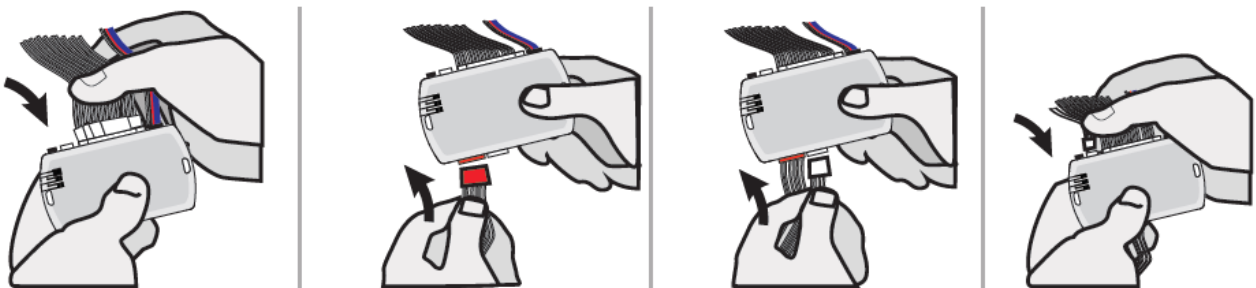

Insert the required remaining connectors.

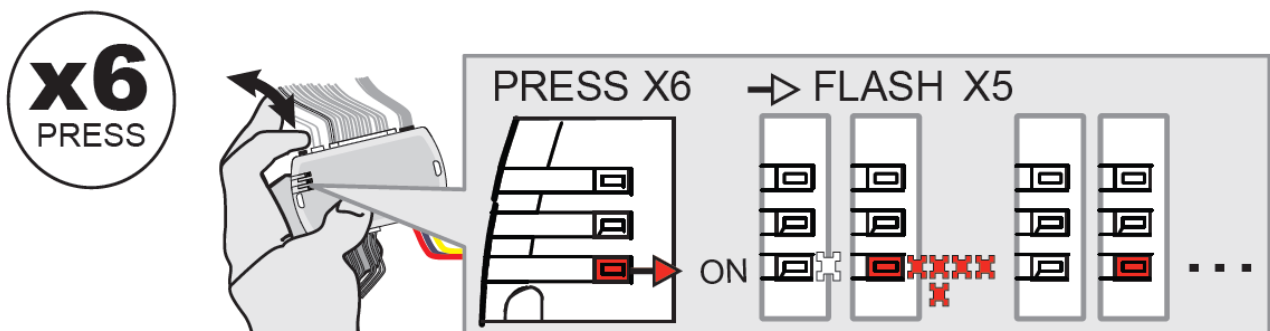

Press and release the programming button 6 times (6x).

- The RED LED will flash 5 times and pause.



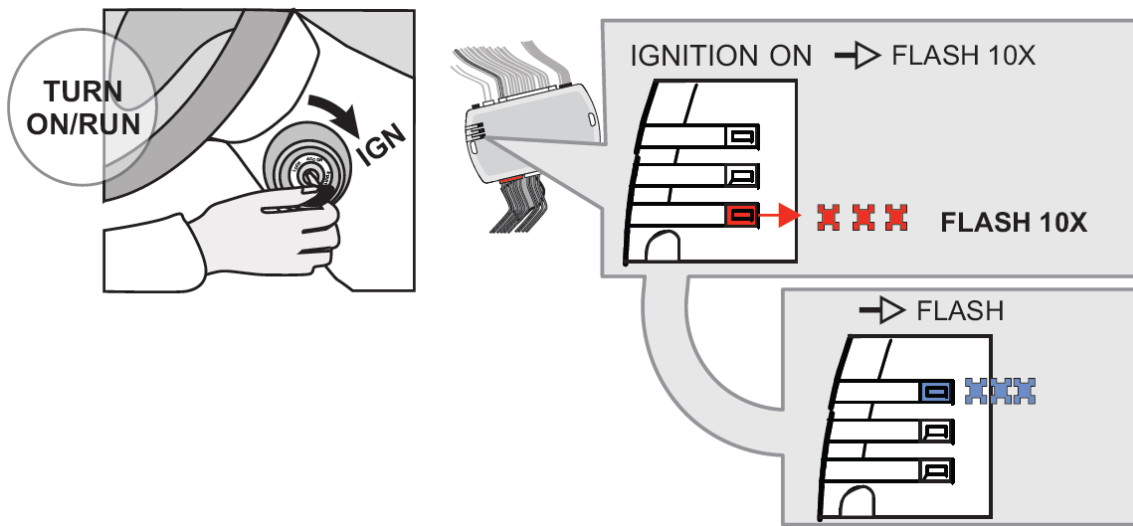

Turn the key to the Ignition ON/RUN position.

- The Red LED will flash 10 times rapidly.

Key bypass programmed.

- The Blue LED will flash rapidly.

CAN-Bus programmed.

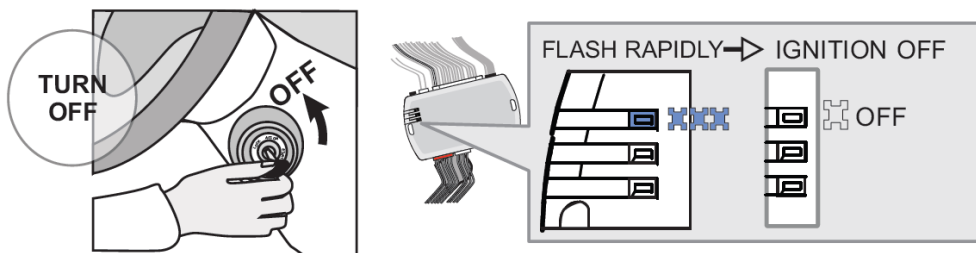

Turn the key to the OFF position.

- The Blue LED will turn off.



**The module is now programmed.**

Use the remote of the remote starter / security system to test all the supported features and ensure all the features are properly programmed.

**PROGRAM.: 2 VEHICLE WITHOUT EMS COM WIRE**

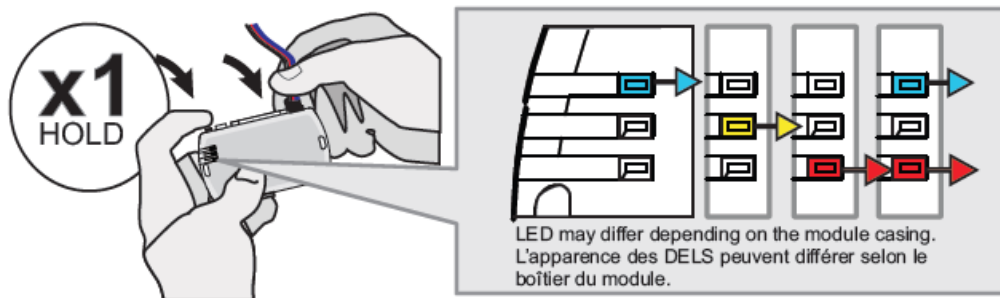

**Press and hold the programming button:**

Connect the 4-PIN Data-link harness (Black connector).

- The Blue, Red, Yellow and Blue & Red LEDs will alternatively illuminate.

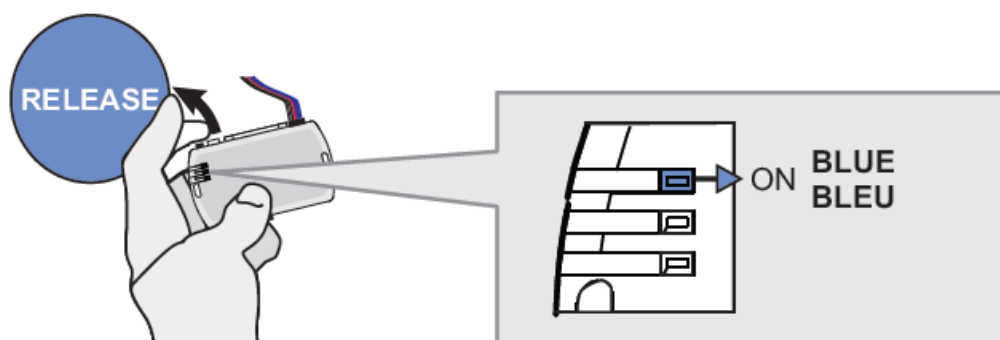

Release the programming button when the LED is BLUE.

If the LED is not solid BLUE disconnect the 4-Pin connector (Data-Link) and go back to step 1.

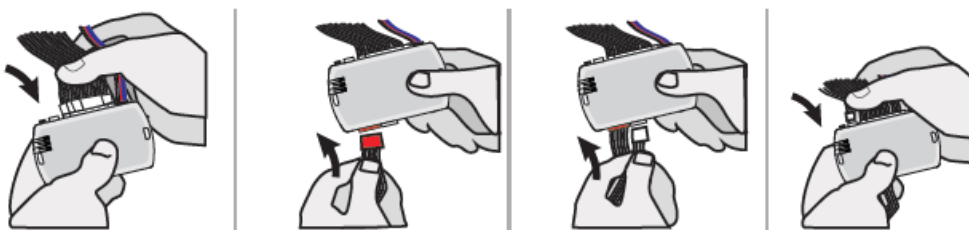

Insert the required remaining connectors.

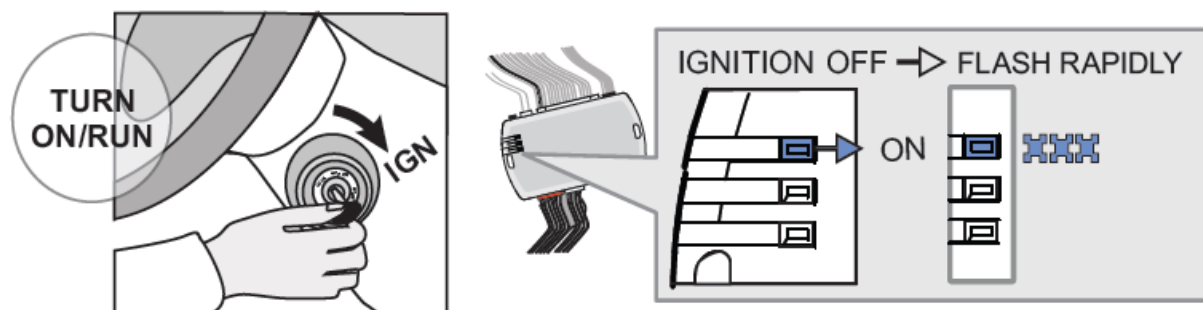

Turn the key to the Ignition ON/RUN position.

- The BLUE LED will flash rapidly.

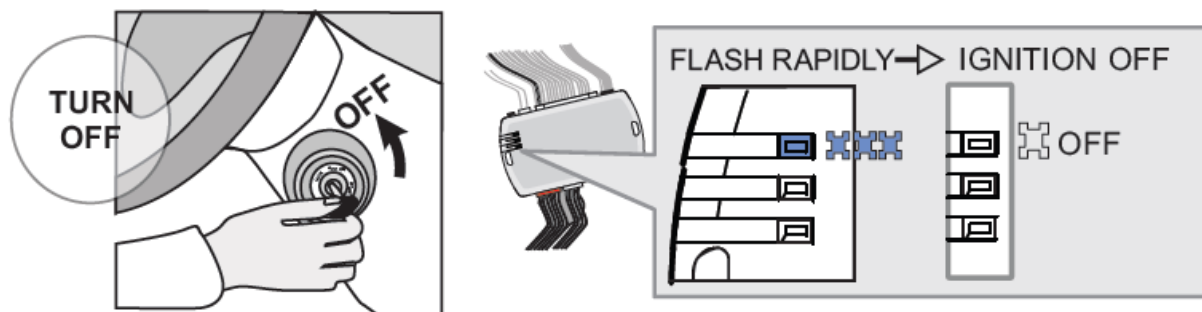

Turn the key to the OFF position.  
→ The BLUE LED will turn off.



The module is now programmed.

## REMOTE STARTER FUNCTIONALITY



- All doors must be closed.
- Remote start the vehicle.
- Unlock the doors with the remote-starter remote or the OEM remote.
- Insert and Turn the key to the Ignition ON/RUN position.
- Press the brake pedal.
- The vehicle can now be put in to gear and driven.

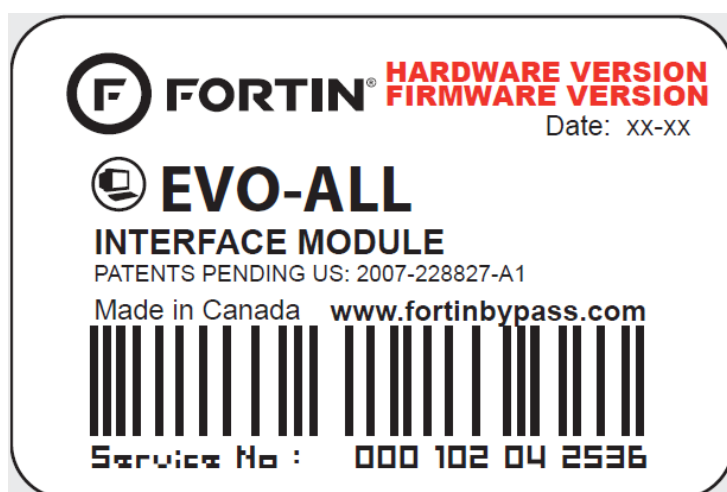

### Module label

**Notice:** Updated Firmware and Installation Guides Updated firmware and installation guides are posted on our web site on a regular basis. We recommend that you update this module to the latest firmware and download the latest installation guide(s) prior to the installation of this product.

### WARNING

The information on this sheet is provided on an (as is) basis with no representation or warranty of accuracy whatsoever. It is the sole responsibility of the installer to check and verify any circuit before connecting to it. Only a computer safe logic probe or digital multimeter should be used. FORTIN ELECTRONIC SYSTEMS assumes

absolutely no liability or responsibility whatsoever pertaining to the accuracy or currency of the information supplied. The installation in every case is the sole responsibility of the installer performing the work and FORTIN ELECTRONIC SYSTEMS assumes no liability or responsibility whatsoever resulting from any type of installation, whether performed properly, improperly or any other way. Neither the manufacturer or distributor of this module is responsible of damages of any kind indirectly or directly caused by this module, except for the replacement of this module in case of manufacturing defects. This module must be installed by qualified technician. The information supplied is a guide only. This instruction guide may change without notice. Visit [www.fortinbypass.com](http://www.fortinbypass.com) to get the latest version.

Copyright © 2006-2018, FORTIN AUTO RADIO INC ALL RIGHTS RESERVED PATENT PENDING



#### TECH SUPPORT

Tél: 514-255-HELP (4357)

1-[877-336-7797](tel:877-336-7797)



#### ADDENDUM GUIDE

[www.fortinbypass.com](http://www.fortinbypass.com)

#### WEB UPDATE

### Documents / Resources



[FORTIN 2024 Immobilizer Bypass Module](#) [pdf] Installation Guide  
2024, 2024 Immobilizer Bypass Module, Immobilizer Bypass Module, Bypass Module, Module

### References

- [User Manual](#)

[Manuals+](#), [Privacy Policy](#)

This website is an independent publication and is neither affiliated with nor endorsed by any of the trademark owners. The "Bluetooth®" word mark and logos are registered trademarks owned by Bluetooth SIG, Inc. The "Wi-Fi®" word mark and logos are registered trademarks owned by the Wi-Fi Alliance. Any use of these marks on this website does not imply any affiliation with or endorsement.