



FORTIN 2023-2024 Vehicle 2 Inch Display Key with Keyless Installation Guide

[Home](#) » [FORTIN](#) » FORTIN 2023-2024 Vehicle 2 Inch Display Key with Keyless Installation Guide 



REV.: 20240925
Guide # 117041

Contents

- 1 2023-2024 Vehicle 2 Inch Display Key with Keyless
- 2 NOTES
- 3 PARTS REQUIRED (NOT INCLUDED)
- 4 STAND ALONE CONFIGURATION
- 5 REMOTE STARTER FUNCTIONALITY
- 6 REMOTE STARTER WARNING CARD
- 7 AUTOMATIC TRANSMISSION WIRING CONNECTION
- 8 DCRYPTOR PROGRAMMING PROCEDURE
- 9 OPTIONAL RF-KIT PROGRAMMING
- 10 REMOTE STARTER FUNCTIONALITY
- 11 Documents / Resources
 - 11.1 References

2023-2024 Vehicle 2 Inch Display Key with Keyless

THAR-FOR5 THARNESSTAND ALONE INSTALLATION INSTALLATION STAND ALONE HARNAS THAR-FOR5 ADDENDUM – SUGGESTED WIRING CONFIGURATION

 ONLY COMPATIBLE WITH AUTOMATIC TRANSMISSION VEHICLES.



VEHICLE YEARS

FORD

F-250, F-350, F-450, F-550 12" display

Key with keyless* 2022

Key with keyless 2023-2024

Vehicle functions supported in this diagram (functional if equipped)

•	•	Immobilizer bypass Contournement
•	•	T-Harness available (sold separately)
•	•	Lock
•	•	Unlock
•	•	Arm
•	•	Disarm
•	•	RAP Disable
•	•	Parking Lights™
•	•	Tachometer
•	•	Heated seats**
•	•	Heated Mirrors
•	•	Rear desfrost**
•	•	Door Status
•	•	Trunk Status
•	•	Hood Status*
•	•	Hand-Brake Status
•	•	Foot-Brake Status
•	•	OEM remote monitoring

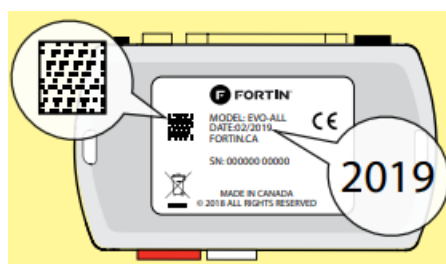

COMPATIBLE	QR CODE ON THE LABEL
MODULE REQUIRED:	MANUFACTURED AFTER: 2019
MODULE	CODE QR SUR 'ÉTIQUETTE
COMPATIBLE REQUIS	FABRIQUÉ APRÈS: 2019

FIRMWARE VERSION VERSION LOGICIELLE 58.[06] MINIMUM

To add the firmware version and the options, use the FLASH LINK UPDATER or FLASH LINK MOBILE tool, sold separately.



Program bypass option:

IF THE VEHICLE IS NOT EQUIPPED WITH FUNCTIONAL HOOD PIN:

UNIT OPTION

UNIT OPTION	DESCRIPTION
C1	OEM Remote status (Lock/Unlock) monitoring
A11 	Hood trigger (Output Status).

NOTES

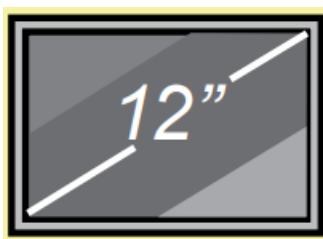

*The vehicle must be equipped with 12 inch radio display.

The vehicles OEM remote and SmartKey are still operable during remote start.

**Heated seats

**Rear Defrost The heated seats and rear defrost activate automatically when it's cold.

***Parking Lights The parking Lights at remote start only.

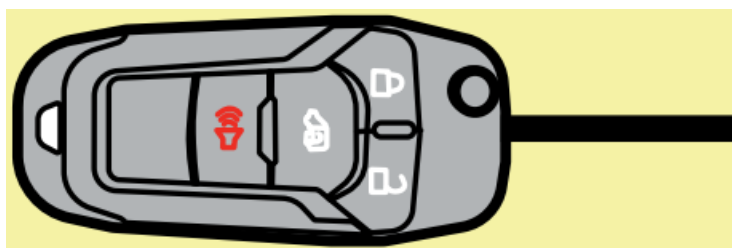

The vehicle must be equipped with the OEM remote with the door locks.

MANDATORY INSTALL

* HOOD PIN CONTACT DE CAPOT



HOOD STATUS : THE HOOD PIN SWITCH MUST BE INSTALLED IF THE VEHICLE CAN BE REMOTE STARTED WITH THE HOOD OPEN, SET FUNCTION A11 TO OFF.

A11 

Notice: the installation of safety elements are mandatory. The hood pin is an essential security element and must be installed.

THIS MODULE MUST BE INSTALLED BY A QUALIFIED TECHNICIAN. A WRONG CONNECTION CAN CAUSE PERMANENT DAMAGE TO THE VEHICLE.

This guide may change without notice. See www.fortin.ca for latest version.

PARTS REQUIRED (NOT INCLUDED)

1x  FLASH LINK UPDATER,

1x  FLASH LINK MANAGER

1x  SOFTWARE | PROGRAMME

Microsoft Windows Computer with Internet connection

Ordinateur Microsoft Windows avec connection Internet

1x  FLASH LINK MOBILE

1x  FLASH LINK MOBILE APP

1x  Smartphone Android or iOS with Internet connection (provider charges may apply).

MANDATORY

HOOD PIN

CONTACT

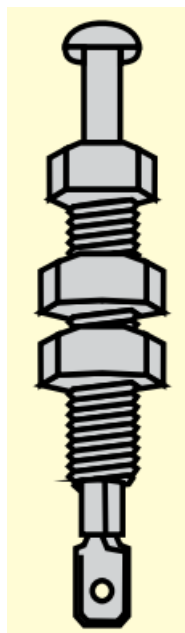

REMOTE START SAFETY OVERRIDE SWITCH

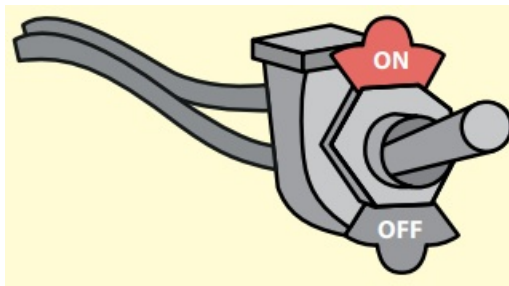

VALET SWITCH COMMUTATEUR VALET

Part #: RSPB available, Sold separately.

Notice: the installation of safety elements are mandatory.

The hood pin and the valet switch are essential security elements and must be installed.

STAND ALONE CONFIGURATION



Program bypass option



OEM Remote Stand Alone Remote Starter:



Program bypass option with oem remote:



Program bypass option with RF KIT antenna:

UNIT OPTION	DESCRIPTION
D1.10  D1.1 	By default, LOCK, LOCK, LOCK Par défaut, VERROUILLE,VERROUILLE,VERROUILLE
C1	OEM Remote Monitoring
H1 to H6 H1 à H6	Supported RF Kits and select RF Kit

REMOTE STARTER FUNCTIONALITY

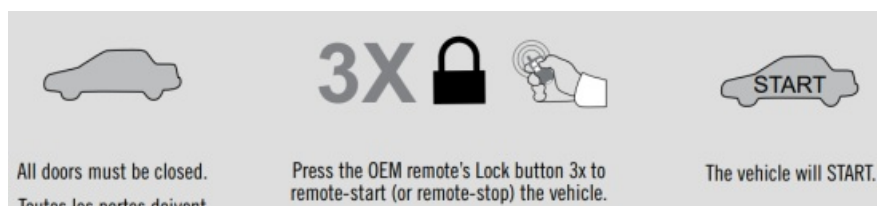

REMOTE STARTER DIAGNOSTICS

MODULE RED LED

x2 flash :Brake ON

x3 flash :No tach

x4 flash : Ignition before start

x5 flash : Hood Open

REMOTE STARTER WARNING CARD



CUT THIS WARNING CARD AND STICK IT ON A VISIBLE PLACE:

or use the package RSPB, Sold separately.



WARNING

REMOTE STARTER

THE VEHICLE CAN BE STARTED BY EITHER: PRESSING THE LOCK BUTTON ON THE OEM REMOTE 3 TIMES CONSECUTIVELY OR BY A SMARTPHONE. TURN ON THE SAFETY SWITCH LOCATED UNDER THE DASHBOARD BEFORE WORKING ON THE VEHICLE.

NOTES



THE REMOTE START WILL NOT OPERATE IF :



Hood is open

or switch is not present



Check Engine light is ON



Low fuel light is ON



Vehicle battery voltage
is too low

⚠ CAUTION

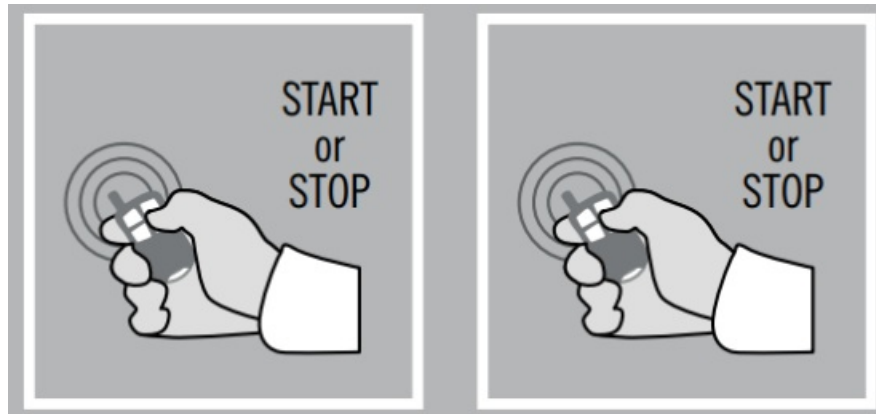

The remote start is limited to two consecutive command Start or Stop.

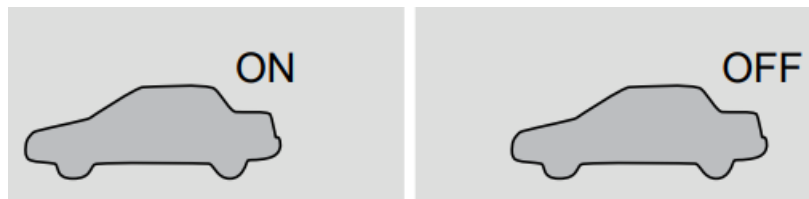

To use the remote again ignition must be turned ON and OFF.

AUTOMATIC TRANSMISSION WIRING CONNECTION

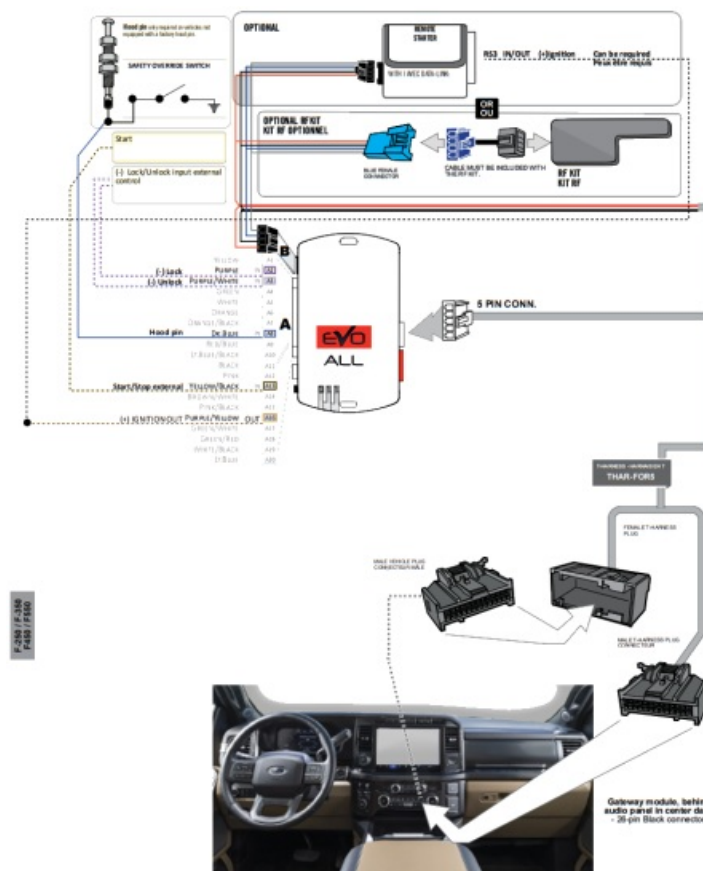

DCRYPTOR PROGRAMMING PROCEDURE



Parts required (not included)



1x FLASH LINK UPDATER,

1x  FLASH LINK MANAGER

1x  SOFTWARE | PROGRAMME

Microsoft Windows Computer with Internet connection
Ordinateur Microsoft Windows avec connection Internet
OR



1x  FLASH LINK MOBILE

1x  FLASH LINK MOBILE APP

1x  Smartphone Android or iOS with Internet connection
(Internet provider charges may apply)

BEFORE PROGRAMMING SET THE UNIT OPTIONS AND SAVE.

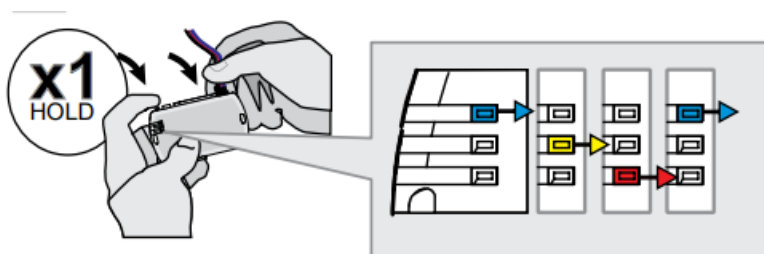

Press and hold

Insert the programming button: the 4-Pin (Data-Link) connector.

The Blue, Red, Yellow and Blue & Red LEDs will alternatively illuminate.

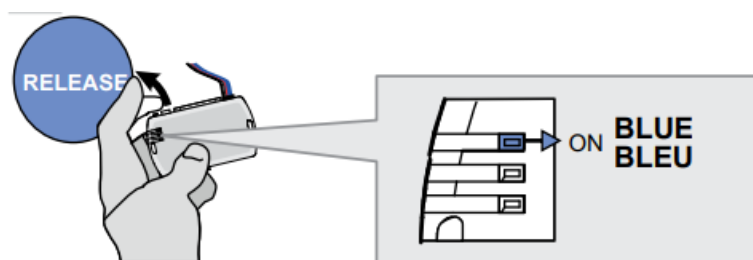

Release the programming button when the LED is BLUE.

If the LED is not solid BLUE disconnect the 4-Pin connector (Data-Link) and go back to step 1.

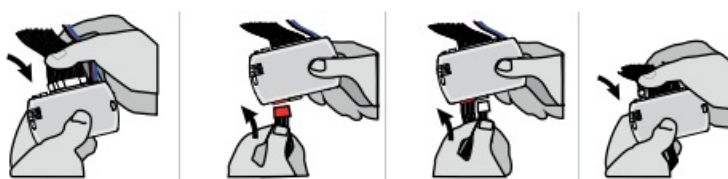
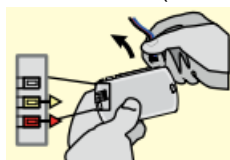

Insert the required remaining connectors.

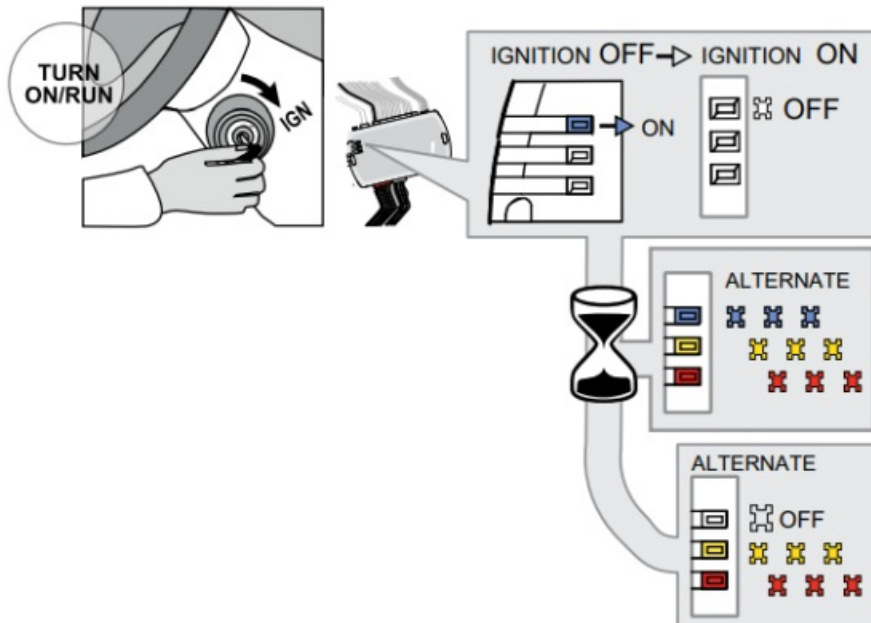

Turn the key to the Ignition ON/RUN position.

↳ The BLUE LED will turn OFF.

↳ The BLUE, YELLOW and RED LEDs will alternated.

↳ The RED and YELLOW LEDs will alternated.

Make sure that the DELs are flashing RED and YELLOW before continuing programming.

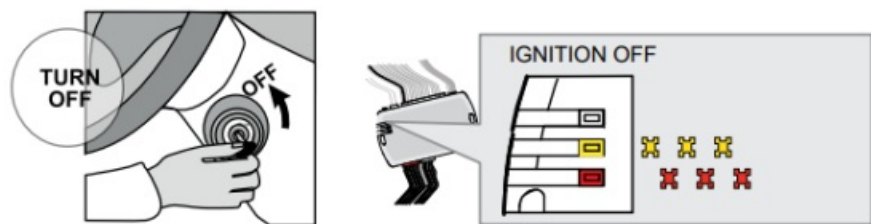
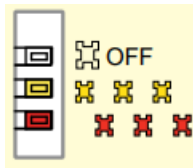

Turn the key to the OFF position.

↳ The RED and YELLOW LEDs alternate.

KEY BYPASS PROGRAMMING PROCEDURE 2/2



The module must be programmed on the vehicle.

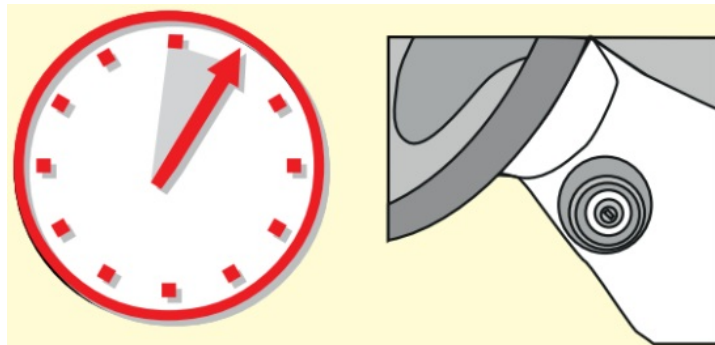

MAKE SURE THE IGNITION KEY HAS BEEN IN THE OFF POSITION FOR AT LEAST 5 SECONDS.

1 ON Turn the key to the ON/RUN position.	2 OFF Turn the ignition to the OFF position.	3 ON Turn the key to the ON/RUN position.	4 4X BRAKES Press and release the brake pedal four times.	5 ON EACH TRANSMITTER SUR CHACUNE DES TELECOMMANDES 4 BUTTONS 4 BOUTONS PRESS AND RELEASE APPUYEZ ET RELÂCHEZ PRESS AND RELEASE APPUYEZ ET RELÂCHEZ 1 BUTTON 1 BOUTON PRESS APPROX. 12 SEC. AND WAIT FOR THE BLUE LED TO TURN OFF THEN BACK ON SOLID THEN RELEASE.	6 OFF Turn the ignition to the OFF position.	7 ON Turn the key to the ON/RUN position and leave it ON for 5 sec.	8 OFF Turn the ignition to the OFF position.
 The YELLOW LED will turn ON solid.	 The YELLOW LED will turn Off.	 The YELLOW LED will turn ON solid.	 The LED will flash rapidly. The 3 LED will turn ON solid.	 The LED will flash rapidly. Le témoin clignotera rapidement.	 The LED will turn Off.	 The YELLOW LED will turn ON solid.	 The YELLOW LED will turn Off.

REMOTE STARTER FUNCTIONALITY



All doors must be closed.

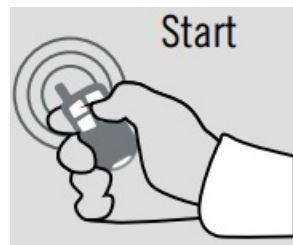

Remote start the vehicle.



Unlock the doors with the remote-starter remote or the OEM remote.

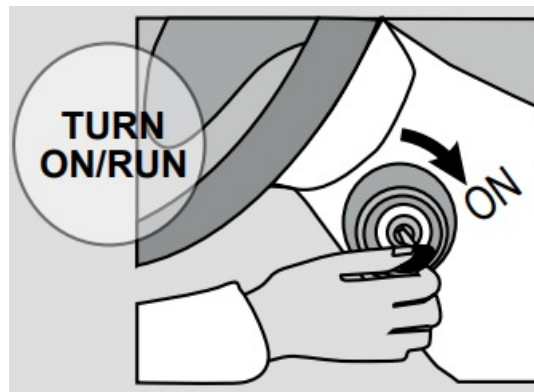

Insert and Turn the key to the Ignition ON/RUN position.

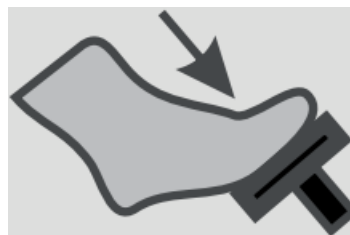

Press the brake pedal.

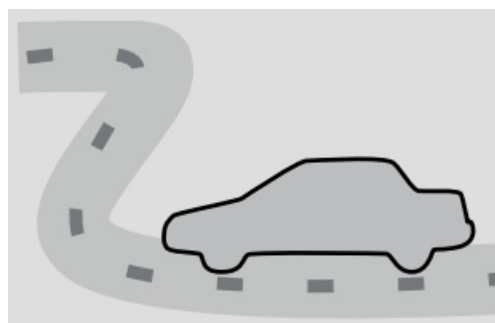

The vehicle can now be put in to gear and driven.

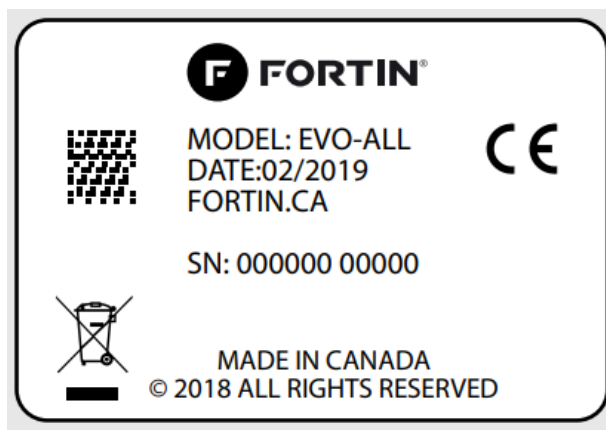

Module label

Notice: Updated Firmware and Installation Guides

Updated firmware and installation guides are posted on our web site on a regular basis. We recommend that you update this module to the latest firmware and download the latest installation guide(s) prior to the installation of this product.

WARNING

The information on this sheet is provided on an (as is) basis with no representation or warranty of accuracy whatsoever.

It is the sole responsibility of the installer to check and verify any circuit before connecting to it. Only a computer safe logic probe or digital multimeter should be used. FORTIN ELECTRONIC SYSTEMS assumes absolutely no liability or

responsibility whatsoever pertaining to the accuracy or currency of the information supplied. The installation in every case is the sole responsibility of the installer performing the work and FORTIN ELECTRONIC SYSTEMS assumes no liability or responsibility whatsoever resulting from any type of installation, whether performed properly, improperly or any other way. Neither the manufacturer or distributor of this module is responsible of damages of any kind indirectly or directly caused by this module, except for the replacement of this module in case of manufacturing defects. This module must be installed by qualified technician. The information supplied is a guide only. This instruction guide may change without notice. Visit www.fortinbypass.com to get the latest version.

Copyright © 2006-2019, FORTIN AUTO RADIO INC ALL RIGHTS RESERVED PATENT PENDING



TECH SUPPORT

Tél: 514-255-HELP (4357)

1-877-336-7797



ADDENDUM GUIDE

www.fortinbypass.com



WEB UPDATE

This guide may change without notice.



See www.fortin.ca for latest version.

Documents / Resources



[FORTIN 2023-2024 Vehicle 2 Inch Display Key with Keyless \[pdf\]](#) Installation Guide
EVO-ALL, THAR-FOR5, 117041, 2023-2024 Vehicle 2 Inch Display Key with Keyless, Vehicle 2
Inch Display Key with Keyless, Display Key with Keyless, Key with Keyless, Keyless

References

-  [OFF.La](#)
-  [wah damn solid](#)
- [User Manual](#)

Manuals+, Privacy Policy

This website is an independent publication and is neither affiliated with nor endorsed by any of the trademark owners. The "Bluetooth®" word mark and logos are registered trademarks owned by Bluetooth SIG, Inc. The "Wi-Fi®" word mark and logos are registered trademarks owned by the Wi-Fi Alliance. Any use of these marks on this website does not imply any affiliation with or endorsement.