

FORTIN 2020 EVO ALL Push Button Remote Starters and Alarm Systems



FORTIN 2020 EVO ALL Push Button Remote Starters and Alarm Systems Installation Guide

[Home](#) » [FORTIN](#) » FORTIN 2020 EVO ALL Push Button Remote Starters and Alarm Systems Installation Guide



Contents

- [1 FORTIN 2020 EVO ALL Push Button Remote Starters and Alarm Systems](#)
- [2 Product Information](#)
- [3 Product Usage Instructions](#)
- [4 REGULAR INSTALLATION](#)
- [5 DESCRIPTION](#)
- [6 WIRING CONNECTION](#)
- [7 REMOTE STARTER FUNCTIONALITY |](#)
- [8 Documents / Resources](#)
 - [8.1 References](#)
- [9 Related Posts](#)

FORTIN®

FORTIN 2020 EVO ALL Push Button Remote Starters and Alarm Systems



Product Information

Specifications

- Model: EVO-ALL
- Compatibility: Lexus ES250 Push-to-Start 2019-2024
- Firmware Version: 79.[66]
- Manufacturer Date: After 2019

Product Usage Instructions

Installation Requirements

It is mandatory to install the hood pin switch for proper functionality. For vehicles that can be remote started with the hood open, set function A11 to OFF.

Wiring Connection

Refer to the provided wiring connection guide for proper installation. Ensure all connections are secure and follow the instructions carefully.

Safety Precautions:

Installation of safety elements like the hood pin is essential for security purposes. This module must be installed by a qualified technician to avoid any damage to the vehicle.

Frequently Asked Questions (FAQ)

- **Q: Is the installation of the hood pin switch mandatory?**

A: Yes, for proper functioning and safety, the installation of the hood pin switch is mandatory.

- **Q: Can the module be installed by anyone?**

A: No, this module must be installed by a qualified technician to prevent any damage to the vehicle.

REGULAR INSTALLATION

ADDENDUM – SUGGESTED WIRING CONFIGURATION

Vehicle functions supported in this diagram (functional if equipped)

VEHICLE VEHICULES	YEARS ANNÉES	Immobilizer bypass Contournement d'immobilisateur	Lock	Unlock	Arm	Disarm	Trunk (open)	Parking Lights	Tachometer	Door Status	Trunk Status	Hood Status*	Hand-Brake Status	Foot-Brake Status	OEM Remote monitoring**
LEXUS															
ES250	Push-to-Start 2019-2024	•	•	•	•	•	•	•	•	•	•	•	•	•	•

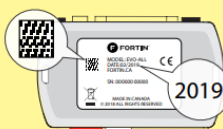
	COMPATIBLE MODULE REQUIRED:	QR CODE ON THE LABEL MANUFACTURED AFTER: 2019	FIRMWARE VERSION VERSION LOGICIELLE	To add the firmware version and the options, use the FLASH LINK UPDATER or FLASH LINK MOBILE tool, sold separately.
	MODULE COMPATIBLE REQUIS:	CODE QR SUR L'ÉTIQUETTE FABRIQUÉ APRÈS: 2019	79.[66] MINIMUM	

	Program bypass option: <div></div>	UNIT OPTION OPTION UNITÉ	DESCRIPTION
		C1	OEM Remote status (Lock/Unlock) monitoring Suivi des status (Verrouillage/Déverrouil- lage) de la télécommande d'origine
		D6	Push-to-Start Push-to-Start
		A11	<div>OFF NON</div> Hood trigger (Output Status). Contact de capot (état de sortie).

IF THE VEHICLE IS NOT EQUIPPED WITH FUNCTIONAL HOOD PIN: <div></div>	

NOTES



** The vehicles OEM remote and SmartKey are still operable during remote start.



Parts required (Not included)

1X Diode

MANDATORY INSTALL | INSTALLATION OBLIGATOIRE

* HOOD PIN



HOOD STATUS: THE HOOD PIN SWITCH MUST BE INSTALLED IF THE VEHICLE CAN BE REMOTE STARTED WITH THE HOOD OPEN, SET FUNCTION **A11** TO OFF.

A11

OFF
NON

Notice: the installation of safety elements are mandatory. The hood pin is an essential security element and must be installed.

THIS MODULE MUST BE INSTALLED BY A QUALIFIED TECHNICIAN. A WRONG CONNECTION CAN CAUSE PERMANENT DAMAGE TO THE VEHICLE.

CONTACT
DE CAPOT

DESCRIPTION

ECU, Driver's side

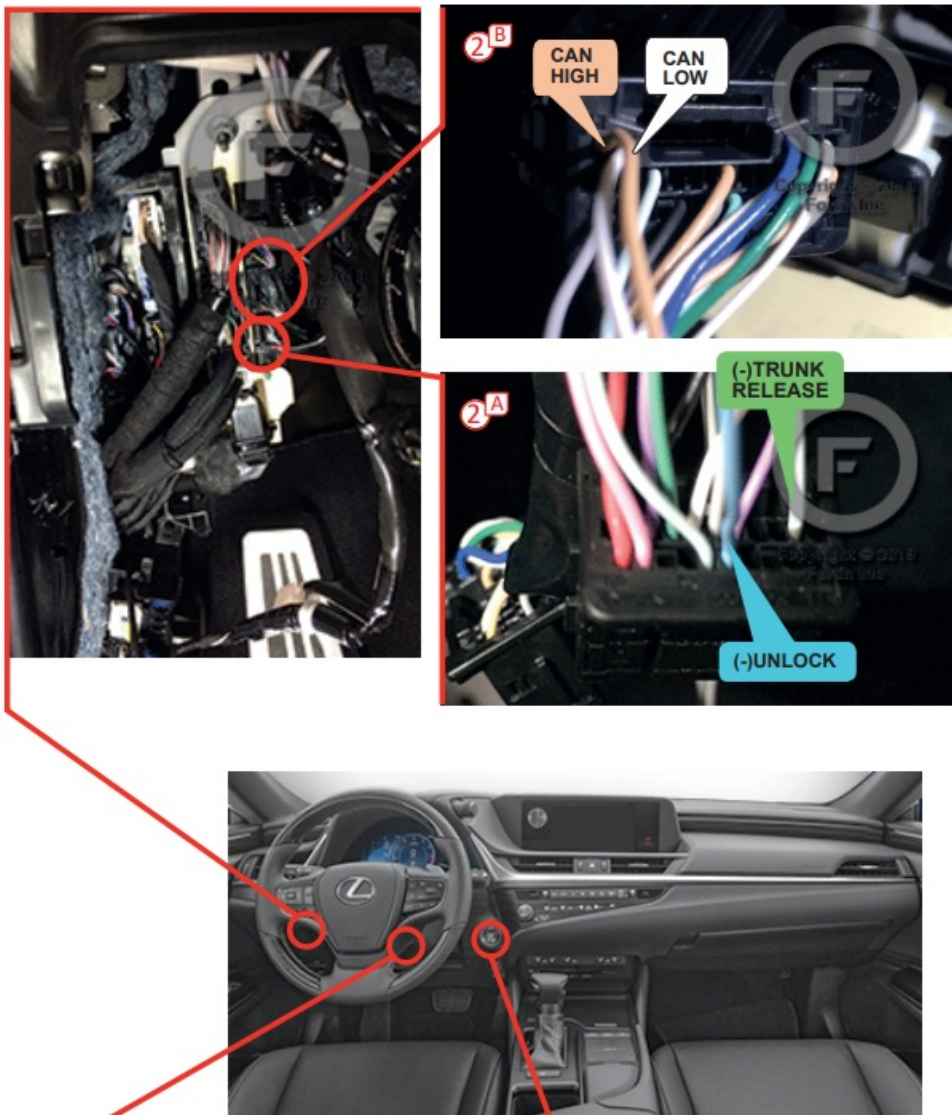

③ ① At Steering Column
À la colonne de direction



④ At push-to-start button
Au bouton poussoir

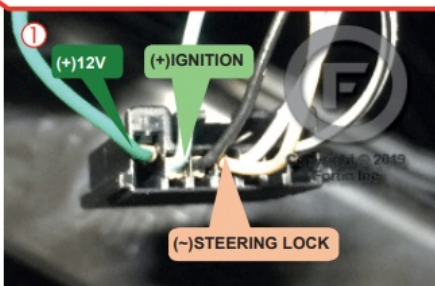
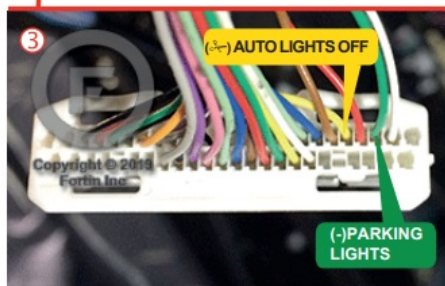
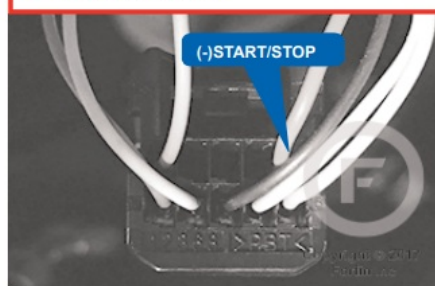

WIRING CONNECTION

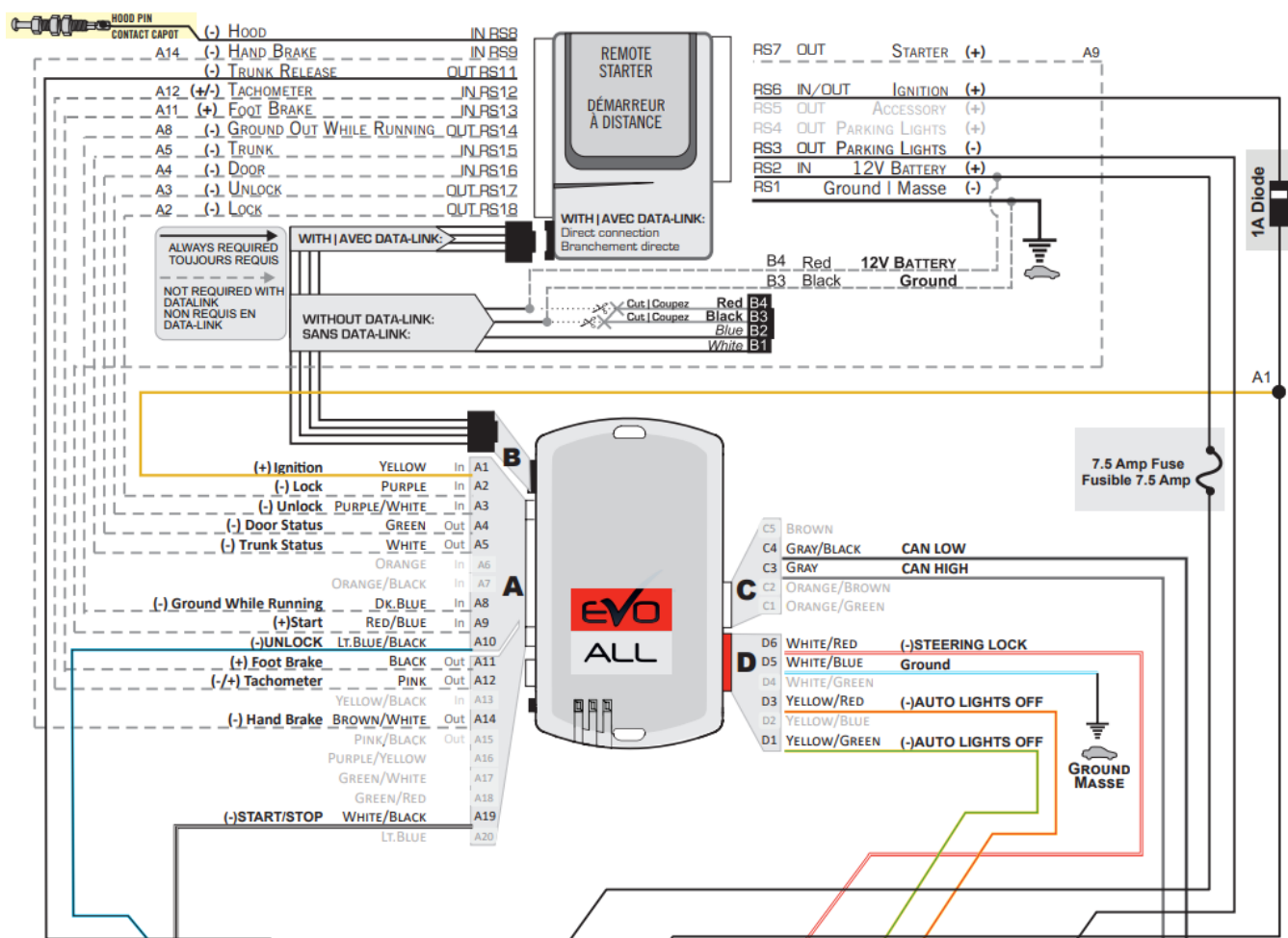

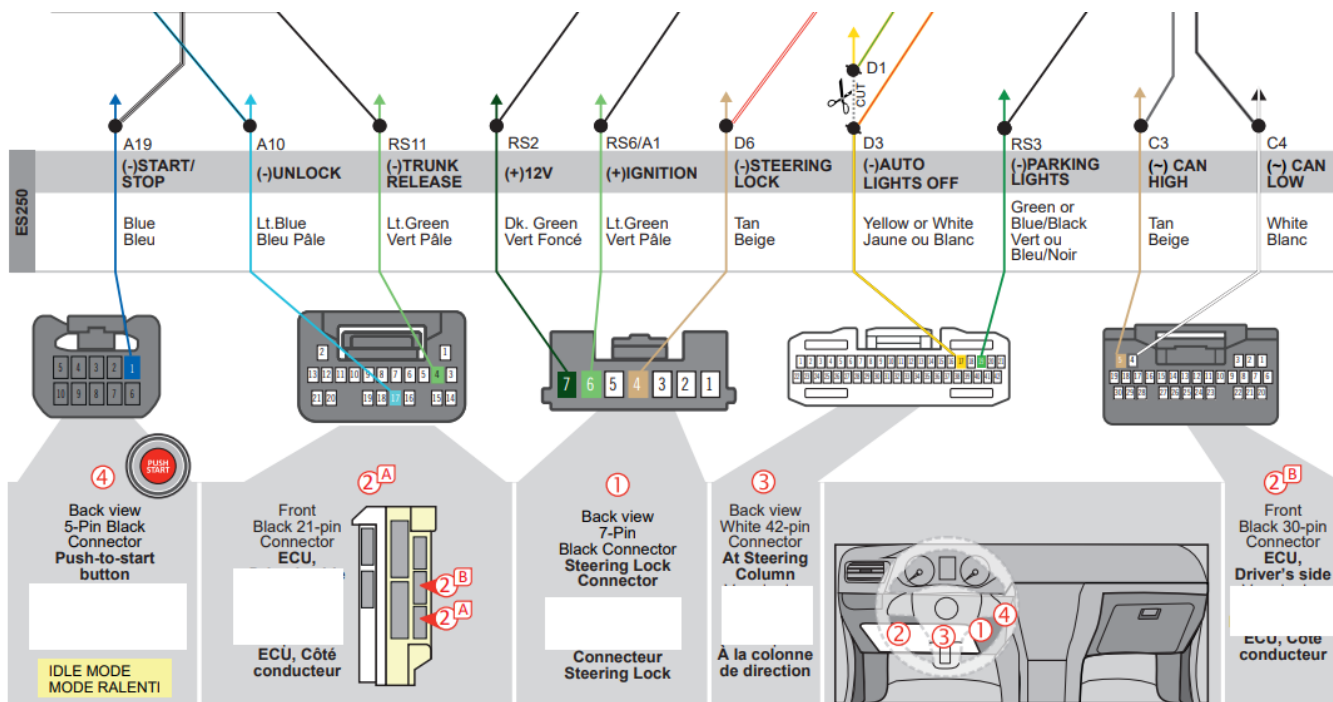

DCRYPTOR PROGRAMMING PROCEDURE

Parts required (not included)

- 1x **FLASH LINK UPDATER**, **FLASH LINK MANAGER** SOFTWARE | PROGRAMME
- 1x Microsoft Windows Computer with Internet connection
Ordinateur Microsoft Windows avec connection Internet

Pièces requises (non incluses)

- 1x **FLASH LINK MOBILE**
- 1x **FLASH LINK MOBILE APP**
- 1x Smartphone Android or iOS with Internet connection
(Internet provider charges may apply)
Téléphone Intelligent Android ou iOS avec connection Internet (des frais du fournisseur Internet peuvent s'appliquer)

OR OU

DCRYPTOR TECHNOLOGY

BEFORE PROGRAMMING SET THE UNIT OPTIONS AND SAVE.

1

2

3

Press and hold the programming button: Connect the 4-PIN Data-link connector.

↳The BLUE, RED, YELLOW and BLUE & RED LEDs will alternatively illuminate.

Release the programming button when the LED is BLUE.

If the LED is not solid BLUE disconnect the 4-Pin connector (Data-Link) and go back to step 1.

Insert the required remaining connectors.

4

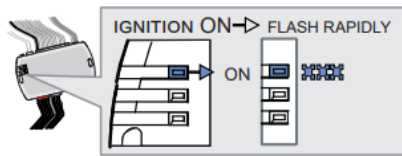
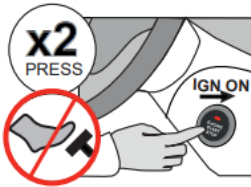

Do not press the brake pedal.
Press the Push-to-Start button twice to turn on the ignition.

↳ Wait for the **BLUE LED** to flash rapidly and constantly.

5

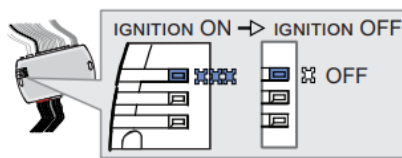
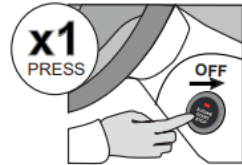

Press the Push-to-Start button once to turn off the ignition.

↳ The **BLUE LED** will turn off.

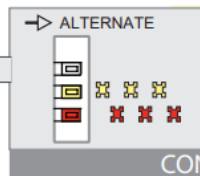

↳ If the **RED** and **YELLOW** LEDs alternate:

GO STEP 6 at Dcryptor process.

CONTINUED NEXT PAGE |

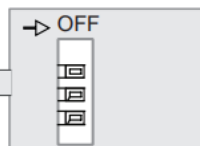

↳ If the **LEDS** turn **OFF**:

The module is now programmed.



KEY BYPASS PROGRAMMING PROCEDURE 2/2

6

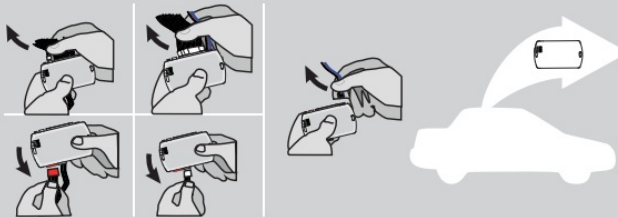

Disconnect all the connectors and after the Data-Link (4-pins) connector.

7

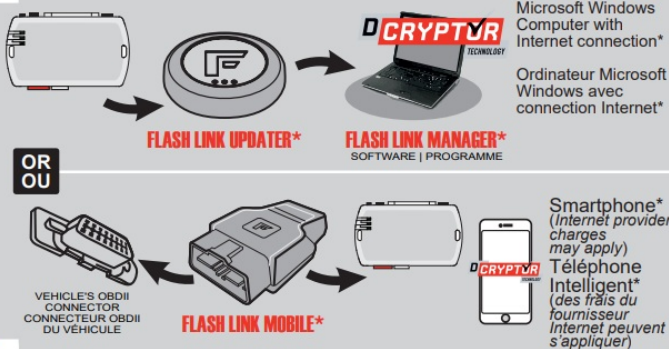

Use the tool:
FLASH LINK UPDATER or
FLASH LINK MOBILE
to visit the DCryptor menu.

*Parts required (not included)

8

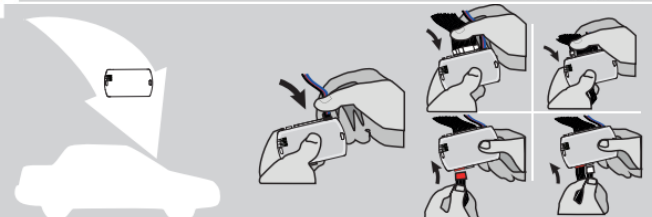

AFTER DCRYPTOR PROGRAMMING COMPLETED
Go back to the vehicle and **reconnect** the 4-Pin (Data-Link) connector and after, all the remaining connector.



The module is now programmed.
Le module est programmé.



REMOTE STARTER / ALARM VERIFICATION

REMOTE STARTER FUNCTIONALITY |

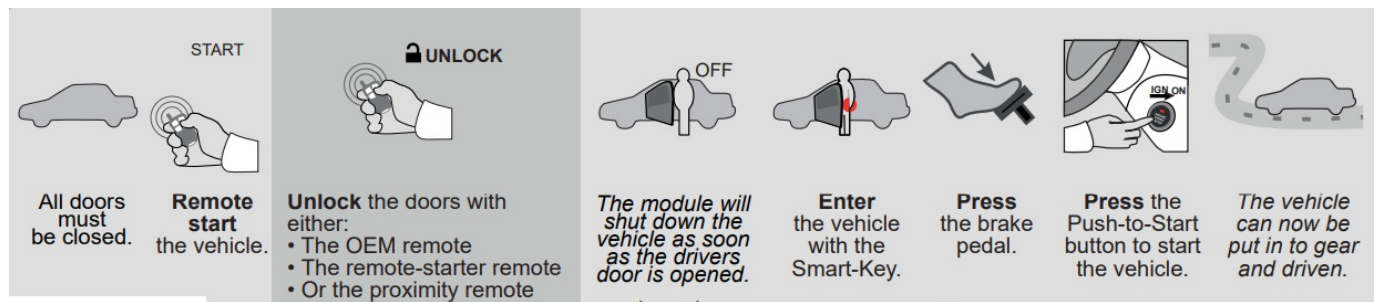

Module label

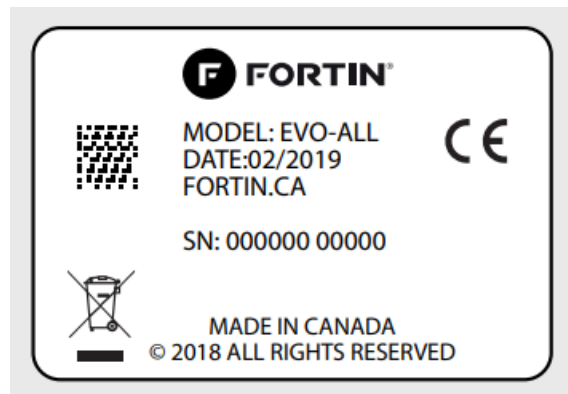

Notice: Updated Firmware and Installation Guides

Updated firmware and installation guides are posted on our web site on a regular basis. We recommend that you update this module to the latest firmware and download the latest installation guide(s) prior to the installation of this product.

WARNING

The information on this sheet is provided on an (as is) basis with no representation or warranty of accuracy whatsoever. It is the sole responsibility of the installer to check and verify any circuit before connecting to it. Only a computer safe logic probe or digital multimeter should be used. FORTIN ELECTRONIC SYSTEMS assumes absolutely no liability or responsibility whatsoever pertaining to the accuracy or currency of the information supplied. The installation in every case is the sole responsibility of the installer performing the work and FORTIN ELECTRONIC SYSTEMS assumes no liability or responsibility whatsoever resulting from any type of installation, whether performed properly, improperly or any other way. Neither the manufacturer or distributor of this module is responsible of damages of any kind indirectly or directly caused by this module, except for the replacement of this module in case of manufacturing defects. This module must be installed by qualified technician. The information supplied is a guide only. This instruction guide may change without notice. Visit www.fortinbypass.com to get the latest version.

TECH SUPPORT

Tél: 514-255-HELP (4357)

1-877-336-7797

ADDENDUM GUIDE

www.fortinbypass.com

WEB UPDATE

Documents / Resources

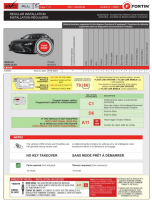

[FORTIN 2020 EVO ALL Push Button Remote Starters and Alarm Systems](#) [pdf] Installation Guide

2020, 2020 EVO ALL Push Button Remote Starters and Alarm Systems, EVO ALL Push Button Remote Starters and Alarm Systems, Push Button Remote Starters and Alarm Systems, Button Remote Starters and Alarm Systems, Remote Starters and Alarm Systems, Starters and Alarm Systems, Alarm Systems, Systems

References

- **[User Manual](#)**

Manuals+, Privacy Policy

This website is an independent publication and is neither affiliated with nor endorsed by any of the trademark owners. The "Bluetooth®" word mark and logos are registered trademarks owned by Bluetooth SIG, Inc. The "Wi-Fi®" word mark and logos are registered trademarks owned by the Wi-Fi Alliance. Any use of these marks on this website does not imply any affiliation with or endorsement.