

FORTE MFF2023\_IM Multi Purpose Shelf with Integrated Desk



# FORTE MFF2023\_IM Multi Purpose Shelf with Integrated Desk Instruction Manual

[Home](#) » [FORTE](#) » FORTE MFF2023\_IM Multi Purpose Shelf with Integrated Desk Instruction Manual 

## Contents

- [1 FORTE MFF2023\\_IM Multi Purpose Shelf with Integrated Desk](#)
- [2 Product Information](#)
- [3 Product Usage Instructions](#)
- [4 Dimension](#)
- [5 Assembly Plan](#)
- [6 Parts](#)
- [7 HARDWARE LIST](#)
- [8 Assembling instruction](#)
- [9 Documents / Resources](#)
  - [9.1 References](#)

# FORTE

FORTE MFF2023\_IM Multi Purpose Shelf with Integrated Desk



## Product Information

### Product Specifications:

- **Model:** MFF2023
- **Assembling Time:** 180 minutes
- **Weight Capacity:** max 15 kg (upper shelf), max 50 kg (lower shelf)
- **Dimensions:** 420 x 1594 x 1036 mm

## Product Usage Instructions

### Assembling the Furniture:

Follow the assembling instructions provided in the manual to ensure safety and proper setup of the furniture.

### Ventilation After Assembly:

After assembling the furniture, it is recommended to ventilate the room where the furniture is placed for about four weeks or until any manufacturing odours dissipate.

### Avoid Overloading:

Make sure not to exceed the weight capacity limits specified for each shelf to prevent damage or accidents.

### FAQ:

- **Q: What should I do if I encounter any difficulties during assembly?**

A: If you face challenges during assembly, refer to the manual for troubleshooting tips or contact customer support for assistance.

- **Q: Can I disassemble the furniture once it's assembled?**

A: It is possible to disassemble the furniture following the reverse of the assembly steps. Take care to keep track of all parts for reassembly.

## Dimension

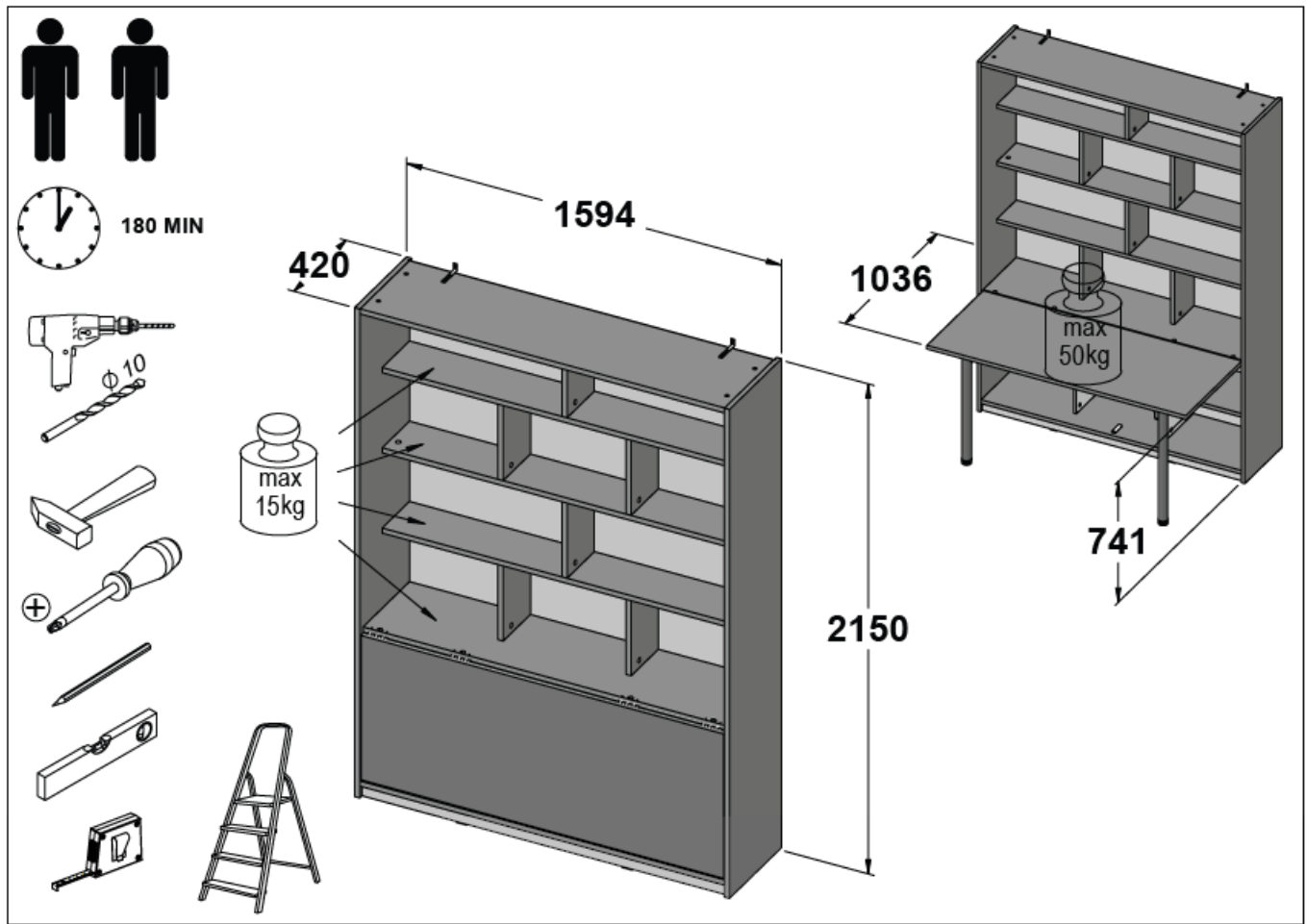

Follow the manufacturer's assembly instructions, otherwise, danger may occur.

## Assembly Plan

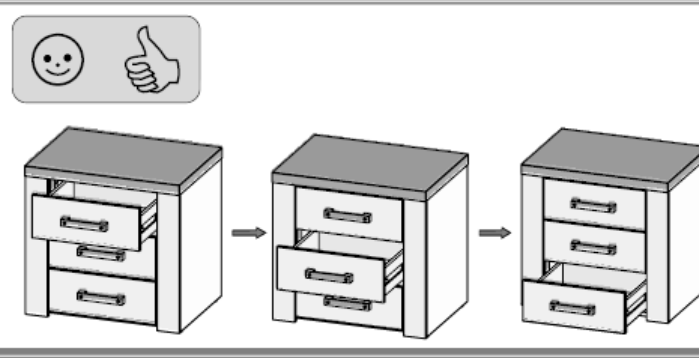
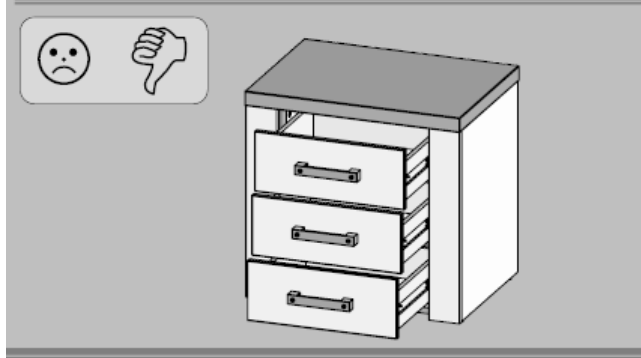
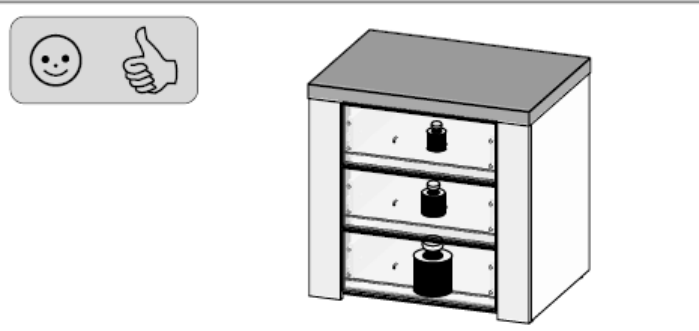
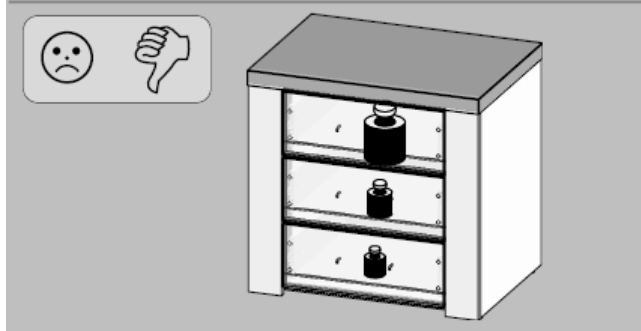
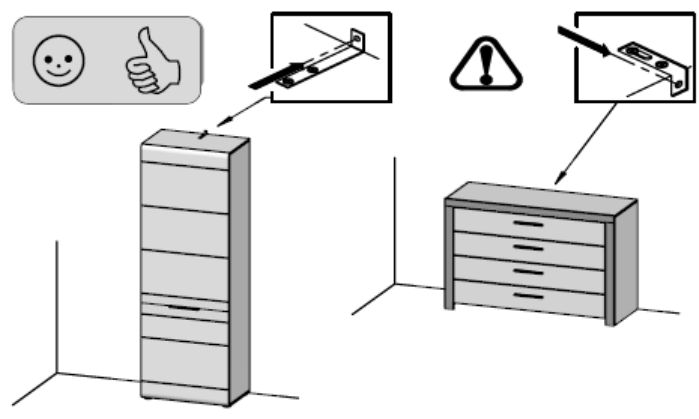
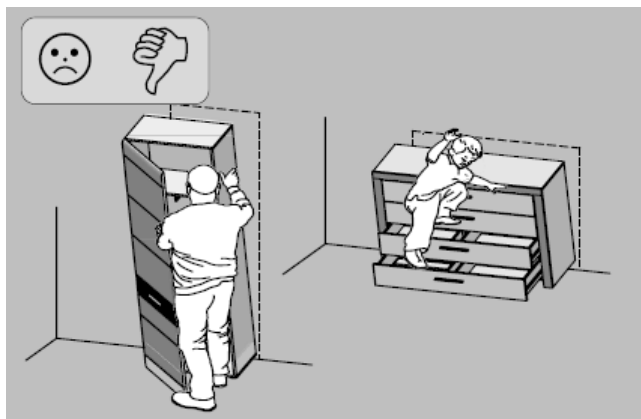

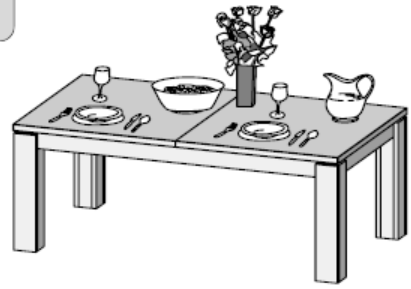
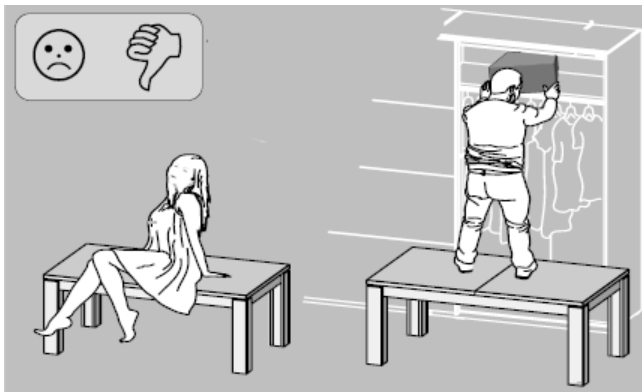

2/34

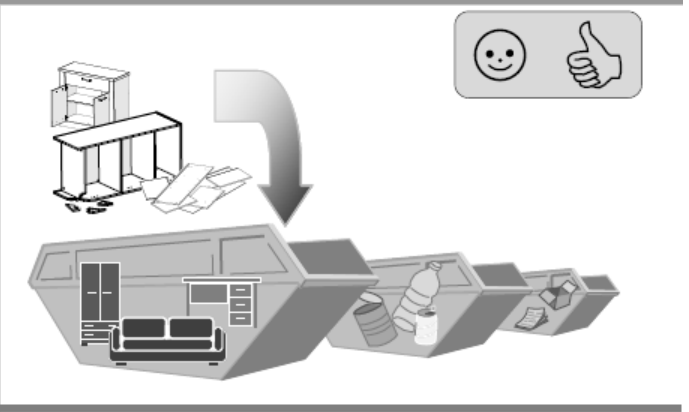
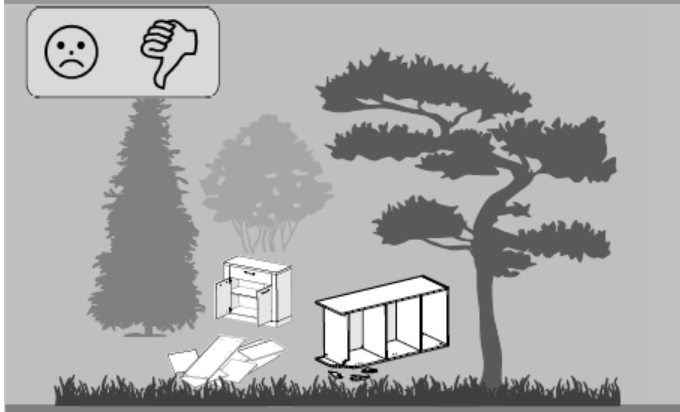

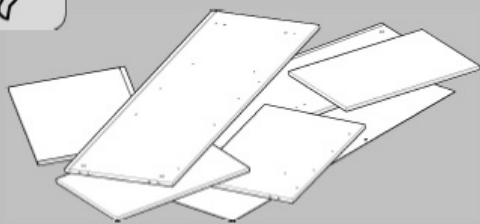
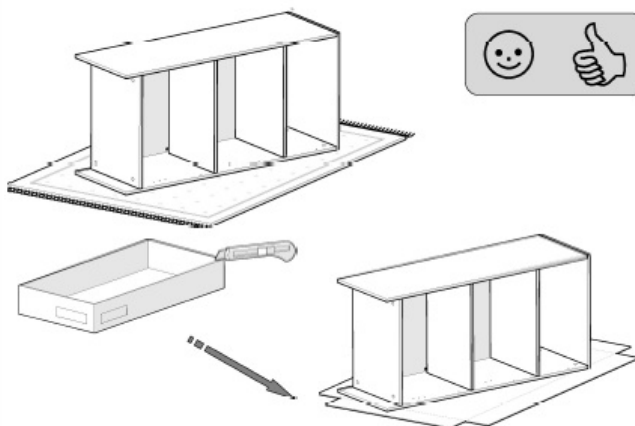
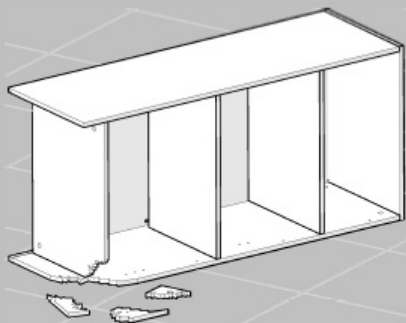
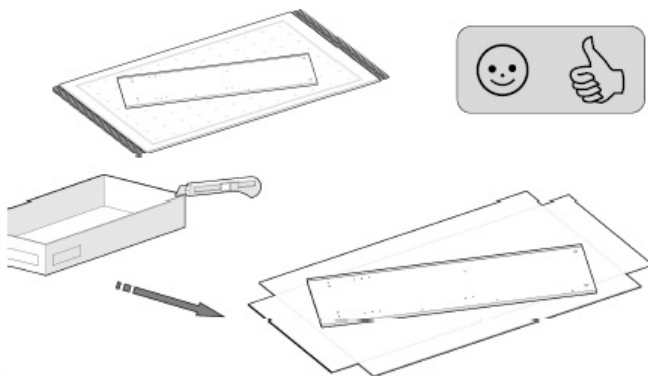
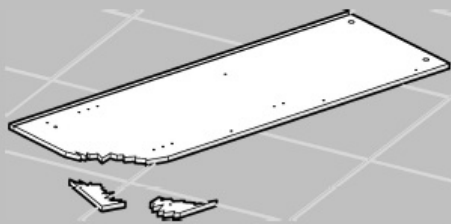

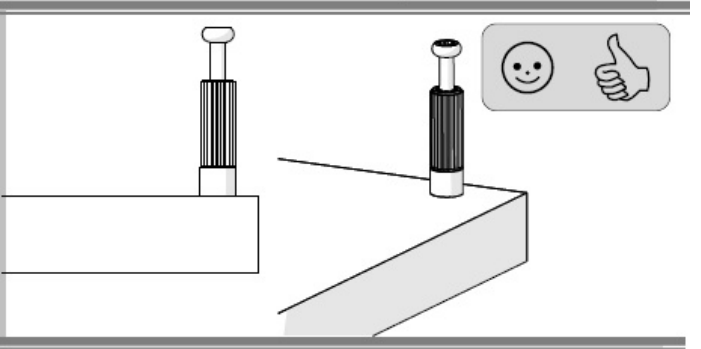
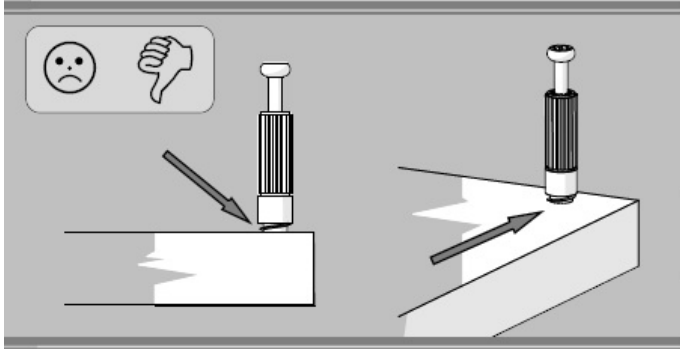
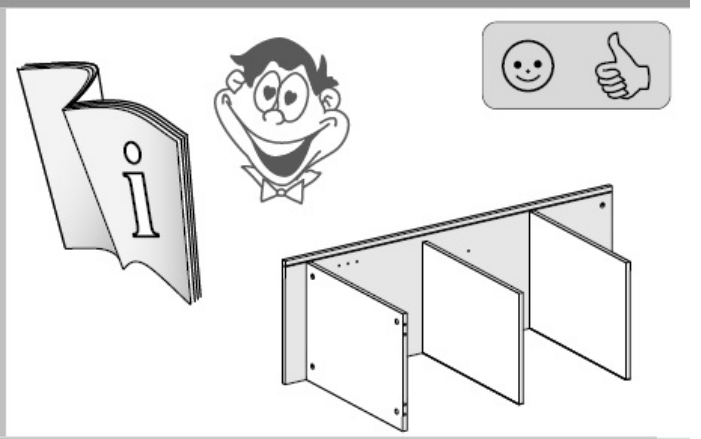
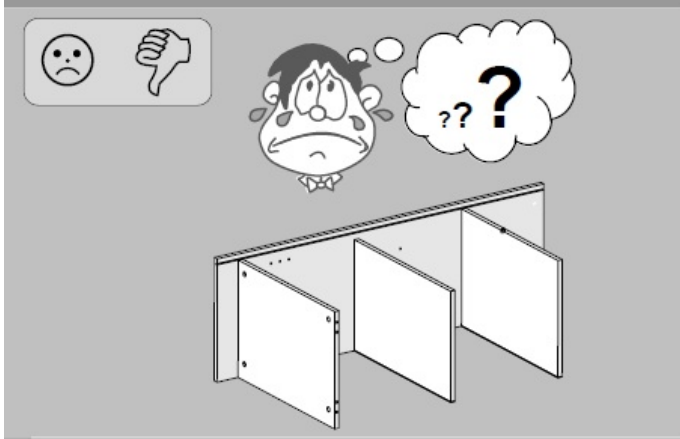
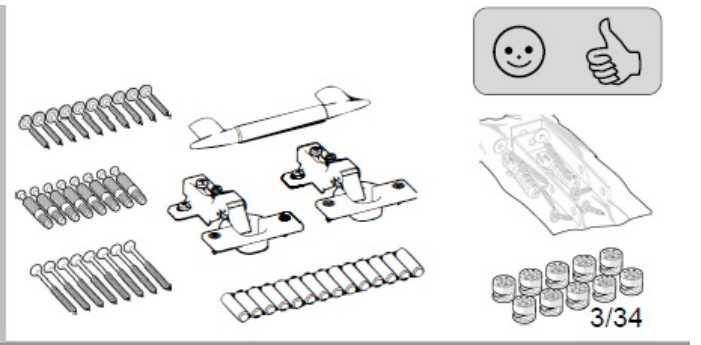
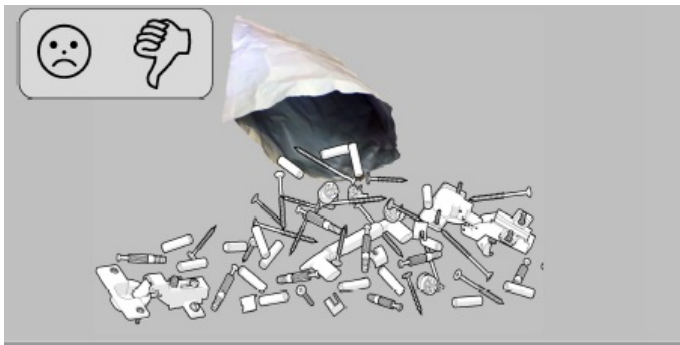

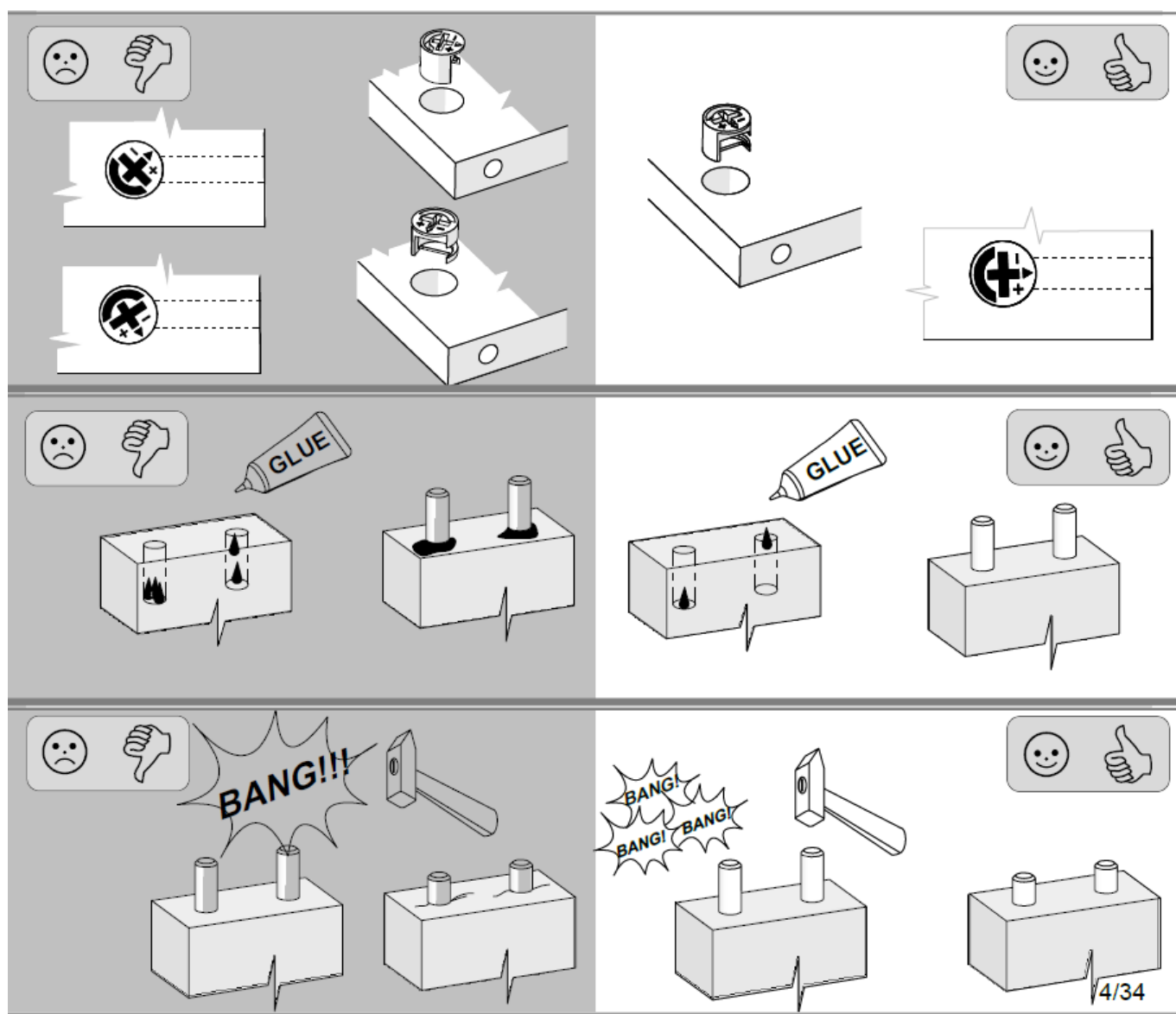

Furniture containing wood-based panels (particle board, fibreboard, plywood etc.) may emit into indoor air inconsiderable amounts of substances used in the production processes. The level of this emission is examined and it meets the applicable standards. After assembling the furniture, it is advised to regularly ventilate the room where the furniture stands, which should last about four weeks or until the smell is eliminated.

## Service

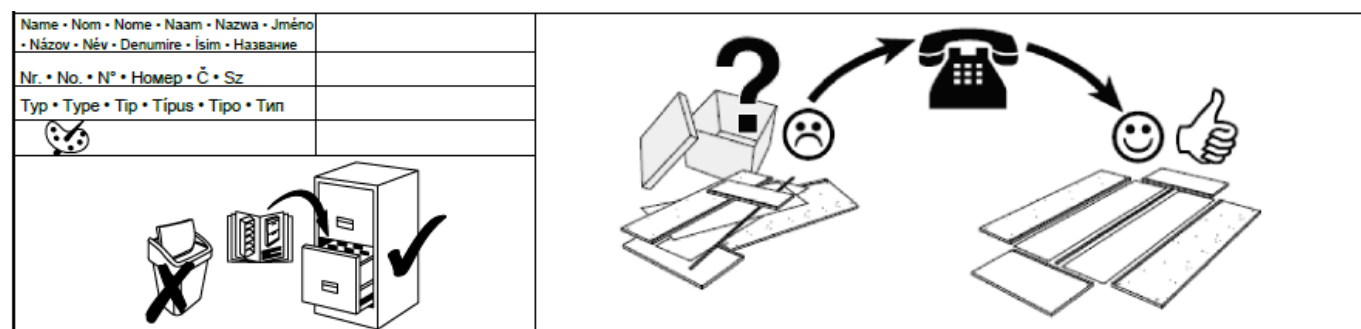

## Parts



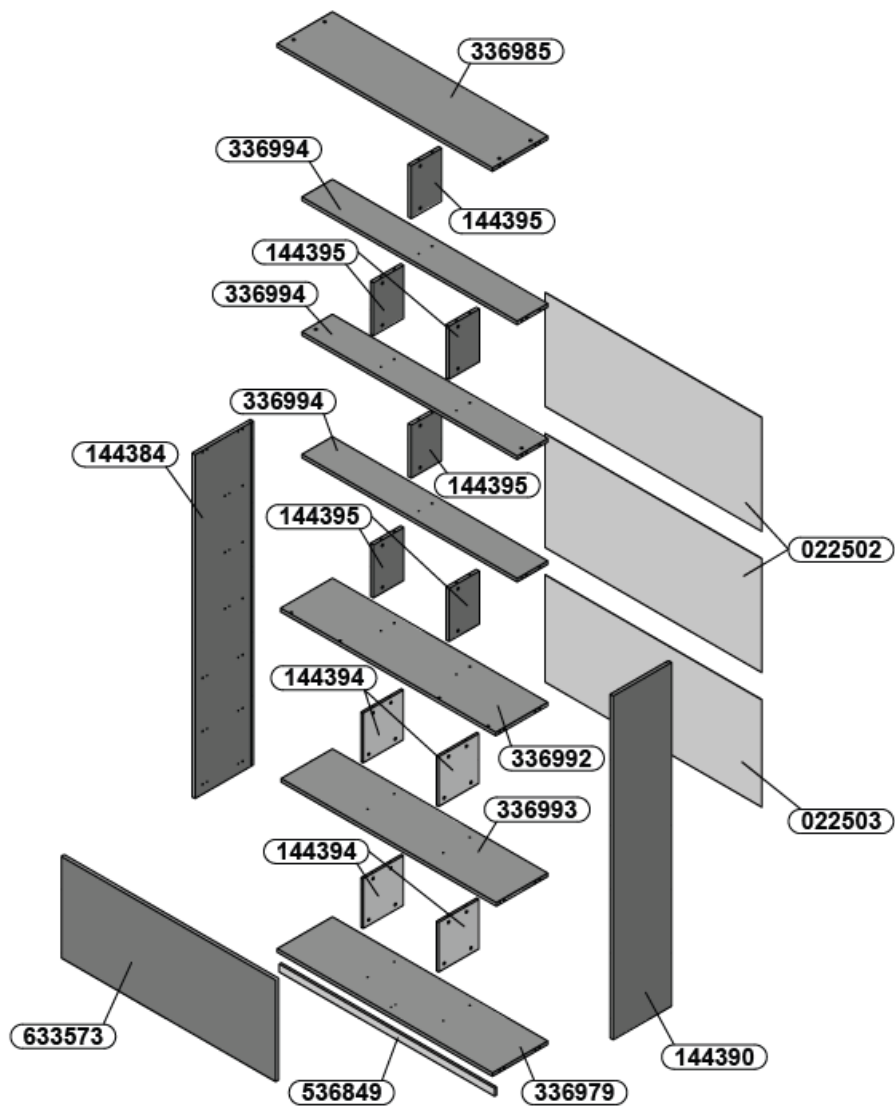

<b>CODE</b>	<b>DIMENSIONS</b>	<b>Colli-000 1</b>	<b>Colli-000 2</b>	<b>Colli-000 3</b>	<b>Colli-000 4</b>	<b>Colli-000 5</b>
<b>022502</b>	1560x711x2			<b>2</b>		
<b>022503</b>	1560x670x2			<b>1</b>		
<b>144384</b>	2145x420x22		<b>1</b>			
<b>144390</b>	2145x420x22		<b>1</b>			
<b>144394</b>	310x290x15	<b>4</b>				
<b>144395</b>	330x219x22			<b>6</b>		
<b>336979</b>	1550x399x22				<b>1</b>	
<b>336985</b>	1550x399x22				<b>1</b>	
<b>336992</b>	1550x374x22	<b>1</b>				
<b>336993</b>	1550x370x22	<b>1</b>				
<b>336994</b>	1550x220x22					<b>3</b>
<b>536849</b>	1550x50x15	<b>1</b>				
<b>633573</b>	1544x636x22			<b>1</b>		

## **HARDWARE LIST**

40x S70969 Ø8x28		50x S30211		16x S30212 Ø15x12		34x S30205 Ø15x16	
3x S34701 Ø4x14		4x S30167 Ø4x20		20x S30150 Ø4x20		4x S31298-14 Ø4x14	
8x S30111 Ø6,3x13		12x S30140 Ø6,3x20		8x S30142 M4x9		70x S31299 Ø1,6x30	
4x S34657-15 Ø5x12		6x S34702		2x S36177		42x S3xxxx	
4x S3iiii Ø20		20x S30312		6x S30978		4x S37526	
2x S38802		1x S30577		2x S32892-N			
2x S36628 Ø10x50, Ø5x60				1x S38147			
4x S39553				2x S39552			

## Assembling instruction

**1**  
**4x**

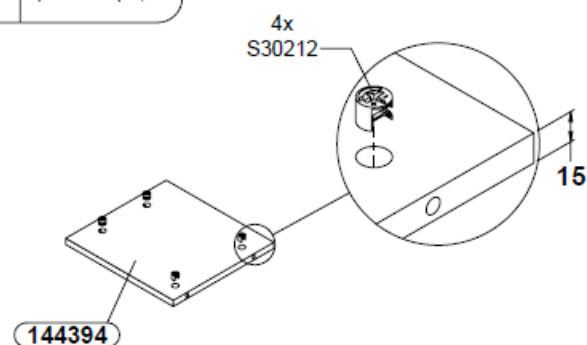
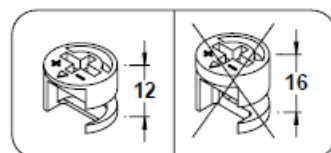

**2**

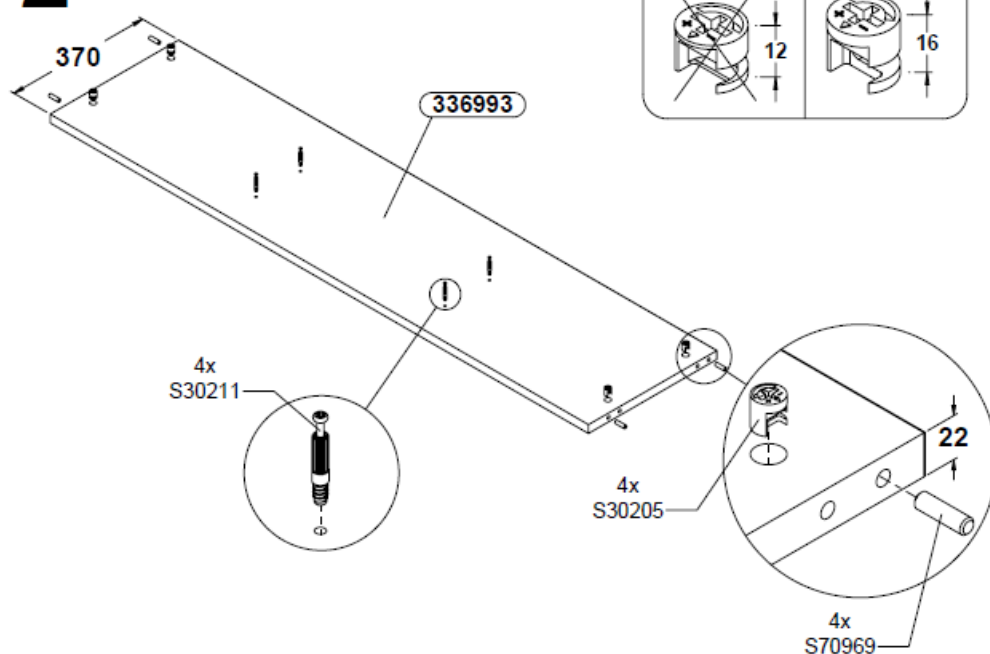
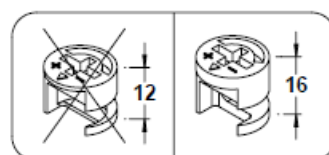

# 3

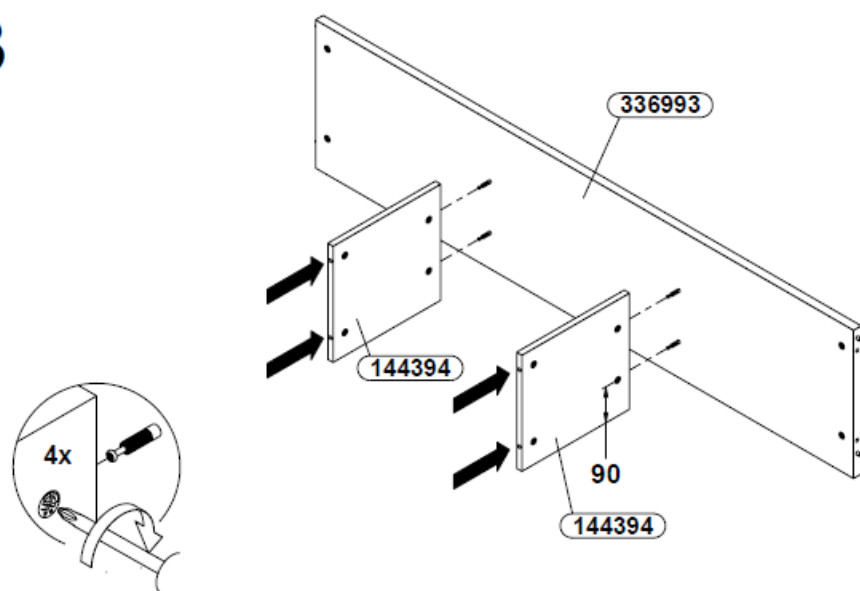

# 4

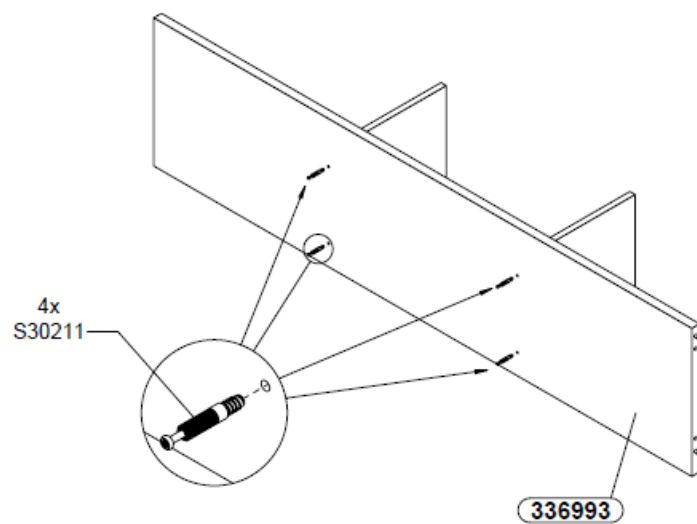

# 5

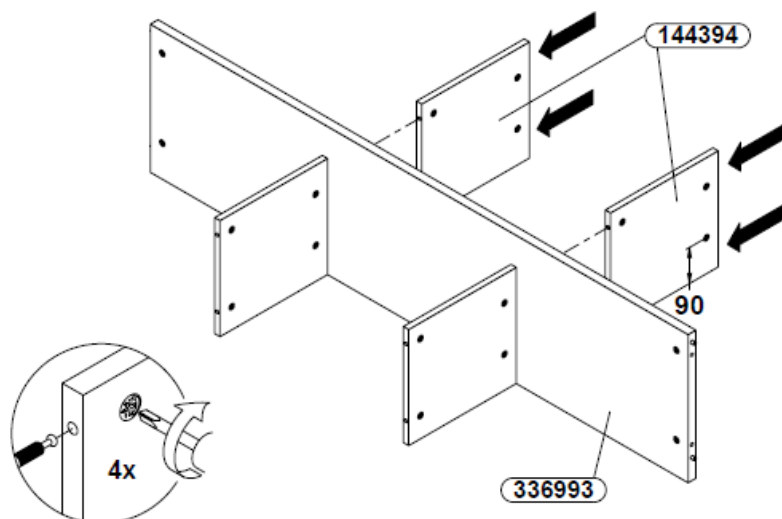

# 6

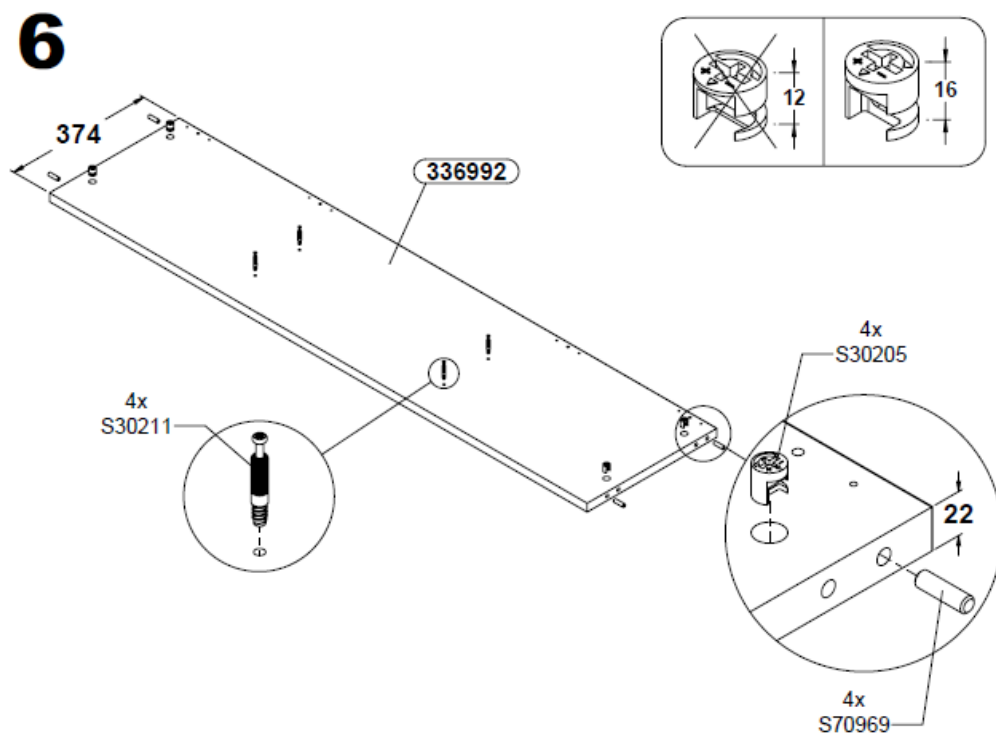

7

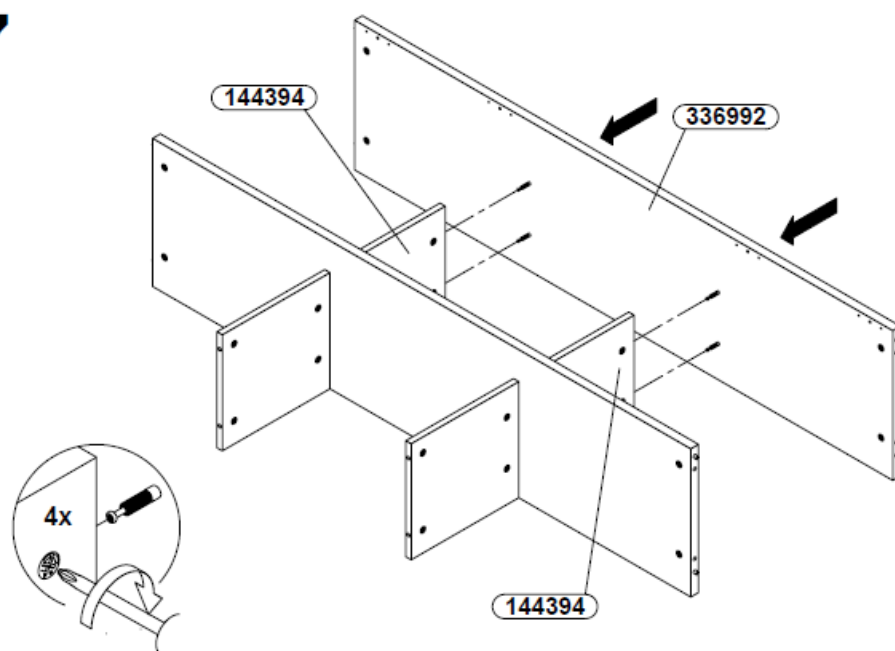

8

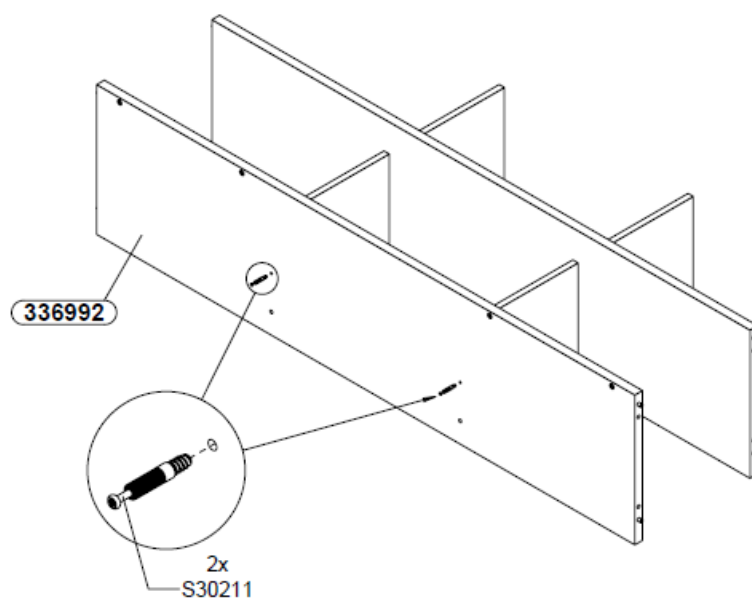

**9**  
**6x**

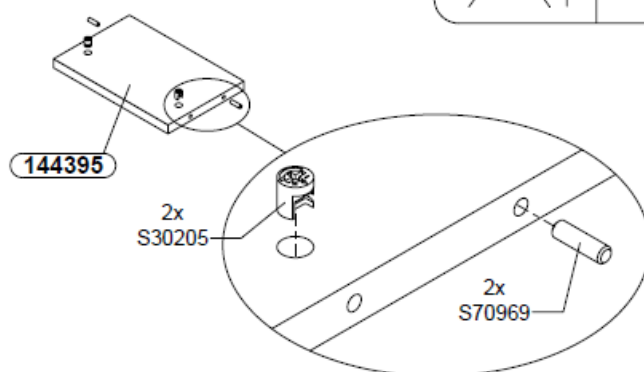
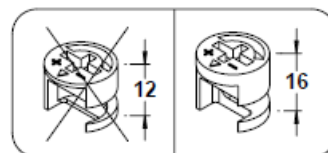

**10**

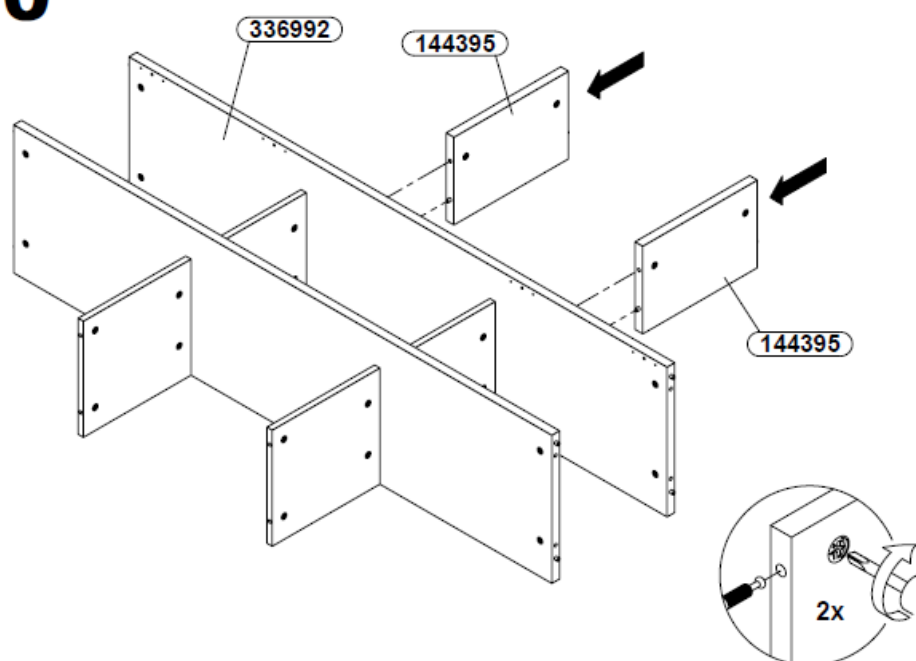



**11**  
**2x**

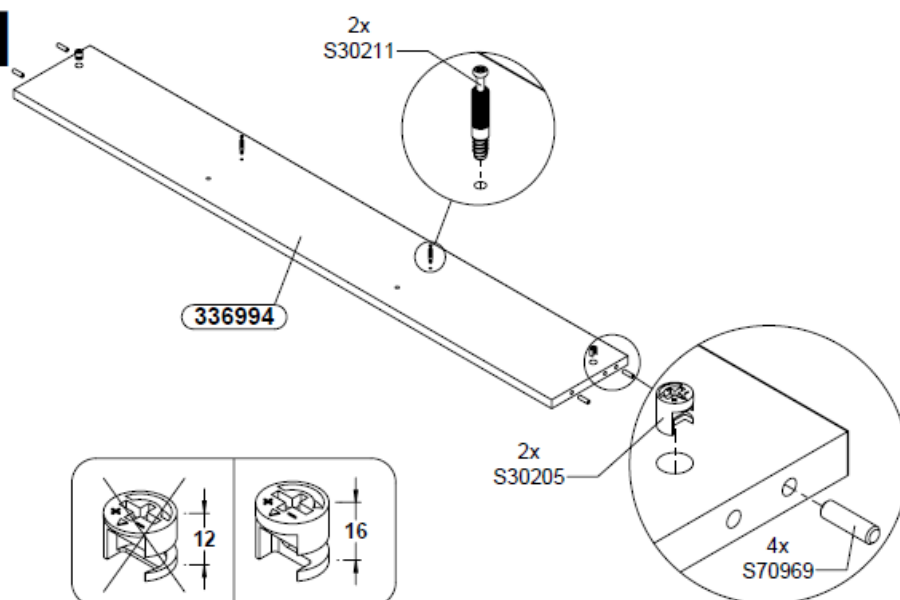

**12**

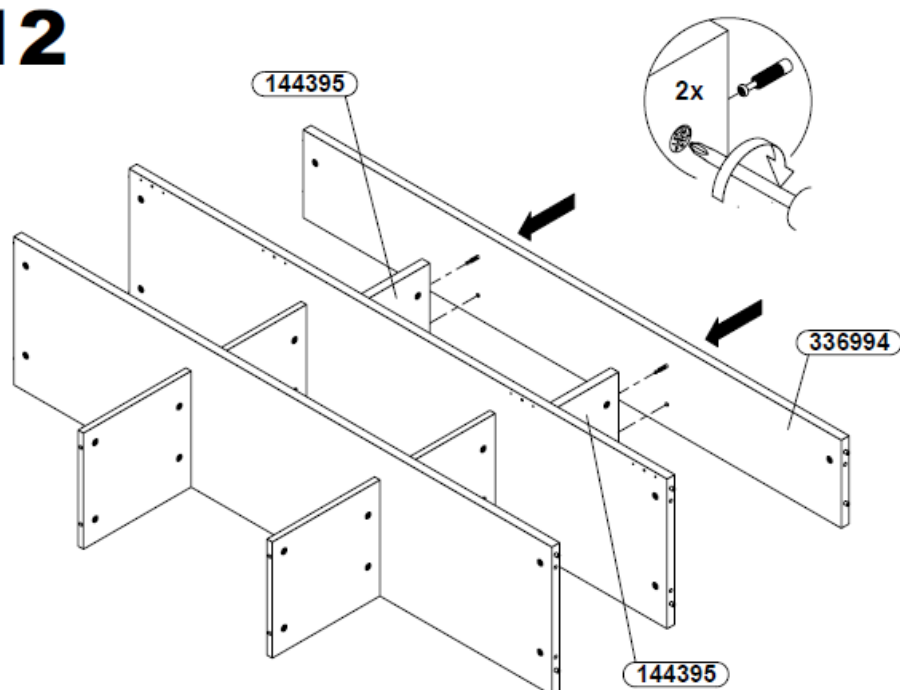

# 13

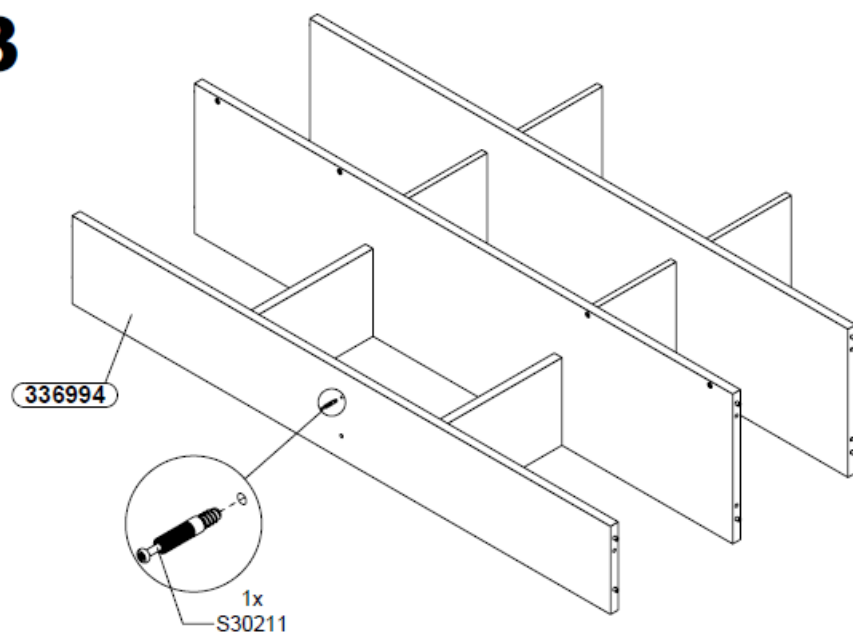

# 14

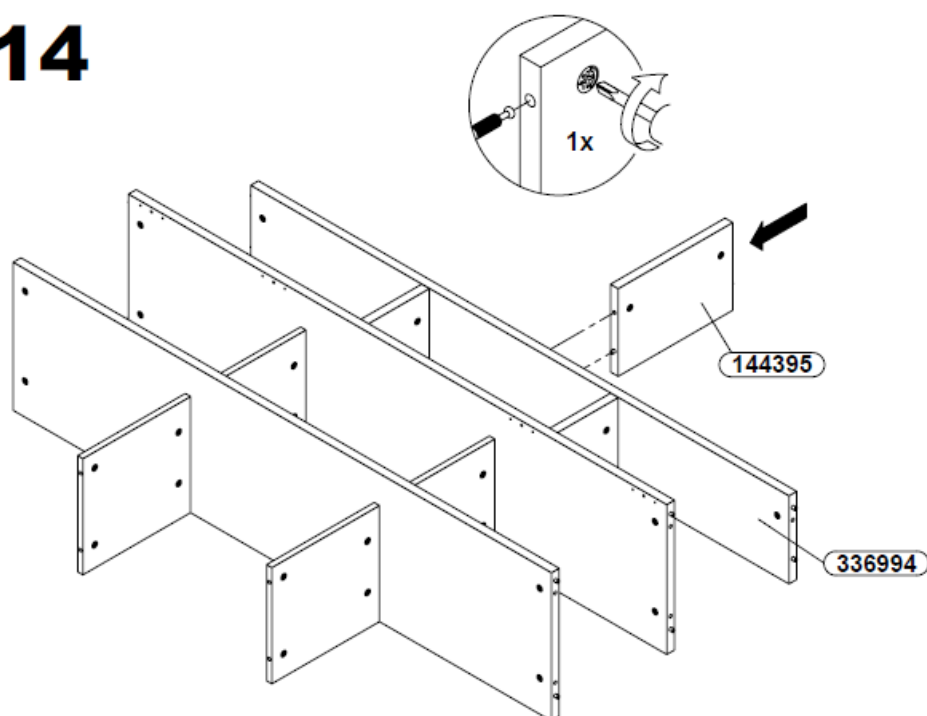

**15**  
**1x**

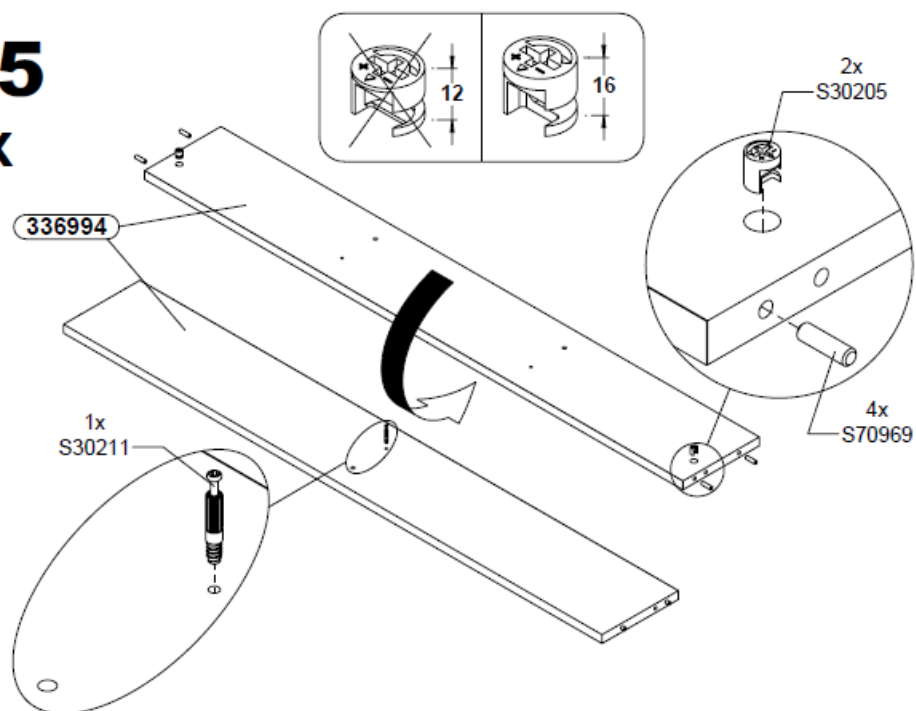

**16**

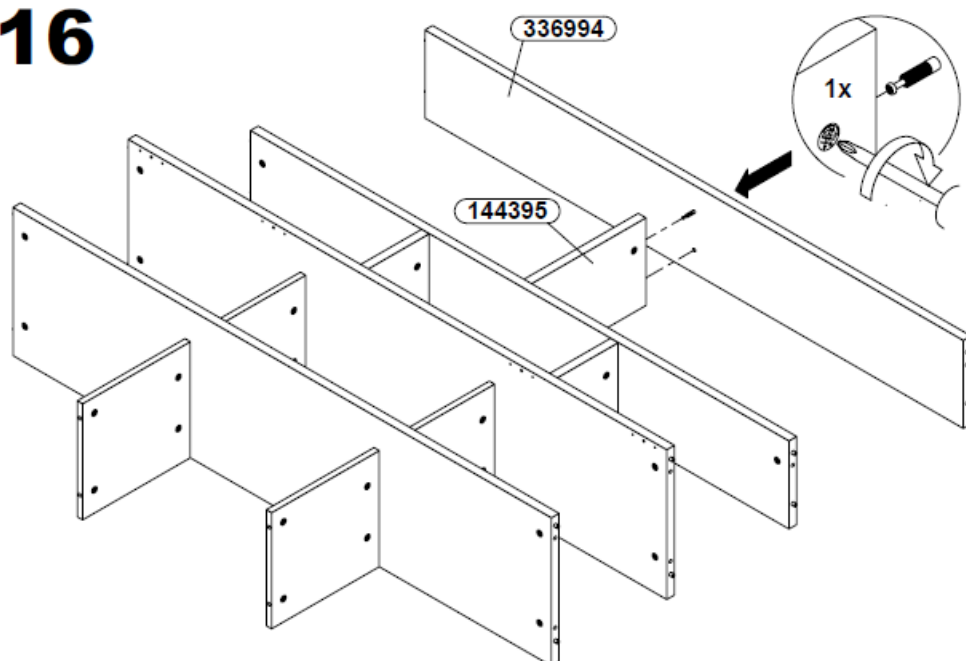

# 17

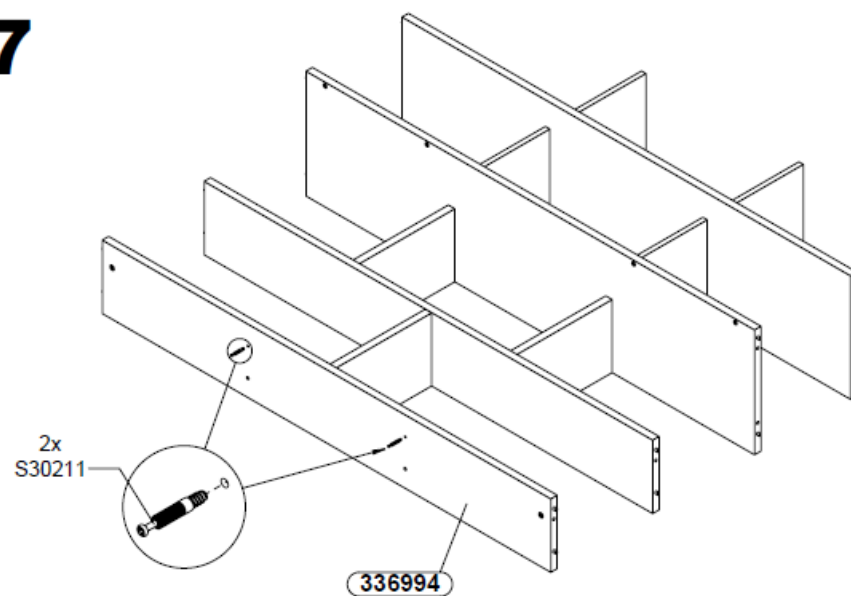

# 18

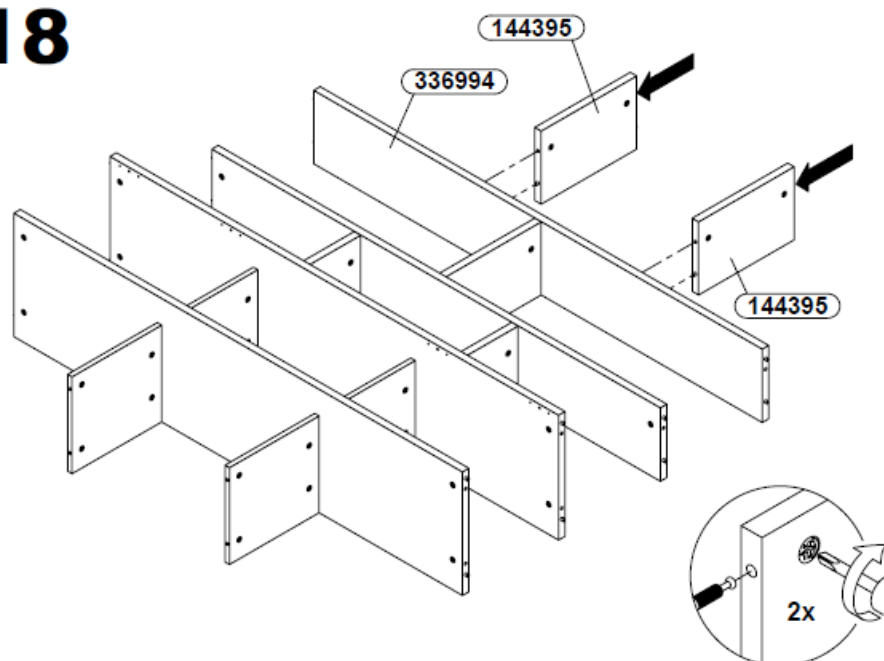

# 19

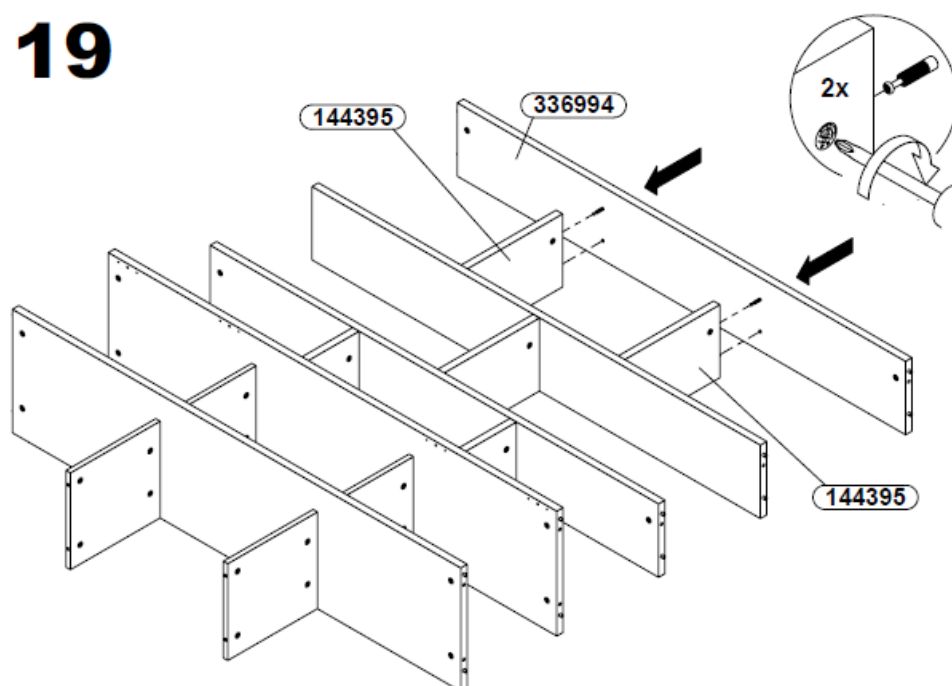

# 20

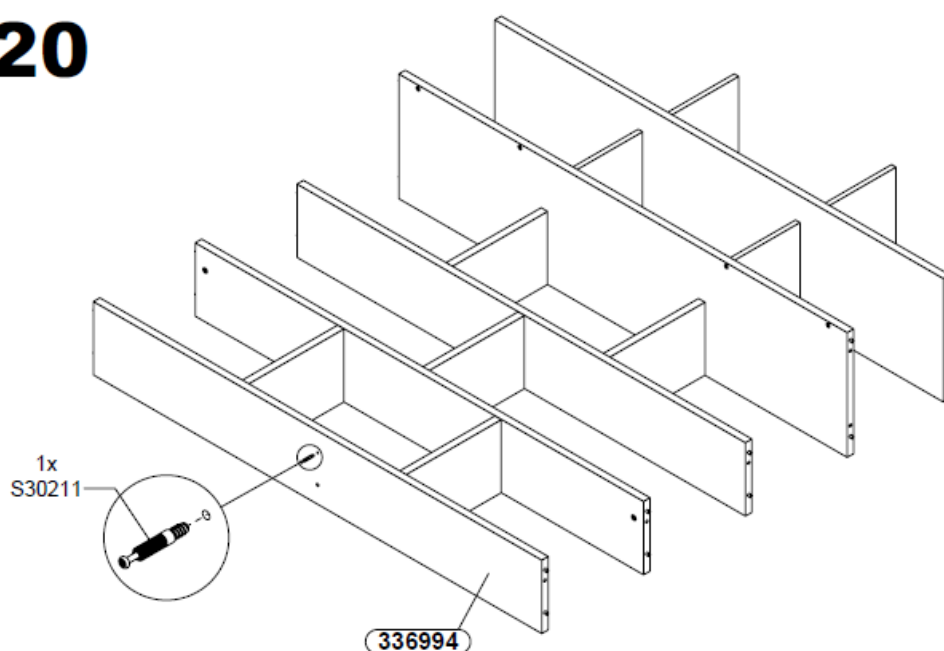

# 21

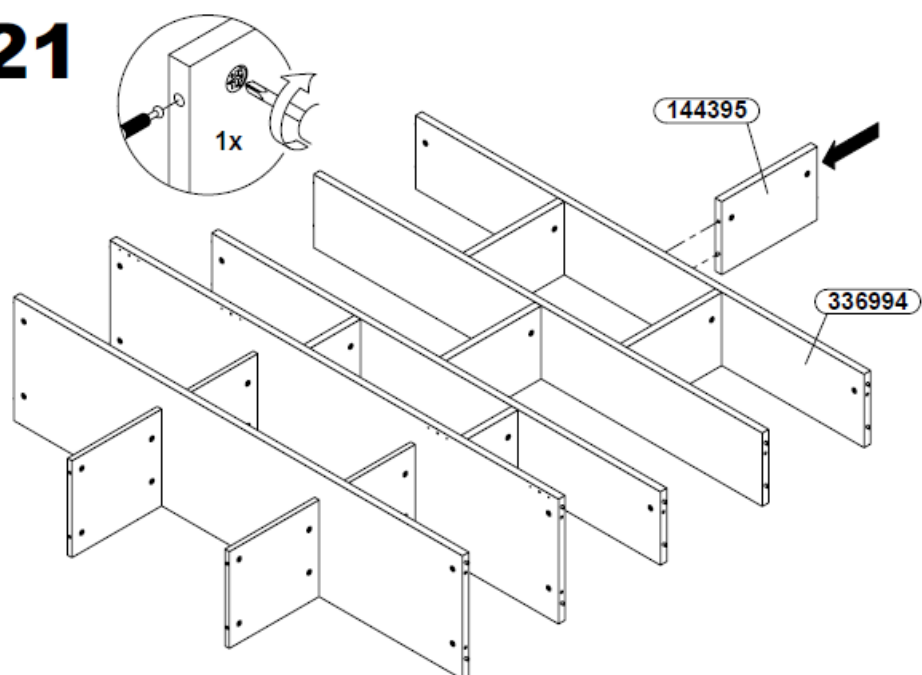

# 22

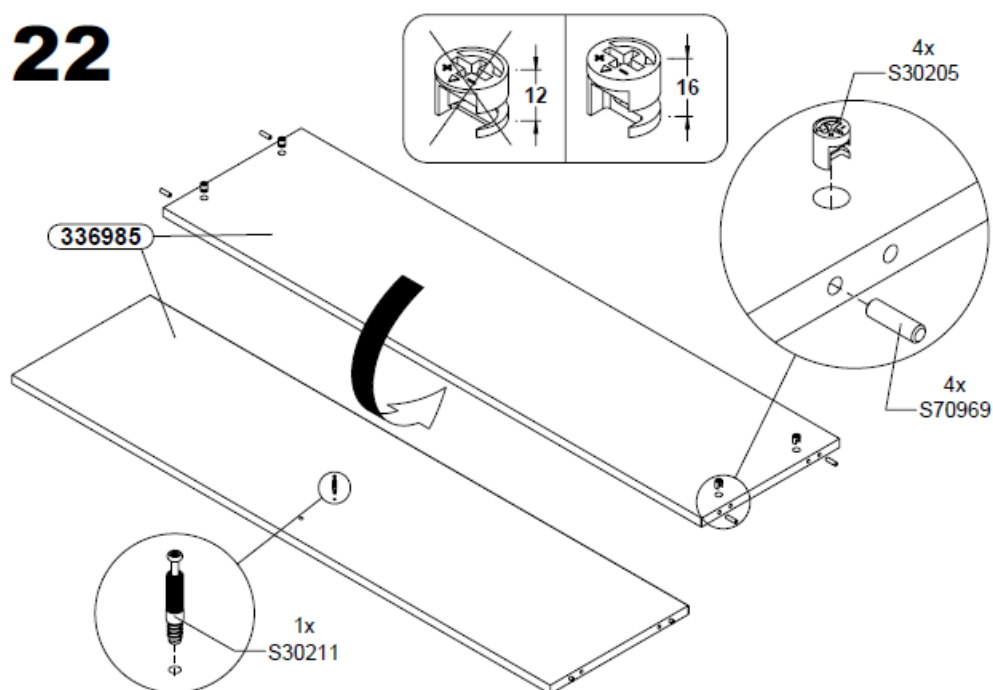

# 23

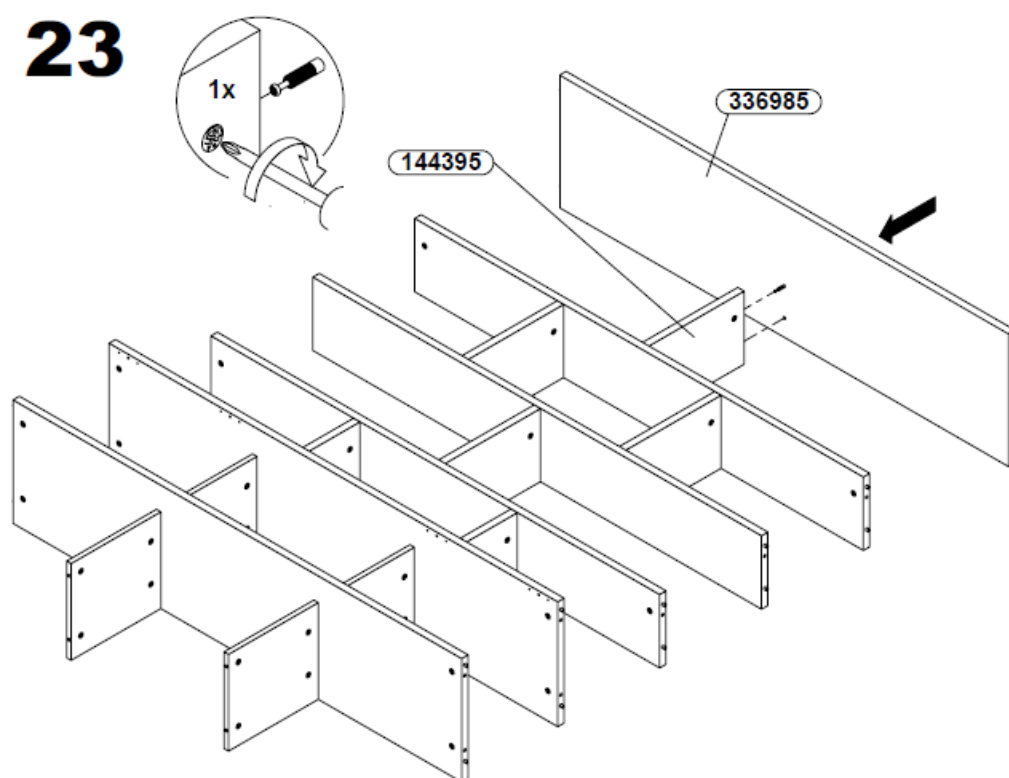

# 24

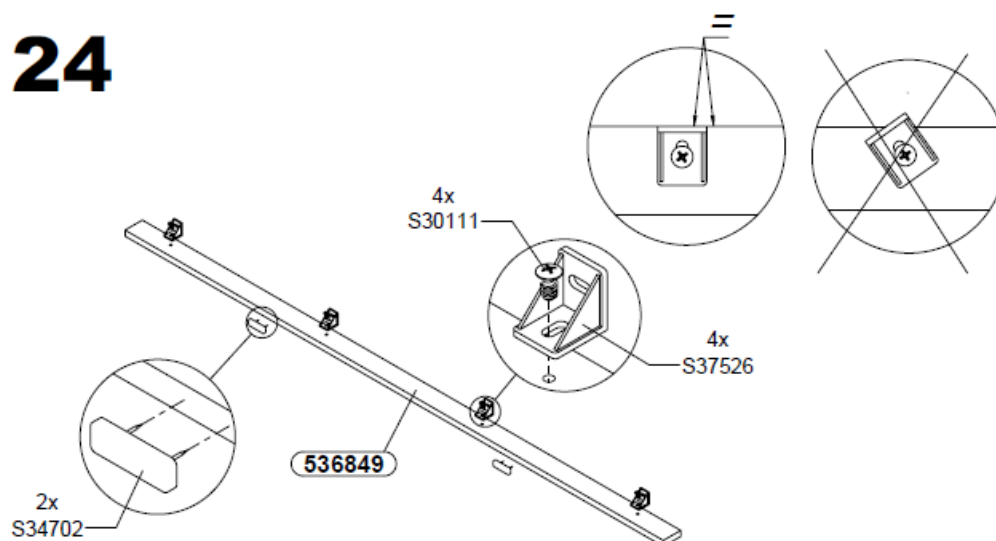

# 25

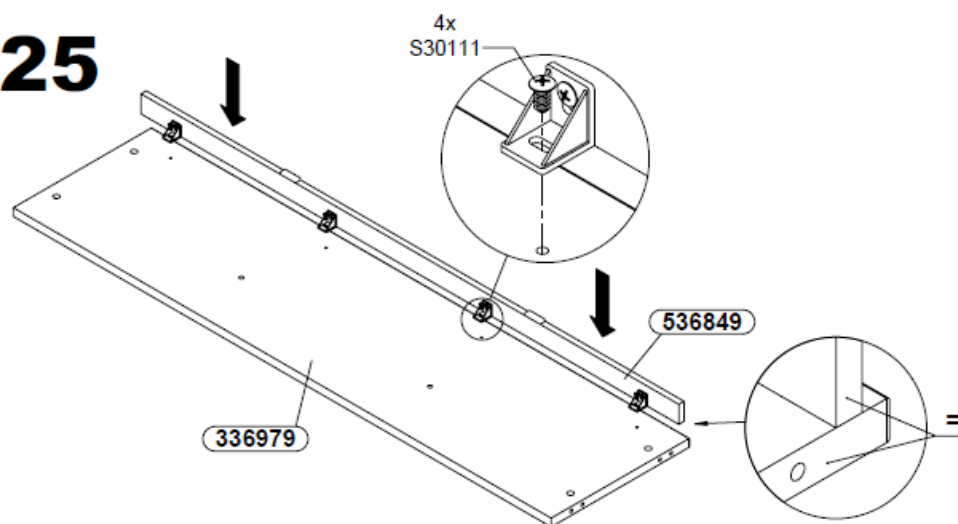

# 26

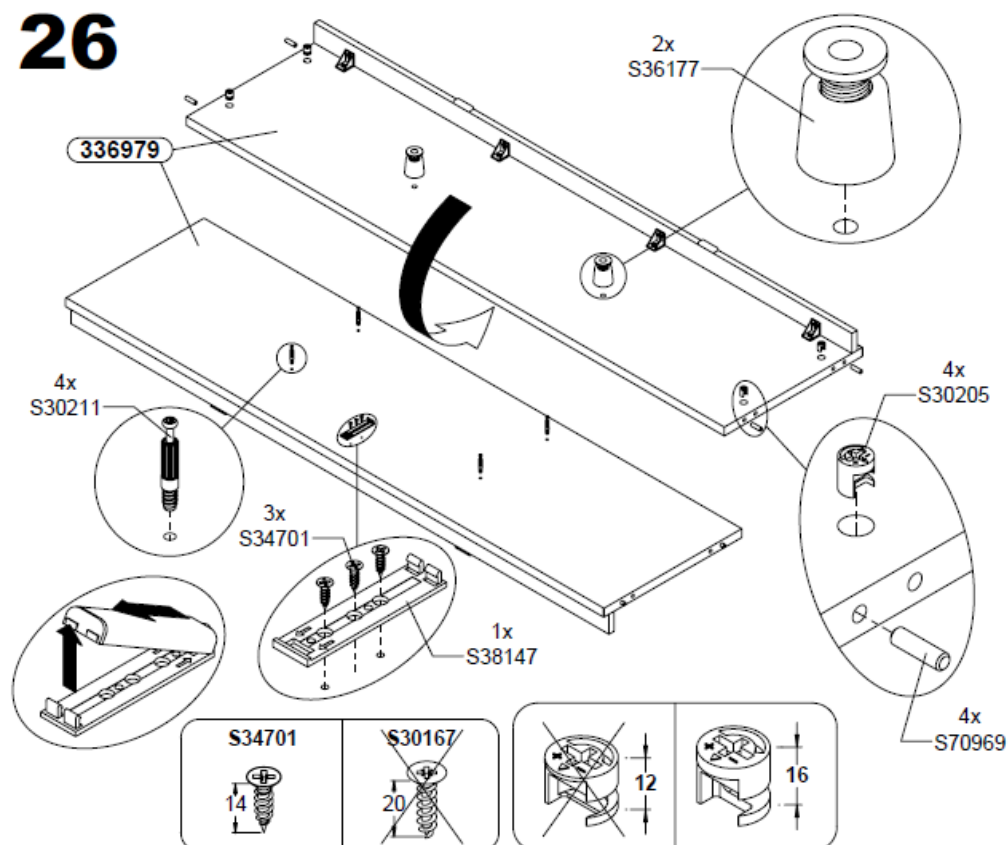



# 27

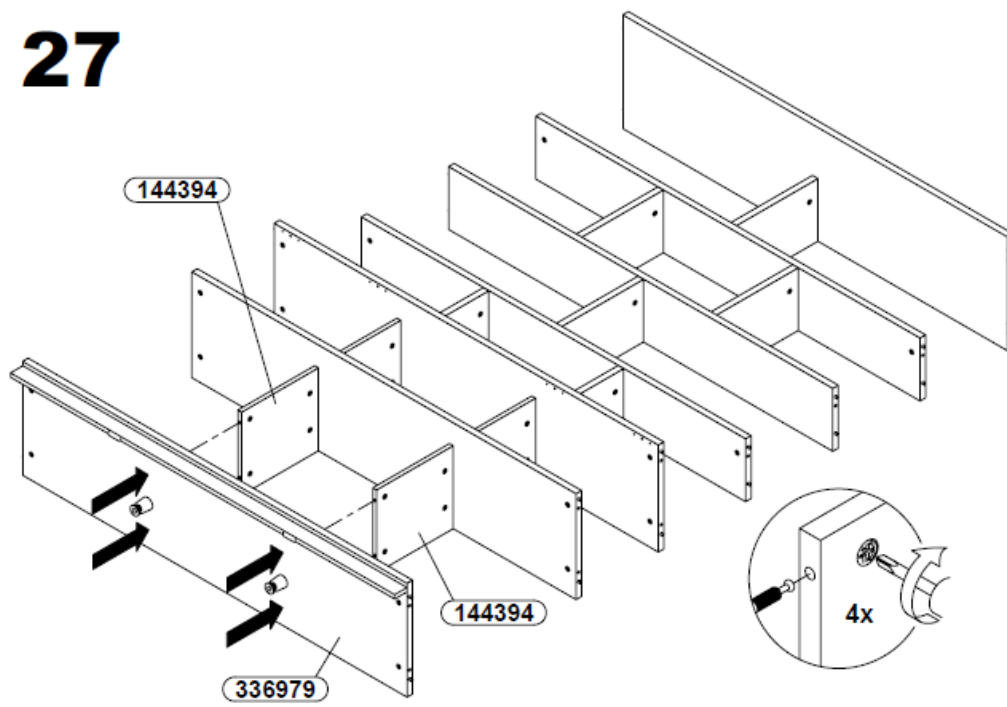

# 28

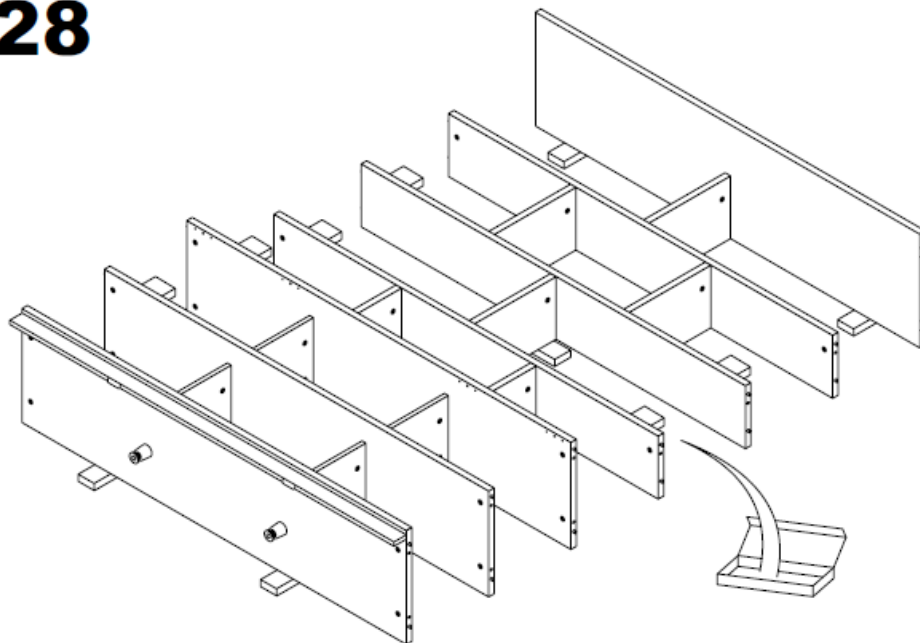

# 29

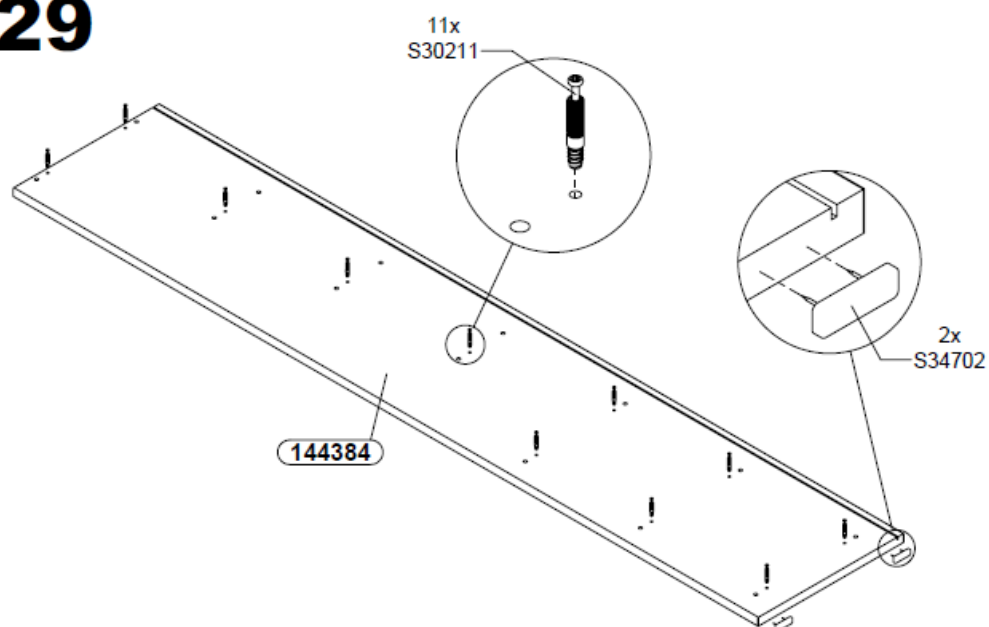

# 30

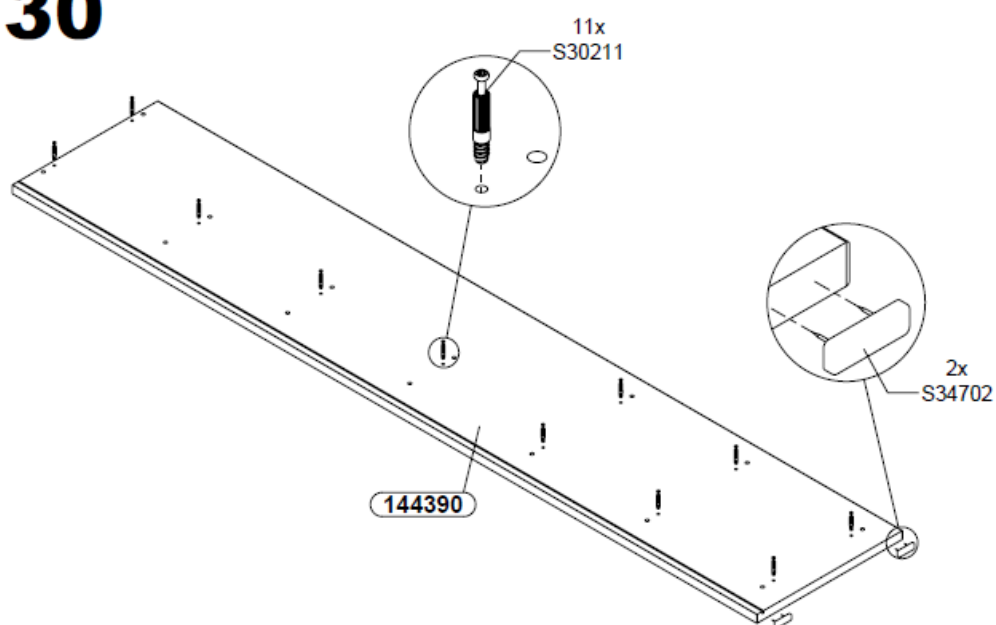

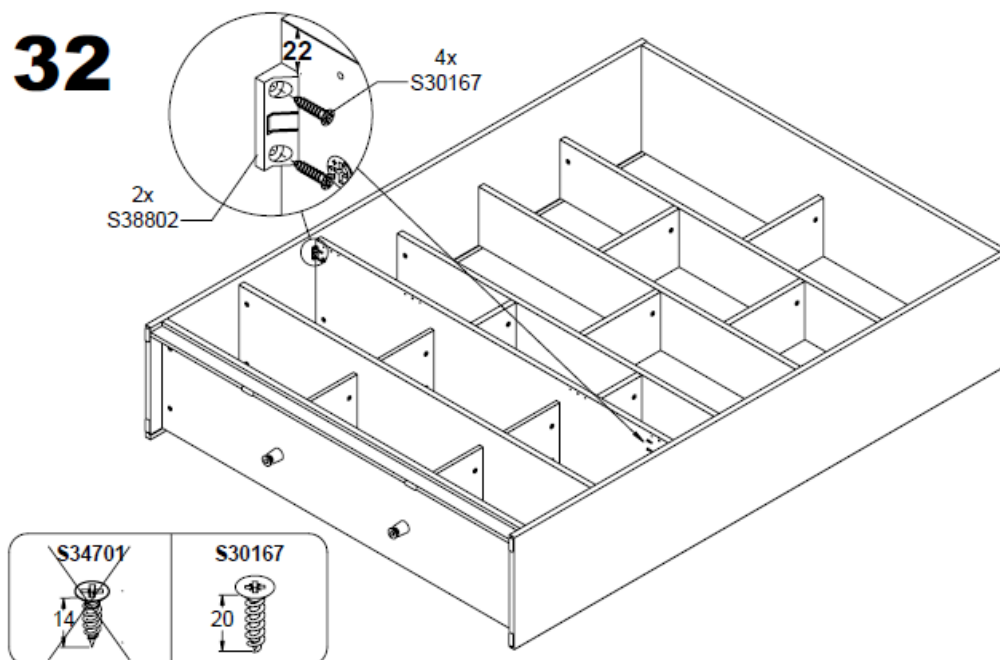
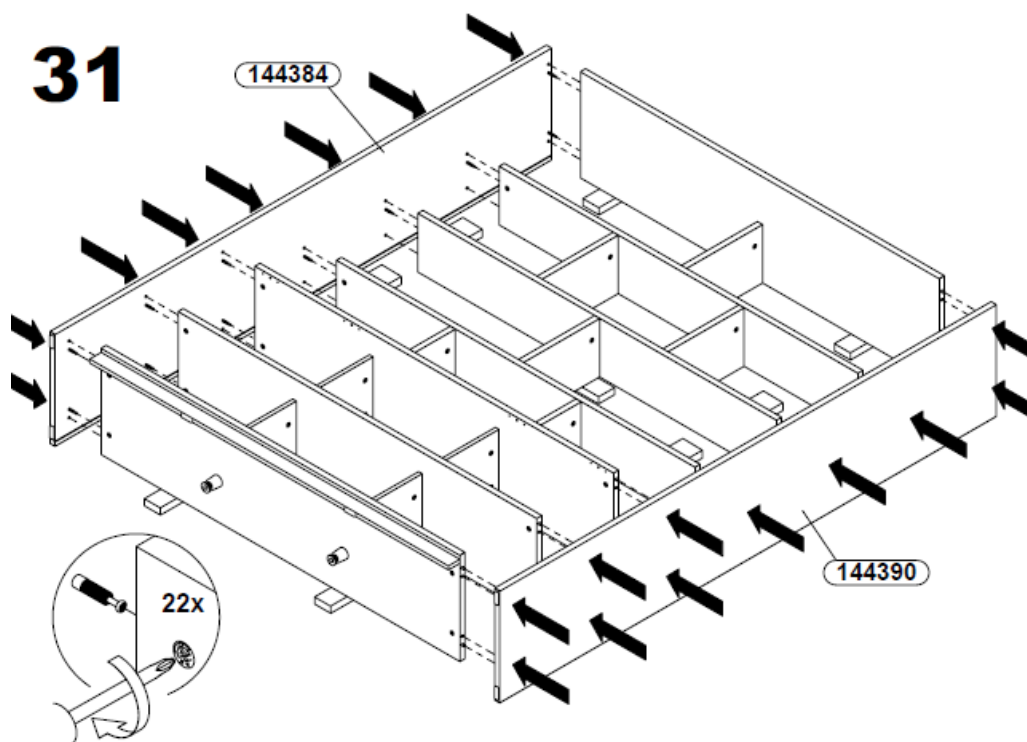

# 33

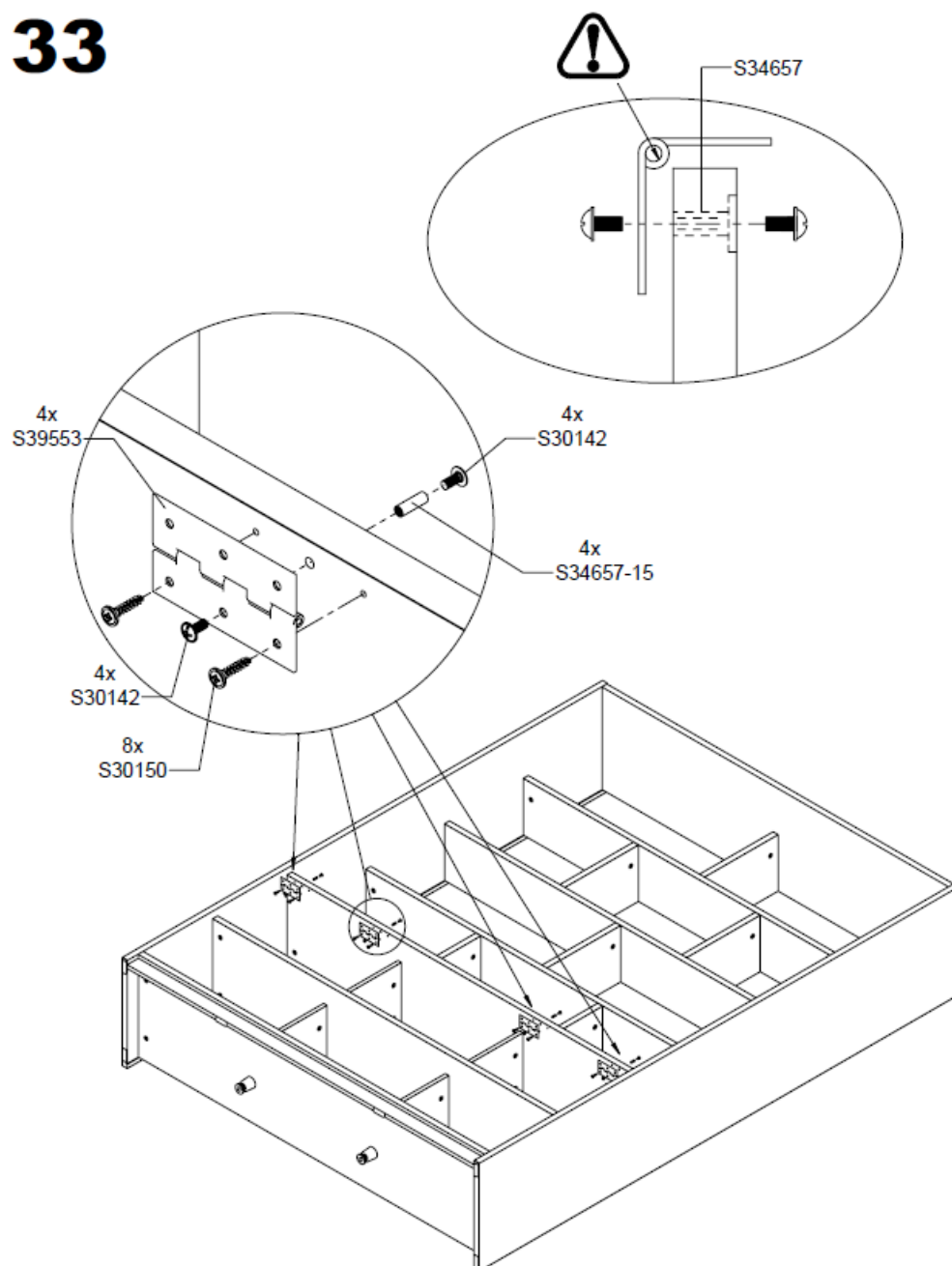

# 34

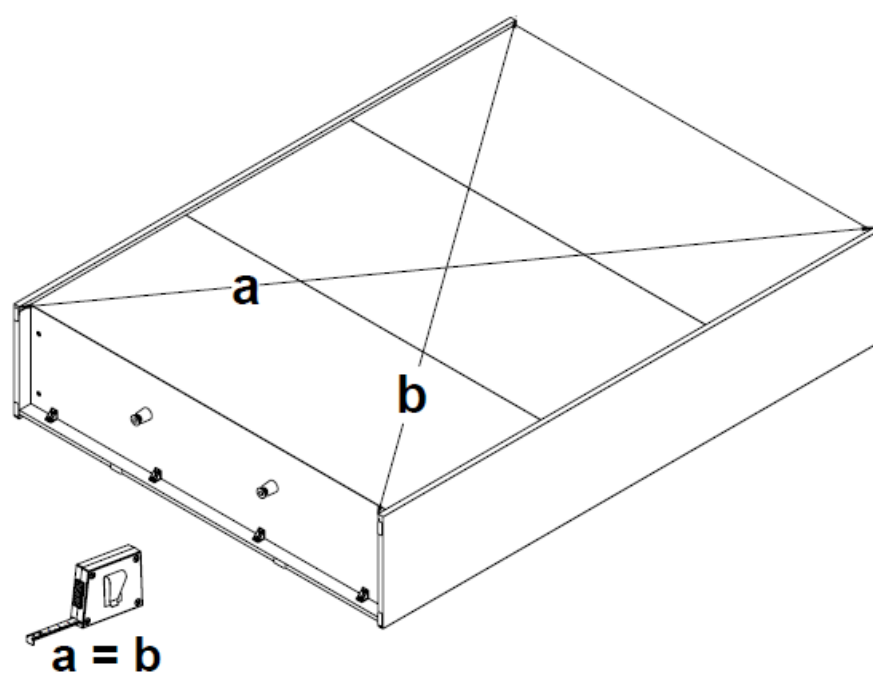
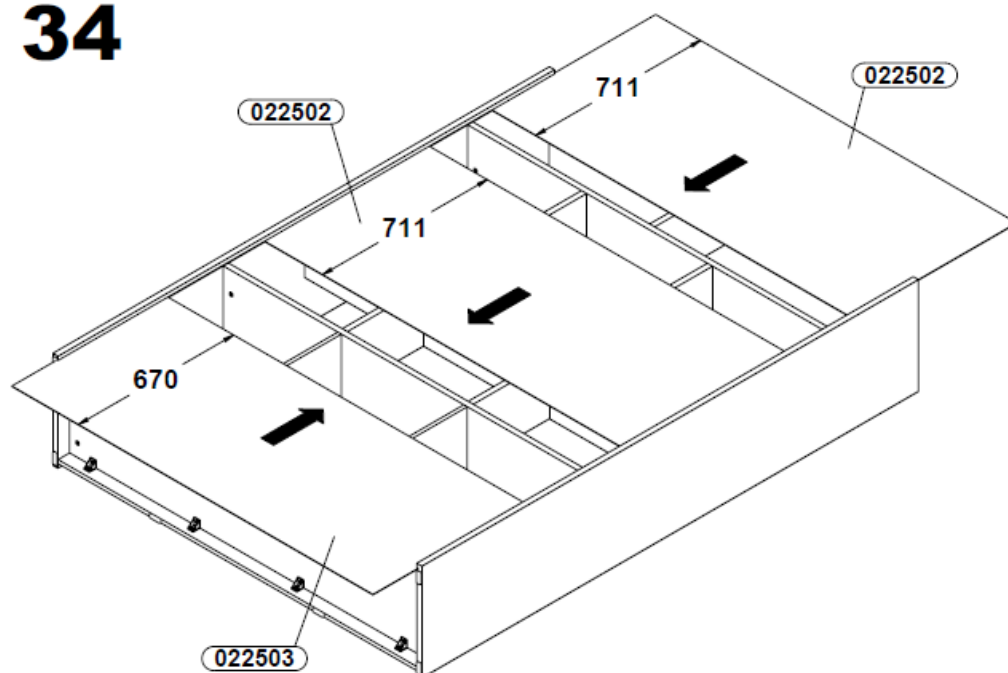

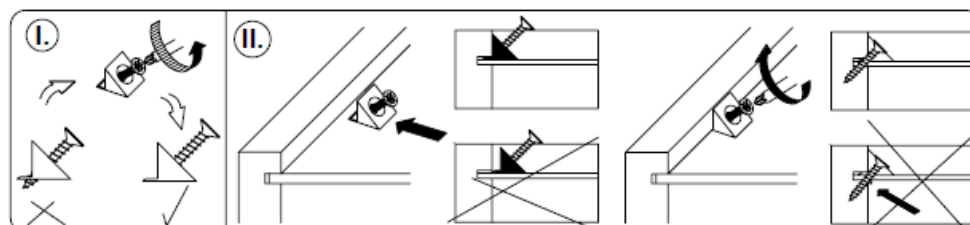
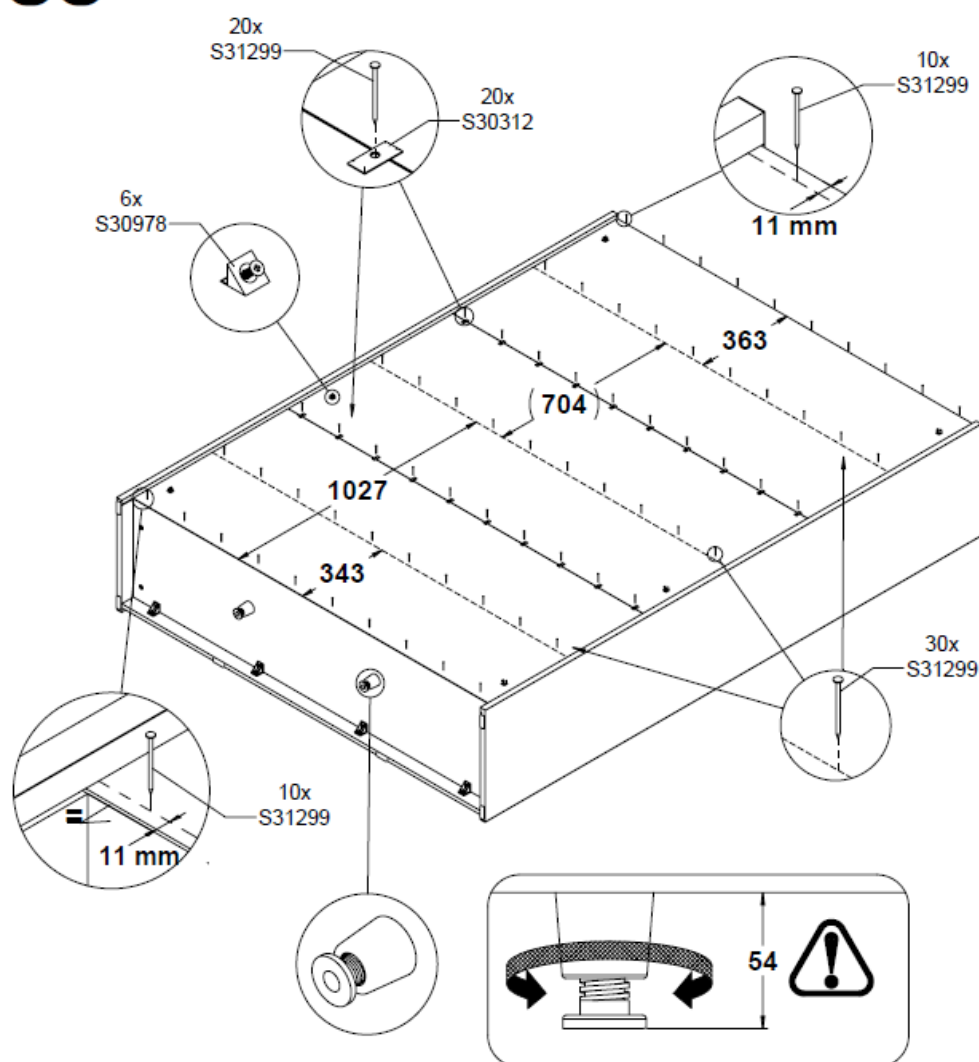

# 36

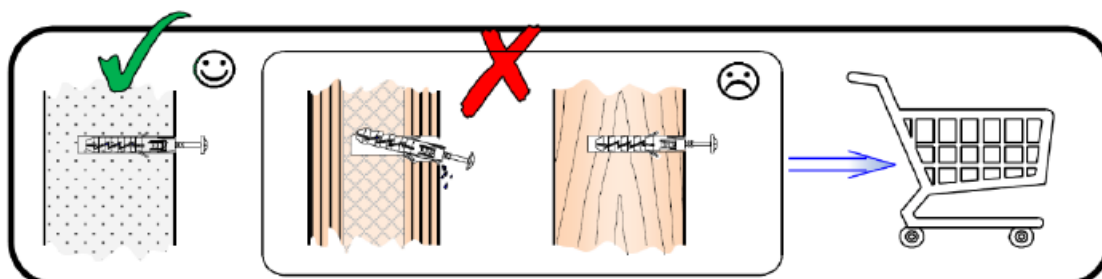
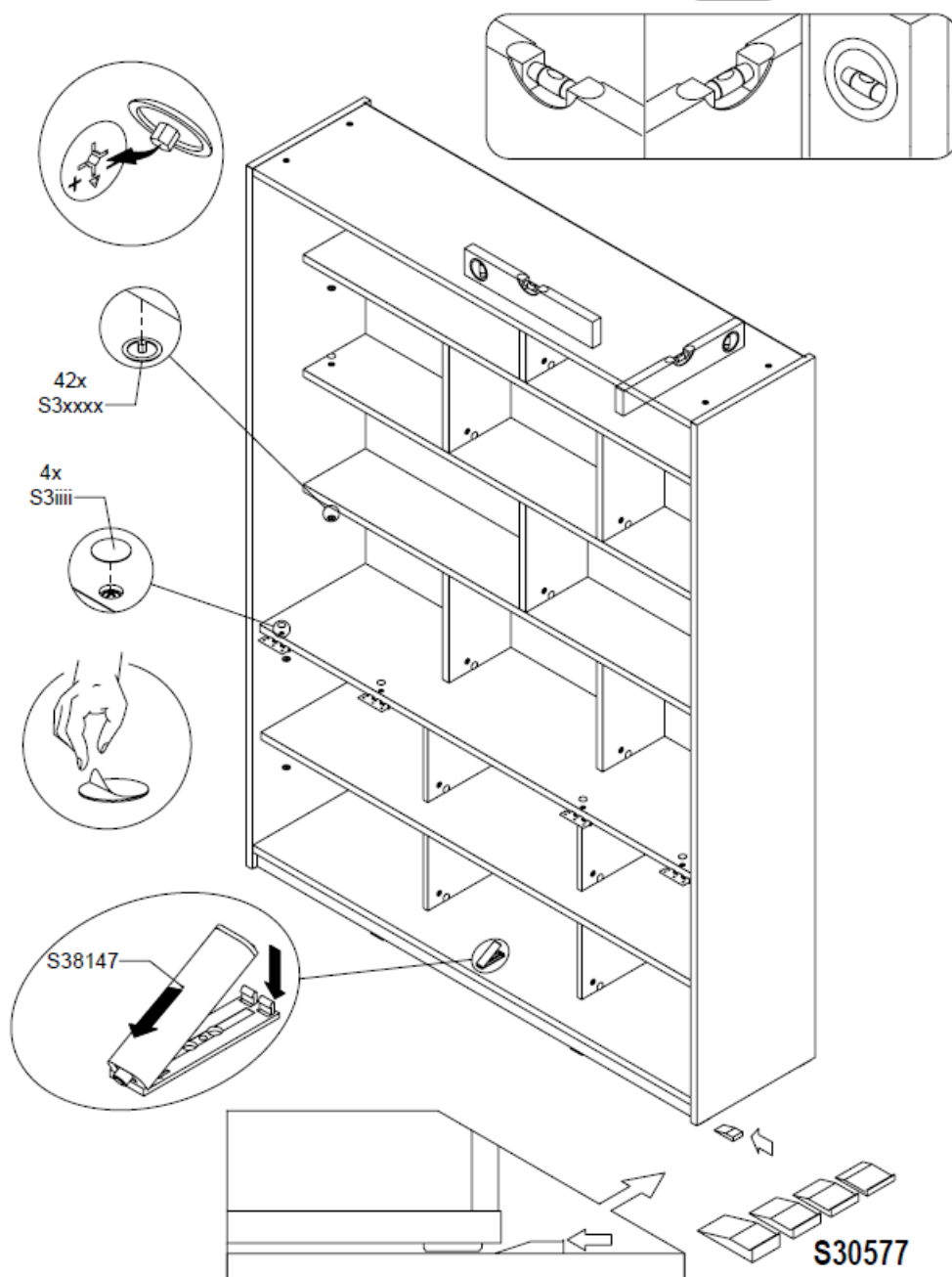

Before suspending or fixing furniture to the wall (in order to prevent falling over), check the type and strength of the wall. Select wall plugs and screws appropriate for the given type of the wall. In the case of doubts, contact a specialist. The installation must be performed by a competent person.

## WARNING!

If the rawlplugs with screws are attached to the product, then they are intended only for walls made of solid and homogeneous materials.

To prevent the piece of furniture from falling over, please attach it permanently to the wall.

**37**

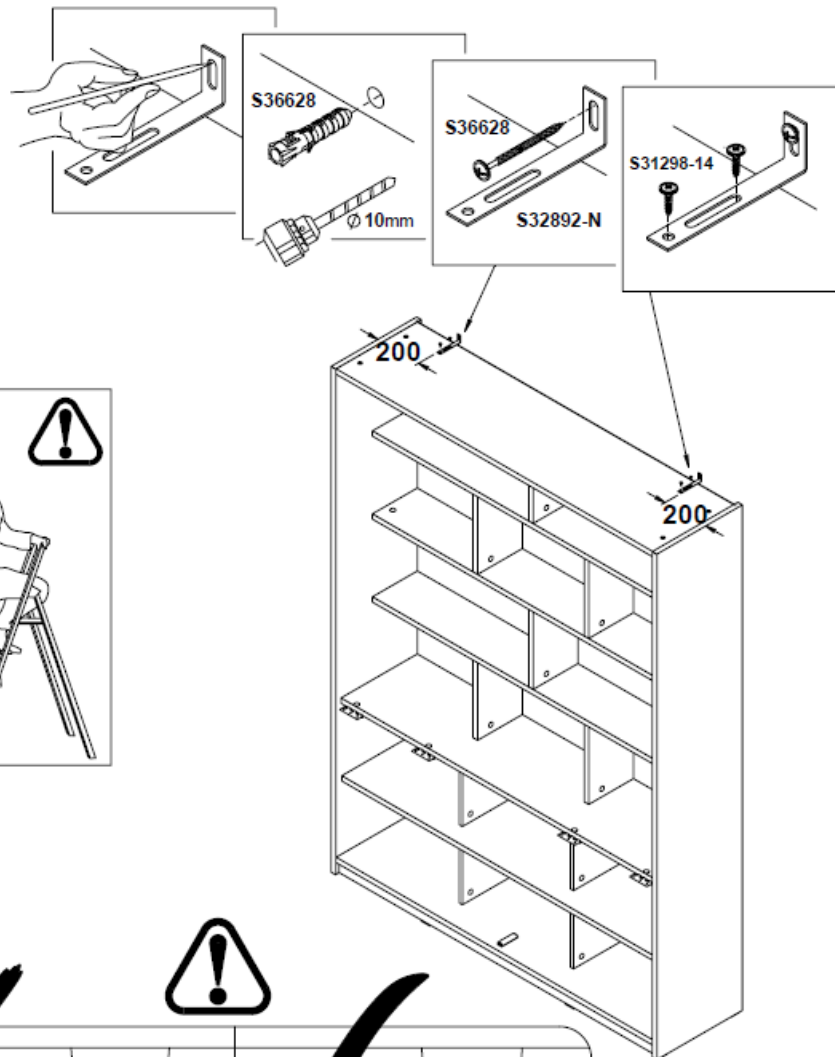



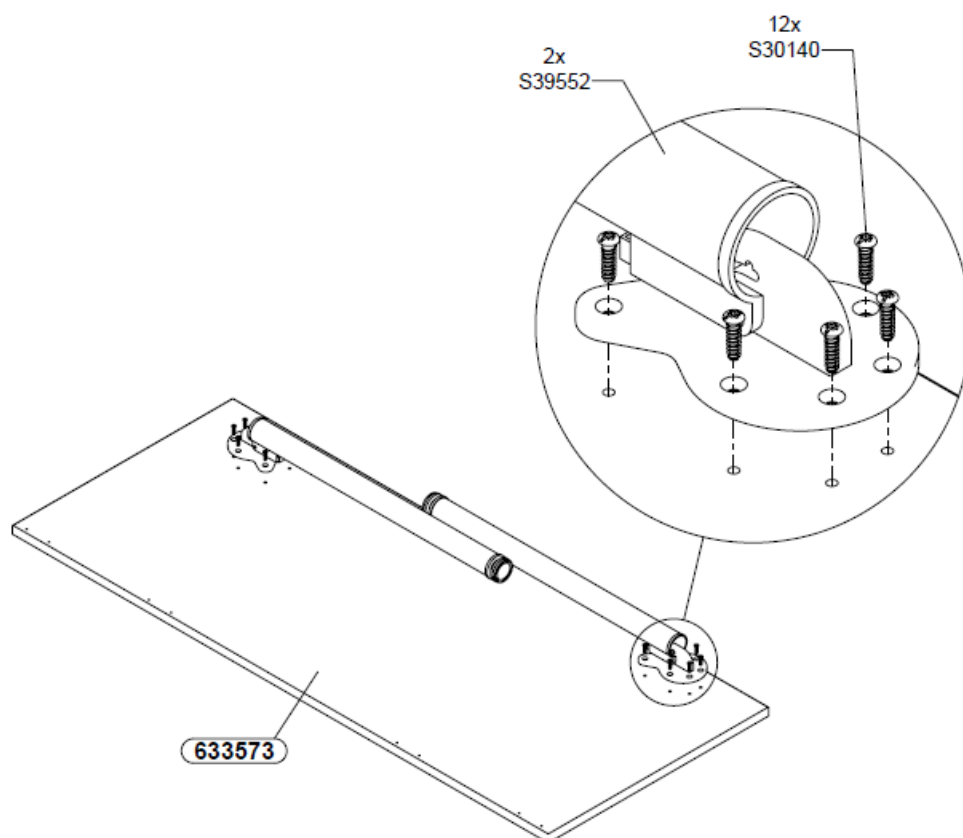
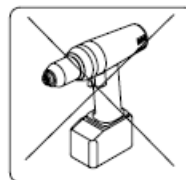
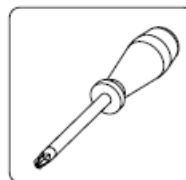

# 39

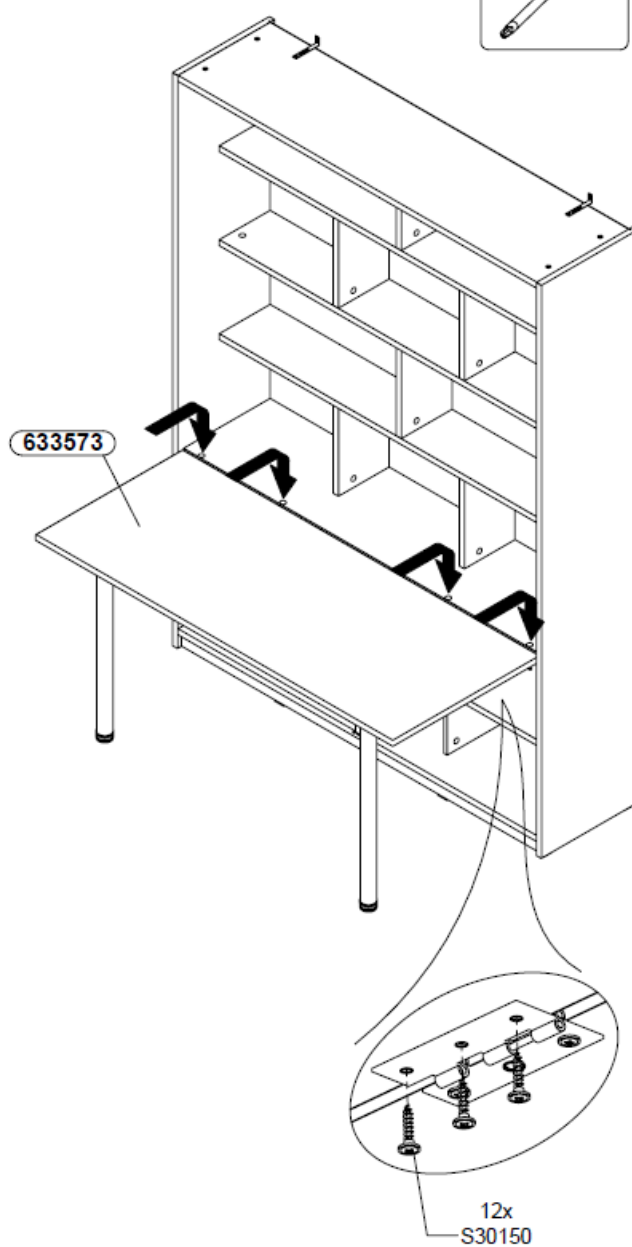
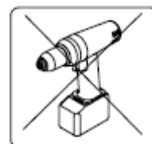

**40**

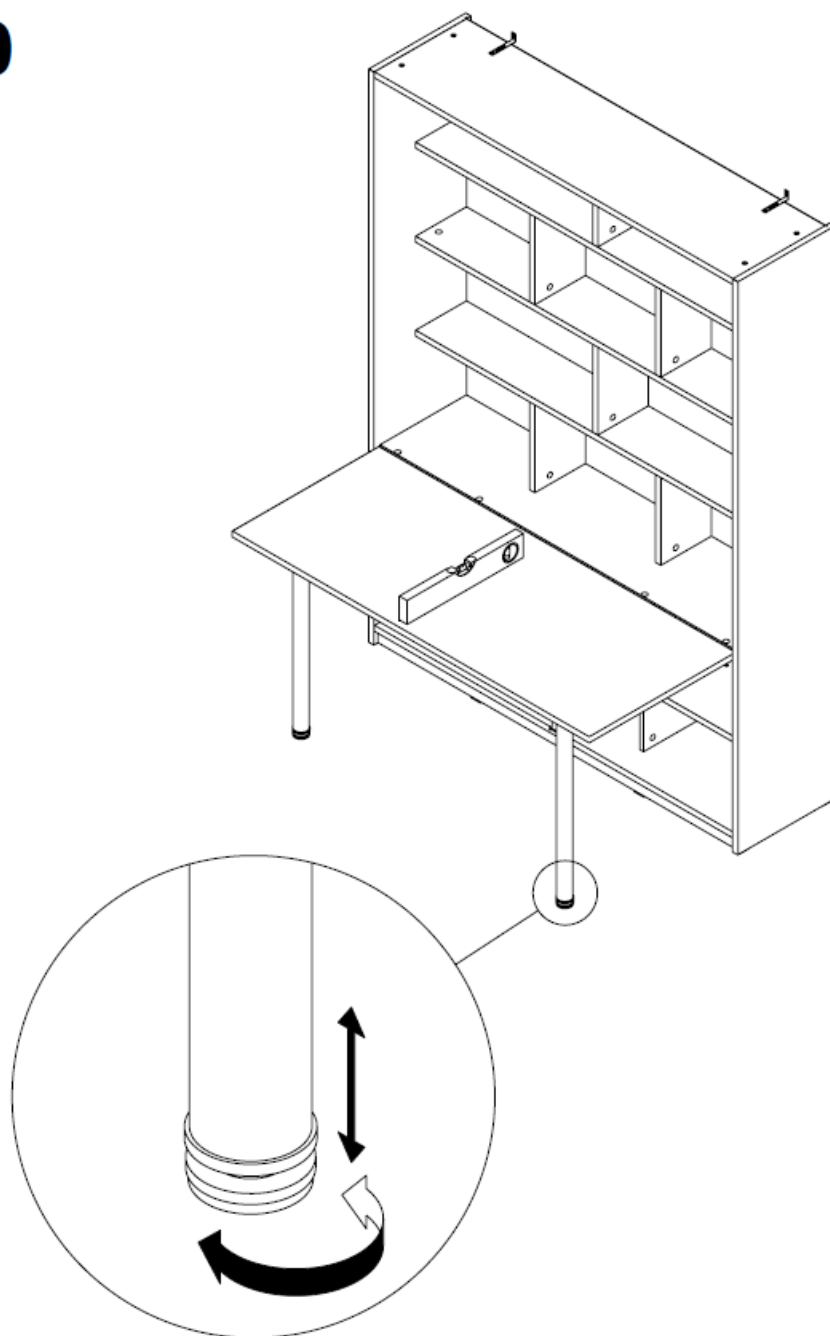

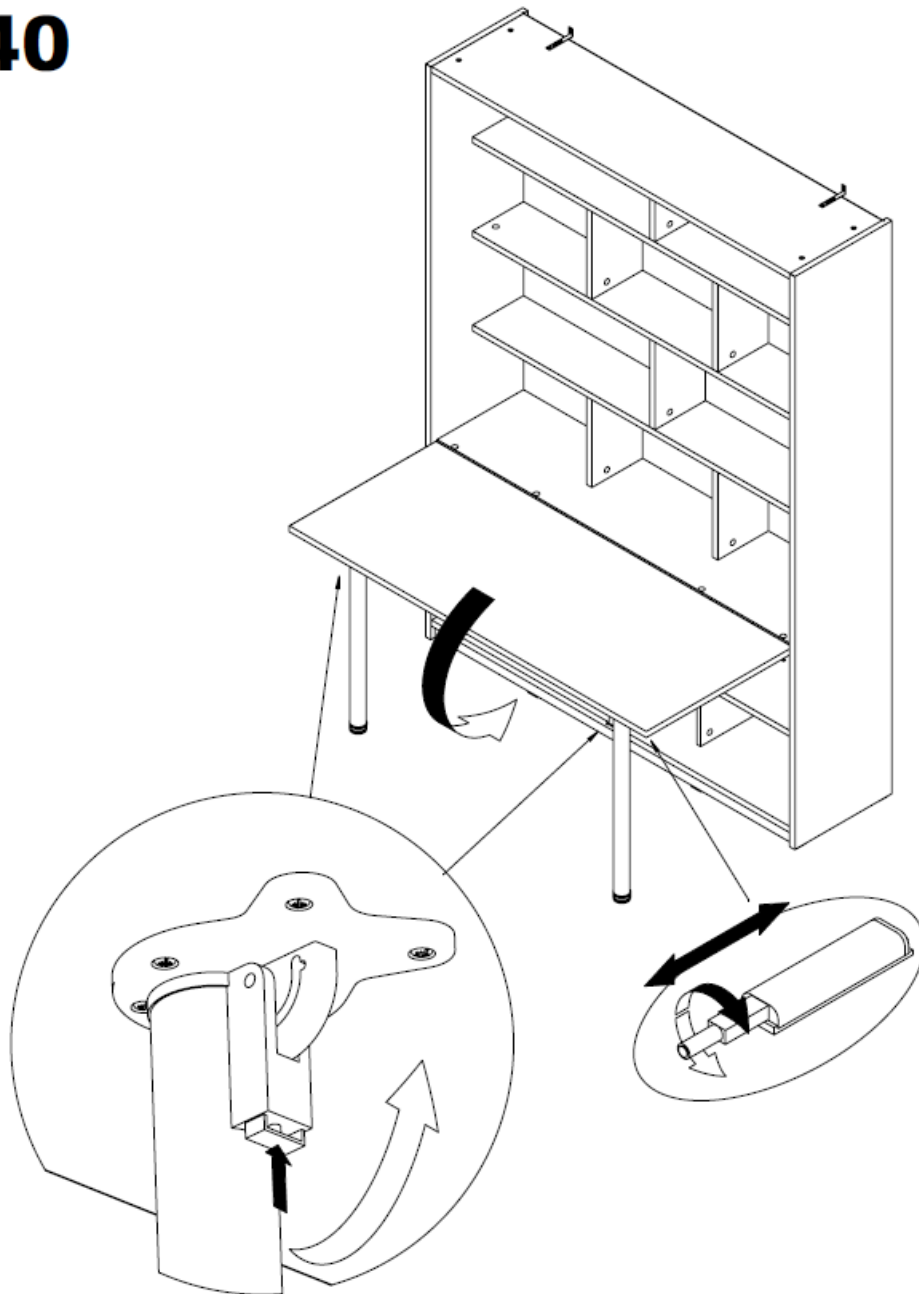

## Documents / Resources

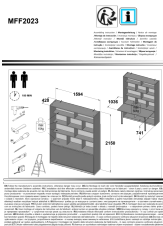
	<p><b><a href="#">FORTE MFF2023_IM Multi Purpose Shelf with Integrated Desk</a></b> [pdf] Instruction Manual MFF2023_IM Multi Purpose Shelf with Integrated Desk, MFF2023_IM, Multi Purpose Shelf with Integrated Desk, Purpose Shelf with Integrated Desk, Shelf with Integrated Desk, Integrated Desk, Desk</p>
---	---

## References

- [User Manual](#)

## **Manuals+. Privacy Policy**

This website is an independent publication and is neither affiliated with nor endorsed by any of the trademark owners. The "Bluetooth®" word mark and logos are registered trademarks owned by Bluetooth SIG, Inc. The "Wi-Fi®" word mark and logos are registered trademarks owned by the Wi-Fi Alliance. Any use of these marks on this website does not imply any affiliation with or endorsement.