



FORTE CDKR801 File shelf Instruction Manual

[Home](#) » [FORTE](#) » FORTE CDKR801 File shelf Instruction Manual 

FORTE

CDKR801



Assembling instruction

Contents

- [1 CDKR801 File shelf](#)
- [2 GUIDELINES FOR FURNITURE CARE](#)
- [3 Documents / Resources](#)
 - [3.1 References](#)

CDKR801 File shelf



60 MIN

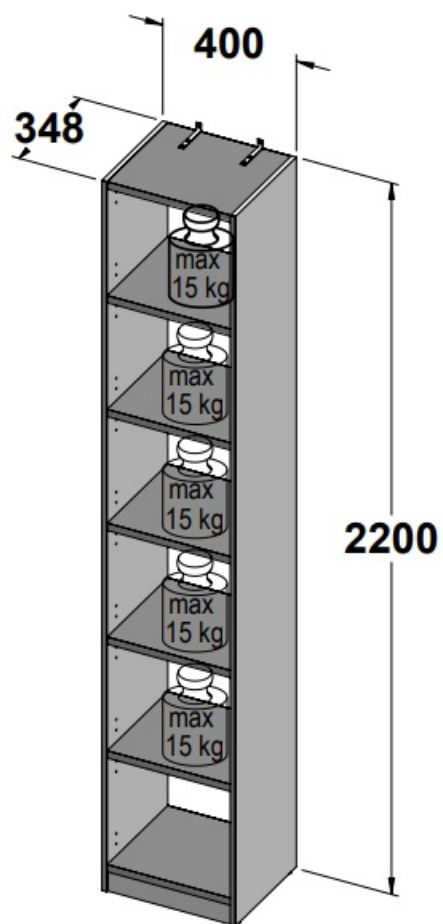
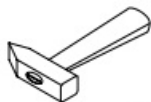
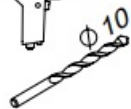
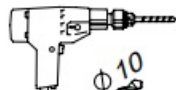

Follow the manufacturer's assembly instructions, otherwise danger may occur.

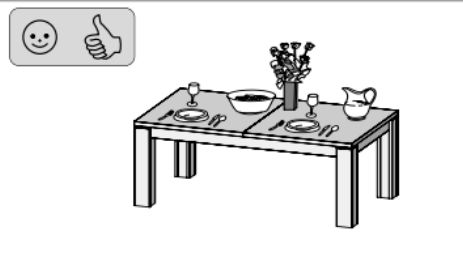
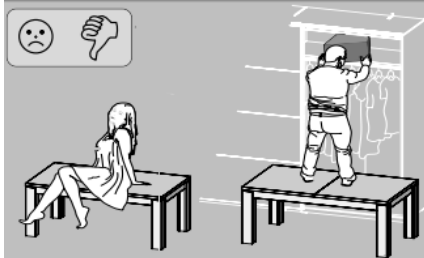
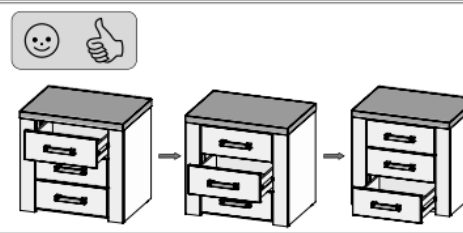
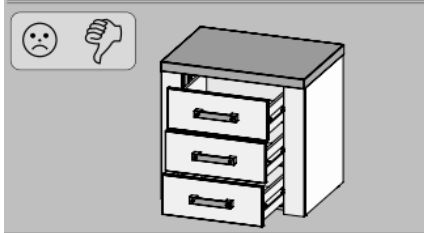
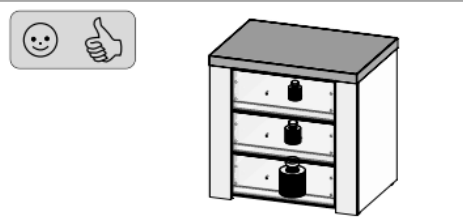
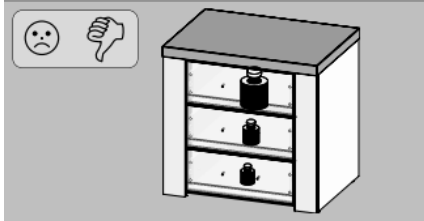
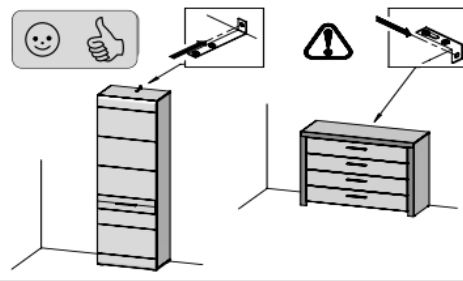
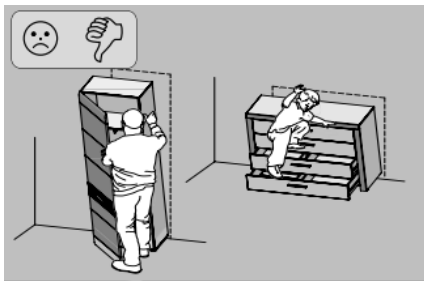

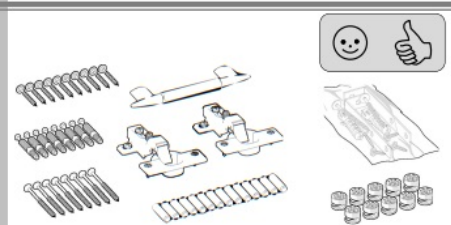
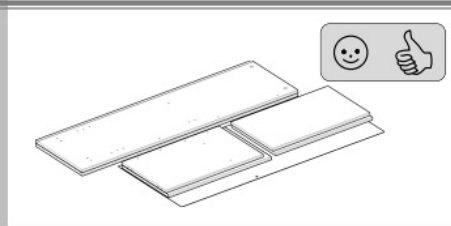
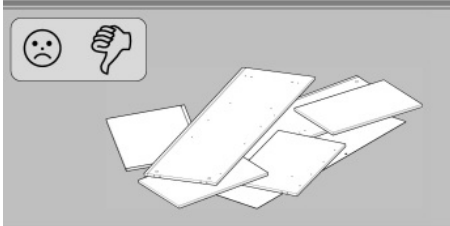
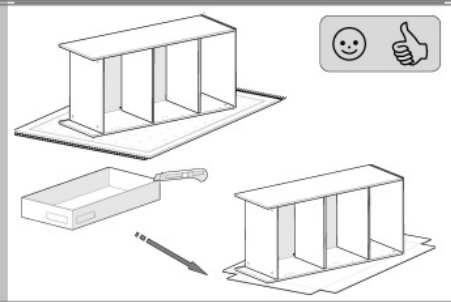
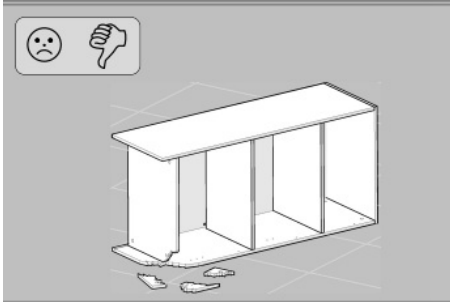
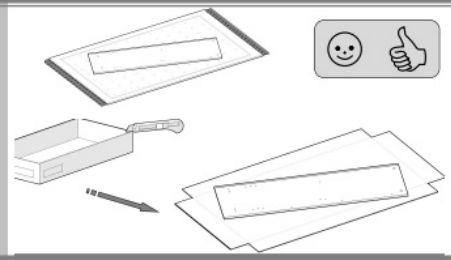
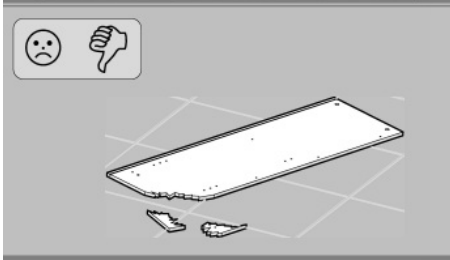
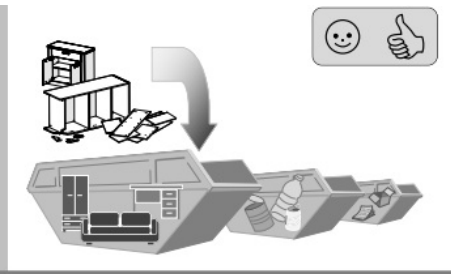

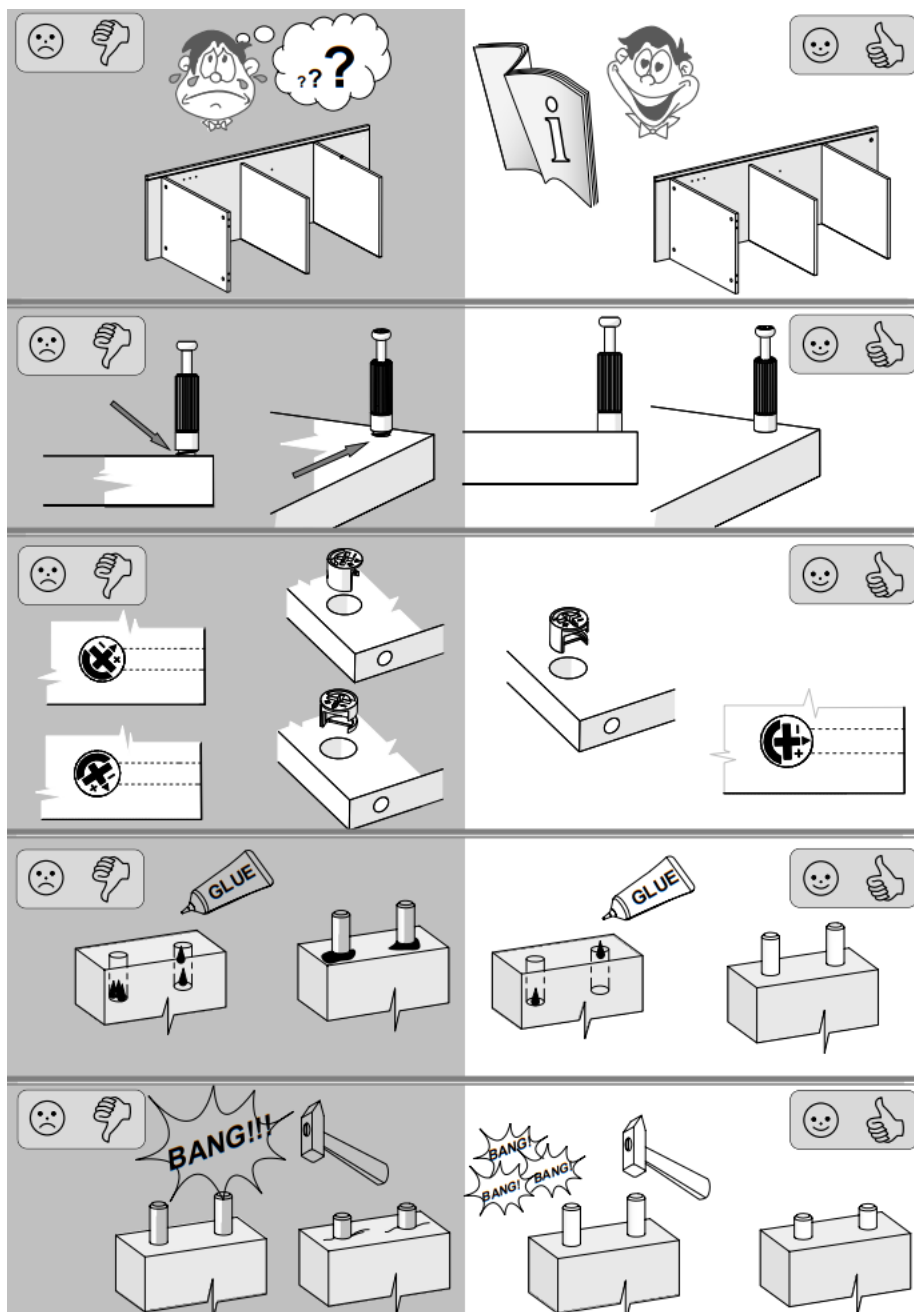

Furniture containing wood-based panels (particle board, fibreboard, plywood etc.) may emit into indoor air inconsiderable amounts of substances used in the production processes. The level of this emission is examined and it meets the applicable standards. After assembling the furniture, it is advised to regularly ventilate the room where the furniture stands, which should last about four weeks or until the smell is eliminated.

Service

Name

No.

Type

CODE	DIMENSIONS	Colli -0001
144035	2195x348x15	1
144036	2195x348x15	1
336686	370x346x22	7
536644	370x60x15	1

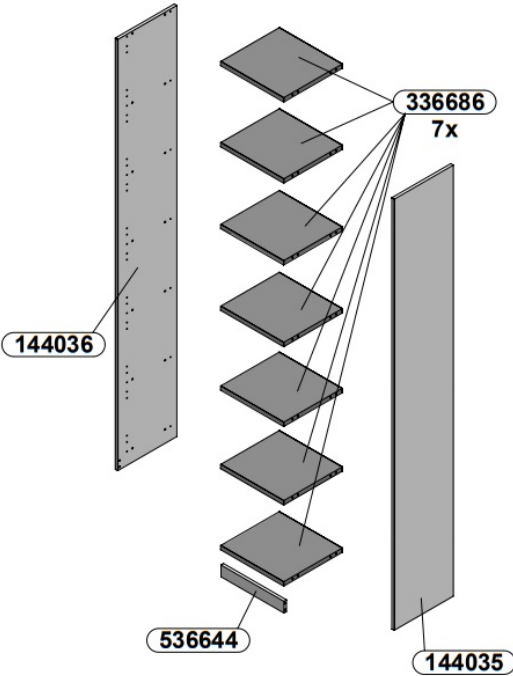

32x S70969 Ø8x28	28x S30211	28x S30205 Ø15x16	4x S31298-14 Ø4x14
4x S30558	24x S3xxxx	2x S32892	1x S30577
2x S36628 Ø10x50, Ø5x60	2x S20553		

1

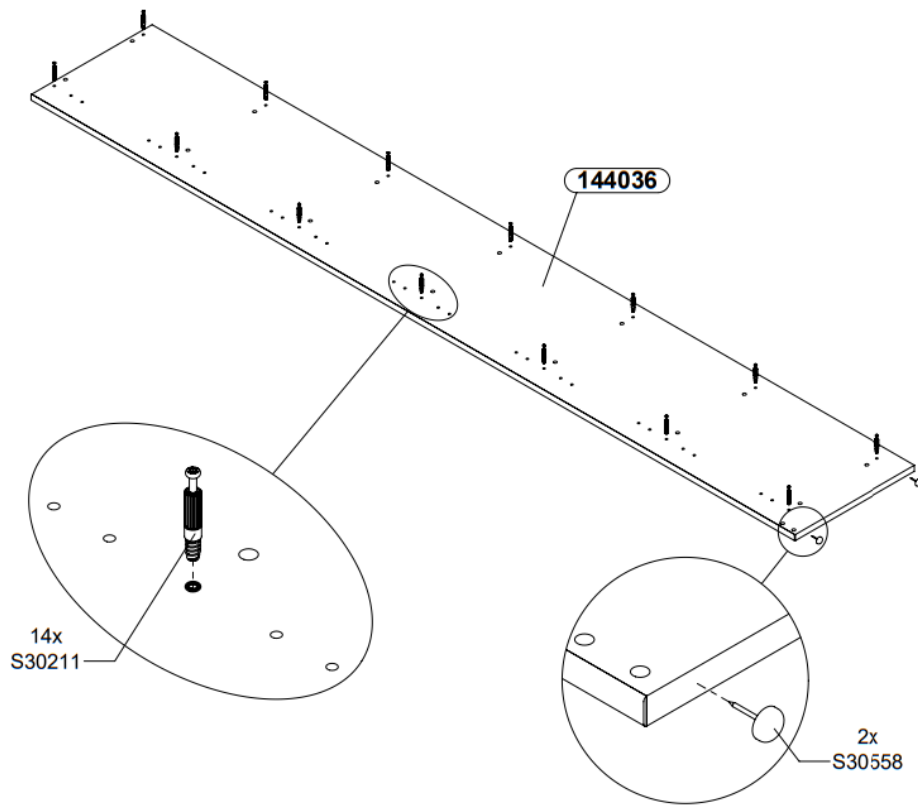

2
7x

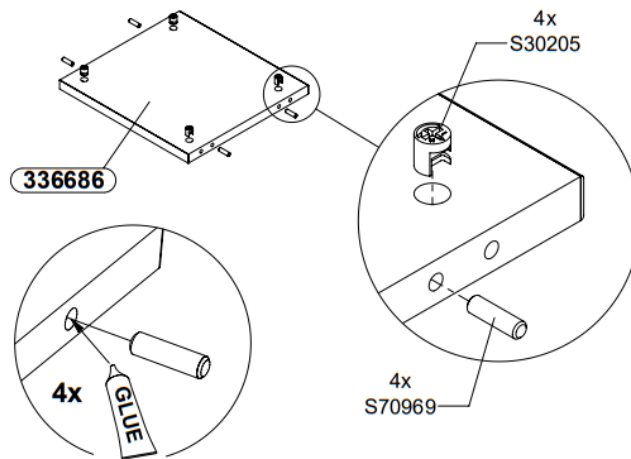

3

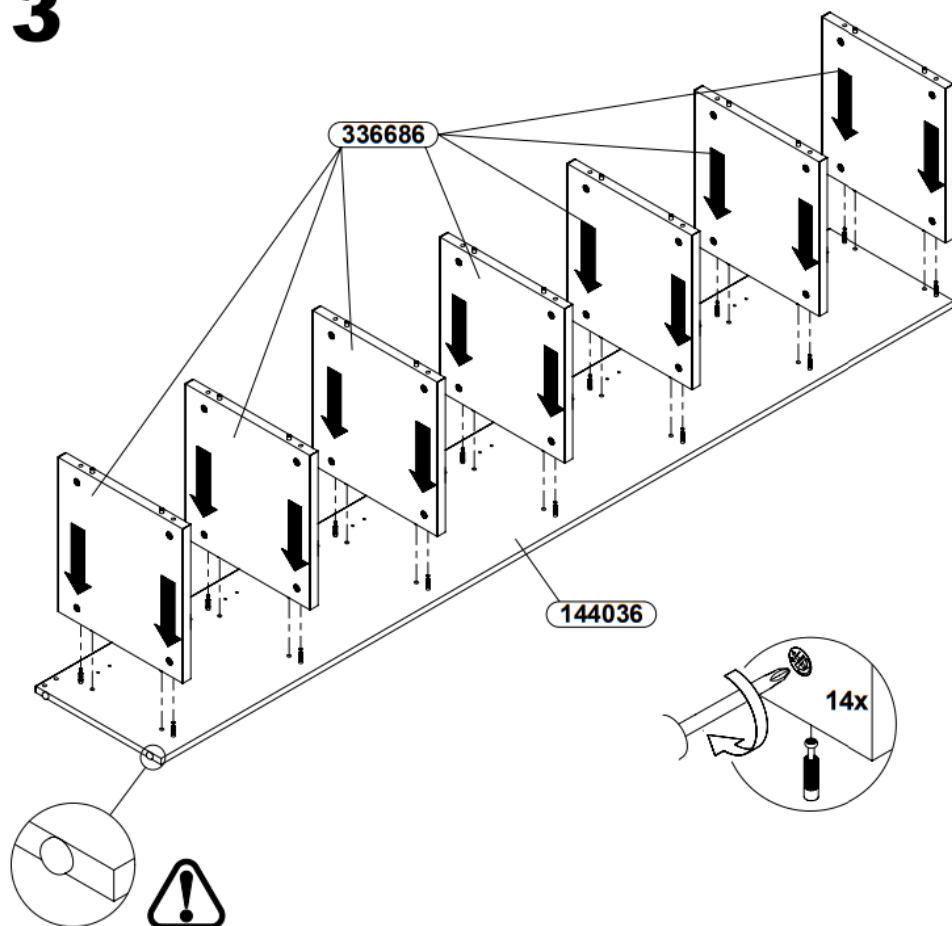

4

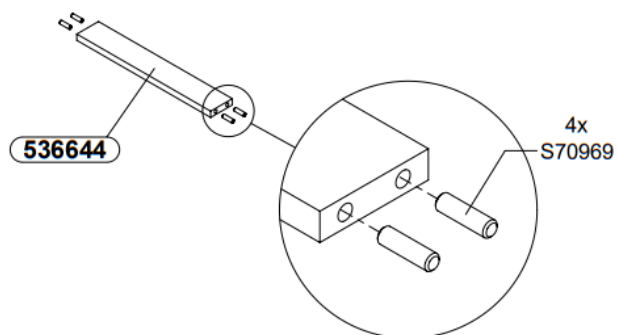

5

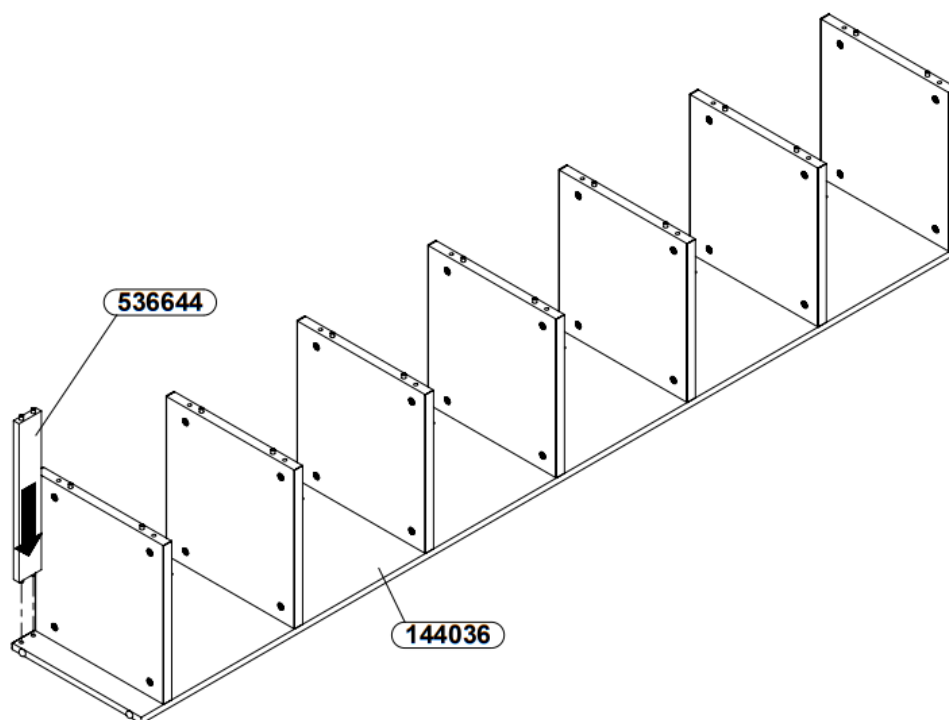

6

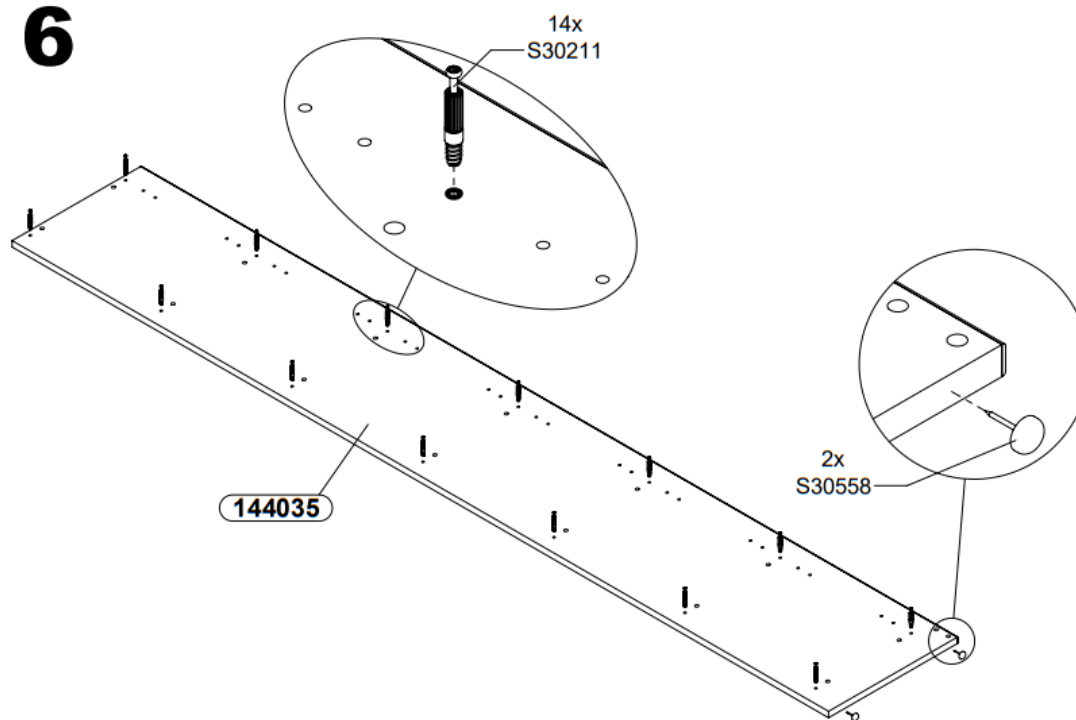

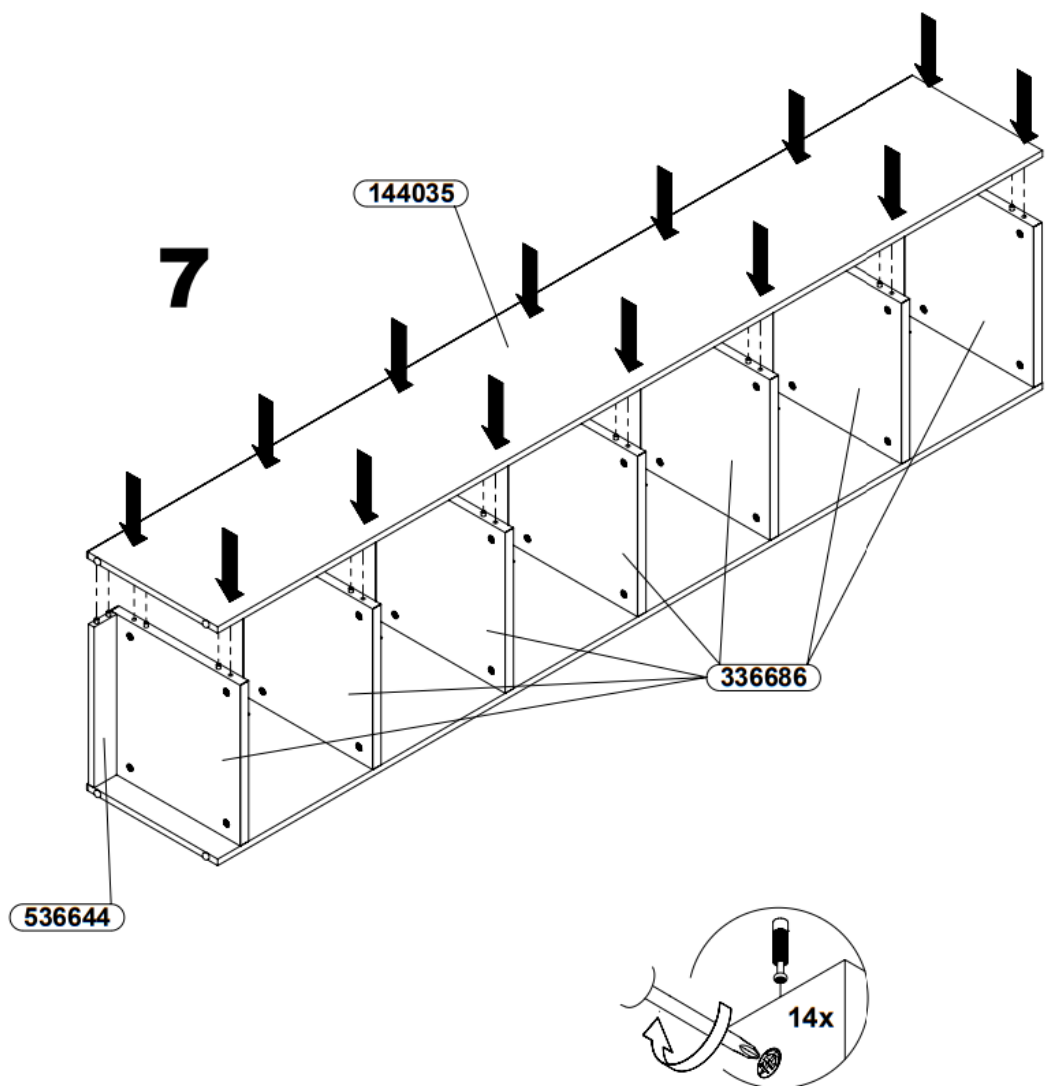

8

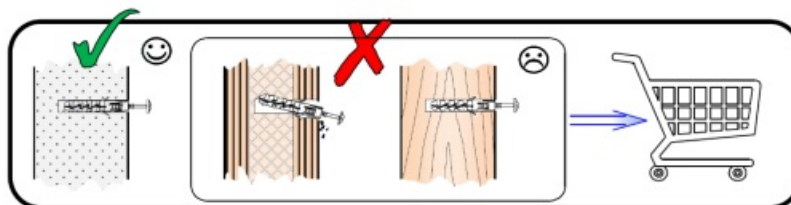
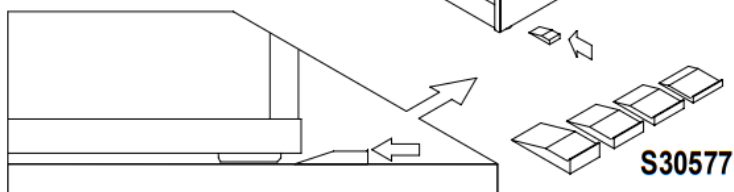
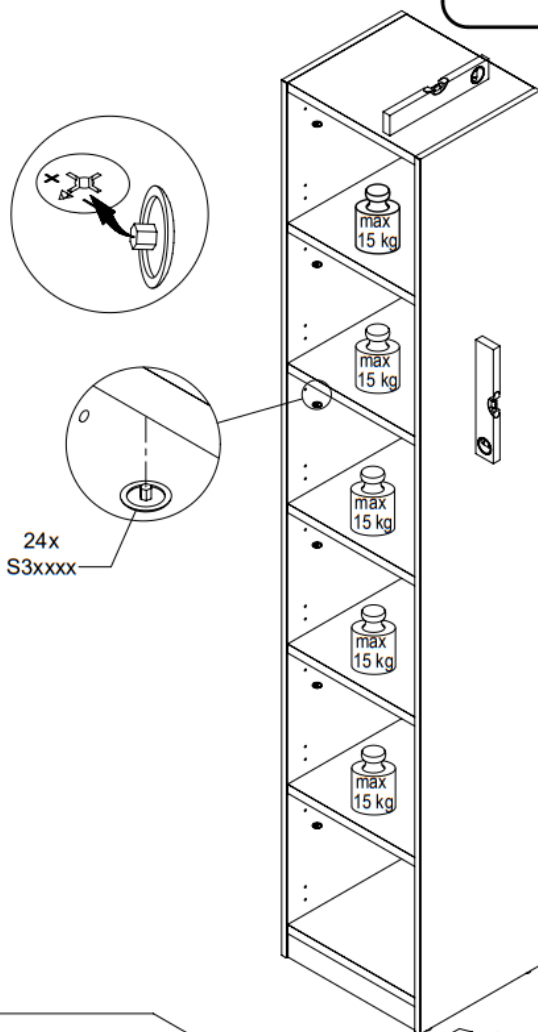
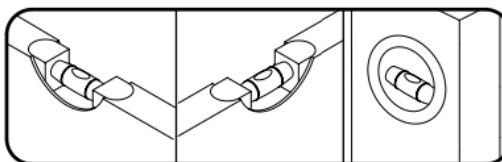

Before suspending or fixing furniture to the wall (in order to prevent falling over), check the type and strength of the wall. Select wall plugs and screws appropriate for the given type of the wall. In the case of doubts, contact a specialist. The installation must be performed by a competent person.

WARNING!!! If the rawplugs with screws are attached to the product, then they are intended only for walls made of solid and homogeneous materials.

9

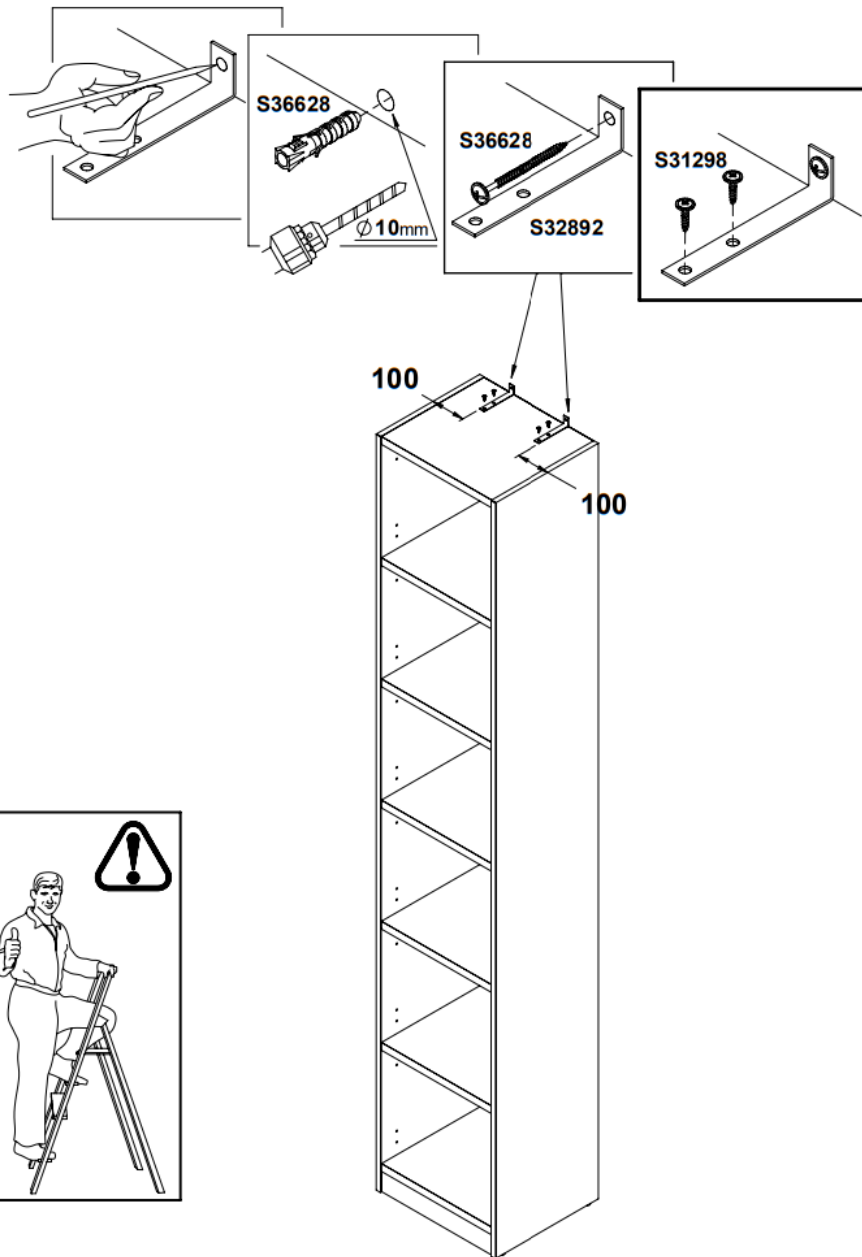

GUIDELINES FOR FURNITURE CARE

Please follow the below specified remarks in order to properly take care of your furniture:

A clean dry soft fabric must be used for cleaning. If the furniture requires thorough cleaning, then you can slightly moistened it with water or cleaning agent designed for furniture cleaning, and subsequently the cleaned elements must be wiped until they're dry. Metal and glass parts must be cleaned using commercially available cleaning agents designed for cleaning of this type of materials, in accordance with the included instructions.

Do not use corrosive agents, scouring agents and other agents if their intended use is unknown.

The cleaning agents must have clear marking that they are intended for cleaning furniture.

WARNING!!! High gloss elements, from which the protective foil was removed, may be cleaned and used only after 72 hours.

13.12.2022

FORTE

Documents / Resources

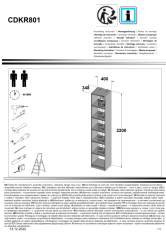
	<p>FORTE CDKR801 File shelf [pdf] Instruction Manual CDKR801 File shelf, CDKR801, File shelf, shelf</p>
---	---

References

- [User Manual](#)

[Manuals+](#), [Privacy Policy](#)

This website is an independent publication and is neither affiliated with nor endorsed by any of the trademark owners. The "Bluetooth®" word mark and logos are registered trademarks owned by Bluetooth SIG, Inc. The "Wi-Fi®" word mark and logos are registered trademarks owned by the Wi-Fi Alliance. Any use of these marks on this website does not imply any affiliation with or endorsement.