

FONICER CKW500BT Vertical Ergonomic Bluetooth Mouse and Keyboard



FONICER CKW500BT Vertical Ergonomic Bluetooth Mouse and Keyboard Installation Guide

[Home](#) » [FONICER](#) » FONICER CKW500BT Vertical Ergonomic Bluetooth Mouse and Keyboard Installation Guide



Contents

- [1 FONICER CKW500BT Vertical Ergonomic Bluetooth Mouse and Keyboard](#)
- [2 Product Information](#)
- [3 Product Usage Instructions](#)
- [4 Frequently Asked Questions](#)
- [5 Connect](#)
- [6 Documents / Resources](#)
 - [6.1 References](#)

FONICER

FONICER CKW500BT Vertical Ergonomic Bluetooth Mouse and Keyboard



Product Information

Specifications:

- Model: CKW500BT
- Document Size: 88.9 x 88.9 mm
- Connectivity: Bluetooth, 2.4GHz

Product Usage Instructions

Front Panel:

1. Locate the front panel of the device.
2. Unfold the 1st fold to face inwards.
3. Unfold the 2nd fold to face outwards.
4. Identify sections A and B on the front panel.

Back Panel:

1. Find the back panel of the device.
2. Look for the connection instructions in various languages – Connect, Conectar, Collegare, Verbinden Sie, Connector.

Bluetooth Connectivity:

The device supports Bluetooth connectivity for wireless operation. Follow the standard Bluetooth pairing process on your device to connect to the CKW500BT.

Wireless Frequency:

The device operates on the 2.4GHz frequency band for stable wireless communication.

Symbols:

The symbols ~, ` , 2.4GHz, _ , and ^ have specific meanings related to the device's operation. Refer to the user manual for detailed explanations of these symbols.

Frequently Asked Questions

Q: How do I pair the device with my smartphone via Bluetooth?

A: To pair the device with your smartphone, ensure Bluetooth is enabled on both devices. Then, search for available devices on your smartphone and select the CKW500BT to establish the connection.

Q: What is the purpose of the symbols on the device?

A: The symbols on the device indicate specific functions or features. Refer to the user manual for a detailed explanation of each symbol and its relevance to the device's operation.

Connect

Bluetooth

- Insert Batteries
- Open PC Bluetooth Connection
- Hold Fn Key & choose either #1, 2, 3 Key (3 Bluetooth channels for multi devices) 3-5sec until Window pops up CKW500BT
- Press Connect

2.4GHz

- Insert dongle
- Hold Fn Key & #4 Key (2.4Ghz) 3-5sec

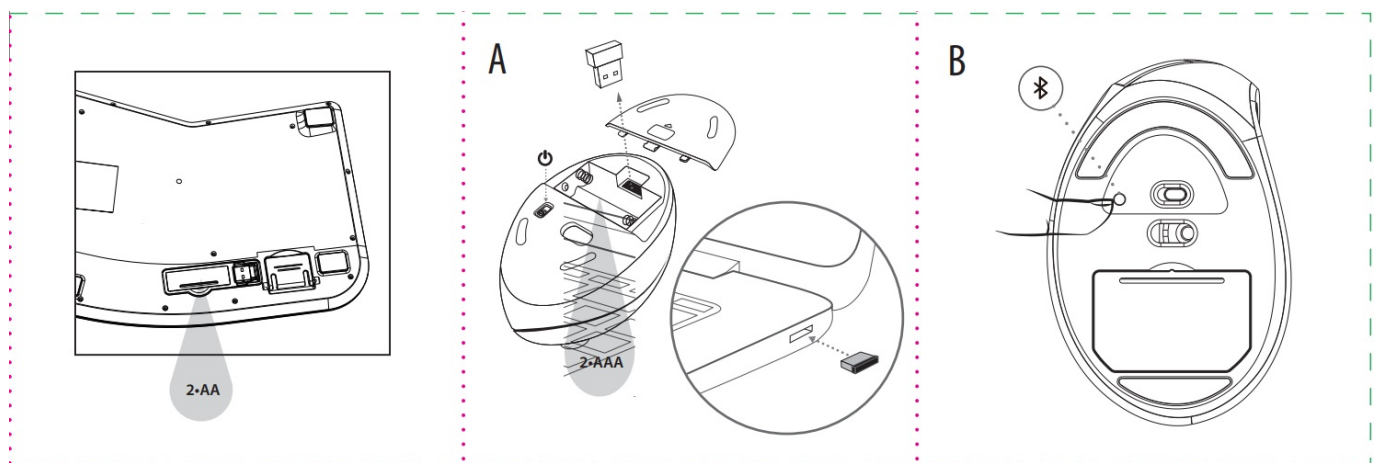

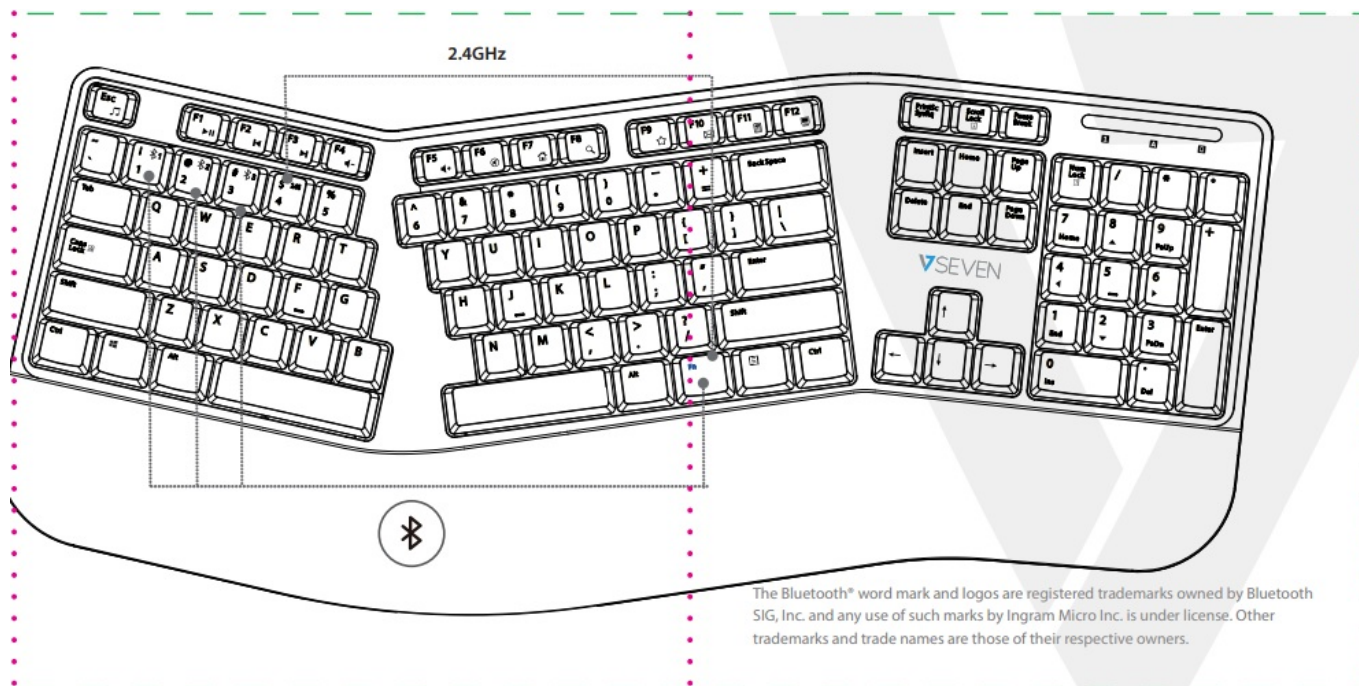

document size 88.9 x 88.9 mm

Documents / Resources

	<p>FONICER CKW500BT Vertical Ergonomic Bluetooth Mouse and Keyboard [pdf] Installation Guide</p> <p>CKW500BT, CKW500BT Vertical Ergonomic Bluetooth Mouse and Keyboard, Vertical Ergonomic Bluetooth Mouse and Keyboard, Ergonomic Bluetooth Mouse and Keyboard, Bluetooth Mouse and Keyboard, Mouse and Keyboard, Keyboard</p>
--	---

References

- [User Manual](#)

[Manuals+.](#) [Privacy Policy](#)

This website is an independent publication and is neither affiliated with nor endorsed by any of the trademark owners. The "Bluetooth®" word mark and logos are registered trademarks owned by Bluetooth SIG, Inc. The "Wi-Fi®" word mark and logos are registered trademarks owned by the Wi-Fi Alliance. Any use of these marks on this website does not imply any affiliation with or endorsement.