



FODSPORTS M1-SPLUS Helmet Bluetooth Intercom User Manual

[Home](#) » [Fodsports](#) » FODSPORTS M1-SPLUS Helmet Bluetooth Intercom User Manual 

Contents

- 1 FODSPORTS M1-SPLUS Helmet Bluetooth Intercom
- 2 Package Include
- 3 Charging
- 4 Operation GETTING STARTED
- 5 Device Pairing
 - 5.1 Pairing Modes
 - 5.2 Wire Connecting
- 6 Multi-device pairing connection
- 7 Technical Specifications
- 8 Q&A/Warning
- 9 Statement/Warranty/After-Sale Service
 - 9.1 FCC Statement
- 10 Documents / Resources



FODSPORTS M1-SPLUS Helmet Bluetooth Intercom



Package Include

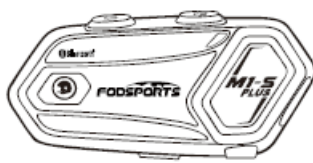

1x M1-S PLUS

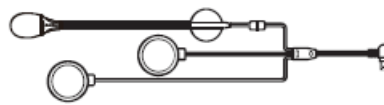

Speakers & Hard Tube Microphone



1x USB Cable



1x Soft Microphone

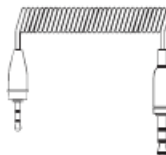

1x 2.5mm to 3.5mm Cable



1x Unit Base



1x Metal Clip



2x 3M Blue Velcro

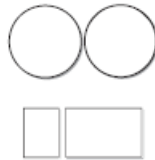

4x Velcro



2x Eva rubber



1x User Manual

Charging

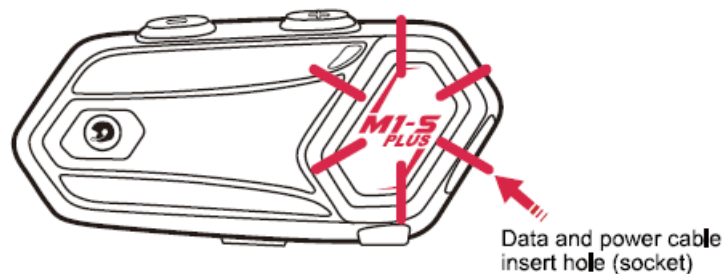

1. The function button lights up red when charging, and the red light goes out after finishing (As shown below).
Please charge before using for the first time.
2. Please use a qualified charger 5V/1A± 0.5A.
3. Please keep charging at least once every 2 months if the product is not used for a long time.

Speaker Installation

1. Open the inner helmet lining on the ear position and attach the velcro loops.
2. Attach the Headphone with Velcro hook to the loop (the short-line speaker is on the left).
3. Place Velcro on the right position on the left side of the helmet. match the microphone with the mouth position, and tidy up the cable and lining.



Remark:

the microphone should be close to and aimed at the mouth as possible. The speakers are as close to their ears as possible. If the installation position of the speaker is too deep so that the speaker is too far away from the ear, the sponge in the accessory may be used to jack up.

Fixed by clamp

1. Find and assemble the Unit base and metal clip.

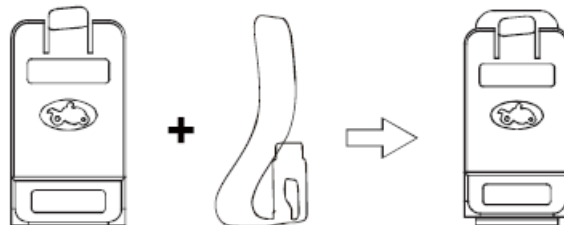

2. Fix the base in the right position.



3. Assemble the M1-S PLUS: Insert the snap of the bottom of the host into the groove of the base, and press the host to the base so that the clip of the base buckle the top of the host.

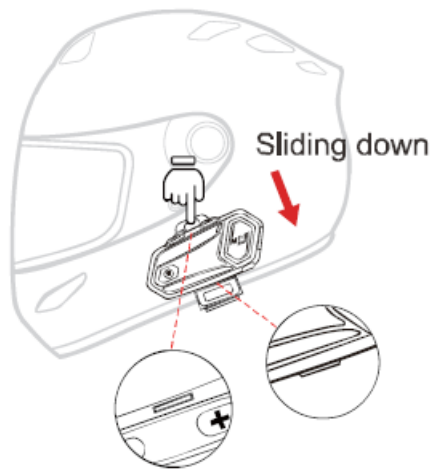

4. Insert the microphone and earphone connection line, and installation is complete.



Disassembly of the Device

1. Pull out the headset plug.

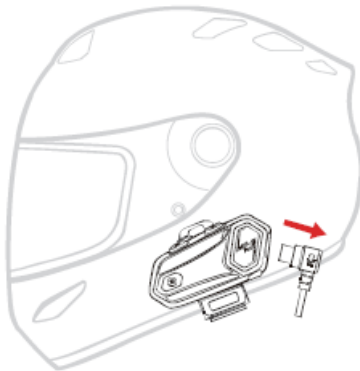

2. Press the upper clamp buckle and move the device upward to remove it.



Operation GETTING STARTED

Outlook/ Button

1. Intercom
2. Volume –
3. Volume +
4. Function
5. AUX In
6. YPE-C port (earphones/ charging)

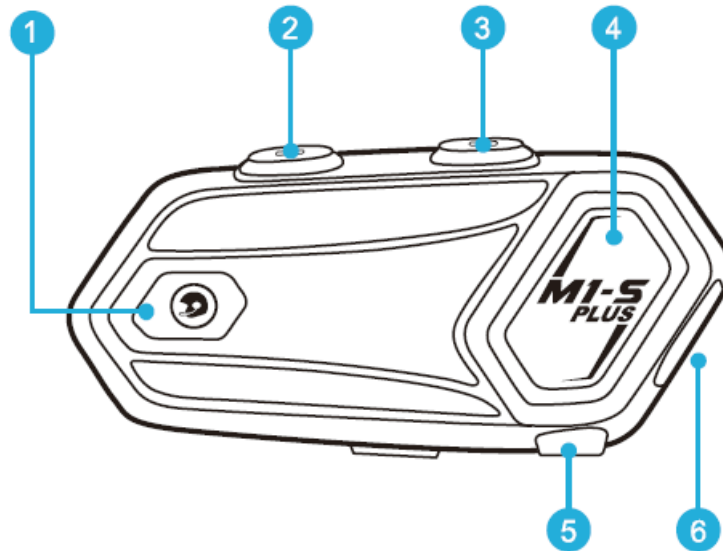

Switch On / OFF

- **Switch On:** Long press the Intercom button and Function button at the same time for 3 seconds, Voice message will also say u Welcome to FOOSPORTS Bluetooth Communication System?.
- **Switch Off:** Long press the Intercom button and Function button at the same time for 3 seconds. A voice message will also say UPower off”.

Power Detect & Notification Function

- M1-S PLUS has a power detect function, when the device is on, long press the Function button and Volume- button at the same time for 3 seconds, and a recorded voice message will tell you:
- Power over 90%
- Power over 50%
- Power lower than 50%

Low Power Notification

- When power is lower than 20%, a red light flash in the function button and a voice message will remind “Power lower than 20%, please recharge immediately”.
- When power is lower than 10%, a red light flash in the function button and a voice message will remind”Power lower than 10%, will be turning off. please recharge immediately”.

Cellphone

- **Answering Call:** Short press the Function button.
- **Hangup Call:** Call ended, short press the Function button.
- **Refuse Call:** Long press the Function button for 2 seconds.
- **Redial:** Short press the Function button twice.
- **Volume Up:** short press the Volume+ button.
- **Volume Down:** short press the Volume- button.

Switch manual/automatic answering calls :While in standby, press and hold the intercom button and volume “+” “-” button at the same time for 3 seconds. (Default: answer incoming calls automatically)

Voice Command

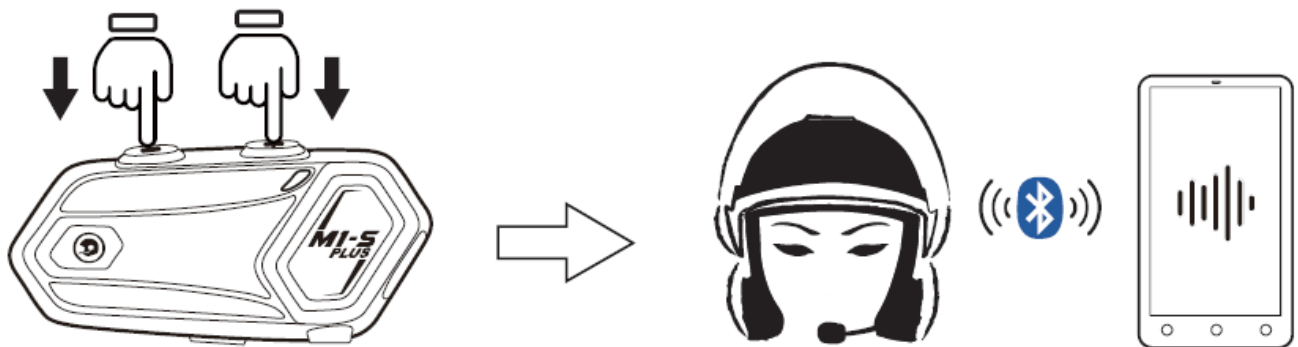

Short Press Volume+ button and Volume- button once.

Open mobile phone voice input function automatically

When your M1-S PLUS is paired up with a cellphone. Short pressing the Volume+ button and Volume- button once, will automatically switch on the voice command function (only for iOS).

Cellphones must have a voice command function.

Music Function

- **Play:** short press the Function button.
- **Pause:** short press the Function button.
- **Volume Up:** short press the Volume+ button.
- **Volume Down:** short press the Volume- button.
- **Play Previous:** short press the Volume+ button twice.
- **Play Next:** short press the Volume- button twice.

Music Sharing

Long press 3 seconds

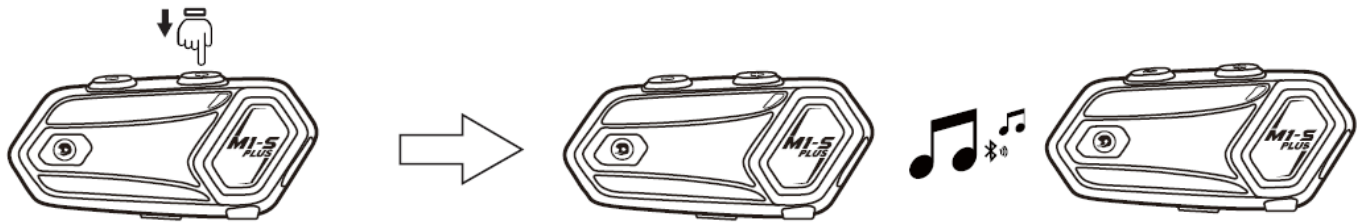

Start Sharing Music:

For example A share music with B

- **Step 1:** Connect with phone(refer to 5.3)
- **Step 2:** A and B establish intercom connection(refer to 5.2)
- **Step 3:** Short press the intercom button of A to exit intercom mode
- **Step 4:** Long press the volume + button for about 3 seconds, voice notice"Start Sharing Music"
- **Step 5:** Turn on Music player on your phone and play songs.
- **Step 6:** Now, B can enjoy the music shared by A.

Stop Sharing Music:

Pause music first, long press the volume + button for about 3 seconds, voice notice "Stop Sharing Music".

About Music Sharing

- Music sharing function is used only between two M1-S PLUS devices.
- When you start/stop music sharing, the music needs to be in pause status.
- Short press the function button to play/pause music sharing.
- If the operation of sharing music fails, you need to clear the pairing memory of unit A and unit B, and try again.

Intercom Function

- **Switch Intercom On** short press the Intercom button.
- **Switch Intercom Off:** short press the Intercom button.
- **Volume Up:** short press the Volume+ button.
- **Volume Down:** short press the Volume- button.

Microphone (mute)

- **Mute Microphone:** When the device is in a call (intercom),long press the Volume+ button for 2 seconds.
- **Enable Microphone:** When the device is in a call (intercom) long press the Volume+ button for 2 seconds.
Default: Enable Microphone)

FM Function

- **FM On:** Long press the Volume- button for 3 seconds.
- **FM Off:** Long press the Volume- button for 3 seconds.

- **Volume Up:** Short press the Volume+ button.
- **Volume Down:** Short press the Volume- button.
- **Search Channels:** short press Volume+ / Volume- button twice.

Memory Clear

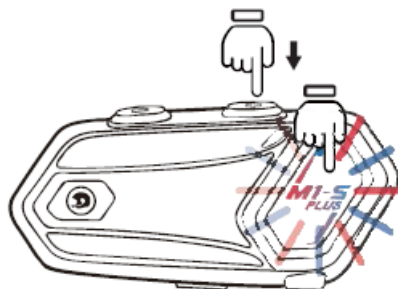

Memory Clear:

When the device is on, press the Function and Volume+ buttons at the same time for 5 seconds. Then M1-S PLUS will clear the pairing memory with other devices. The red and blue lights flash at the same time, Dearing memory completely.

Device Pairing

Pairing Modes

Passive pairing mode

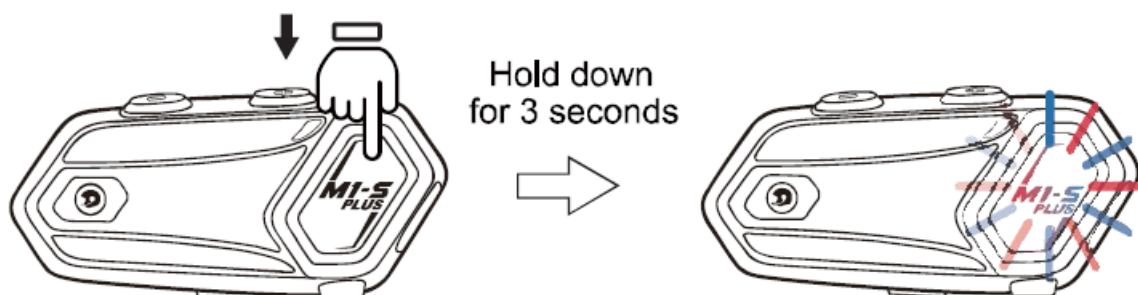

When the device is on, long press the Function button to enter Pairing Mode. Red and blue lights flash quickly. Voice notice " pairing ". Pairing mode for connection to Bluetooth devices such as mobile phones and Bluetooth GPS.

Active search mode

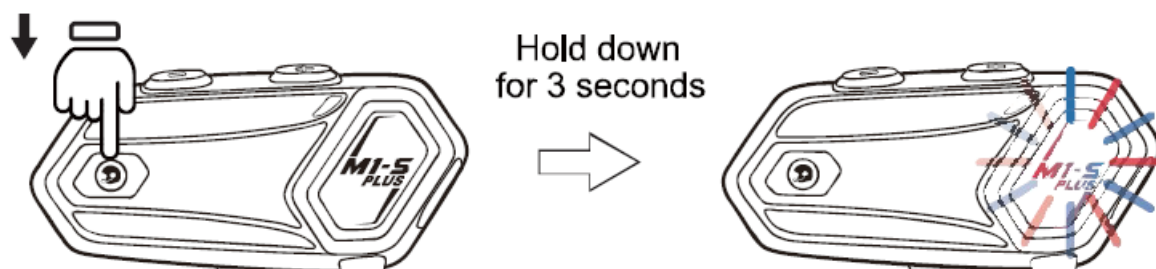

When the device is on, long press the Intercom button to enter Search Mode, red and blue lights flash slowly,

voice message says “Searching”. search mode only use for intercom function connection between M1-S PLUS devices.

(A) M1-S PLUS connect with (B) M1-S PLUS



An M1-S PLUS is in active search mode(refer to 5.1.2), B M1-S PLUS is in passive search mode(refer to 5.1.1), A and B M1-S PLUS change from flashing red and blue lights alternately to function and intercom buttons flashing blue lights at the same time. connect successfully.

Pairing With Cellphone

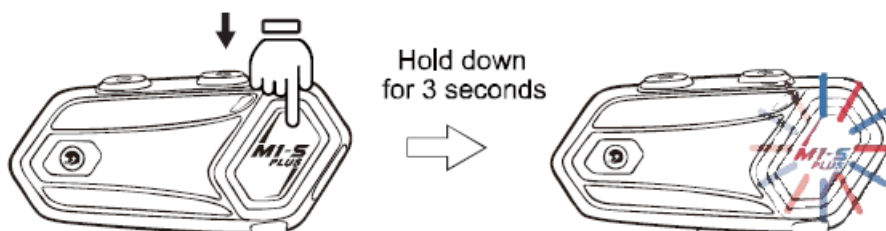

- STEP 1. When the device is on. long press the Function button, red and blue light flash quickly, entering passive pairing mode.



- **STEP 2.** Turn on the cellphone Bluetooth, select” FODSPORTS M1-S PLUS”, and the pairing is complete. A voice message will notice “Device Connected”.

Connect with two phones



- **Step 1.** Connect to the first phone(refer to 5.3)
- **Step 2.** Long press the Function button, M1-S PLUS on passive search mode, connect to the second phone.

Notice: M1-S PLUS can connect with two phones, but only support one phone for audio input.

Wire Connecting

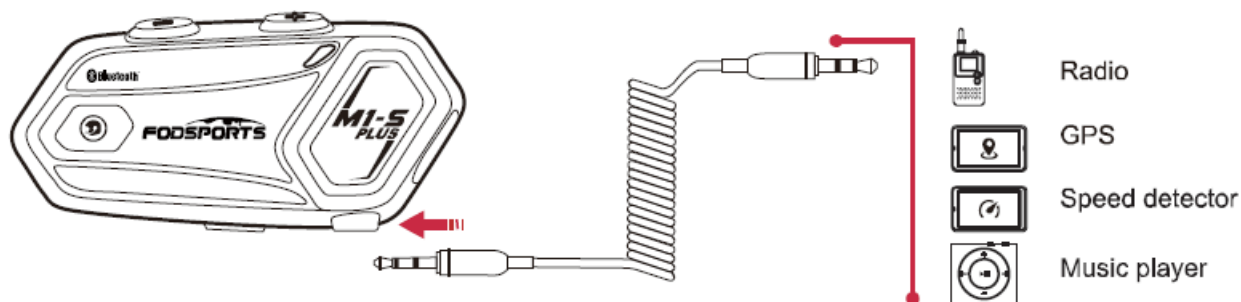

Any device with a 3.5mm connector can transmit a voice signal to M1-S PLUS. When the device wire is connected by 2.5mm to 3.5mm cable to M1-S PLUS. Complete the wired sound source input.

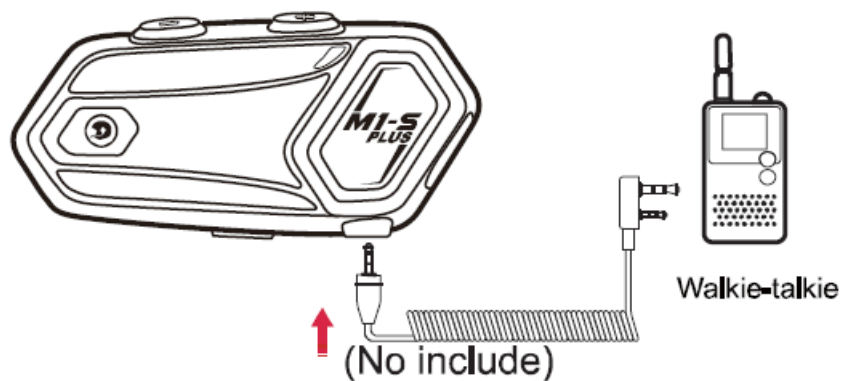

You need to purchase a cable if you need a wired connection for Walkie-talkie equipment.

Multi-device pairing connection

Occasions:

Rider A connects with Passenger B for the intercom. Then A connects with two Bluetooth devices and one wired equipment and B connects with one Bluetooth device(as shown below).

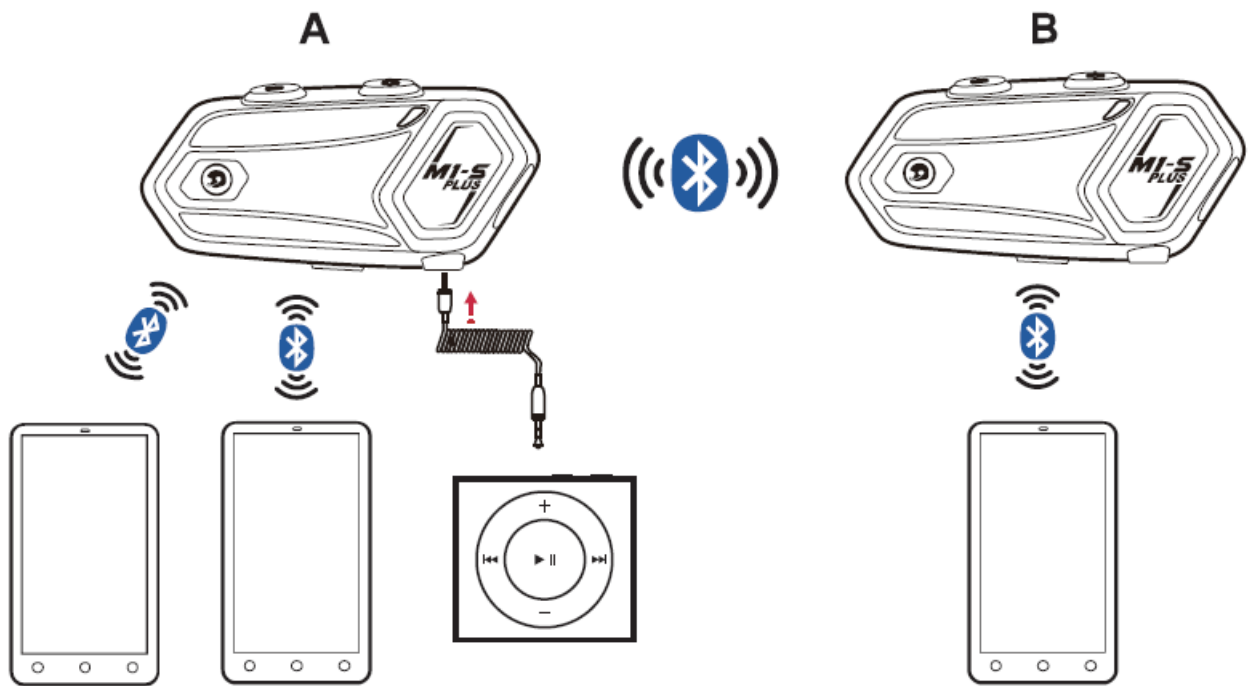

- **Step 1.** A M1-S PLUS connect with B M1-S PLUS(refer to 5.2)
- **Step 2.** Short press one time A or B intercom button to disconnect the intercom
- **Step 3.** A connect with 2 phones(refer to 5.4)
- **Step 4.** A use 2.5 mm to 3.5 mm AUX audio line to connect with one audio device
- **Step 5.** B connects with one phone(Bluetooth device)
- **Step 6.** Short press the intercom button of A or B for connection.

Notice: If A or B needs to use the audio function of the phone (Bluetooth device), you need to disconnect the intercom.

Multiple Intercom

M1-S PLUS equipped with multiple intercom function, recommended 4 units(A,B,C,D), pairing procedure as follow:

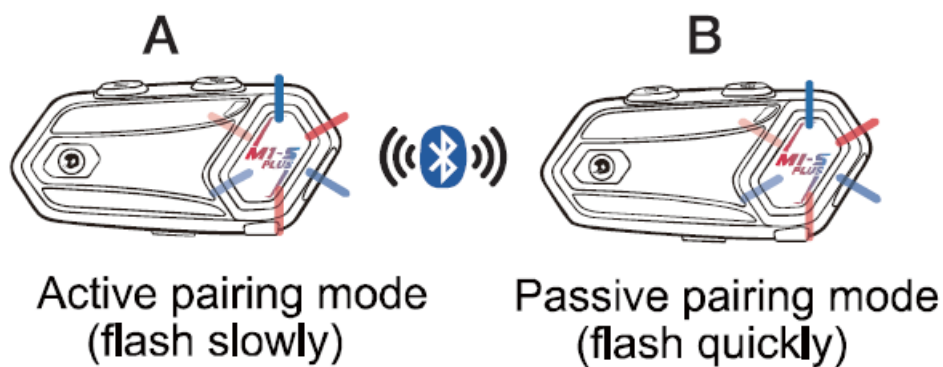

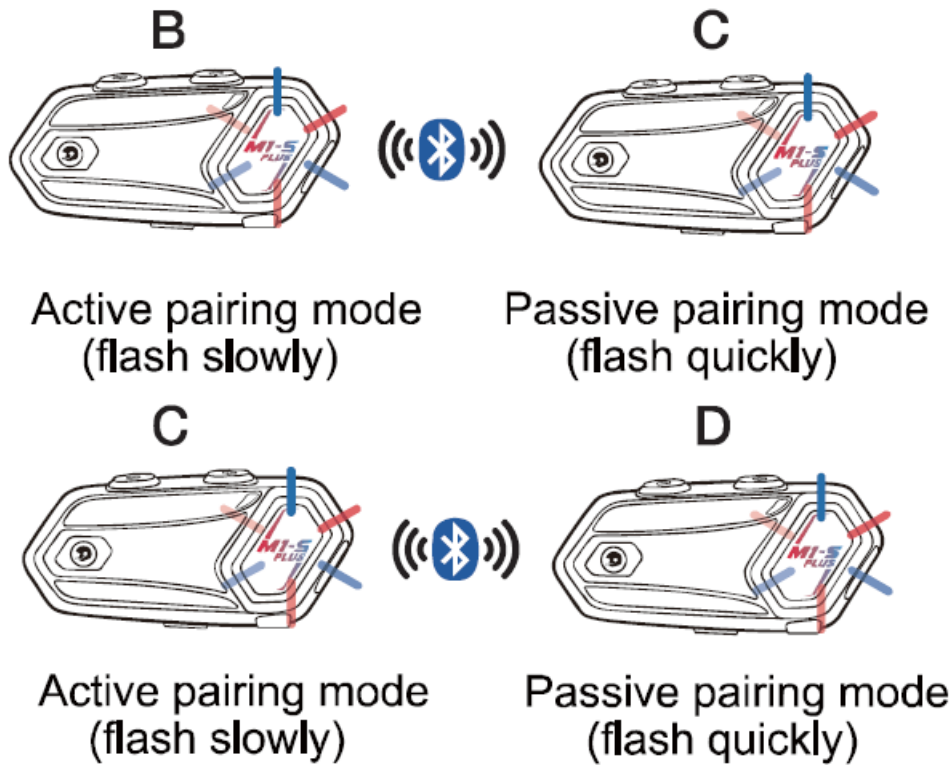

- **Step 1:** Unit A is on active search mode(refer to 5.1.2), Unit B is on passive search mode(refer to 5.1.1), Unit A and Unit B change from flashing red and blue lights alternately to function button and intercom button flashing blue lights at the same time,connect successfully. Short press the intercom button of Unit B for one time, exit intercom state temporarily.
- **Step 2:** Unit B is on active search mode(refer to 5.1.2), Unit C is on passive search mode(refer to 5.1. 1), Unit B and Unit C change from flashing red and blue lights alternately to function button and intercom button flashing blue lights at the same time, connect successfully. Short press the intercom button of Unit C for one time, exit intercom state temporarily.
- **Step 3:** Unit C is on active search mode(refer to 5.1.2), Unit D is on passive search mode(refer to 5.1.1), Unit C and Unit D change from flashing red and blue lights alternately to function button and intercom button flashing blue lights at the same time, connect successfully.
- **Step 4:** The intercom buttons and function buttons of Unit A .B C D and D flash blue light at the same time, the connection of group intercom successfully.

You can connect more M1-S PLUS by repeating the above methods.

Notice:

The first and the last one M1-S PLUS can connect with another 2 Bluetooth devices. The M1-S PLUS in the middle connection position of the group can connect with an additional Bluetooth device.

For example:

When in the group intercom mode, Unit B and C can only connect with one bluetooth device. Unit A and D can connect with two bluetooth devices.

Intercom Interruption

In multiple intercoms mode, if there is an incoming call caused one unit away from the connection, after call, will reconnected automatically.If interruption is caused by distance or bad signal, please press intercom button to reconnect.

Memory Connection Function

M1-S PLUS will remember paired units, but after switch off and want to reconnect again, please follow the procedure:

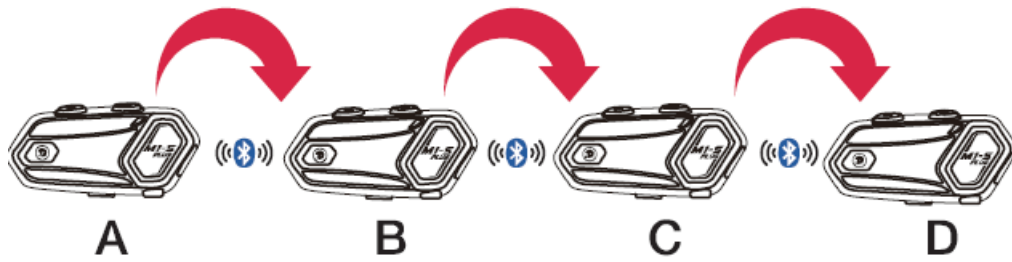

- **STEP 1.** Switch off all 4 units(A,B,C,D) and all Bluetooth devices connected to the headset such as cellphone and GPS. (It will affect the pairing)
- **STEP 2.** Switch on all 4 units(A,B,C,D) in the same time(long press intercom and function buttons about 3 seconds).
- **STEP 3.** Short press one intercom button of the 4 M1-S PLUS and they flash blue and red lights in the same time. Memory connection start successfully.
- **STEP 4.** After all 4 units reconnected , switch on original connected Bluetooth devices such as cellphone and GPS.

Four-persons intercom quick connection method (Fast Pairing Mode)

Step 1

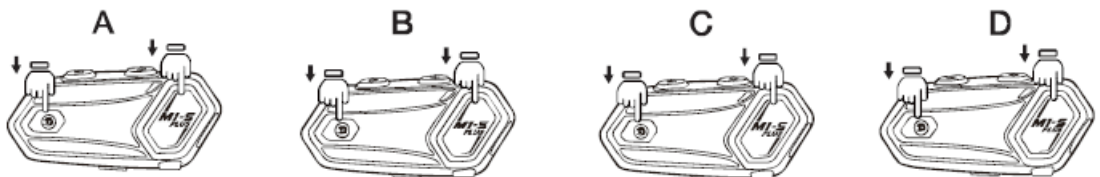

Step 2

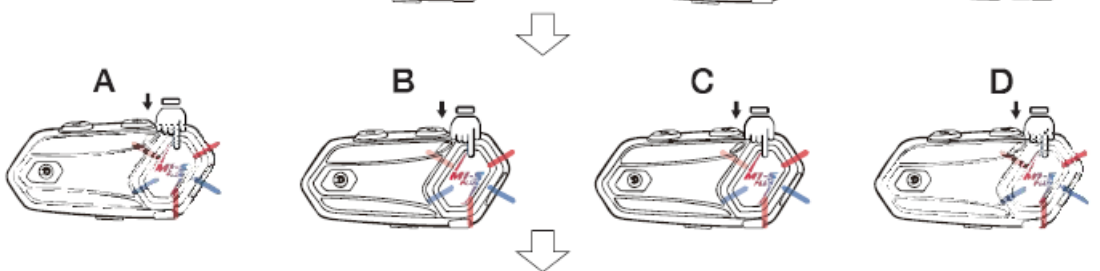

Step 3

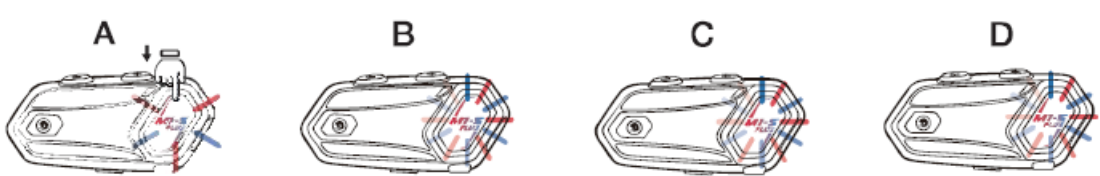

Step 4

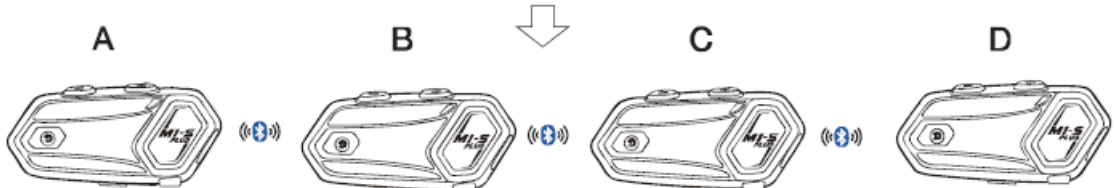

- **Step 1:** Switch on 4 M1-S PLUS of AB C and D.
- **Step 2:** Unit AB C and D are all on passive search mode by long pressing function buttons.4 Units are flash blue and red lights alternately, voice notice"pairing".

- **Step 3:** Short press the function button of one M1-S PLUS for one time, 4 units keep flashing blue and red light alternately.
- **Step 4:** After 15 seconds, Voice notice "Searching" of 4 units the function buttons and intercom buttons flash blue lights at the same time, group intercom connection finish successfully.

Notice: Fast pairing mode only for 4 riders use.

Technical Specifications

- **Bluetooth Support:** HSP,HFP,A2DP,AVRCP, AGHSP
- **Battery:** lithium battery, 900mA , 3.7v
- **Dimensions:** 8.6cm "4.4cm * 2.5cm
- **Weight:** 44G, 92G(Include Headphone & Mic Kits)
- **Frequency Range:** 2.4G-2.485G
- **Operating temperature:** -20 °C .50 °C
- **Certification:** CE FCC ROHS BQB TELEC
- **USB Adapter standard charge voltage:** DC 5V±0.2V
- **USB Adapter standard charge circuit:** DC 1A±0.5A
- **Charging time:** 2-3 hours

Q&A/Warning

Q1: No sounds from one or two side speaker.

A1: Check device plug,needs to firmly connected.

Q2: Can It be recharged from bike USB charger while riding?

A2.:

1. Not recommended,unstable power source will cause damage on internal circuit,may cause unable to recharge/can't fully charged/can't switch on.
2. Power bank will be good.

Q3: When using radlo,not transmission or continuous transmission.

A3: Check 2.5mm pin.has to insert finnly.The pin equipped with waterproof aprons,user might think its already plugged.

Q4: New device can't switch on.

A4: Recharged at least 30 minutes before switch use.

Warning

Sound Volume Warning

Long periods of listening or having the volume too high may damage your hearing.

Disassemble or Modification

The M1-S PLUS is precisely made in factory.Any disassemble or modification may damage the device,please do not tear any of the safety regulation and serial sticker from the device ,that will void the warranty.Please contact us

directly if needed.

Statement/Warranty/After-Sale Service

FCC Statement

Changes or modifications not expressly approved by the party responsible for compliance could void the user's authority to operate the equipment.

This equipment has been tested and found to comply with the limits for a Class B digital device.pursuant to Part 15 of the FCC Rules. These limits are designed to provide reasonable protection against harmful interference in a residential installation.This equipment generates uses and can radiate radio frequency energy and, if not installed and used in accordance with the instructions, may cause hannful interference to radio communications.

However.there is no guarantee that interference will not occur in a particular installation.If this equipment does cause harmful interference to radio or television reception,which can be determined by turning the equipment off and on,the user is encouraged to try to correct the interference by one or more of the following measures:

- Reorient or relocate the receiving antenna.
- Increase the separation between the equipment and receiver.
- Connect the equipment into an outlet on a circuit different from that to which the receiver is connected.
- Consult the dealer or an experienced radio/TV technician for help.

This device complies with part 15 of the FCC rules.Operation is subject to the following two conditions

1. This device may not cause hannful interference, and
2. This device must accept any interference received,including interference that may cause undesired operation.
This device has been evaluated to meet general RF exposure requirement.The device can be used in portable exposure condition without restriction.

Warranty

In nonnal use.one year warranty from the date of purchase.any disassemble.modification will void warranty.

Warranty Card

Production Date		Customer Name	
Purchase Date		Customer Tel	
Dealer Name		Customer E-mail	
Item No.		Remark	

After-Sale Service

For any quality problem or missing accessories, especially pairing problem between 2 or more M1•S PLUS headsets, please feel free to contact us at email: winzon.cs@outlook.com. We're always here ready to help, will reply to you in 12 hours.

User Manual Download



www.fodsports.com/support/m1-s-plus



fodsports.com

Documents / Resources

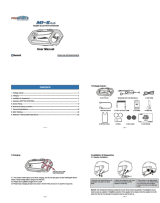
	<p>FODSPORTS M1-SPLUS Helmet Bluetooth Intercom [pdf] User Manual M1-SPLUS, M1SPLUS, 2A4SC-M1-SPLUS, 2A4SCM1SPLUS, M1-SPLUS Helmet Bluetooth Intercom, M1-SPLUS, Helmet Bluetooth Intercom</p>
---	--