

FODSPORTS
FODSPORTS
FX10C Bluetooth Mesh
Intercom



FODSPORTS FX10C Bluetooth Mesh Intercom Installation Guide

[Home](#) » [Fodsports](#) » FODSPORTS FX10C Bluetooth Mesh Intercom Installation Guide 

Contents

- [1 FODSPORTS FX10C Bluetooth Mesh Intercom](#)
- [2 Product Description](#)
- [3 Basic Function](#)
- [4 Charging](#)
- [5 Universal Pairing](#)
- [6 Pair Device \(Mobile phone\)](#)
- [7 Mobile Phone](#)
- [8 Website](#)
- [9 Music Sharing](#)
- [10 Bluetooth Intercom](#)
- [11 FODSPORTS Bluetooth Mesh Intercom](#)
- [12 Package Include](#)
- [13 Clamp Installation](#)
- [14 Installation](#)
- [15 Technical Specifications](#)
- [16 Documents / Resources](#)
 - [16.1 References](#)
- [17 Related Posts](#)



FODSPORTS FX10C Bluetooth Mesh Intercom



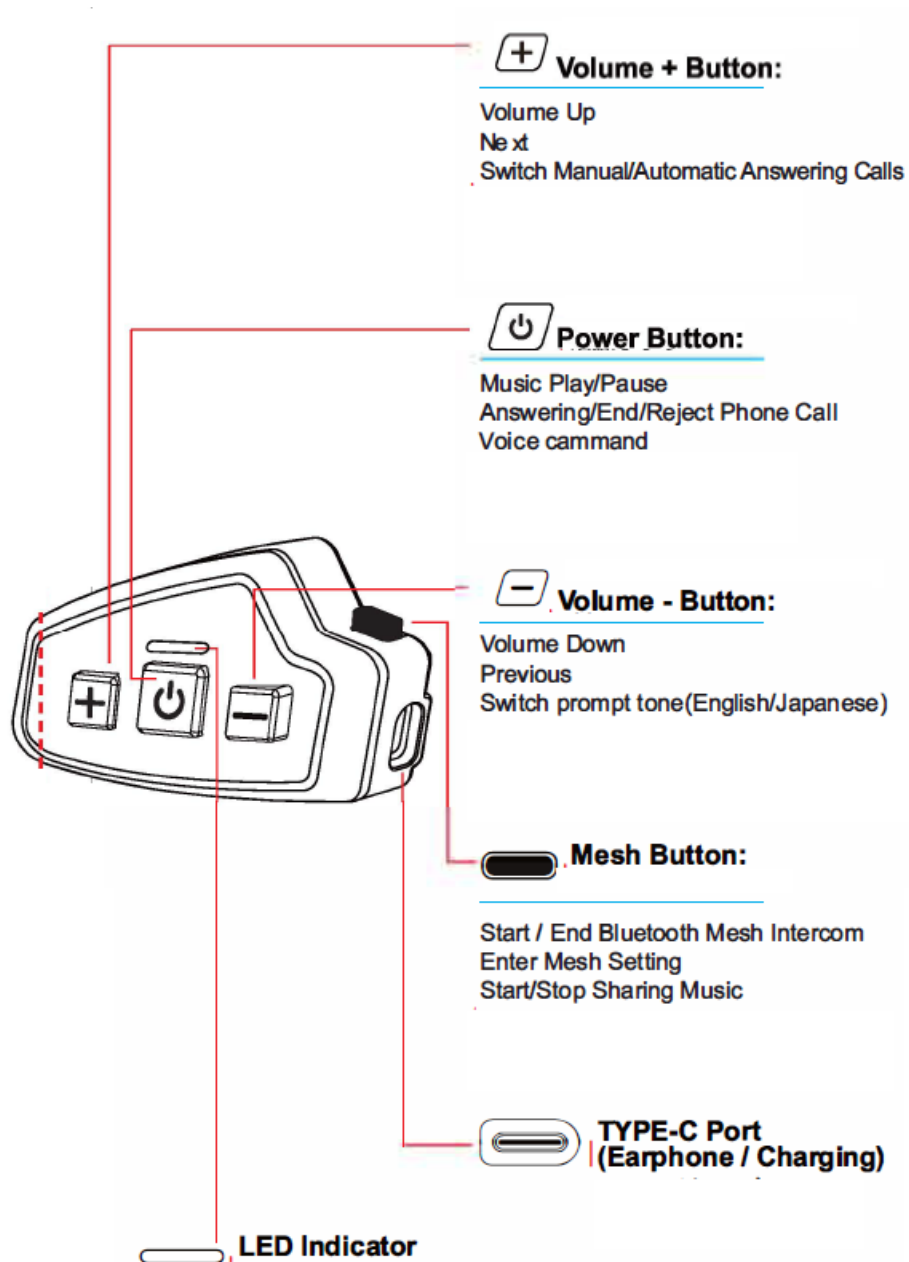

Product Description



 State:Charging

 State:Full Charge

 State:OFF

 State:ON / Stand by

 State:Pairing Mode

 State:Search Mode

 State: Start Intercom

 State: End Intercom

 State: Start Mesh Intercom

 State: End Mesh Intercom

Basic Function

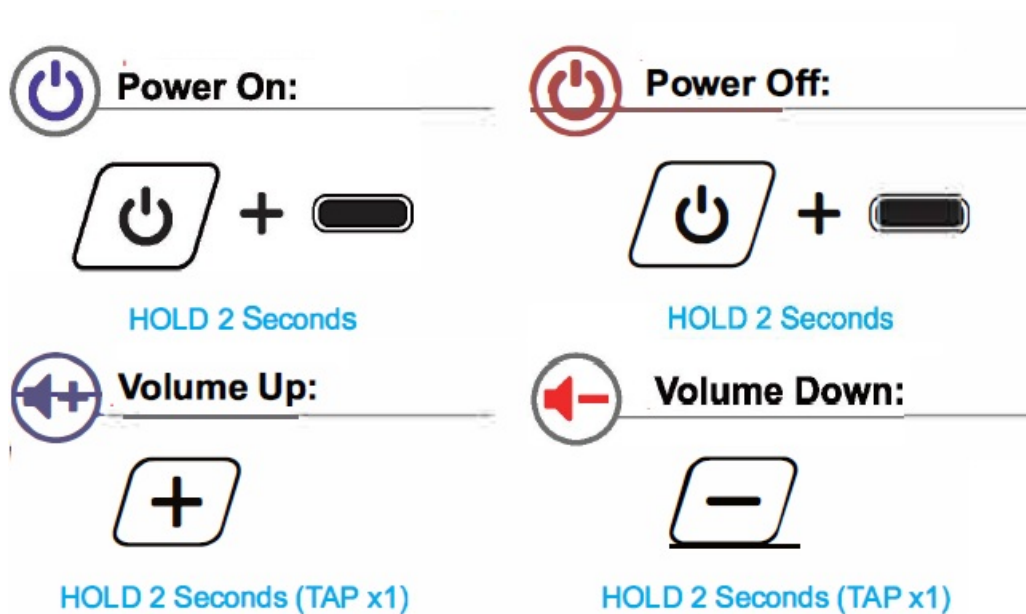

Volume Adjustment: Fm/Music/Telephone/Bluetooth Intercom/Mesh Intercom

- Music FODSPORTS
- Bluetooth Mesh Intercom

HOLD 2 Seconds

TAP x1

NOTE: When using the “FODSPORTS Bluetooth Mesh Intercom” function talkback, and music is played at the same time, the volume can be adjusted separately



Enter Pairing Mode:

*Used to connect Bluetooth devices



Enter Search Mode:

*Used to intercom function connection between FX 10C



Charging



TYPE-C Port(Charging)

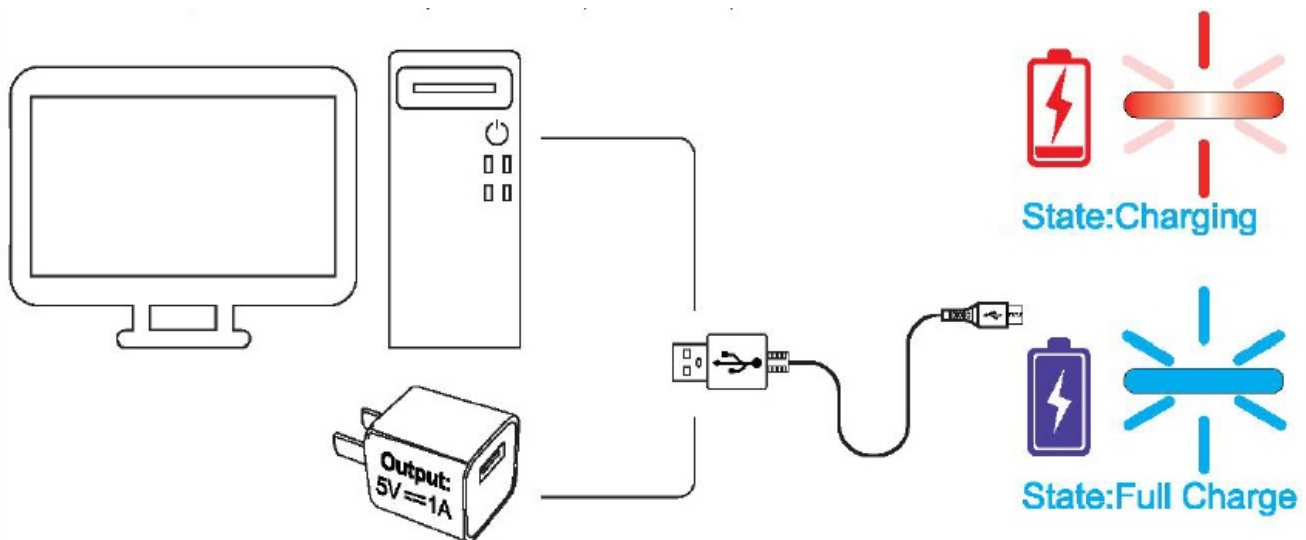

Battery detection

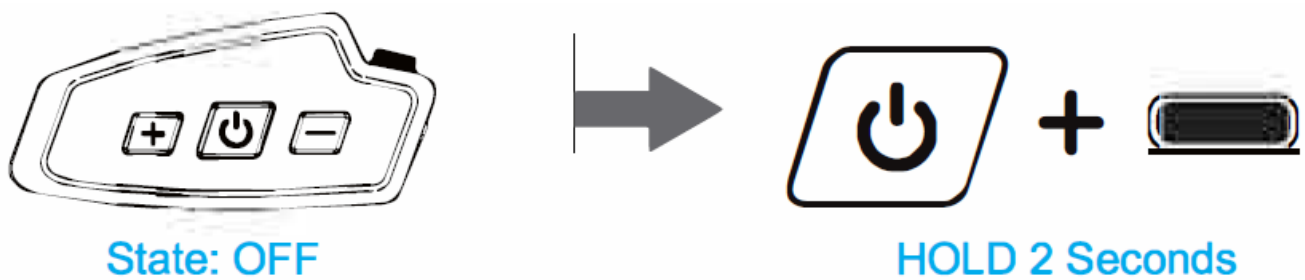

	Situation	Voice prompts
1		Battery 100%
2		Battery 80%
3		Battery 50%
4		Battery 25%



Reset Bluetooth Pairing Record:



Switch prompt tone(English/Japanese):

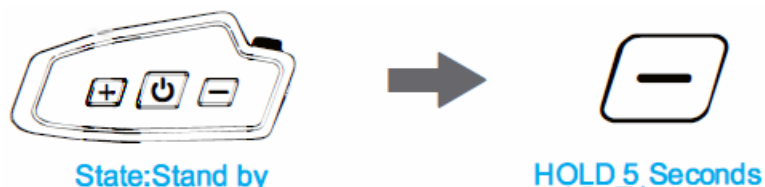

Universal Pairing



Non -fodsports/Other Bluetooth headset

Follow the unit instruction to enter pairing mode

Enter Search Mode:

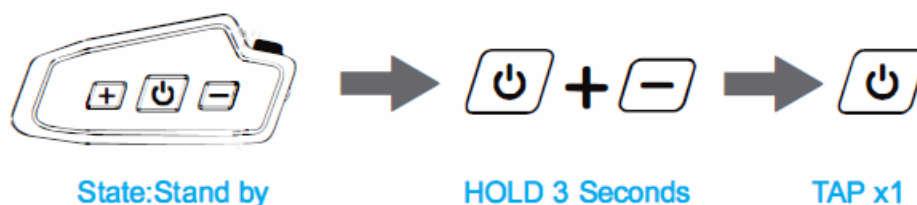

Paired Successfully

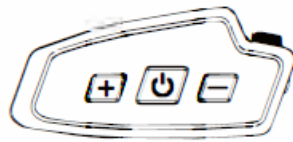

- Start Intercom
- End Intercom

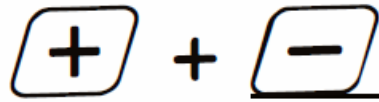

TAP x1



TAP x1

FM Radio



Radio On

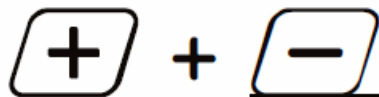

HOLD 3 Seconds



Radio Off

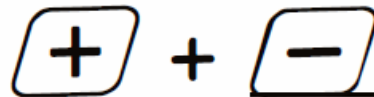

HOLD 3 Seconds



Previous Channel



TAP x2



Next Channel

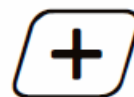

TAP x2

Pair Device (Mobile phone)

Power On



State: Off

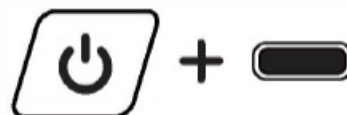

HOLD 2 Seconds

Enter Pairing Mode



State: On

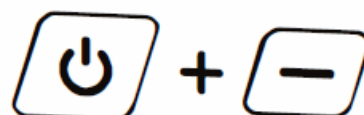

HOLD 3 Seconds

Pair Mobile Phone



Select "FODSPORTS FX 10C"

Paired Successfully

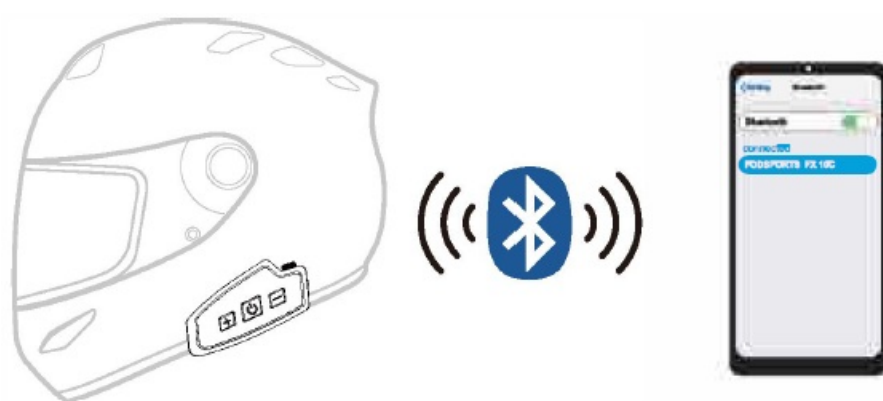

Mobile Phone



Answer Phone Call :



State:Call incoming



TAP x1



End Phone Call :



State:Call incoming



TAP x1



Reject Phone Call :

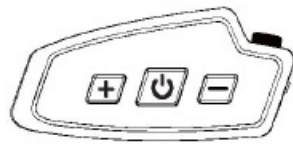

State:Call incoming



TAP x2



Voice Command (Siri/S-Voice):



State:Stand by



TAP x2



Switch Manual/Automatic Answering Calls:



State:Stand by

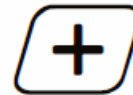

HOLD 5 Seconds

Website



User Manual Download



<https://community.fodsports.com/support/fx-10c-user-manual/>



Fodsports
Official Facebook Page



facebook.com/Fodsports



www.fodsports.com

You Tube
Fodsports
Official YouTube Channel



youtube channel: Fodsports

NOTE: In addition, you can also contact from the following email address. contact information :
winzon.cs@outlook.com

Music

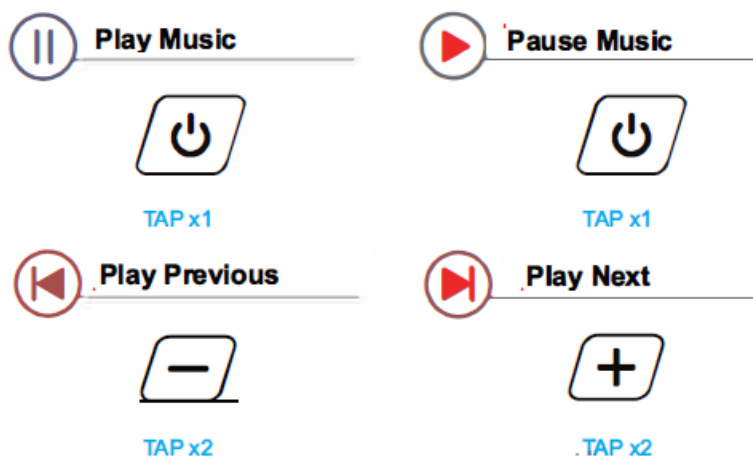

Music Sharing

Power on (No.1) and (No.2)



Intercom Connection

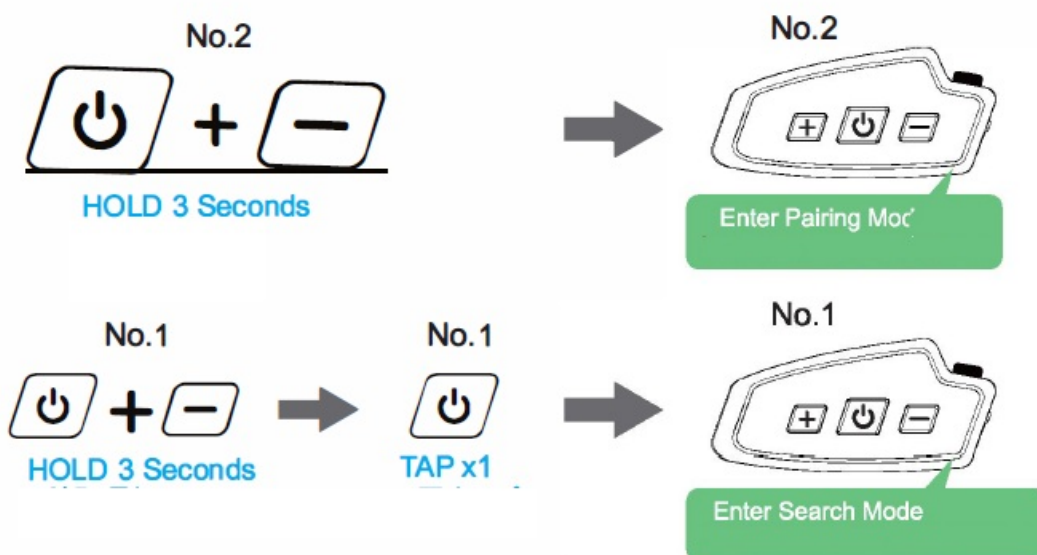

Paired Successfully

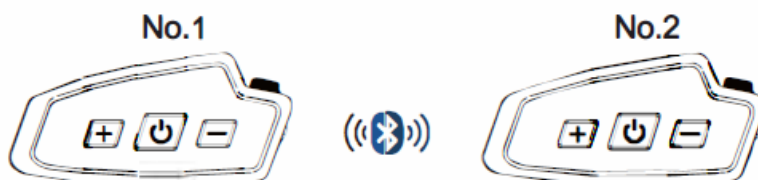

Enter Pairing Mode:



Paired with Mobile Phone

No.1

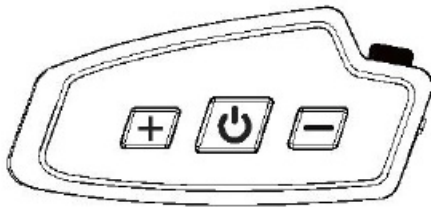

Playing Music

No.1

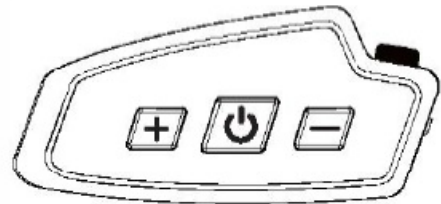

State:Playing Music

Music Sharing

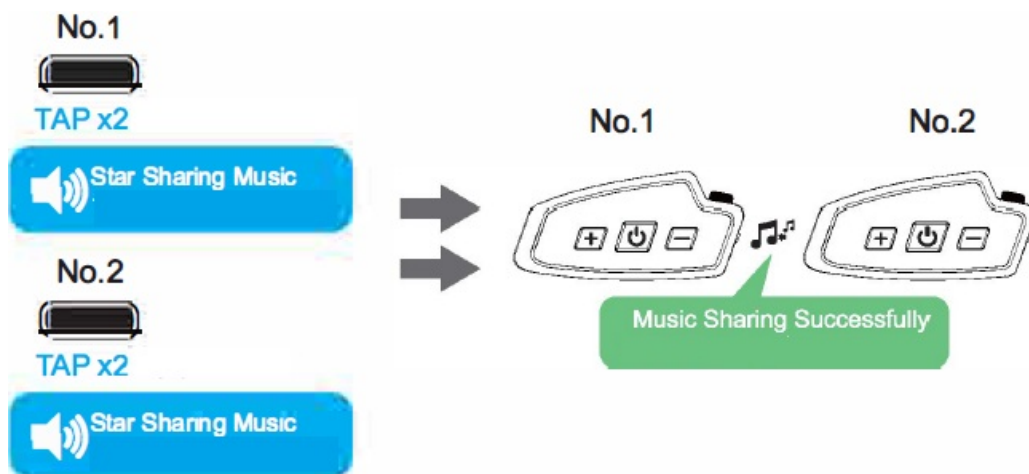

NOTE: When sharing music, the best effect is that one is connected to your phone and the other is not.

Exit Music Sharing

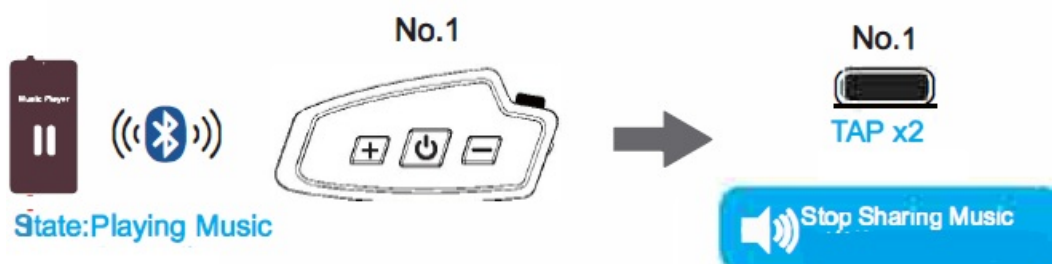

Bluetooth Intercom

Power on (No.1) and (No.2)

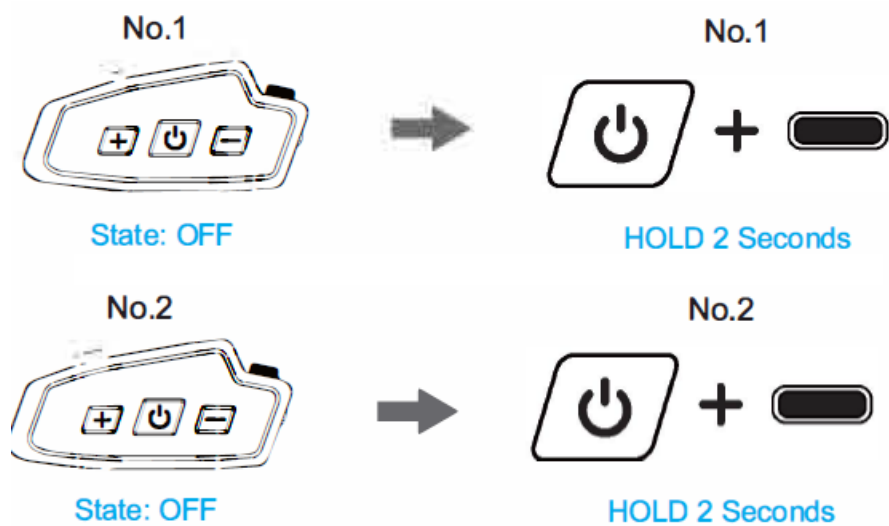

(No.1) and (No.2) enter pairing/ search mode

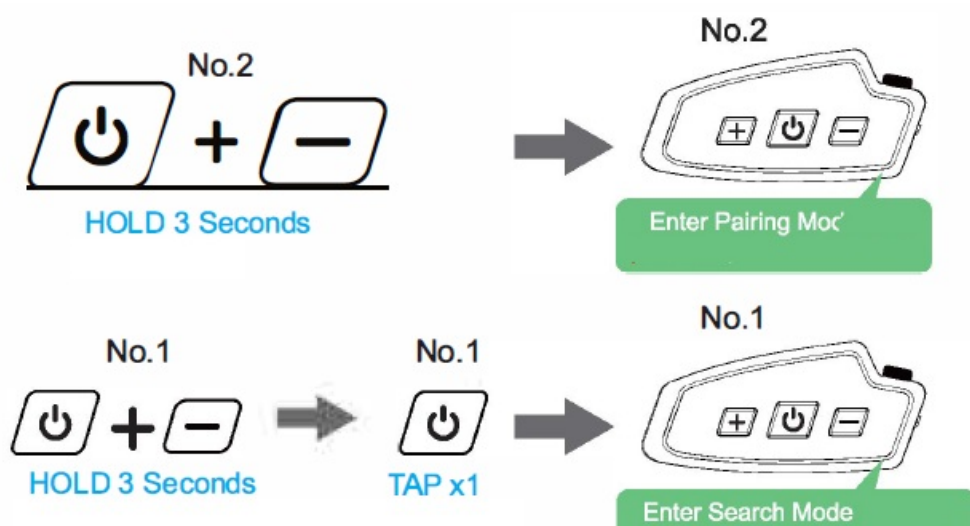

Paired Successfully



Start Intercom



End Intercom



HOLD 2 Seconds

FODSPORTS Bluetooth Mesh Intercom

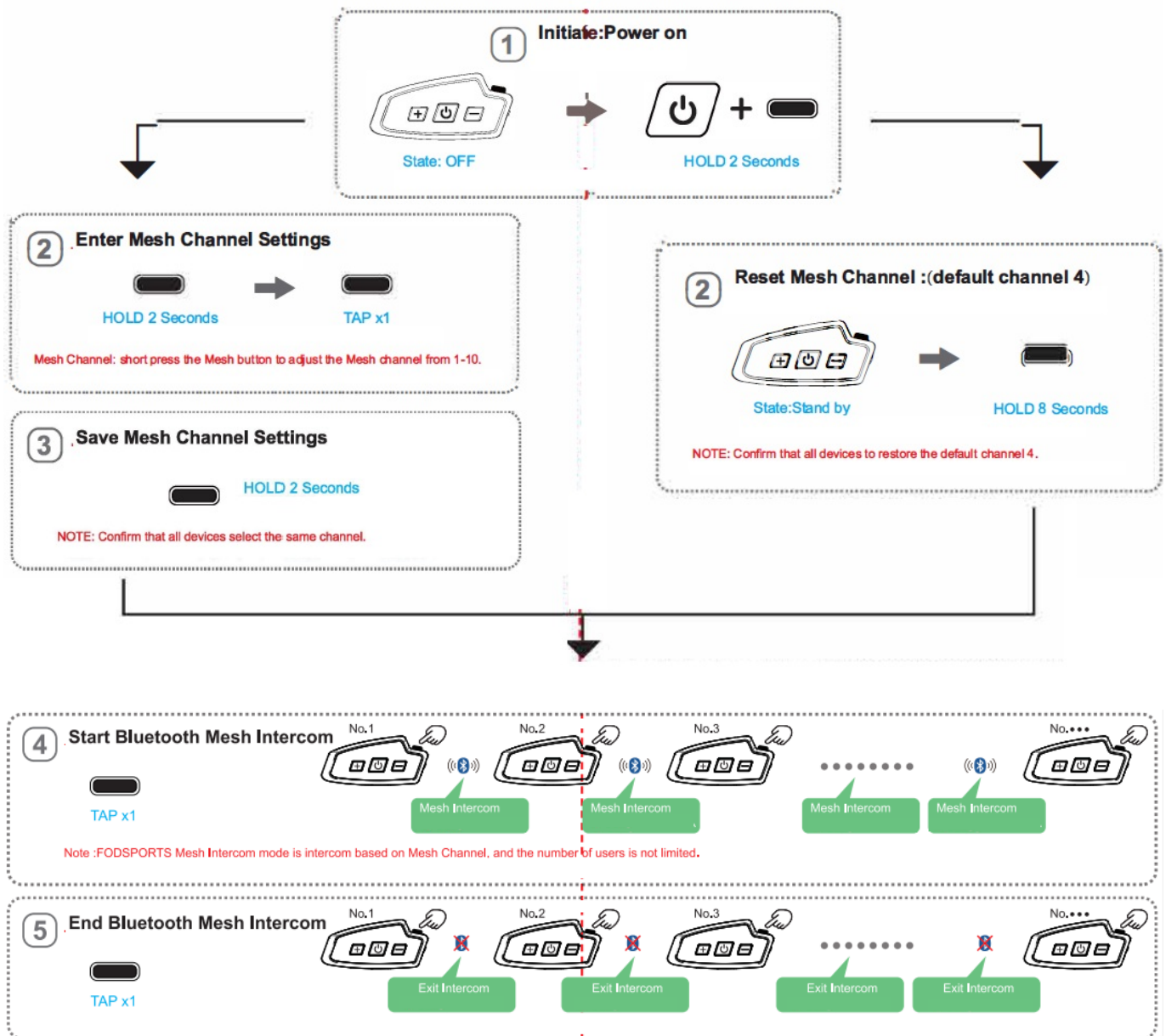

Background sound function

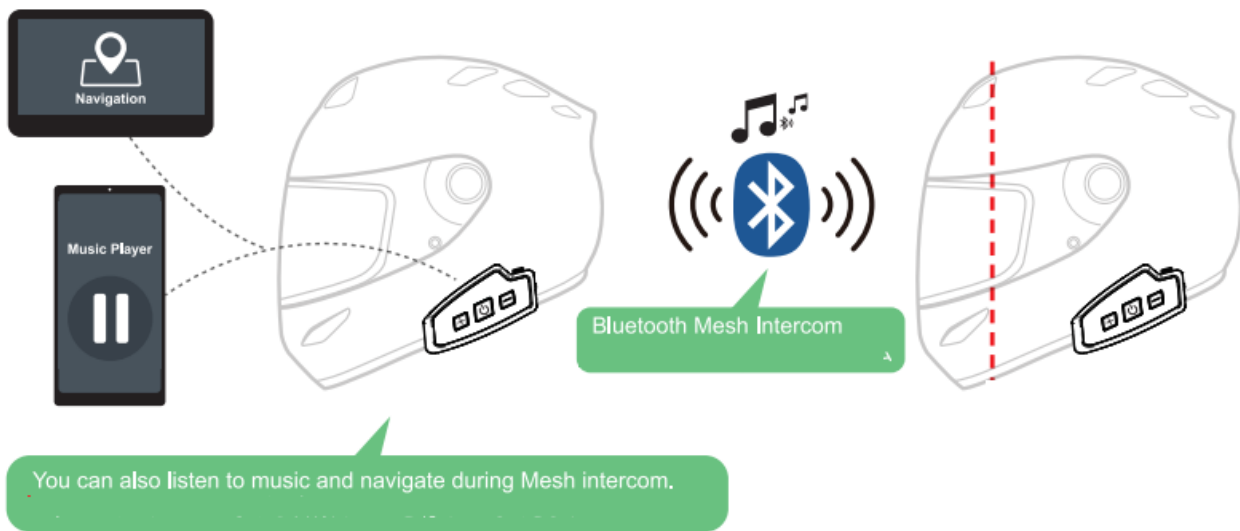

NOTE: When using the FODSPORTS Bluetooth Mesh intercom mode, you can listen to music and navigation while intercom.

Volume Adjustment:

Music



FODSPORTS Bluetooth Mesh Intercom



Package Include



FX 10C



Button Microphone



Speakers&Hard Tube Microphone



USB Cable

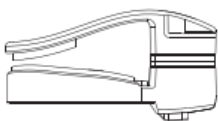

Clip Mounting Bracket



Wrench&Screw

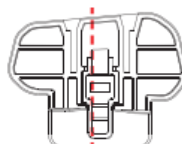

3M Tape Bracket

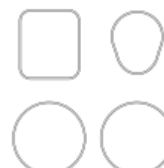

Unit Base



Start Guide

Clamp Installation

method 1 : Clip Mounting Bracket + Wrench&Screw

1

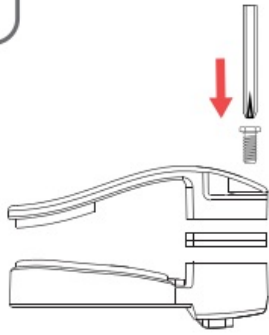

2



3

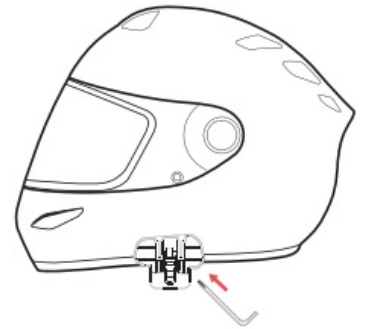

1. Assembly the Clip Mounting Bracket.
2. Fix the Clip Mounting Bracket to the helmet.
3. Screw the screw in with a wrench.

4

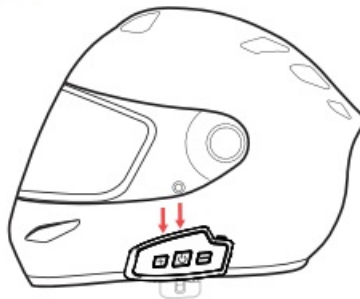

4. Install the FX 1 0C to helmet.

Method 2: 3M Tape Bracket

1

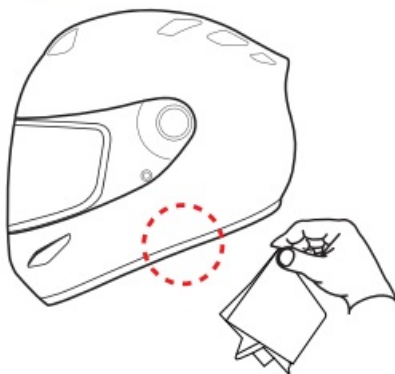

2

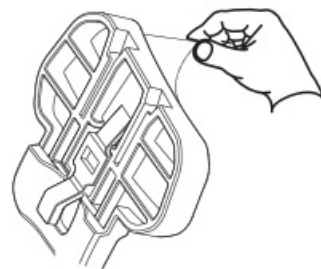

1. Wipe clean the position for pasting the base.
2. Tear the 3M Tape protective layer.
- 3.

3



Press the 3M Tape Bracket for more than 15 seconds to make it fit better.

4

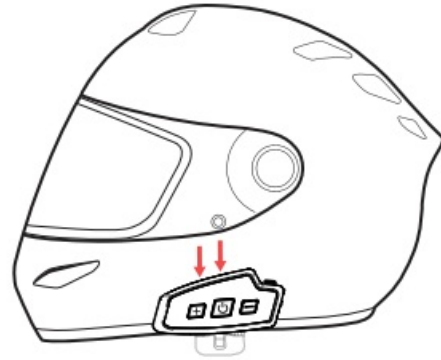

4. Install the FX 10 C to helmet.

Installation

Situation 1: Speakers & Button Microphone+ FX 10C

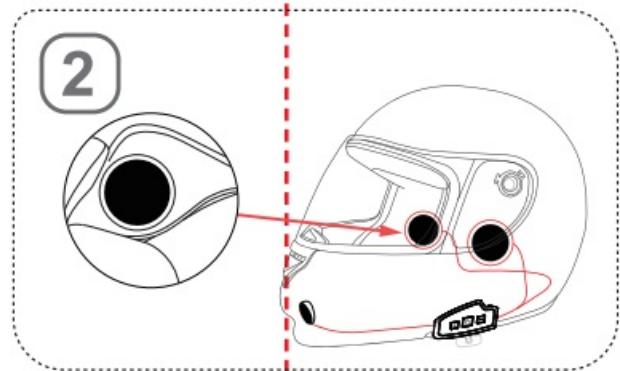
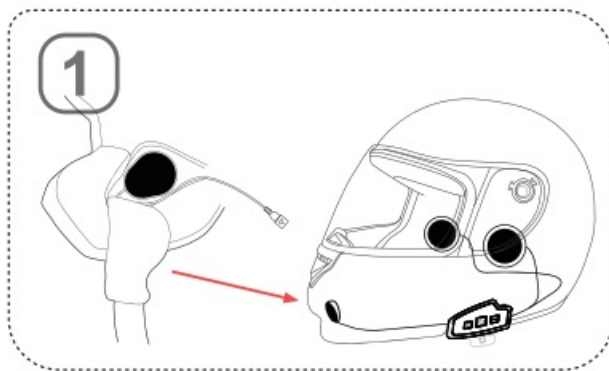

1. Locate an area in the nose section just to the left of center to mount the button microphone for full helmets .
Place the button microphone to the velcro pad and it to the connector of the headset.
2. Place the speakers into the cheek pads. Push the speakers and microphone firmly against the Velcro pads.
Press the wires into the gap between the helmet liner and shell.

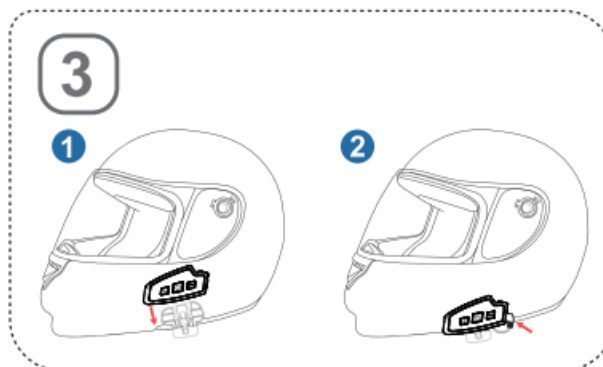

3. Insert the microphone and earphone line, installation complete.

Situation 2: Speakers & Hard Tube Microphone+ FX 10C

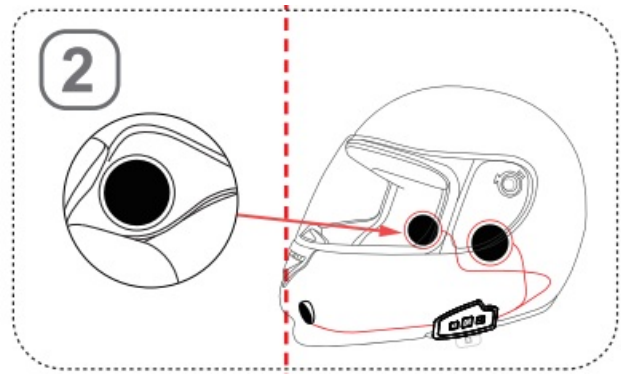
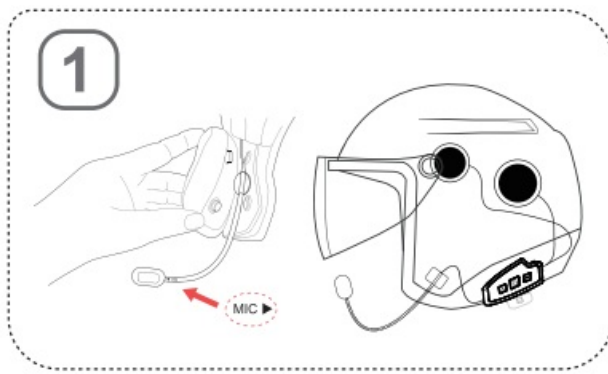

1. If you are installing into an open face helmet, please adjust the direction of the microphone so that the triangular mark on the microphone is pointing towards your mouth.
2. Place the speakers into the cheek pads. Push the speakers and microphone firmly against the Velcro pads. Press the wires into the gap between the helmet liner and shell.

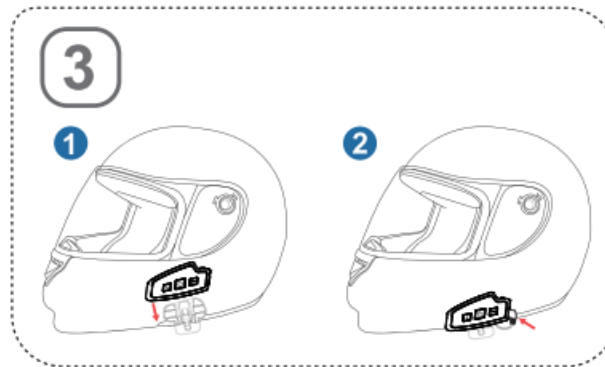

3. Insert the microphone and earphone line, installation complete.

Technical Specifications

1. Bluetooth 5.0 Support:
2. Battery Total Capacity: lithium battery, 800mAh /3.7v
3. Dimensions: 94mm *44mm * 25mm
4. FODSPORTS Bluetooth Mesh Intercom
(the number of users is not limited.)
5. Intercom users: Two riders
6. Working time:15 hours
7. Standby time:200 hours
8. Charging time: 2-3 hours
9. Weight: 44g ; 92g (Include Headphone & Mic Kits)
10. Frequency Range: 2.4G~ 2.485G
11. Operating temperature: -20 °C~ 50 °C
12. Certification: CE FCC ROHS BQB TELEC
13. USB Adapter standard charge voltage: DC 5V±0.2V
14. USB Adapter standard charge circuit: DC 1A~ 2A

The FX 1 OC operates in the following order of priority

1. Phone call (highest)

2. FODSPORTS Bluetooth
Mesh Intercom
3. Intercom
4. Music
5. FM Radio

<https://www.fodsports.com>

Documents / Resources

	<p>FODSPORTS FX10C Bluetooth Mesh Intercom [pdf] Installation Guide FX10C Bluetooth Mesh Intercom, FX10C, Bluetooth Mesh Intercom, Mesh Intercom, Intercom</p>
---	--

References

- [User Manual](#)

[Manuals+.](#) [Privacy Policy](#)

This website is an independent publication and is neither affiliated with nor endorsed by any of the trademark owners. The "Bluetooth®" word mark and logos are registered trademarks owned by Bluetooth SIG, Inc. The "Wi-Fi®" word mark and logos are registered trademarks owned by the Wi-Fi Alliance. Any use of these marks on this website does not imply any affiliation with or endorsement.