



# FOCAL 1000 series utopia 3 Way in Wall Loudspeaker User Manual

[Home](#) » [FOCAL](#) » FOCAL 1000 series utopia 3 Way in Wall Loudspeaker User Manual 

## Contents

- [1 FOCAL 1000 series utopia 3 Way in Wall Loudspeaker](#)
- [2 INSTALLATION SPECIFICATION](#)
- [3 IMPORTANT SAFETY INSTRUCTIONS](#)
- [4 Package contents](#)
- [5 Key points](#)
- [6 INSTALLATION](#)
- [7 Product assembly](#)
- [8 Documents / Resources](#)
  - [8.1 References](#)
- [9 Related Posts](#)



**FOCAL 1000 series utopia 3 Way in Wall Loudspeaker**



## INSTALLATION

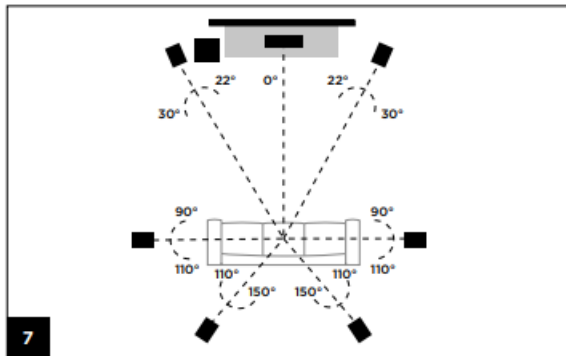
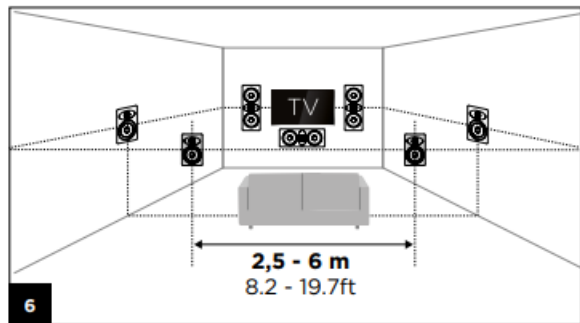
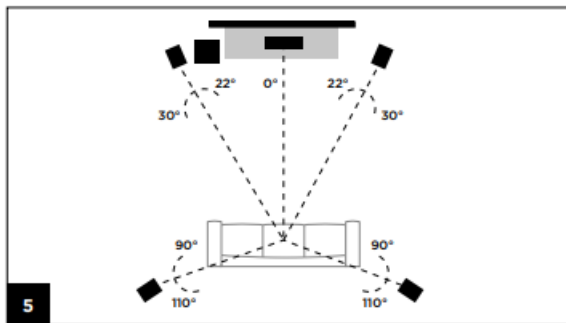
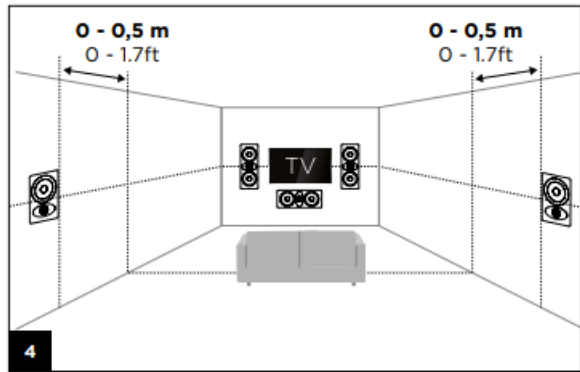
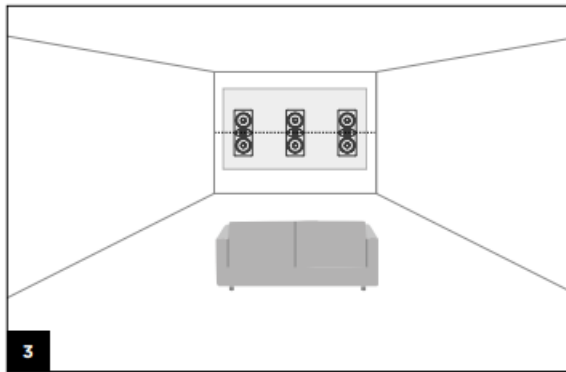
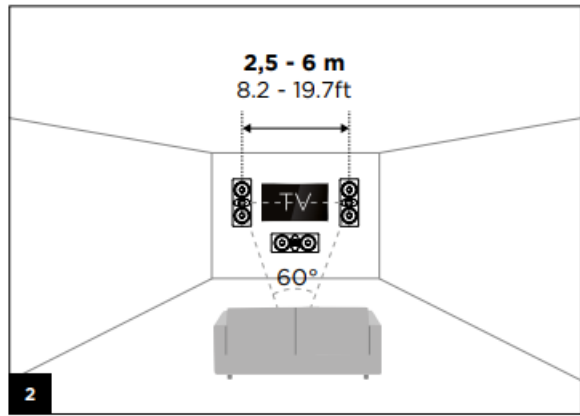
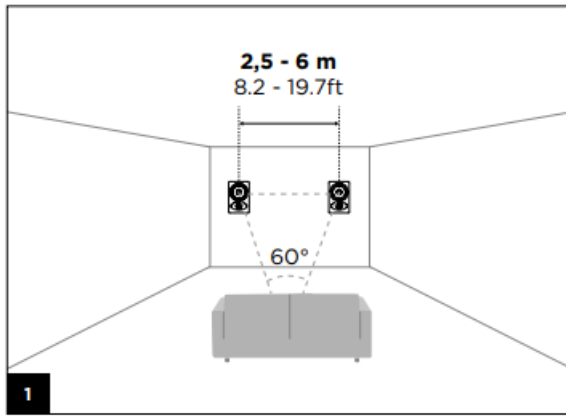

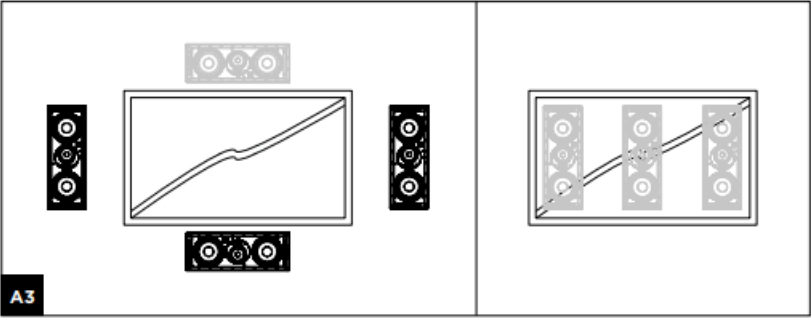
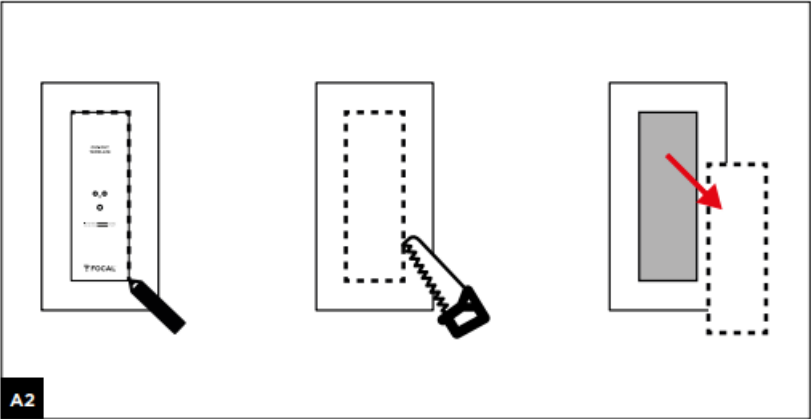
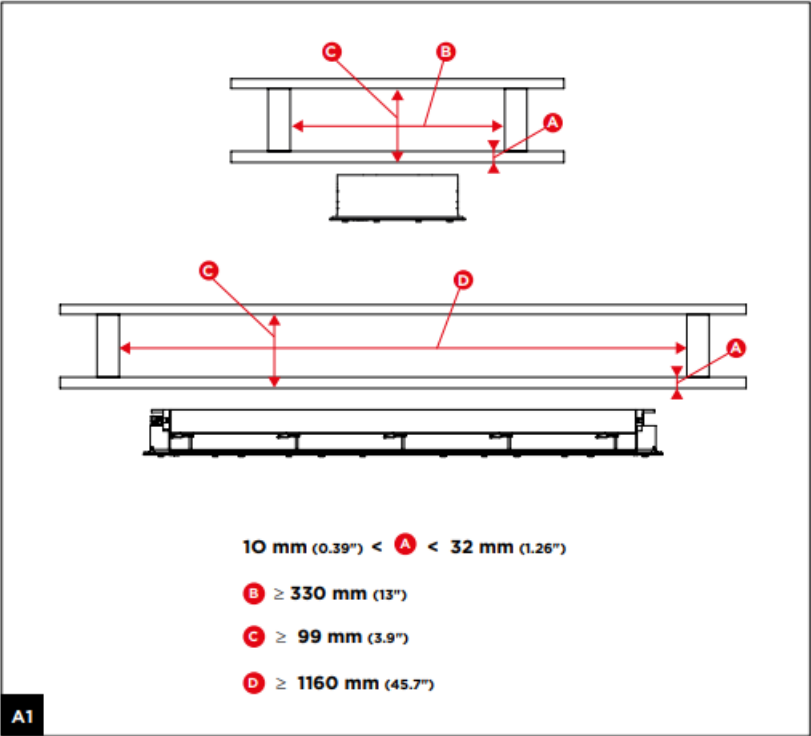

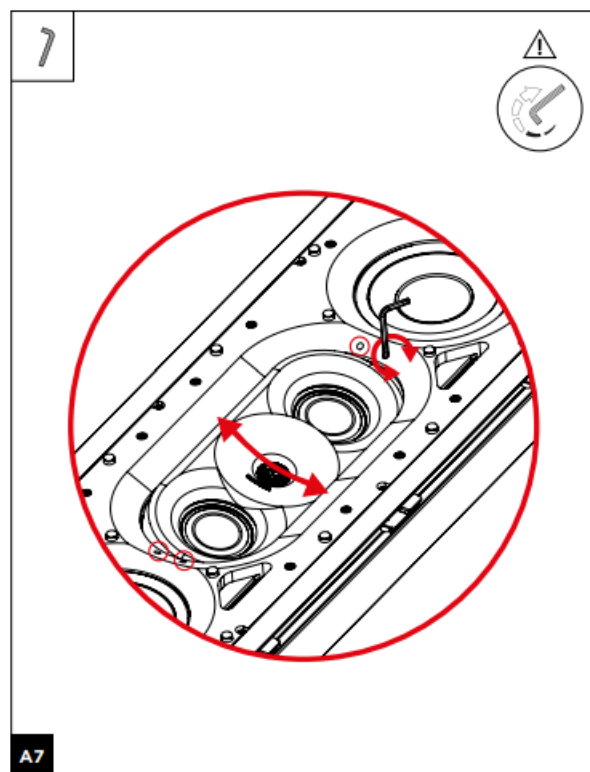
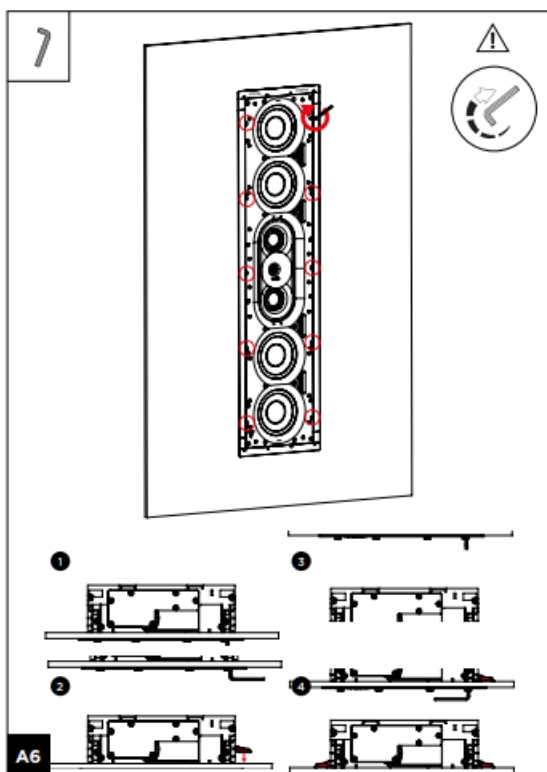
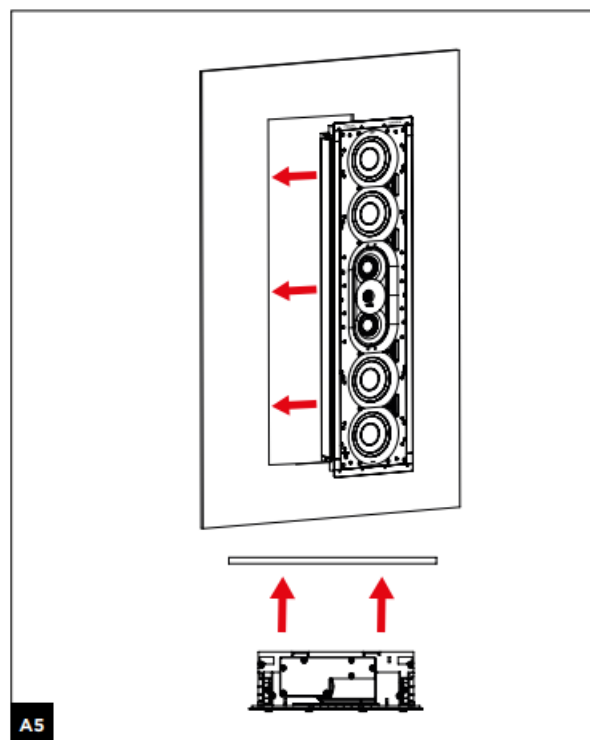
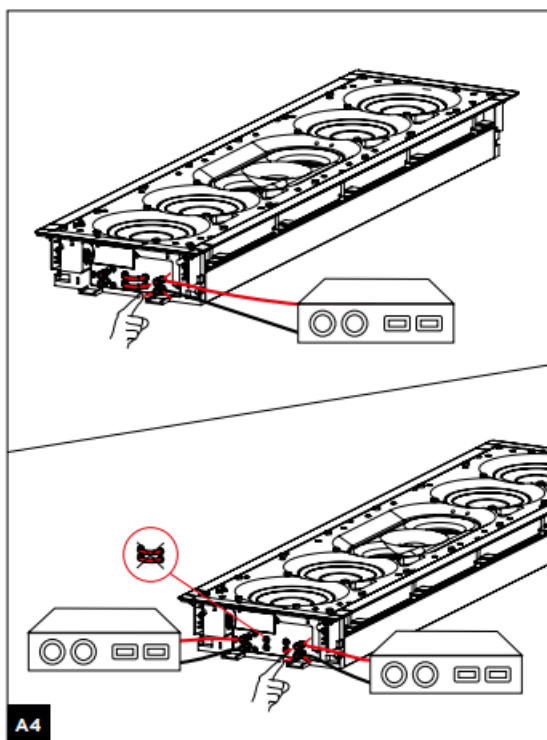

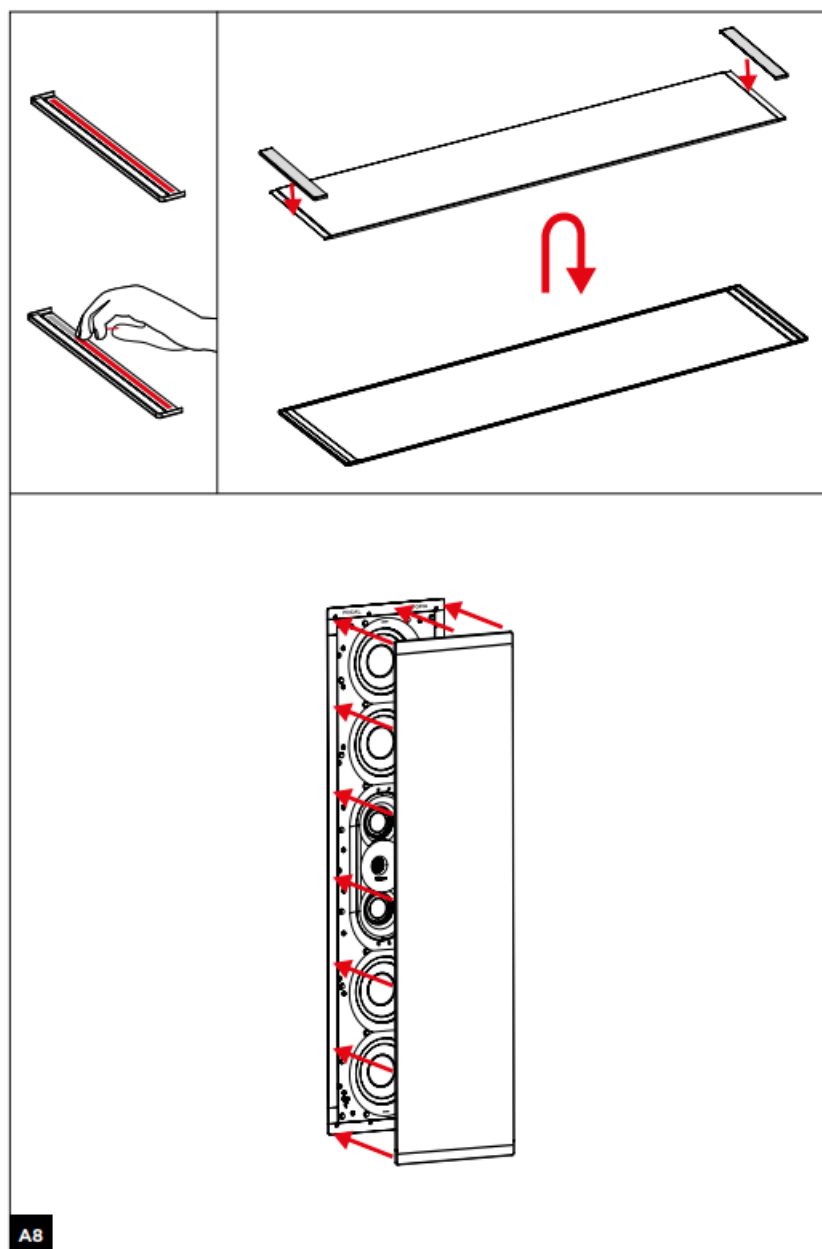

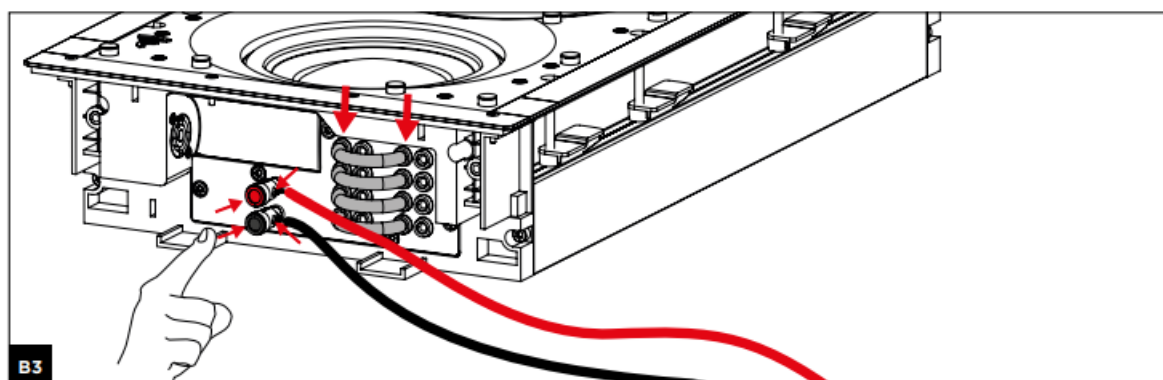
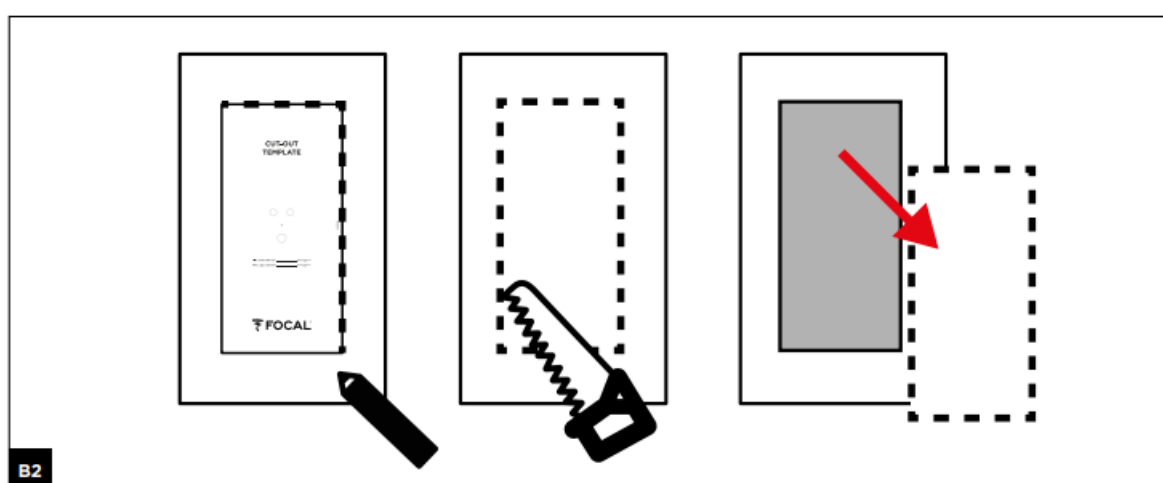
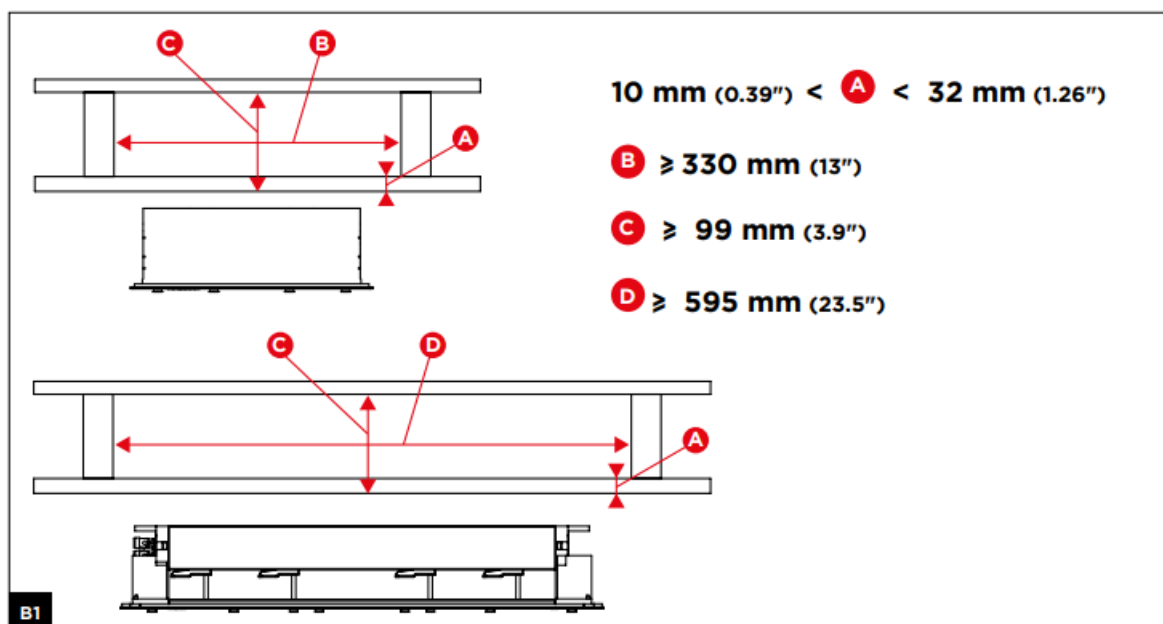

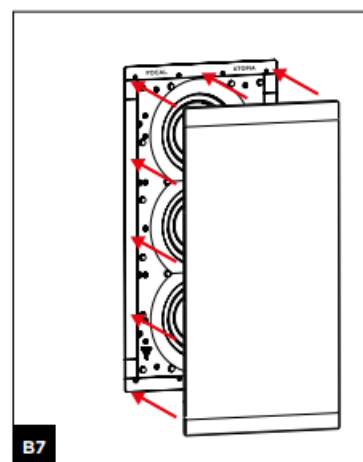
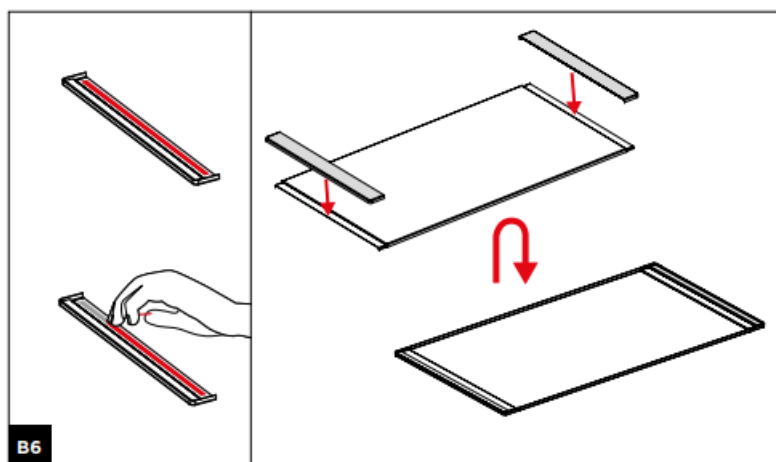
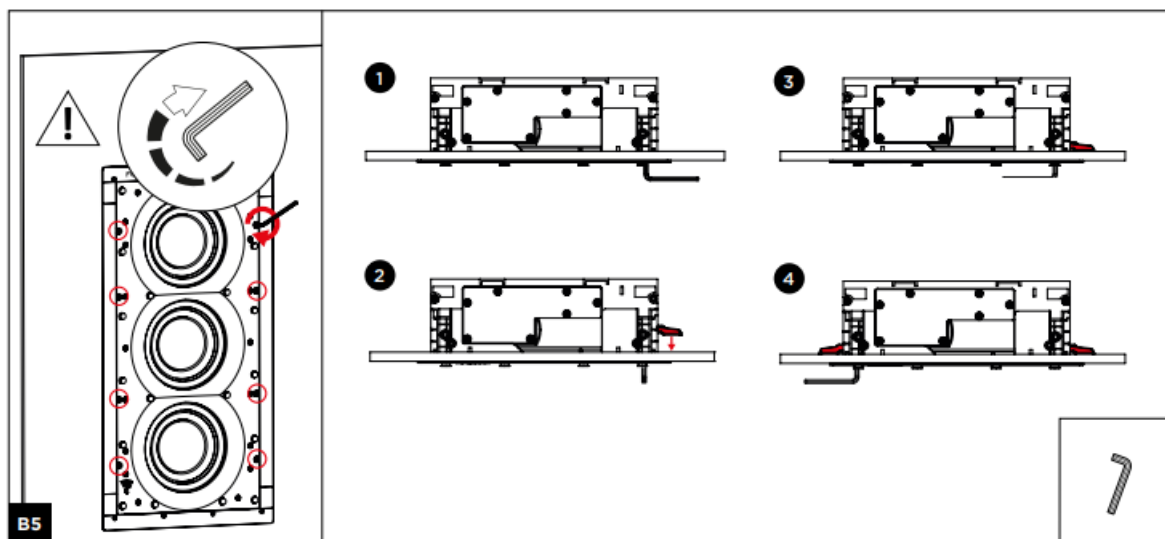
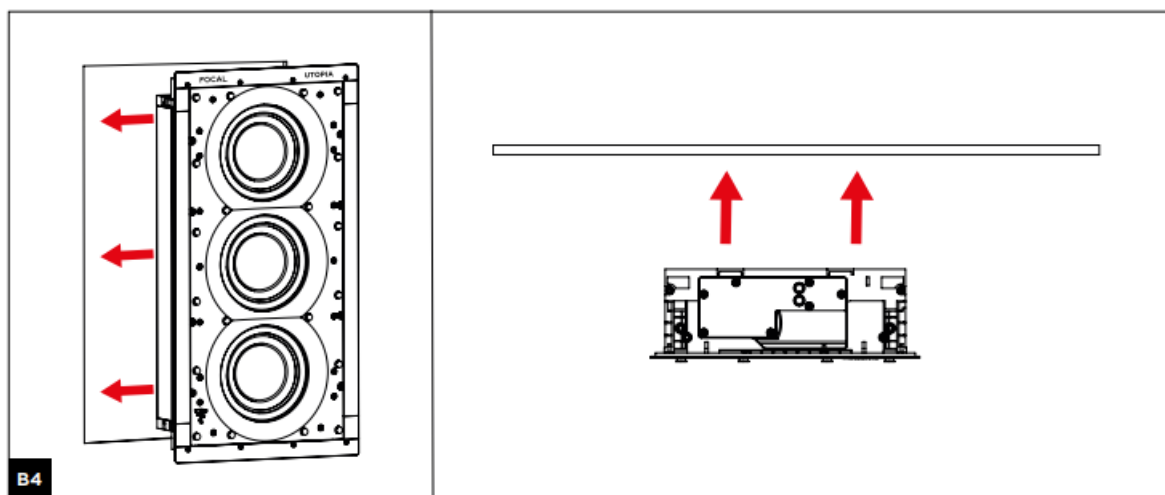



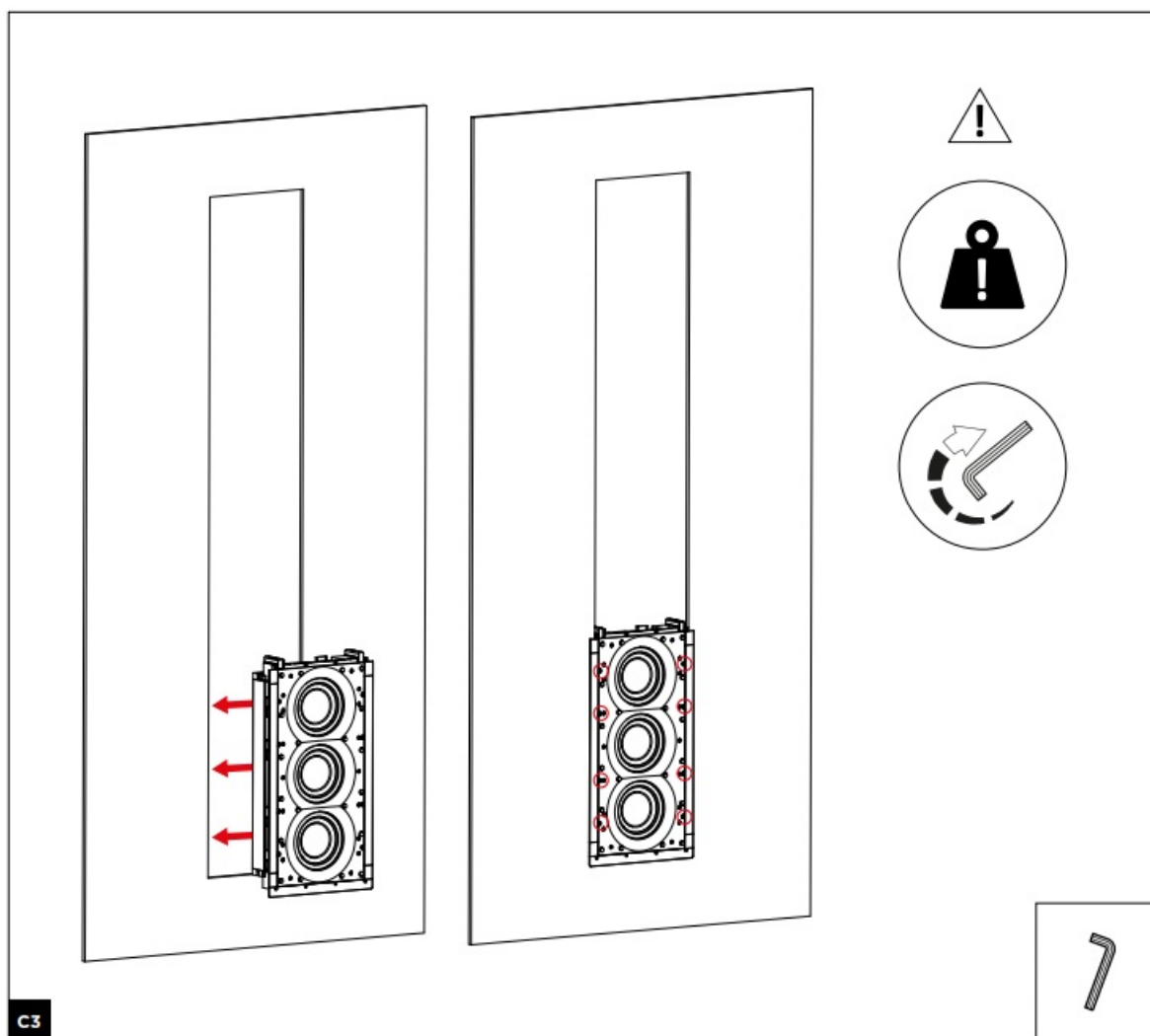
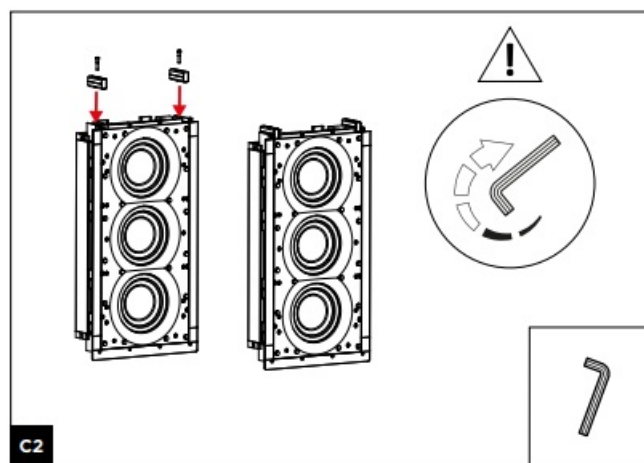
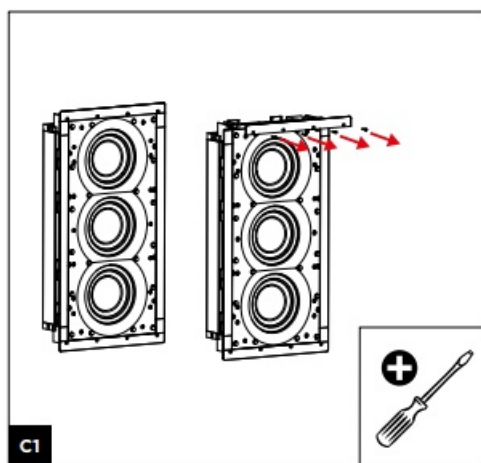

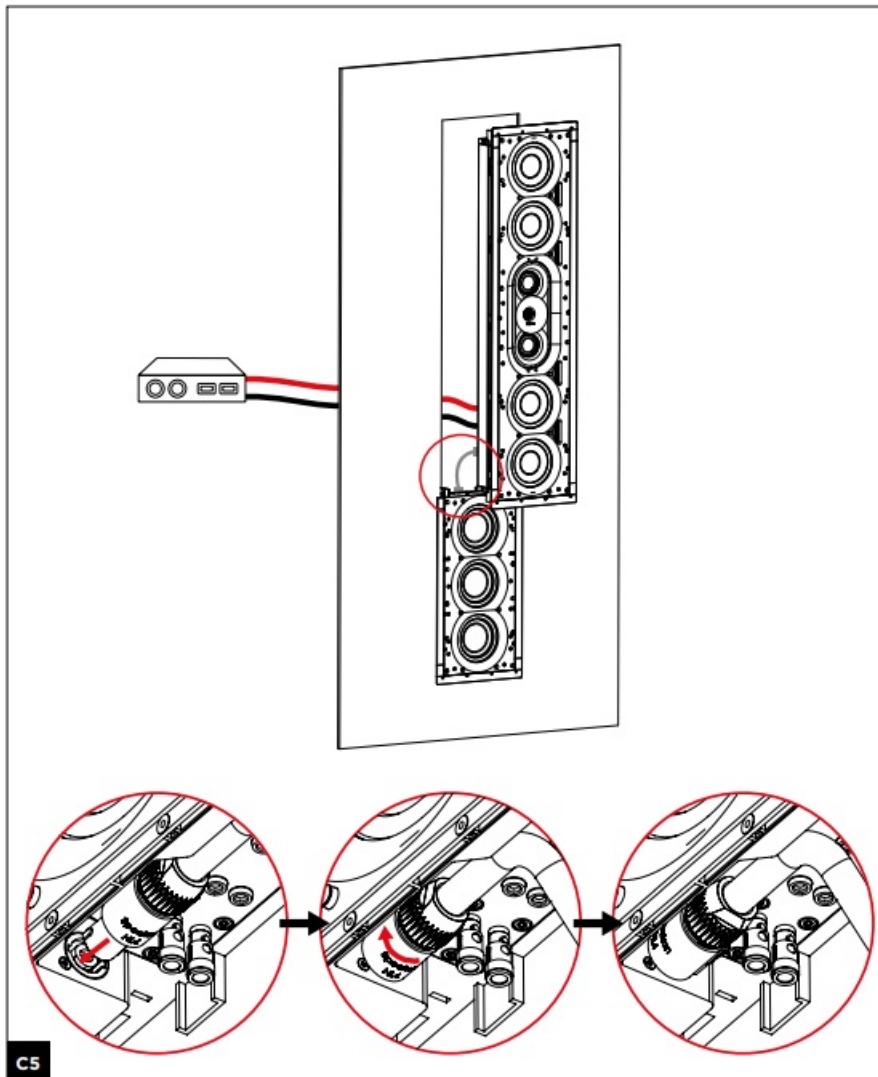
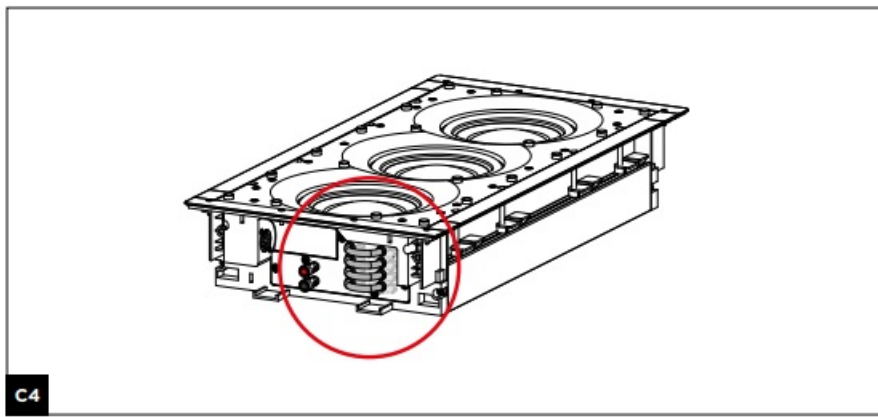

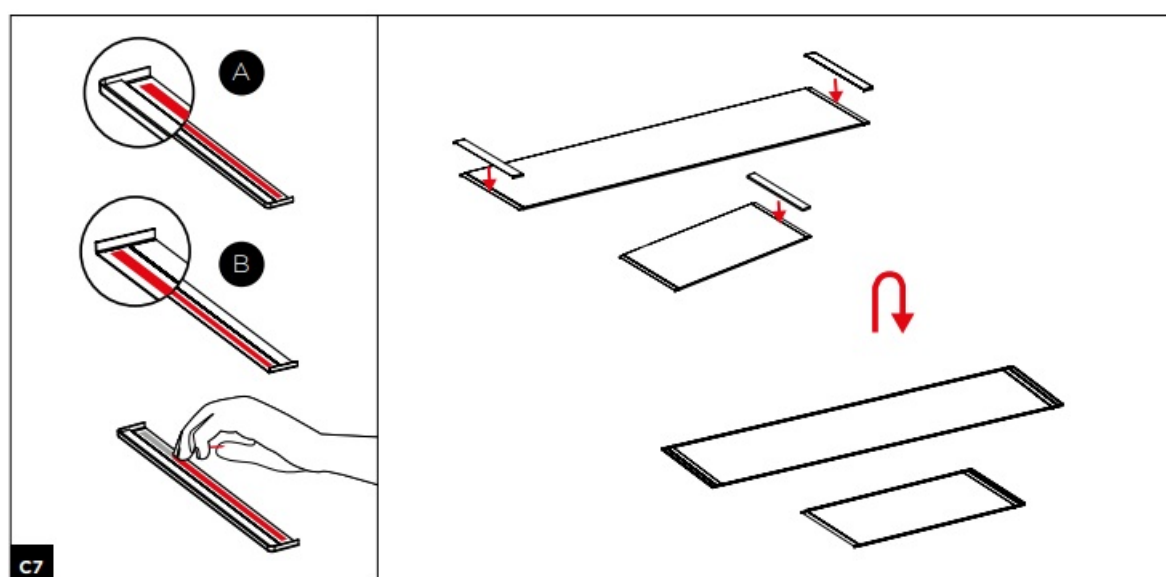
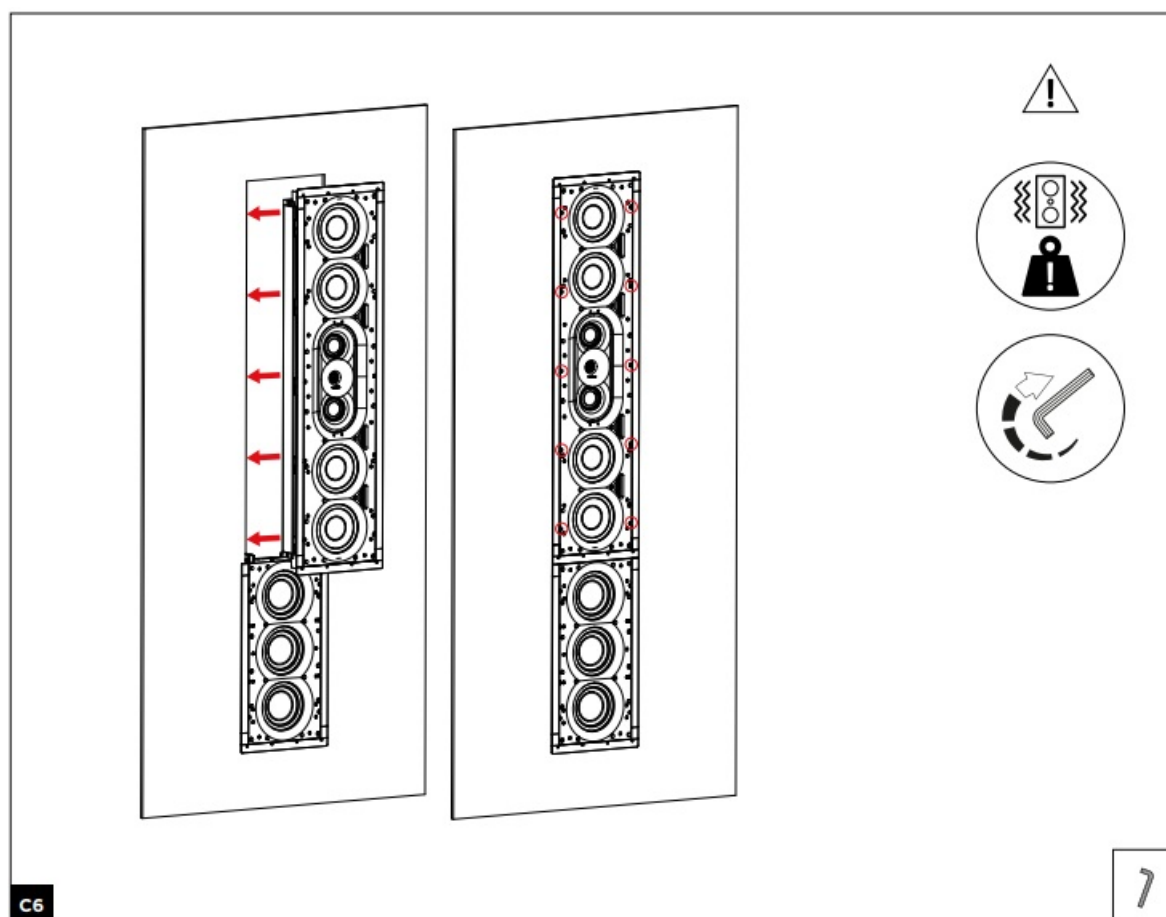

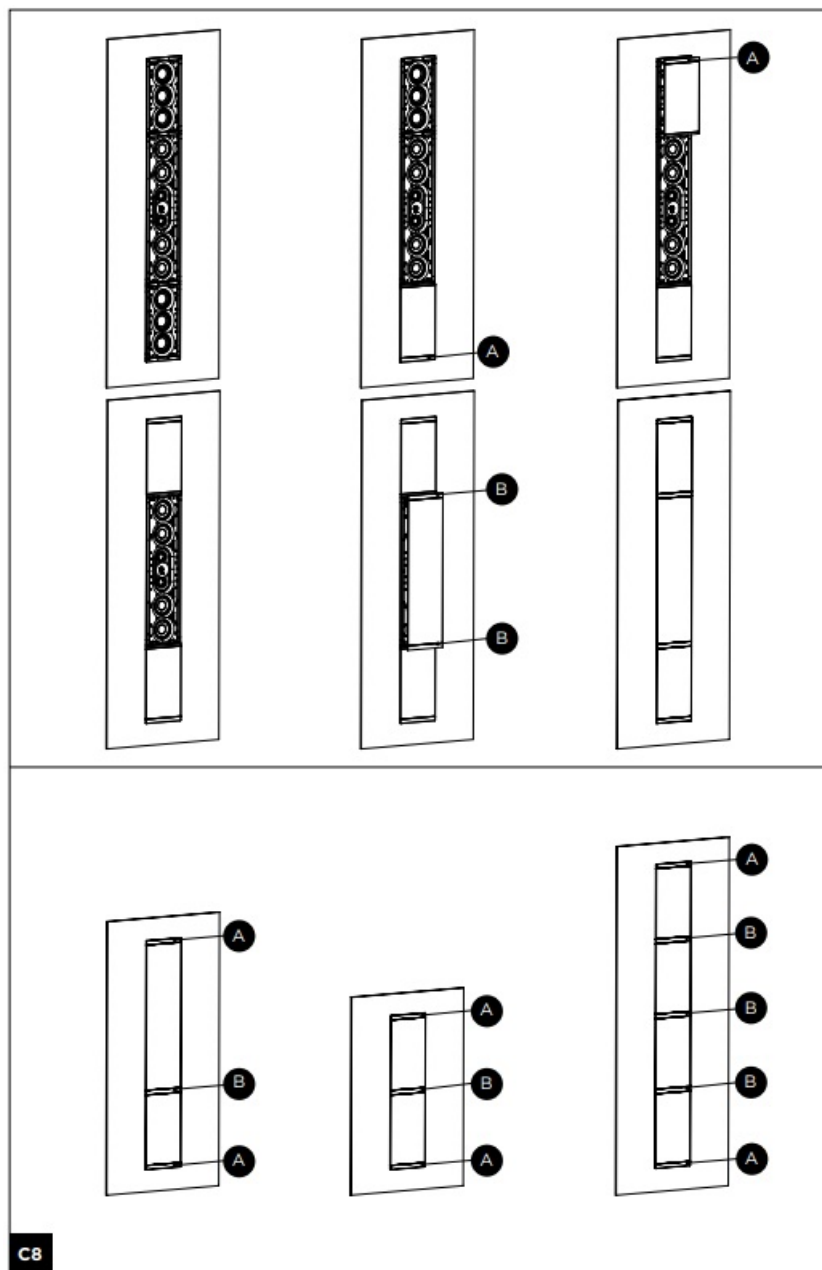

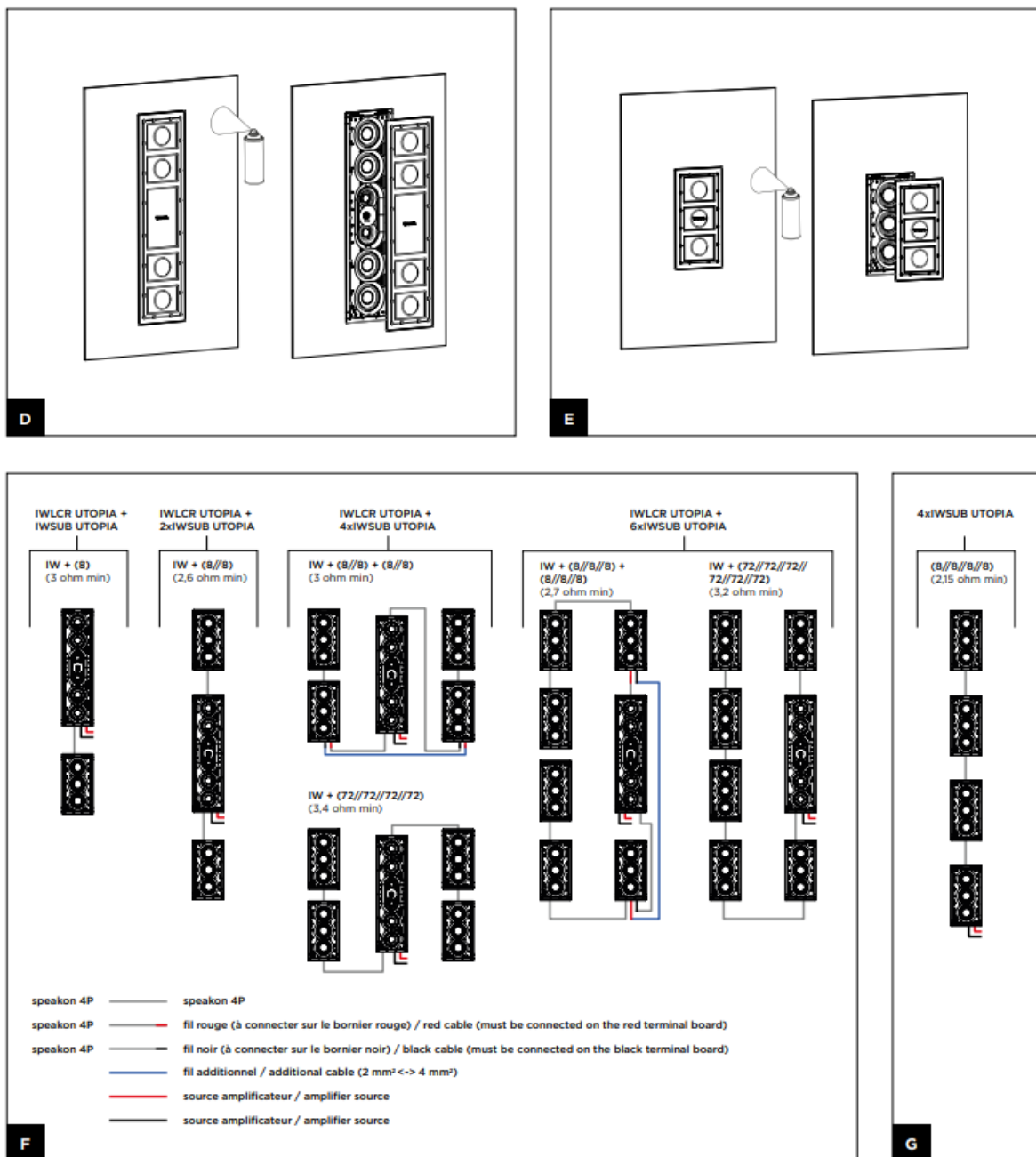

## SPECIFICATION

	Assembly*	Assembly*	Assembly*	Assembly*	Assembly*
	1000 IWLCR	1000 IWLCR	1000 IWLCR	1000 IWLCR	1000 IWLCR
	UTOPIA +	UTOPIA +	UTOPIA	UTOPIA	UTOPIA
	1 x IWSUB UT OPIA	2 x IWSUB UT OPIA	+ 4 x IWSUB	+ 6 x IWSUB	+ 6 x IWSUB
	(8 Ω)	(8 Ω)	UTOPIA	UTOPIA (72 Ω )	UTOPIA
			(8 Ω / 8 Ω)		(8 Ω / 8 Ω / 8 Ω)
			+ (8 Ω / 8 Ω)		+ (8 Ω / 8 Ω / 8 Ω)

Speaker drivers	7 x 6 1/2" (16.5cm) 'W' cone Bass; 2 x 3 1/8" (8cm) 'W' cone 'M'-shaped midranges; 1" (27mm) pure Beryllium inverted dome tweeter	10 x 6 1/2" (16.5cm) 'W' cone Bass; 2 x 3 1/8" (8cm) 'W' cone 'M'-shaped midranges; 1" (27mm) pure Beryllium inverted dome tweeter	16 x 6 1/2" (16.5cm) 'W' cone Bass; 2 x 3 1/8" (8cm) 'W' cone 'M'-shaped midranges; 1" (27mm) pure Beryllium inverted dome tweeter	22 x 6 1/2" (16.5cm) 'W' cone Bass; 2 x 3 1/8" (8cm) 'W' cone 'M'-shaped midranges; 1" (27mm) pure Beryllium inverted dome tweeter	22 x 6 1/2" (16.5cm) 'W' cone Bass; 2 x 3 1/8" (8cm) 'W' cone 'M'-shaped midranges; 1" (27mm) pure Beryllium inverted dome tweeter
Sensitivity (2.83 V/3 feet – 1m)	93dB	94dB	95dB	95db	96dB
Bandwidth (+/-3 dB)	38Hz – 40kHz	36Hz – 40kHz	34Hz – 40kHz	34Hz – 40kHz	32Hz – 40kHz
Low-frequency cut-off (-6dB)	32Hz	28Hz	26Hz	28Hz	24Hz
Nominal impedance	6 Ω	4 Ω	6 Ω	6 Ω	6 Ω
Minimal impedance	3 Ω	2.6 Ω	3 Ω	3.2 Ω	2.7 Ω
Recommended amp	100 – 750W (8 Ω)	100 – 750W (8 Ω)	100 – 750W (8 Ω)	100 – 750W (8 Ω)	100 – 750W (8 Ω)
power	200 – 1500W (4 Ω)	200 – 1500W (4 Ω)	200 – 1500W (4 Ω)	200 – 1500W (4 Ω)	200 – 1500W (4 Ω)
Net weight (with grille)	37/8" (99mm)	37/8" (99mm)	37/8" (99mm)	37/8" (99mm)	37/8" (99mm)
Net weight (with grille)	65.26lbs (29.6kg)	85.1lbs (38.6kg)	127.43lbs (57.8kg)	169.77lbs (77kg)	169.77lbs (77kg)

In the case of an assembly of 1000 Series IWLCR UTOPIA and IWSUB UTOPIA products, performances may change. Below you will find the specifications for the recommended assemblies. You must always make sure you have an impedance higher than 2 ohms to avoid a fault occurring with your amplifier. Focal recommends specific configurations (fig. F) in order to achieve constant impedance control.

	Assembly	Assembly	Assembly
	2 x 1000 IWSUB	3 x 1000 IWSUB UTOPIA (8 Ω )	4 x 1000 IWSUB UTOPIA (8 Ω)
	UTOPIA (8 Ω)		
Speaker drivers	6 x 61/2" (16.5cm) 'W' bass	9 x 61/2" (16.5cm) 'W' bass	12 x 61/2" (16.5cm) 'W' bass
Sensitivity (2.83V/3 feet – 1m)	89dB	92dB	95dB
Bandwidth (+/-3dB)	40Hz – 2.5kHz	40Hz – 2.5kHz	40Hz – 2.5kHz
Low-frequency cut-off (-6dB)	30Hz	27Hz	26Hz
Nominal impedance	6 Ω	4 Ω	3 Ω
Minimal impedance	4.3 Ω	2.9 Ω	2.15 Ω
Recommended amp power	100 – 750W (8 Ω) 200 – 1500W (4 Ω)	100 – 750W (8 Ω) 200 – 1500W (4 Ω)	100 – 750W (8 Ω) 200 – 1500W (4 Ω)
Mounting depth	37/8" (99mm)	37/8" (99mm)	37/8" (99mm)
Net weight (with grille)	42.33lbs (19.2kg)	63.49lbs (28.8kg)	84.66lbs (38.4kg)

In the case of an assembly of 1000 Series IWSUB UTOPIA and other IWSUB UTOPIA products, performance may change. Below you will find the specifications for the recommended assemblies. You must always make sure you have an impedance higher than 2 ohms to avoid a fault occurring with your amplifier. Focal recommends specific configurations (fig. G) in order to achieve constant impedance control.

## IMPORTANT SAFETY INSTRUCTIONS

1. Read these instructions.
2. Keep these instructions.
3. Heed all warnings.
4. Follow all the instructions.
5. Do not use this device near water.
6. Only clean with a dry cloth.
7. Do not obstruct ventilation openings. Follow the manufacturer's instructions for installing the device.
8. Do not install the device close to a heat source such as a radiator, cooker, heat vents or any other appliance including amplifiers) that gives out heat.
9. Only use accessories recommended by the manufacturer.
10. Only use trolleys, stands, tripods, mounts or tables recommended by the manufacturer or sold with the device.  
If using a trolley, take extra care when moving the trolley and device together, to prevent the device from falling

off and causing injury.

11. All maintenance tasks should be performed by a qualified professional. Maintenance is required in case of any kind of damage to the device  
(damaged cable or plug, spillages or objects inserted into the device, exposure to rain or humidity, if the device malfunctions or overturns, etc.).
12. To avoid damaging your hearing, do not listen to loudspeakers at high volumes for long periods of time.  
Listening to loudspeakers at high volumes can cause damage to the user's ears and may lead to hearing problems (temporary or permanent deafness, buzzing in the ears, tinnitus, hyperacusis). Exposure to excessive volumes (over 85 dB) for more than one hour can cause irreparable damage to your hearing.
13. Your loudspeakers use a tweeter with an inverted dome made from pure beryllium, a substance that is harmless in solid form. However, given its nature, certain precautions should be taken to avoid exposure to unnecessary risks:
  1. The beryllium dome must never come into contact with abrasive materials.
  2. If the beryllium dome is damaged in any way, use the protective adhesive strip supplied to cover the entire surface area of the dome, as soon as possible. You will find the adhesive strip in the plastic packet containing the leaflet for the tweeter with an inverted dome made from pure beryllium. Contact the retailer to have the tweeter dismantled and replaced by trained personnel at the distributor.
  3. If the dome is broken, any beryllium particles should be carefully collected using sticky tape and then placed in a hermetically sealed plastic bag and sent back to the retailer along with the loudspeaker.For more information, please refer to the safe use manual in the box.  
You can also address your questions directly to: [beryllium@focal.com](mailto:beryllium@focal.com)

The methods of installing and mounting loudspeakers to walls, ceilings or any other surface depend on the conditions and standards of construction, refurbishment, safety and cabling in force and applicable to the brackets involved. In addition, the products may vibrate and damage the brackets in which they are installed. For this reason, the relevant installation operations must be performed by a qualified professional who is familiar with the installation and safety standards. Focal does not provide any end-of-use warranty for a given bracket or installation, as installing the loudspeakers is the customer's sole responsibility. Focal is therefore not liable in any capacity whatsoever in the event of unhooking, fall, accident and/or any other result or damage of any kind related to the installation of loudspeakers.

**Please validate your Focal-JMLab warranty,**

it is now possible to register your product online: [www.focal.com/warranty](http://www.focal.com/warranty)

Thank you for purchasing a Focal product. Welcome to our High-Fidelity world. Innovation, tradition, excellence and pleasure are our values; our one and only aim is to bring you a sound that is rich, pure and true. To get the most out of your product, we recommend that you read the instructions in this booklet, then store it in a safe place to refer to in the future.

## **Package contents**

- 1 x QuickStart + QuickAssembly
- 1 x beryllium user manual
- 1 set of safety instructions and warranty terms and conditions
- 1 x loudspeaker
- 1 x rectangular grille
- 3 x grille seals



- 1 x safety mask for use when painting walls/ceilings
- 1 cut-out template
- 2 x acoustic cloths (black or white)
- 2 x Allen keys
- 1 x mounting frame (optional)

### **Package contents (1000 IWLCR UTOPIA)**

- 1 x QuickStart + QuickAssembly
- 1 x beryllium user manual
- 1 set of safety instructions and warranty terms and conditions
- 1 x loudspeaker
- 1 x rectangular grille
- 3 x grille seals
- 1 x safety mask for use when painting walls/ceilings
- 1 cut-out template
- 2 x acoustic cloths (black or white)
- 2 x Allen keys
- 1 x mounting frame (optional)

### **Key points**

Beryllium inverted dome tweeter: the tweeter developed for the 1000 Series UTOPIA range of products uses Focal's exclusive inverted dome technology, which enables optimum transfer of energy and limited directionality. The dome's beryllium guarantees exceptional performance in terms of lightness, damping and rigidity, to provide a silky, detailed and precise treble. 'M'-shaped 'W'-cone speaker drivers: the membrane of the 1000 Series UTOPIA speaker drivers is made in France with Focal's exclusive 'M'-shaped 'W' technology. 'W' composite sandwich technology, with uniform design, unibody cone and unique performance, providing a rich and precise midrange and a distortion-free bass. Protective grille with magnetic attachment: easy to install, improved integration. Optimum Directivity Crossover: optimised directivity for a more homogeneous sound, especially when listening to the products off-axis. Assembly kit (optional): for installing in a partition during construction, for a single product or assembly. For On Wall configuration: wall frame available as an option. Key products: for better in-wall integration, products from the 1000 Series UTOPIA range are less than 4" (10cm) deep.

### **Running-in period**

The speaker drivers used in the Integration 1000 Series UTOPIA loudspeakers are complex mechanical assemblies which need a break-in period to operate at their best and to become acclimatised to the temperature and humidity of your environment. This running-in period varies depending on the conditions in question and may take several weeks. To reduce this time, you can operate your loudspeakers for about twenty consecutive hours at a moderate volume. Once the loudspeakers' characteristics have totally stabilised, you will be able to enjoy your Integration 1000 Series loudspeakers' performance to the full.

### **Pre-installation wiring**

You can only install your speakers once you have wired them up. Make sure you leave enough cable length to be able to connect your product with ease (approximately 193/4" / 50cm). We recommend using a cable with a marker to ensure the polarity of the speaker drivers is respected (+/-). Choose good quality cables with a cross-section appropriate for their length (more than 1/16" / 2mm<sup>2</sup> and less than 3/16" / 4mm<sup>2</sup>): your dealer will be able to advise you.

### **Choosing an amplifier**

- It is not an excess of amplifier power that can damage your loudspeaker and drivers, but rather a lack of power. In fact, if the volume is too high, the amplifier saturates and generates parasite signals that may destroy the tweeter. The dynamic capacity and definition of Integration 1000 Series UTOPIA loudspeakers are high enough to reveal the strengths and weaknesses of any amplifier that is connected to them. Your dealer will be able to guide your choice to suit your tastes and budget.

However, Focal recommends using a stable amplifier between 3 and 2 ohms, depending on the configuration you choose. This will avoid an untimely triggering of the amplifier's protection. Focal recommends a 250W power at 8 ohms for the loudspeakers to operate correctly.

- Choosing the Focal Astral 16 amplifier

If you are using the Astral 16 amplifier, it is important to follow these tips to enhance your experience. Make sure that you balance the loudspeakers over the 3 power supplies of the Astral 16 amplifier. This balance will allow you to get the best out of the loudspeakers and the amplifier. The aim is to combine loudspeakers that consume a great deal of current (front loudspeaker, for example) with loudspeakers that consume less (rear or Dolby Atmos loudspeakers).

- The IWLCR UTOPIA and IWSUB UTOPIA loudspeakers are compatible with the LFE routing across the Astral 16 amplifier channels. Focal advises that you set the LFE output level at between -15 dB and -9 dB, depending on the desired volume. Finding the correct ratio between the bass level for the channel's classic output and that of the LFE is important for achieving a balanced sound. Ensure that you balance the LFE level on each channel. This will prevent overloading one loudspeaker and underloading another. The rendering will be faithful and balanced.
- When using the equalisation processing module, you can adjust the midrange and tweeter jumpers, "Midrange level" and "Tweeter Level" respectively, on their "+2 dB" and "+3 dB" positions. This allows you to use the loudspeaker across its full dynamic range.
- During assembly, ensure that the minimal impedance of the loudspeaker assembly does not fall below 2.1 ohms. We recommend setting the limiter on each channel between -3 dB and -9 dB. Otherwise, untimely power outages and current distortion may occur.
- In order to avoid causing a fault on the Astral 16 amplifier, make sure you adhere to the following formula:

With RN1: nominal impedance on the 1st amplification rail

With RN2: nominal impedance on the 2nd amplification rail

With RN3: nominal impedance on the 3rd amplification rail

With RN4: nominal impedance on the 4th amplification rail

## INSTALLATION

### Loudspeaker positioning

The loudspeakers in the 1000 Series UTOPIA range have been developed to deliver the most faithful sound reproduction, whether they are used for stereo music or home cinema. Nonetheless, a few simple rules should be followed to optimise their performance and to guarantee good tonal balance and a realistic sound image. We recommend positioning the 1000 IWSUB UTOPIA loudspeakers as close as possible to the floor or in the corners of the room.

### Using in Stereo systems (15m<sup>2</sup> – 50m<sup>2</sup>)

The loudspeakers should be positioned symmetrically, facing the listening area, ideally forming an isosceles triangle with it. The angle between the listening position and the two loudspeakers must be 60° (fig. 1). The space between the two loudspeakers will be between 10ft (3m) and 20ft (6m) (fig. 1). However, it is possible to vary these distances to find an ideal compromise depending on the specific room layout. The loudspeakers should be

positioned at the same height and in the same horizontal plane (fig. 1). We recommend positioning the tweeter at the viewer's ear level.

### **Using in Home Cinema systems (20m<sup>2</sup> – 75m<sup>2</sup>)**

- Right, left and central front loudspeakers. Position the tweeters of the 1000 IWLCR UTOPIA Series at the viewer's ear level. The vertical position is recommended for a centre speaker (behind a projection screen, for example), but it is possible to vary the tweeter orientation depending on your configuration.
- When using wall loudspeakers, the right and left front loudspeakers should be placed symmetrically on either side of the screen and at mid-height, facing the listening area, ideally to form an isosceles triangle with it. The angle between the listening position and the two loudspeakers must be 60° (fig. 2). The space between the two loudspeakers must be between 10ft. and 20ft. (3m and 6m), for a listening area between 10 and 20 feet. However, it is possible to vary these distances to find an ideal compromise depending on the specific room layout. The centre speaker should be placed as close as possible to the screen, above or below it, for realistic dialogue reproduction (fig. 2).
- If a micro-perforated (acoustically transparent) projection screen is used, the right and left front loudspeakers and the centre speaker should be placed halfway up the screen, in the same horizontal plane behind this screen (fig. 3).

### **Surround-sound loudspeakers for the 5.1 system**

When using wall loudspeakers, the surround-sound loudspeakers should be installed on the side walls, slightly behind the listening area (0ft/0m – 3ft/0.5m) and at the same height as the right and left front loudspeakers (fig. 4). In addition, an angle between 90° and 110° between the axis of the loudspeaker behind the listening position and the axis from the centre speaker and the listening position must be respected in order to follow Dolby specifications (fig. 5).

### **Surround-sound loudspeakers for the 7.1 system**

When using wall loudspeakers, the right and left surround-sound loudspeakers should be installed on the side walls level with the listening area, and at the same height as the right and left front speakers. The surround-sound speakers should be installed on the wall behind the listening area, and at the same height as the right and left front loudspeakers. The space between the two loudspeakers should be between 6.5ft (2.5m) and 13ft (6m) (fig. 6). An angle between 90° and 110° between the axis of loudspeaker beside the listening area and the axis from the centre speaker to the listening area should also be respected (fig. 7). In addition, an angle between 135° à 150° between the axis of the loudspeaker behind the listening area and the axis from the centre speaker to the listening area should be respected in order to follow Dolby specifications (fig. 7).

### **Existing construction**

The methods of installing and mounting loudspeakers to walls, ceilings or any other surface depend on the conditions and standards of construction, refurbishment, safety and cabling in force and applicable to the brackets involved. In addition, the products may vibrate and damage the brackets in which they are installed. For this reason, the relevant installation operations must be performed by a qualified professional who is familiar with installation and safety standards. Focal does not provide any end-of-use warranty for a given bracket or installation, as installing the loudspeakers is the customer's sole responsibility. Focal is therefore not liable in any capacity whatsoever in the event of unhooking, fall, accident and/or any other result or damage of any kind related to the installation of loudspeakers. The risk of vibrations is considerable.

Before installing the loudspeakers, ensure that the intended positions in the wall are free of any obstruction such as air vents or any cables that may interfere with the installation. Use the appropriate tools to help you determine suitable locations. Make sure that there is enough space inside the wall to install the product. Trace around the cut-out template supplied, onto the existing wall. Cut along the traced line with a suitable tool to create an opening in the wall (fig. A2/B2). It is important to bond the structural elements surrounding the loudspeaker. At high volumes or when listening for prolonged periods, vibrations can occur and negatively impact the listening experience (wall/battens/wall plate, for example).

## New construction

Use the optional specific mounting kit. Wire up the speakers before installing them. If assembling the 1000 Series IWSUB UTOPIA and IWLCR UTOPIA products, connect the Speakon cable between each product following the diagram (fig. F). If assembling 1000 IWSUB UTOPIA products, connect the Speakon cable between each product following the diagram (fig. G). It is important to bond the structural elements surrounding the loudspeaker. At high volumes or when listening for prolonged periods, vibrations can occur and negatively impact the listening experience (wall/battens/wall plate, for example).

## Installing the loudspeakers

Products from the 1000 Series UTOPIA range include a loudspeaker and a magnetic grille. Products from the 1000 Series UTOPIA range are closed and are less than 315/16" (10cm) deep, allowing them to be easily installed in most walls. 1000 Series UTOPIA products are fitted into the wall using rotating brackets. To do this, place the loudspeaker into the cut-out opening and turn the screw on the mounting brackets clockwise to tighten it using the Allen key supplied or a screw-gun. If using a screwdriver, make sure that the tightening torque is set to a low value to avoid damaging the mounting brackets. The loudspeaker is properly mounted when you feel resistance at the end of tightening. Products from the 1000 Series UTOPIA are heavy and therefore should be installed by at least 2 people, including one professional.

## 1000 IWLCR UTOPIA

1. Connect the pre-stripped loudspeaker wire to the loudspeaker's spring-loaded terminals. It is essential that the connection polarity for each loudspeaker is correct: the cable connected to the '+' terminal on the amplifier must be connected to the red terminal on the loudspeaker. Likewise, the cable connected to the '-' terminal on the amplifier must be connected to the black terminal (fig. A4).

Mono-amplification scenario: 1000 IWLCR UTOPIA allows a mono-amplification connection, in which case use the two 'straps' supplied and connect the inputs as shown (fig. A4).

Bi-amplification scenario: 1000 IWLCR UTOPIA allows a bi-amplification connection, in which case use the two 'straps' and connect each cable or amplifier to the BASS and MAIN (midrange/treble) inputs as shown (fig. A4).

2. Insert the product into the wall by pressing on each side of the loudspeaker to ensure it is in place (fig. A5).  
Products from the 1000 Series are heavy, and it is therefore essential that they are installed by a specialist. We recommend that installation is carried out by at least 2 people.
3. Lock all the mounting brackets using the Allen key supplied (fig. A6). Make sure the brackets are snug against the internal partition of your wall.
4. Position the midrange-treble support facing towards the listening area by slightly unscrewing the 4 screws at the top and the bottom of it (fig. A7).
5. If required, adjust the treble, midrange and woofers according to the room's acoustics. Simply adjust the position of the 'straps' as desired.
6. Peel off the tape from the adhesive on the grille seals, then stick the seals onto the ends of the grilles (fig. A8).  
The seals will stick after a few seconds (fig. A8). In the vertical position, select the seal with the vertical logo; the Focal logo will always be located at the bottom of the product. In the horizontal position, select the seal with the horizontal logo; the logo will be on the right of the product.
7. The grille can now be fitted. The grille is held onto the mounting frame magnetically, which means you only need to align it with the edge of the mounting frame (fig. A9). Self-adhesive felt is used so that the product blends more seamlessly into your interior. You can also choose not to stick felt onto your grilles, for perfect sound reproduction. A grille positioned incorrectly on the product may vibrate and negatively impact the listening experience. Make sure the grille is correctly positioned on the loudspeaker's metal frame. NB: the felt may peel off while you are handling the grille.

## 1000 IWSUB UTOPIA

1. Connect the pre-stripped loudspeaker wire to the loudspeaker's spring-loaded terminals. It is essential that the connection polarity for each loudspeaker is correct: the cable connected to the '+' terminal on the amplifier must be connected to the red terminal on the loudspeaker. Likewise, the cable connected to the '-' terminal on the amplifier must be connected to the black terminal (fig. B3).

1000 IWSUB UTOPIA allows you to have two different impedances depending on your desired assembly, 8 ohms or 72 ohms. You can select these impedances by changing the position of the 4 'straps'. It is important that all the 'straps' are in the same position and that they are always connected to the loudspeakers. To optimise the impedance in line with your amplifier's capacity, you can also mix parallel and serial assembly of the IWSUBs. To do this, you will need an additional speaker driver cable.

2. Insert the product into the wall by pressing on each side of the loudspeaker to ensure it is in place (fig. B4). Products from the 1000 Series are heavy, and it is therefore essential that they are installed by a specialist.
3. Lock all the mounting brackets using the Allen key supplied (fig. B5). Make sure the brackets are snug against the internal partition of your wall.
4. Peel off the tape from the adhesive on the grille seals, then stick the seals onto the ends of the grilles (fig. B6). The seals will stick after a few seconds (fig. B6). In the vertical position, select the seal with the vertical logo; the Focal logo will always be located at the bottom of the product. In the horizontal position, select the seal with the horizontal logo; the logo will be on the right of the product.
5. The grille can now be fitted. The grille is held onto the mounting frame magnetically, which means you only need to align it with the edge of the mounting frame (fig. B7). Self-adhesive felt is used so that the product blends more seamlessly into your interior. You can also choose not to stick felt onto your grilles, for perfect sound reproduction. A grille positioned incorrectly on the product may vibrate and negatively impact the listening experience. Make sure the grille is correctly positioned on the loudspeaker's metal frame. NB: the felt may peel off while you are handling the grille.

## 1000 IWLCR UTOPIA & 1000 IWSUB UTOPIA assembly

1. Unscrew the top strip of 1000 IWSUB UTOPIA using a screwdriver (fig. C1). The top strip is always marked 'FOCAL UTOPIA'.
2. Insert and screw the two dividers onto the top of the 1000 IWSUB UTOPIA (fig. C2).
3. Insert the product into the wall by pressing on each side of the loudspeaker to ensure it is in place (fig. C3). Products from the 1000 Series are heavy, and it is therefore essential that they are installed by a specialist. 1000 IWSUB UTOPIA allows you to have two different impedances depending on your desired assembly, 8 ohms or 72 ohms. You can select these impedances by changing the position of the 4 'straps'. It is important that all the 'straps' are in the same position and that they are always connected to the loudspeakers. To optimise the impedance in line with your amplifier's capacity, you can also mix parallel and serial assembly of the IWSUB UTOPIA and IWLCR UTOPIA (fig. F/G). To do this, you will need an additional speaker driver cable.
4. Connect your amplifier to the main 1000 IWLCR UTOPIA loudspeaker (fig. C5).
5. Connect the 1000 IWLCR UTOPIA and 1000 IWSUB UTOPIA products, using the Speakon cable supplied (fig. C5).
6. Press the product up against the partition of your wall and lock it using the key supplied (fig. C6). The 1000 Series UTOPIA products are heavy and generate strong vibrations, so make sure you use a professional to

install them.

7. You can repeat these operations when assembling other 1000 IWSUB UTOPIA products with your other products.
8. The grilles need to be prepared using the connections and grille dividers supplied (fig. C7). Peel off the tape from the adhesive and position the connection or divider on the grilles. The glue holds within a few seconds, with sufficient pressure exerted on the product.
9. The grille can now be fitted. The grille is held onto the mounting frame magnetically, which means you only need to align it with the edge of the mounting frame (fig. C8). Self-adhesive felt is used so that the product blends more seamlessly into your interior. You can also choose not to stick felt onto your grilles, for perfect sound reproduction. A grille positioned incorrectly on the product may vibrate and negatively impact the listening experience. Make sure the grille is correctly positioned on the loudspeaker's metal frame. NB: the felt may peel off while you are handling the grille.

## **Product assembly**

1000 Series UTOPIA products are assembled using the Speakon cable supplied. This cable allows you to connect products to each other. If the IWSUB UTOPIAs are assembled as a series, you will need an additional cable. When 1000 Series UTOPIA products are assembled as a series, we advise that you follow the recommendations (fig. F). To optimise the performance of your system, you need to disassemble the Speakon cable supplied to retrieve the red or black wire (fig. F); this wire connected to the Speakon cable will be connected to the terminal board ('+' or '-') of the IWSUB UTOPIA loudspeaker (fig. F).

## **Paint**

If you wish, you can paint the grille on your products, the strips and grille dividers, so that your product is coordinated with your environment. We recommend that you firstly remove the grille and paint it using a paint gun. The paint used can be the same type as the paint used on the walls (fig. D/E). If you wish to paint the ceiling/wall without disassembling your product, we recommend that you use the protective mask supplied. It is magnetically attached to the mounting frame (fig. D/E).

## **Special precautions**

To clean your UTOPIA 1000 Series loudspeakers, simply dust using a dry cloth. If the loudspeaker is marked, we recommend that you use just a damp duster. Never use solvents, detergents, alcohol or corrosive products, scrapers or scouring utensils to clean the surface of the loudspeaker. Avoid positioning the loudspeakers near to any heat sources.

## **Warranty terms and conditions**

In the event of a problem, please contact your Focal dealer. The warranty for France on any Focal equipment is 2 years, non-transferable in the event of resale, from the date of purchase. In the event of faulty equipment, you must send it in its original packaging and at your own expense to the dealer, who will analyse the equipment and determine the nature of the fault. If it is under warranty, the equipment will be returned to you or replaced. Otherwise, you will be offered an estimate for repair. The warranty does not cover damage resulting from inappropriate use or incorrect wiring (burnt out voice-coils, for example). Outside France, Focal equipment is covered by a warranty for which the terms and conditions are determined locally by the official Focal-JMLab distributor for each country, in accordance with the laws in force in the region in question.

## **Correct elimination of this product.**

This marking indicates that within the EU this product should not be disposed of with other household wastes. To prevent any risk to the environment or human health, please recycle them responsibly to encourage the reuse of material resources. To return your used device, please use the return and collection systems available, or contact the retailer where you purchased the product. They can recycle this product safely.

## Documents / Resources

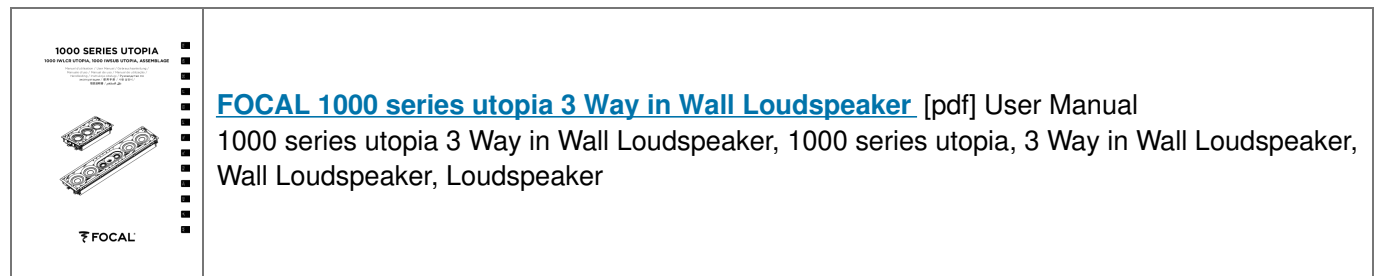

## References

- ₹ USA | Focal
- ₹ Focal
- ₹ Focal