

FOAMit BFS-BA-48 Belt Foam Bar Attachment

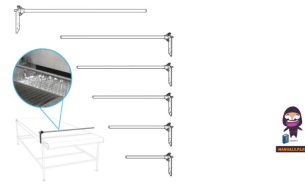

FOAMit BFS-BA-48 Belt Foam Bar Attachment User Manual

[Home](#) » [FOAMit](#) » FOAMit BFS-BA-48 Belt Foam Bar Attachment User Manual 

Contents

- [1 FOAMit BFS-BA-48 Belt Foam Bar Attachment](#)
- [2 Product Usage Instructions](#)
- [3 FAQ](#)
- [4 Product requirements](#)
- [5 Product specifications](#)
- [6 Safety](#)
- [7 Product Components](#)
- [8 Assembly](#)
- [9 Operation](#)
- [10 Parts](#)
- [11 Documents / Resources](#)
 - [11.1 References](#)



FOAMit BFS-BA-48 Belt Foam Bar Attachment

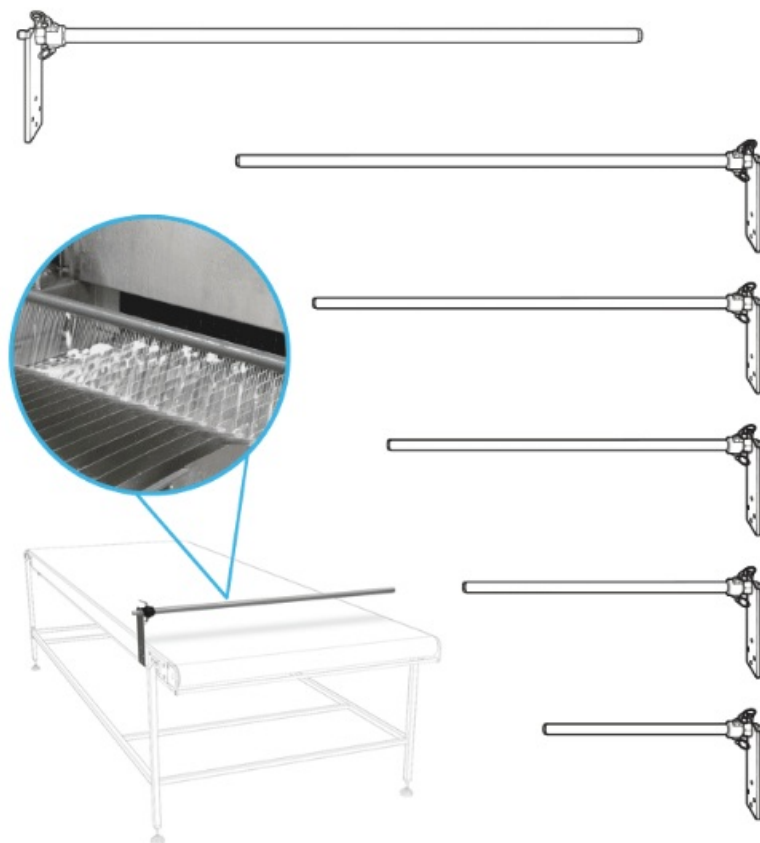

Product Usage Instructions

- Before using the equipment, ensure you have read and understood all safety precautions mentioned in the manual. Always wear protective clothing, gloves, and eye protection to prevent injuries.
- Ensure that the chemical products used are formulated for this application and are compatible with the materials of the unit.
- Consult the manufacturer or Safety Data Sheet for guidance.

Operation Guidelines

1. Depressurize and clean the unit after each use to prevent unexpected chemical releases.
2. Do not operate the unit if it is damaged or leaking to avoid exposure to chemical solutions.
3. Avoid pointing the discharge wand at yourself, others, or unwanted objects.
4. Keep incoming air pressure below 100 psi (6.9 bar) to prevent pressure buildup and potential hazards.
5. Do not use hydrocarbons or flammable products with the unit to avoid fire or explosions.
6. When switching between alkaline and acid solutions, thoroughly flush the unit with fresh water to prevent chemical reactions.

FAQ

- **Q:** Can I use chemicals not specified in the manual with this equipment?
- **A:** It is recommended to use only chemicals formulated for this equipment and compatible with its materials. Consult the manufacturer or SDS for guidance on chemical compatibility.
- **Q:** What should I do if the unit is damaged or leaking?
- **A:** Do not operate the unit if it is damaged or leaking. Contact customer service for assistance and do not

attempt to use the equipment until it is repaired.

Product requirements

Liquid temperature range	40-100°F (4.4-37.8°C)
Equipment requirements	Requires connection to a FOAMit unit with ¾ in. (19 mm) discharge hose and a ½ in. FPT discharge ball valve.
Chemical compatibility	Chemical products used with this equipment must be formulated for this type of application and compatible with unit materials and pump seals. For more information on chemical compatibility, consult the manufacturer or SDS for your product or contact our customer service department.

Product specifications

Chemical pickup type	Pre-mixed solution
Output volume	20 gal/min (75.7 l/min)
Flow rate*	2.6 gal/min (9.8 l/min)
Coverage area	48 in. (1.2 m) width beneath the bar

Flow rates given are based on the viscosity of water and factory air pressure settings.

READ ALL INSTRUCTIONS BEFORE USING, OR SERVICING, THIS EQUIPMENT. KEEP THIS MANUAL IN A LOCATION THAT IS READILY AVAILABLE TO USERS AND SERVICE TECHNICIANS.

English (Original Instructions)

Scan this code for the user manual



Safety

WARNING

PEOPLE OR OBJECTS CAN BE HURT OR DAMAGED IF THIS UNIT IS NOT USED CORRECTLY!



• Failure to read all the instructions before operating the unit may result in personal injury or death

from the improper use of the chemical solution. Anyone handling, operating or using the unit must read, and understand, the instructions in the manual. The buyer assumes all responsibility for safety and proper use by the instructions.



- Using, or servicing, the unit without proper protective clothing, gloves, and eyewear may result in serious injury such as burns, rashes, eye, throat or lung damage and death. Always wear protective clothing, gloves, and eye wear when using, or servicing, the unit. Protect eyes, skin, and lungs against drifting spray.



- Chemical solutions may pose a health risk and death if they contact the skin or eyes, and are inhaled or swallowed. Always read, and follow, all chemical safety precautions and handling instructions provided by the chemical manufacturer and the Safety Data Sheet (SDS) associated with the chemical solution being used before using the unit.



- Pressure within the equipment may cause an unexpected release of the chemical solution and cause serious injury such as burns, rashes, eye damage, throat or lung damage and death. Always depressurize and clean the unit after each use. Never leave the unit unattended while pressurized.
- Using the unit with fluid temperatures above 100°F (37.8°C) may result in scalding, burns, serious injury or death. DO NOT use a solution with a temperature above 100°F (37.8°C).
- Operating the unit when damaged or leaking may result in exposure to chemical solutions, serious injury or death. Never use the unit if it is damaged or leaking.
- Never point the discharge wand at yourself, another person, or any object you do not want covered in chemicals.
- Using incoming air pressure exceeding 100 psi (6.9 bar) may result in pressure buildup, explosion, serious injury or death. DO NOT exceed 100 psi (6.9 bar) incoming air pressure when operating the unit.



- Use of hydrocarbons and flammable products may result in explosions, fire and serious injury or death.
- Never use hydrocarbons or flammable products with the unit.



- Mixing an alkaline with an acid may result in a chemical reaction. Overheating of the mixture may cause it to splatter caustic compounds or release hazardous fumes, gas and vapours. Always flush the unit with fresh water thoroughly when switching from an alkaline to an acid or an acid to an alkaline.

NOTICE

- Servicing, or modification, of this unit with parts not listed in this manual may cause the unit to operate improperly.

- Do not use unauthorized parts when servicing the unit.
- Use of an air lubricator before the unit may result in diminished performance and damage to the unit. Do not use an air lubricator before the unit.
- Moisture in the airlines may damage the pump and diminish the unit's life. The air must be filtered, clean, dry and free of moisture. If needed, install an air dryer before the unit.

PROTECT THE ENVIRONMENT



- Please dispose of packaging materials, old machine components, and hazardous fluids in an environmentally safe way according to local waste disposal regulations.

Product Components

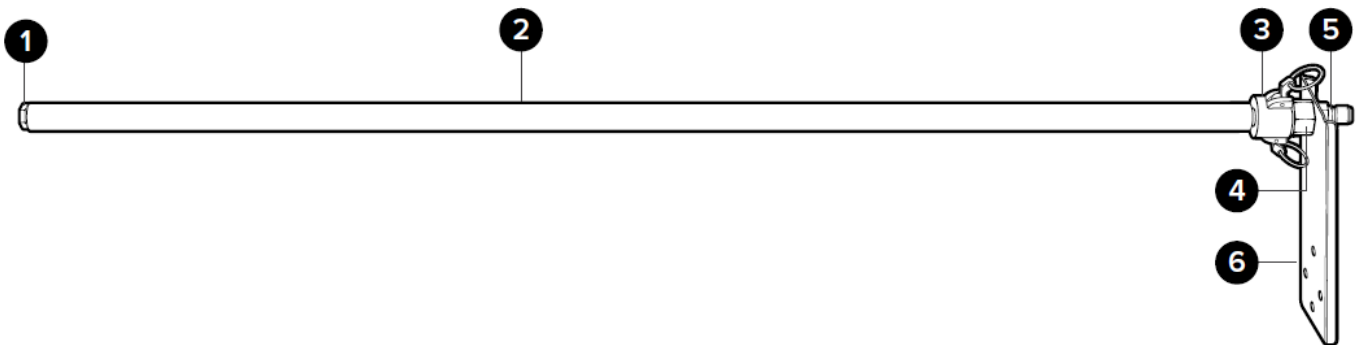

1. Bar plug
2. Foam bar
3. Female cam lock fitting
4. Male cam lock fitting
5. Male quick-connect plug
6. Mounting bracket

Assembly

This attachment comes with quick-connect fittings for easy installation and use.

Important! Only install quick-connect fittings on the output side of the discharge valve. Do not install in any other configuration.

1. Remove all components from the packaging.

Note: The male cam lock fitting, male quick-connect plug and mounting bracket come assembled.

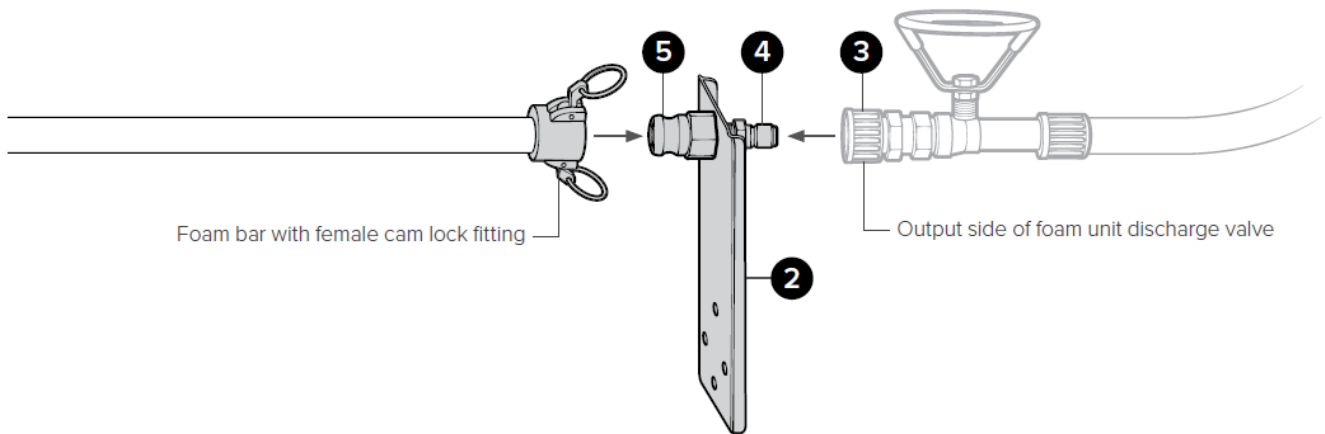

2. Attach the mounting bracket to the conveyor.
3. With the foam unit turned off and depressurized (refer to your foam unit user manual for specific procedures), remove the wand from the discharge ball valve and install the male quick-connect coupler.
4. Connect the output side of the foam unit discharge valve to the male quick-connect plug on the mounting bracket.
5. Connect the foam bar to the male cam lock fitting.

Operation

Operating Instructions

1. Connect the foam bar to the foam unit by engaging the bar to the male cam lock fitting. Important! Check the foam bar and the foam unit discharge valve are securely connected to the fittings before activating the foam unit.
2. Activate the foam unit (refer to the foam unit user manual for specific procedures) to begin foaming.
3. To stop foaming, deactivate the foam unit (refer to the foam unit user manual for specific procedures).

After Use Instructions

4. Turn off and depressurize the foam unit.
Follow all after-use procedures in the foam unit user manual.
5. Rinse the attachment thoroughly with fresh water to remove any chemical residue.
6. To disengage quick-connect fittings, pull back on the retaining collar to release the female fitting

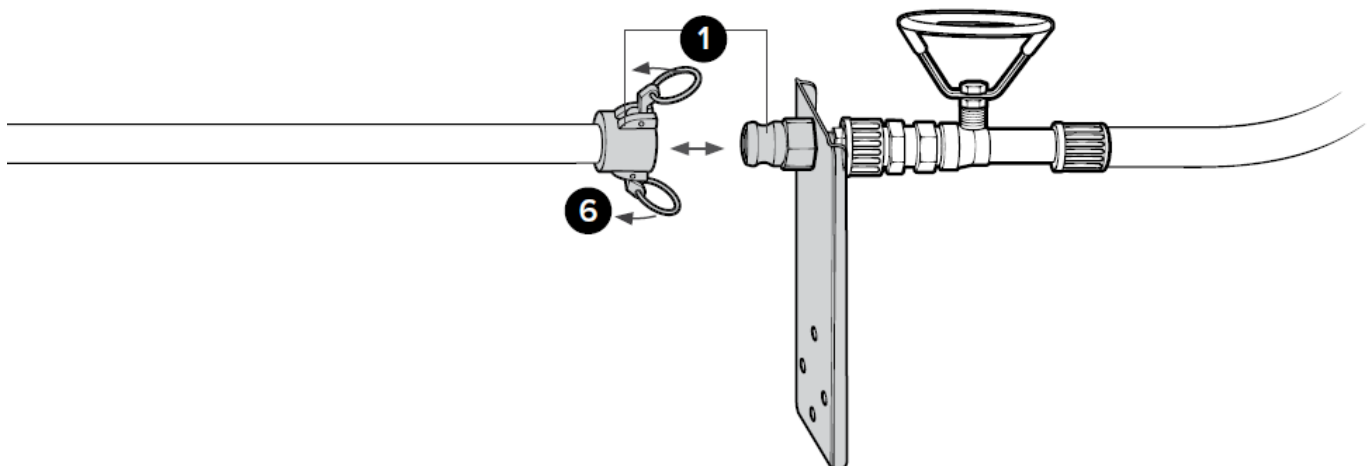

Parts

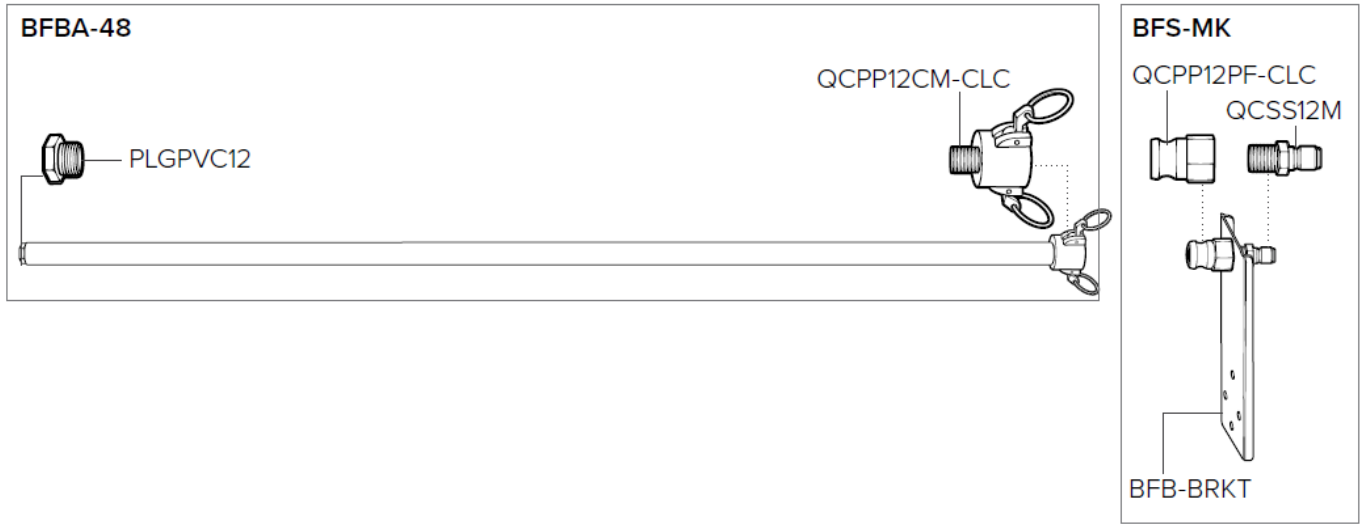

Item number	Description
BFBA-48	48 In. belt foam bar assembly – includes quick connects – mounting kit sold separately
BFB-BRKT	Bracket for belt foam bar – stainless
BFS-MK	Mounting kit for belt foam system – foam bar and quick connects sold separately
PLGPVC12	THD plug – 1/2 in. MPT – PVC 850-005 – spears only
QCPP12CM-CLC	Quick connect coupler – 1/2 in. MPT x 3/4 in. cam lock connector – polypropylene
QCPP12PF-CLC	Quick connect coupler – 1/2 in. MPT x 3/4 in. cam lock connector – polypropylene
QCSS12CM	SS Non check 1/2 in. quick-connect coupler – MPT
QCSS12M	SS Non check 1/2 in. quick-connect plug – MPT
QCSS12PF	SS Non check 1/2 in. quick-connect plug – FPT

Additional Belt Foam Bar Sizes

Note: The following Belt Foam Bars and bar assemblies are optional and available for purchase.

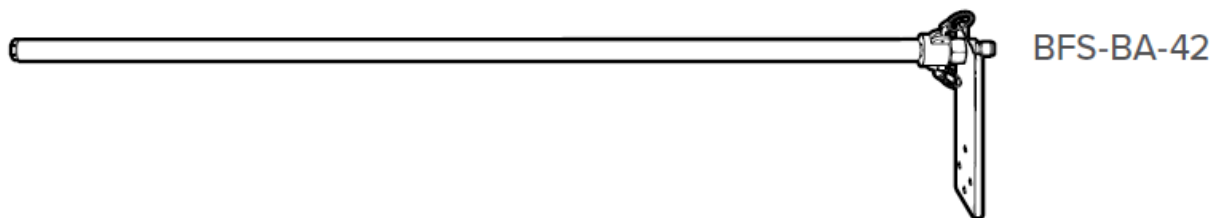

BFS-BA-42



BFS-BA-36

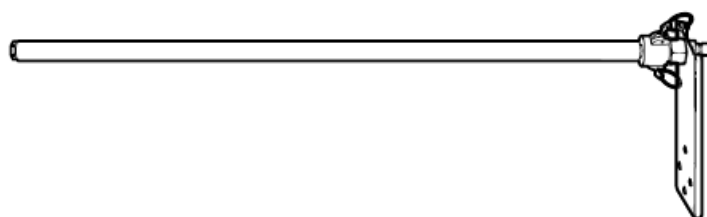

BFS-BA-30

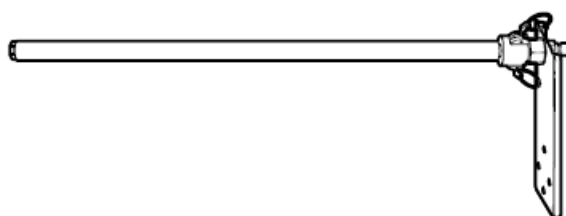

BFS-BA-24

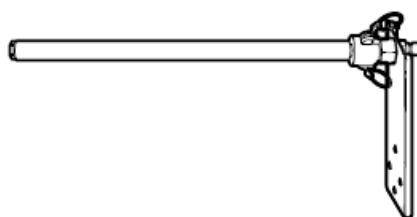

BFS-BA-18

Model	BFS-BA-42	BFS-BA-36	BFS-BA-30	BFS-BA-24	BFS-BA-18
Output volume	24 gal/min (90.8 l/min)	25 gal/min (94.6 l/min)	28 gal/min (106 l/min)	26 gal/min (98.4 l/min)	30 gal/min (113.6 l/min)
Flow rate *	2.4 gal/min (9.1 l/min)	2.1 gal/min (7.9 l/min)	2.3 gal/min (8.7 l/min)	2 gal/min (7.6 l/min)	2.1 gal/min (7.9 l/min)
Coverage area	42 in. (1.1 m) width beneath the bar	36 in. (0.9 m) width beneath the bar	30 in. (0.8 m) width beneath the bar	24 in. (0.6 m) width beneath the bar	18 in. (0.5 m) width beneath the bar
Replacement bar assemblies	BFBA-42	BFBA-36	BFBA-30	BFBA-24	BFBA-18

Flow rates are based on the viscosity of water and factory air pressure settings.

Documents / Resources

	<p>FOAMit BFS-BA-48 Belt Foam Bar Attachment [pdf] User Manual</p> <p>BFS-BA-48, BFS-BA-48 Belt Foam Bar Attachment, BFS-BA-48 Belt Foam Bar, Belt Foam Bar, Belt Foam, Belt Foam Bar Attachment, Foam Bar Attachment, Bar Attachment, Foam Bar</p>
---	---

References

- [User Manual](#)

[Manuals+](#), [Privacy Policy](#)

This website is an independent publication and is neither affiliated with nor endorsed by any of the trademark owners. The "Bluetooth®" word mark and logos are registered trademarks owned by Bluetooth SIG, Inc. The "Wi-Fi®" word mark and logos are registered trademarks owned by the Wi-Fi Alliance. Any use of these marks on this website does not imply any affiliation with or endorsement.