

FLYCAM FLN-MSTR-EGV1 Flowline Master with Edge



# FLYCAM FLN-MSTR-EGV1 Flowline Master with Edge Instruction Manual

[Home](#) » [FLYCAM](#) » FLYCAM FLN-MSTR-EGV1 Flowline Master with Edge Instruction Manual 

## Contents

- [1 FLYCAM FLN-MSTR-EGV1 Flowline Master with Edge](#)
- [2 Product Information](#)
- [3 Product Usage Instructions](#)
- [4 FAQ](#)
- [5 What's In The Box](#)
- [6 Flowline Starter with Edge Setup](#)
- [7 Capture Every Angle \(180° Rotation\)](#)
- [8 Low/ High Angle Shots](#)
- [9 Adjust Camera Setup Position](#)
- [10 Documents / Resources](#)
  - [10.1 References](#)
- [11 Related Posts](#)



**FLYCAM FLN-MSTR-EGV1 Flowline Master with Edge**



## Product Information

### Specifications

- Product Name: Flowline Starter with Edge V1 Stabilization Arm (FLCM-FLN-EGV1)
- Model Number: FLCM-FLN-EGV1
- Features:
  - Foldable Design for easy storage
  - Tension adjustment knob to match rig's weight
  - Adaptable sliding knob to adjust support rope
  - Compatible with Flowline Body Worn Systems

## Product Usage Instructions

### Step 1: Unboxing

Inspect the contents of your shipped package to ensure you have received everything listed below:

- Camera Hook
- Support Bar
- Edge V1 Stabilization Arm
- Side Support Adjustment
- Balance Adjustment Knob
- Flycam Flowline Starter
- 2 x Washers
- 2 x Velcro
- 2mm Allen Key
- 2.5mm Allen Key

### Step 2: Assembly

To assemble the Flowline Starter with Edge V1 Stabilization Arm, follow these steps:

1. Attach the Camera Hook to the Support Bar.
2. Connect the Edge V1 Stabilization Arm to the Support Bar.
3. Adjust the Side Support and Balance using the respective knobs.
4. Secure the Flycam Flowline Starter using the washers and Allen keys provided.

### **Step 3: Setup**

If you have a Support Arm (not included), attach it to the Support Rod from the Vest.

### **Step 4: Usage**

Once the Flowline Starter with Edge V1 Stabilization Arm is assembled and set up, you can use it for various purposes:

- Low/High Angle Shots: Adjust the camera setup position to capture shots from different angles.
- Smooth Floating Shots: Attach the Flowline Starter to compatible Flowline Body Worn Systems (e.g., Basic flowline hanger, master flowline hanger, and N series hanger) for stable and comfortable floating shots.

### **FAQ**

- **Q: Can I fold the Flowline Edge for storage?**
  - A: Yes, the Flowline Edge has a foldable design, making it easier to store.
- **Q: How do I adjust the tension and support rope?**
  - A: Use the tension adjustment knob to match your rig's weight, and the adaptable sliding knob to adjust the support rope according to your filming needs.
- **Q: What Flowline Body Worn Systems are compatible with the Flowline Starter?**
  - A: The Flowline Starter is compatible with Basic flowline hanger, master flowline hanger, and N series hanger (300N, 400N & 500N).

### **What's In The Box**

Please inspect the contents of your shipped package to ensure you have received everything that is listed below.



**All rights reserved.**

No part of this document may be reproduced, stored in a retrieval system, or transmitted by any form or by any means, electronic, mechanical, photo-copying, recording, or otherwise, except as may be expressly permitted by the applicable copyright statutes or in writing by the Publisher.

### Flowline Starter with Edge Setup

- Loosen the screw of the Camera Hook attached to the Flowline Support Arm (Not Included) using the Allen key.



- Similarly, remove the second screw.
  - Now, remove the Hook from the Flowline Support Arm (Not Included)



- As shown in the image, take the Cord bundle out from the Cup and pull the Cord until a Cord lock comes out.



- Separate the Cord and the Cord lock.
  - Keep the lock aside to re-attach it later.

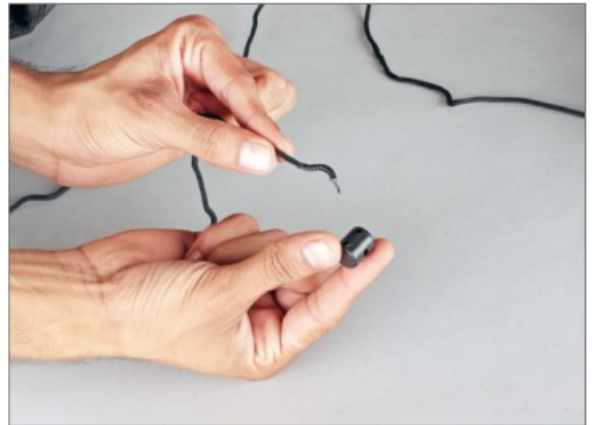
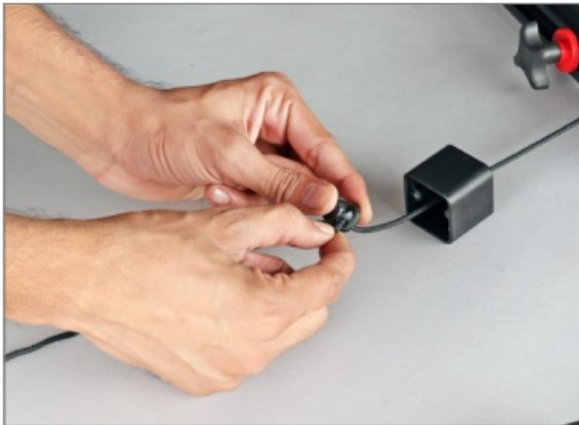

- Similarly, separate the Cord from the Cup to mount it back later.



- To detach the Flowline Support Rod pull it upwards.



- Disassemble the Camera Hook and the Support Rod from the Vest.





- To detach the extension from the Support Rod of the Vest, remove its screw using a screwdriver.



- Detach the extension from the Support Rod and align the cord with the height riser,(Not Included) as shown in the image.



- Attach the extension with the height riser (Not Included) and push it inside.



- Insert a screw in the Support rod and tighten it using the screwdriver.



- Similarly, tighten the top screw using the screwdriver.
  - Loosen the knob of the Flowline Edge.



- After loosening the knob, remove it and pull the rod of Flowline Edge to open it.
  - **Feature:** The Foldable Design of Flowline Edge makes it easier to store.



- After opening the Rod, insert the knob and properly tighten it, as shown in the image.
  - **Feature:** Tension adjustment knob to match your rig's weight, while the adaptable sliding knob adjusts the support rope to your unique filming needs.



- Insert the cord of the Flowline vest in the Flowline Edge.



- After inserting the cord in the Edge, pull the cord from the side of the Rod.



- Properly attach the Edge to the flowline vest.
  - **Feature:** It attaches to your Flowline Body Worn Systems like Basic flowline hanger, master flowline hanger, and N series hanger (300N, 400N & 500N) to provide Smooth Floating Shots with utmost comfort.

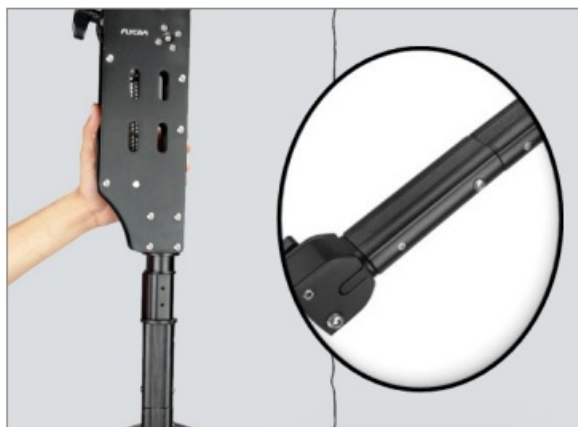



- Insert the cord into the cup and pull out.

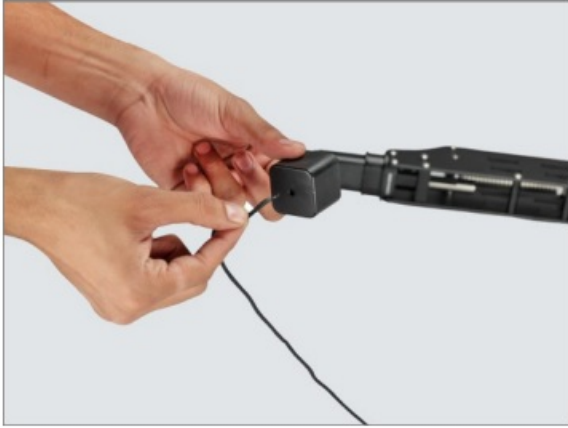

- After inserting the cord in the Cup, pull it outwards and insert it in the Cord Lock.

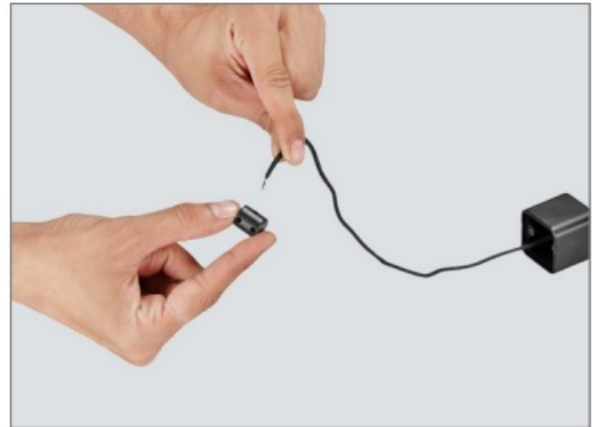

- After inserting it into the Cup, tie it properly with the Cord Lock.

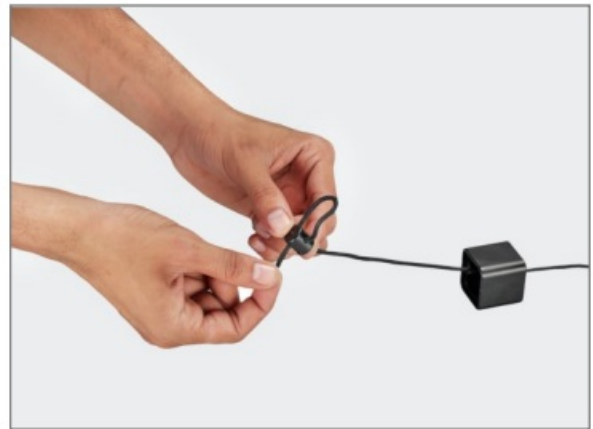
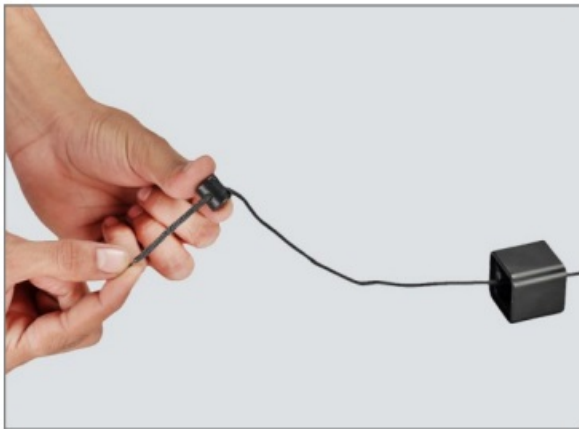

- Attach the Camera Hook to the Cup.



- Insert the screw into the Camera Hook and secure it properly using an Allen key.
  - The Flowline Edge is fully assembled with the Stabilization Arm. The versatile belt system molds to fit all body types.



### Capture Every Angle (180° Rotation)



### Low/ High Angle Shots



## Adjust Camera Setup Position



YOUR FLYCAM FLOWLINE STARTER WITH EDGE V1 STABILIZATION ARM ALL DRESSED UP AND READY TO GO!



**(SHOWN WITH OPTIONAL ACCESSORIES)**



**Warranty:** We offer one year warranty for our products from date of purchase. Within this period of time, we will

repair it without charge for labor or parts. Warranty doesn't cover transportation costs nor does it cover a product subjected to misuse or accidental damage. Warranty repairs are subjected to inspection and evaluation by us.

**Liability:** We are not liable for damage caused by products that we do not supply or from mishandling in transit, accident, misuse, neglect, lack of care of the product, or service by anyone other than our company.

**Contact Us:** In case of any kind of dissatisfaction, please Contact us immediately and we promise our utmost support and care until you use our product.

Documents / Resources

	<a href="#">FLYCAM FLN-MSTR-EGV1 Flowline Master with Edge</a> [pdf] Instruction Manual FLN-MSTR-EGV1 Flowline Master with Edge, FLN-MSTR-EGV1, Flowline Master with Edge, M aster with Edge
	<a href="#">FLYCAM FLN-MSTR-EGV1 Flowline Master with Edge</a> [pdf] Instruction Manual FLN-MSTR-EGV1 Flowline Master with Edge, FLN-MSTR-EGV1, Flowline Master with Edge, M aster with Edge, Edge

References

- [User Manual](#)

[Manuals+.](#) [Privacy Policy](#)

This website is an independent publication and is neither affiliated with nor endorsed by any of the trademark owners. The "Bluetooth®" word mark and logos are registered trademarks owned by Bluetooth SIG, Inc. The "Wi-Fi®" word mark and logos are registered trademarks owned by the Wi-Fi Alliance. Any use of these marks on this website does not imply any affiliation with or endorsement.