



FLYCAM FLCM-FLN-EGV1 Flowline Starter with Edge V1 Stabilization Arm Instruction Manual

[Home](#) » [FLYCAM](#) » FLYCAM FLCM-FLN-EGV1 Flowline Starter with Edge V1 Stabilization Arm Instruction Manual



Contents

- [1 FLYCAM FLCM-FLN-EGV1 Flowline Starter with Edge V1 Stabilization Arm Instruction Manual](#)
- [2 What's In The Box](#)
- [3 All rights reserved.](#)
- [4 Flowline Starter with Edge Setup](#)
- [5 Capture Every Angle \(180° Rotation\)](#)
- [6 Adjust Camera Setup Position](#)
- [7 \(SHOWN WITH OPTIONAL ACCESSORIES\)](#)
- [8 Read More About This Manual & Download PDF:](#)
- [9 Documents / Resources](#)
 - [9.1 References](#)

FLYCAM FLCM-FLN-EGV1 Flowline Starter with Edge V1 Stabilization Arm Instruction Manual



What's In The Box

Please inspect the contents of your shipped package to ensure you have received everything that is listed below.



All rights reserved.

No part of this document may be reproduced, stored in a retrieval system, or transmitted by any form or by any means, electronic, mechanical, photo-copying, recording, or otherwise, except as may be expressly permitted by the applicable copyright statutes or in writing by the Publisher.

Flowline Starter with Edge Setup

- Loosen the screw of the Camera Hook attached to the Flowline Support Arm using the Allen key.



- Similarly, remove the second screw.
- Now, remove the Hook from the Flowline Support Arm.



- As shown in the image, take the Cord bundle out from the Cup and pull the Cord until a Cord lock comes out.



- As shown in the image, take the Cord bundle out from the Cup and pull the Cord until a Cord lock comes out.
- Separate the Cord and the Cord



- To detach the Flowline Support Rod



- Disassemble the Camera Hook and the Support Rod from the



- To detach the extension from the Support Rod of the Vest, remove its screw using a



- Detach the extension from the Support Rod and align the cord with the height riser, (Not Included) as shown in the image.



- Attach the extension with the height riser (Not Included) and push it

Feature: Height riser that offers up to 4" of vertical extension for taller operators and a lockable hook to secure any camera, gimbal, or cage effortlessly.



- Insert a screw in the Support rod and tighten it using the screwdriver.



- Similarly, tighten the top screw using the screwdriver.
- Loosen the knob of the Flowlin



- After loosening the knob, remove it and pull the rod of Flowline Edge to open

Feature: Foldable Design of Flowline Edgemakes it easier to store.\

- Insert the cord of the Flowline vest in the Flowline Edge

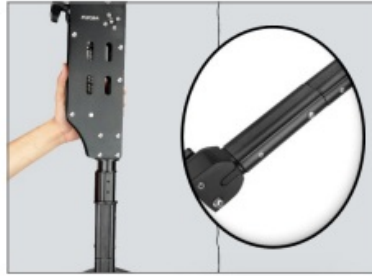

- Insert the cord of the Flowline vest in the Flowline



- Insert the cord into the cup and pull out
- After inserting the cord in the Cup, pull it outwards and insert it in the Cord Lock



- After inserting it into the Cup, tie it properly with the Cord Lock.



-

Capture Every Angle (180° Rotation)



Low/ High Angle Shots



Adjust Camera Setup Position

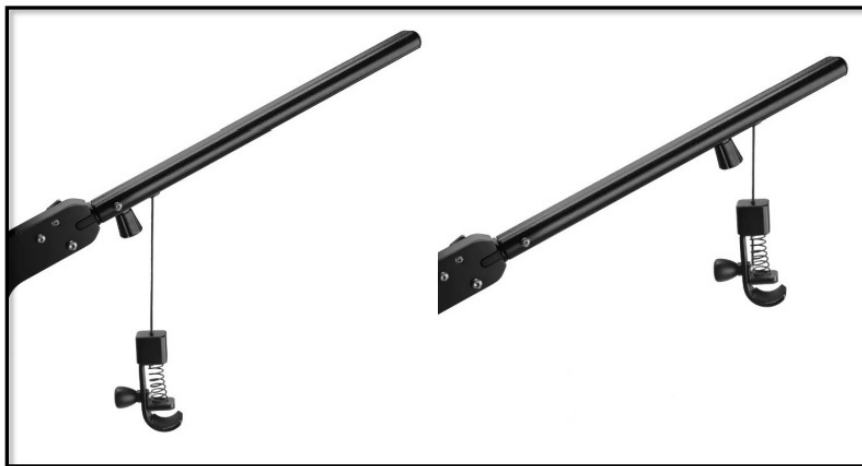

YOUR FLYCAM FLOWLINE STARTER WITH EDGE V1 STABILIZATION ARM ALL DRESSED UP AND READY TO GO!



(SHOWN WITH OPTIONAL ACCESSORIES)

Warranty: We offer one year warranty for our products from date of purchase. Within this period of time, we will repair it without charge for labor or parts. Warranty doesn't cover transportation costs nor does it cover a product subjected to misuse or accidental damage. Warranty repairs are subjected to inspection and evaluation by us.

Liability: We are not liable for damage caused by products that we do not supply or from mishandling in transit, accident, misuse, neglect, lack of care of the product, or service by anyone other than our company.

Contact Us: In case of any kind of dissatisfaction, please Contact us immediately and we promise our utmost support and care until you use our product.

Read More About This Manual & Download PDF:

Documents / Resources

	<p>FLYCAM FLCM-FLN-EGV1 Flowline Starter with Edge V1 Stabilization Arm [pdf] Instruction Manual</p> <p>FLCM-FLN-EGV1 Flowline Starter with Edge V1 Stabilization Arm, FLCM-FLN-EGV1, Flowline Starter with Edge V1 Stabilization Arm, Edge V1 Stabilization Arm, Stabilization Arm, Arm</p>
---	--

References

- [User Manual](#)

[Manuals+](#), [Privacy Policy](#)

This website is an independent publication and is neither affiliated with nor endorsed by any of the trademark owners. The "Bluetooth®" word mark and logos are registered trademarks owned by Bluetooth SIG, Inc. The "Wi-Fi®" word mark and logos are registered trademarks owned by the Wi-Fi Alliance. Any use of these marks on this website does not imply any affiliation with or endorsement.