



FLYCAM FLCM-EDGE-V1 Flowline Edge V1 Stabilization Arm Instruction Manual

[Home](#) » [FLYCAM](#) » FLYCAM FLCM-EDGE-V1 Flowline Edge V1 Stabilization Arm Instruction Manual 



Assembly Manual
Flowline Edge V1 Stabilization Arm for Flowline Rigs,
Cameras & Gimbals (FLCM-EDGE-V1)



Contents

- 1 What's In The Box
- 2 Flowline Edge Setup
- 3 Documents / Resources
 - 3.1 References

What's In The Box

Please inspect the contents of your shipped package to ensure you have received everything that is listed below.



Flowline Edge V1 Stabilization Arm



Height Riser

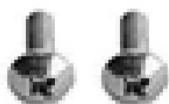

2 x Screws
(Size: 4 x 12)



2 x Screws CSK
(Size: 3 x 8)



2mm Allen Key

All rights reserved.

No part of this document may be reproduced, stored in a retrieval system, or transmitted by any form or by any means, electronic, mechanical, photo-copying, recording, or otherwise, except as may be expressly permitted by the applicable copyright statutes or in writing by the Publisher.

Flowline Edge Setup

- Loosen the screw of the Camera Hook attached to the Flowline Support Arm (Not Included) using the Allen key.



- Similarly, remove the second screw.
- Now, remove the Hook from the Flowline Support Arm (Not Included).



- As shown in the image, take the Cord bundle out from the Cup and pull the Cord until a Cord lock comes out.



- Separate the Cord and the Cord lock.
- Keep the lock aside to re-attach it later.

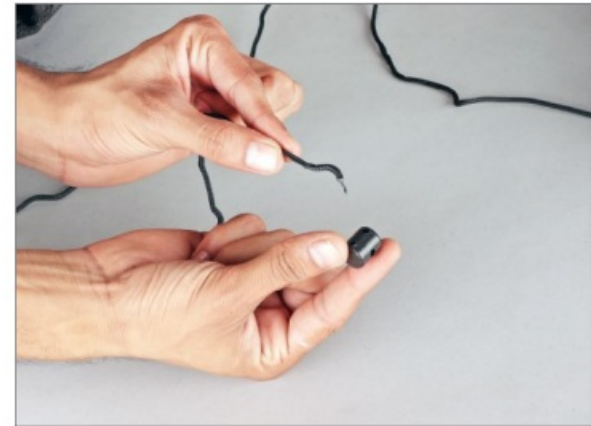
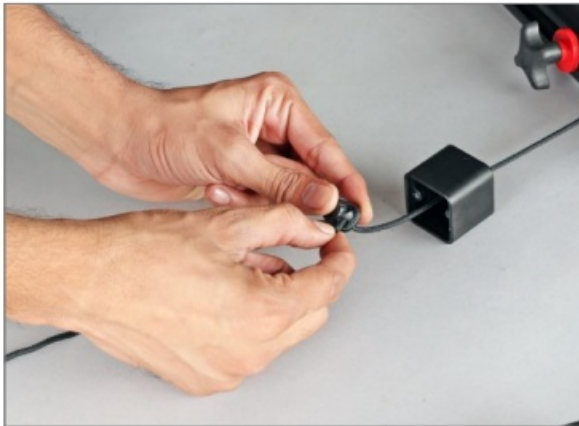

- Similarly, separate the Cord from the Cup to mount it back later.



- To detach the Flowline Support Rod (Not Included), pull it upwards.



- Disassemble the Camera Hook and the Support Rod from the Vest.



- To detach the extension from the Support Rod of the Vest, remove its screw using a screwdriver.



- Detach the extension from the Support Rod (Not Included) and align the cord with the height riser, as shown in the image.



- Attach the extension with the height riser and push it inside.



- Insert a screw in the Support rod and tighten it using the screwdriver.



- Similarly, tighten the top screw using the screwdriver.
- Loosen the knob of the Flowline Edge.



- After loosening the knob, remove it and pull the rod of Flowline Edge to open it.
- Feature: Foldable Design of Flowline Edge makes it easier to store.



- After opening the Rod, insert the knob and properly tighten it, as shown in the image.

Feature: The top bar allows for 180° rotation to capture shots with incredible freedom of movement.



- Insert the cord of the Flowline vest in the Flowline Edge.



- After inserting the cord in the Edge, pull the cord from the side of the Rod.



- Properly attach the Edge to the flowline vest.

Feature: It attaches to your Flowline Body Worn Systems like Basic flowline hanger, master flowline hanger, and N series hanger (300N, 400N & 500N) to provide Smooth Floating Shots with utmost comfort.

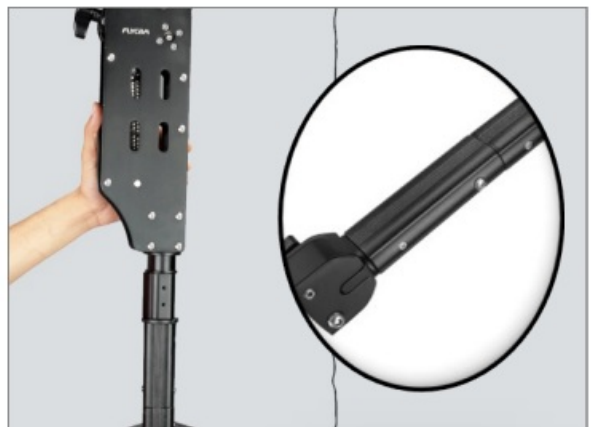

- Insert the cord into the cup and pull out.



- After inserting the cord in the Cup, pull it outwards and insert it in the Cord Lock.

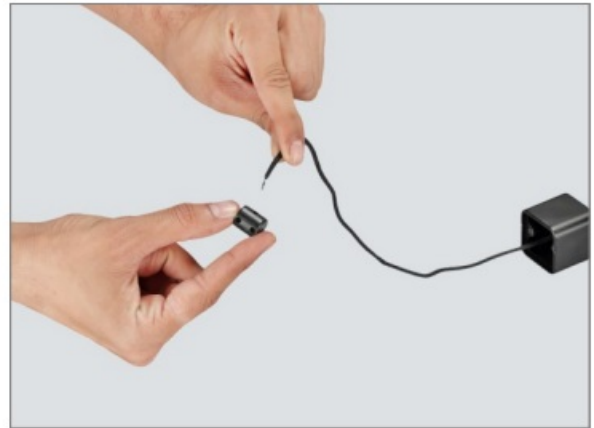

- After inserting it into the Cup, tie it properly with the Cord Lock.

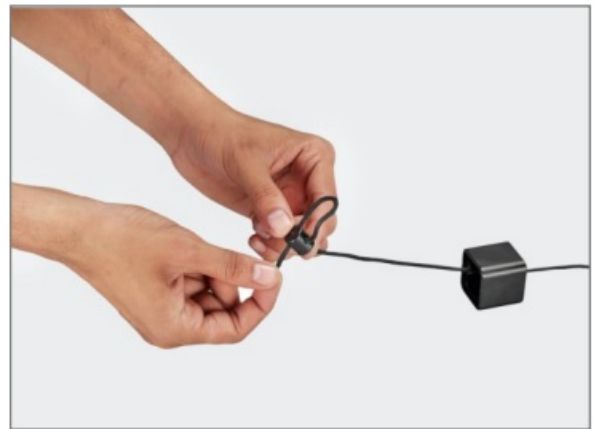

- Attach the Camera Hook (Not Included) to the Cup.



- Insert the screw into the Camera Hook and secure it properly using an Allen key.
- The Flowline Edge is fully assembled with the Stabilization Arm.

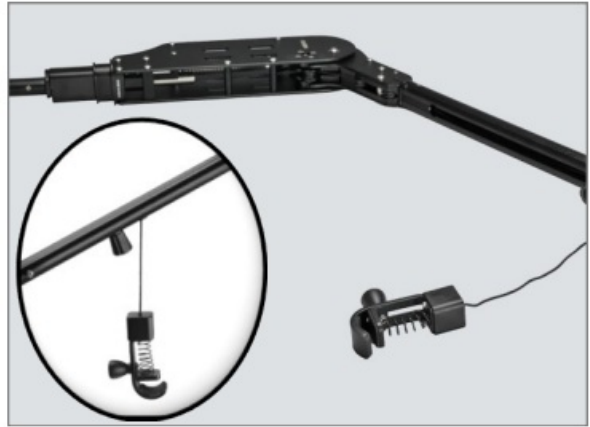

180° Rotation



YOUR FLYCAM FLOWLINE EDGE V1 STABILIZATION ARM ALL DRESSED UP AND READY TO GO!



(SHOWN WITH OPTIONAL ACCESSORIES)

Warranty: We offer one year warranty for our products from date of purchase. Within this period of time, we will repair it without charge for labor or parts. Warranty doesn't cover transportation costs nor does it cover a product subjected to misuse or accidental damage. Warranty repairs are subjected to inspection and evaluation by us.

Liability: We are not liable for damage caused by products that we do not supply or from mishandling in transit, accident, misuse, neglect, lack of care of the product, or service by anyone other than our company.

Contact Us: In case of any kind of dissatisfaction, please Contact us immediately and we promise our utmost support and care until you use our product.

FLYCAM

	<p>FLYCAM FLCM-EDGE-V1 Flowline Edge V1 Stabilization Arm [pdf] Instruction Manual FLCM-EDGE-V1, FLCM-EDGE-V1 Flowline Edge V1 Stabilization Arm, Flowline Edge V1 Stabilization Arm, Edge V1 Stabilization Arm, Stabilization Arm, Arm</p>
--	--

References

- [User Manual](#)

[Manuals+](#), [Privacy Policy](#)

This website is an independent publication and is neither affiliated with nor endorsed by any of the trademark owners. The "Bluetooth®" word mark and logos are registered trademarks owned by Bluetooth SIG, Inc. The "Wi-Fi®" word mark and logos are registered trademarks owned by the Wi-Fi Alliance. Any use of these marks on this website does not imply any affiliation with or endorsement.