



flybold Tilt Out Trash Can Holder User Manual

[Home](#) » [flybold](#) » flybold Tilt Out Trash Can Holder User Manual 



TILT-OUT TRASH CAN HOLDER ASSEMBLY INSTRUCTIONS

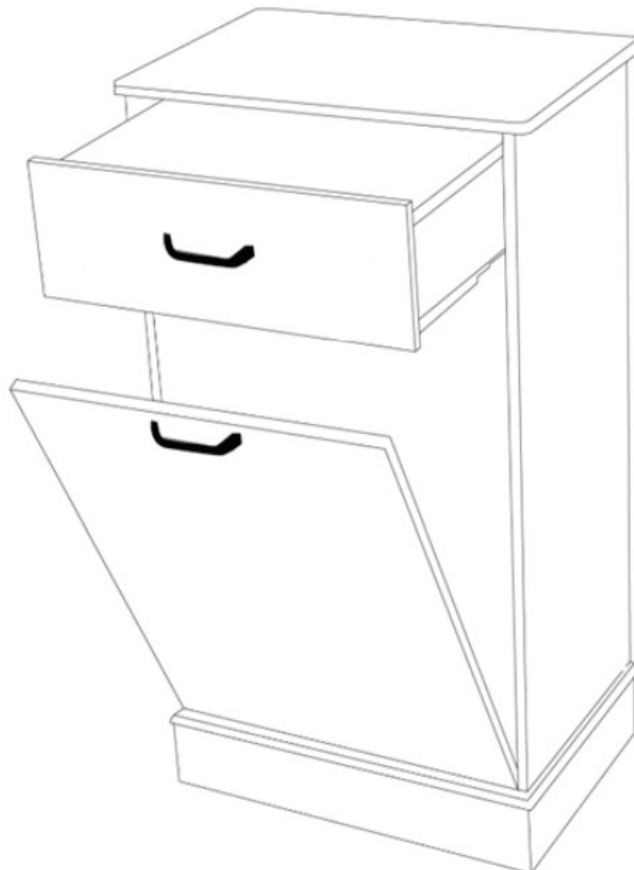

IMPORTANT

The manufacturer, sellers, and resellers of this product make no representations and/or work-routines, regarding the product, including without limitation, any warranties as to quality, merchantability, or fitness for a particular purpose. The manufacturer, sellers, and resellers shall not be held liable in any way whatsoever for special, indirect, consequential, or incidental damages, whether Posed on breach of contract, breach of warranty, tort including negligence). product liability or otherwise, even if they have been advised of the possibility of such damages. The buyer of the product and the user agree that his or her full remedy against the manufacturer, sellers, and resellers for any liability, claims, or damages, shall be limited to the purchase price of the product, and irrevocably waive all claims for any other damages that they may have.

remedy against the manufacturer, sellers, and resellers for any liability, claims, or damages, shall be limited to the purchase price of the product, and irrevocably waive all claims for any other damages that they may have.

Contents

- [1 CONTENTS](#)
- [2 ASSEMBLY INSTRUCTION](#)
- [3 Documents / Resources](#)
- [4 Related Posts](#)

CONTENTS

Unpack all components from the carton and check for missing components. Do not attempt to assemble or use the product if any component is missing.

1. Make sure that 19 wooden boards are inside the package with numbering on each board from 1 – 19.
2. Accessories





SMALL SCREW (30PCS)



CAM SCREWS (48PCS)



CAM LOCKNUTS (48PCS)

ASSEMBLY INSTRUCTION

STEP 1



Screw the cam screws into the holes with white sleeve on all boards

STEP 2



Pull down the lock pin in the rail guides and then pull out the front end guide and back end guide separately

STEP 3

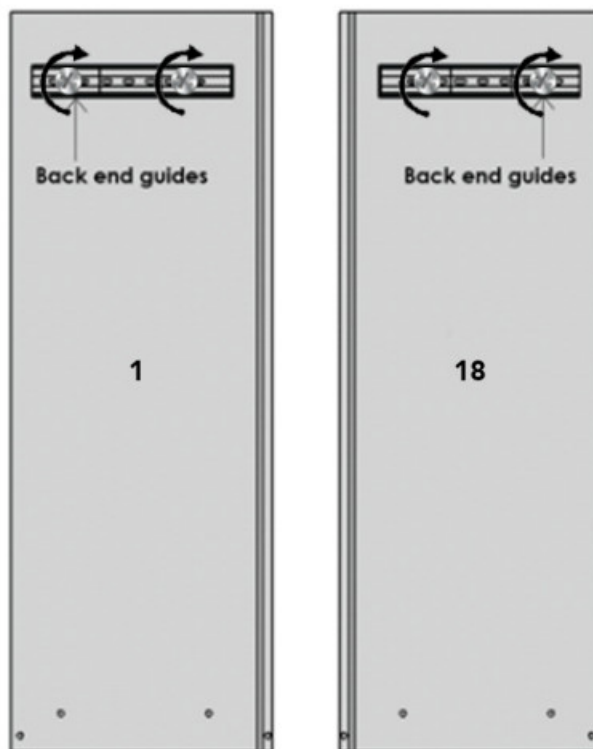

Screw the back end of the rail guides onto the wooden board 1 and 18 with small screws as shown in figure

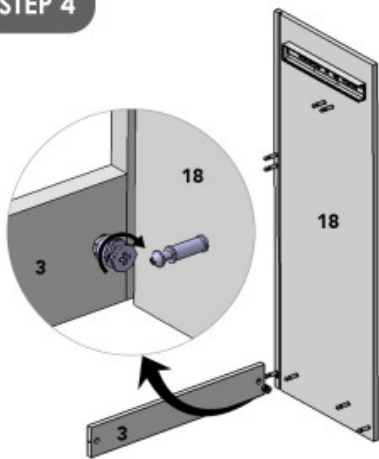
STEP 4

Connect wooden board 3 onto board 18 (with holes on board 3 facing front as shown in figure) and screw the cam locknut on board 3 as shown in zoomed figure.

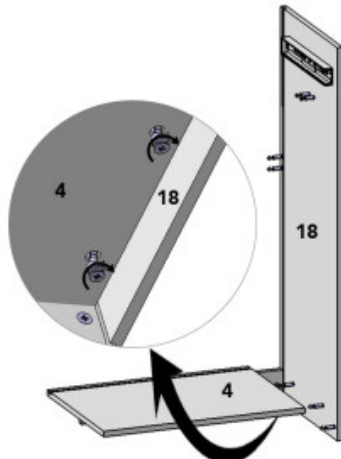

Connect wooden board 4 onto board 18 (with holes on board 4 facing down as shown in figure) and screw 2 cam locknuts on the bottom of the board 4 as shown in zoomed figure.

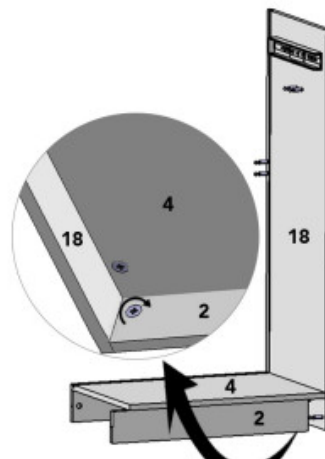

Connect wooden board 2 onto board 18 (with holes on board 2 at the back) and screw the cam locknut on the back of board 2 as shown in zoomed figure.

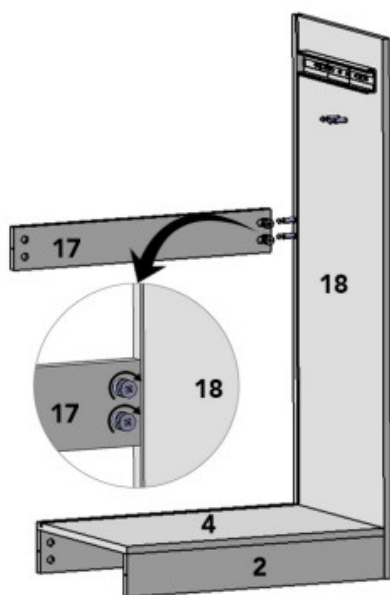
STEP 5

Connect wooden board 17 onto board 18 (with holes on board 17 facing front as shown in figure) and screw 2 cam locknuts on the board 17 as shown in zoomed figure.

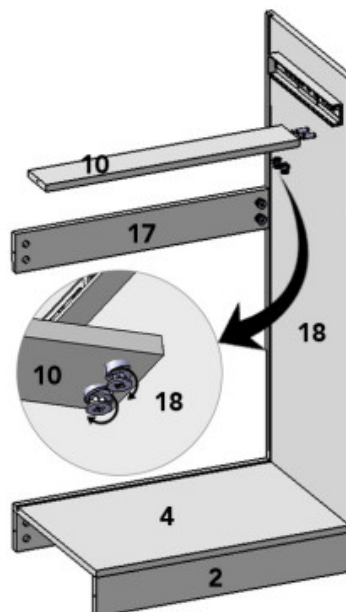

Connect wooden board 10 onto board 18 (with holes on board 10 facing down as shown in figure) and screw 2 cam locknuts on the bottom of the board 10 as shown in zoomed figure.

STEP 6

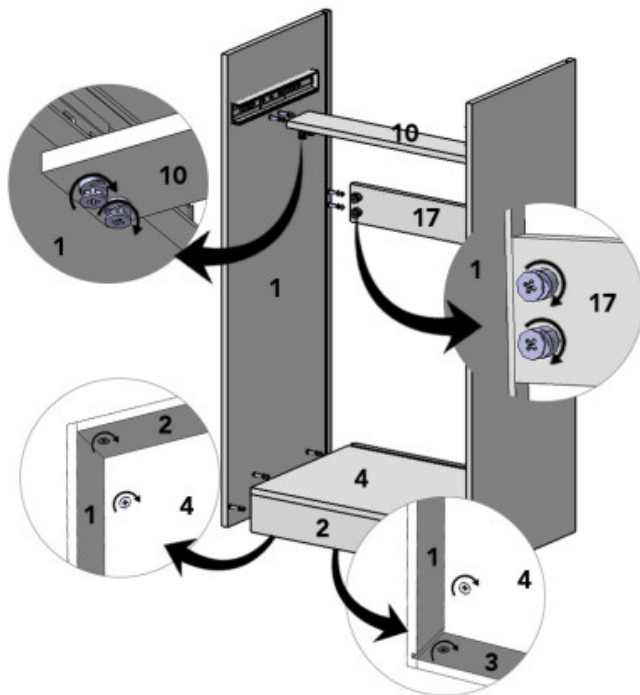

Connect wooden board 1 onto the previous setup in the same alignment as shown in figure and screw 2 cam locknuts on the bottom of board 10, 2 cam locknuts on the front of board 17, 2 cam locknuts on the bottom of board 4, 1 camlock nut each on the board 2 and 3 as shown in figure.

STEP 7



Slide wooden board 16 into the set up as shown in figure.

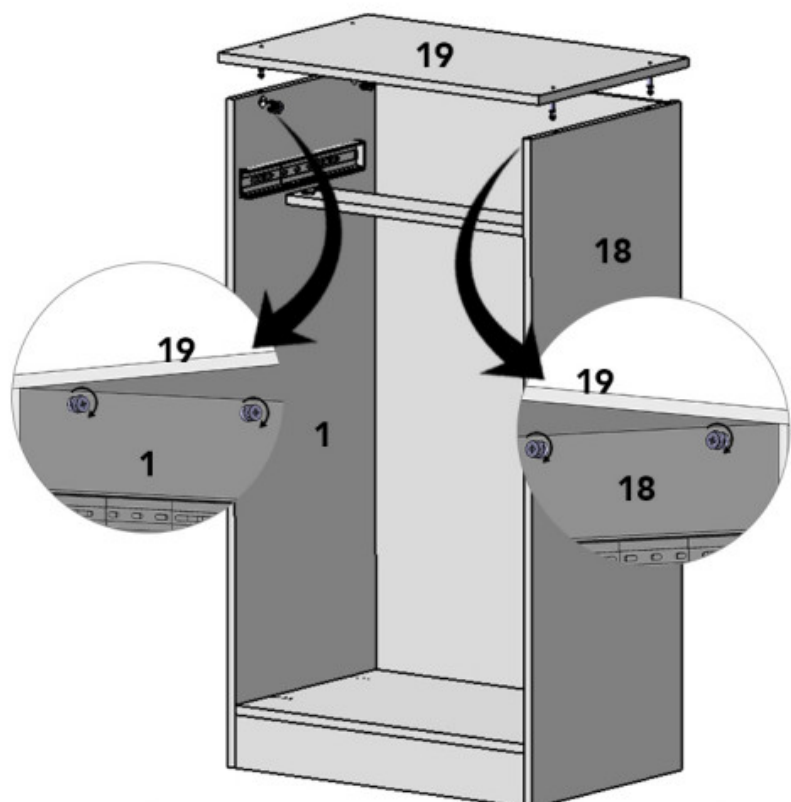

Connect wooden board 19 on top of the setup and screw 2 cam locknuts on board 1 & 2 cam locknuts on board 18 as shown in figure.

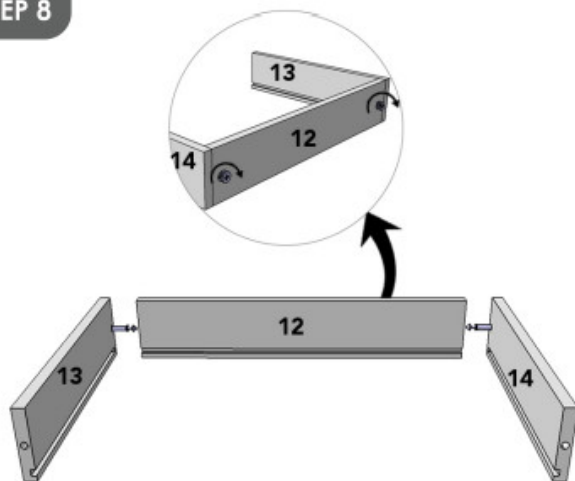
STEP 8

Connect wooden board 13 & 14 onto board 12 (with slots on three boards facing inside as shown in figure) and screw 2 cam locknuts on back side of board 12 as shown in zoomed figure.

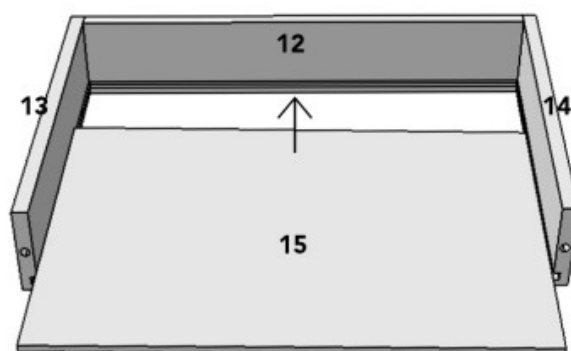

Slide in wooden board 15 as shown in figure.

Connect wooden board 11 onto the previous setup in the same alignment as shown in figure and screw 1 cam locknut each on boards 13 and 14 as shown in zoomed figure.

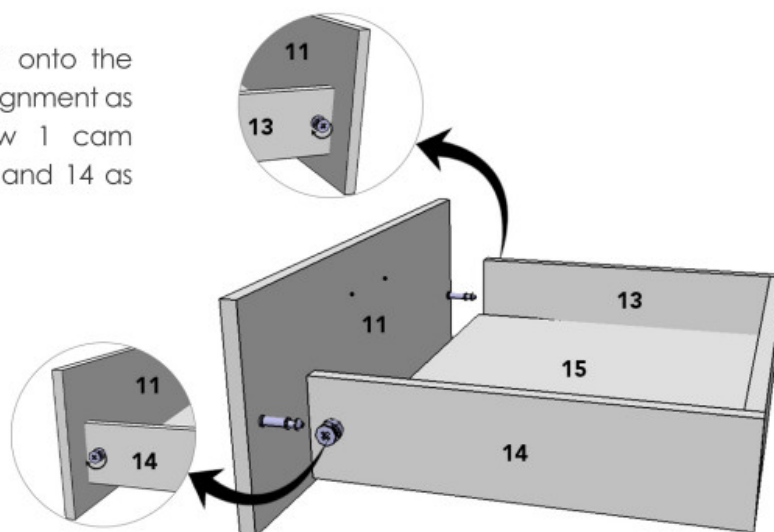

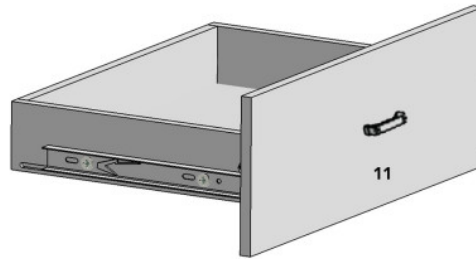
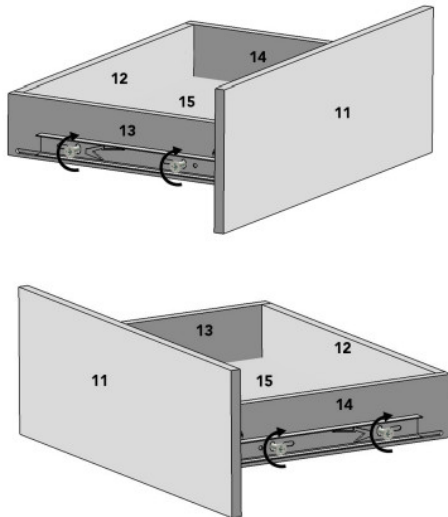
STEP 9

Fix the handle on the drawer with small screws as shown in figure

Fix the 2 front-end rail guides on board 13, 14 and screw with 2 small screws on each rail guides as shown in figure

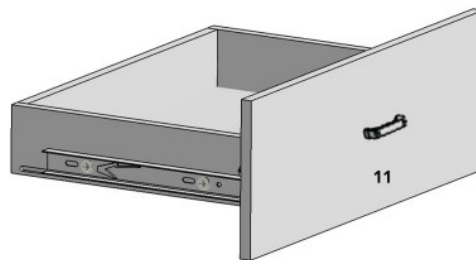
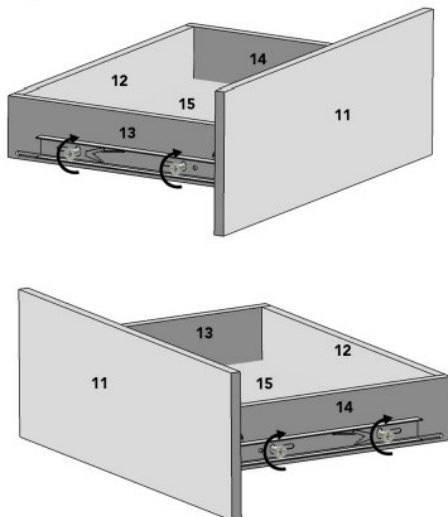
STEP 9

Fix the handle on the drawer with small screws as shown in figure

Fix the 2 front-end rail guides on board 13, 14 and screw with 2 small screws on each rail guides as shown in figure

STEP 10

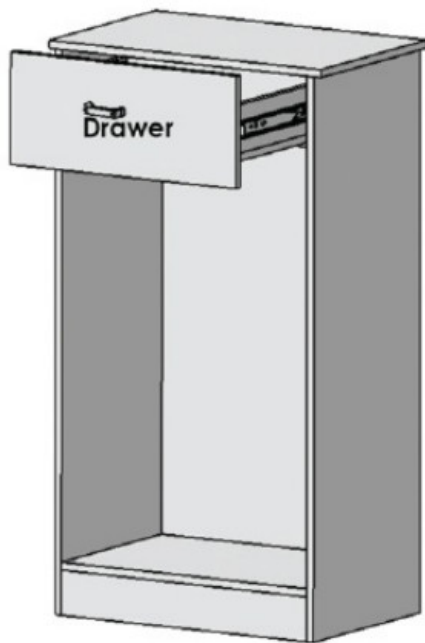

Fix the drawer by pushing the front-end rail guides into the back end rail guides.

STEP 11

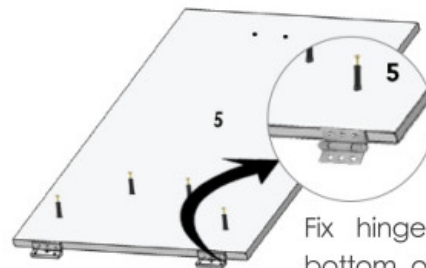

Fix hinges on the bottom of board 5 with 2 small screws on each hinges.

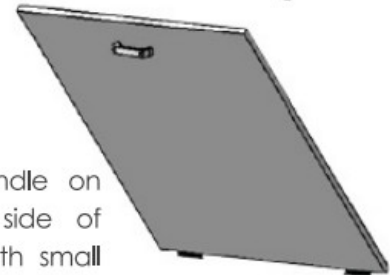

Fix the handle on the other side of board 5 with small screws as shown in figure

STEP 12

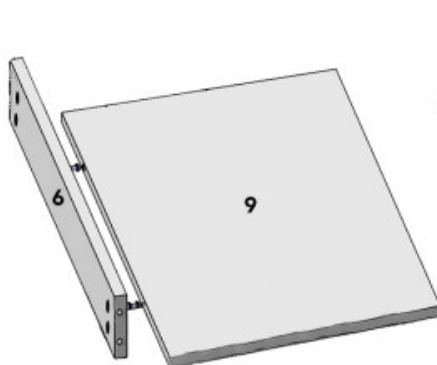

Connect wooden board 9 onto board 6 in the same alignment as shown in figure

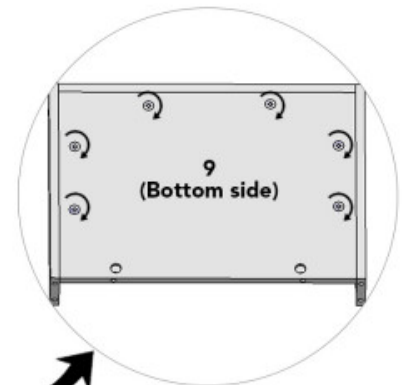
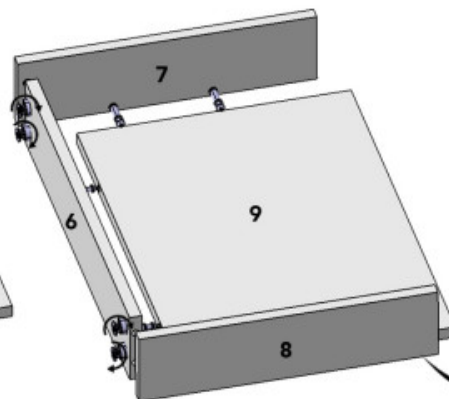

Connect wooden boards 7 & 8 onto the previous setup in the same alignment as shown in figure and screw 4 cam locknuts on the front side of board 6 & 6 cam locknuts on the bottom of board 9 as shown in figure

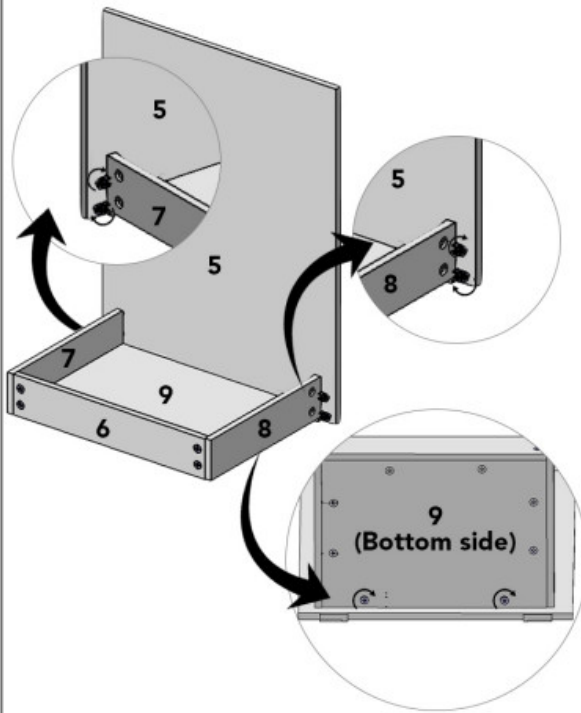
STEP 13

Attach the previous stepup onto board 5 in the same alignment as shown in figure and screw 2 cam locknuts each on boards 7, 8, 9 as shown in figure

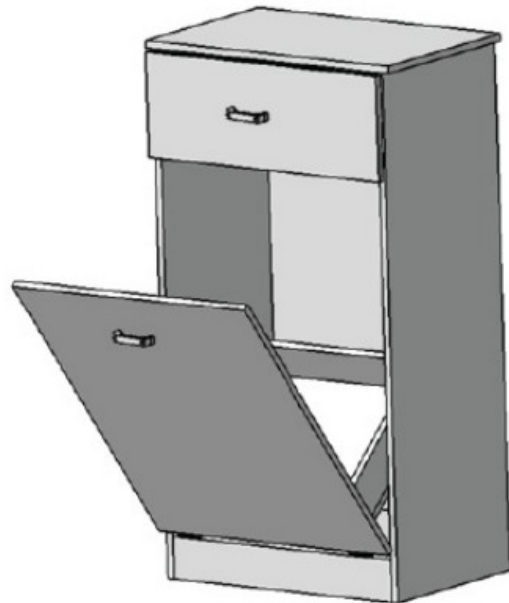
STEP 14

Fix the other end of the hinges onto the board 4 with the small screws.

STEP 15

Connect the door stopper on both sides of door with small screws as shown in figure.

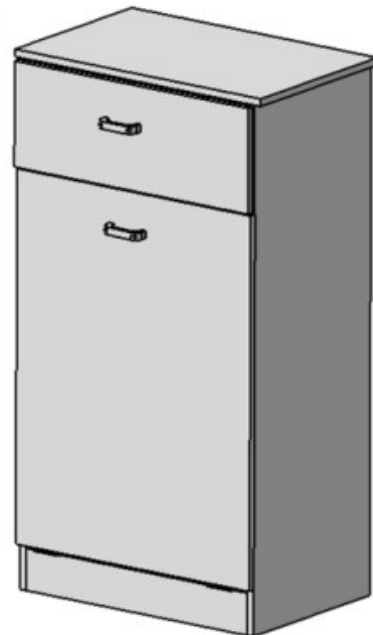
STEP 16

Your tilt out trash cabinet is ready!

