 **Fluidmaster**
1000A-039
Universal
Cistern



Fluidmaster 1000A-039 Universal Cistern Installation Guide

[Home](#) » [FLUIDMASTER](#) » Fluidmaster 1000A-039 Universal Cistern Installation Guide 

Contents

- [1 Fluidmaster 1000A-039 Universal Cistern](#)
- [2 Install with Confidence](#)
- [3 PARTS OVERVIEW](#)
- [4 PRE-INSTALLATION](#)
- [5 TROUBLESHOOTING](#)
- [6 Documents / Resources](#)
 - [6.1 References](#)
- [7 Related Posts](#)



Fluidmaster 1000A-039 Universal Cistern



Install with Confidence

CISTERN TANK OVERVIEW

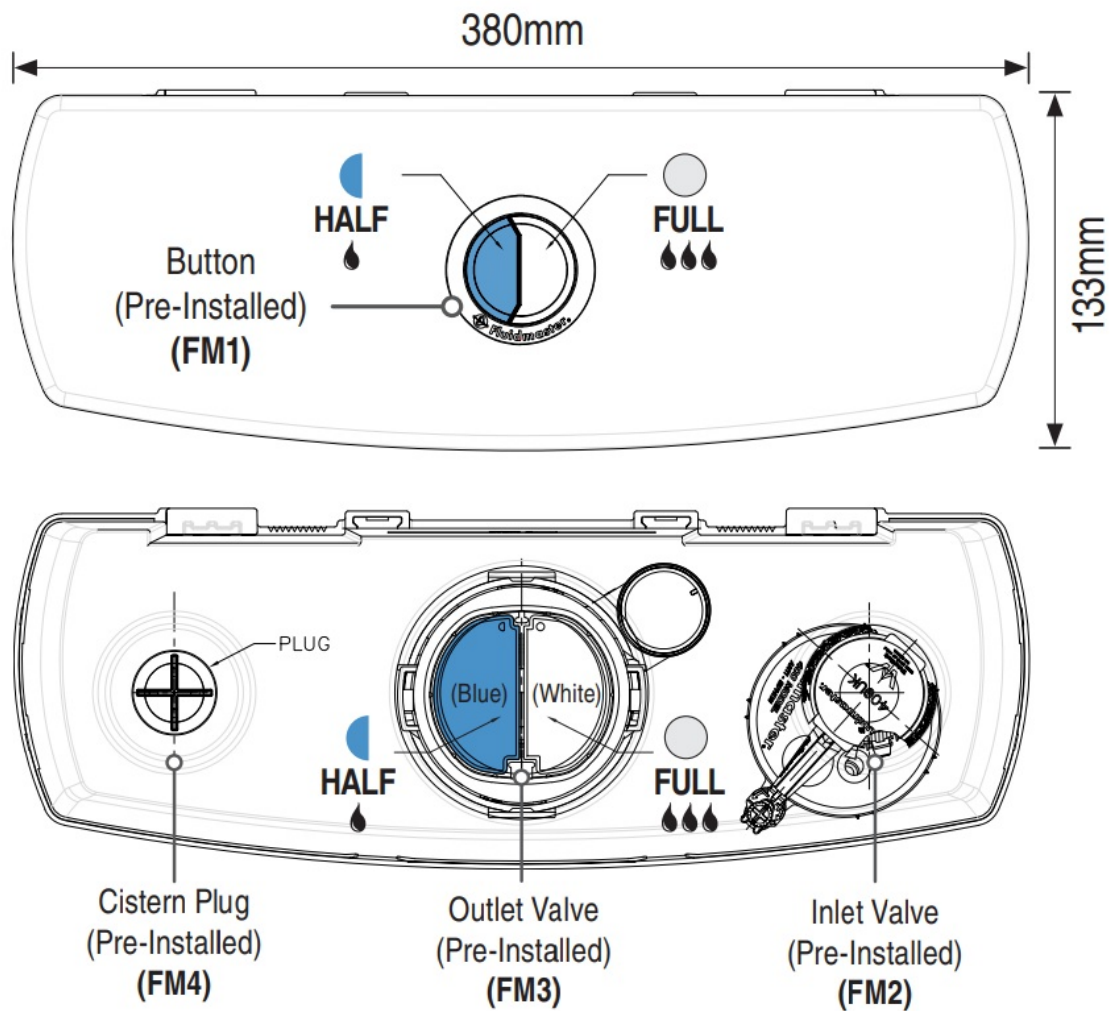

CISTERN TANK HEIGHT: 396mm

PARTS OVERVIEW

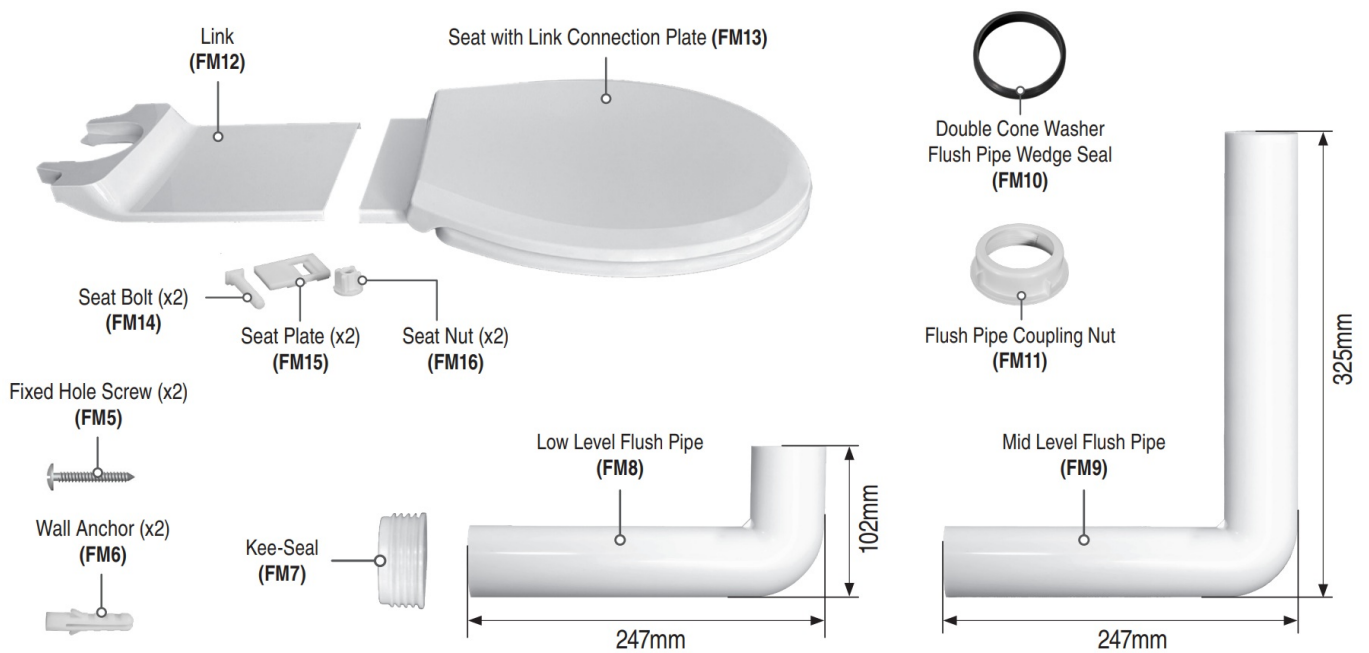

PRE-INSTALLATION

A: OPEN LID

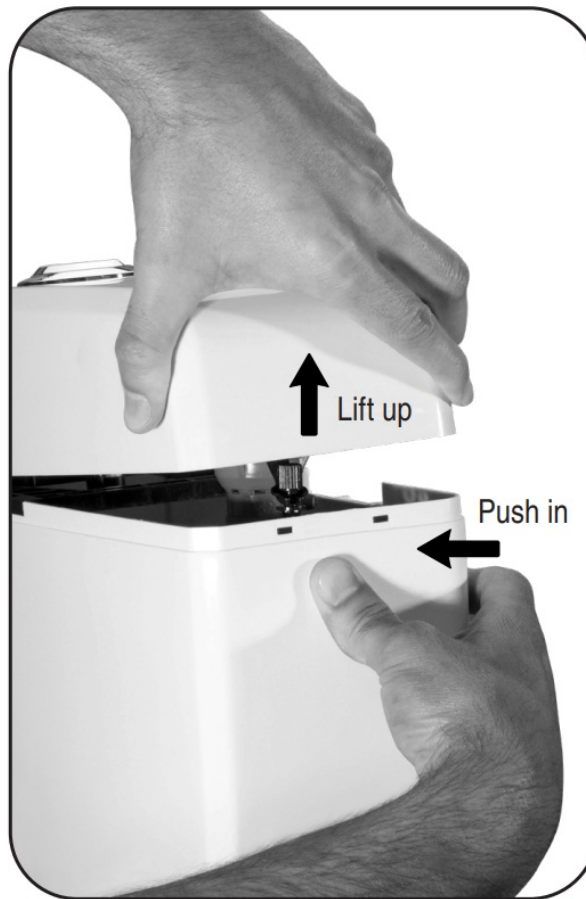

B: FLUSH VOLUME CONVERSION

CONVERTING TO 4.5/3L OR 9/4.5L FLUSH VOLUME SYSTEM

B1: Remove the black cistern tank spacer.

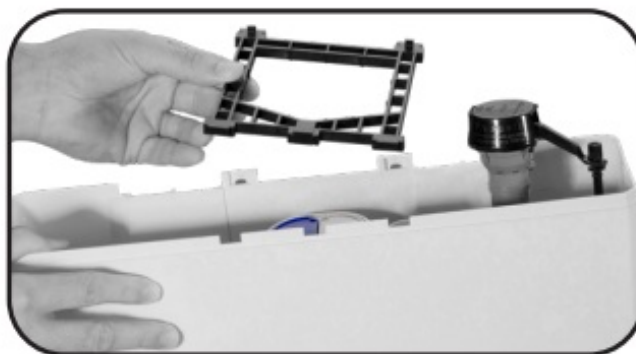

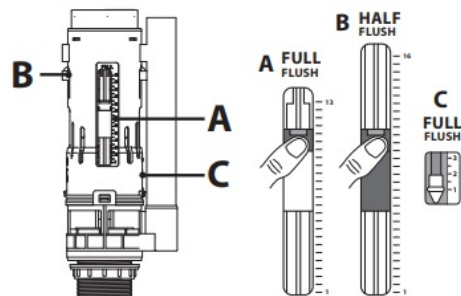

CISTERN FLUSH VOLUME CONVERSION SETTINGS

		4.5/3L	6/3L	9/4.5L*
A	Full Float #	10	4.5	1
B	Half Float #	14.5	13.5	10
C	Full Window #	1	1	1

B2: Remove flush valve body & adjust full and half float settings per Flush Volume Conversion Table



B3: Re-install flush valve body and black cistern tank spacer. Ensure proper full and half flush alignment.

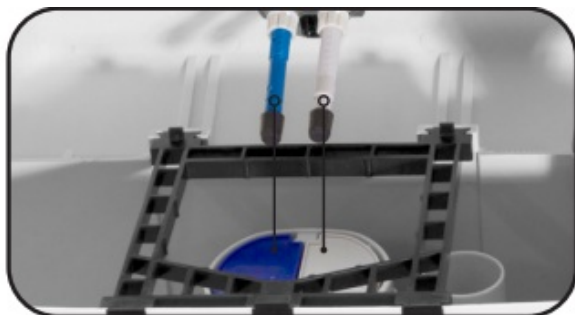

Note:

- (Blue) = Half Flush 💧
- (White) = Full Flush 💧💧💧

CHOOSE DESIRED INSTALL METHOD

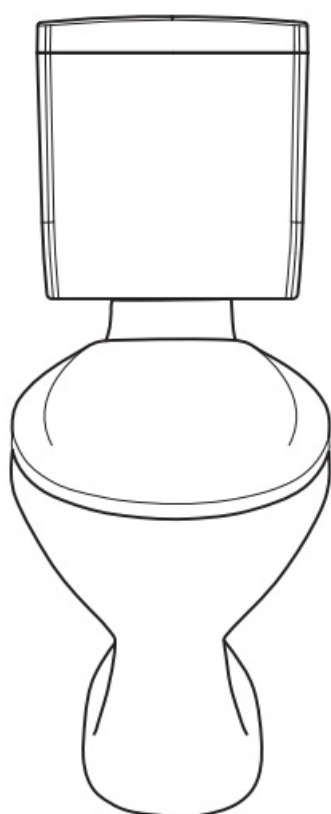

(C1)
Low Level
with Link

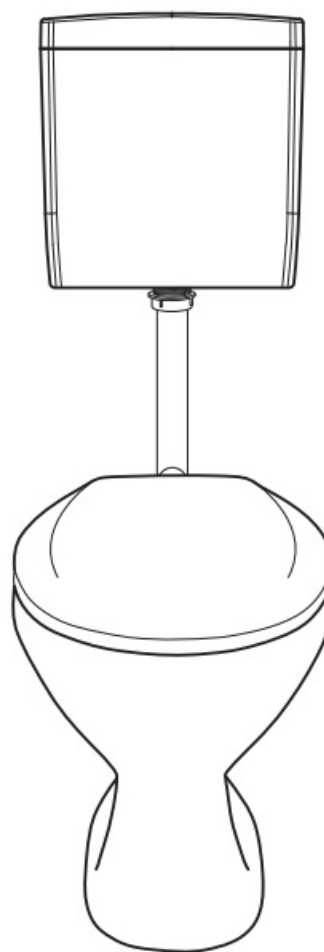

(C2)
Mid Level
(Uncut Height)

STEP 1: MARK WALL FOR SCREW HOLES

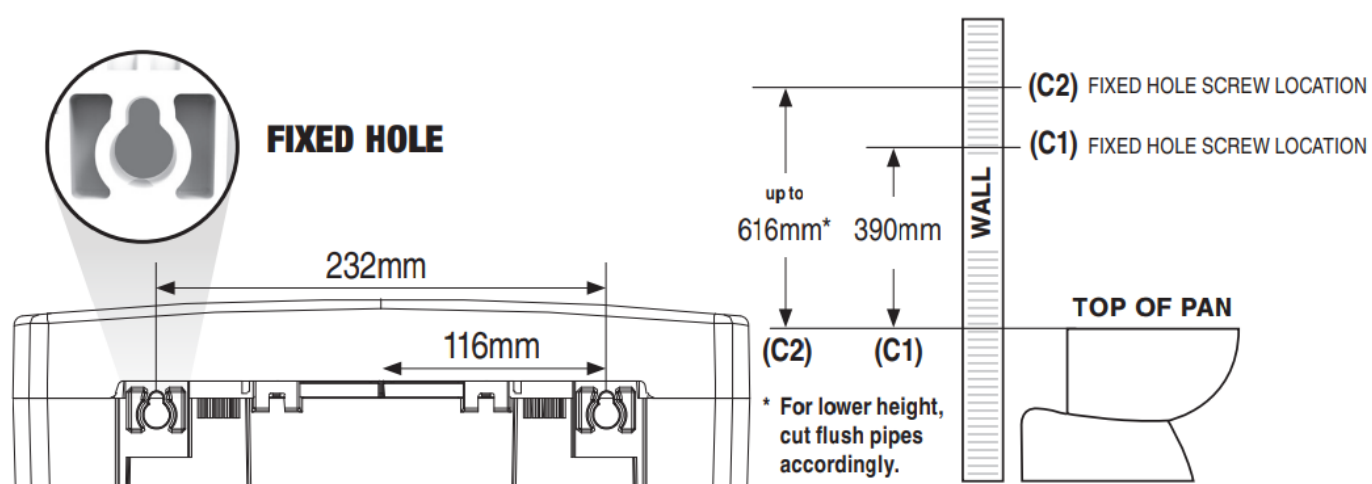

STEP 2: SET SCREWS

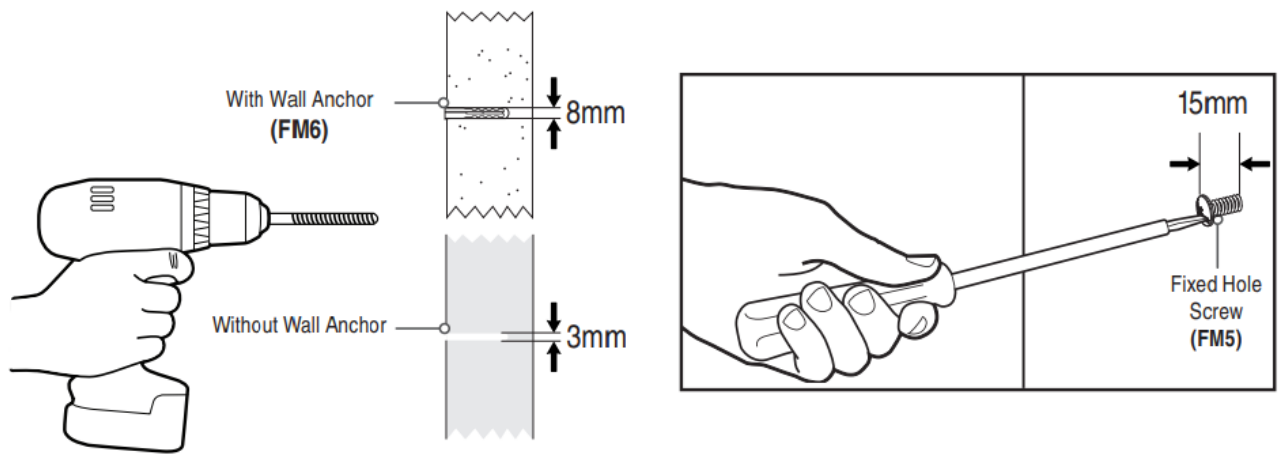

STEP 3: INSTALL FLUSH PIPE

- Trim / Cut Flush Pipe as needed.

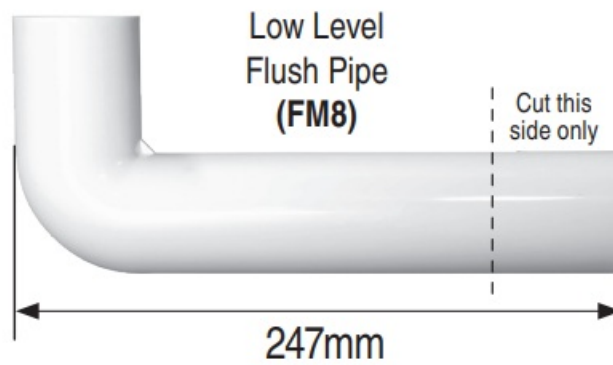

- Lubricate kee-seal with soap and water. Insert the flush pipe and connect it to the pan.

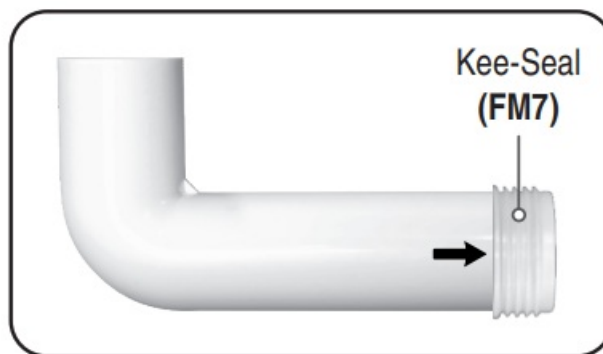

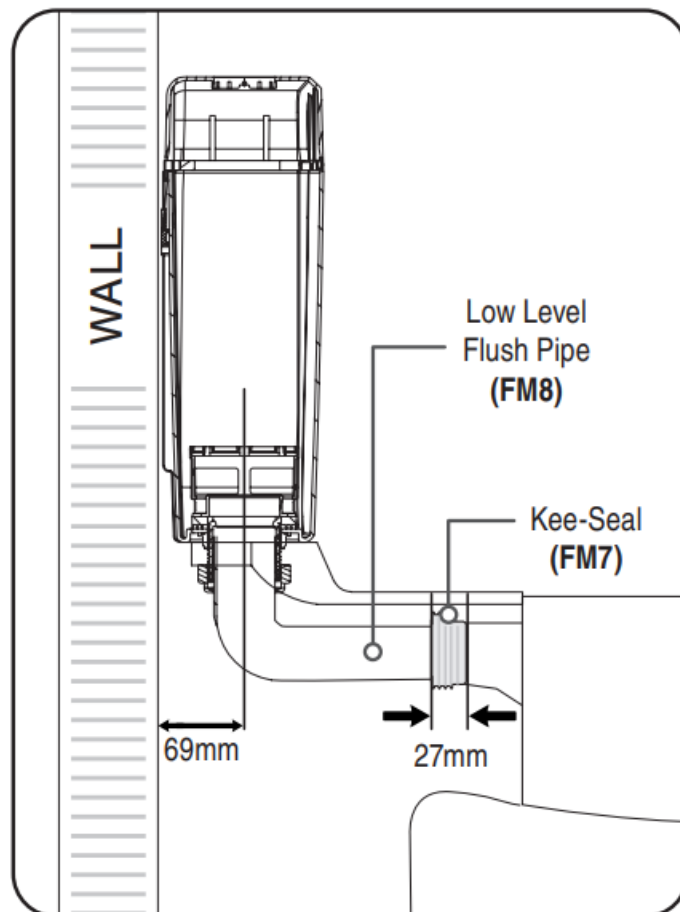

STEP 4: HANG CISTERN TANK & SECURE FLUSH PIPE

- Install screws through Fixed Holes to secure the tank.

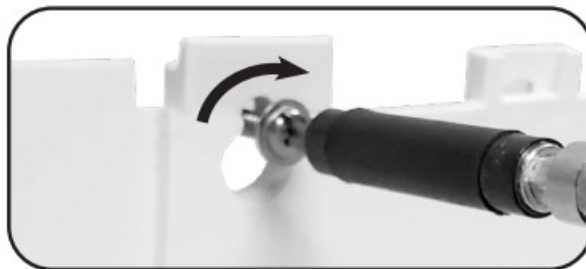

- Fit the Flush pipe coupling nut and double cone washer wedge seal onto the flush pipe. Hand-tighten the Flush pipe coupling nut and secure the flush pipe to the outlet valve shank. **DO NOT OVERTIGHTEN**

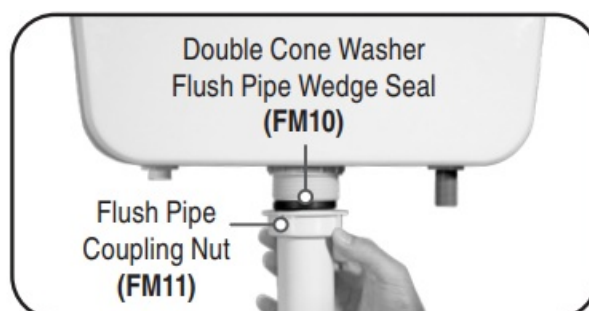

SPECIAL NOTE: If the cistern experiences thumping sounds during flushing, ensure both screws are set towards

the top of the fixed hole cut-outs and firmly tightened. Properly secure the black cistern tank spacer and re-secure the lid for proper flush performance.

STEP 5: WATER SUPPLY CONNECTION & FINE-TUNE TANK WATER LEVEL

- Turn on the water & flush the water supply line.
- Turn off the water & connect the water supply line to the cistern with approved fittings. Hand-tighten only.
- DO NOT OVERTIGHTEN.
- Turn on the water & check for leaks.



- **FLUSH THE CISTERN TO CHECK THE TANK WATER LEVEL** After the water stops filling the tank, the water level should be at the water line “WL” mark to ensure a proper flush.

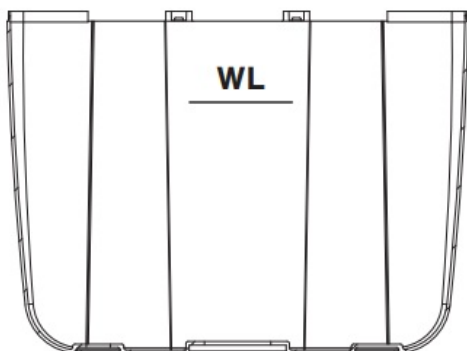

STEP 6: ATTACH LINK (IF REQUIRED)

- Secure link into position.



- Set the seat onto the link to mark desired seat endpoint & cut point.

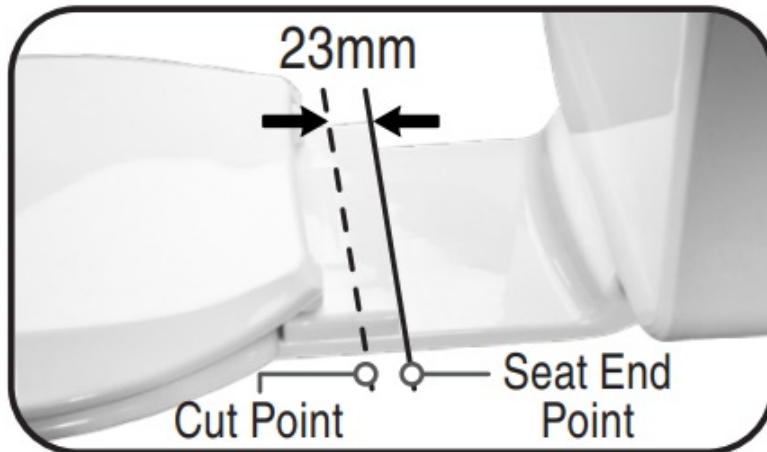

- If cut is required, cutting line guides reference on the back of the link as needed.

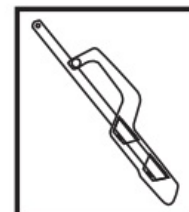
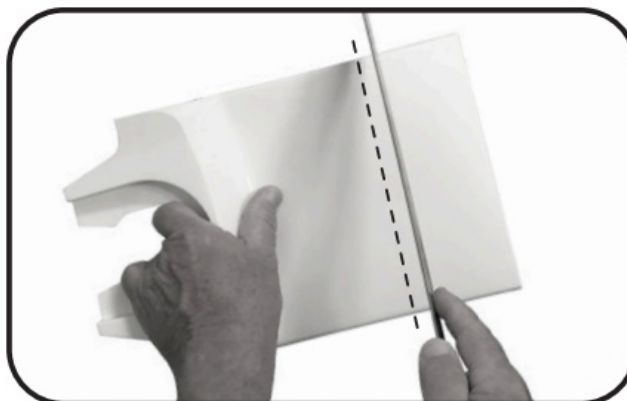

Mini Hack Saw

STEP 7: INSTALL SEAT

- Insert Seat Bolt Plates in the Connection plate (follow arrow guides).

For Link Application

- Insert link to seat connection plate. nSet seat bolts into pan holes and hand-tighten seat bolt nuts (FM16).

For Non-Link Application

- Set seat bolts into pan holes and hand-tighten seat bolt nuts (FM16).

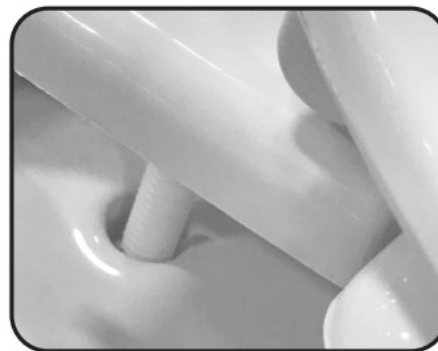
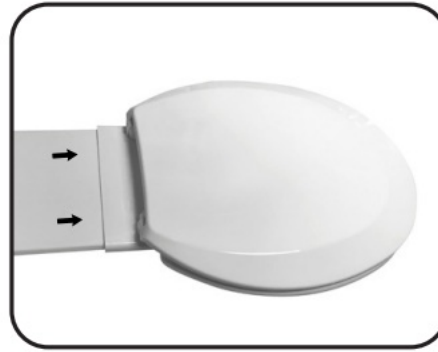
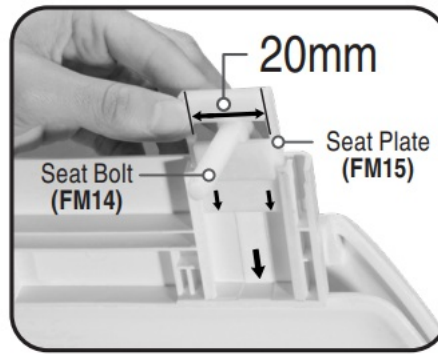

STEP 8: ATTACH / RE-SECURE LID

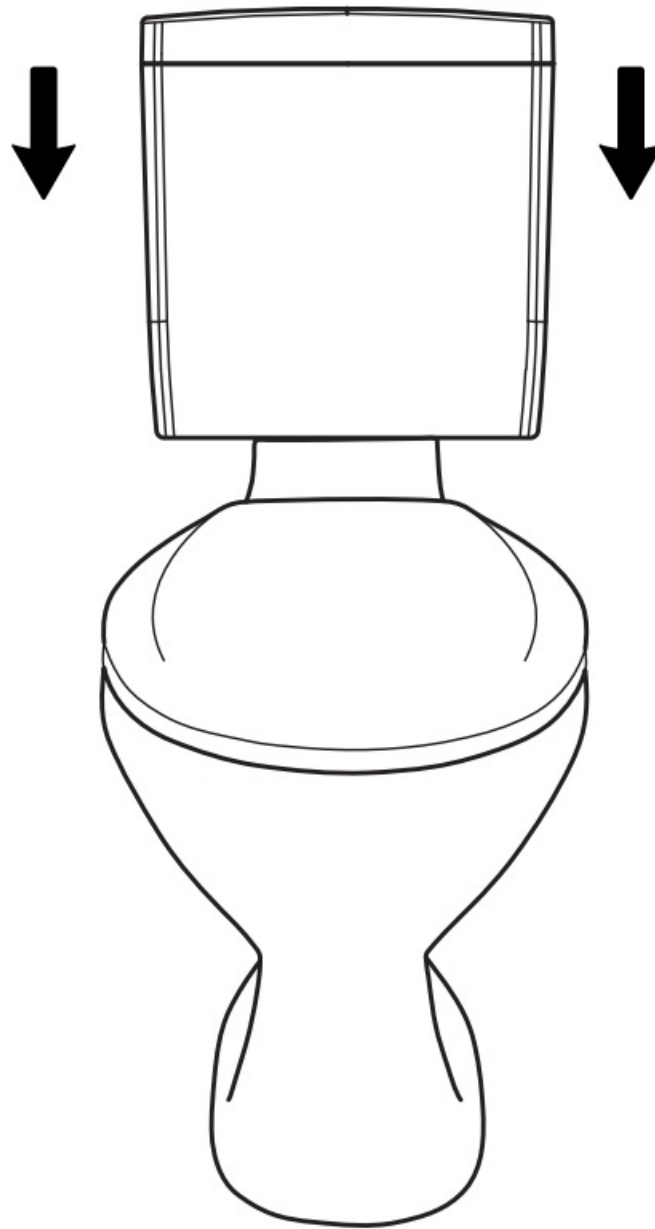

TROUBLESHOOTING

IF THE INLET VALVE:

- DOES NOT TURN ON
- WON'T TURN OFF
- WON'T REFILL TANK

VIDEO

- See Our Troubleshooting HOW-TO VIDEO <http://bit.ly/2yAdZn7>

REMOVE CAP AND CHECK FOR DEBRIS



- Turn off the water supply.
- Flush cistern.
- With the right hand push the float up, grip, and hold the haft under a float.
- With the left hand twist the cap and lever the arm counterclockwise to unlock the cap. Let the cap hang on the float cup.
- Hold the empty cup upside down over the uncapped valve to prevent splashing.
- Turn the water supply on and off a few times.
- Turn the water supply off.
- Replace the valve cap.
- Place cap assembly on top of the gray valve body by aligning cap arm and adjustment rod.
- Press down on the top cap while rotating the top & arm clockwise to the locked position.

Always use genuine Fluidmaster parts when installing or repairing. Fluidmaster will not be responsible or liable for the use of non-Fluidmaster parts during installation or repair.

WARNING

DO NOT USE IN-CISTERN DROP-IN TOILET BOWL CLEANERS CONTAINING BLEACH OR CHLORINE. Use of such products will: (1) RESULT IN DAMAGE to Cistern components and MAY CAUSE FLOODING and PROPERTY DAMAGE and (2) VOID FLUIDMASTER WARRANTY. DO NOT overtighten nuts or cistern/bowl may crack. Always use quality Fluidmaster parts when installing or repairing. Fluidmaster will not be responsible or

liable for the use of non-Fluidmaster parts during installation or repair.

WARRANTY

Our goods come with guarantees that cannot be excluded under the Australian Consumer Law. You are entitled to a replacement or refund for a major failure and compensation for any other reasonably foreseeable loss or damage.

You are also entitled to have the goods repaired or replaced if the goods fail to be of acceptable quality and the failure does not amount to a major failure. To present claims under this warranty, please contact your place of purchase or contact Fluidmaster Australia Holdings Pty Ltd. NOTE: Original proof of purchase is required.

WATERMARK SCOPE OF USE:

Warranty excludes incorrect installation. Installation shall be by AS/NZS 3500.1 and AS/NZS 3500.2 (Install with a licensed plumber; any installation processed without a licensed plumber will void warranty)

5-Year Parts Replacement / 5-Year Parts Warranty / 11-Year Labor Warranty. Suitable for indoor use on 6/3L, 4.5/3L, and 9/4.5L* pans. * Replacement cisterns only to match pre-installed pans by plumbing code AS1172.2 Table 2.1

Cistern Material: PP

Only clean with soap and warm water to maintain a quality finish. Do not use harsh chemical cleaners.

ADDITIONAL QUESTIONS?

For installation assistance, contact our technical services department.

- EMAIL, or CALL our toll-free number.
- Phone: +61 (03) 8870 2555 | Toll-Free: 1 800 931 166 IN NEW ZEALAND Call 09 415 5585
- Email: salesau@fluidmaster.com
- Website: www.Fluidmaster.com.au

Fluidmaster Australia Holdings Pty Ltd 6 / 100 New Street Ringwood, Victoria 3134 Australia

- www.Fluidmaster.com.au

Documents / Resources

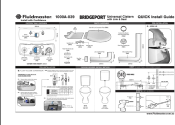
	Fluidmaster 1000A-039 Universal Cistern [pdf] Installation Guide 1000A-039, 20-0051_Grev1_1000A-039-P1_IS_P-278, 1000A-039 Universal Cistern, 1000A-039, Universal Cistern, Cistern
---	---

References

- [User Manual](#)

[Manuals+](#), [Privacy Policy](#)

This website is an independent publication and is neither affiliated with nor endorsed by any of the trademark owners. The "Bluetooth®" word mark and logos are registered trademarks owned by Bluetooth SIG, Inc. The "Wi-Fi®" word mark and logos are registered trademarks owned by the Wi-Fi Alliance. Any use of these marks on this website does not imply any affiliation with or endorsement.