



# fluentalk T1 Portable Translator User Manual

[Home](#) » [fluentalk](#) » fluentalk T1 Portable Translator User Manual 



## T1 Portable Translator User Manual

### Contents

- [1 T1 Portable Translator](#)
- [2 Get to know your translator](#)
- [3 Basic Operation](#)
- [4 Translation Functions](#)
- [5 FAQ](#)
- [6 Product Specification](#)
- [7 Documents / Resources](#)
  - [7.1 References](#)

## T1 Portable Translator

### Package List



Translator



Type-C  
Charging Cable



Slot Pin



Lanyard



User Manual

## Get to know your translator

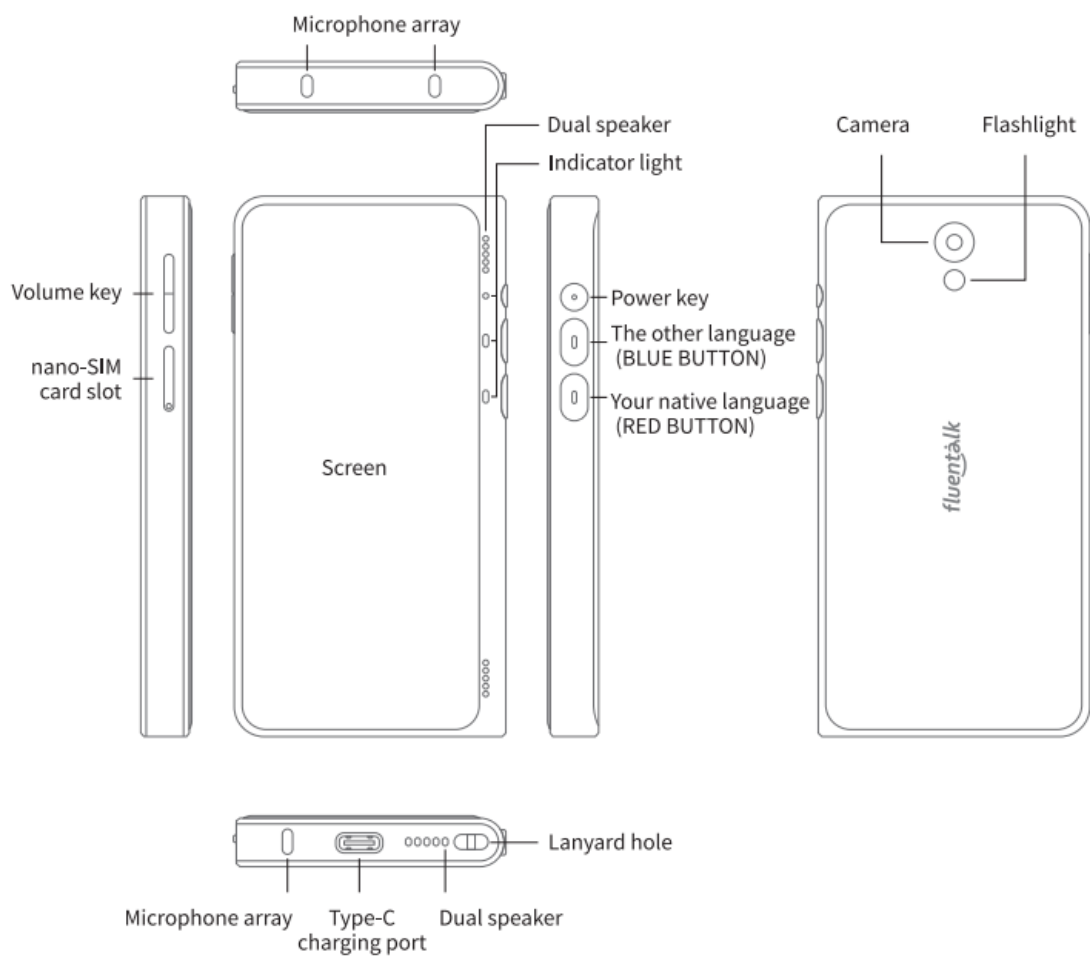

## Basic Operation

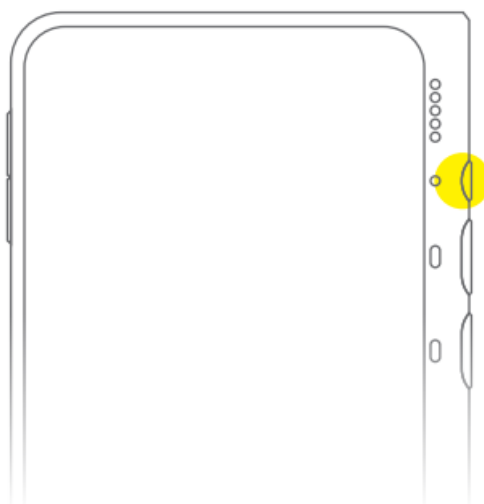

### Power on/Power off/Restart:

- Power on: press and hold the power button;
- Power off/restart: press and hold the power button to select Power Off/Restart.

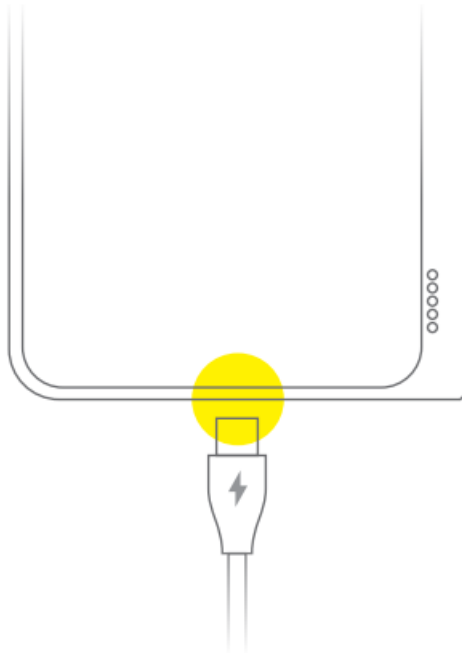

### Charging

Connect the Type-C charging cable with a standard 5V1A charger to charge the Fluently T1.

### Install nano-SIM card

1. Use the Slot Pin to eject the SIM card slot.
2. Put the nano-SIM into the card slot.

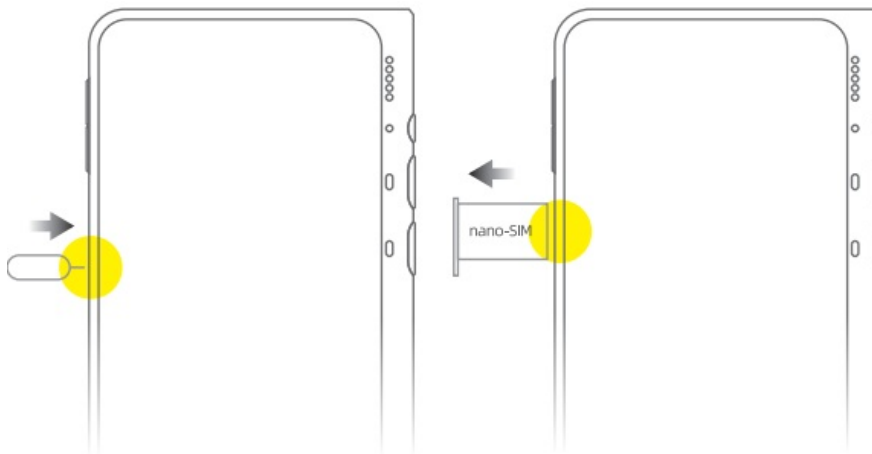

### Use WLAN hotspot

The Fluently T1 will be able to share mobile data with other devices when nano-SIM card is activated.

\*Please switch the network to your nano-SIM card in the setting after you have installed it in the card slot. [Setting – Network and Connection – Mobile Data]

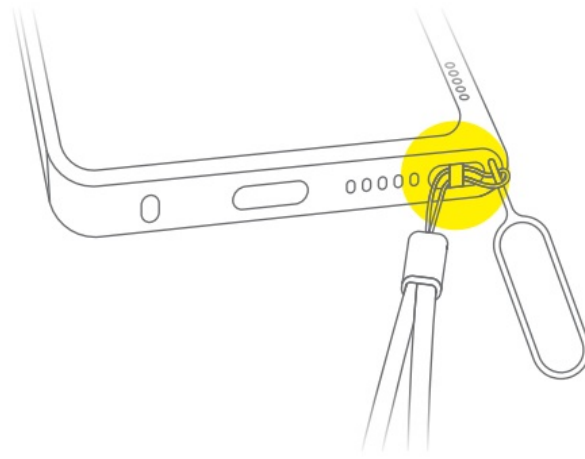

### How to use lanyard

Put one end of the lanyard through the hole, and pull the other end out from the other side with the Slot Pin.

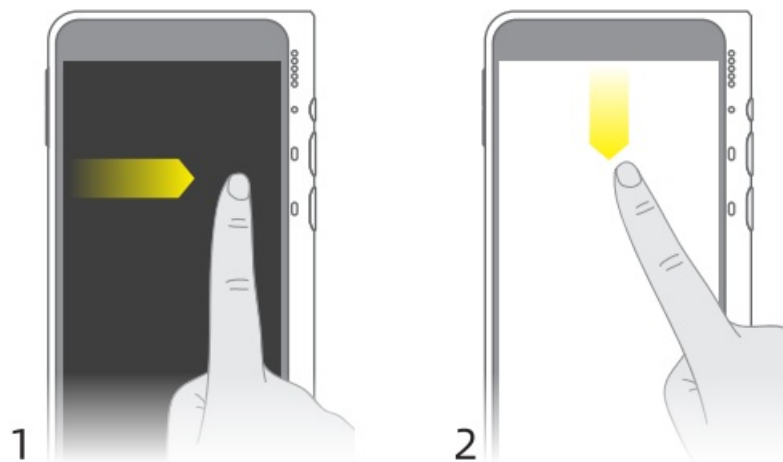

### GESTURES

1. The previous screen: Swipe right on the edge of the left-hand side of the screen to return to the previous screen;
2. Quick settings bar: Swipe down to bring up the quick setting for WiFi, transfer data, Bluetooth, and flight mode. enable Bluetooth and flight mode.

### Translation Functions

Please refer to “User Guide” for detailed information about functions. The machine’s interface is subject to modifications or updates without prior notice!

#### 1. One-Click Translation

Hold the RED button to speak your native language, and the translation will play automatically when you release. Hold the BLUE button to pick up another language from the other person, and the translation will play automatically when you release. You can select your native language and the other language on the home screen or on the translation screen.

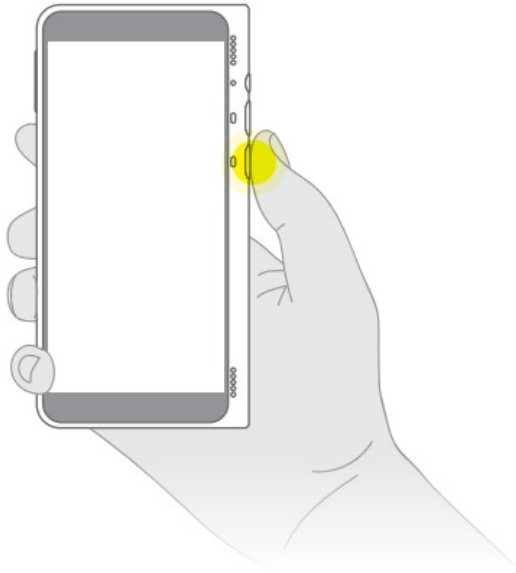

### **Rotate the screen**

You can tap the switch button on the translation screen and rotate the screen to have a side-by-side conversation in different languages.

You can tap the language button on the screen to pause the translation.

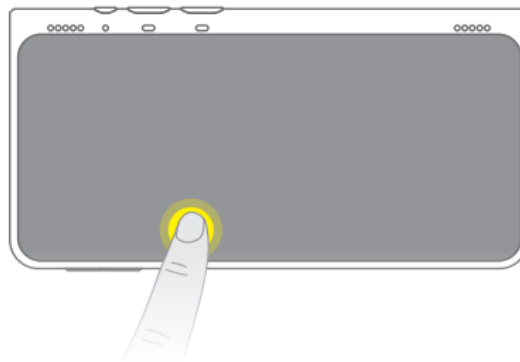

## **2. Photo Translation**

- Select the language you want to translate before taking the photo.
- Make sure the text you want to translate is clearly visible and as centered as possible.
- Tap the camera button, and Fluently TI will automatically scan and translate the text. You can turn on the flashlight if too dark.
- Tap [Save] on the upper right corner, and the translated photo will be saved in the album.

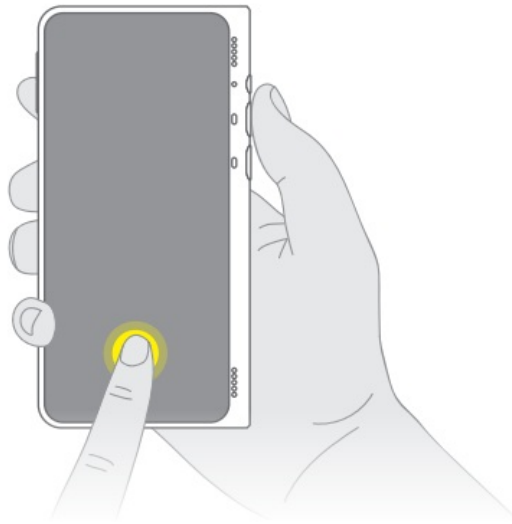

### 3. Ask for Directions Mode

Double-push the power button, and Fluently TI will automatically play the pre-configured translation you set up in advance.

You can configure the translation anytime on the [Custom] page.

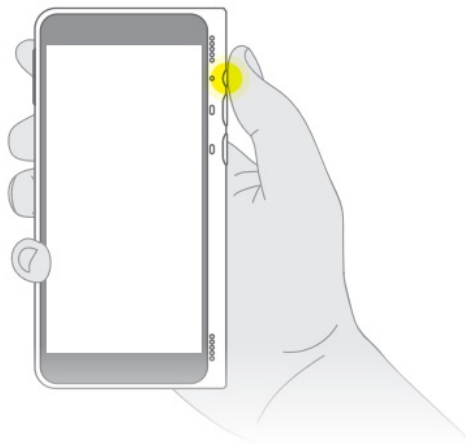

4. Listen Mode Place the Translator in front of the speaker, click [Record] to start recording and translating in real time.



### 5. Chat Translation

Select your native language and the other language, and put the Fluently TI in corresponding direction. Tap Start button to begin the translation.

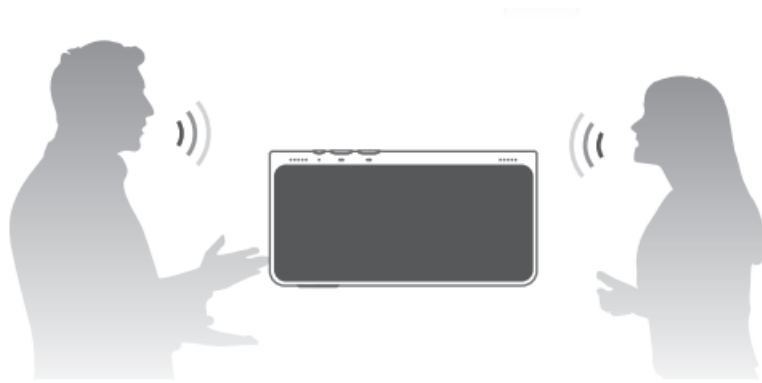

## 6. Offline Translation

You can enable or disable this function in the translation settings of any modes. Please be advised that offline language packs must be downloaded with internet connection before you can use Offline Translation.

**Notes:** Offline Translation Package could only be downloaded with Internet connection.

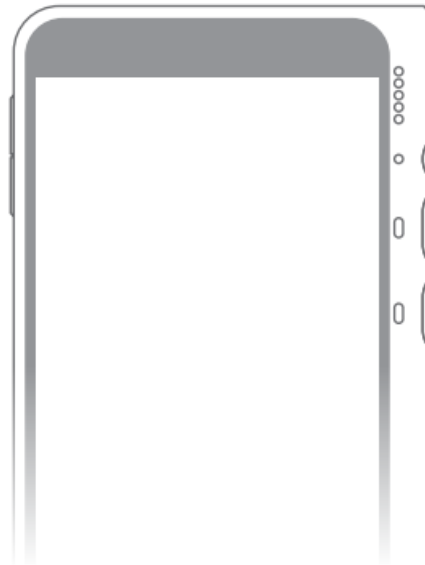

## 7. Translation setting

Tap the upper right corner of any translation functions to enter the translation setting. Speaking interval: configure the speaking interval depending on your preferred speaking speed and habits, and the translation engine will optimize the performance for you.

**Voice playback:** Fluently T1 automatically plays the translation by voice by default. To avoid disturbing others, you can disable "Voice playback".

## FAQ

or reboot Fluently T1." image-1="" headline-2="p" question-2="3. Freeze up or breakdown" answer-2="Improper use of Fluently T1 may cause it to freeze. In this case, you can hold the power button for 20 seconds to reboot Fluently T1." image-2="" headline-3="p" question-3="4. No voice playback" answer-3="You may have disabled the voice playback in the setting or the volume is too low." image-3="" headline-4="p" question-4="5. Battery runs out too fast" answer-4="If your Internet connection is unstable, Fluently T1 may have to search the Internet frequently, causing the battery to run out fast. in this case, you may switch to a stable WiFi connection." image-4="" headline-5="p" question-5="6. No mobile data after nano-SIM card is inserted" answer-5="- Check if the nano-SIM card has been inserted properly; – After checking it' s inserted properly, reboot Fluently T1; – Wait one to two minute, and check if roaming and mobile data are enabled. " image-5="" headline-6="h2" question-6="" answer-6="" image-6="" count="7" html="true" css\_class=""]

## Product Specification

Product Name: Portable Translator	Camera: 8 mega pixel
Product Model: TI	Microphone: Multiarray microphone
Size: 116.858.611.2 mm Weight: 115 g	Speaker: Dual speakers
Processor: Quad-core ARM, 12nm, up to 2.0GHz	Charging: Type-C 5V 1A
Storage: 3G (RAM), 32G (ROM)	Battery capacity: 1500 mAh
Operating system: Android 10	Communication mode: WIFI/Nano-SIM/ e-SIM (embedded)
Screen size: 4 inch Onfell Resolution: 540 1080	Network: 2G/3G/4G LTE

## Safety

Please read the following safety and warning information before using TI.

1. Do not use unofficially recommended charging methods to avoid fire, explosion, or other dangers.
  2. Do not deliberately drop, burn, penetrate, squeeze, or immerse in liquid to avoid product damages.
  3. Do not expose to high temperatures or around heating equipment such as microwaves or ovens.
  4. Use the device within the range of 0°C – 35°C and store within the range of -20°C – 45°C. If the temperature is too high or too low, it will cause the device to malfunction.
- . Time kettle is not responsible for quality issues, product failures, and safety accidents caused by the use of unofficially approved accessories.

## Corporate Information

Manufacturer: this product is authorized for manufacturing by Shenzhen Time kettle Technologies Co., Ltd.

Address: Room 612, Building 4, Minji Science Park, Xixi Road, Shenzhen, Guangdong Province, China

All rights reserved by Shenzhen Time kettle Technologies Co., Ltd.

## Warranty regulations

1. If the product and accessories have any quality issues within 1 year (unless otherwise states by local laws & regulations) and 6 months respectively from the date of purchase, you may be qualified for free repair service with proof of purchase and warranty card.
2. What is NOT covered by the warranty:
  - a. Product is worn due to regular usage.
  - b. Failure to use in accordance with the instructions.
  - c. Damage caused by human or irresistible factors.
3. Repair costs will incur for damages caused by man-made faults, beyond the warranty period, and irresistible factors.

## FCC Warning

This device complies with part 15 of the FCC Rules. Operation is subject to the following two conditions:

1. This device may not cause harmful interference, and
2. this device must accept any interference received, including interference that may cause undesired operation.

Any Changes or modifications not expressly approved by the party responsible for compliance could void the user's authority to operate the equipment.



**Note:** This equipment has been tested and found to comply with the limits for a Class B digital device, pursuant to part 15 of the FCC Rules. These limits are designed to provide reasonable protection against harmful interference in a residential installation. This equipment generates uses and can radiate radio frequency energy and, if not installed and used in accordance with the instructions, may cause harmful interference to radio communications. However, there is no guarantee that interference will not occur in a particular installation. If this equipment does cause harmful interference to radio or television reception, which can be determined by turning the equipment off and on, the user is encouraged to try to correct the interference by one or more of the following measures: - Reorient or relocate the receiving antenna. -Increase the separation between the equipment and receiver.

- Connect the equipment into an outlet on a circuit different from that to which the receiver is connected.
- Consult the dealer or an experienced radio/TV technician for help. This Portable Translator meets the government's requirements for exposure to radio waves. The guidelines are based on standards that were developed by independent scientific organizations through periodic and thorough evaluation of scientific studies. The standards include a substantial safety margin designed to assure the safety of all persons regardless of age or health.

The SAR limit of USA (FCC) is 1.6 W/kg averaged over one gram of tissue. Device types: Portable Translator (FCC D: 2A02G-T1) has also

been tested against this SAR limit. The highest SAR value reported under this standard during product certification for use at the ear is 0.573W/kg and when properly worn on the body is 1.252W/kg. This device was tested for typical body-worn operations with the back of the handset kept 10mm from the body. To maintain compliance with FCC RF exposure requirements, use accessories that maintain a 10mm separation distance between the user's body and the back of the handset. The use of belt clips, holsters and similar accessories should not contain metallic components in its assembly. The use of accessories that do not satisfy these requirements may not comply with FCC RF exposure requirements, and should be avoided.

#### **Body-worn Operation**

This device was tested for typical body-worn operations. To comply with RF exposure requirements, a minimum separation distance of 10mm must be maintained between the user's body and the handset, including the antenna.

Third-party belt-clips, holsters, and similar accessories used by this device should not contain any metallic components.

Body-worn accessories that do not meet these requirements may not comply with RF exposure requirements and should be avoided. Use only the supplied or an approved antenna.

#### **IC Warning**

This device complies with Industry Canada licenceexempt RSS standard(s). Operation is subject to the following two conditions:

1. This device may not cause interference, and
2. This device must accept any interference, including interference that may cause undesired operation of the device.

The SAR limit of USA is 1.6 W/kg averaged over one gram of tissue. Device types: Portable Translator (IC: 26483-T1) has also been tested against this SAR limit. The highest SAR value reported under this standard during product certification for use at the ear is 0.573W/kg and when properly worn on the body is 1.252W/kg. This device was tested for typical body-worn operations with the back of the handset kept 10mm from the body. To maintain compliance with IC RF exposure requirements, use accessories that maintain a 10mm separation distance between the user's body and the back of the handset. The use of belt clips, holsters and similar accessories should not contain metallic components in its assembly. The use of accessories that do not satisfy these requirements may not comply with IC RF exposure requirements, and should be avoided.

#### **Body-worn Operation**

This device was tested for typical body-worn operations. To comply with RF exposure requirements, a minimum separation distance of 10mm must be maintained between the user's body and the handset, including the antenna.

Third-party belt-clips, holsters, and similar accessories used by this device should not contain any metallic

components.  
Body-worn accessories that do not meet these requirements may not comply with RF exposure requirements and should be avoided. Use only the supplied or an approved antenna.  
Operations in the S.I 5-5.2SGHz band are restricted to indoor usage only.

**Contact US**  
TEL: +1(833) 491-1328 Support:  
Official Website:  [www.fluentalk.com](http://www.fluentalk.com)  
Customer Service:  [support@fluentalk.com](mailto:support@fluentalk.com)

**Documents / Resources**

  <small>Connect to your device via Bluetooth or USB for best results</small>	<a href="#">fluentalk T1 Protable Translator</a> [pdf] User Manual T1 Protable Translator, T1, Protable Translator, Translator
--	---

**References**

- [User Manual](#)