



FLUANCE Ai61 Powered 6.5" Bookshelf Speakers User Guide

[Home](#) » [FLUANCE](#) » FLUANCE Ai61 Powered 6.5" Bookshelf Speakers User Guide 

FLUANCE[®]

Ai61 – Powered 6.5" Bookshelf Speakers
Quick Start Guide v1.0



Contents

- 1 Important Safety Instructions
- 2 Introduction
- 3 Break-in Period
- 4 What's Included
- 5 Front & Back Panel Layout
- 6 Product Setup
 - 6.1 EQ Adjustment
 - 6.2 RCA Input
 - 6.3 Bluetooth® Pairing
 - 6.4 Optical Input
 - 6.5 USB Input
 - 6.6 Subwoofer Output
 - 6.7 Frequently Asked Questions
 - 6.8 Certification Information
 - 6.8.1 FCC Statement
 - 6.9 Warranty Information
- 7 Documents / Resources
 - 7.1 References
- 8 Related Posts

Important Safety Instructions

1. Read these instructions.
 2. Keep these instructions.
 3. Heed all warnings.
 4. Follow all instructions.
 5. Do not use this apparatus near water.
 6. Clean only with dry cloth.
 7. Do not block any ventilation openings. Install in accordance with the manufacturer's instructions.
 8. Do not install near any heat sources such as radiators, heat registers, stoves, or other apparatus (including amplifiers) that produce heat.
 9. Do not defeat the safety purpose of the polarized or grounding-type plug. A polarized plug has two blades with one wider than the other. A grounding-type plug has two blades and a third grounding prong. The wide blade or the third prong are provided for your safety. If the provided plug does not fit into your outlet, consult an electrician for replacement of the obsolete outlet.
 10. Protect the power cord from being walked on or pinched particularly at plugs, convenience receptacles, and the point where they exit from the apparatus.
 11. Only use attachments/accessories specified by the manufacturer.
-
12. Use only with the cart, stand, tripod, bracket, or table specified by the manufacturer, or sold with the apparatus. When a cart is used, use caution when moving the cart/ apparatus combination to avoid injury from tip-over.
 13. Unplug this apparatus during lightning storms or when unused for long periods of time.
 14. Refer all servicing to qualified service personnel. Servicing is required when the apparatus has been damaged in any way, such as power supply cord or plug is damaged, liquid has been spilled or objects have fallen into the apparatus, the apparatus has been exposed to rain or moisture, does not operate normally, or has been dropped.

15. The use of apparatus in moderate climates.

CAUTION

- Minimum 5cm around the apparatus for sufficient ventilation.
- The ventilation should not be impeded by covering the ventilation openings with items, such as newspapers, tablecloths, curtains, etc.
- No naked flame sources, such as lighted candles, should be placed on the apparatus.
- Should be drawn to the environmental aspects of the battery disposal.
- To reduce the risk of fire or electric shock, do not expose this apparatus to rain or moisture.
- The battery shall not be exposed to excessive heat such as sunshine, fire, or the like.
- The mains plug or an appliance coupler is used as the disconnect device, the disconnect device shall remain readily operable.

Introduction

Thank you for the purchase of your Fluance product. We hope you enjoy your experience. If you have any questions please visit us at www.Fluance.com/support.

Fluance believes everyone should experience audio in its truest form, recreating the performance the way the artist intended. Utilizing only superior components and expert audio engineering, their products are a testament to the performance that can be achieved when a passion for music takes center stage. The perfect complement to any audiophile's lifestyle, you'll be enjoying live performances in your home for years to come.

Break-in Period

Our speakers have a Butyl rubber ring surrounding the cone. The break-in period allows the rubber to loosen and stretch, allowing the cone a larger range of movement, resulting in better sound reproduction. We recommend 10-12 hours of play at a moderate volume to achieve this.

For additional product information, please consult the manual at: Fluance.com/resources

What's Included

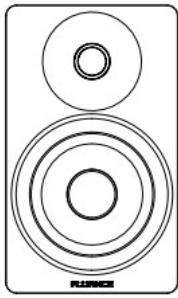

Ai61 Passive
Speaker
(Left Channel)

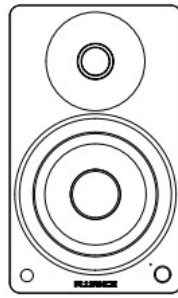

Ai61 Active
Speaker
(Right Channel)

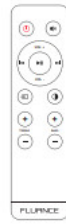

Remote
Control



2 'AAA'
Batteries

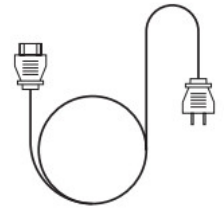

Power
Cable



Speaker
Wire

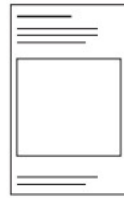

Quick Start
Guide



Lifetime
Customer Support

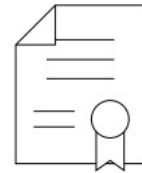

2 Year
Warranty

Front & Back Panel Layout

Active Speaker

Passive Speaker

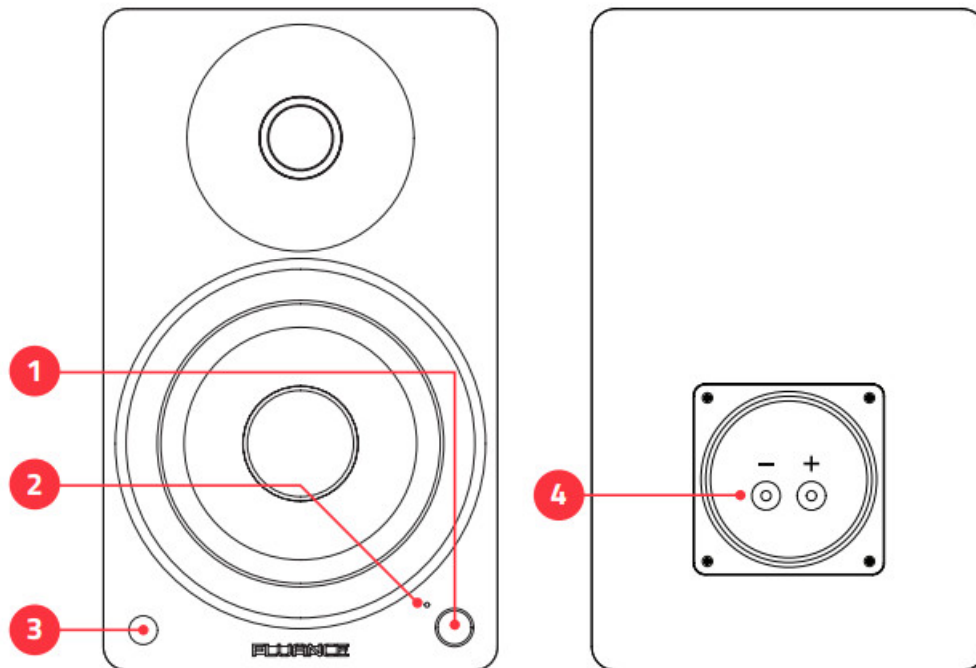

1. Control Knob
 - Volume
 - Input Selection
 - Power ON/OFF
2. Source LED
 - Blue (Solid) – Bluetooth Paired
 - Blue (Flashing) – Bluetooth® Pairing Mode

- Green (Solid) – RCA
- White (Solid) – Optical
- Purple (Solid) – USB
- Red (Solid) – Standby Mode
- Red (Flashing) – Mute
- Red (Flash x2) – Volume Set to Max
- Red (Flash x2) – Bass/Treb Set to -5 or +5
- Source Color: Blue/Green/White/Purple (Flash x2) – Bass/Treb Set to 0

Active Speaker (Back)

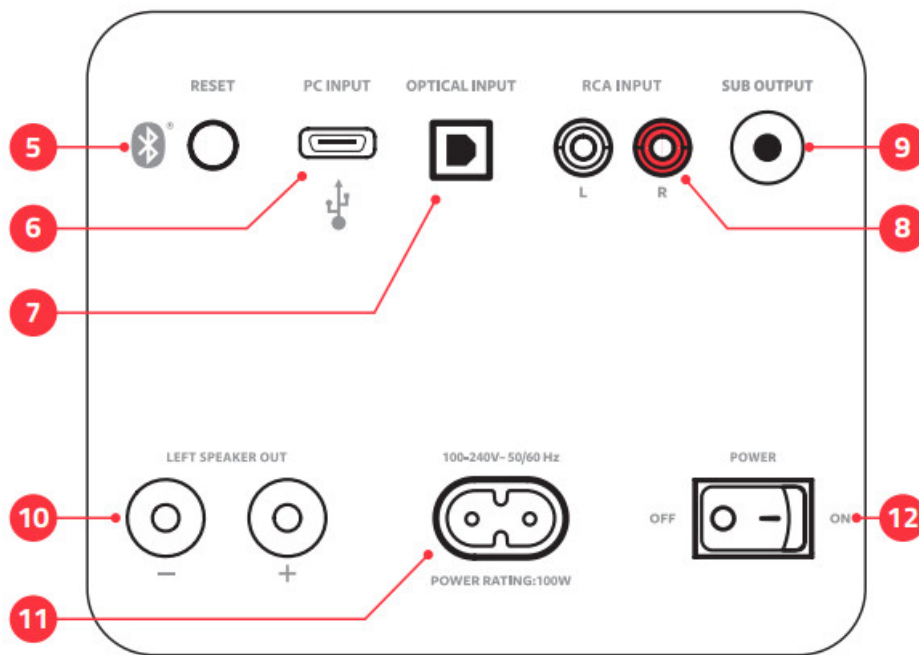

3. IR Sensor
4. Speaker Input
5. Bluetooth® Reset Pairing
6. USB Input (Audio Playback Only)
7. Optical Input
8. RCA Input
9. Subwoofer Output
10. Left Speaker Output
11. AC Input
12. Power Switch

Remote Control Layout

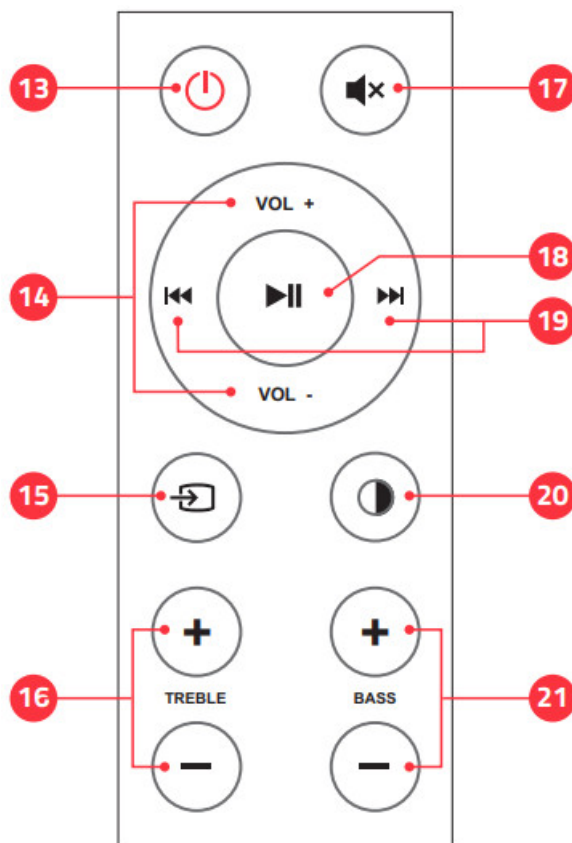

- 13. Power ON/OFF
- 14. Volume UP/DOWN
- 15. Source
- 16. Treble UP/DOWN
- 17. Mute
- 18. Play/Pause & Bluetooth® Pairing Reset* *To enable Bluetooth® Pairing Reset, press + hold for 3 seconds.
- 19. Forward/Back
- 20. LED Brightness – (100% > 25% > OFF)
- 21. Bass UP/DOWN

Product Setup

1. Position the speakers with the Active Speaker on the right and the Passive Speaker on the left.

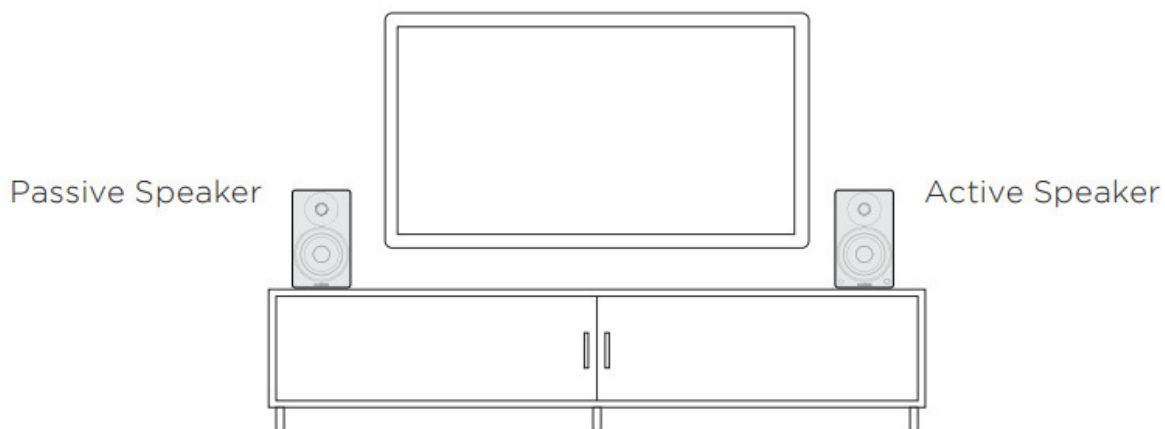

NOTE: If placing the speakers in a cabinet or on a shelf, position the front of the speakers as close as possible to the front edge of the shelf for optimum audio performance.

2. Connect one end of the speaker wire to the binding posts on the back of the Active Speaker and connect the other end of the speaker wire to the binding posts on the back of the Passive Speaker.

IMPORTANT: Ensure the same wire is connected to the same color binding post on each speaker.

NOTE: The included speaker wire is 8ft. If placing your speakers further than 8ft apart it is recommended to use a standard 18 gauge speaker wire to connect the speakers over a longer distance.

3. Connect the power cable to the back of the Active Speaker and set the power switch to the ON position.

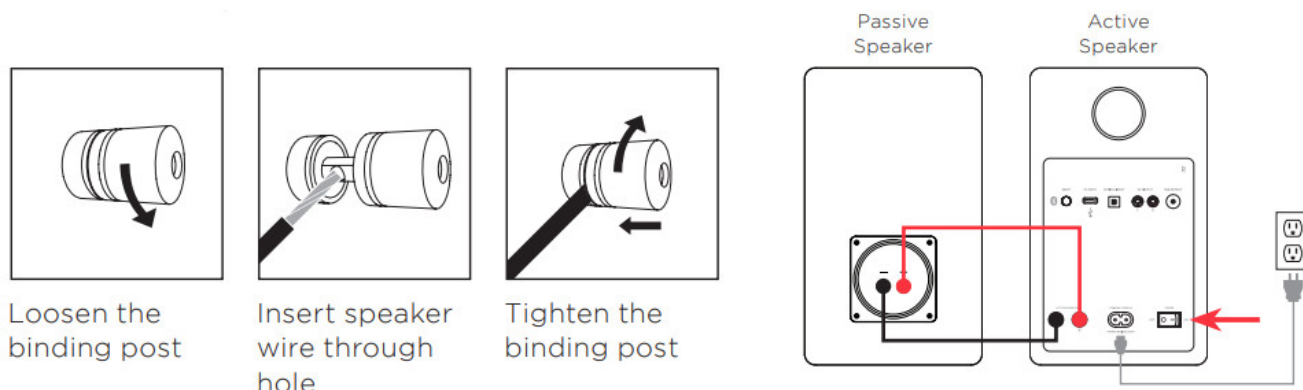

EQ Adjustment

Use the Bass/Treble buttons on the Remote to adjust each from -5 to +5.

LED Behavior:



Red (Flash 2x) – Bass/Treble Set to -5 or +5



Source Color (Flash 2x) – Bass/Treble Set to 0

Note: If using a source device, with its own EQ settings, ensure it is set to flat(0).

RCA Input

1. Connect the RCA cable to your source device (Turntable, Smartphone, Computer...).
2. Connect the other end of the RCA cable to the back of the Active Speaker.

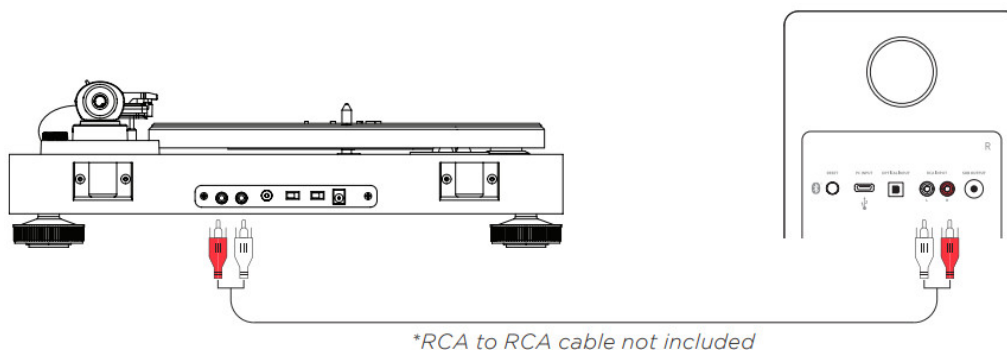

3. Press the Control Knob to select the RCA input (Green LED).

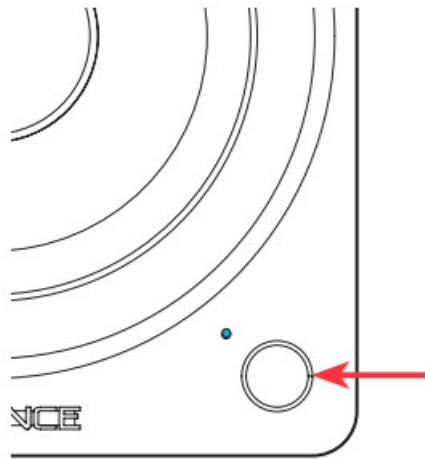

4. Adjust the volume on Ai61 as well as the source device.

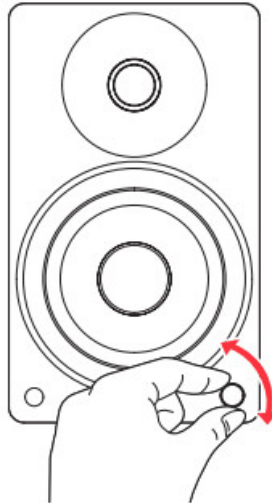

Bluetooth® Pairing

1. Press the Control Knob to select the Bluetooth® input (Blue LED).

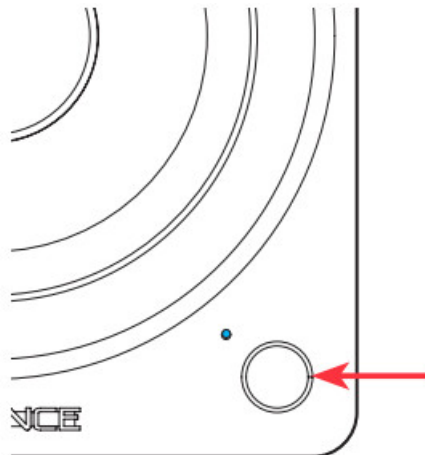

2. Pair to "Fluance Ai61" on your source device.

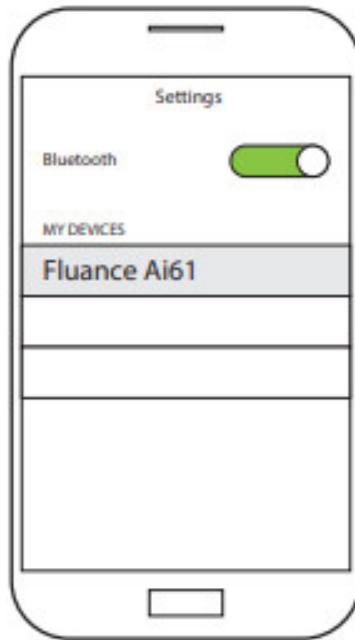

Note: Unit will attempt to auto-pair to the last paired device.

3. Use the Remote to control playback on your source device.

Note: Adjust Volume on the source device as well as the Ai61.

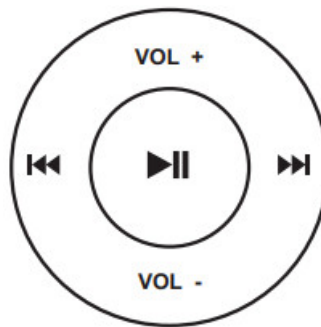

4. If your device cannot find "FluanceAi61", you can reset Bluetooth® pairing.

- Press and hold ►|| on to the Remote for 3 seconds to reset Bluetooth® pairing.



- Press the Bluetooth® Pairing Reset Button on the back of the unit.

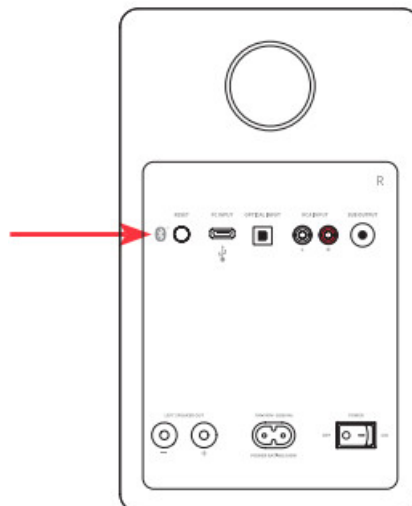

Note: How you access your device's Bluetooth® settings may vary from one manufacturer to another. The

maximum line of sight for Bluetooth® range is 33ft. Obstacles may decrease transmission distance.

Optical Input

1. Connect the Optical cable to your source device (TV, Computer, Game Console...).
Ensure protective caps are removed from the ends of the Optical cable.
2. Connect the other end of the Optical cable to the back of the Active Speaker.

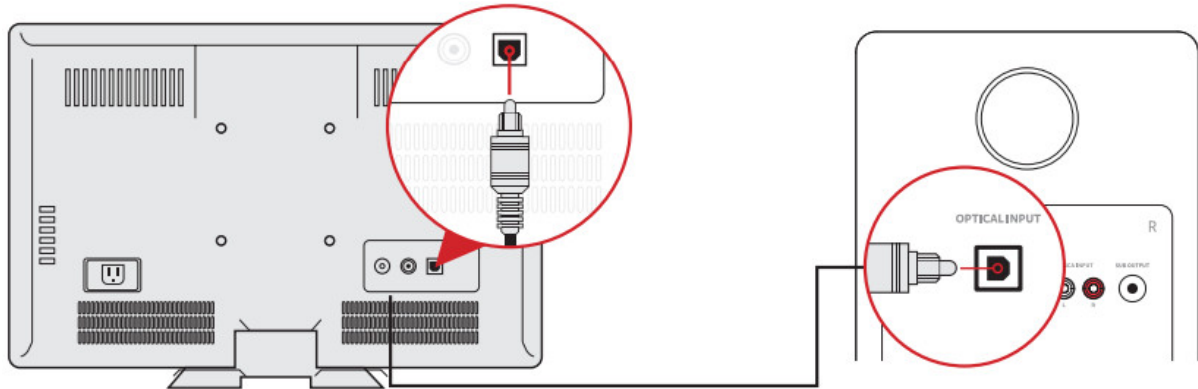

**Optical cable not included*

3. Press the Control Knob to select the Optical Input (White LED).

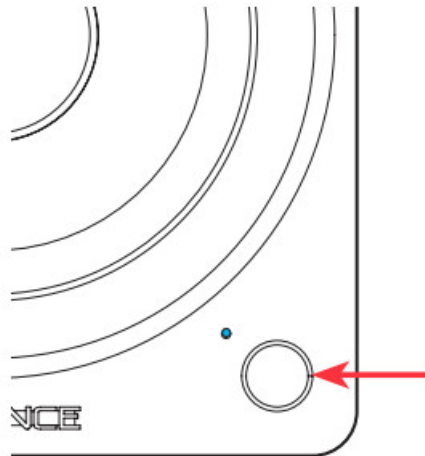

4. Adjust the volume on Ai61 as well as the source device.

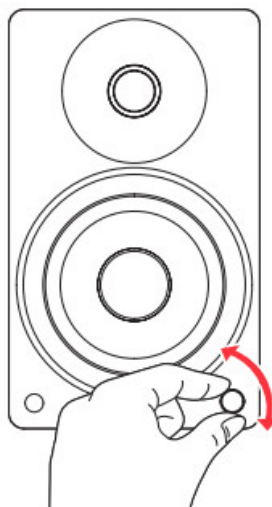

Optical Audio Signal Compatibility

The Ai61 does not support Dolby Digital Audio or DTS Audio. Locate the audio output settings on your source device and ensure Dolby Digital is turned off. The correct audio output setting is commonly referred to as PCM or Stereo.

Some TVs also require that audio output be enabled. This setting may be referred to as External Speakers. Ensure this is selected as your speaker/audio output. For instructions on a specific device, please consult the device's user manual.

USB Input

1. Connect the USB cable to your source device (Laptop, Desktop...).
2. Connect the other end of the USB cable to the Micro USB port on the back of the Active Speaker.

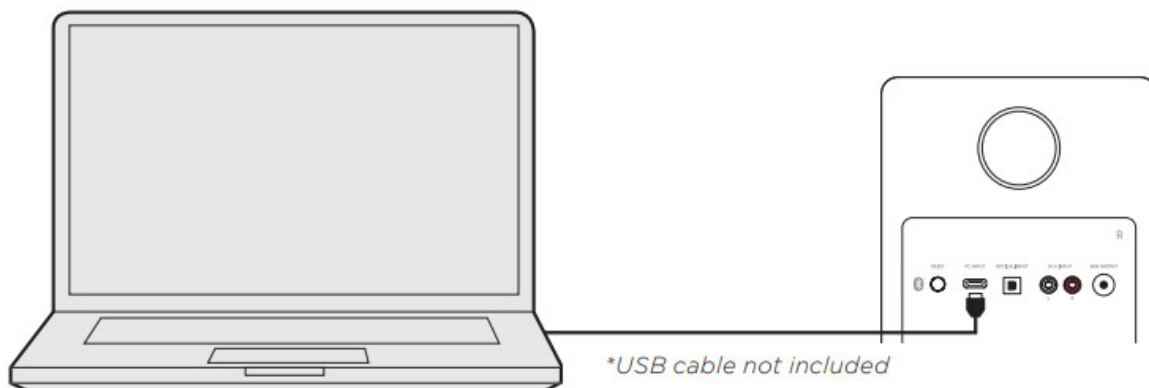

IMPORTANT: The USB input on the Ai61 is for USB audio playback and not for USB charging.

3. Press the Control Knob to select the USB Input (Purple LED).

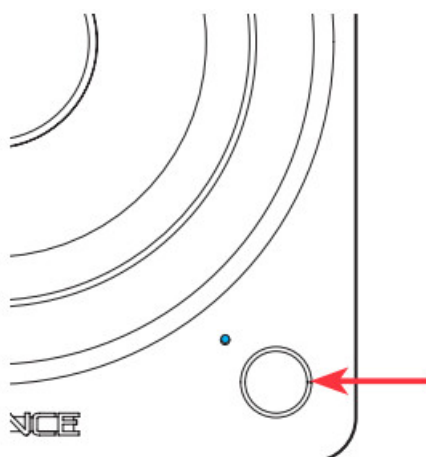

4. Adjust the volume on Ai61 as well as the source device. You may also need to adjust the volume in the different programs on the source device.

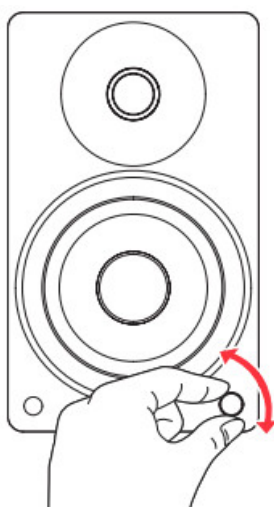

USB Audio Output Settings

You may need to enable USB audio output on your source device. Here are the directions for most Windows

Computers.

Windows® and Apple® : Control Panel > Sound > USB Audio

Apple®: System Preferences > Sound > Output > USB

It is also important to check that any sound enhancements, effects, or EQ settings are disabled® on your source device.

Subwoofer Output

IMPORTANT: When a subwoofer cable is connected, the Ai61 will automatically cut frequencies below 80Hz to optimize performance. The subwoofer cable must be removed to resume full frequency playback.

1. Connect the Subwoofer cable to your powered subwoofer.
2. Connect the other end of the Subwoofer cable to the back of the Active Speaker.
3. Adjust the volume on the Subwoofer for the best listening experience.

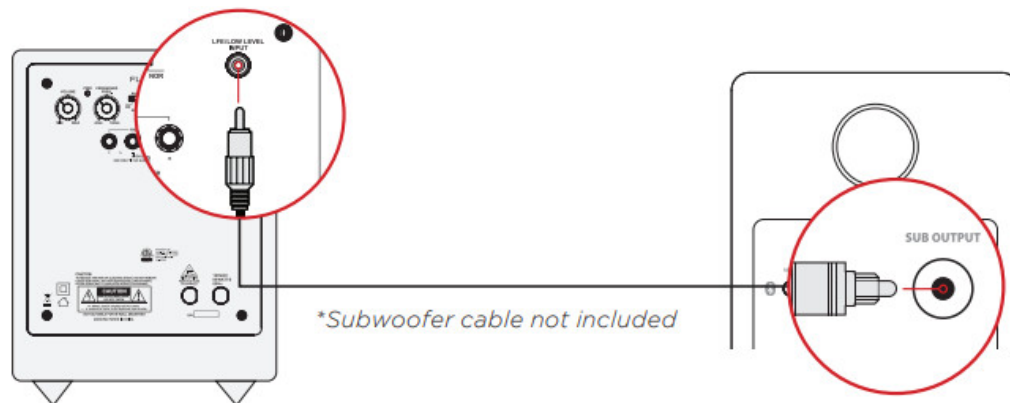

Fluance offers matching subwoofers for the ultimate audio experience. For more information visit:

www.Fluance.com/subwoofer.

Frequently Asked Questions

What is “auto-pairing” and how does it work?

Auto-pairing is a convenient connection feature included in all Fluance Bluetooth®Speakers.

If the connected Bluetooth® -enabled device leaves the connection range of the Ai61 and returns at a later time, the device will automatically connect. If the device’s Bluetooth® function is disabled and then enabled at a later time, the device will automatically connect well.

***Note:** The Fluance Ai61 will only auto-pair to the last device that it was connected to.

Another device is connected to my Fluance Ai61 and I want to connect my device.

You can reset any Bluetooth® connection by pressing the Bluetooth® Pairing Reset button on the back of the Active Speaker. You can also press and hold “Play/Pause” on the Remote for 3 seconds.

How can I increase the volume when using the Ai61 with a turntable?

If turntable audio is too quiet you may need to add a preamplifier. Some turntables have built-in preamps which can be turned on or off. The Fluance PA10 preamplifier is a great match for Fluance powered speakers and turntables.

Why is the volume from each input different on the Ai61?

Ensure that any volume and EQ settings on your source devices are set to similar levels. The different signal types used by each input mean they are processed differently by the Ai61. The Optical Input uses a digital signal while the RCA Input uses an analog signal. These differences can result in slight variances in the output volume of the Ai61.

Certification Information

FCC Statement

This equipment has been tested and found to comply with the limits for a Class B digital device, pursuant to Part 15 of the FCC Rules. These limits are designed to provide reasonable protection against harmful interference in a residential installation. This equipment generates uses and can radiate radio frequency energy and, if not installed and used in accordance with the instructions, may cause harmful interference to radio communications. However, there is no guarantee that interference will not occur in a particular installation. If this equipment does cause harmful interference to radio or television reception, which can be determined by turning the equipment off and on, the user is encouraged to try to correct the interference by one or more of the following measures:

- Reorient or relocate the receiving antenna.
- Increase the separation between the equipment and receiver.
- Connect the equipment into an outlet on a circuit different from that to which the receiver is connected.
- Consult the dealer or an experienced radio/TV technician for help.

This device complies with part 15 of the FCC Rules. Operation is subject to the following two conditions:(1) This device may not cause harmful interference, and (2) this device must accept any interference received, including interference that may cause undesired operation.

Changes or modifications not expressly approved by the party responsible for compliance could void the user's authority to operate the equipment. This equipment complies with FCC radiation exposure limits set forth for an uncontrolled environment. This equipment should be installed and operated with a minimum distance of 20cm between the radiator & your body.

The device has been evaluated to meet general RF exposure requirements. The device can be used in portable exposure conditions without restriction.

IC Warning

This device complies with Industry Canada license-exempt RSS standard(s).

Operation is subject to the following two conditions:

(1) This device may not cause interference, and (2) This device must accept any interference, including interference that may cause undesired operation of the device.

Changes or modifications not expressly approved by the party responsible for compliance could void the user's authority to operate the equipment. This equipment complies with IC radiation exposure limits set forth for an uncontrolled environment. This equipment should be installed and operated with a minimum distance of 20cm between the radiator & your body. This transmitter must not be co-located or operating in conjunction with any other antenna or transmitter.

Warranty Information

Fluance gives the following warranty to the original customer of each new Fluance product purchased from a dealer authorized by Fluance. Fluance warrants that each new product, under normal use, is free from defects, subject to the terms and conditions set forth. If a defect should occur within the warranty period, repairs will be made free of charge for parts and labor when such defects are determined by us to be attributable to faulty materials or workmanship at the time of manufacture.

Warranty Period

The Fluance products listed below are warranted for parts and labor for the stated period from the date of original purchase and are subject to the terms and conditions of the warranty.

Home Audio Passive Speakers: Lifetime Warranty

Active/Powered Speakers: 2 Year Warranty

Warranty Exclusions

- Products purchased from a dealer not authorized by Fluance.
- Products with the serial number defaced, altered or missing.
- Defects resulting from disaster, accident, abuse, misuse, lightning, power surges, neglect, unauthorized modification or water damage.
- Defects or damage as a result of repairs performed by a person or party not authorized by Fluance.
- Defects or damage occurring during shipping (claims should be made with the shipping company).
- Defect or damage as a result of connecting a product to an outlet with the incorrect voltage. Voltage converters must be used where applicable.

To Obtain Warranty Service

Should your Fluance product require warranty service, please contact your Fluance Authorized Dealer and send your product fully insured and freight prepaid to the nearest Fluance authorized service center. Before sending to Fluance, you will be required to get a Return Authorization Number from your dealer.

Products shipped without a valid Return Authorization Number will be refused. To avoid possible shipping damage, make sure the product is properly packaged and well protected. Include a copy of your original bill of sale as proof of warranty along with your name, home and/or work telephone number(s), a complete return address, and a detailed description of the faults.

Products repaired within warranty will be returned freight prepaid. This warranty in itself is not considered a valid proof of purchase. When applying for warranty repairs, you must present the original copy of your bill of sale as proof of warranty.

Thank you for your purchase of this Fluance® product.

We hope you enjoy your experience.

Questions?

Give us a chance to help, we're just a click away.



[Fluance.com/resources](https://fluance.com/resources)



[Fluance.com/support](https://fluance.com/support)



[Fluance.com/videos](https://fluance.com/videos)









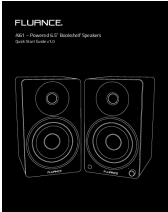
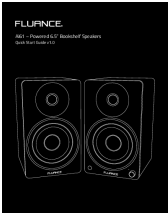
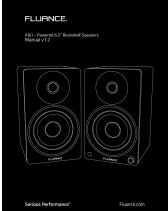



[Fluance.com/contact](https://fluance.com/contact)

Don't forget to register your product with us!

[Fluance.com/registration](https://fluance.com/registration)

	<p>FLUANCE Ai61 Powered 6.5” Bookshelf Speakers [pdf] User Guide Ai61, Powered 6.5 Bookshelf Speakers</p>
	<p>FLUANCE Ai61 Powered 6.5 Bookshelf Speakers [pdf] User Manual Ai61 Powered 6.5 Bookshelf Speakers, Bookshelf Speakers</p>
	<p>FLUANCE Ai61 Powered 6.5 Bookshelf Speakers [pdf] User Manual Ai61 Powered 6.5 Bookshelf Speakers, Ai61, Powered 6.5 Bookshelf Speakers, 6.5 Bookshelf Speakers, Bookshelf Speakers, Speakers</p>

References

-  [Turntables, Home Theater Surround Sound Speaker Systems and Home Audio Products | Fluance](#)
-  [Fluance Support Center](#)
-  [Register your product | Fluance](#)
-  [Fluance](#)
-  [Powered Subwoofers | Fluance](#)
-  [Fluance Support Center](#)
-  [Fluance Support Center](#)
-  [Turntables, Home Theater Surround Sound Speaker Systems and Home Audio Products | Fluance](#)
-  [Powered Subwoofers | Fluance](#)
-  [Fluance Support Center](#)