

FLTCAL FLN-MSTR-EGV1 FlowlineMaster with Edge V1 Stabilization Arm



FLTCAL FLN-MSTR-EGV1 Flowline Master with Edge V1 Stabilization Arm Instruction Manual

[Home](#) » [FLTCAL](#) » FLTCAL FLN-MSTR-EGV1 Flowline Master with Edge V1 Stabilization Arm Instruction Manual



Contents

- [1 FLTCAL FLN-MSTR-EGV1 Flowline Master with Edge V1 Stabilization Arm](#)
- [2 Product Information](#)
- [3 Product Usage Instructions](#)
- [4 What's In The Box](#)
- [5 Flowline Master with Edge Setup](#)
- [6 180° Rotation](#)
- [7 Low/ High Angle Shots](#)
- [8 Adjust Camera Setup Position](#)
- [9 Warranty:](#)
- [10 Documents / Resources](#)
 - [10.1 References](#)

FLTCAL

FLTCAL FLN-MSTR-EGV1 Flowline Master with Edge V1 Stabilization Arm



Product Information

Specifications

- Model: Flowline Master with Edge V1 Stabilization Arm (FLN-MSTR-EGV1)
- Features: Foldable design, height riser, lockable hook, tension adjustment knob
- Compatible with: Flowline Body Worn Systems (Basic flowline hanger, master flowline hanger, and N series hanger – 300N, 400N & 500N)

What's In The Box

- Camera Hook
- Support Bar
- Edge V1 Stabilization Arm
- Height Riser
- Side Support Adjustment
- Balance Adjustment Knob
- Flycam Flowline Master
- 2 x Washers
- 2 x Velcro
- 2mm Allen Key
- 2.5mm Allen Key

Product Usage Instructions

Assembly

1. Inspect the contents of the package to ensure everything is included.
2. Attach the Camera Hook to the Support Bar using the provided Allen Keys.
3. Connect the Edge V1 Stabilization Arm to the Support Bar.
4. Attach the Height Riser to the Stabilization Arm to extend its height if needed.
5. Adjust the Side Support according to your preference.
6. Use the Balance Adjustment Knob to achieve proper balance.
7. Attach the Flycam Flowline Master to your desired Flowline Body Worn System using the appropriate hanger.
8. Secure the components with the provided washers and Velcro.

Low/High Angle Shots

To capture low-angle shots, adjust the camera setup position downwards. For high-angle shots, adjust the camera setup position upwards.

Adjust Camera Setup Position:

Use the adjustable sliding knob to modify the support rope's position based on your filming needs.

Folding and Storage

The Flowline Edge features a foldable design, making it easier to store when not in use. Simply fold the arm and secure it in place.

FAQ (Frequently Asked Questions):

- **Q:** What cameras can be used with the Flowline Master with Edge V1 Stabilization Arm?
- **A:** The Flowline Master with Edge V1 Stabilization Arm can be used with any camera, gimbal, or cage that can be securely attached using the lockable hook.
- **Q:** Can the height of the Stabilization Arm be adjusted?
- **A:** Yes, the Stabilization Arm comes with a height riser that offers up to 4 inches of vertical extension for taller operators.
- **Q:** How do I achieve proper balance with my rig?
- **A:** Use the Balance Adjustment Knob to adjust the tension according to your rig's weight until it is properly balanced.
- **Q:** Which Flowline Body Worn Systems are compatible with the Flowline Master with Edge V1 Stabilization Arm?
- **A:** The Flowline Master with Edge V1 Stabilization Arm is compatible with a Basic flowline hanger, master flowline hanger, and N series hanger (300N, 400N & 500N).

What's In The Box

Please inspect the contents of your shipped package to ensure you have received everything that is listed below.



All rights reserved. No part of this document may be reproduced, stored in a retrieval system, or transmitted by any form or by any means, electronic, mechanical, photocopying, recording, or otherwise, except as may be expressly permitted by the applicable copyright statutes or in writing by the Publisher.

Flowline Master with Edge Setup

- Loosen the screw of the Camera Hook attached to the Flowline Support Arm using the Allen key.



- Similarly, remove the second screw.
- Now, remove the Hook from the Flowline Support Arm.



- As shown in the image, take the Cord bundle out from the Cup and pull the Cord until a Cord lock comes out.



- Separate the Cord and the Cord lock.
- Keep the lock aside to re-attach it later.

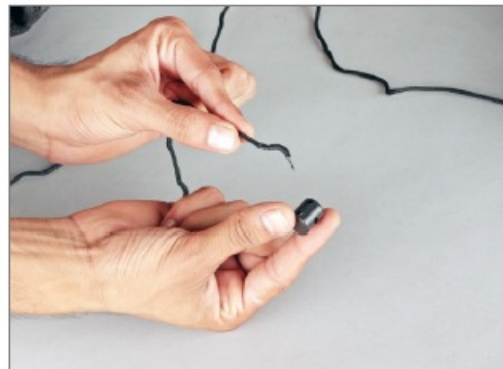
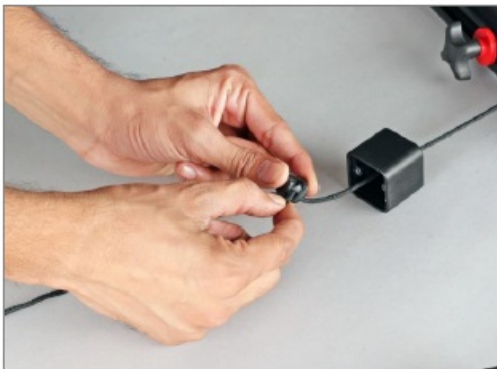

- Similarly, separate the Cord from the Cup to mount it back later.



- To detach the Flowline Support Rod, pull it upwards.



- Disassemble the Camera Hook and the Support Rod from the Vest.



- To detach the extension from the Support Rod of the Vest, remove its screw using a screwdriver.



- Detach the extension from the Support Rod and align the cord with the height riser, as shown in the image.



- Attach the extension with the height riser and push it inside.

Feature: Height riser that offers up to 4" of vertical extension for taller operators and a lockable hook to secure any camera, gimbal, or cage effortlessly.



- Insert a screw in the Support rod and tighten it using the screwdriver.



- Similarly, tighten the top screw using the screwdriver.
- Loosen the knob of the Flowline Edge.



- After loosening the knob, remove it and pull the rod of Flowline Edge to open it.

Feature: The Foldable Design of Flowline Edge makes it easier to store.



- After opening the Rod, insert the knob and properly tighten it, as shown in the image.

Feature: Tension adjustment knob to match your rig's weight, while the adaptable sliding knob adjusts the support rope to your unique filming needs.



- Insert the cord of the Flowline vest in the Flowline Edge.



- After inserting the cord in the Edge, pull the cord from the side of the Rod.



- Properly attach the Edge to the flowline vest.

Feature: It attaches to your Flowline Body Worn Systems like Basic flowline hanger, master flowline hanger, and N series hanger (300N, 400N & 500N) to provide Smooth Floating Shots with utmost comfort.

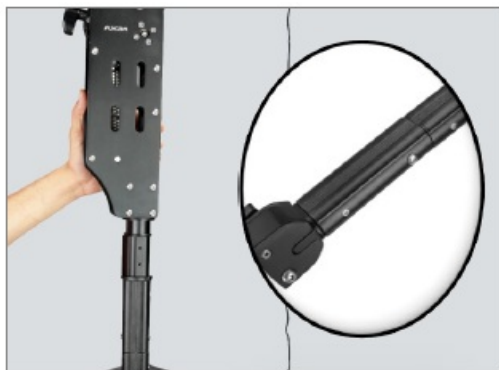

- Insert the cord into the cup and pull it out.

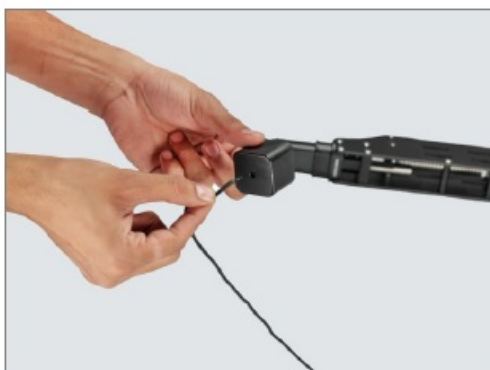

- After inserting the cord in the Cup, pull it outwards and insert it in the Cord Lock.

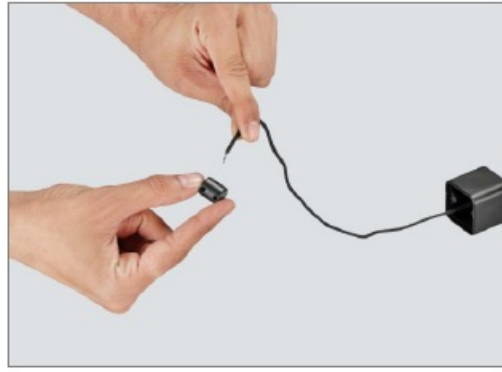

- After inserting it into the Cup, tie it properly with the Cord Lock.

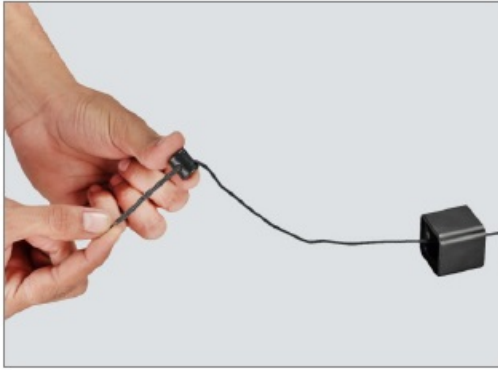

- Attach the Camera Hook to the Cup.



- Insert the screw into the Camera Hook and secure it properly using an Allen key.
- The Flowline Edge is fully assembled with the Stabilization Arm. The versatile belt system moulds to fit all body types.



180° Rotation



Low/ High Angle Shots



Adjust Camera Setup Position

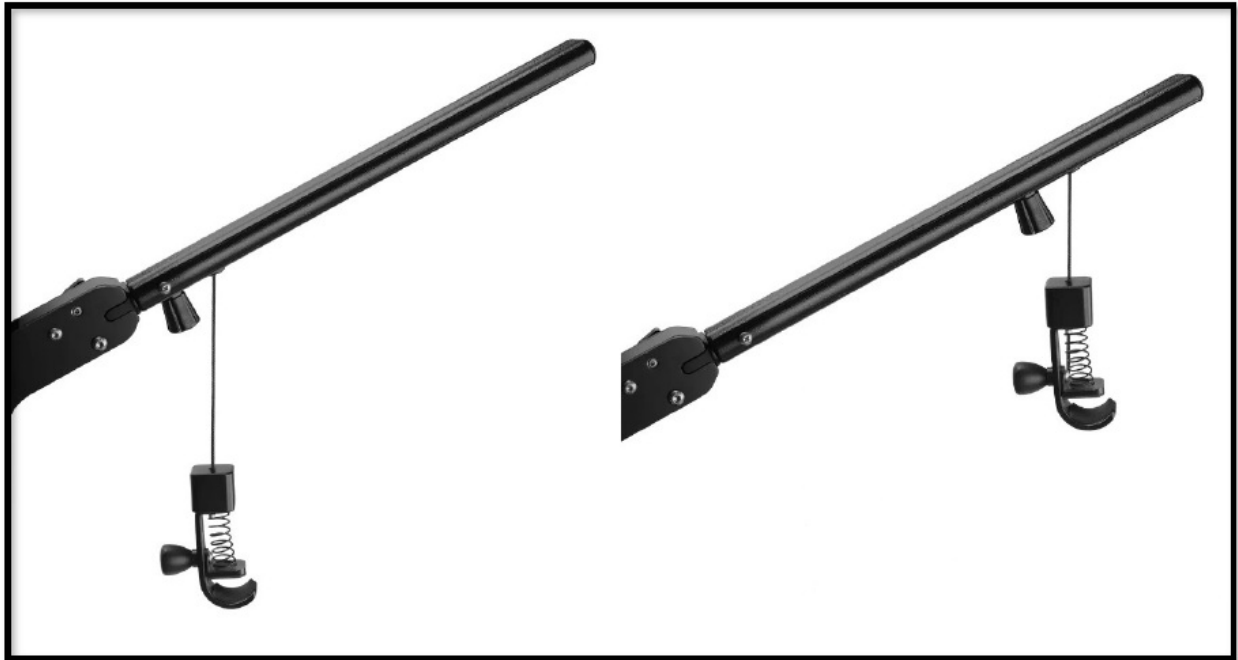

YOUR FLYCAM FLOWLINE MASTER WITH EDGE V1 STABILIZATION ARM IS ALL DRESSED UP AND READY TO GO!



(SHOWN WITH OPTIONAL ACCESSORIES)

Warranty:

We offer a year warranty for our products from date of purchase. Within this period of time, we will repair it without charge for labour or parts. Warranty doesn't cover transportation costs nor does it cover a product subjected to misuse or accidental damage. Warranty repairs are subjected to inspection and evaluation by us.

Liability: We are not liable for damage caused by products that we do not supply or from mishandling in transit, accident, misuse, neglect, or lack of care of the product, or service by anyone other than our company.

Contact Us:

In case of any kind of dissatisfaction, please Contact us immediately and we promise our utmost support and care until you use our product.

Documents / Resources

	<p>FLTCAL FLN-MSTR-EGV1 Flowline Master with Edge V1 Stabilization Arm [pdf] Instruction Manual</p> <p>FLN-MSTR-EGV1 Flowline Master with Edge V1 Stabilization Arm, FLN-MSTR-EGV1, Flowline Master with Edge V1 Stabilization Arm, Edge V1 Stabilization Arm, Stabilization Arm</p>
---	--

References

- [User Manual](#)

[Manuals+](#), [Privacy Policy](#)

This website is an independent publication and is neither affiliated with nor endorsed by any of the trademark owners. The "Bluetooth®" word mark and logos are registered trademarks owned by Bluetooth SIG, Inc. The "Wi-Fi®" word mark and logos are registered trademarks owned by the Wi-Fi Alliance. Any use of these marks on this website does not imply any affiliation with or endorsement.