



flox FLX-018-AS01 Flo X Split Clamp Instruction Manual

[Home](#) » [flox](#) » flox FLX-018-AS01 Flo X Split Clamp Instruction Manual 

Contents

- 1 [flox FLX-018-AS01 Flo X Split Clamp](#)
- 2 [Product Usage Instructions](#)
- 3 [PARTS INCLUDED](#)
- 4 [CONFIGURE CLAMP BRACKET](#)
- 5 [INSTALL CLAMP SCREW AND CLAMP PAD](#)
- 6 [FIT CLAMP TO DESK](#)
- 7 [TIGHTEN CLAMP SCREW](#)
- 8 [MAINTENANCE AND INSPECTION](#)
- 9 [DISCLAIMERS](#)
- 10 [Documents / Resources](#)



flox FLX-018-AS01 Flo X Split Clamp



Product Information

- Product Name: Clamp Bracket
- Model Number: FLX/018/AS01
- Parts Included: Clamp Cover, Bush Allen Key, Clamp Pad, Upper Clamp, Caphead Screws, Lower Clamp Clamp Screw
- Desk Thickness Range:
 - Setting 1: 9mm – 25mm (3/8" – 1")
 - Setting 2: 20mm – 45mm (3/4" – 1 3/4")

Product Usage Instructions

1. Configure Clamp Bracket:
 1. Tighten Clamp Screw using the Allen Key provided with the clamp.
2. Alternative Installation Methods for Restricted Gap at Rear of Work Surface:
 - Fold the Flo X Split Clamp FLX/018/AS01.
3. If required, change the clamp plate setting by:
 1. Removing the screws.
 1. Adjusting to the correct setting for Desk Thickness Range.
 2. Install Clamp Screw and Clamp Pad:

IMPORTANT NOTE: Ensure screw is tightened.

1. Fit Clamp to Desk:
 1. Fit Clamp Cover and Bush.
2. Warning:

Ensure proper maintenance and inspection of the product.

1. Disclaimers:

- Colebrook Bosson Saunders holds a number of patents and other intellectual property rights covering their products and processes.
Patent information can be found on their website at: www.colebrookbossonsaunders.com/patents.
- Consider leaving these instructions with the product if further installation may be required by others.

Print size – A4 297mm x 210mm

PARTS INCLUDED

FLX/018/AS01

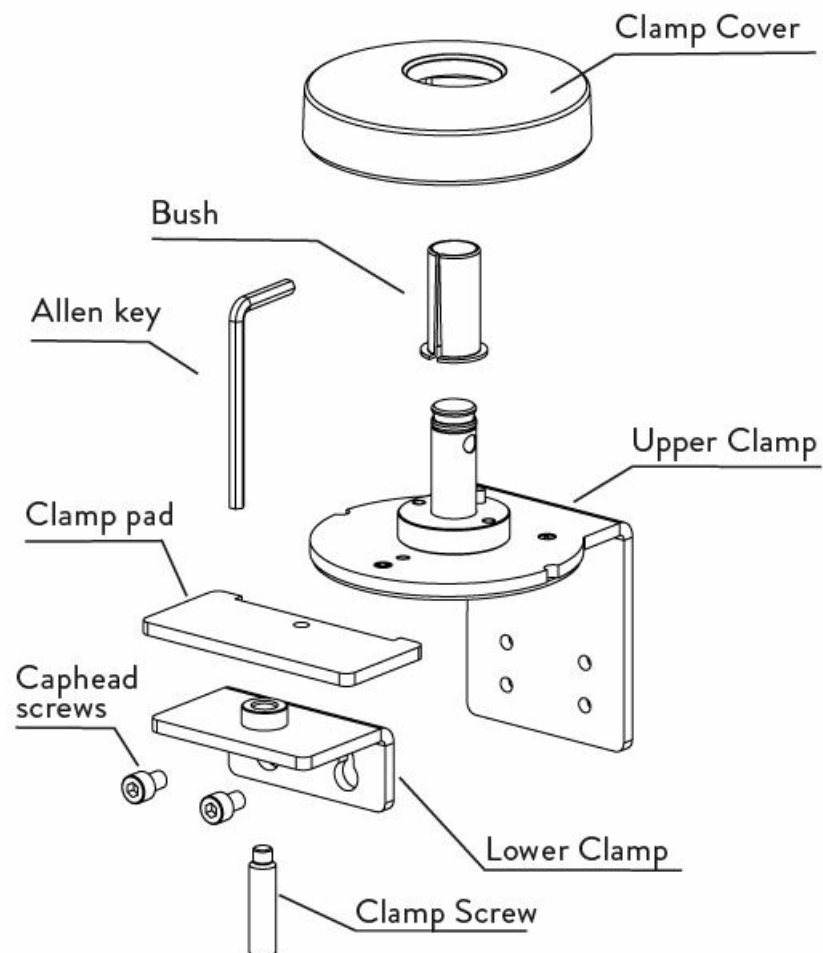

CONFIGURE CLAMP BRACKET

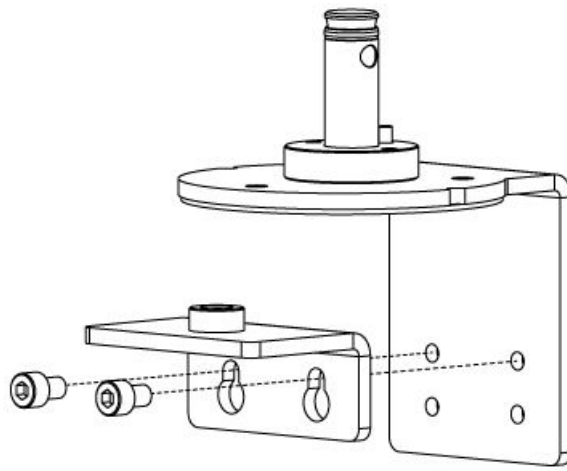

If required change the clamp plate setting by removing the screws and adjusting to correct setting

Desk Thickness Range

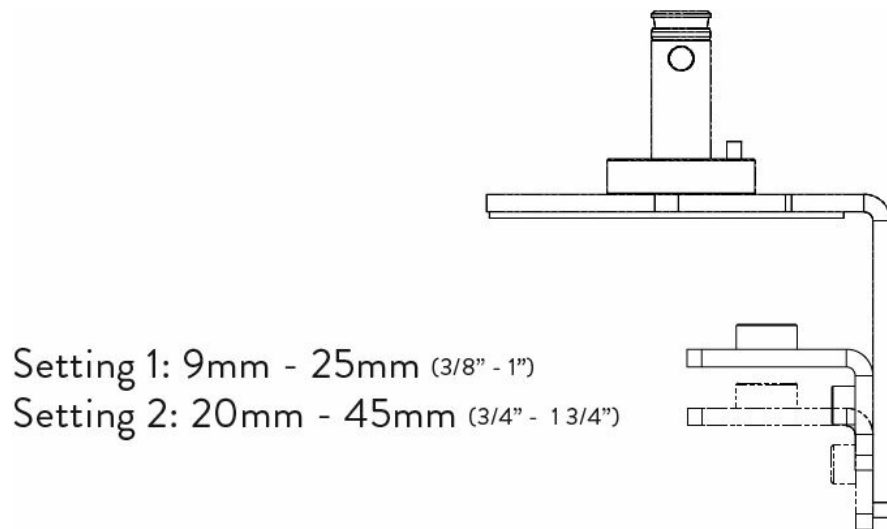

INSTALL LAMP SCREW AND CLAMP PAD

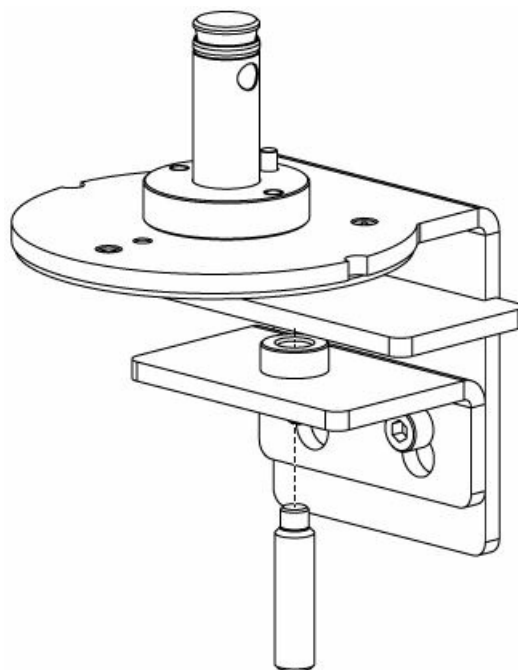

FIT CLAMP TO DESK

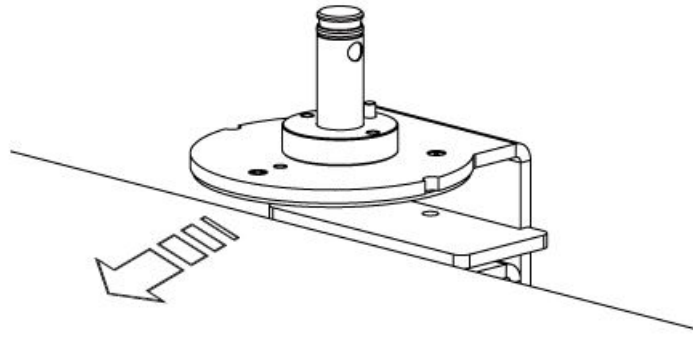

TIGHTEN CLAMP SCREW

Use Allen Key provided
with clamp

! IMPORTANT NOTE
Ensure screw is tightened

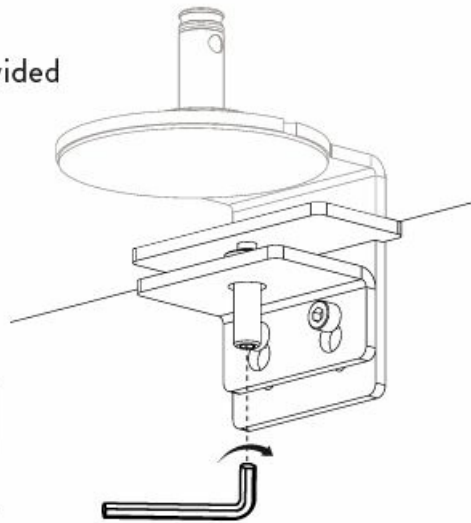

CONFIGURE 180° STOP (if required)

A 180° STOP ENGAGED

B 360° ROTATION

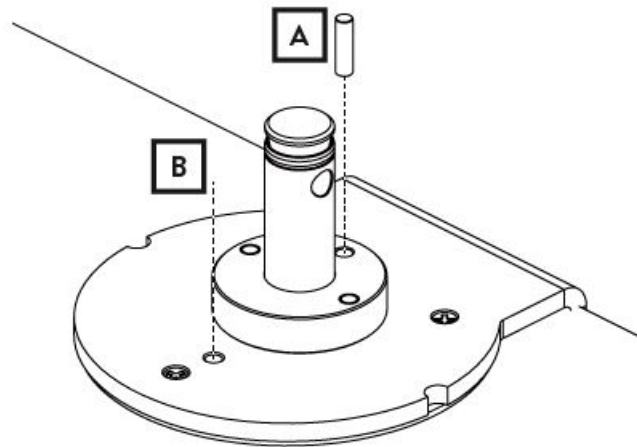
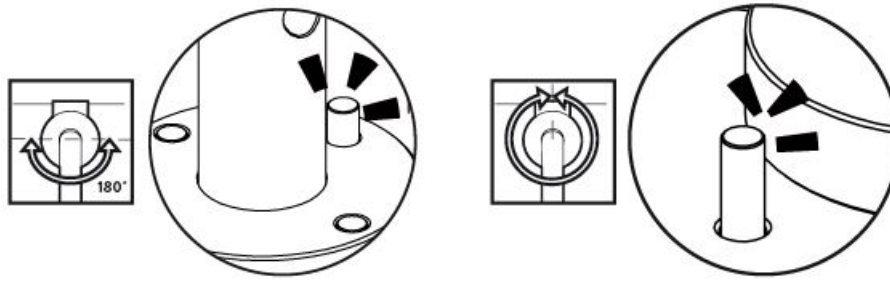

FIT CL AMP COVER AND BUSH

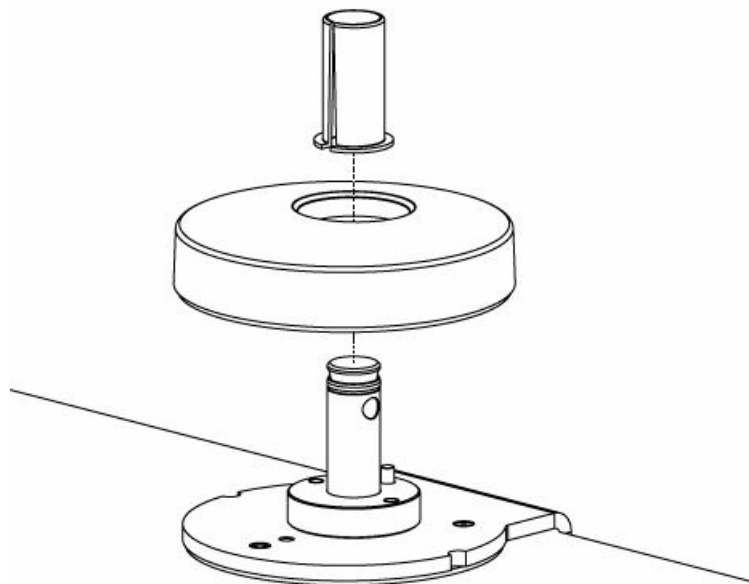

ALTERNATIVE INSTALLATION METHODS FOR RESTRICTED GAP AT REAR OF WORK SURFACE

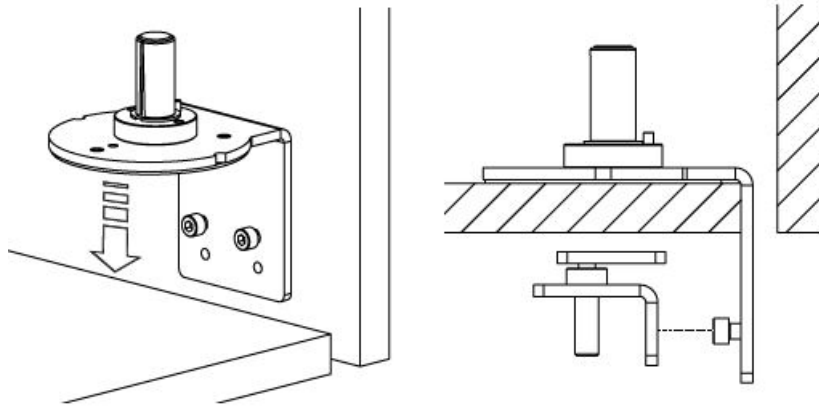

WARNING

- Do not use this product for any purpose other than that for which it was designed
 - Ensure desk/worksurface is suitable to take the weight of the arm/s and monitors
 - Supported weight must not exceed the maximum load per arm
- Take care when installing as fingers could become trapped

MAINTENANCE AND INSPECTION

Ensure all screws are tightened and occasionally adjust if needed
 Ensure arm is pushed fully down onto the clamp before installing the monitor(s)
 Clean with a damp cloth, NO solvents

DISCLAIMERS

The use of power tools, lever bars or excessive force during the installation, or re-configuration of the product will invalidate your guarantee
 Failure to observe the recommendations in the use, and configuration of these products may affect your guarantee
 As a part of Colebrook Bosson Saunders ongoing product improvement programme the design of products may change without prior notice and details may vary from those illustrated

PATENTS

Colebrook Bosson Saunders hold a number of patents and other intellectual property rights covering our products and processes. You can find patent information on our website at:
www.colebrookbossonsaunders.com/patents

Please consider leaving these instructions with the product if further installation may be required by others

FLX-018-AS01-INST-A-SEPT-2022

Documents / Resources

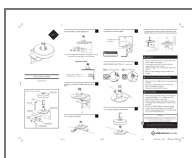

[flox FLX-018-AS01 Flo X Split Clamp](#) [pdf] Instruction Manual
 FLX-018-AS01 Flo X Split Clamp, FLX-018-AS01, Flo X Split Clamp, Split Clamp, Clamp