

FLOWMASTER 718114 Performance System Instruction Manual

[Home](#) » [FLOWMASTER](#) » FLOWMASTER 718114 Performance System Instruction Manual 

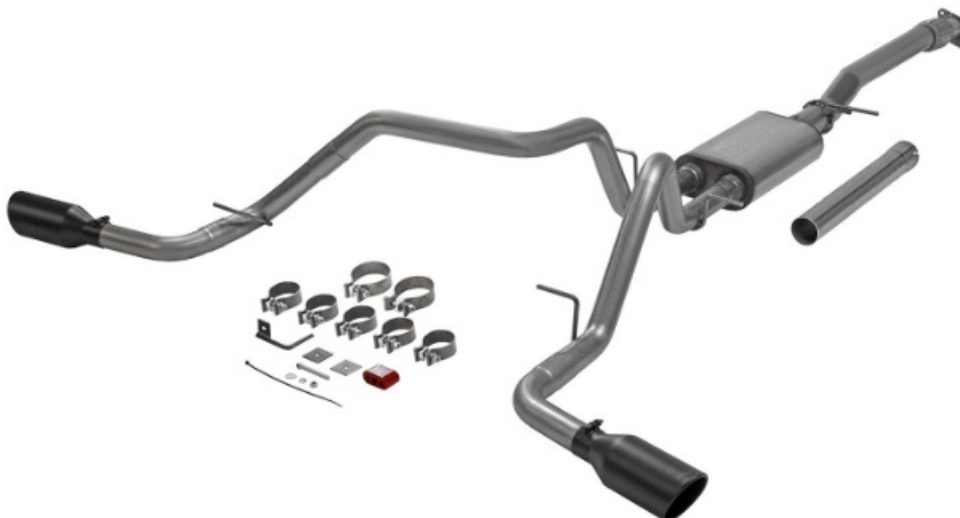

Installation Instructions
718114
2019-23 GM 1500 TRUCKS
2.7T ENGINE
147" and 157" wheelbase



Contents

[1 OVERVIEW](#)

[2 Installation Diagram](#)

[3 Documents / Resources](#)

[4 Related Posts](#)

OVERVIEW

1. Take a moment to read and understand these instructions before installing your Flowmaster performance system.

NOTE: Please inventory all parts now before continuing and if necessary, report any missing items to our tech line. This will avoid potentially stranding your vehicle until any missing replacement parts arrive.

ITM #	PART #	DESCRIPTION	QTY.
1	36083M	Inlet Pipe	1
2	36084M	Extension Pipe	1
3	72687-Z	FlowFX Muffler	1
4	86566M	Left Front Tailpipe	1
5	86568M	Left Rear Tailpipe	1
6	86567M	Right Tailpipe	1
7	86698M	Side Exit Pipe	2

REMOVE STOCK EXHAUST SYSTEM:

2. Raise vehicle up on a hoist or rack to working height. If you don't have access to a hoist or rack, support vehicle with jack stands.

WARNING: Avoid serious burns! Allow your vehicle time to cool completely before touching any factory engine components.

To ease preparation and installation of your new kit:

- Apply penetrating lubricant to mounts, bolts and clamps before you remove them.
- Use stands as necessary to support parts as you detach them from your vehicle and again as you install new parts.

ITM #	PART #	DESCRIPTION	QTY.
8	ST507B	Tips	2
N/A	PK1058	Hardware Package includes:	1
9	226HA	Frame Hanger	1
10	HA566	Backing Plate	2
11	HA168	Red Rubber Hanger	1
12	MC250BS	2-1/2" Stainless Band Clamp	5
13	MC350BS	3-1/2" Stainless Band Clamp	2
14	HW220	3/8-16 x 4" Bolt	1
15	HW303	3/8" Flat Washer	1
16	HW309	3/8" Lock Washer	1
17	HW103	3/8" Nut	1
18	HW502	7/16" Hanger Keeper	2
19	HW503	1/2" Hanger Keeper	4
20	HW505	15" Zip Tie	1

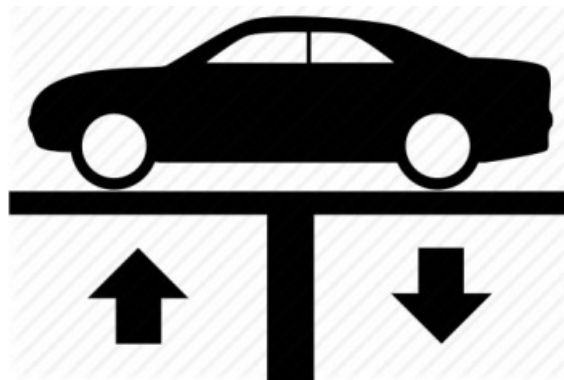

3. Cut tailpipe at muffler exit. Disassemble hanger wires from isolators and remove tailpipe section from vehicle.

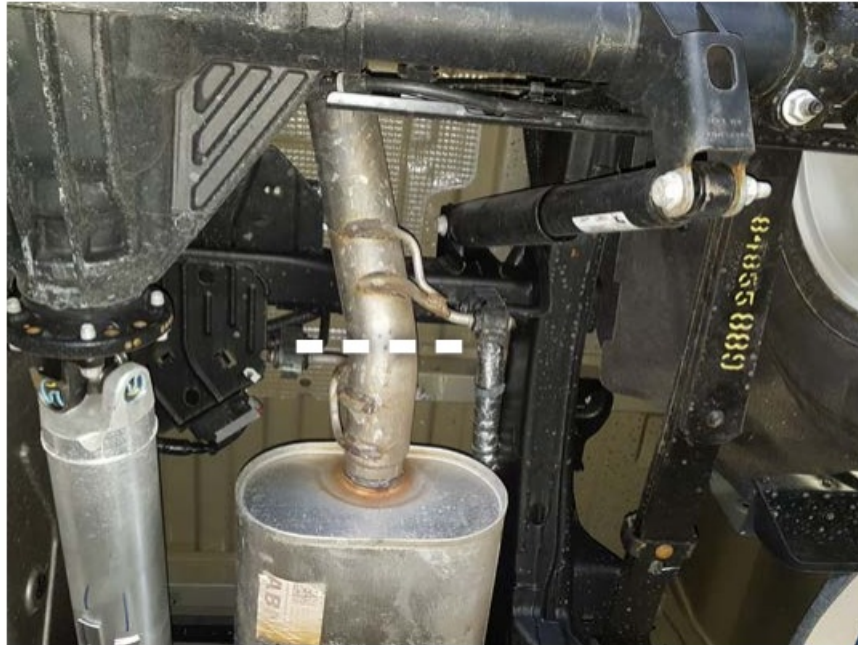

4. Support muffler and disassemble wire hangers from isolators. Remove and retain fasteners and gasket from flange, then remove muffler section from vehicle.



INSTALL FLOWMASTER EXHAUST SYSTEM:

5. Apply anti-seize compound to threaded fasteners for a more secure install.

NOTE: The image in this step is intended for illustrative purposes only and may or may not accurately reflect components included in your kit.



6. Install inlet pipe (1) with stock gasket and fasteners onto factory exhaust and insert wire hanger in isolator.





NOTE: If your vehicle has a 147" wheelbase, trim 10" from rear of extension pipe before continuing.

7. Place 3-1/2" clamp (13) onto extension pipe (2) then connect it to inlet pipe. Tighten clamp just enough to allow for adjustment.

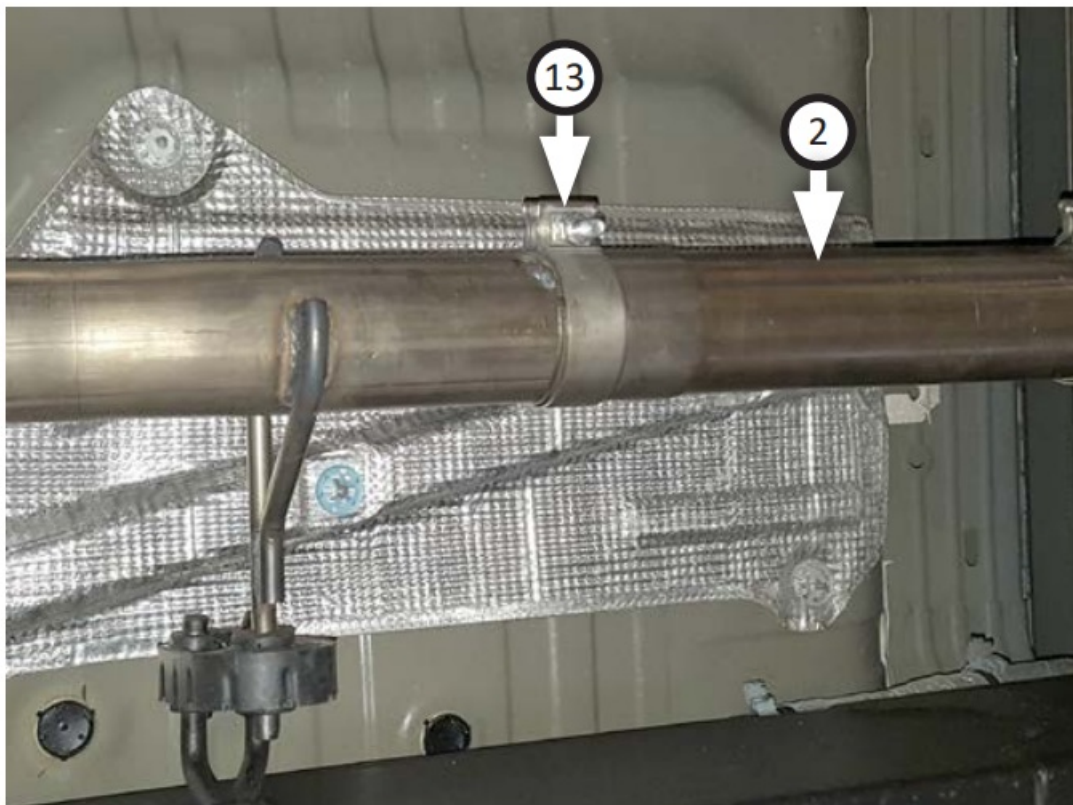

8. Place 3-1/2" clamp (13) on muffler (3) inlet then connect it to extension pipe. Tighten clamp just enough to allow for adjustment then place (x2) 2-1/2" clamps (12) onto muffler outlets.



9. Install frame hanger (9) on rear driver-side frame (with rod pointing inboard), using bolt (14) and backing plate (10) (on the outside), and backing plate (10), flat washer (15), lock washer (16), and nut (17) (on the inside). Place rubber hanger (11) on hanger rod.

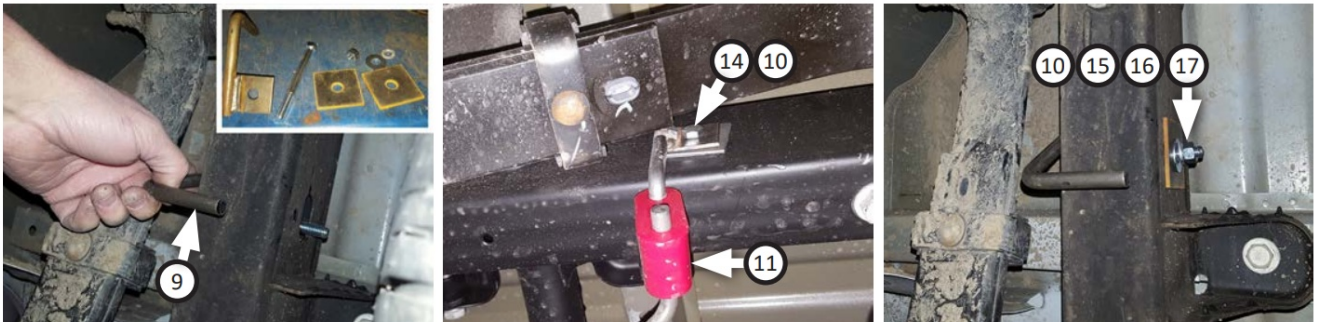

10. Route left front (4) and right tailpipes (6) over axle then connect them to muffler. Insert their wire hangers into isolators then tighten clamps just enough to allow for adjustment.

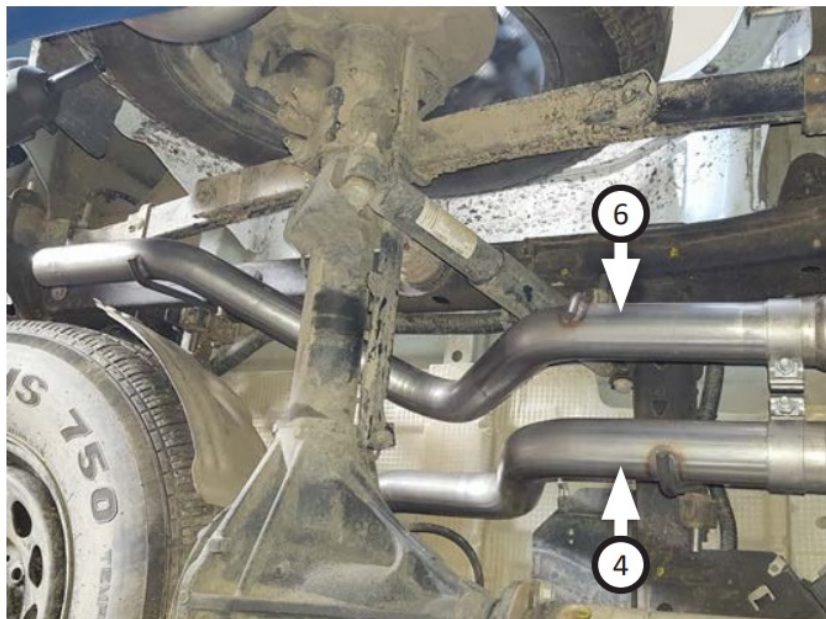

11. Place 2-1/2" clamp (12) onto left rear tailpipe (5) then connect it to left front tailpipe. Insert wire hanger into

rubber hanger then tighten clamp enough to hold parts.

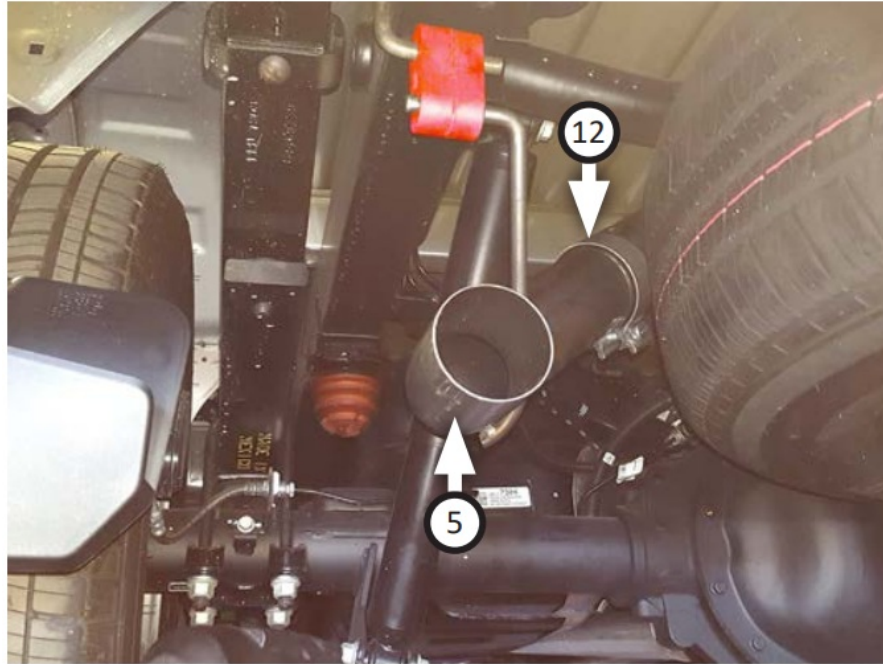

12. Place a 2-1/2" clamp (12) onto each side exit pipe (7), then connect exit pipes to tailpipes and tighten clamps just enough to hold parts.
13. Place a tip (8) onto each side exit pipe, and tighten inlets. Rotate exit pipes and tips to desired distance from body or bumper, so angle cut on tips are oriented as desired.



14. Adjust exhaust components for fit; maintaining 1/2-3/4" clearance, and compensating for suspension travel and vibration. Secure vent hose and brake lines away from exhaust components with zip tie (20), then tighten all clamps. Finally, install hanger keepers (18 & 19) onto hanger rods as shown in parts drawing.
15. Recommended: Secure slip-fit connections with a 1-inch tack weld, then spray welds with high-temp paint to prevent corrosion.

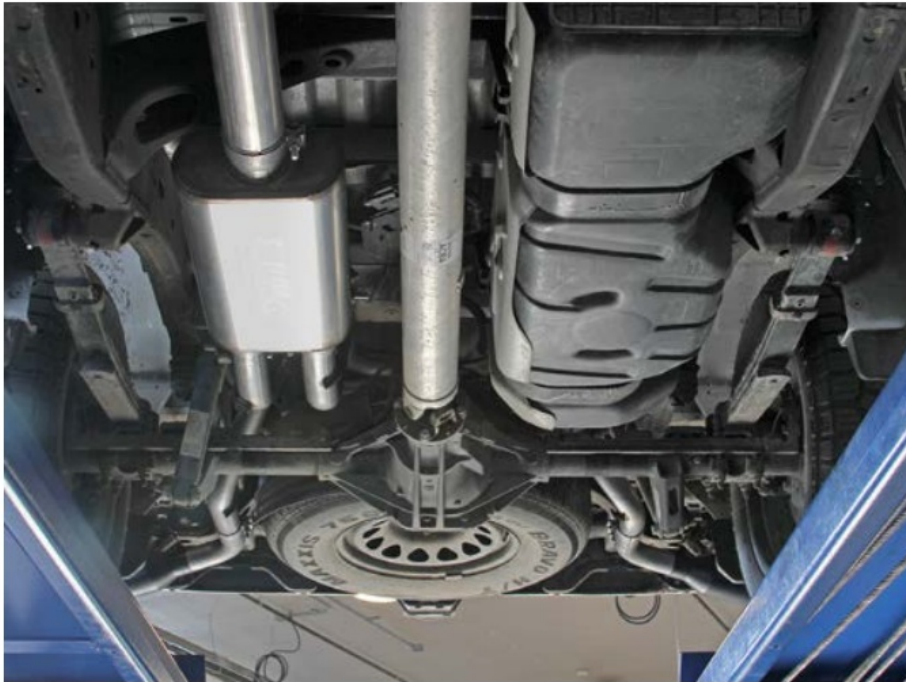

Congratulations, the installation of your FLOWMASTER performance exhaust system is now complete!



www.flowmastermufflers.com
Technical Support (866) 464-6553

Installation Diagram

718114
2019-23 GM 1500 TRUCKS
2.7T ENGINE

147" and 157" wheelbase

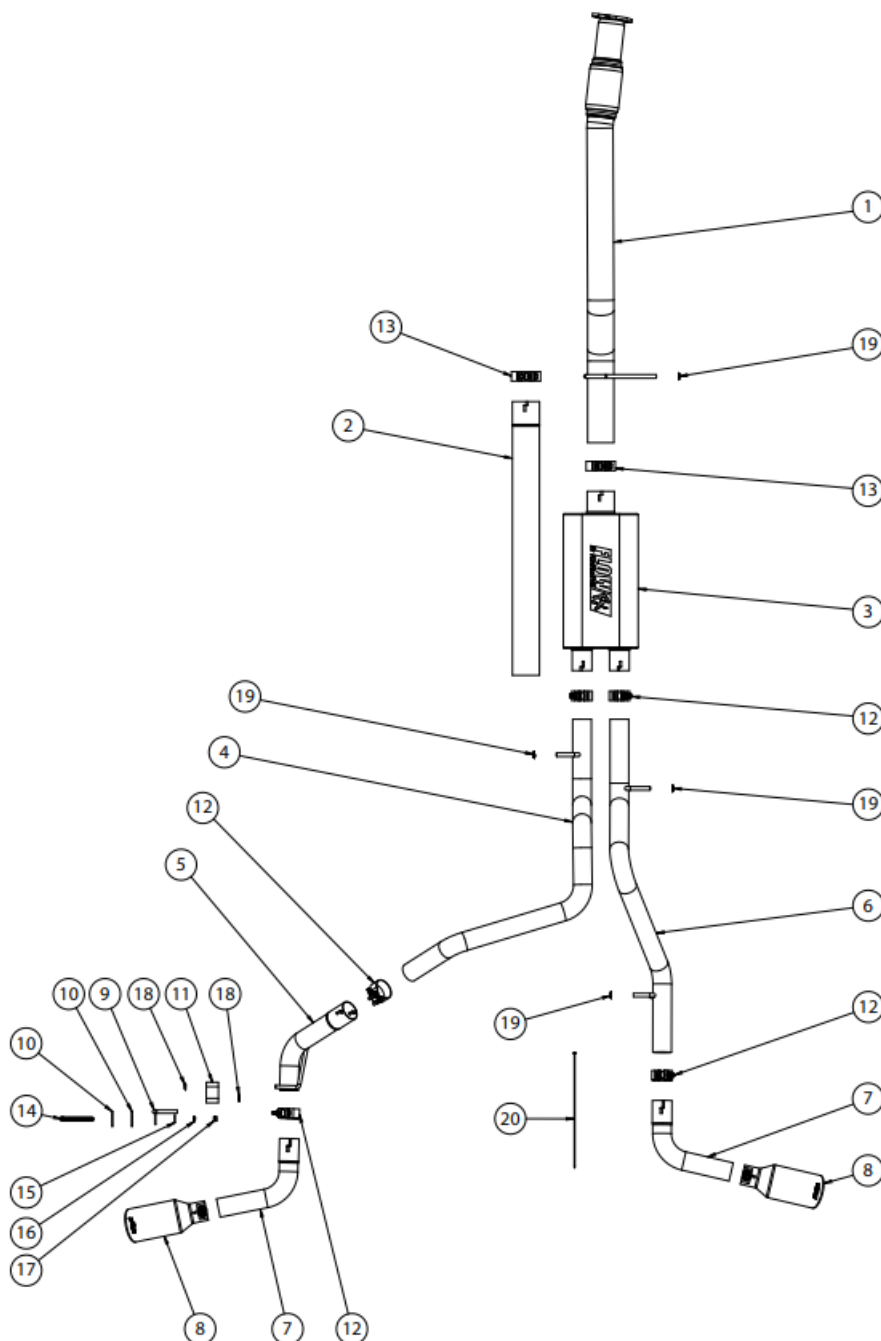

www.flowmastermufflers.com

Technical Support (866) 464-6553

Documents / Resources

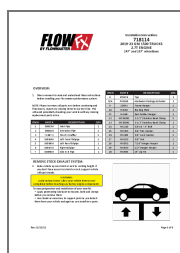

[FLOWMASTER 718114 Performance System](#) [pdf] Instruction Manual
718114 Performance System, 718114, Performance System

